

Latitude 38° 35'

Longitude 81° 15'

+ 1.73 S
+ 2.96 W

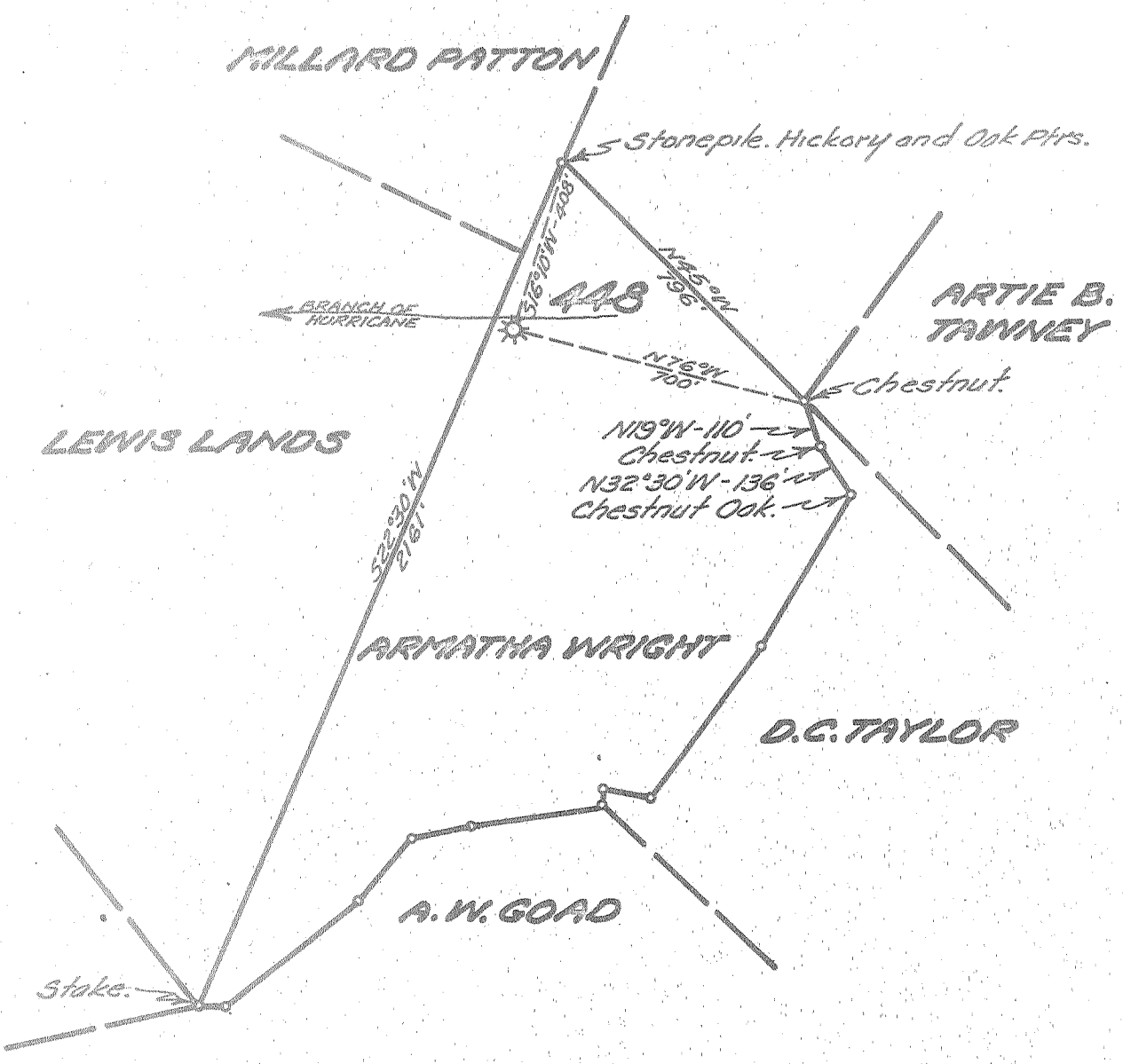

New Location
 Drill Deeper
 Abandonment

Company UNITED FUEL GAS CO.
 Address CHARLESTON, W. VA.
 Farm ARMATHA WRIGHT
 Tract _____ Acres 30 Lease No. 2242
 Well (Farm) No. 1 Serial No. 448
 Elevation (Spirit Level) 894'
 Quadrangle WALTON
 County ROANE District GEARY
 Engineer Paul E. Jacobus
 Engineer's Registration No. 669
 File No. 78-73 Drawing No. _____
 Date 4-23-54 Scale 1" = 400'

STATE OF WEST VIRGINIA
 DEPARTMENT OF MINES
 OIL AND GAS DIVISION
 CHARLESTON

See microfilm for Well Record
WELL LOCATION MAP
 FILE NO. ROA-824-A

+ Denotes location of well on United States Topographic Maps, scale 1 to 62,500, latitude and longitude lines being represented by border lines as shown.
 - Denotes one inch spaces on border line of original tracing.