

LATITUDE 38° 35'

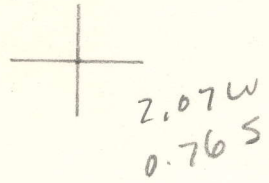

LONGITUDE

7'5 OGIS topo location

7.5' loc _____ 15' loc _____
 _____ (calc.) _____

Company _____

Farm _____

Quad Otter (sw)

County Roane

District Geary

WELL LOCATION MAP

File No. 087-725A

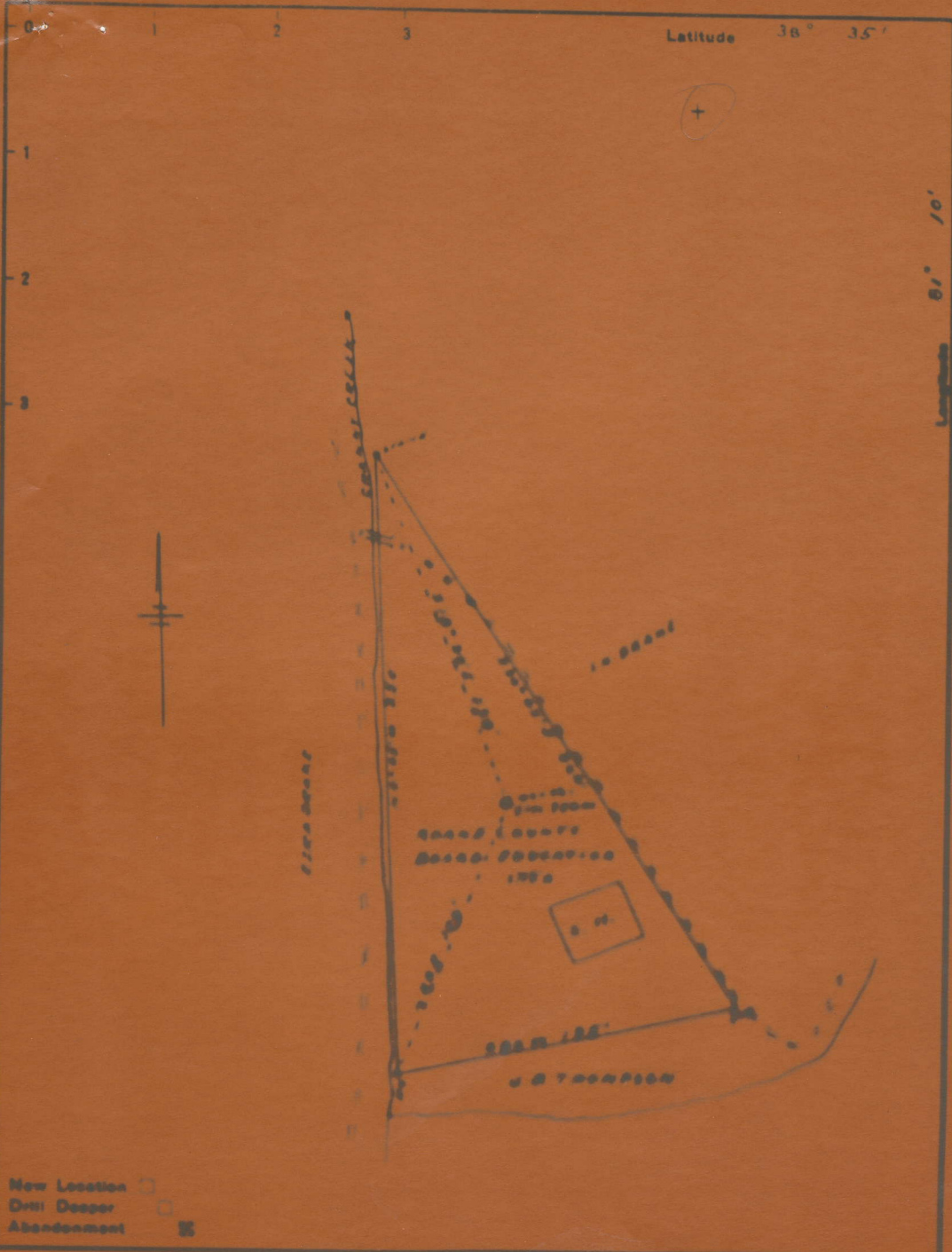

Company MOBLAY OIL & GAS CO.
 Address SPENCER, W. VA.
 Farm ROANE CO., BOARD EDUCATION

STATE OF WEST VIRGINIA
 DEPARTMENT OF MINES
 OIL AND GAS DIVISION
 CHARLESTON

ROANE COUNTY BOARD OF EDUCATION NO. 1. Roa-725-A.

By Morley Oil & Gas Co.

Geary Dist.

~~(NO PLAT)~~

see microfilm
for well record
& Plat