

New Location
 Drill Deeper
 Abandonment

Company SAM BEREN
 Address 516 - 4th St. MARIETTA, OHIO
 Farm BENJAMIN SUMMERFIELD
 Tract _____ Acres 126.0 Lease No. 1783
 Well (Farm) No. 5-8 Serial No. 3024
 Elevation (Spirit Level) 754 - 889
 Quadrangle WALTON
 County ROANE District SMITHFIELD
 Engineer C. E. Kuehl
 Engineer's Registration No. 9
 File No. _____ Drawing No. _____
 Date 8-8-49 Scale 1" - 400'

STATE OF WEST VIRGINIA
 DEPARTMENT OF MINES
 OIL AND GAS DIVISION
 CHARLESTON
 See microfilm for Well Record
WELL LOCATION MAP
 ROA-705-A-5
 FILE NO. ROA-707-A-B

+ Denotes location of well on United States Topographic Maps, scale 1 to 62,500, latitude and longitude lines being represented by border lines as shown.

- Denotes one inch spaces on border line of original tracing.

Roane 705 A comp. 1913 oil well TD 1815'
 707 A comp. 1920 oil well TD. 1934'

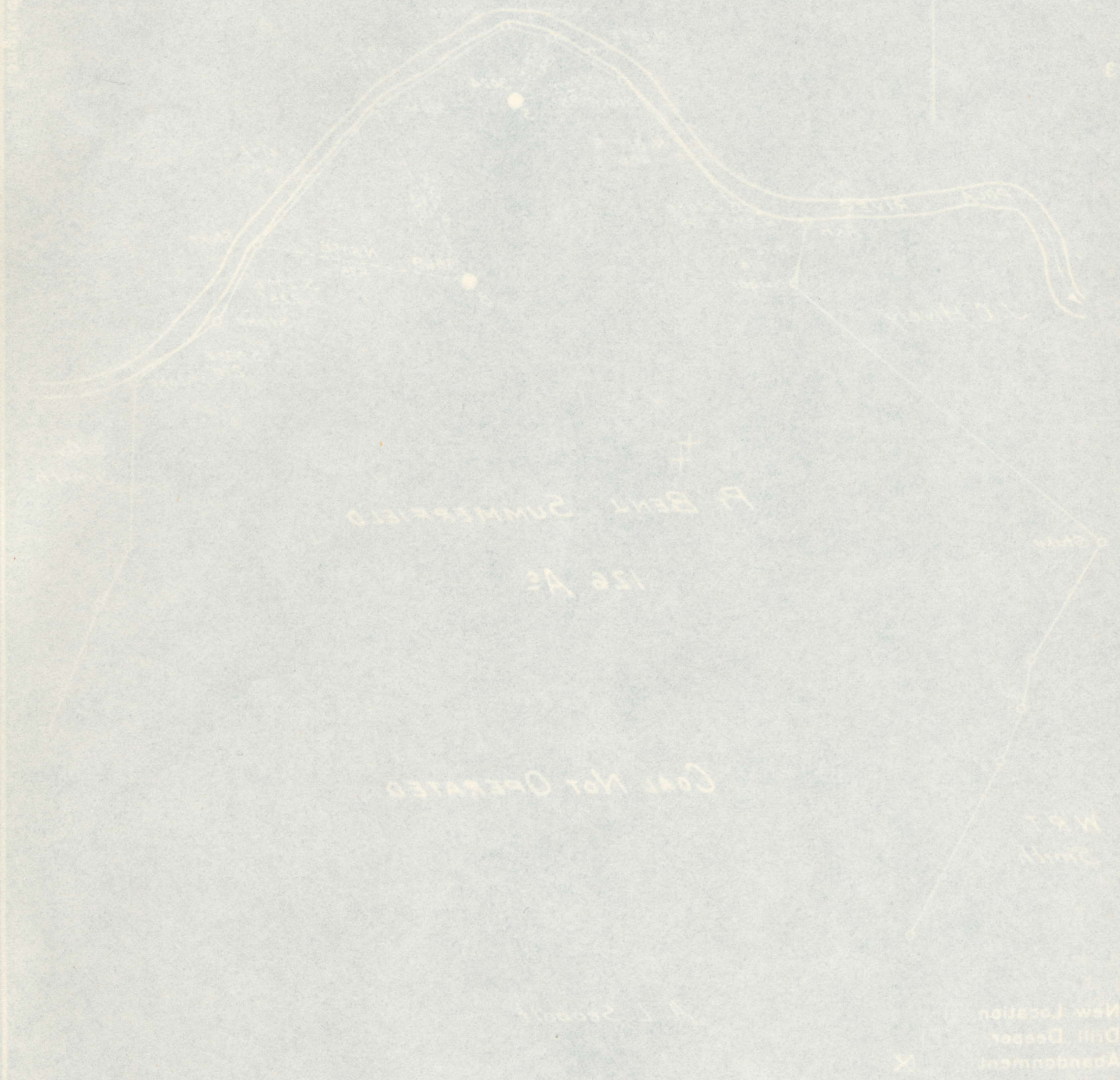

WELL LOCATION MAP
 STATE OF WEST VIRGINIA
 DEPARTMENT OF MINES
 OIL AND GAS DIVISION
 CHARLESTON
 FILE NO. 705-1913-5

+ Denotes location of well in United States
 Topographic Maps, scale 1 to 62,500, lat-
 itude and longitude lines being represented
 by border lines as shown.
 - Denotes one inch spaces on border line
 of original tracing

Date 8-8-43 Scale 1" = 400'
 File No. Drawing No.
 Engineer's Registration No. 7
 Engineer J. C. Smith
 County Roane District Smithfield
 Quadrangle Walton
 Elevation (Spot Level) 754 - 889
 Well (Farm No. 5 - 8 - 2022 Serial No. 3024
 Tract Acres 12.5 Lease No. 1723
 Farm Benjamin Summerfield
 Address 214 St. Marietta Ohio
 Company Sam Bevan