

Latitude  $38^{\circ} 45'$

Longitude  $81^{\circ} 15'$

F. F. Dye

L. C. Smith

Pt. BENJ. SUMMERFIELD

126 A<sup>c</sup>

COAL NOT OPERATED

W. R. T. Smith

0.03 W of  $81^{\circ} 20'$  (NC)

A. L. Seabolt

705-A	S 5.62
#5	W 4.60
707-A	S 5.72
#8	W 4.54

(NE)

- New Location...
- Drill Deeper.....
- Abandonment.....

Company SAM BEREN

Address 516 - 4th St., MARIETTA, OHIO

Farm BENJAMIN SUMMERFIELD

Tract \_\_\_\_\_ Acres 126.0 Lease No. 1783

Well (Farm) No. 5-8 Serial No. 3024

Elevation (Spirit Level) 754 - 889

Quadrangle WALTON

County ROANE District SMITHFIELD

Engineer B. E. Kuehl

Engineer's Registration No. 9

File No. \_\_\_\_\_ Drawing No. \_\_\_\_\_

Date 8-8-49 Scale 1" - 400'

STATE OF WEST VIRGINIA  
DEPARTMENT OF MINES  
OIL AND GAS DIVISION  
CHARLESTON

WELL LOCATION MAP

FILE NO. ROA-705-A-5  
ROA-707-A-B

+ Denotes location of well on United States Topographic Maps, scale 1 to 62,500, latitude and longitude lines being represented by border lines as shown.

- Denotes one inch spaces on border line of original tracing.

Roane 705 A comp. 1913 oilwell TD 1815'  
 707 A comp. 1928 oilwell TD. 1934'

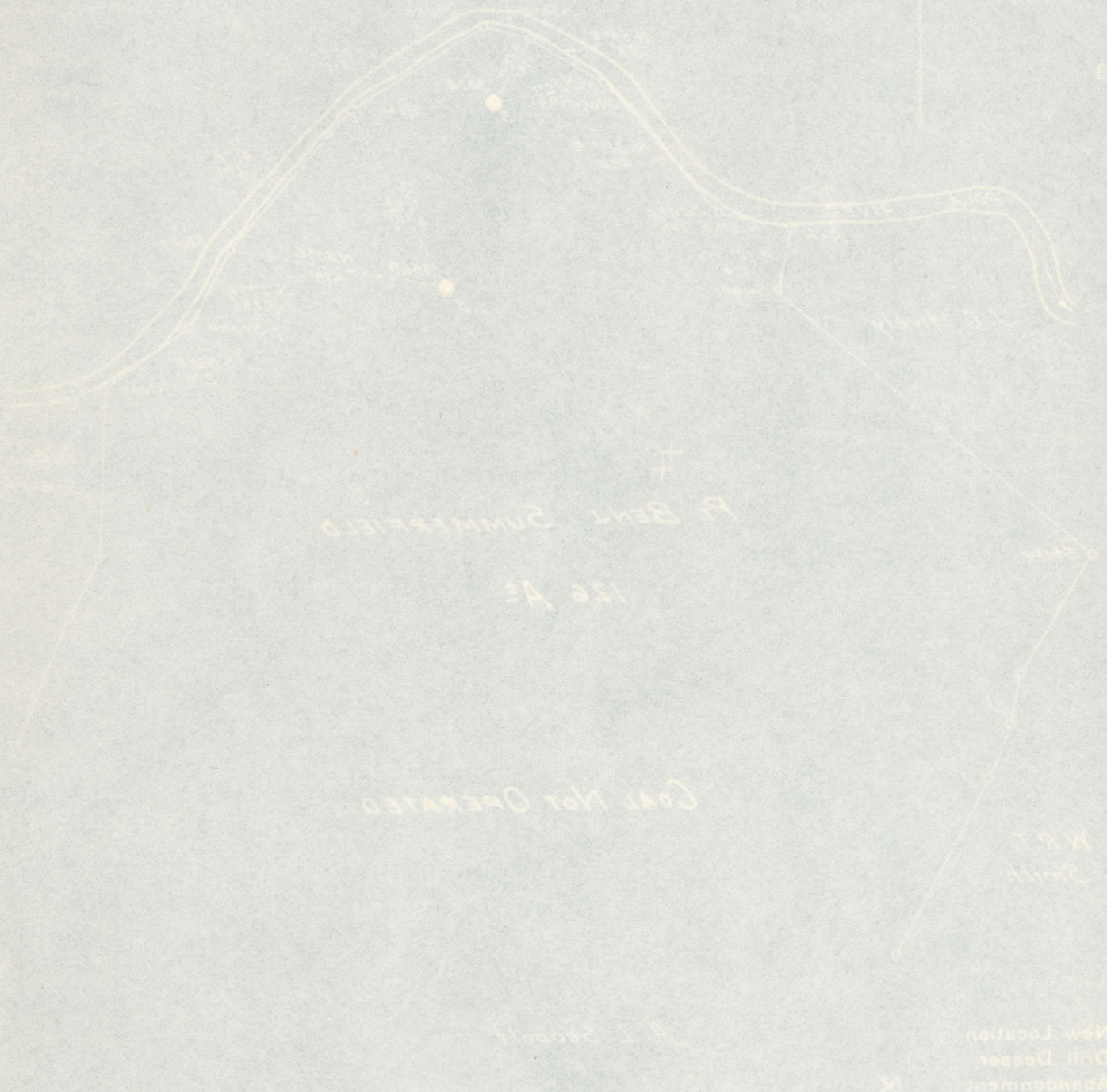

WELL LOCATION MAP  
 STATE OF WEST VIRGINIA  
 DEPARTMENT OF MINES  
 OIL AND GAS DIVISION  
 CHARLESTON

— Denotes one inch spaces on border line of original tracing  
 + Denotes location of well on United States Topographic Map, scale 1 to 62,500. latitude and longitude lines being represented by dotted lines as shown

Date 8-8-43  
 Scale 2" = 400'  
 Drawing No. 1  
 Engineer's Registration No. 7  
 Engineer J. C. Smith  
 County ROANE, District SMITHFIELD  
 Quadrangle WALTON  
 Elevation (Spot Level) 754 - 889  
 Well (Farm) No. 5 - B - 2022  
 Well (Farm) No. 5 - B - 2024  
 Tract Address 1/2 Sec. 5, Lease No. 1723  
 Farm BENJAMIN SUMMERFIELD  
 Address 28 1/2 W. St. Marietta Ohio  
 Company SAM BERRY