

Company UNITED FUEL GAS CO.
 Address CHARLESTON, W.VA.
 Farm C.C. WEAVER
 Tract _____ Acres 100 Lease No. 1856
 Well (Farm) No. 2 Serial No. 126
 Elevation (Spirit Level) 367.2
 Quadrangle SPENCER
 County ROANE District SPENCER
 Engineer J.M. Moore
 Engineer's Registration No. 662
 File No. 72-89 Drawing No. _____
 Date 11-19-48 Scale 1" = 400'

STATE OF WEST VIRGINIA
 DEPARTMENT OF MINES
 OIL AND GAS DIVISION
 CHARLESTON

See microfilm for Well Record

WELL LOCATION MAP
 FILE NO. ROA-584-A

+ Denotes location of well on United States Topographic Maps, scale 1 to 62,500, latitude and longitude lines being represented by border lines as shown.

- Denotes one inch spaces on border line of original tracing.

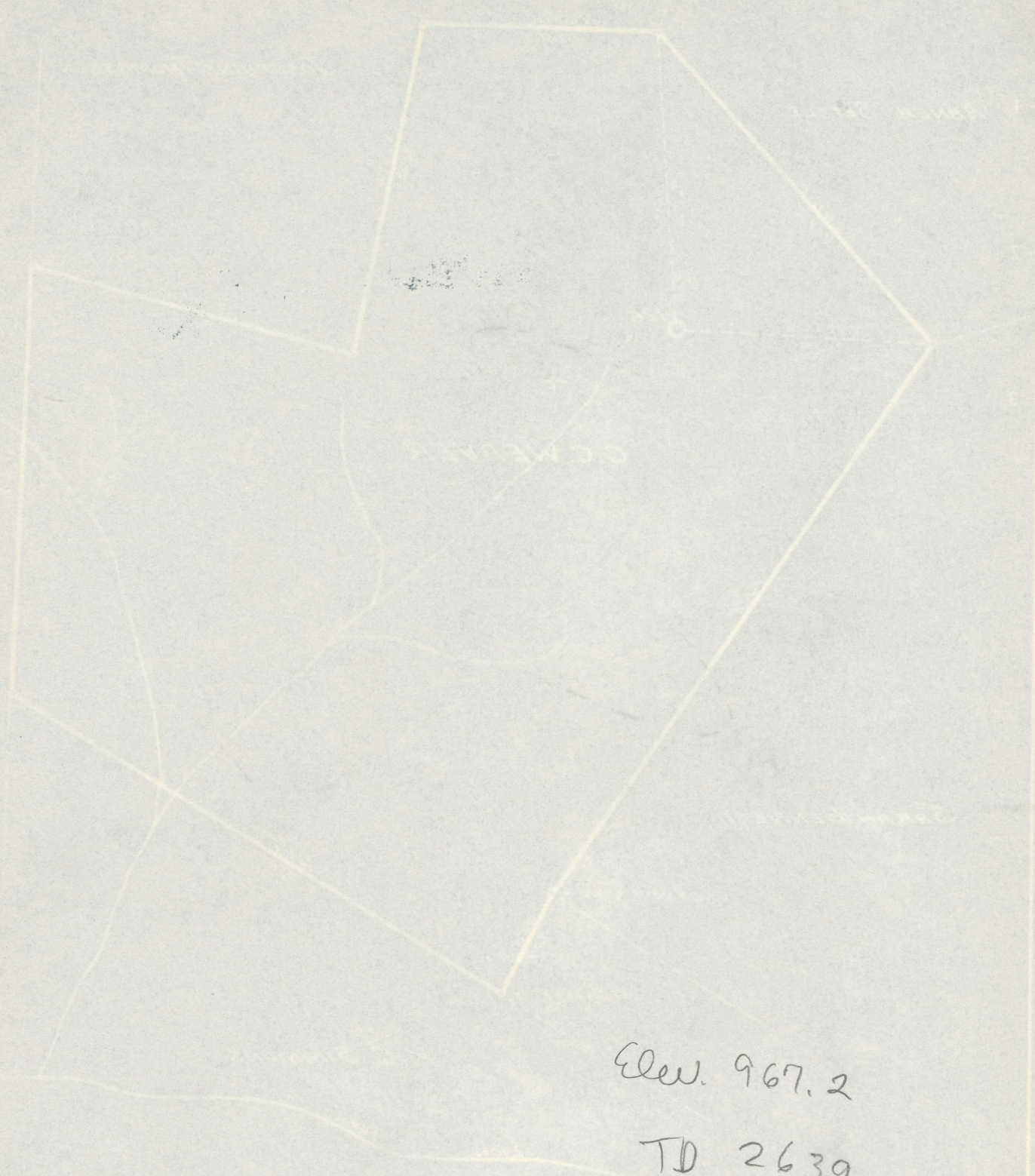

Elev. 967.2

TD 2639

DF-404

DFT=395

shot

2580-2594

Net OF 12,500 McF

Rk press 930 R/S.

New Location
Dist. Depart.
Assignment

Company
Address

Tract
Acres

Well No. 128
Elevation (Spit Level)

Quarterly
County

Engineer's
Engineer's Registration No.

The No. 75-25
Drawing No.
Date 11-19-78 Scale 1"=400'

STATE OF WEST VIRGINIA
DEPARTMENT OF MINES
OIL AND GAS DIVISION
CHARLESTON

WELL LOCATION MAP
FILE NO. RGA-284-A

+ Denotes location of well in United States
Topographic Map, scale 1" to 62,500', the
tube and longitude lines being represented
by dotted lines as shown.
- Denotes one inch scale of border line
of original tracing.