

I, the undersigned, hereby certify that this map is correct and shows all the information to the best of my knowledge and belief, required by the Oil and Gas Section of the Mining Laws of West Virginia.

G. B. Cunningham
Engineer

Acknowledged before me, a Notary Public of Kanawha County, W. Va.
this 16th day of February 1934.

My Commission expires Nov. 25 1940 J. L. Johnson

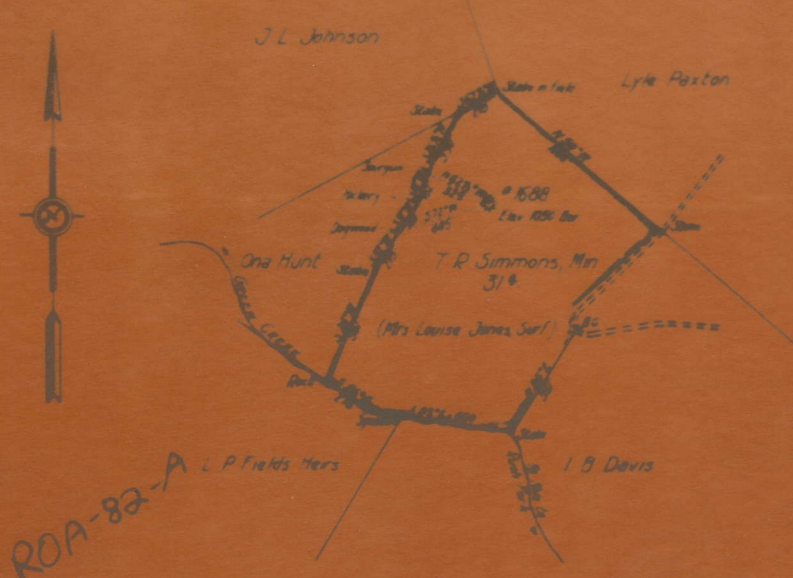

T. R. Simmons
Well No 1688
Harper District,
Roane County, W. Va.
Feb. 13, 1934.

UNITED FUEL GAS CO.
MAP SHOWING
WELL TO BE ABANDONED
SCALE: 1 INCH = 600 FEET

820

Harper District, Roane County, W. Va.

By United Fuel Gas Co., Charleston, W. Va.

On 31 acres, surface owned by Mrs. Louise Jones, Kettle, W. Va.,
and mineral rights by T. R. Simmons Heirs, J. H. Depue, Agent,
Spencer, W. Va.

Well was completed Oct. 27, 1926.

Elevation, 1050' B.

8 $\frac{1}{2}$ " casing, 710'; 6-5/8", 1825'.B. H. packer, 6-5/8 x 8 $\frac{1}{2}$ x 10, set at 1809'.

No coal was encountered.

Abandonment reported to Dept. of Mines Feb. 16, 1934.

Well was shot at 1960-1967'.

Production, 160,000 cu. ft.

No record of water.

	Top.	Bottom.	Thickness.
Soil	0	12	12
Slate	12	50	38
Sand	50	100	50
Red rock	100	400	300
Slate and shells	400	620	220
Sand	620	875	255
Slate and shells	875	1340	465
Salt Sand	1340	1630	290
Maxton Sand	1630	1760	130
Little Lime	1760	1782	22
Pencil Cave	1782	1792	10
Big Lime (gas, 1900')	1792	1914	122
Big Injun Sand (gas, 1921-1922'; gas, 1962-1965')	1914	1967	53
Slate, to bottom	1967	2014	47

(Green Creek)

Rush Fork