

LATITUDE 38°45'00"

LONGITUDE 81°17'30"

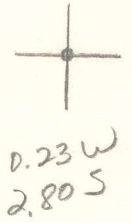

7'5 OGIS topo location

7.5' loc _____ 15' loc _____
 _____ (calc.) _____

Company CNB

Farm _____

Quad Looneyville 7 1/2'

County Round

District Smithfield

WELL LOCATION MAP

File No. 087-7A

(CNB # F-19336)

SOUTH PENN OIL COMPANY.

Proposed Abandonment: J.H Bays Well No. 2
Lease No. 60285. 150 acres. Smithfield District, Roane County, W Va
Leusel Fork of Poca River 505 39W
Scale 1 inch = 800' Elev. 995.5'

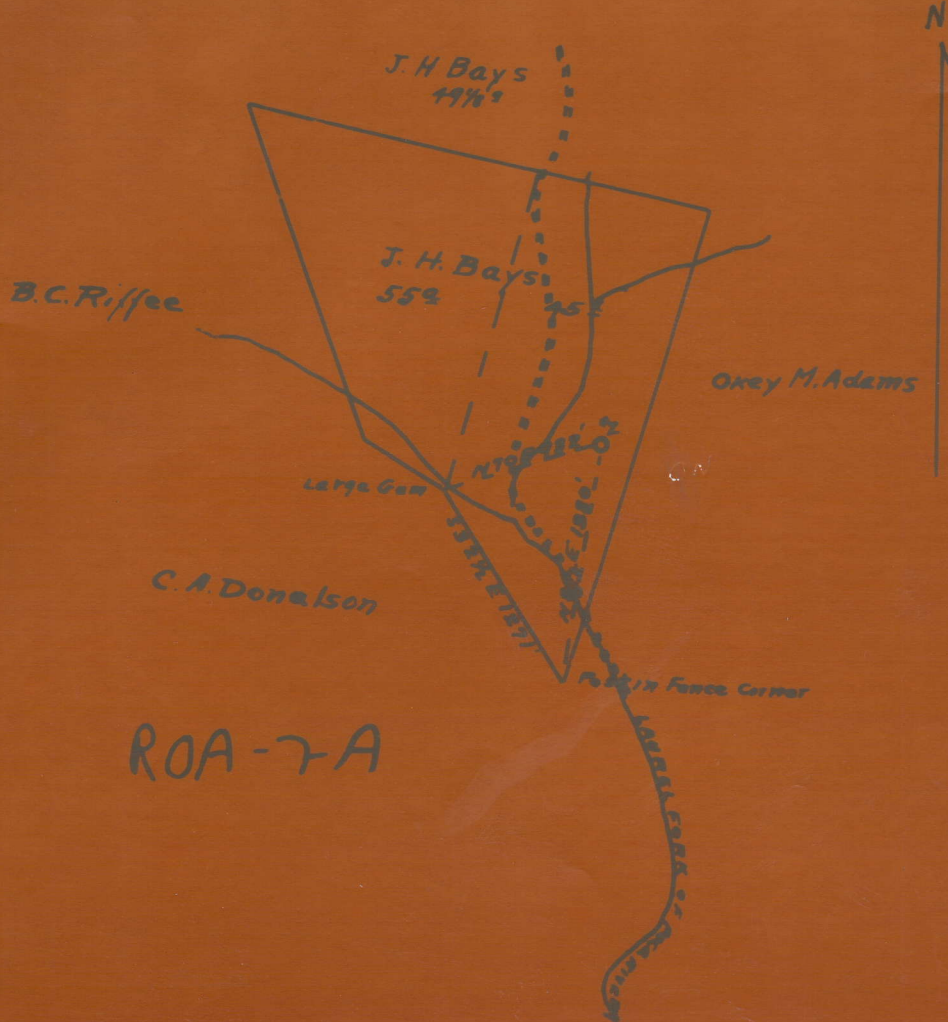

ROA-7A

I, the undersigned hereby certify that the...

BAYS, J. S., NO. 2.

Roa-7-A.

By South Penn Oil Co.

Smithfield Dist.

See microfilm
for plat

Well record on microfilm

Elev. = 995.5