



1) Date: June 2, 1983  
 2) Operator's Well No. 649-1  
 3) API Well No. 47 - 87 - 3843  
 State County Permit

DRILLING CONTRACTOR:

Unknown

STATE OF WEST VIRGINIA  
DEPARTMENT OF MINES, OIL AND GAS DIVISION

OIL AND GAS WELL PERMIT APPLICATION

- 4) WELL TYPE: A Oil  / Gas   
 B (If "Gas", Production  / Underground storage  / Deep  / Shallow )
- 5) LOCATION: Elevation: 977' Watershed: Leatherwood Run  
 District: Harper County: Roane Quadrangle: Kentuck 7 1/2'
- 6) WELL OPERATOR Key Oil, Inc. 11) DESIGNATED AGENT Joe McLaughlin  
 Address P.O. Box 709 Address P.O. Box 709  
Spencer, W.Va. 25276 Spencer, W.Va. 25276
- 7) OIL & GAS ROYALTY OWNER Gatha Berry 12) COAL OPERATOR None  
 Address P.O. Box 177 Address \_\_\_\_\_  
Craigsville, W.V. 26205
- 8) SURFACE OWNER Gatha Berry 13) COAL OWNER(S) WITH DECLARATION ON RECORD:  
 Address P.O. Box 177 Name None  
Craigsville, W.V. 26205 Address \_\_\_\_\_  
 Acreage 100 Name \_\_\_\_\_  
 Address \_\_\_\_\_
- 9) FIELD SALE (IF MADE) TO:  
 Address \_\_\_\_\_
- 10) OIL & GAS INSPECTOR TO BE NOTIFIED  
 Name Homer H. Dougherty Address \_\_\_\_\_  
Linden Route, Box 3-A  
Looneyville, WV 25259
- 15) PROPOSED WORK: Drill  / Drill deeper  / Redrill  / Fracture or stimulate   
 Plug off old formation  / Perforate new formation   
 Other physical change in well (specify) \_\_\_\_\_
- 16) GEOLOGICAL TARGET FORMATION, Marcellus Shale
- 17) Estimated depth of completed well, 5700 feet  
 18) Approximate water strata depths: Fresh, 200 feet; salt, 700 feet.  
 19) Approximate coal seam depths: None Is coal being mined in the area? Yes  / No

RECEIVED  
JUN -8 1983

OIL & GAS DIVISION  
DEPT. OF MINES

20) CASING AND TUBING PROGRAM

CASING OR TUBING TYPE	SPECIFICATIONS					FOOTAGE INTERVALS		CEMENT FILL-UP OR SACKS (Cubic feet)	PACKERS
	Size	Grade	Weight per ft.	New	Used	For drilling	Left in well		
Conductor									Kinds
Fresh water	9 5/8	H-40	32.3	X		300'	300'	To surface	by rule 15-05
Coal									Sizes
Intermediate	7	J-55	23	X		2,200'	2,200'	To surface	
Production	4 1/2	J-55	10.5	X		5,700'	5,700'	As needed	Depths set
Tubing									
Liners									Perforations: Top Bottom

21) EXTRACTION RIGHTS

Check and provide one of the following:  
 Included is the lease or leases or other continuing contract or contracts by which I hold the right to extract oil or gas.  
 The requirement of Code 22-4-1-(c) (1) through (4). (See reverse side for specifics.)

22) ROYALTY PROVISIONS

Is the right to extract, produce or market the oil or gas based upon a lease or other continuing contract or contracts providing for flat well royalty or any similar provision for compensation to the owner of the oil or gas in place which is not inherently related to the volume of oil or gas so extracted, produced or marketed? Yes  No

If the answer above is No, nothing additional is needed. If the answer is Yes, you may use Affidavit Form IV-60.

23) Required Copies (See reverse side.)

24) Copies of this Permit Application and the enclosed plat and reclamation plan have been mailed by registered mail or delivered by hand to the above named coal operator, coal owner(s), and coal lessee on or before the day of the mailing or delivery of this Permit Application to the Department of Mines at Charleston, West Virginia.

Notary: Charles T. Maxwell  
 My Commission Expires November 9, 1992

Signed: Joe M. Laughlin  
 Its: President

47-087-3843 OFFICE USE ONLY August 10, 1983

Permit number \_\_\_\_\_ DRILLING PERMIT Date 09/15/2023

This permit covering the well operator and well location shown below is evidence of permission granted to drill in accordance with the pertinent legal requirements subject to the conditions contained herein and on the reverse hereof. Notification must be given to the District Oil and Gas Inspector. (Refer to No. 10) Prior to the construction of roads, locations and pits for any permitted work. In addition, the well operator or his contractor shall notify the proper district oil and gas inspector 24 hours before actual permitted work has commenced.)

Permit expires April 10, 1984 unless drilling is commenced prior to that date and prosecuted with due diligence.

Bond: <u>B</u>	Agent: <u>[Signature]</u>	Plat: <u>[Signature]</u>	Casing: <u>[Signature]</u>	Fee: <u>958</u>
----------------	---------------------------	--------------------------	----------------------------	-----------------

Michael Lewis  
 Administrator, Office of Oil and Gas

File

Line Item Explanation

- 1) Date of Application
- 2) Your well name and number
- 3) To be filled out by office of oil & gas
- 4A) "Oil" means natural crude oil or petroleum and other hydrocarbons, regardless of gravity, which are produced at the well in liquid form by ordinary production methods and which are not the result of condensation of gas after it leaves underground reservoirs: "Gas" means all natural gas and all other fluid hydrocarbons not defined as oil.
- 4B) "Shallow well" means any well drilled and completed in a formation above the top of the uppermost member of the "Onondaga Group" or a depth less than six thousand feet, whichever is shallower.  
 "Deep well" means any well drilled and completed in a formation at or below the top of the uppermost member of the "Onondaga Group" or at a depth less than six thousand feet, whatever is shallower.
- 5) Where well is located
- 6) Before a permit can be issued in a corporation, company partnership, or fictitious name, the name must be registered with the Secretary of State Office
- 7) Use separate sheet if necessary
- 8) Present surface owner at time application is filed.
- 9) Optional
- 11) See Reg. 7.01 relating to code §22-4-1k
- 12) "Coal Operator" means any persons, firm, partnership, partnership association or corporation that proposes to or does operate a coal mine. See Note 24
- 13 & 14) As per §22-4-20; See Note 24
- 15) Work that will be attempted—A separate Form IV-2 shall not be required for fracturing or stimulating a well where fracturing or stimulating is to be part of the work for which a permit is sought and is noted as such on the Form IV-2 filed in connection therewith.
- 16) Anticipated formation for which well will be completed
- 17) Self explanatory
- 18) Depth to deepest freshwater, and shallowest salt water, taken from nearby wells corrected for differences in elevation
- 19) All coal seam depths
- 20) Proposed casing program and cementing refer to Code 22-4-5, 22-4-6, 22-4-7, 22-4-8, 22-4-8a Reg 9.01, 15.01, 15.02, 15.03, 15.04, 25.01, 25.02, 25.03, 25.04
- 21) Code 22-4-11(c) - In lieu of filing the lease or leases or other continuing contract or contracts, the applicant for a permit described herein may file the following:
  - (1) A brief description of the tract of land including the district and county wherein the tract is located;
  - (2) The identification of all parties to all leases or other continuing contractual agreements by which the right to extract, produce or market the oil or gas is claimed;
  - (3) The book and page number wherein each such lease or contract by which the right to extract, produce or market the oil or gas is recorded;
  - (4) A brief description of the royalty provisions of each such lease or contract.
- 22) Code 22-4-11(d) and 22-4-11(e).
- 23) Regulation 7.02 of the Department of Mines provides that the original and four copies of Form IV-2 must be filed with the Department, accompanied by (i) a plat in the form prescribed by Regulation 11, (ii) a bond in one of the forms prescribed by Regulation 12, or in lieu thereof the other security allowed by Code §22-4-2, (iii) Form IV-9, "Reclamation Plan", applicable to the reclamation required by Code §22-4-12b and Regulation 23, (iv) unless previously paid on the same well, the fee required by Code §22-4-12a, and (v) if applicable, the consent required by Code §22-4-8a from the owner of any water well or dwelling within 200 feet of the proposed well.
- 24) The above named coal operator, coal owner(s), and coal lessee are hereby notified that any objection they wish to make or are required to make by Code §22-4-3 must be filed with the Department of Mines within fifteen (15) days after the receipt of this Application by the Department.

.....

The following waiver must be completed by the coal operator and by any coal owner or coal lessee who has recorded a declaration under Code 22-4-20, if the permit is to be issued within fifteen (15) days of receipt thereof.

WAIVER

The undersigned coal operator \_\_\_\_\_ / owner \_\_\_\_\_ / lessee \_\_\_\_\_ / of the coal under this well location has examined this proposed well location. If a mine map exists which covers the area of the well location, the well location has been added to the mine map. The undersigned has no objection to the work proposed to be done at this location, provided, the well operator has complied with all applicable requirements of the West Virginia Code and the governing regulations.

09/15/2023

Date: \_\_\_\_\_, 19\_\_\_\_\_

By \_\_\_\_\_

Its \_\_\_\_\_

ATTACH OR PHOTOCOPY SECTION OF INVOLVED TOPOGRAPHIC MAP. QUADRANGLE \_\_\_\_\_

**LEGEND**











Well Site 

Access Road 

**WELL SITE PLAN**

Sketch to include well location, existing access road, roads to be constructed, wellsite, drilling pits and necessary structures numbered or lettered to correspond with the first part of this plan. Include all natural drainage.

**LEGEND**

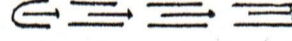
Property boundary 	Diversion 
Road 	Spring 
Existing fence 	Wet spot 
Planned fence 	Building 
Stream 	Drain pipe 
Open ditch 	Waterway 

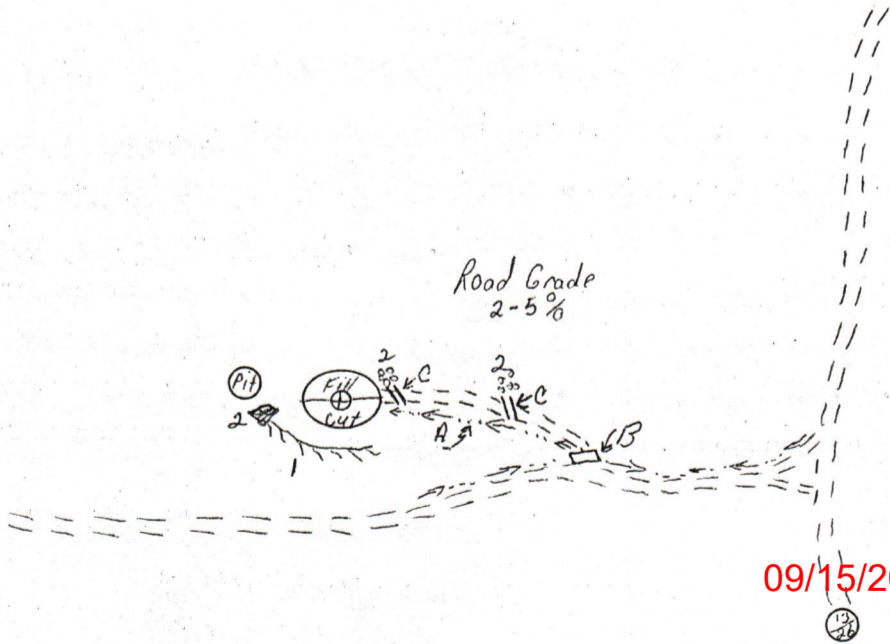

09/15/2023

State of West Virginia

Department of Mines  
Oil and Gas Division

CONSTRUCTION AND RECLAMATION PLAN

DESIGNATED AGENT Joe McLaughlin

COMPANY NAME Key Oil, Inc.

Address P.O. Box 709 Spencer, W.V., 25276

Address P.O. Box 709 Spencer, W.V., 25276

Telephone 304-927-5490

Telephone 304-927-5490

LANDOWNER Gatha Berry et. al.

SOIL CONS. DISTRICT Little Kanawha

Revegetation to be carried out by Key Oil, Inc. (Agent)

This plan has been reviewed by Little Kanawha SCD. All corrections

and additions become a part of this plan: 8-20-82

(Date)

(SCD Agent)

*Janet Newman*

ACCESS ROAD

LOCATION

(A) Structure Drainage Ditch

Spacing

Page Ref. Manual 2-12

(B) Structure Culvert (15")

Spacing

Page Ref. Manual 2-7

(C) Structure Cross Drains

Spacing 135'

Page Ref. Manual 2-1

All structures should be inspected regularly and repaired if necessary. All commercial timber is to be cut and stacked and all brush and small timber cut and removed from the site before dirt work begins.

REVEGETATION

Treatment Area I & II

Treatment Area II

Lime or correct to pH 6.5 Tons/acre

Fertilizer 500 lbs/acre (10-20-20 or equivalent)

Mulch Silva-fiber Tons/acre

Seed\* Ky. 31 Tall Fescue 20 lbs/acre

Flatpea 20 lbs/acre

lbs/acre

\*Inoculate all legumes such as vetch, trefoil and clovers with the proper bacterium. Inoculate with 3X recommended amount.

NOTES: Please request landowner cooperation to protect new seeding for one growing season. Attach separate sheets as necessary for comments.

lbs/acre

Seed\* lbs/acre

Mulch Tons/acre

Fertilizer lbs/acre (10-20-20 or equivalent)

Lime or correct to pH Tons/acre

ADDRESS P.O. Box 709

PHONE NO. 304-927-5490

OIL & GAS DIVISION  
DEPT. OF MINES

RECEIVED  
JUN 28 1982

DATE 8-20-82  
WELL NO. 1  
API NO. 47-087-3843





AGREEMENT, made and entered into this day of April 23, 1982, by and between P. H. Berry heirs: Dewey P. Berry and Mary Dot Berry, husband and wife, Clarence B. Berry, single and Gatha Berry, widow and Gladys M. Price, single, one half

P.O. Box 177 Craigsville, W. Va. 26205

Roane County of West Virginia, State of West Virginia, and described as follows, to-wit: Bounded on the NORTH by lands of Andrew Presley

EAST by lands of C. C. Chapman

SOUTH by lands of G. N. Price

WEST by lands of T. W. Hall

On Waters of Leatherwood Run

Containing Two tracts (1) 20 acres (2) 80 acres Total 100 acres, more or less.

2. It is agreed that this lease shall remain in force for a primary term of (1) One year from this date and as long thereafter as operations for oil or gas are being conducted on the premises, or oil or gas is found in paying quantities thereon.

3. The Lessee shall deliver to the credit of the Lessor free of cost, in the pipe line to which he may connect his wells, the equal one-eighth (1/8) part of all oil produced and saved from the leased premises, and shall pay Lessor their proportionate share of the equal one-eighth (1/8) part of all gas produced and saved from the leased premises for all gas and casing head gas produced and sold from the premises, payable monthly; provided, Lessee shall pay Lessor a royalty at the rate of Fifty Dollars per year on each gas well while, through lack of market, gas therefrom is not sold or used off the premises, and while said royalty is so paid said well shall be held to be a paying well under paragraph 2 hereof.

4. The Lessee shall commence operations for a well on the premises on or before May 3, 1982, unless Lessee pays thereafter a rental of \$5.00 per acre (12) twelve months that operations are delayed from the time above mentioned. The consideration first recited herein, the down payment, shall cover not only the privilege granted to the date when first said rental is payable as aforesaid, but also the Lessee's option of extending that period as aforesaid, and any and all other rights conferred. The drilling of a non-productive well shall be accepted by the Lessor in lieu of delay rental for a period of one year after its completion, and following the exhaustion or abandonment of all wells the Lessee shall have the right for a period of one year to resume the payment of delay rental or commence operations for another well. Upon the resumption of payment of rentals the provisions hereof governing such payment and the effect thereof shall continue in force as though they not been interrupted.

5. All moneys coming due hereunder shall be paid or tendered to Lessor 85 Prescott St., Cambridge, MA 021 direct, or by check payable to his (or her) order mailed to one half to Gladys M. Price at Cambridge, MA 021 and no default shall be declared against the Lessee by the Lessor for failure of the Lessee to make any payment or perform any conditions provided for herein unless the Lessee shall refuse or neglect to pay or perform the same for ten days after having received written notice by registered mail from the Lessor of his intention to declare such default.

6. Lessor reserves 200,000 cubic feet of gas per annum for domestic use, to be taken through his own appliances at any producing gas well, and agrees to pay Lessee a fair domestic rate for any gas used in excess thereof. Lessor further covenants and agrees that his taking and use of gas shall be wholly at his own risk, the Lessee not to be held liable for any accident or damage caused thereby, nor shall Lessee be liable for any shortage or failure in the supply of gas for said domestic use.

7. If said Lessor owns a less interest in the above described land than the undivided fee simple estate therein, then the royalties and rentals herein provided shall be paid the Lessor only in the proportion which his interest bears to the whole and undivided fee.

8. No well may be drilled nearer than 200 feet to the house or barn now on said premises without the written consent of Lessor. Lessee shall have and enjoy all rights and privileges necessary and convenient for the proper use and development of this lease, and shall have the right to use, free of cost, gas, oil and water produced on said land for its operations thereon, except water from wells of Lessor. Lessee shall also have the right at any time to remove all or any part of the machinery, fixtures or structures placed on said premises, including the right to draw and remove casing. Lessee shall pay for damages caused by its operations to growing crops on said lands, and, when requested by Lessor, shall bury its pipe lines below plow depth.

9. The interest or estate of either party hereto may be assigned, the privilege of assigning in whole or in part being expressly allowed. In event this lease shall be assigned as to any part or parts of the above described land and the assignee or assignees of such part or parts shall fall or make default in the payment of the proportionate part of the rents due from him or them, such default shall not operate to defeat or affect this lease insofar as it covers a part or parts of said land upon which the said Lessee or any assignee thereof shall make due payment of said rental. No change of ownership in the land or in the rentals or royalties shall be binding on the Lessee until after notice to the Lessee and it has been furnished with a written transfer or assignment or a certified copy thereof.

10. At any time, Lessee its successors or assigns, shall have the right to surrender this lease or any part thereof for cancellation, after which all payments and liabilities hereunder shall cease and determine, and if the whole is surrendered, then this lease shall become absolutely null and void. This surrender may be made to the Lessor, or if more than one Lessor, then to any one of them, or the heirs or assigns of any one of them by delivery of a duly executed surrender thereof in person or by mail addressed to the post office address of such person, or by recording a duly executed surrender thereof in the Recorder's office of the County in which the land is located.

11. Lessor hereby warrants and agrees to defend the title to the land herein described and agrees that the Lessee at its option may pay, discharge or redeem any taxes, mortgages, or other liens existing, levied, or assessed on or against the above described lands, and in event it exercises such option, it shall be subrogated to the rights of any holder or holders thereof and may reimburse itself by applying any royalty or rentals accruing hereunder to the discharge of any such taxes, mortgages or other liens.

12. It is expressly agreed that if the Lessee shall commence drilling operations at any time while this lease is in force, it shall remain in force and its terms continue so long as such operations are prosecuted, and if production results therefrom, then as long as production continues. If after the expiration of the term of this lease production from the leased premises shall cease from any cause, this lease shall not terminate provided Lessee resumes operations within sixty days from such cessation, and this lease shall remain in force during the prosecution of such operations, and, if production results therefrom, then as long as oil or gas is produced in paying quantities.

This instrument prepared by M & J JOINT VENTURE, Spencer, W. Va.

Check & receipt A. 298

2023/15/16

A-9

A-11

Attached to and made a part of that certain Oil and Gas lease dated the 23rd day of April, 1982. By and between M. and J. Joint Venture and Dewey P. Berry and Mary Dot Berry, Clarence B. Berry and Gatha Berry and Gladys M. Price, Single

Terms of Exhibit:

- (A) This lease covers to a depth of 6,000 feet or to the bottom of the Devonian shale whichever is greater
- (B) The Lessor must be consulted on the well sites
- (C) No pooling is allowed on this lease
- (D) No gas storage allowed on this lease
- (E) ----- A second well must be drilled within 180 days after first well completion to hold lease if spacing of wells is no problem

Dewey Berry  
Signed for identification

Date: April 23, 1982

Jack W. Floyd Agent  
M. & J. Joint Venture

STATE OF WEST VIRGINIA,  
ROANE COUNTY COMMISSION CLERK'S OFFICE, 12 May 1982 11:30 A.M.

Book No. 166

The foregoing instrument together with the certificate thereto annexed, was this date admitted to record in said office.

File No. 14594

Fee \$ 3.75

GENE M. ASHLEY, Clerk  
By Deputy Scarborough Deputy

09/15/2023



RECEIVED

JUN - 8 1983

AGREEMENT #649

WHEREAS, the undersigned did on the 23rd day of April, 1983, GAS DIVISION DEPT. OF MINES by oil and gas lease of record in the office of the clerk of the County Court of Roane County, West Virginia, in Book No. 166, at Page 272, lease unto M & J JOINT VENTURE, a tract of land containing one hundred (100) acres in Harper District of said county; and

WHEREAS, it is the desire of the undersigned to extend the primary term of the lease.

NOW, THEREFORE, WITNESSETH, That for and in consideration of the sum of One (\$1.00) Dollar, cash in hand paid, and other good and valuable considerations, the receipt of all of which is hereby acknowledged, the undersigned hereby extend the primary term of the above described lease for a period of <sup>one (1)</sup> ~~two (2)~~ years and do hereby provide that the primary term of said lease shall expire on the 23rd day of April, 1985.

Given under our hands and seals this 27<sup>th</sup> day of May, 1983.

X Gladys M. Price  
Gladys M. Price

STATE OF Massachusetts  
COUNTY OF Middlesex

Taken, subscribed and sworn to before me this 27<sup>th</sup> day of May, 1983, by Gladys M. Price, Single

Dec. 2 1989  
My Commission Expires:

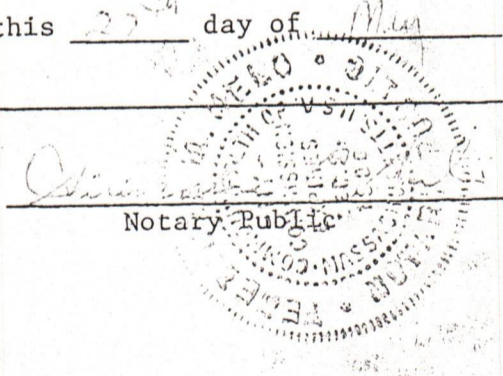

STATE OF \_\_\_\_\_  
COUNTY OF \_\_\_\_\_

Taken, subscribed and sworn to before me this \_\_\_\_\_ day of \_\_\_\_\_, 19\_\_\_\_, by \_\_\_\_\_

My Commission Expires:

Notary Public

09/15/2023

This instrument prepared by:  
M & J Joint Venture  
P.O. Box 727  
Spencer, W.Va. 25276

STATE OF WEST VIRGINIA,  
ROANE COUNTY COMMISSION CLERK'S OFFICE, 2 June, 1983 2:47 P.  
Book No. 173

The foregoing instrument together with the certificate thereto annexed, was this date admitted to record in said office.

BOOK 173 PAGE 255

B-11



State of West Virginia

BARTON B. LAY, JR.  
DIRECTOR

Department of Mines  
Oil and Gas Division  
Charleston 25305

THEODORE M. STREIT  
ADMINISTRATOR

February 19, 1985

Key Oil Company  
P. O. Box 709  
Spencer, WV 25276

In Re: Permit No:	<u>47-087-3843</u>
Farm:	<u>Gatha Berry</u>
Well No:	<u>649-1</u>
District:	<u>Harper</u>
County:	<u>Roane</u>
Issued:	<u>8-10-83</u>

Gentlemen:

The FINAL INSPECTION REPORT for the above captioned well has been received in this office. Only the column checked below applies:

XXXXXX The well designated by the above captioned permit number has been released under your Blanket Bond. (PERMIT CANCELLED - NEVER DRILLED)

Please return the enclosed cancelled single bond which covered the well designated by the above permit number to the surety company who executed said bond in your behalf, in order that they may give you credit on their records.

Your well record was received and reclamation requirements approved. In accordance with Chapter 22, Article 4, Section 2, the above captioned well will remain under bond coverage for life of the well.

Very truly yours,

Theodore M. Streit, Administrator  
Dept. Mines-Office of Oil & Gas

TMS/nw

09/15/2023

73-12

STATE OF WEST VIRGINIA  
DEPARTMENT OF MINES  
OIL AND GAS DIVISION  
STATUS INSPECTION REQUEST  
INSPECTOR'S COMPLIANCE REPORT

Permit No. 087-3843 County. Roane  
Company. Key Oil, Inc. Farm. Gatha Berry  
Inspector. Homer Dougherty Well No. 649-1  
Date. September 20, 1984 Issued. 8-10-83

RULE	DESCRIPTION	IN COMPLIANCE	
		YES	NO
23.06	Notification Prior to starting Work	___	___
25.04	Prepared before Drilling to prevent Waste	___	___
25.03	High-Pressure Drilling	___	___
16.01	Required Permits at Wellsite	___	___
15.03	Adequate Fresh Water Casing	___	___
15.02	Adequate Coal Casing	___	___
15.01	Adequate Production Casing	___	___
15.04	Adequate Cement Strength	___	___
23.02	Maintained Access Roads	___	___
25.01	Necessary Equipment to prevent Waste	___	___
23.03	Reclaimed Drilling Site	___	___
23.04	Reclaimed Drilling Pits	___	___
23.05	No Surface or Underground Pollution	___	___
7.03	Identification Markings	___	___

**RECEIVED**  
FEB 18 1985  
OIL & GAS DIVISION  
DEPT. OF MINES

COMMENTS: Please issue final on cancellation if location is okay. Permit  
expired on 4-10-84 and company says well was not drilled.

I have inspected the above well and ~~(Have/Have Not)~~ found it to be in compliance with all of the rules and regulations of the Office of Oil and Gas-Department of Mines of the State of West Virginia.

SIGNED: Homer H. Dougherty  
DATE: 2/12/85

09/15/2023

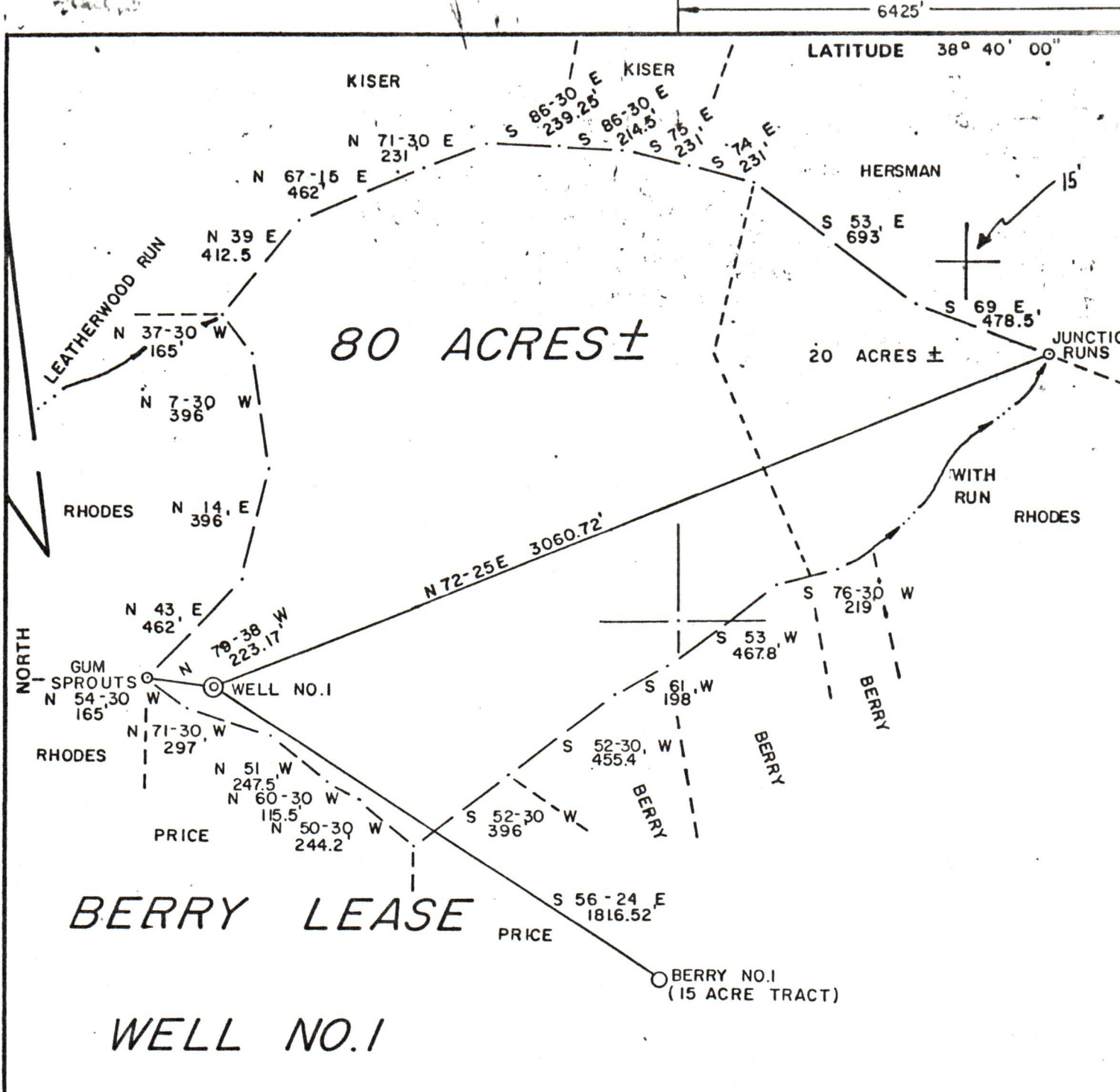

FILE NO. 8-6  
 DRAWING NO. \_\_\_\_\_  
 SCALE 1" = 500'  
 MINIMUM DEGREE OF ACCURACY 1/200  
 PROVEN SOURCE OF ELEVATION JUNCTION OF ROADS  
ELEV. 988'

I THE UNDERSIGNED, HEREBY CERTIFY THAT THIS PLAT IS CORRECT TO THE BEST OF MY KNOWLEDGE AND BELIEF AND SHOWS ALL THE INFORMATION REQUIRED BY LAW AND THE REGULATIONS ISSUED AND PRESCRIBED BY THE DEPARTMENT OF MINES.  
 (SIGNED) Gregory A. Smith  
 R.P.E. \_\_\_\_\_ L.L.S. 677

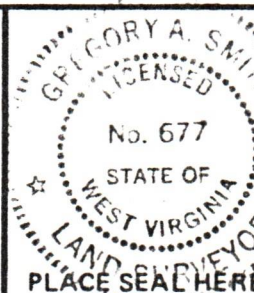

(+) DENOTES LOCATION OF WELL ON UNITED STATES TOPOGRAPHIC MAPS  
 FORM IV-6 (8-78)

  
**STATE OF WEST VIRGINIA**  
 DEPARTMENT OF MINES  
 OIL AND GAS DIVISION

DATE JULY 26, 1982  
 OPERATOR'S WELL NO. 1  
 API WELL NO. 47-087-3843  
 STATE WEST VIRGINIA COUNTY ROANE PERMIT cancelled

WELL TYPE: OIL  GAS  LIQUID INJECTION  WASTE DISPOSAL   
 (IF "GAS,") PRODUCTION  STORAGE  DEEP  SHALLOW   
 LOCATION: ELEVATION 977' WATER SHED LEATHERWOOD RUN  
 DISTRICT HARPER COUNTY ROANE  
 QUADRANGLE KENTUCK 7.5'

SURFACE OWNER GATHA BERRY et. al. ACREAGE 80 09/15/2023  
 OIL & GAS ROYALTY OWNER GATHA BERRY et. al. LEASE ACREAGE 100  
 LEASE NO. 649

PROPOSED WORK: DRILL  CONVERT  DRILL DEEPER  REDRILL  FRACTURE OR STIMULATE  PLUG OFF OLD FORMATION  PERFORATE NEW FORMATION  OTHER PHYSICAL CHANGE IN WELL (SPECIFY) \_\_\_\_\_

PLUG AND ABANDON  CLEAN OUT AND REPLUG   
 TARGET FORMATION MARCELLUS ESTIMATED DEPTH 5175'  
 WELL OPERATOR KEY OIL COMPANY DESIGNATED AGENT JOE McLAUGHLIN  
 ADDRESS P.O. BOX 709 ADDRESS P.O. BOX 727  
SPENCER W.V. 25276 SPENCER W.V. 25276