

M

P

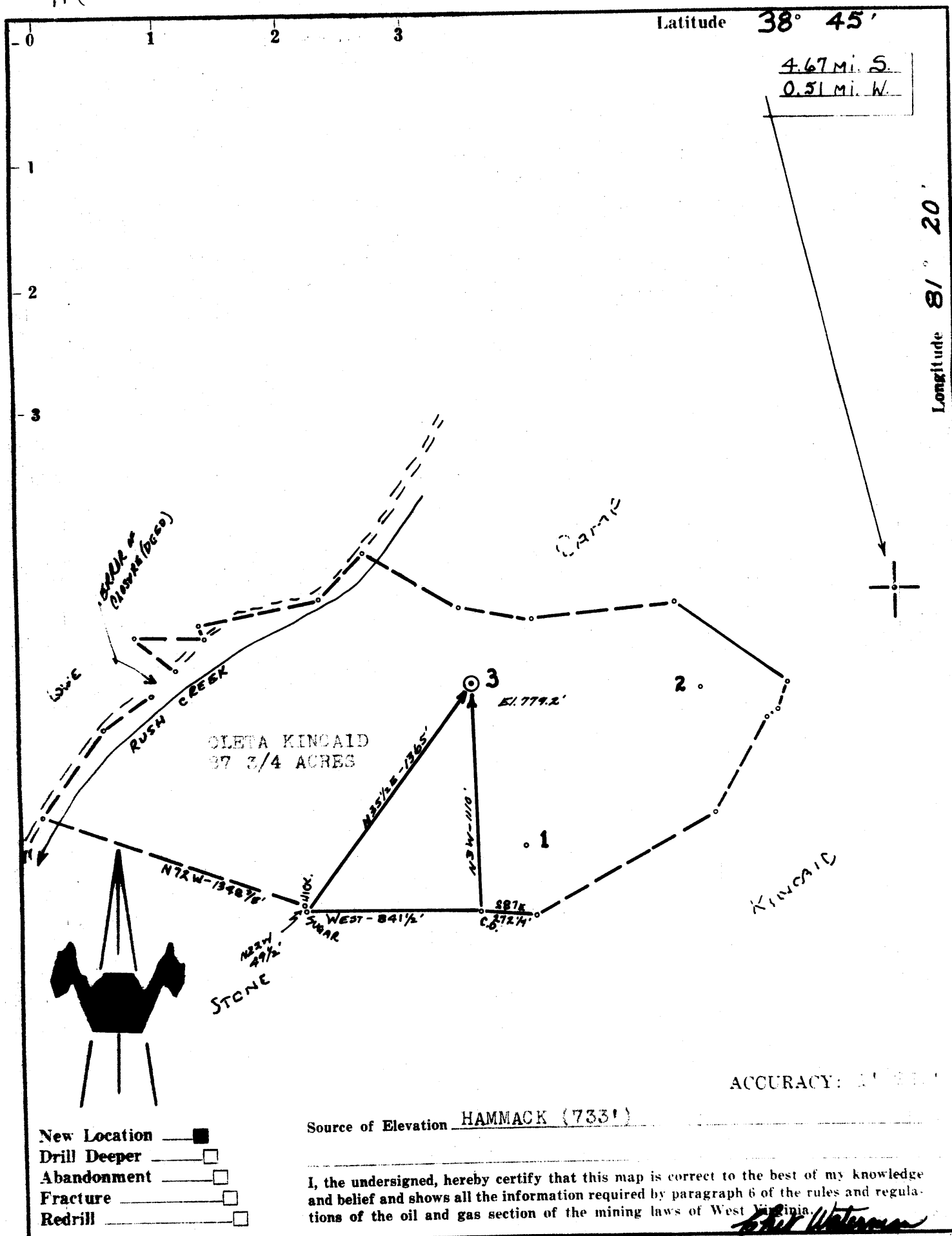

- New Location
- Drill Deeper
- Abandonment
- Fracture
- Redrill

Company RAY BROTHERS

Address CHARLESTON, W. VA.

Farm OLETA KINCAID

Tract Acres 87 3/4 Lease No. \_\_\_\_\_

Well (Farm) No. 3 Serial No. \_\_\_\_\_

Elevation (Spirit Level) 779.2'

Quadrangle WALTON - NC

County ROANE District SMITHFIELD

Engineer CHET WATERMAN

Engineer's Registration No. 3788

File No. 66003-227 Drawing No. \_\_\_\_\_

Date 10/31/66 Scale 1" = 600'

STATE OF WEST VIRGINIA  
DEPARTMENT OF MINES  
OIL AND GAS DIVISION  
CHARLESTON

**WELL LOCATION MAP**

FILE NO. ROA - 1544

+ Denotes location of well on United States Topographic Maps, scale 1 to 62,500, latitude and longitude lines being represented by border lines as shown.

- Denotes one inch spaces on border line of original tracing.

6-6-1966



STATE OF WEST VIRGINIA  
DEPARTMENT OF MINES  
OIL AND GAS DIVISION

Rotary   
Spudder   
Cable Tools   
Storage

Quadrangle \_\_\_\_\_

Permit No. ROA-1544

WELL RECORD

Oil or Gas Well Oil  
(KIND)

Company Ray Brothers  
Address 718 Kan. Valley Bldg., Chas., W. Va.  
Farm Oleta Fae Kincaid Acres. 87 3/4  
Location (waters) \_\_\_\_\_  
Well No. 3 Elev. 779'  
District Smithfield County Roane  
The surface of tract is owned in fee by \_\_\_\_\_  
Address \_\_\_\_\_  
Mineral rights are owned by Oleta Kincaid  
Spencer, W. Va Address \_\_\_\_\_

Casing and Tubing	Used in Drilling	Left in Well	Packers
Size			Kind of Packer
16			
13			
10 3/4	38'		Size of
8 5/8	472'		
6 7/8	1472'	1472'	Depth set
5 3/16			
4 1/2	1973'	1774'	
3			Perf. top
2 3/8	1938'		Perf. bottom
Liners Used			Perf. top
			Perf. bottom

Drilling commenced May 4, 1967  
Drilling completed June 10, 1967  
Date Shot From \_\_\_\_\_ To \_\_\_\_\_  
With \_\_\_\_\_  
Open Flow /10ths Water in \_\_\_\_\_ Inch  
/10ths Merc. in \_\_\_\_\_ Inch  
Volume \_\_\_\_\_ Cu. Ft.  
Rock Pressure \_\_\_\_\_ lbs. \_\_\_\_\_ hrs.  
Oil \_\_\_\_\_ bbls., 1st 24 hrs.  
WELL ACIDIZED (DETAILS) \_\_\_\_\_  
WELL FRACTURED (DETAILS) 30,000# Sand, 600 BB Water

Attach copy of cementing record.  
CASING CEMENTED \_\_\_\_\_ SIZE \_\_\_\_\_ No. Ft. \_\_\_\_\_ Date \_\_\_\_\_  
Amount of cement used (bags) \_\_\_\_\_  
Name of Service Co. \_\_\_\_\_  
COAL WAS ENCOUNTERED AT \_\_\_\_\_ FEET \_\_\_\_\_ INCHES  
\_\_\_\_\_ FEET \_\_\_\_\_ INCHES FEET \_\_\_\_\_ INCHES  
\_\_\_\_\_ FEET \_\_\_\_\_ INCHES FEET \_\_\_\_\_ INCHES

RESULT AFTER TREATMENT (Initial open Flow or bbls.) 20 BB Oil, 50 BB Water  
ROCK PRESSURE AFTER TREATMENT \_\_\_\_\_ HOURS  
Fresh Water \_\_\_\_\_ Feet \_\_\_\_\_ Salt Water \_\_\_\_\_ Feet \_\_\_\_\_  
Producing Sand \_\_\_\_\_ Depth \_\_\_\_\_

Formation	Color	Hard or Soft	Top	Bottom	Oil, Gas or Water	Depth	Remarks
Red Rock			0	90			
Sand			90	110			
Red Rock			110	180			
Sand			180	235			
Red Rock			235	730			
Sand			730	1020			
Slate			1020	1260			
Sand			1260	1287			
Slate			1287	1320			
Sand			1320	1358			
Slate			1358	1463			
Salt Sand			1463	1735			
Lime			1735	1776			
Slate			1776	1784			
Big Lime			1784	1898			
Injun Sand			1898	1933			
Black Lime			1933	1976 TD			

RECEIVED  
West Virginia  
Dept. of Mines  
AUG 1967

RECEIVED  
West Virginia  
Dept. of Mines  
AUG 1967