



WELL RECORD, FORM OG-10, MUST BE SUBMITTED TO OBTAIN RELEASE OF WELL UNDER BOND.

STATE OF WEST VIRGINIA
DEPARTMENT OF MINES
OIL AND GAS DIVISION

31
7-21-66

NOTICE OF PROPOSED LOCATION OF OIL AND GAS WELL

To THE DEPARTMENT OF MINES,
Charleston, W. Va.

COAL OPERATOR OR COAL OWNER

ADDRESS

COAL OPERATOR OR COAL OWNER

ADDRESS

O. G. KINCAID
OWNER OF MINERAL RIGHTS

SPENCER
ADDRESS

JOSEPH S. GRUSS

P. O. BOX 471 NAME OF WELL OPERATOR

SPENCER, W. VA.

COMPLETE ADDRESS

7/15/66, 19

PROPOSED LOCATION

SMITHFIELD District

ROANE County

Well No. 3

O. G. KINCAID Farm

Elevation 956' Acres 109

GENTLEMEN:

The undersigned well operator is entitled to drill upon the above named farm or tract of land for oil and gas, having fee title thereto, (or as the case may be) under grant or lease dated 1/10/66, made by C. C. DODD, to JOSEPH S. GRUSS, and recorded on the 10th day of JAN. 1966, in the office of the County Clerk for said County in Book 109, page 61.

The enclosed plat was prepared by a competent engineer and shows the proposed location of a well to be drilled for oil and gas by the undersigned well operator on the farm and in the Magisterial District and County above named, determined by survey and courses and distances from two permanent points, or land marks.

The undersigned well operator is informed and believes there are no coal operators operating beds of coal beneath said farm or tract of land on which said well is located, or within 500 feet of the boundaries of the same, who have mapped their workings and filed their maps as required by law, excepting the coal operators or coal owners (if any) above named as addressees.

The above named coal operators or coal owners (if any) are notified that any objections they may desire to make to such proposed location, or which they are required to make by Section 3 of said Code, if the drilling of a well at said proposed location will cause a dangerous condition in or about their respective coal mines, must be received by, or filed with the Department of Mines within ten* days from the receipt of a copy of this notice and accompanying plat by said Department. Said coal operators are further notified that forms for use in making such objections will be furnished to them by the Department of Mines promptly on request and that all such objections must set forth as definitely as is reasonably possible the ground or grounds on which such objections are based and indicate the direction and distance the proposed location should be moved to overcome same.

(The next paragraph is to be completed only in Department's copy.)

Copies of this notice and the enclosed plat were mailed by registered mail, or delivered to the above named coal operators or coal owners at their above shown respective address day before, or on the same day with the mailing or delivery of this copy to the Department of Mines at Charleston, West Virginia.

Very truly yours,

(Sign Name) J. N. Hickox
WELL OPERATOR

JOSEPH S. GRUSS

P. O. BOX 471 STREET

SPENCER, W. VA. CITY OR TOWN

STATE

09/15/2023

PLEASE REMIT TO:
J N Hickox
PO Box 471
SPENCER

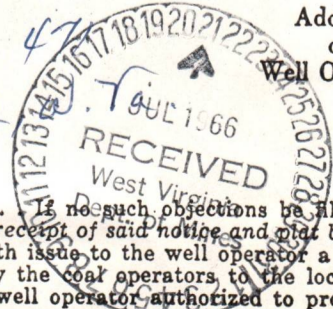

Address of Well Operator }

*Section 3 . . . If no such objections be filed or be found by the department of mines, within said period of ten days from the receipt of said notice and plat by the department of mines, to said proposed location, the department shall forthwith issue to the well operator a drilling permit reciting the filing of such plat, that no objections have been made by the coal operators, to the location, or found thereto by the department, and that the same is approved and the well operator authorized to proceed to drill at said location.

BLANKET BOND

ROA-1424 PERMIT NUMBER

1424

Posted 7/21/66

PROPOSED WORK ORDER

THIS IS AN ESTIMATE ONLY:
ACTUAL INFORMATION MUST BE SUBMITTED ON FORM IV-35 UPON COMPLETION

DRILLING CONTRACTOR (IF KNOWN) QUAKER STATE OIL REFG. CORP. - Service rig
Address _____

GEOLOGICAL TARGET FORMATION, Big Lime

Estimated depth of completed well, 2028 feet Rotary _____ / Cable tools XX /

Approximate water strata depths: Fresh, na feet; salt, 1550 feet.

Approximate coal seam depths: none Is coal being mined in the area? Yes _____ / No XX /

CASING AND TUBING PROGRAM - Casing in hole.

CASING OR TUBING TYPE	SPECIFICATIONS			New	Used	FOOTAGE INTERVALS		CEMENT FILL-UP OR SACKS (Cubic feet)	PACKERS
	Size	Grade	Weight per ft			For drilling	Left in well		
Conductor									Kinds
Fresh Water	8 5/8	na	na	na		173	173	cts	
Coal									Sizes
Intermediate									
Production	4 1/2	na	na	na			2101	100 SX	Depths set
Tubing									
Liners									Perforations:
									Top Bottom

NOTE: Regulation 7.02 of the Department of Mines provides that the original and four copies of Form IV-2 must be filed with the Department, accompanied by (i) a plat in the form prescribed by Regulation 11, (ii) a bond in one of the forms prescribed by Regulation 12, or in lieu thereof the other security allowed by Code § 22-4-2, (iii) Form IV-9, "Reclamation Plan", applicable to the reclamation required by Code § 22-4-12b and Regulation 23, (iv) unless previously paid on the same well, the fee required by Code § 22-4-12a, and (v) if applicable, the consent required by Code § 22-4-8a from the owner of any water well or dwelling within 200 feet of the proposed well.

A separate Form Iv-2 shall not be required for fracturing or stimulating a well where fracturing or stimulating is to be part of the work for which a permit is sought and is noted as such on the Form IV-2 filed in connection therewith.

THIS PERMIT MUST BE POSTED AT THE WELL SITE.
ALL PROVISIONS BEING IN ACCORDANCE WITH CHAPTER 22,
ARTICLE 4 OF THE W. VA. CODE, THE LOCATION IS HEREBY
APPROVED FOR fracturing. THIS PERMIT SHALL EXPIRE 5-14-83
IF OPERATIONS HAVE NOT COMMENCED BY _____
BY [Signature]

The following waiver must be completed by the coal operator and by any coal owner or coal lessee who has recorded a declaration under Code 22-4-20, if the permit is to be issued within fifteen (15) days of receipt thereof.

WAIVER

The undersigned coal operator _____ / owner _____ / lessee _____ / of the coal under this well location 09/15/2023 has examined this proposed well location. If a mine map exists which covers the area of the well location, the well location has been added to the mine map. The undersigned has no objection to the work proposed to be done at this location, provided, the well operator has complied with all applicable requirements of the West Virginia Code and the governing regulations.

Date: _____, 19 _____

By _____
Its _____

Row 1424 Inc.



State of West Virginia
Department of Mines
Oil and Gas Division
Charleston 25305

TO: ALL OPERATORS
FROM: Theodore M. Streit, Administrative Assistant
RE: New Permit Application Forms

DATE: June 10, 1982

On March 13, 1982, the legislature passed HB-154 which goes into effect June 11, 1982. This bill requires proof of one-eighth (1/8) royalty payment to the royalty owners before any well permit can be issued.

We are at the present time printing up new Permit Application Forms which should be available by next month. In the meantime you will be required to send in a notarized affidavit (sample copy below) with each permit application.

AFFIDAVIT

I, Carl J. Carlson (the above designated owner or operator, or authorized representative thereof) hereby verifies that the owner or owners of the mineral estate upon which this proposed well is to be located will receive minimum one-eighth (1/8) royalty payments for any gas or oil extracted therefrom. Copies of the Permit Application and the enclosed plat and reclamation plan have been mailed by registered mail or delivered by hand to the above-named coal operator, co-owner(s), and coal lessee on or before the day of the mailing or delivery of this Permit Application to the Department of Mines at Charleston, West Virginia.

Signed: *Carl J. Carlson*
(Owner, Operator, or Authorized Representative)
Carl J. Carlson - District Manager

Notary : *Dolores L. Branch* (Signed)

My commission expires _____

DOLORES L. BRANCH
Notary Public, State of Ohio
My Commission Expires Feb. 25, 1985



RECEIVED
SEP 13 1982

OIL & GAS DIVISION
DEPT. OF MINES

09/15/2023



Handwritten notes in the top right corner, including "L. L. ..."

Faint, mostly illegible typed text covering the main body of the document.

Handwritten signature or initials in the lower middle section.

Handwritten signature or initials in the lower right section.

Faint printed text, possibly a title or header, located below the signatures.

RECEIVED
SEP 19 1985



DEPT. OF MINES
OIL & GAS DIVISION

09/15/2023

IV-9 REVERSE

Revised 11-81

ATTACH OR PHOTOCOPY SECTION OF INVOLVED TOPOGRAPHIC MAP. QUADRANGLE Looneyville

LEGEND

Well Site ⊕

Access Road ———

WELL SITE PLAN

Sketch to include well location, existing access road, roads to be constructed, length and slope of road, wellsite, drilling pits and necessary structures numbered or lettered to correspond with the first part of this plan. Include all natural drainage.

Land Use: Pasture ___ Hayland ___ Cropland ___ Woodland X

LEGEND

Property boundary ———▲———	North Arrow ↗
Road = = = = =	Diversion // // // //
Existing fence — X — X —	Spring ⊙ →
Planned fence — / — / —	Wet Spot ⊙
Stream ~ ~ ~ ~ ~	Building ■
Open Ditch —→—→—→—→—→	Drain pipe —○—→—○—→
Waterway (—→—→—→—→—→)	

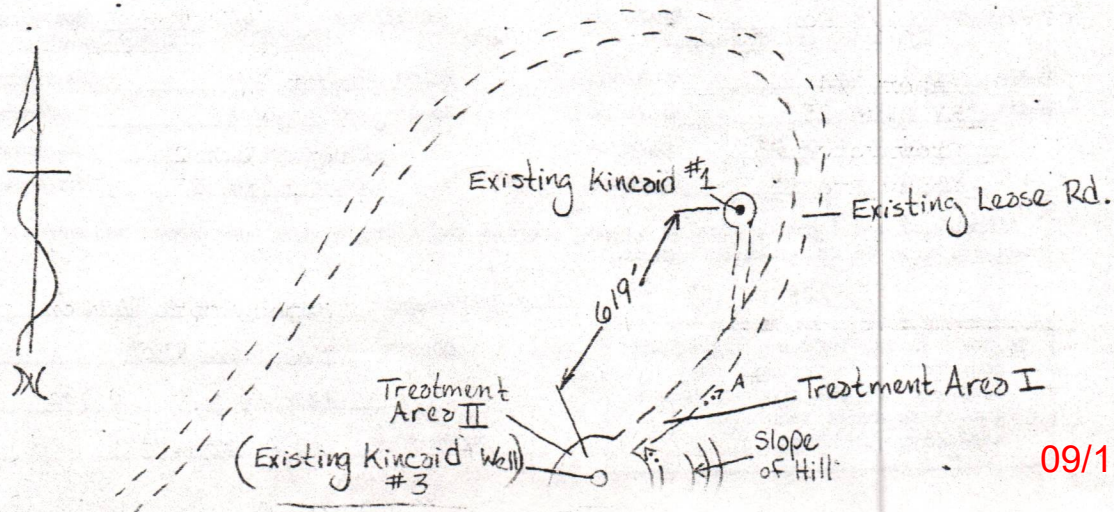

09/15/2023

RECEIVED
SEP 1 1982
Revised 11-81

OIL & GAS DIVISION
DEPT. OF MINES



DATE 8-26-82
WELL NO. Kincaid #3

State of West Virginia API NO. 47 - 087 - 1424 - Frac

Department of Mines
Oil and Gas Division

CONSTRUCTION AND RECLAMATION PLAN

Quaker State Oil

COMPANY NAME Refining Corporation DESIGNATED AGENT Carl J. Carlson
Address P.O. Box 1327 Pksbg WV 26101 Address P.O. Box 1327 Pksbg WV 26101
Telephone (614) 423-9543 Telephone (614) 423-9543
LANDOWNER George Moffatt SOIL CONS. DISTRICT Little Kanawha
Revegetation to be carried out by Petro-Services and/or Quaker State (Agent)

This plan has been reviewed by Little Kanawha SCD. All corrections and additions become a part of this plan: 9-1-82

(Date)
James Scott Taylor
(SCD Agent)

ACCESS ROAD	LOCATION
Structure Drainage Ditch (A)	Structure Diversion Ditch (1)
Spacing Per Sketch	Material Soil
Page Ref. Manual 2-10	Page Ref. Manual 2-10
Structure (B)	Structure Drilling Pit (2)
Spacing	Material Soil
Page Ref. Manual	Page Ref. Manual
Structure (C)	Structure (3)
Spacing	Material
Page Ref. Manual	Page Ref. Manual

All structures should be inspected regularly and repaired if necessary. All commercial timber is to be cut and stacked and all brush and small timber to be cut and removed from the site before dirt work begins.

REVEGETATION

Treatment Area I	Treatment Area II
Lime 3 Tons/acre or correct to pH 6.5	Lime 3 Tons/acre or correct to pH 6.5
Fertilizer 1/4 Ton /acre (10-20-20 or equivalent)	Fertilizer 1/4 Ton /acre (10-20-20 or equivalent)
Mulch Paper 3/4 Tons/acre	Mulch Paper 3/4 Tons/acre
Seed* KY Blue 25 lbs/acre	Seed* KY Blue 25 lbs/acre
Crownvetch 25 lbs/acre	Crownvetch 25 lbs/acre
Penny Rye 25 lbs/acre	Penny Rye 25 lbs/acre

*Inoculate all legumes such as vetch, trefoil and clovers with the proper bacterium. Inoculate with 3X recommended amount.

NOTES: Please request landowners' cooperation to protect new seedling for one growing season. Attach separate sheets as necessary for comments.

PLAN PREPARED BY James Scott Taylor
ADDRESS P.O. Box 1327
Pksbg, W.V 26101
PHONE NO. (614) 423-9543

09/15/2023

RECEIVED

SEP 13 1982

OIL & GAS DIVISION
DEPT. OF MINES

09/15/2023

46

891 m/ David C. Clous
Box 288
Parkersburg, W. Va.
26101

THIS ASSIGNMENT, made this 30th day of November, 1973, by and between MAREVE OIL CORP., a corporation, EVMAR OIL CORP., a corporation, JOGRUSS OIL CORP., a corporation, and JOMACARE, INC., a corporation, parties of the first part, hereinafter referred to collectively as "Assignors", and QUAKER STATE OIL REFINING CORPORATION, a Delaware corporation, party of the second part, hereinafter referred to as "Assignee",

WITNESSETH, that for and in consideration of the sum of One Dollar (\$1.00), cash in hand paid, the receipt of which is hereby acknowledged, Assignors hereby sell, transfer, assign, set-over and deliver to Assignee, with covenants of special warranty, all of Assignors' right, title, claim and interests in and to the leases and leasehold estates therein created and oil and gas wells and other improvements thereon, as shown on the exhibit attached hereto and made a part hereof.

It is understood between the parties hereto that the attached exhibit is intended to include all leases and leasehold estates therein created, owned by the Assignors in the State of West Virginia. This Assignment shall convey to Assignee all of Assignors' interests in such leases, leasehold estates therein created, and oil and gas wells and other improvements thereon, wheresoever situate in the the State of West Virginia whether or not listed on the attached exhibit.

This Assignment is executed pursuant to a Purchase Agreement entered into by the parties hereto dated November 16, 1973. All of the terms, conditions, representations and warranties contained in said Purchase Agreement are made a part hereof by reference.

Assignors reserve and except unto themselves for future conveyance to the West Virginia Department of Highways all those certain parts, portions and areas of said leases and leasehold estates, pipelines, improvements, rights of way, easements, 4 wells, L. Price No. 1, G. Carte No. 1, B. Osbourne No. 1 and A. Newhouse No. 1, tanks, and appurtenances within and underlying the controlled access right of way limits of Interstate 79 in Kanawha County, West Virginia, and by accepting this Assignment, Assignee agrees if requested by West Virginia Department of Highways, to join in as a party to instruments of conveyance to said West Virginia Department of Highways, without charge or compensation.

RECEIVED
SEP 13 1982

OIL & GAS DIVISION
DEPT. OF MINES

09/15/2023

10 Productive

BOOK 130 PAGE 401

BOOK 82 PAGE 67

47

IN WITNESS WHEREOF, the parties have duly executed this Agreement as of the date first hereinabove written.

MAREVE OIL CORP.

By [Signature]
Its President

EVMAR OIL CORP.

By [Signature]
Its President

JOGRUSS OIL CORP.

By [Signature]
Its President

JOMACARE, INC.

By [Signature]
Its President

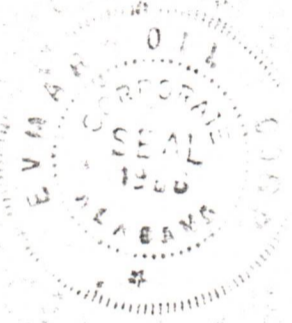

RECORDED
1973 DEC - 3 PM 12:47
JACK L. PAULEY
CLERK COUNTY COURT
KANAWHA COUNTY, W. VA.

RECEIVED
SEP 13 1982

OIL & GAS DIVISION
DEPT. OF MINES

09/15/2023

Productive

BOOK 82 PAGE 68

STATE OF NEW YORK,

COUNTY OF New York, TO-WIT:

BOOK 130 PAGE 402

48

I, Philip Lo Spalluto, a notary public of said County, do certify that Joseph S. Gruss, President, who signed the writing hereto annexed, bearing date the 30th day of November, 1973, for Mareve Oil Corp., a corporation, has this day in my said county, before me, acknowledged the said writing to be the act and deed of said corporation.

Given under my hand this 30 day of November, 1973.

My commission expires; March 30, 1975.

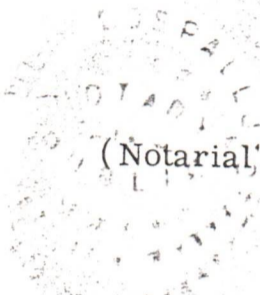

(Notarial Seal)

Philip Lo Spalluto

Notary Public
PHILIP LO SPALLUTO
Notary Public, State of New York
No. 08-2405950
Qualified in Bronx County
Commission Expires March 30, 1975

STATE OF NEW YORK,

COUNTY OF New York, TO-WIT:

I, Philip Lo Spalluto, a notary public of said County, do certify that Joseph S. Gruss, President, who signed the writing hereto annexed, bearing date the 30th day of November, 1973, for Evmar Oil Corp., a corporation, has this day in my said county, before me, acknowledged the said writing to be the act and deed of said corporation.

Given under my hand this 30 day of November, 1973.

My commission expires; March 30, 1975.

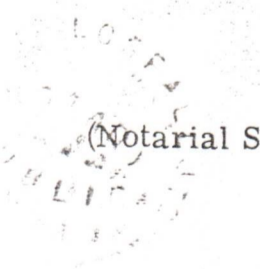

(Notarial Seal)

Philip Lo Spalluto

Notary Public

PHILIP LO SPALLUTO
Notary Public, State of New York
No. 08-2405950
Qualified in Bronx County
Commission Expires March 30, 1975

RECEIVED
SEP 13 1982

OIL & GAS DIVISION
DEPT. OF MINES

09/15/2023

<u>LEASE NO.</u>	<u>DATE</u>	<u>LESSOR</u>	<u>COUNTY</u>	<u>LEASE BOOK AND PAGE</u>	<u>ACREAGE</u>
656.58	2/22/66	Osty Santee, widower	Roane	109 - 395	61
656.58	12/15/65	Russell T. Keith	Roane	108 - 587	29
656.51	11/24/65	Maude Kincaid, et al.	Roane	108 - 510	109
347	1/24/67	Ernie Patrick	Kanawha	163 - 395	73-3/4
348	1/25/67	Elizabeth Wehrle & Marion Wehrle	Kanawha	163 - 509	350
350	2/15/67	John C. Burdette Fay Burdette	Kanawha	163 - 663	60
121-K	12/1/66	Imogene E. Halstead & Charles E. Halstead	Kanawha	162 - 211	56.36
139-K	10/7/64	C. F. Fleshman, et al.	Kanawha	162 - 591	280
170-K	11/9/66	Hubert Huffman, et al.	Kanawha	171 - 637	26-1/8
170-K	11/9/66	Biddie Jarrell, et ux.	Kanawha	163 - 27	26-1/8
219-K	8/11/67	Arthur E. Lilly, et al.	Kanawha	172 - 477	56
219-K	8/29/68	Ernest L. Thaxton	Kanawha	175 - 127	56
107-K	11/15/66	Henry A. Walker, et ux.	Kanawha	161 - 367	52
183-K	10/8/64	Dexter W. Facemyer, et ux.	Kanawha	162 - 569	64-1/2
183-K	7/18/66	Maxine O'Dell, et al.	Kanawha	160 - 433	64-1/2
183-K	6/20/67	Paul F. Weese, et ux.	Kanawha	166 - 513	64-1/2
183-K	6/20/67	Melissa Byrum, et vir.	Kanawha	166 - 529	64-1/2
216-K	2/20/67	John L. Ray, et al.	Kanawha	165 - 319	329
133-K	8/14/67	Helen G. Rucker	Kanawha	167 - 69	73-3/4
133-K	11/19/66	Dora Koontz	Kanawha	164 - 189	73-3/4
133-K	2/8/67	Bessie Walker, widow	Kanawha	166 - 605	73-3/4
409-K	9/22/69	W. P. Dodd, et ux.	Kanawha	180 - 423	2-1/2
247-K	3/3/67	Nellie Siders, et al.	Kanawha	165 - 285	12
247-K	3/2/67	Forest Burdette, et ux.	Kanawha	165 - 279	61

RECEIVED

SEP 13 1982

09/15/2023

OIL & GAS DIVISION
DEPT. OF MINE

Formation	Color	Hard or Soft	Top ²⁹	Bottom	Oil, Gas or Water	Depth Found	Remarks
Shale TD			2086	2110			

100 212 40710

09/15/2023

Date October 22, 1966

APPROVED Joseph S. Gruss, Owner

By *J. S. Gruss*
(Title)



STATE OF WEST VIRGINIA
DEPARTMENT OF MINES

OIL AND GAS DIVISION 29

Rotary x

WELL RECORD

Oil or Gas Well 011 (KIND)

Permit No. 23202/5/1604

Quadrangle Walton

Company Joseph S. Gruss
Address 30 Broad St., N.Y., N.Y.

Farm 0.6, Kincaid Acres 109

Location (waters) Poco

Well No. 3 Elev. 956

District Smithfield County Roane

The surface of tract is owned in fee by D.G. Kincaid

Address 0.6, Kincaid

Mineral rights are owned by D.G. Kincaid

Address 0.6, Kincaid

Drilling commenced 8-31-66

Drilling completed 9-4-66

Date Shot From To

Open Flow /10ths Water in Inch

Volume /10ths Merc. in Inch

Rock Pressure lbs. hrs.

Oil Show hrs. 1st 24 hrs.

WELL ACIDIZED

WELL FRACTURED 30,000 # 20/40 30,000 gallons gelled fresh water

RESULT AFTER TREATMENT 72 barrels per 24 hours

ROCK PRESSURE AFTER TREATMENT

Fresh Water Feet

Salt Water Feet

Formation

Color

Hard or Soft

Top

Bottom

Oil, Gas or Water

Depth

Remarks

Rotary

SFC Clay & Rock

Clay Red Bed

Rock

Rock & Sand

Sand

Sand shale St.

Sand with Shale

Sand

Sand

Lime

Lime

Lime

Lime

Shale



(over)

DETAILS OF PERFORATED INTERVALS, FRACTURING OR STIMULATING, PHYSICAL CHANGE, ETC.

Set bridge plug at 2005' (top).
 Perforated from 1957 to 1958 with 2 shots and from 1981 to 1983 with 2 shots.
 Frac'd with 125 bbl. foamed acid. Breakdown at 2100 psi, treated at 2500 psi
 and 8 BPM. I.S.I. 2050 psi.
 No production from the Big Lime after frac.
 Knocked the bridge plug to bottom and put back to pumping from the Big Injun
 (approx. 1 BOPD).

WELL LOG

FORMATION	COLOR	HARD OR SOFT	TOP FEET	BOTTOM FEET	REMARKS Including indication of all fresh and salt water, coal, oil and gas
Big Lime			1898	2012	
(see original completion report).					

(Attach separate sheets as necessary)

QUAKER STATE OIL REFINING CORPORATION

Well Operator

Michael G. Brannock - Geologist

By: *Michael G. Brannock*

09/15/2023

Date: September 6, 1983

Note: Regulation 2.02(i) provides as follows:
 "The term 'log' or 'well log' shall mean a systematic
 detailed geological record of all formations, including
 coal, encountered in the drilling of a well."

STATE OF WEST VIRGINIA
DEPARTMENT OF MINES
OIL AND GAS DIVISION

INSPECTOR'S WELL REPORT

Permit No. ROA-1424

Oil or Gas Well _____
(KIND)

Company GRUSS

Address _____

Farm KIWCAID

Well No. 3

District SMITHFIELD County ROANE

Drilling commenced _____

Drilling completed _____ Total depth _____

Date shot _____ Depth of shot _____

Initial open flow _____ /10ths Water in _____ Inch

Open flow after tubing _____ /10ths Merc. in _____ Inch

Volume _____ Cu. Ft.

Rock pressure _____ lbs. _____ hrs.

Oil _____ bbls., 1st 24 hrs.

Fresh water _____ feet _____ feet

Salt water _____ feet _____ feet

CASING AND TUBING	USED IN DRILLING	LEFT IN WELL	PACKERS
Size			
16			Kind of Packer _____
13			
10			Size of _____
8 1/4			
6 5/8			Depth set _____
5 3/16			
3			Perf. top _____
2			Perf. bottom _____
Liners Used			Perf. top _____
			Perf. bottom _____

CASING CEMENTED _____ SIZE _____ No. FT. _____ Date _____

NAME OF SERVICE COMPANY _____

COAL WAS ENCOUNTERED AT _____ FEET _____ INCHES

_____ FEET _____ INCHES _____ FEET _____ INCHES

_____ FEET _____ INCHES _____ FEET _____ INCHES

Drillers' Names _____

Remarks: _____

FINAN

10/28/66
DATE

E. L. Lusk
DISTRICT WELL INSPECTOR





State of West Virginia

Department of Mines
Oil and Gas Division
Charleston 5

W. F. EIGENBROD
DIRECTOR

November 4, 1966

GURMER WAMOCK
DEPUTY DIRECTOR

Joseph S. Gruss
P. O. Box 471
Spencer, West Virginia 25276

In Re: Permit _____
Farm _____
Well No. _____
District _____
County _____

FOA 1121

O. G. Kincaid

3

Smithfield

Boone

Gentlemen:

The final inspection report for your well which is described above has been received in our office.

Please be advised that the well, which is covered by the above permit number, has been released under your Blanket Bond.

Yours very truly,

Gurmer Wamock
Deputy Director
OIL AND GAS DIVISION

sj

09/15/2023



State of West Virginia
Department of Mines
Oil and Gas Division
Charleston 25305

FINAL INSPECTION REPORT
INSPECTORS COMPLIANCE REPORT

RECEIVED
SEP 17 1985

DIVISION OF OIL & GAS
DEPARTMENT OF ENERGY

17 SEP 85 11:20

COMPANY Quaker State Oil Corp.
Parkersburg, W. Va.

PERMIT NO 087-1424 fac. (9-14-82)

FARM & WELL NO O. G. Kincaid #3

DIST. & COUNTY Smithfield-Roane

RULE	DESCRIPTION	IN COMPLIANCE	
		YES	NO
23.06	Notification Prior to Starting Work	✓	
25.04	Prepared before Drilling to Prevent Waste		
25.03	High-Pressure Drilling		
16.01	Required Permits at Wellsite	✓	
15.03	Adequate Fresh Water Casing		
15.02	Adequate Coal Casing		
15.01	Adequate Production Casing	✓	
15.04	Adequate Cement Strenght	✓	
15.05	Cement Type		
23.02	Maintained Access Roads	✓	
25.01	Necessary Equipment to Prevent Waste	✓	
23.04	Reclaimed Drilling Pits	✓	
23.05	No Surface or Underground Pollution	✓	
23.07	Requirements for Production & Gathering Pipelines	✓	
16.01	Well Records on Site		
16.02	Well Records Filed		
7.05	Identification Markings	✓	

I HAVE INSPECTED THE ABOVE CAPTIONED WELL AND RECOMMEND THAT IT BE RELEASED:

SIGNED Homer H. Dougherty
DATE 9-9-85

Your well record was received and reclamation requirements approved. In accordance with Chapter 22, Article 4, Section 2, the above well will remain under bond coverage for the life of the well.

T.H. [Signature]
Administrator-Oil & Gas Division
September 19, 1985
DATE

09/15/2023



STATE OF WEST VIRGINIA
DEPARTMENT OF MINES
CHARLESTON

July 27, 1966

Joseph S. Gruss
P. O. Box 471
Spencer, West Virginia

Attention: O. G. Kincaid

In Re: Permit No.	<u>ROA-1424</u>
Farm	<u>O. G. Kincaid</u>
Well No.	<u>3</u>
District	<u>Smithfield</u>
County	<u>Roane</u>

Gentlemen:

Enclosed is Permit for drilling the above described well.

Please post one copy of permit at the well site and send us two copies of the well record when drilling has been completed.

Very truly yours,

GURMER WAMOCK
DEPUTY DIRECTOR

GW/ eh
Enclosures

cc: Mr. Ernest Lusher, Inspector, Box 37-A, Lavalette, W. Va. TEL: 525-6868
West Virginia Geological & Economic Survey

Huntington

Mr. R. C. Tucker, Assistant
State Geologist

bc: Mr. C. A. Washburn, Deputy Securities Commissioner

09/15/2023

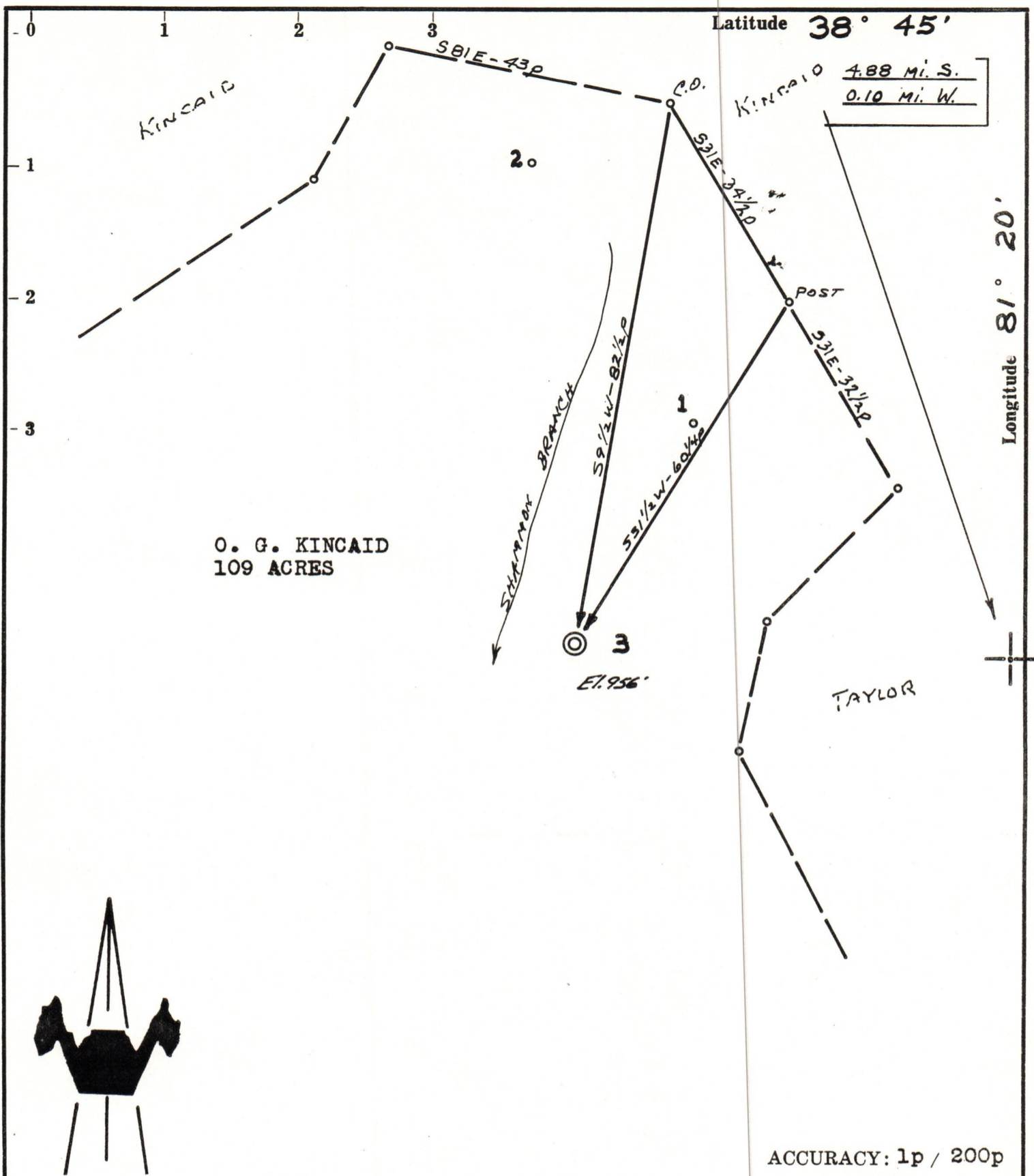

- New Location
- Drill Deeper
- Abandonment
- Fracture 9/14
- Redrill

Source of Elevation HAMMACK (733')

I, the undersigned, hereby certify that this map is correct to the best of my knowledge and belief and shows all the information required by paragraph 6 of the rules and regulations of the oil and gas section of the mining laws of West Virginia.

Chet Waterman

Company	<u>Quaker State Oil Refining</u>		
Address	<u>10 Box 1327 - Pk5b, WVA 26101</u>		
Farm	<u>O. G. KINCAID</u>		
Tract	Acres <u>109</u>	Lease No.	
Well (Farm) No.	<u>3</u>	Serial No.	
Elevation (Spirit Level)	<u>956'</u>		
Quadrangle	<u>WALTON</u>		
County	<u>ROANE</u>	District	<u>SMITHFIELD</u>
Engineer	<u>CHET WATERMAN</u>		
Engineer's Registration No.	<u>3788</u>		
File No.	<u>66003-132</u>	Drawing No.	
Date	<u>7/15/66</u>	Scale	<u>1" = 20p</u>

STATE OF WEST VIRGINIA
DEPARTMENT OF MINES
OIL AND GAS DIVISION
CHARLESTON

WELL LOCATION MAP

FILE NO. ROA - 1424 09/15/2023

+ Denotes location of well on United States Topographic Maps, scale 1 to 62,500, latitude and longitude lines being represented by border lines as shown.

— Denotes one inch spaces on border line of original tracing.

47-087