

ACCURACY 1" IN 200'

New Location SOURCE ELEV. B.M. SHOWN ON PLAT 716.00
 Drill Deeper
 Redrill
 Abandonment "I, the undersigned, hereby certify that this map is correct to the best of my knowledge and belief and shows all the information required by paragraph 6 of the rules and regulations of the oil and gas section of the mining laws of West Virginia."
 7/13/76

Company RAY RESOURCES, Div. of EDOG
 Address BX 51 SPENCER, WV
 Farm H.O. SERGENT ET AL
 Tract _____ Acres 31.75 Lease No. _____
 Well (Farm) No. 1 Serial No. _____
 Elevation (Spirit Level) 735.91
 Quadrangle WALTON C
 County ROANE District WALTON
 Engineer S. J. Dye
 Engineer's Registration No. 804
 File No. _____ Drawing No. _____
 Date 5-26-66 Scale 1" = 400'

STATE OF WEST VIRGINIA
 DEPARTMENT OF MINES
 OIL AND GAS DIVISION
 CHARLESTON

WELL LOCATION MAP
 FILE NO. ROA-1355-P

+ Denotes location of well on United States Topographic Maps, scale 1 to 62,500, latitude and longitude lines being represented by border lines as shown.

- Denotes one inch spaces on border line of original tracing.

47-087

1 2 3

Latitude 38° 40'

Longitude 81° 20'

⊕ 1.48 S
1.96 W

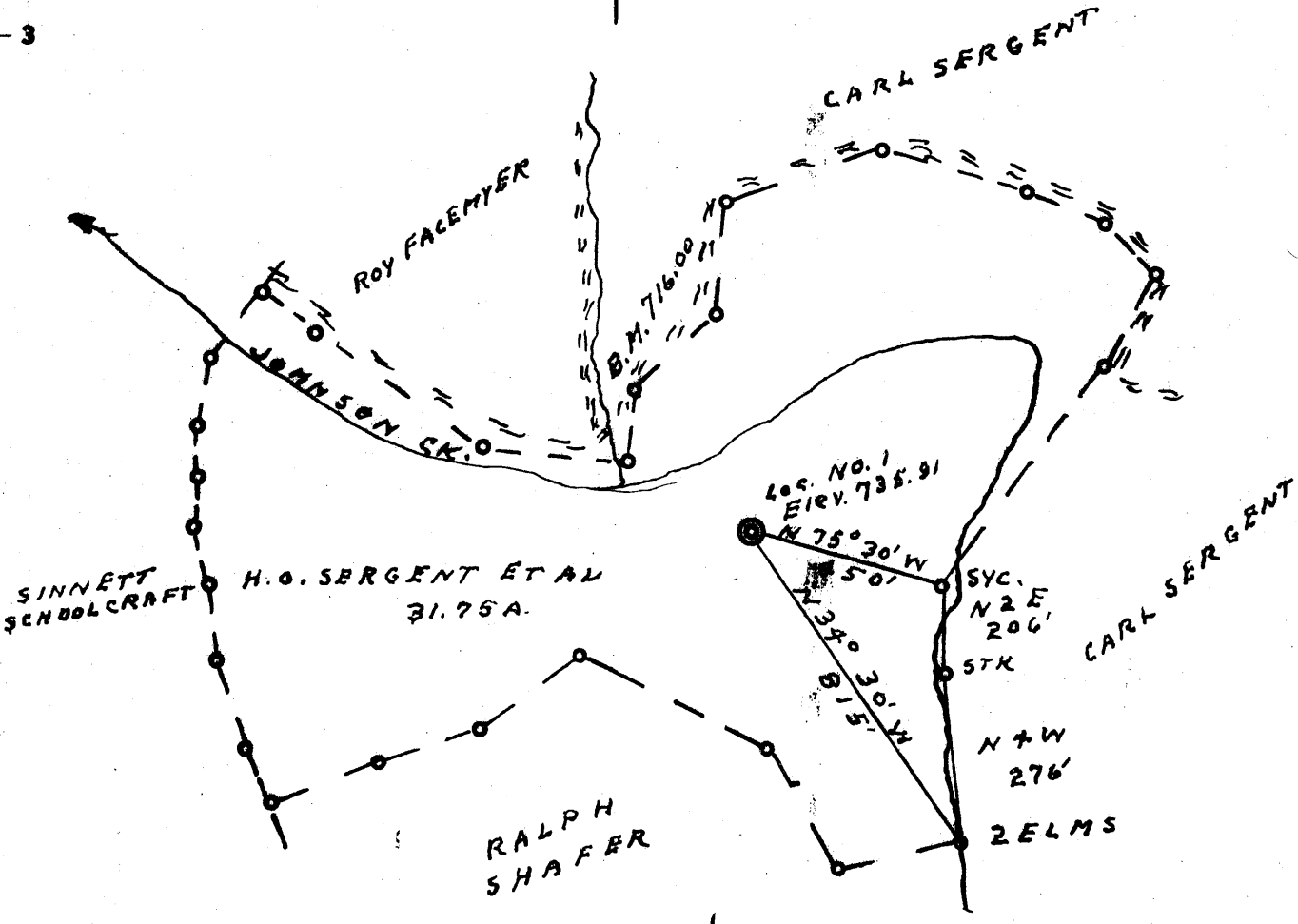

ACCURACY 1" IN 200'

New Location . SOURCE ELEV. B.M. SHOWN ON PLAT 716.00
 Drill Deeper
 Redrill "I, the undersigned, hereby certify that this map is correct to the best of my knowledge and belief and shows all the information required by paragraph 6 of the rules and regulations of the oil and gas section of the mining laws of West Virginia."
 Abandonment

Company	M. & M. DRILLING
Address	BOX 54 SPENCER, W.VA.
Form	H.O. SERGENT ET AL
Tract	Acres 31.75 Lease No.
Well (Farm) No.	① Serial No.
Elevation (Spirit Level)	735.91
Quadrangle	WALTON-C
County	ROANE District WALTON
Engineer	L. J. Dye
Engineer's Registration No.	804
File No.	Drawing No.
Date	5-26-66 Scale 1" = 400'

STATE OF WEST VIRGINIA
 DEPARTMENT OF MINES
 OIL AND GAS DIVISION
 CHARLESTON

WELL LOCATION MAP
 FILE NO. ROA-1355

+ Denotes location of well on United States Topographic Maps, scale 1 to 62,500, latitude and longitude lines being represented by border lines as shown.

- Denotes one inch spaces on border line of original tracing.

6-60 196



STATE OF WEST VIRGINIA
DEPARTMENT OF MINES
OIL AND GAS DIVISION 18

- Rotary
- Spudder
- Cable Tools
- Storage

Quadrangle Walton
Permit No. ROA-1355

WELL RECORD

Oil or Gas Well Neither
(KIND) Dry

Company M & M Drilling
Address P.O. Box 54, Spencer, West Va.
Farm Harry O. Sargent #1 Acres 32
Location (waters) Johnson's Creek
Well No. 1 Elev. 736'
District Walton County Roane
The surface of tract is owned in fee by James Summers
Address Walton, West Va.
Mineral rights are owned by H. O. Sargent Heirs.
Address Charleston, West Va.
Drilling commenced June 3, 1966
Drilling completed July 9, 1966
Date Shot No From To
With
Open Flow None /10ths Water in None Inch
/10ths Merc. in Inch
Volume None Cu. Ft.
Rock Pressure None lbs. hrs.
Oil Show only bbls., 1st 24 hrs.
WELL ACIDIZED (DETAILS) No
WELL FRACTURED (DETAILS) Fractured by Dowell with 600 Bbls water and 26,000 lbs of sand size 10 x 20.
RESULT AFTER TREATMENT (Initial open Flow or bbls.) Well has been pumping salt water since July 19, 1966
ROCK PRESSURE AFTER TREATMENT None HOURS
Fresh Water 70' & 230' Feet Salt Water 1465' Hole full Feet
Producing Sand Not producing yet, still under development. Depth Injun Sand at 1870' to 1916'

Casing and Tubing	Used in Drilling	Left in Well	Packers
Size			
16			Kind of Packer
13	40'	Yes	
10	331'	Yes	Size of
8 1/4	950'	No	
6 5/8			Depth set
5 3/16	1951'	Yes	
4 1/2			
3			Perf. top 1885'
2	1906'	Yes	Perf. bottom 1886'
Liners Used	None		Perf. top 1892'
			Perf. bottom 1894'

Attach copy of cementing record.
CASING CEMENTED 5 1/2" SIZE 300' No. Ft. 7/2/66 Date
Amount of cement used (bags) 50 Bags
Name of Service Co. Ready Oil & Gas Cementing
COAL WAS ENCOUNTERED AT None FEET INCHES
FEET INCHES FEET INCHES
FEET INCHES FEET INCHES

Formation	Color	Hard or Soft	Top	Bottom	Oil, Gas or Water	Depth	Remarks
Top Soil			0	50			
Slate			50	101	Water	70'	
Red Rock			101	140			
Slate			140	200			
Sand			200	245	Water	230'	
Slate			245	285			
Sand			285	300			
Slate			300	320			
Red Rock			320	395			
Slate			395	415			
Red Rock			415	480			
Slate			480	505			
Red Rock			505	530			
Slate			530	580			
Sand			580	670			
Slate			670	715			
Sand			715	770			
Slate			770	820			
Sand			820	897			
Slate			897	912			
Sand			912	950			
Slate			950	960			
Sand			960	1005			
Slate			1005	1130			
Line			1130	1350			
Sand			1350	1380			
Slate			1380	1445			
Salt Sand			1445	1730	Water	1465'	Hole full

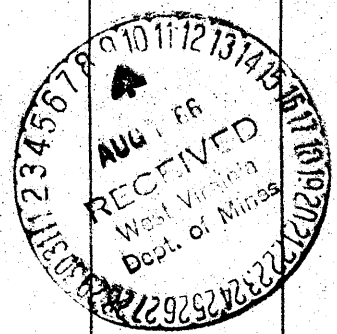

Formation	Color	Hard or Soft	Top 18	Bottom	Oil, Gas or Water	Depth Found	Remarks
ms			1730	1765			
g Lms			1765	1860			
g Injun			1860	1915	Smell of Oil & Gas in Injun with hole full of water.		
ate			1915	1951			
			T.D.	1951			
				3110			

Date August 7, 1966, 19
 APPROVED Cecil Meadows, Owner
 By Cecil Meadows
 (Title)