

*Jamie 5/2/88*

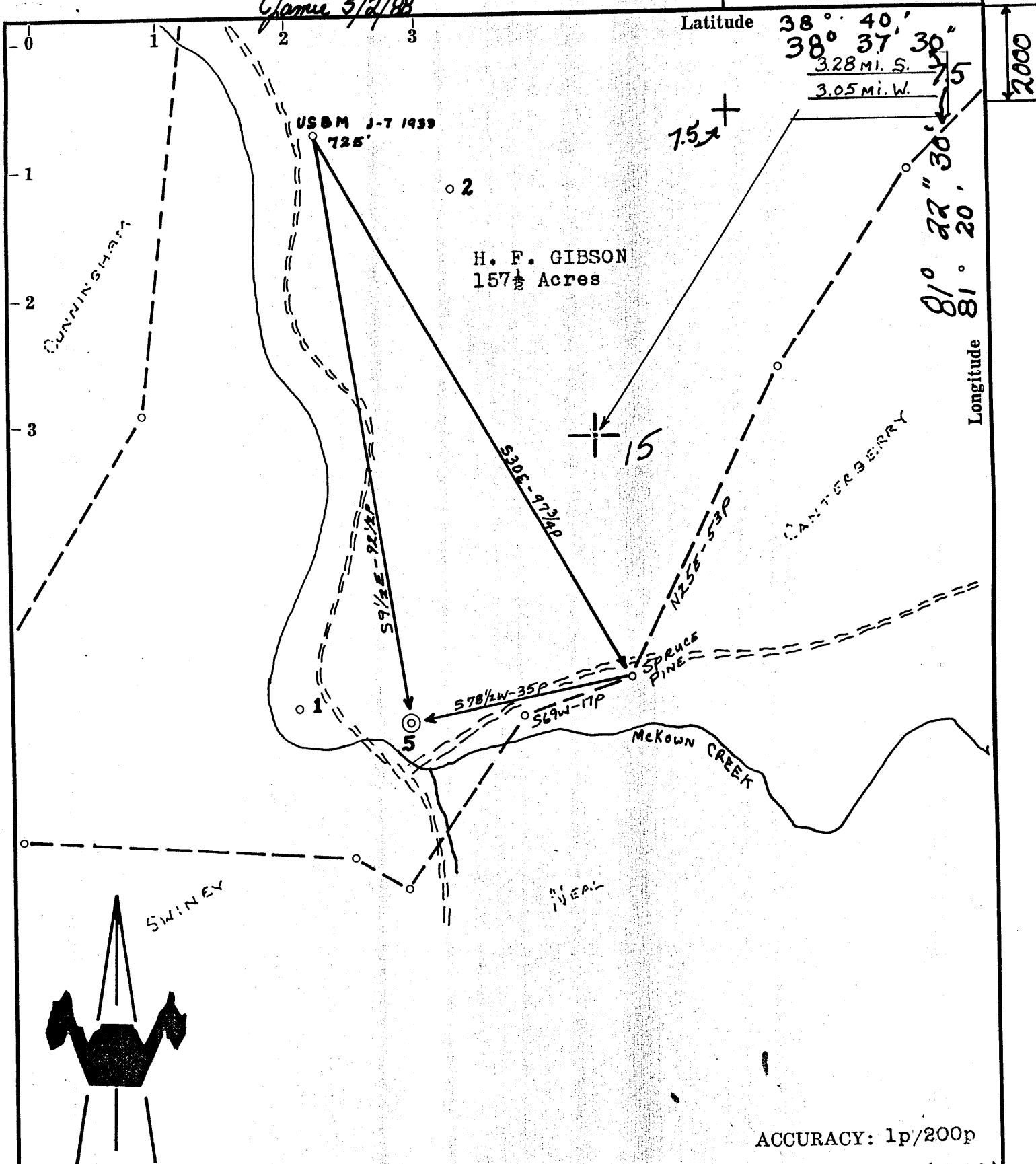

- New Location
- Drill Deeper
- Abandonment
- Fracture
- Redrill

Source of Elevation U. S. B. M. #J-7, 1933 along road (725')

I, the undersigned, hereby certify that this map is correct to the best of my knowledge and belief and shows all the information required by paragraph 6 of the rules and regulations of the oil and gas section of the mining laws of West Virginia.  
*Chet Waterman*

Company. Quaker State Oil Refining Co.  
 Address. ~~XXXXXXXXXXXXXXXXXXXX~~ Belpre, Ohio  
 Farm H. F. GIBSON  
 Tract Acres 157 1/2 Lease No. \_\_\_\_\_  
 Well (Farm) No. 5 Serial No. \_\_\_\_\_  
 Elevation (Spirit Level) 712.5'  
 Quadrangle WALTON 15 Kettle 7.5  
 County ROANE District WALTON  
 Engineer CHET WATERMAN  
 Engineer's Registration No. 3788  
 File No. 65002-43 Drawing No. \_\_\_\_\_  
 Date 10/12/65 Scale 1" = 20p

STATE OF WEST VIRGINIA  
 DEPARTMENT OF MINES  
 OIL AND GAS DIVISION  
 CHARLESTON

WELL LOCATION MAP  
 FILE NO. ROA - 1206 - P

+ Denotes location of well on United States Topographic Maps, scale 1 to 62,500, latitude and longitude lines being represented by border lines as shown.  
 — Denotes one inch spaces on ~~border lines~~ original tracing.  
 MAY 10 1988  
 47-087

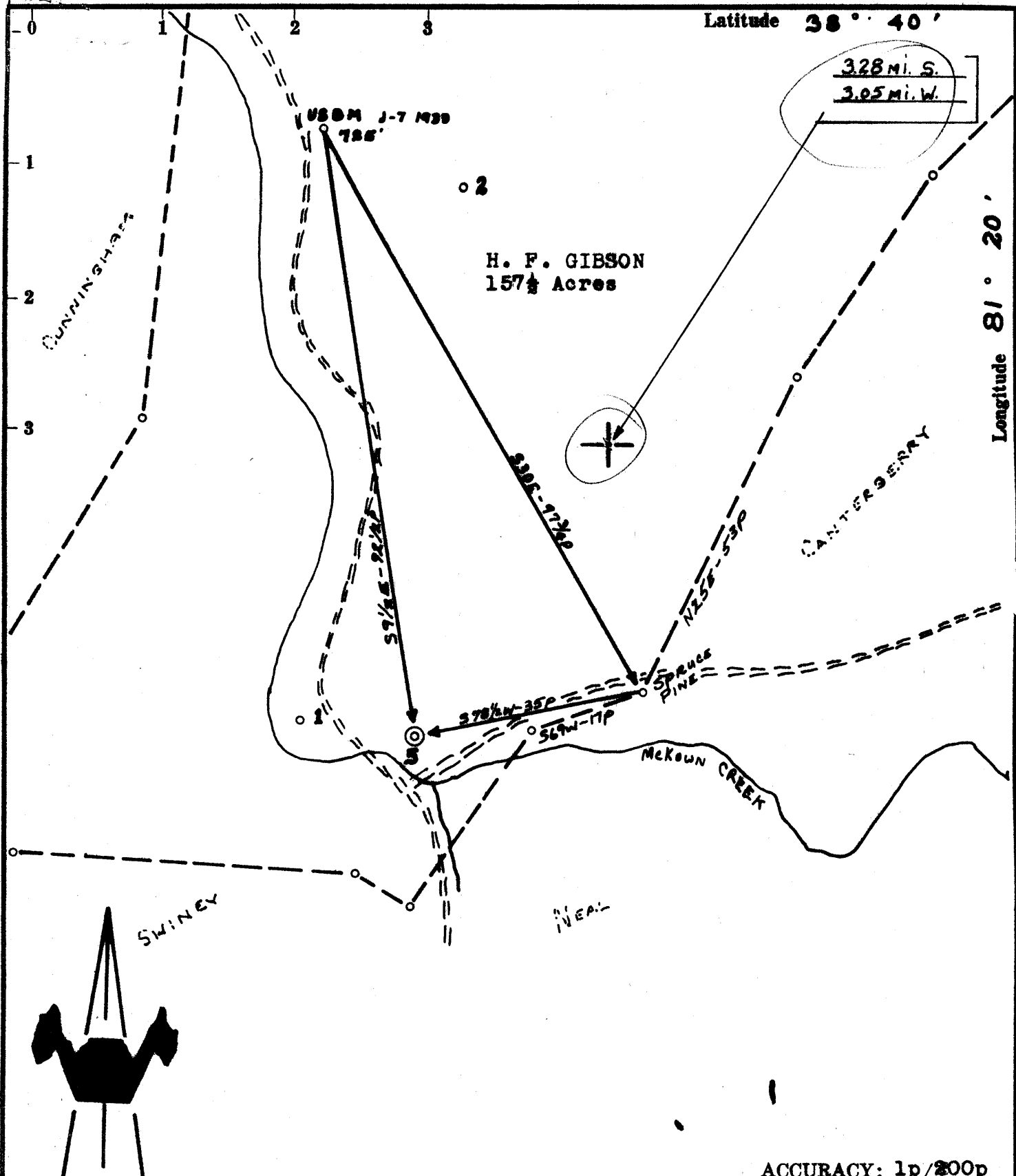

ACCURACY: 1p/200p

- New Location
- Drill Deeper
- Abandonment
- Fracture
- Redrill

Source of Elevation U. S. B. M. #J-7, 1933 along road (725')

I, the undersigned, hereby certify that this map is correct to the best of my knowledge and belief and shows all the information required by paragraph 6 of the rules and regulations of the oil and gas section of the mining laws of West Virginia.

Company	JOSEPH S. GRUSS	
Address	NEW YORK, N. Y.	
Farm	H. F. GIBSON	
Tract	Acres 157 1/2	Lease No.
Well (Farm) No.	5	Serial No.
Elevation (Spirit Level)	712.5'	
Quadrangle	WALTON - C	
County	ROANE	District
Engineer	CHET WATERMAN	
Engineer's Registration No.	3788	
File No.	65002-43	Drawing No.
Date	10/12/65	Scale 1" = 20p

STATE OF WEST VIRGINIA  
DEPARTMENT OF MINES  
OIL AND GAS DIVISION  
CHARLESTON

WELL LOCATION MAP  
FILE NO. ROA - 1206

+ Denotes location of well on United States Topographic Maps, scale 1 to 62,500, latitude and longitude lines being represented by border lines as shown.

- Denotes one inch spaces on border line of original tracing.



STATE OF WEST VIRGINIA  
DEPARTMENT OF MINES  
OIL AND GAS DIVISION

Rotary   
Spudder   
Cable Tools   
Storage

*Oil / Gas Well* Disposal   
(KIND)

WELL RECORD

Quadrangle Walton  
Permit No. ROA - 1206 (W-2)

Company Joseph S. Gruss  
Address New York City, N. Y.  
Farm H. F. Gibson Acres 157 1/2  
Location (waters) McKowas Creek  
Well No. 5 Elev. 712.5'  
District Walton County Roane  
The surface of tract is owned in fee by \_\_\_\_\_  
Address \_\_\_\_\_  
Mineral rights are owned by \_\_\_\_\_  
Address \_\_\_\_\_  
Drilling commenced 12/13/65  
Drilling completed 1/19/66  
Date Shot \_\_\_\_\_ From \_\_\_\_\_ To \_\_\_\_\_  
With \_\_\_\_\_  
Open Flow \_\_\_\_\_ /10ths Water in \_\_\_\_\_ Inch  
\_\_\_\_\_ /10ths Merc. in \_\_\_\_\_ Inch  
Volume \_\_\_\_\_ Cu. Ft.  
Rock Pressure \_\_\_\_\_ lbs. \_\_\_\_\_ hrs.  
Oil \_\_\_\_\_ bbls., 1st 24 hrs.  
WELL ACIDIZED (DETAILS) 1/21/66  
1500 gals.  
WELL FRACTURED (DETAILS) \_\_\_\_\_

Casing and Tubing	Used in Drilling	Left in Well	Packers
Size			Kind of Packer
16			
13			Size of
10	90'	pulled	Depth set
8 3/4	776'	pulled	
6 3/8			Perf. top
5 3/16	1326'		Perf. bottom
4 1/2			Perf. top
3			Perf. bottom
2			
Liners Used			

Attach copy of cementing record.  
CASING CEMENTED 5 1/2" SIZE 1326 No. Ft. 12/31/66 Date  
Amount of cement used (bags) 500  
Name of Service Co. Halliburton  
COAL WAS ENCOUNTERED AT None FEET \_\_\_\_\_ INCHES  
\_\_\_\_\_ FEET \_\_\_\_\_ INCHES  
\_\_\_\_\_ FEET \_\_\_\_\_ INCHES

RESULT AFTER TREATMENT (Initial open Flow or bbls.) \_\_\_\_\_

*Disposal well for Salt Water*

ROCK PRESSURE AFTER TREATMENT \_\_\_\_\_ HOURS

Fresh Water 20' Feet Salt Water 765 & 1315' Feet

Producing Sand \_\_\_\_\_ Depth \_\_\_\_\_

Formation	Color	Hard or Soft	Top	Bottom	Oil, Gas or Water	Depth	Remarks
Soil			0'	6'	Water @ 20'		
Sand			6	22			
Shale			22	144			
Sand			144	196			
Shale			196	602			
Sand			602	648			
Shale			648	712			
Sand			712	768	Water @ 765' SW		
Shale			768	810			
Sand			810	855			
Shale			855	890			
Sand			890	940			
Shale			940	1035			
Sand			1035	1082			
Shale			1082	1130			
Sand			1130	1170			
Shale			1170	1285			
Sand			1285	1627	Water @ 1315' SW		
Shale			1627	1628			
Sand			1628	1631			
Shale			1631	1638			
T.D.				1638			



**CHET WATERMAN**  
PETROLEUM CONSULTANT  
P.O. BOX 532

PARKERSBURG, W. VA.

STATE OF WEST VIRGINIA  
DEPARTMENT OF ENERGY  
DIVISION OF OIL AND GAS

AFFIDAVIT OF PLUGGING AND FILLING WELL

AFFIDAVITE SHOULD BE IN TRIPPLICATE, one copy mailed to the Division, one copy to be retained by the Well Operator and the third copy (and extra copies if required) should be mailed to each coal operator at their respective addresses.

Farm name: MOFFATT, GEORGE/GERTRUDE Operator Well No.: H.F. GIBSON 5

LOCATION: Elevation: 712.50 Quadrangle: KETTLE  
District: WALTON County: ROANE  
Latitude: 2000 Feet South of 38 Deg. 37 Min. 30 Sec.  
Longitude: 4000 Feet West of 81 Deg. 22 Min. 30 Sec.

Company: Quaker State Corporation Coal Operator N/A  
P.O. Box 189 or Owner \_\_\_\_\_  
Belpre, Ohio 45714 \_\_\_\_\_

Agent: Frank R. Rotunda Coal Operator \_\_\_\_\_  
Inspector: Homer Dougherty or Owner \_\_\_\_\_  
Permit Issued: 05/05/88

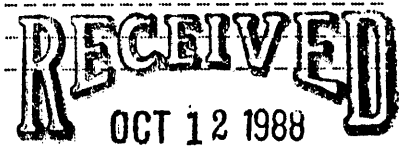

OHIO  
STATE OF ~~XXXXXXXXXXXXXXXXXX~~,  
County of Washington ss:

AFFIDAVIT

DIVISION OF OIL & GAS  
DEPARTMENT OF ENERGY

Timothy S. Knoblock and \_\_\_\_\_ being first duly sworn according to law depose and say that they are experienced in the work of plugging and filling oil and gas wells and were employed by Quaker State Corporation, well operator, and participated in the work of plugging and filling the above well, that said work was commenced on the 28th day of September, 1988, and that the well was plugged and filled in the following manner:

TYPE	FROM	TO	PIPE REMOVED	LEFT
Mechanical bridge plug	1300			
Cement: Class A (22 sx.)	1300	1100		1320' 5 1/2"
6% Gel	1100	600		
Cement: Class A (11 sx.)	600	500		
6% Gel	500	100		
Cement: Class A (11 sx.)	100	0		

Description of monument: (4') 5 1/2" casing / Gibson #5 / P&A 9-28-88 / 47-087-01206-P

and that the work of plugging and filling said well was completed on the 28th day of September, 1988.

And further deponents saith not.

*Timothy S. Knoblock*

Sworn and subscribe before me this 11th day of October, 1988  
My commission expires: \_\_\_\_\_

*Dolores L. Branch*  
Notary Public