

**WELL NO. 6**  
**STATE PLANE COORDINATES**  
**NORTH ZONE (NAD '27)**  
 N. 193,767.4  
 E. 1,567,641.0  
**LAT=(N) 39°01'19.0"**  
**LONG=(W) 81°01'18.4"**  
**UTM (NAD'83)(METERS)**  
 N. 4,319,222.0  
 E. 498,128.0

**NOTES ON SURVEY**

1. TIES TO WELLS AND CORNERS ARE BASED ON GRID NORTH FOR THE WV STATE PLANE COORDINATE SYSTEM NORTH ZONE NAD '27.
2. TIES TO REFERENCES ARE BASED ON MAGNETIC NORTH 09/11/13.
3. LEASE BOUNDARY SHOWN HEREON TAKEN FROM DEED BOOK 263 PAGE 20.
4. SURFACE OWNER AND ADJOINER INFORMATION TAKEN FROM THE ASSESSOR AND COUNTY CLERK RECORDS OF RITCHIE COUNTY IN JULY, 2013.
5. WELL LAT./LONG. (NAD'27) ESTABLISHED BY DGPS(SUBMETER MAPPING GRADE).
6. PLAT CHANGED TO SHOW REVISED ESTIMATED DEPTH AND TARGET FORMATION.

**REFERENCES**

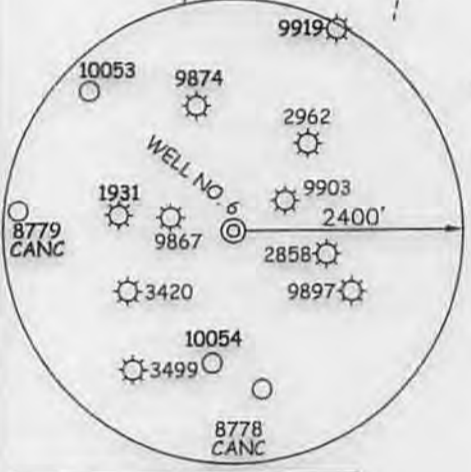
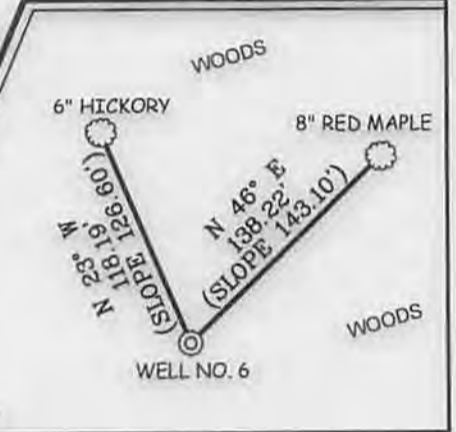

I THE UNDERSIGNED, HEREBY CERTIFY THAT THIS PLAT IS CORRECT TO THE BEST OF MY KNOWLEDGE AND BELIEF AND SHOWS ALL THE INFORMATION REQUIRED BY LAW AND THE REGULATIONS ISSUED AND PRESCRIBED BY THE DIVISION OF ENVIRONMENTAL PROTECTION

P.S. 677  
*Gregory A. Smith*



(+) DENOTES LOCATION OF WELL ON UNITED STATES TOPOGRAPHIC MAPS.  
 DATE SEPTEMBER 24 20 13  
 REVISED APRIL 11 20 14  
 OPERATORS WELL NO. J.E. GUM #6  
 API WELL NO. 47 - 85 - 10125  
 STATE COUNTY PERMIT

MINIMUM DEGREE OF ACCURACY 1/200 FILE NO. 7449P6R (475-63)  
 PROVEN SOURCE OF ELEVATION DGPS (SUBMETER MAPPING GRADE) SCALE 1" = 800'

STATE OF WEST VIRGINIA  
 DIVISION OF ENVIRONMENTAL PROTECTION  
 OFFICE OF OIL AND GAS



WELL TYPE: OIL  GAS  LIQUID INJECTION  WASTE DISPOSAL  IF "GAS" PRODUCTION  STORAGE  DEEP  SHALLOW

LOCATION ELEVATION 1,072' WATERSHED LYNNCAMP RUN  
 DISTRICT MURPHY COUNTY RITCHIE QUADRANGLE SMITHVILLE 7.5'

SURFACE OWNER NOAH L. & EMMA YODER ACREAGE 121.61±  
 ROYALTY OWNER F. CAIN, ET AL LEASE ACREAGE 125±

PROPOSED WORK:  
 DRILL  CONVERT  DRILL DEEPER  REDRILL  FRACTURE OR STIMULATE  PLUG OFF OLD FORMATION   
 PERFORATE NEW FORMATION  PLUG AND ABANDON  CLEAN OUT AND REPLUG  OTHER

PHYSICAL CHANGE IN WELL (SPECIFY) \_\_\_\_\_ TARGET FORMATION BEREA  
 ESTIMATED DEPTH 2,600'

WELL OPERATOR MURVIN & MEIER OIL CO. DESIGNATED AGENT P. NATHAN BOWLES, JR.  
 ADDRESS P.O. BOX 396 ADDRESS P.O. BOX 1237  
OLNEY, IL 62450 CHARLESTON, WV 25325

06/06/2014

COUNTY NAME PERMIT

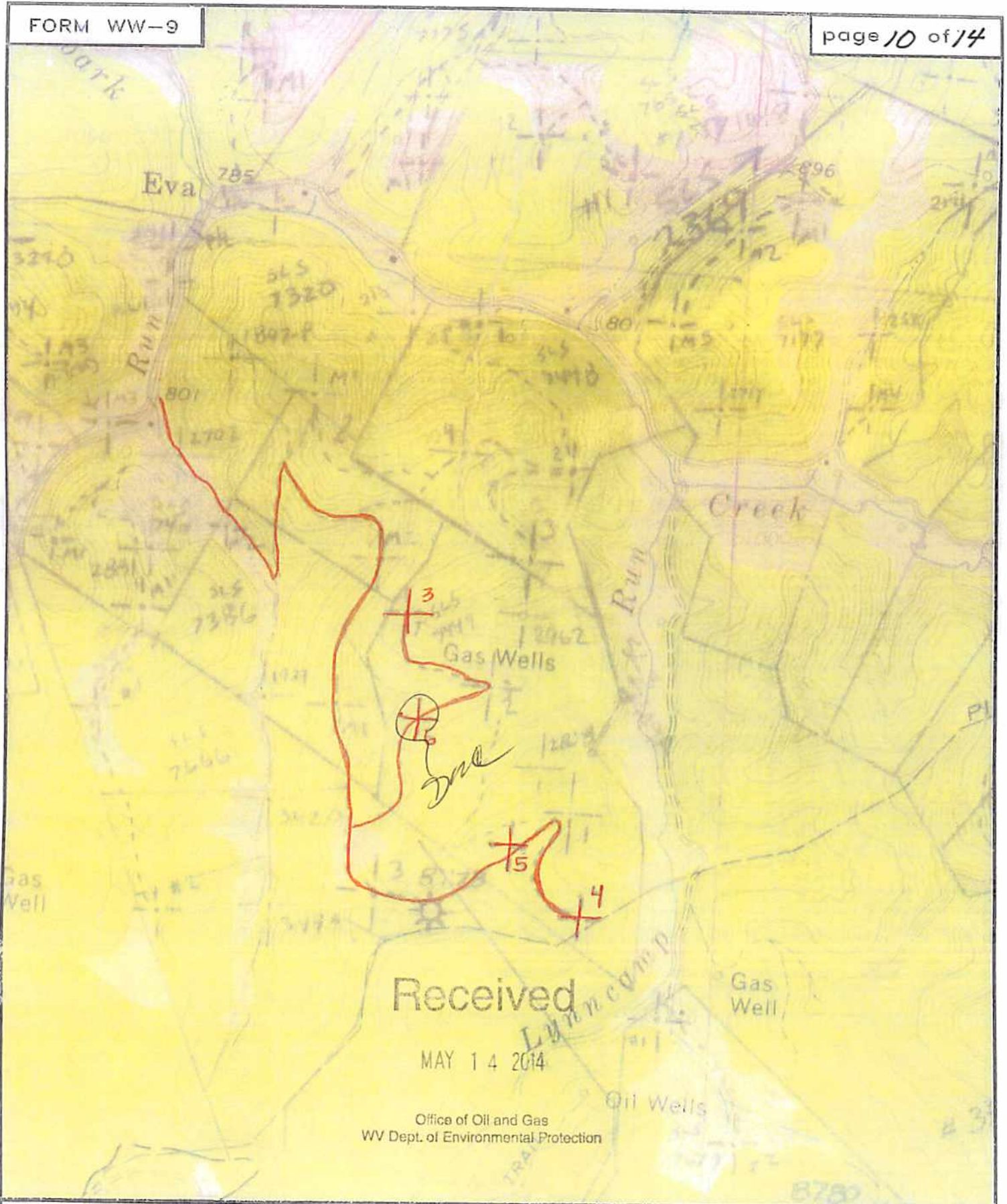

Received

MAY 14 2014

Office of Oil and Gas  
WV Dept. of Environmental Protection



SMITH LAND SURVEYING  
P.O BOX 150 GLENVILLE, WV. 26351

TOPO SECTION OF SMITHVILLE 7.5'

FILE NO. 7449      DATE 9/26/13      SCALE 1"=1,000'