

LOCATION REFERENCES
 (Mag. Bearing - Slope Dist.)
 S37°E 109' 8" Maple
 S44°W 104' 10" Hickory

NOTES

- TIE LINES SHOWN ARE REFERENCED TO GRID NORTH (WV SPC NORTH ZONE, NAD 1927).
- SURFACE OWNER INFORMATION FROM THE RECORDS OF THE RITCHIE COUNTY ASSESSOR'S OFFICE.
- LAT./LONG. AND TIE LINES ESTABLISHED BY DGPS (SUB-METER MAPPING GRADE.)
- LEASE BOUNDARY DEPICTION IS AS SHOWN ON WVDEP PERMIT PLAT FOR F.S. FOSTER HRS. NO.1 (47-085-0875)
- OLD WELLS LOCATED FROM SOUTH PENN FARM MAPS, WVDEP GIS MAPPING OR DGPS DATA.

WASHBURN 8
 UTM COORDINATES (NAD 1983)
 N - 4,337,409 m.
 E - 491,422 m.

⊕ DENOTES LOCATION OF WELL ON UNITED STATES TOPOGRAPHIC MAPS. ◊ DENOTES A POSSIBLE WATER SUPPLY SOURCE LOCATED FROM CIRCA 2003 AERIAL PHOTOGRAPHY - NOT BY SURVEY. OTHER SOURCES MAY BE PRESENT.

FILE NO. 116-15
 DRAWING NO. 8
 SCALE 1" = 1,000'
 MINIMUM DEGREE OF ACCURACY Sub-Meter
 PROVEN SOURCE OF ELEVATION DGPS Survey

I THE UNDERSIGNED, HEREBY CERTIFY THAT THIS PLAT IS CORRECT TO THE BEST OF MY KNOWLEDGE AND BELIEF AND SHOWS ALL THE INFORMATION REQUIRED BY LAW AND THE REGULATIONS ISSUED AND PRESCRIBED BY THE DEPARTMENT OF MINES.

(SIGNED) *[Signature]*
 TIMOTHY P. ROUSH PS 793



WEST VIRGINIA
 Division of Environmental Protection
 Office of Oil and Gas
 601 57th Street
 Charleston, West Virginia 25304



DATE April 18, 2014
 FARM Washburn No.8
 API WELL NO. 47 - 085 - 10114

WELL TYPE: OIL GAS LIQUID INJECTION ___ WASTE DISPOSAL ___
 (IF "GAS") PRODUCTION STORAGE ___ DEEP ___ SHALLOW HORIZONTAL ___
 LOCATION: ELEVATION 1,049' WATERSHED Addis Run
 DISTRICT Grant COUNTY Ritchie
 QUADRANGLE Harrisville 7.5'
 SURFACE OWNER Dana M. Washburn ACREAGE 103 Ac.
 OIL & GAS ROYALTY OWNER Dana M. Washburn LEASE ACREAGE 103 Ac.
 LEASE NO. _____
 PROPOSED WORK: DRILL CONVERT ___ DRILL DEEPER ___ REDRILL ___ FRACTURE OR STIMULATE PLUG OFF OLD FORMATION ___ PERFORATE NEW FORMATION ___ OTHER PHYSICAL CHANGE IN WELL (SPECIFY) _____
 PLUG AND ABANDON ___ CLEAN OUT AND REPLUG ___
 TARGET FORMATION Gordon ESTIMATED DEPTH 2,800'
 WELL OPERATOR Term Energy Corporation DESIGNATED AGENT Leroy Baker
 ADDRESS 713 East Main Street ADDRESS 713 East Main Street
Harrisville, WV 26362 Harrisville, WV 26362

05/06/2014

FORM IV-6

SUBJECT WELL
Washburn No.8

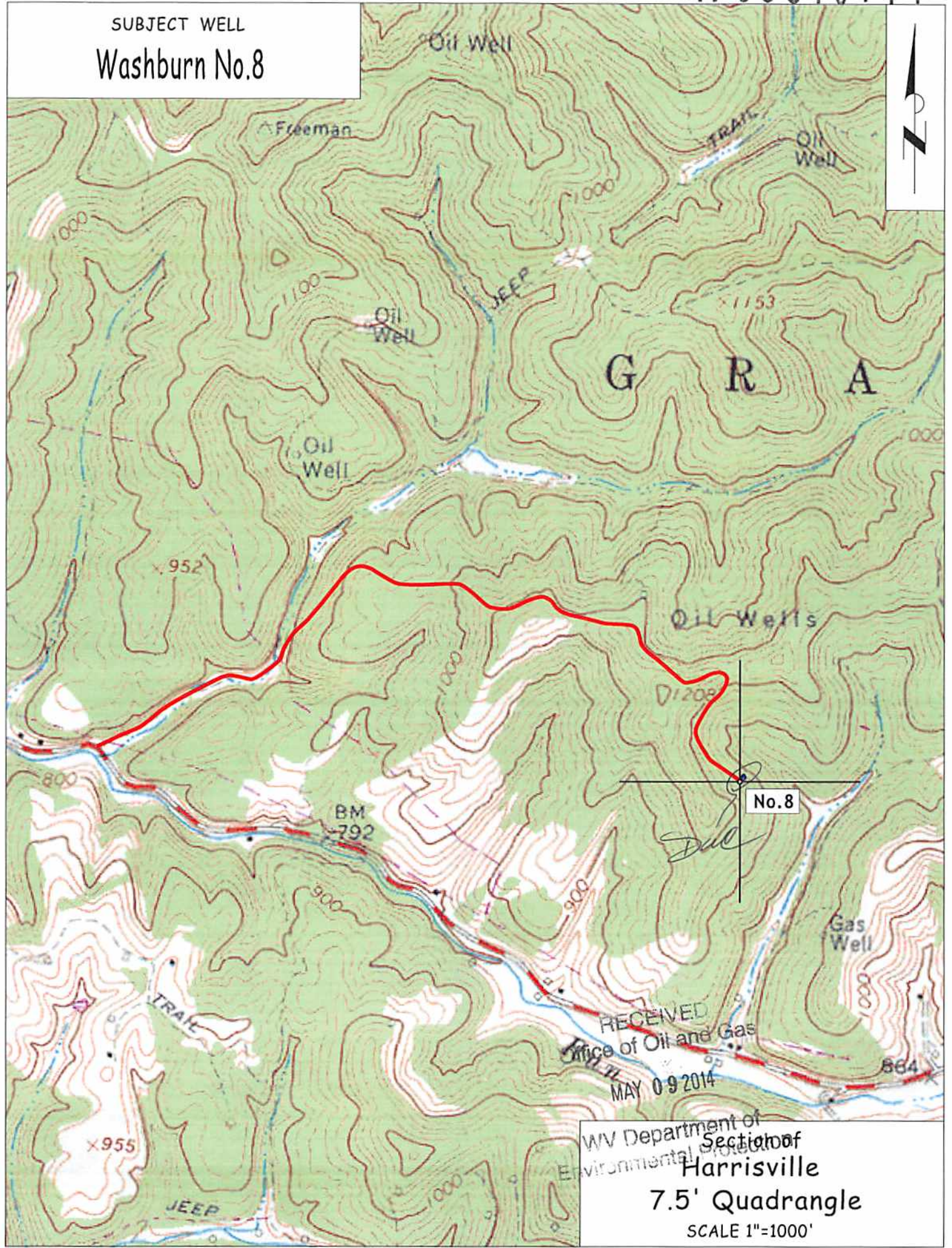

WV Department of Environmental Protection
Section of Harrisville
7.5' Quadrangle
SCALE 1"=1000'