

87B 1/16/86
 Janice 9/13/88

7520'
 LATITUDE 39° 10' 00"

0.63
 3.65
 0.635
 42W

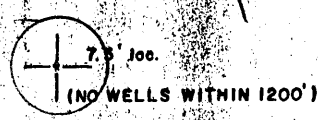

BECKNER - BOGARD LEASE - 29 AC.

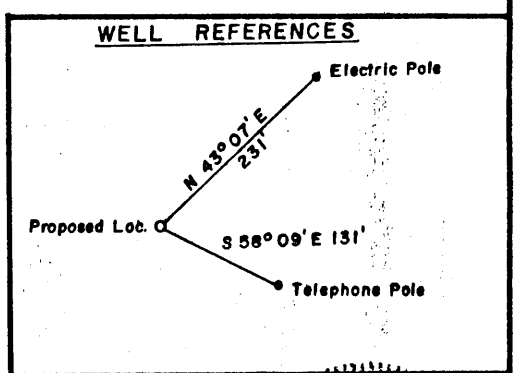
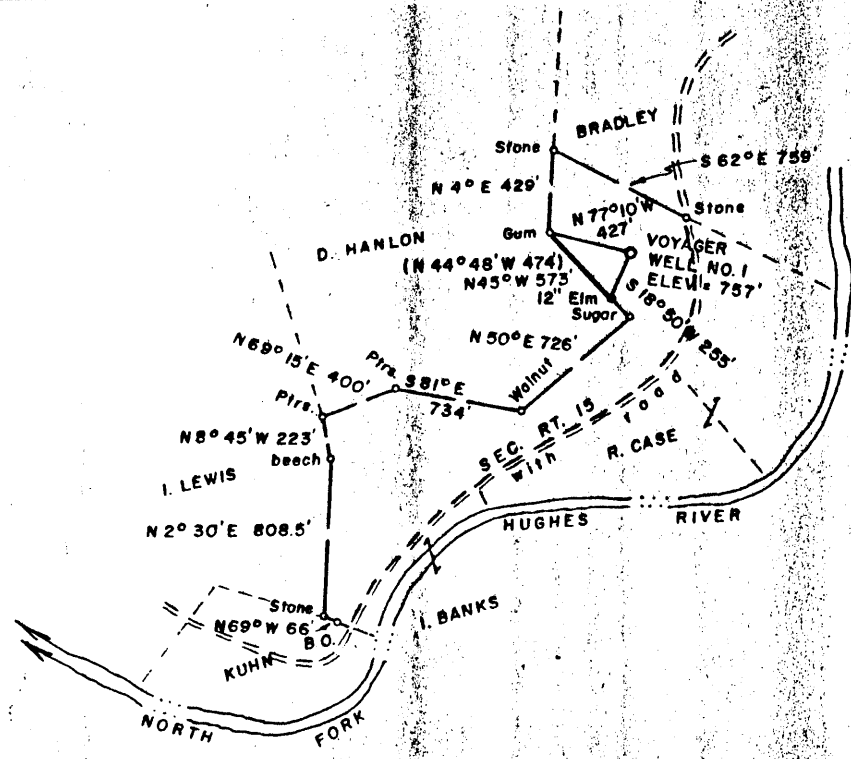

NORTH

LONGITUDE 81° 12' 30"

FILE NO. 12-43
 DRAWING NO. _____
 SCALE 1" = 1000'
 MINIMUM DEGREE OF ACCURACY 1/200
 PROVEN SOURCE OF ELEVATION Top of Knob East of Location, ELEV. = 885'

I THE UNDERSIGNED, HEREBY CERTIFY THAT THIS PLAT IS CORRECT TO THE BEST OF MY KNOWLEDGE AND BELIEF AND SHOWS ALL THE INFORMATION REQUIRED BY LAW AND THE REGULATIONS ISSUED AND PRESCRIBED BY THE DEPARTMENT OF MINES.
Mark C. Echard
 (SIGNED) MARK C. ECHARD
 R.P.E. _____ L.L.S. 490

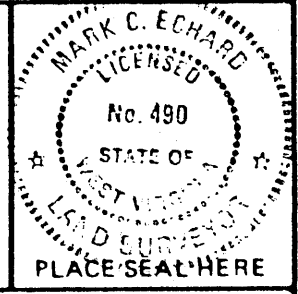

(+) DENOTES LOCATION OF WELL ON UNITED STATES TOPOGRAPHIC MAPS
 FORM IV-6 (8-78)



DATE JANUARY 2, 1987
 OPERATOR'S WELL NO. ONE
 API WELL NO. 47-085-7599-Frac.
 STATE COUNTY PERMIT

**STATE OF WEST VIRGINIA
 DEPARTMENT OF MINES
 OIL AND GAS DIVISION**

WELL TYPE: OIL GAS LIQUID INJECTION _____ WASTE DISPOSAL _____
 (IF "GAS.") PRODUCTION STORAGE _____ DEEP _____ SHALLOW
 LOCATION: ELEVATION 757' WATER SHED NORTH FORK HUGHES RIVER
 DISTRICT GRANT 2 COUNTY RITCHIE
 QUADRANGLE CAIRO 75' 275' 0574
 SURFACE OWNER JACKIE BOGARD ACREAGE 29
 OIL & GAS ROYALTY OWNER JACKIE E. BOGARD, et al LEASE ACREAGE 29
 LEASE NO. _____
 PROPOSED WORK: DRILL CONVERT _____ DRILL DEEPER _____ REDRILL _____ FRACTURE OR STIMULATE _____ PLUG OFF OLD FORMATION _____ PERFORATE NEW FORMATION _____ OTHER PHYSICAL CHANGE IN WELL (SPECIFY) _____
 PLUG AND ABANDON _____ CLEAN OUT AND REPLUG _____
 TARGET FORMATION BEREA ESTIMATED DEPTH 2100'
 WELL OPERATOR GLENVALE RESO. DESIGNATED AGENT DAVID A. HANLON
 ADDRESS P.O. BOX 100 ADDRESS 108 EAST MAIN ST. HARRISVILLE, WV. 26362
 RENO, OHIO 45773 4082

SEP 23 1988

R1 + 1509 - Frac.

82 B 1/16/86

7520'

LATITUDE 39° 10' 00"

0645
366W

0640
142W

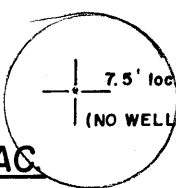

BECKNER - BOGARD LEASE - 29 AC.

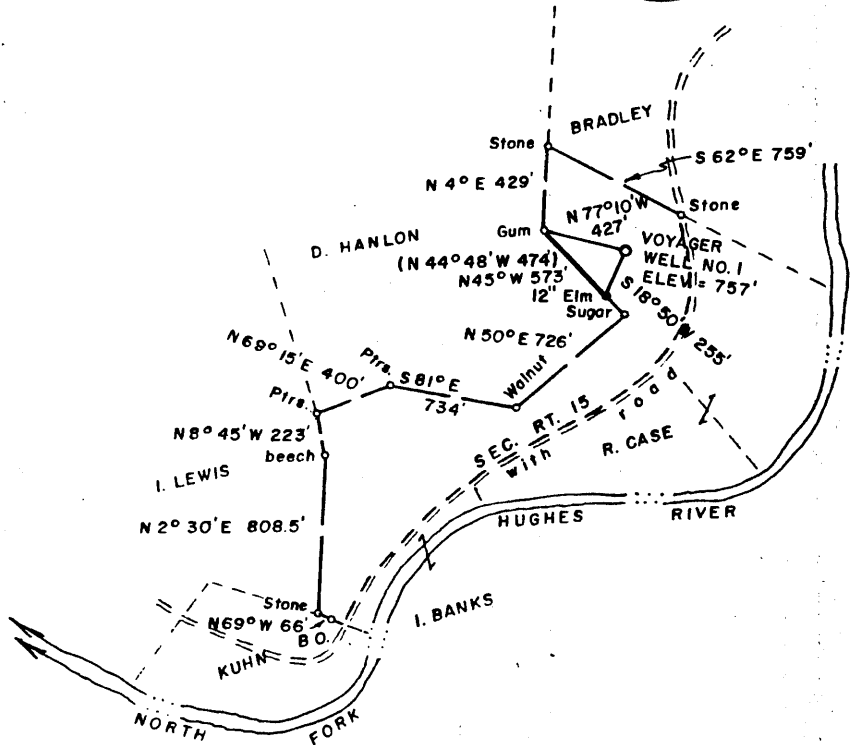

LONGITUDE 81° 12' 30"

WELL REFERENCES

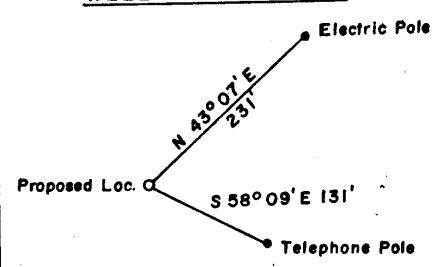

FILE NO. 12-43
DRAWING NO. _____
SCALE 1" = 1000'
MINIMUM DEGREE OF ACCURACY 1/200
PROVEN SOURCE OF ELEVATION Top of Knob East of Location, ELEV. = 885'

I THE UNDERSIGNED, HEREBY CERTIFY THAT THIS PLAT IS CORRECT TO THE BEST OF MY KNOWLEDGE AND BELIEF AND SHOWS ALL THE INFORMATION REQUIRED BY LAW AND THE REGULATIONS ISSUED AND PRESCRIBED BY THE DEPARTMENT OF MINES.
Mark C. Echard
(SIGNED) MARK C. ECHARD
R.P.E. _____ L.L.S. 490

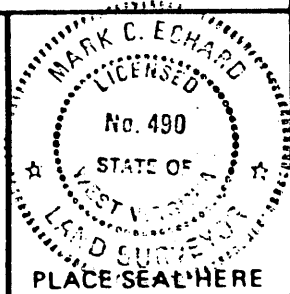

(+) DENOTES LOCATION OF WELL ON UNITED STATES TOPOGRAPHIC MAPS
FORM IV-6 (8-78)



DATE JANUARY 2, 1987
OPERATOR'S WELL NO. ONE
API WELL NO. _____
47 - 085 - 7599
STATE COUNTY PERMIT

**STATE OF WEST VIRGINIA
DEPARTMENT OF MINES
OIL AND GAS DIVISION**

WELL TYPE: OIL GAS LIQUID INJECTION WASTE DISPOSAL
(IF "GAS,") PRODUCTION STORAGE DEEP SHALLOW
LOCATION: ELEVATION 757' WATER SHED NORTH FORK HUGHES RIVER
DISTRICT GRANT 2 COUNTY RITCHIE
QUADRANGLE CAIRO 75' 275 057 WCY Harrisville
SURFACE OWNER JACKIE BOGARD ACREAGE 29
OIL & GAS ROYALTY OWNER JACKIE E. BOGARD, et al LEASE ACREAGE 29
LEASE NO. _____
PROPOSED WORK: DRILL CONVERT DRILL DEEPER REDRILL FRACTURE OR STIMULATE PLUG OFF OLD FORMATION PERFORATE NEW FORMATION OTHER PHYSICAL CHANGE IN WELL (SPECIFY) _____

PLUG AND ABANDON CLEAN OUT AND REPLUG
TARGET FORMATION BEREA ESTIMATED DEPTH 2100' 60 Rcy (115) JAN 26 1987
WELL OPERATOR VOYAGER OIL & GAS CORP DESIGNATED AGENT DAVID A. HANLON
ADDRESS P.O. BOX 183 ADDRESS 108 EAST MAIN ST.
RENO OHIO 45773 HARRISVILLE, WV. 26362

State of West Virginia
DEPARTMENT OF ENERGY
Division of Oil and Gas

Well Operator's Report of Well Work

Farm name: HARRISON, GEORGE Operator Well No.: BECKNER-BOGARD1

LOCATION: Elevation: 757.00 Quadrangle: CAIRO

District: GRANT County: RITCHIE
Latitude: 3400 Feet South of 39 Des. 10Min. 0 Sec.
Longitude 7520 Feet West of 81 Des. 12 Min. 30 Sec.

Company: GLENEAYRE RESOURCES, INC.
P. O. BOX 183
RENO, OH

Agent: DAVID HANLON

Inspector: SAMUEL HERSMAN
Permit Issued: 09/24/88
Well work Commenced: 06/22/88
Well work Completed: 08/01/88
Verbal Plussings
Permission granted on:
Rotary Cable _____ Rig _____
Total Depth (feet) 1870
Fresh water depths (ft) 35
Salt water depths (ft) 1150
Is coal being mined in area (Y/N)? N
Coal Depths (ft): 1760-1180
1261-1268

Casings & Tubing Size	Used in Drilling	Left in Well	Cement Fill Up Cu. Ft.
7"	443	443	
4 1/2"	1870	1699	
2-3/8"		1686	

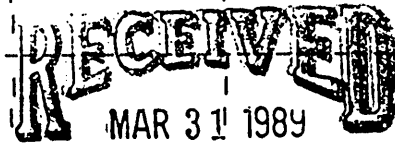

DIVISION OF OIL & GAS
DEPARTMENT OF ENERGY

OPEN FLOW DATA

Producing formation Big Injun Pay zone depth (ft) 1717-28
Gas: Initial open flow 50 MCF/d Oil: Initial open flow 0 Bbl/d
Final open flow 25 MCF/d Final open flow 0 Bbl/d
Time of open flow between initial and final tests 2 Hours
Static rock Pressure 480 psig (surface pressure) after 48 Hours

Second producing formation _____ Pay zone depth (ft) _____
Gas: Initial open flow _____ MCF/d Oil: Initial open flow _____ Bbl/d
Final open flow _____ MCF/d Final open flow _____ Bbl/d
Time of open flow between initial and final tests _____ Hours
Static rock Pressure _____ psig (surface pressure) after _____ Hours

NOTE: ON BACK OF THIS FORM PUT THE FOLLOWING: 1). DETAILS OF PERFORATED INTERVALS, FRACTURING OR STIMULATING, PHYSICAL CHANGE, ETC. 2). THE WELL LOG WHICH IS A SYSTEMATIC DETAILED GEOLOGICAL RECORD OF ALL FORMATIONS, INCLUDING COAL ENCOUNTERED BY THE WELLBORE.

Thomas G. Palmer

For: GLENEAYRE RESOURCES, INC.

By: Thomas G. Palmer
Date: 3-30-89

APR 7 1989

Perforated Interval: 1718-1728

Frac: 1260 bbl gelled water
35,000 lb 20/40 mesh sand
5,000 lb 16/30 mesh sand
16 bbl/min rate
1½ lb/gal max. sand concentration
breakdown 2880 psia (surface)
ISIP 1100 psia (surface)

RECEIVED
MAR 31 1989

DIVISION OF OIL & GAS
DEPARTMENT OF ENERGY

APR 7 1989

21.95



RECEIVED
OCT 09 1987

State of West Virginia
DEPARTMENT OF ENERGY
Oil and Gas Division

Date March 26, 1987
Operator's
Well No. #1
Farm BECKNER-BOGARD
API No. 47 - 085 - 7599

DIVISION OF OIL & GAS
DEPARTMENT OF ENERGY

WELL OPERATOR'S REPORT
OF

DRILLING, FRACTURING AND/OR STIMULATING, OR PHYSICAL CHANGE

WELL TYPE: Oil X / Gas X / Liquid Injection / Waste Disposal /
(If "Gas," Production X / Underground Storage / Deep / Shallow X /)

LOCATION: Elevation: 757' Watershed North Fork Hughes River
District: Grant County Ritchie Quadrangle Cairo 7.5'

COMPANY VOYAGER OIL & GAS CORPORATION
ADDRESS P. O. Box 183, Reno, OH 45773
DESIGNATED AGENT David G. Hanlon
ADDRESS 108 E. Main St., Harrisville, WV 26362
SURFACE OWNER Jackie E. Bogard
ADDRESS Cairo, WV 26337
MINERAL RIGHTS OWNER Jackie E. Bogard et al
ADDRESS Cairo, WV 26337
OIL AND GAS INSPECTOR FOR THIS WORK Samuel Hersman
ADDRESS P. O. Box 66 Smithville, WV 26178
PERMIT ISSUED January 20, 1987
DRILLING COMMENCED January 22, 1987
DRILLING COMPLETED January 24, 1987
IF APPLICABLE: PLUGGING OF DRY HOLE ON CONTINUOUS PROGRESSION FROM DRILLING OR REWORKING. VERBAL PERMISSION OBTAINED ON

Casing & Tubing	Used in Drilling	Left in Well	Cement fill up Cu. ft.
Size 20-16 Cond.			
13-10"			
9 5/8			
8 5/8			
7	475'	463'	74 cu ft
5 1/2			
4 1/2	1870'	1699'	35 cu ft
3			
2			
Liners used			

GEOLOGICAL TARGET FORMATION Big Injun Depth 1680' feet
Depth of completed well 1699 feet Rotary X / Cable Tools
Water strata depth: Fresh 35 feet; Salt 1150 feet
Coal seam depths: NA Is coal being mined in the area? No

OPEN FLOW DATA

Producing formation Big Injun Pay zone depth 1680 feet
Gas: Initial open flow 48 Mcf/d Oil: Initial open flow 0 Bbl/d
Final open flow (5) Mcf/d Final open flow 0 Bbl/d
Time of open flow between initial and final tests 48 hours
Static rock pressure 425 psig (surface measurement) after 48 hours shut in
(If applicable due to multiple completion--)
Second producing formation Pay zone depth feet
Gas: Initial open flow Mcf/d Oil: Initial open flow Bbl/d
Final open flow Mcf/d Oil: Final open flow Bbl/d
Time of open flow between initial and final tests hours
Static rock pressure psig (surface measurement) after hours shut in

OCT 19 1987

DETAILS OF PERFORATED INTERVALS, FRACTURING OR STIMULATING, PHYSICAL CHANGE, ETC.

OPEN HOLE COMPLETION 1699-1870

FRAC: 609 sx 20/40 Sand
 432 bbl H₂O
 BREAK: 1530 psig
 AVG. PRESSURE: 1450 psig
 AVG. RATE: 8 BPM
 ISIP: 1630 psig

RECEIVED
 OCT 09 1987

DIVISION OF OIL & GAS
 DEPARTMENT OF ENERGY

WELL LOG

FORMATION	COLOR	HARD OR SOFT	TOP FEET	BOTTOM FEET	REMARKS Including indication of all fresh and salt water, coal, oil and gas
Surface to 994'		not logged			
Siltstone, Shale			994	1046	
First Salt Sand			1046	1098	No shows
Siltstone, Shale & Coal			1098	1182	Coal: 1176' - 1180'
Second Salt Sand			1182	1247	No shows
Siltstone, Shale, Coal			1247	1358	1261' - 1268'
Third Salt Sand			1358	1434	No shows
Shale, Siltstone			1434	1474	
Maxton Sandstone			1474	1569	No shows
Greenbrier Limestone			1573	1626	
Greenbrier Sandstone			1626	1645	No shows, dolomitic
Shale, Siltstone, trace SS			1645	1661	
✓ Big Injun Sandstone			1661	1747	Good show of oil 1720' - 1730'
Shale, siltstone			1747	T. D.	
					Logger's T. D. 1870' <u>Driller'd T. D. 1870'</u>

(Attach separate sheets as necessary)

VOYAGER OIL & GAS CORPORATION

Well Operator

Richard Hudson

By: _____

Date: _____

~~6/15/87~~

10/06/87

Note: Regulation 2.02(i) provides as follows:
 "The term 'log' or 'well log' shall mean a systematic detailed geological record of all formations, including ..., encountered in the drilling of a well."

FORM WW-2(B) FILE COPY
 (Obv) **RECEIVED**
 7/85
 JAN 15 1987

Todor



1) Date: January 7, 19 86
 2) Operator's Well No. XX BECKNER-BOGARD #1
 3) API Well No. 47-085-7599
 State _____ County _____ Permit _____

STATE OF WEST VIRGINIA
 DIVISION OF OIL & GAS DEPARTMENT OF ENERGY, OIL AND GAS DIVISION
 DEPARTMENT OF ENERGY
 BLANKET BOND #B-004374-087-86
APPLICATION FOR A WELL WORK PERMIT

- 4) WELL TYPE: A Oil X / Gas X
 B (If "Gas", Production X / Underground storage _____ / Deep _____ / Shallow X)
 5) LOCATION: Elevation: 757' Watershed: North Fork Hughes River
 District: Grant 711 2 County: Ritchie 085 Quadrangle: Cairo 7.5' 275
 6) WELL OPERATOR VOYAGER OIL & GAS CODE: 51590 7) DESIGNATED AGENT DAVID G. HANLON
 Address P. O. Box 183 Address 108 East Main Street
Reno, OH 45773 Harrisville, WV 26362
 8) OIL & GAS INSPECTOR TO BE NOTIFIED Name Samuel Hersman
 Address P. O. Box 66
Smithville, WV 26178
 9) DRILLING CONTRACTOR: Name Fouts Operations, Inc.
 Address Route 2, Box 271
Glouster, OH 45732
 10) PROPOSED WELL WORK: Drill X / Drill deeper _____ / Redrill _____ / Stimulate X
 Plug off old formation _____ / Perforate new formation _____
 Other physical change in well (specify) _____
 11) GEOLOGICAL TARGET FORMATION, Berea 345
 12) Estimated depth of completed well, 2100 feet
 13) Approximate trata depths: Fresh, 2413 30 feet; salt, 1000 feet.
 14) Approximate coal seam depths: N/A 1 Is coal being mined in the area? Yes _____ / No X

15) CASING AND TUBING PROGRAM see 085-2030

CASING OR TUBING TYPE	SPECIFICATIONS					FOOTAGE INTERVALS		CEMENT FILL-UP OR SACKS (Cubic feet)	PACKERS
	Size	Grade	Weight per ft.	New	Used	For drilling	Left in well		
Conductor									Kinds
Fresh water	7"			X		243 320'	443 300'	To surface	By Rule 15.05
Coal									Sizes
Intermediate									
Production	4.5"		9.5#	X		2100'	2100'	As Per	Depths set
Tubing								Rule	15.01 <u>or 210 SKS</u>
Liners									Perforations:
									Top Bottom

OFFICE USE ONLY
DRILLING PERMIT

Permit number 47-085-7599 Date January 20 19 87

This permit covering the well operator and well location shown below is evidence of permission granted to drill in accordance with the pertinent legal requirements subject to the conditions contained herein and on the reverse hereof. Notification must be given to the District Oil and Gas Inspector. (Refer to No. 8) Prior to the construction of roads, locations and pits for any permitted work. In addition, the well operator or his contractor shall notify the proper district oil and gas inspector 24 hours before actual permitted work has commenced.)

The permitted work is as described in the Notice and Application, plat, and reclamation plan, subject to any modifications and conditions specified on the reverse hereof.
 Permit expires January 20, 1989 unless well work is commenced prior to that date and prosecuted with due diligence.

Bond: <input checked="" type="checkbox"/>	Agent: <u>ALB</u>	Plat: <u>AS</u>	Casing: <u>AS</u>	Fee: <u>1303 - 1304 166</u>	WCCP: <u>AS</u>	SAR: <u>AS</u>	Other: _____
---	-------------------	-----------------	-------------------	-----------------------------	-----------------	----------------	--------------

NOTE: Keep one copy of this permit posted at the drilling location.
 Director, Division of Oil and Gas
 File

FORM WW-2B

085-7599-1
Issued 9/24/88 Expires 9/24/90
Page 1 of 1

STATE OF WEST VIRGINIA
DEPARTMENT OF ENERGY, DIVISION OF OIL AND GAS
WELL WORK PERMIT APPLICATION

- 1) Well Operator: GLENEYRE RESOURCES, INC. (19280) (2) 275
- 2) Operator's Well Number: Beckner-Bogard #1 3) Elevation: 757'
- 4) Well type: (a) Oil or Gas
 (b) If Gas: Production Underground Storage
 Deep Shallow
- 5) Proposed Target Formation(s): Big Injun
- 6) Proposed Total Depth: 1745 feet
- 7) Approximate fresh water strata depths: 35
- 8) Approximate salt water depths: 1150
- 9) Approximate coal seam depths: N/A
- 10) Does land contain coal seams tributary to active mine? Yes No
- 11) Proposed Well Work: Stimulate existing well
- 12)

CASING AND TUBING PROGRAM

TYPE	SPECIFICATIONS			FOOTAGE INTERVALS		CEMENT
	Size	Grade	Weight per ft.	For drilling	Left in well	Fill-up (cu. ft.)
Conductor	7"		17#	475'	463'	74
Fresh Water						
Coal						
Intermediate						
Production	4½"		10.5#	1870'	1699'	35
Tubing						
Liners						

PACKERS : Kind Hookwall Formation Packer
 Sizes 4½" x 6¼"
 Depths set 1708'

RECEIVED
SEP 08 1988

For Division of Oil and Gas Use Only DIVISION OF OIL & GAS
 DEPARTMENT OF ENERGY

Fee(s) paid: Well Work Permit Reclamation Fund WPCP
 Plat WW-9 WW-2B Bond 50 Blanket Agent

7645
1170
30

Page 1 of 1
Form WW2-A
(09/87)
File Copy

RECEIVED
SEP 08 1988

DIVISION OF OIL & GAS
DEPARTMENT OF ENERGY

1) Date: July 15, 1988
2) Operator's well number
Beckner-Bogard #1
3) API Well No: 47 - 085 - 7599-FRAC
State - County - Permit

STATE OF WEST VIRGINIA Blanket Bond #B-004374-087-
DEPARTMENT OF ENERGY, DIVISION OF OIL AND GAS 86

NOTICE AND APPLICATION FOR A WELL WORK PERMIT

<p>4) Surface Owner(s) to be served:</p> <p>(a) Name <u>George Harrison</u> Address <u>Route 1, Box 9C</u> <u>Petroleum, WV 26161</u></p> <p>(b) Name _____ Address _____</p> <p>(c) Name _____ Address _____</p> <p>6) Inspector <u>Sam Hersman</u> Address <u>Route 1, Box 240</u> <u>Harrisville, WV 26362</u> Telephone (304)-<u>628-3185</u></p>	<p>5) (a) Coal Operator: Name <u>N/A</u> Address _____</p> <p>(b) Coal Owner(s) with Declaration Name _____ Address _____</p> <p>Name _____ Address _____</p> <p>(c) Coal Lessee with Declaration Name _____ Address _____</p>
---	--

TO THE PERSON(S) NAMED ABOVE TAKE NOTICE THAT:

_____ Included is the lease or leases or other continuing contract or contracts by which I hold the right to extract oil and gas OR
X Included is the information required by Chapter 22B, Article 1, Section 8(d) of the Code of West Virginia (see page 2)

I certify that as required under Chapter 22B of the West Virginia Code I have served copies of this notice and application, a location plat, and accompanying documents pages 1 through _____ on the above named parties, by:

- _____ Personal Service (Affidavit attached)
- _____ Certified Mail (Postmarked postal receipt attached)
- _____ Publication (Notice of Publication attached)

I have read and understand Chapter 22B and 38 CSR 11-18, and I agree to the terms and conditions of any permit issued under this application.

I certify under penalty of law that I have personally examined and am familiar with the information submitted on this application form and all attachments, and that based on my inquiry of those individuals immediately responsible for obtaining the information, I believe that the information is true, accurate, and complete.

I am aware that there are significant penalties for submitting false information, including the possibility of fine and imprisonment.

Well Operator Glencayre Resources, Inc.
By: Thomas G. Palmer
Its: Thomas G. Palmer, President
Address P.O. Box 100
Reno, OH 45773
Telephone (614) 373-8385

Subscribed and sworn before me this 15 day of July, 1988

Notary Public
My commission expires 12/20/88