



1) Date: June 7, 1983  
 2) Operator's Well No. M. H. Davis 1-D  
 3) API Well No. 47 085 6644  
 State County Permit

DRILLING CONTRACTOR:

STATE OF WEST VIRGINIA  
DEPARTMENT OF MINES, OIL AND GAS DIVISION

Gene Stalnaker, Inc.  
 P.O. Box 178  
 Glenville, WV 26351

OIL AND GAS WELL PERMIT APPLICATION

- 4) WELL TYPE: A Oil / Gas  / B (If "Gas", Production / Underground storage / Deep / Shallow  )
- 5) LOCATION: Elevation: 930 Watershed: South Fork Hughes River  
 District: Union County: Ritchie Quadrangle: Pullman 7.5
- 6) WELL OPERATOR Gene Stalnaker, Inc. 11) DESIGNATED AGENT Gene Stalnaker  
 Address P.O. Box 178 Address P.O. Box 178  
 Glenville, WV 26351 Glenville, WV 26351
- 7) OIL & GAS ROYALTY OWNER M. H. Davis 12) COAL OPERATOR n/a  
 Address Box 235 Address  
 Flatwoods, WV  
 Acreage 10 of 122.5
- 8) SURFACE OWNER M. Grimm 13) COAL OWNER(S) WITH DECLARATION ON RECORD:  
 Address Box 83 Name n/a  
 Harrisville, WV  
 Acreage 10 of 122.5  
 Address
- 9) FIELD SALE (IF MADE) TO: Name  
 Address
- 10) OIL & GAS INSPECTOR TO BE NOTIFIED 14) COAL LESSEE WITH DECLARATION ON RECORD:  
 Name Samuel Hersman Name n/a  
 Address Box 66 Smithville, WV Address  
 477-3597
- 15) PROPOSED WORK: Drill  / Drill deeper / Redrill / Fracture or stimulate  
 Plug off old formation / Perforate new formation  
 Other physical change in well (specify)
- 16) GEOLOGICAL TARGET FORMATION, Alexander
- 17) Estimated depth of completed well, 5900 feet
- 18) Approximate water strata depths: Fresh, 130 feet; salt, feet
- 19) Approximate coal seam depths: n/a Is coal being mined in the area? Yes  No

RECEIVED  
 JUN - 8 1983  
 OIL & GAS DIVISION  
 DEPT. OF MINES

20) CASING AND TUBING PROGRAM

CASING OR TUBING TYPE	Size	SPECIFICATIONS				FOOTAGE INTERVALS		CEMENT FILL-UP OR SACKS (Cubic feet)	PACKERS
		Grade	Weight per ft.	New	Used	For drilling	Left in well		
Conductor	11 3/4				x	40'			Kinds
Fresh water									
Coal									Sizes
Intermediate	8 5/8	CW	201b	x		1030'	1030'	To Surface	by Rule 15-05
Production	4 1/2	ERW	10.50	x			5900'	2000' Fill	Depth set on 105 109
Tubing								Up	by Rule 15-01
Liners									Perforations:
									Top Bottom

- 21) EXTRACTION RIGHTS  
 Check and provide one of the following:  
 Included is the lease or leases or other continuing contract or contracts by which I hold the right to extract oil or gas.  
 The requirement of Code 22-4-1-(c) (1) through (4). (See reverse side for specifics.)
- 22) ROYALTY PROVISIONS  
 Is the right to extract, produce or market the oil or gas based upon a lease or other continuing contract or contracts providing for flat well royalty or any similar provision for compensation to the owner of the oil or gas in place which is not inherently related to the volume of oil or gas so extracted, produced or marketed? Yes  No
- If the answer above is No, nothing additional is needed. If the answer is Yes, you may use Affidavit Form IV-60.
- 23) Required Copies (See reverse side.)
- 24) Copies of this Permit Application and the enclosed plat and reclamation plan have been mailed by registered mail or delivered by hand to the above named coal operator, coal owner(s), and coal lessee on or before the day of the mailing or delivery of this Permit Application to the Department of Mines at Charleston, West Virginia.
- Notary: Barbara C. Smith  
 My Commission Expires November 9, 1992  
 Signed: Gene Stalnaker  
 Its: President

OFFICE USE ONLY

DRILLING PERMIT

Permit number 47-085-6644 Date August 2, 1983  
 08/18/2023

This permit covering the well operator and well location shown below is evidence of permission granted to drill in accordance with the pertinent legal requirements subject to the conditions contained herein and on the reverse hereof. Notification must be given to the District Oil and Gas Inspector. (Refer to No. 10) Prior to the construction of roads, locations and pits for any permitted work. In addition, the well operator or his contractor shall notify the proper district oil and gas inspector 24 hours before actual permitted work has commenced.)

Permit expires August 2, 1984 unless drilling is commenced prior to that date and prosecuted with due diligence.

Bond: B	Agent: ls	Plat: [Signature]	Casing: [Signature]	Fee: 13627
---------	-----------	-------------------	---------------------	------------

[Signature]  
 Administrator, Office of Oil and Gas

Line Item Explanation

- 1) Date of Application
- 2) Your well name and number
- 3) To be filled out by office of oil & gas
- 4A) "Oil" means natural crude oil or petroleum and other hydrocarbons, regardless of gravity, which are produced at the well in liquid form by ordinary production methods and which are not the result of condensation of gas after it leaves underground reservoirs: "Gas" means all natural gas and all other fluid hydrocarbons not defined as oil.
- 4B) "Shallow well" means any well drilled and completed in a formation above the top of the uppermost member of the "Onondaga Group" or a depth less than six thousand feet, whichever is shallower.  
"Deep well" means any well drilled and completed in a formation at or below the top of the uppermost member of the "Onondaga Group" or at a depth less than six thousand feet, whatever is shallower.
- 5) Where well is located
- 6) Before a permit can be issued in a corporation, company partnership, or fictitious name, the name must be registered with the Secretary of State Office
- 7) Use separate sheet if necessary
- 8) Present surface owner at time application is filed.
- 9) Optional
- 11) See Reg. 7.01 relating to code §22-4-1k
- 12) "Coal Operator" means any persons, firm, partnership, partnership association or corporation that proposes to or does operate a coal mine. See Note 24
- 13 & 14) As per §22-4-20; See Note 24
- 15) Work that will be attempted—A separate Form IV-2 shall not be required for fracturing or stimulating a well where fracturing or stimulating is to be part of the work for which a permit is sought and is noted as such on the Form IV-2 filed in connection therewith.
- 16) Anticipated formation for which well will be completed
- 17) Self explanatory
- 18) Depth to deepest freshwater, and shallowest salt water, taken from nearby wells corrected for differences in elevation
- 19) All coal seam depths
- 20) Proposed casing program and cementing refer to Code 22-4-5, 22-4-6, 22-4-7, 22-4-8, 22-4-8a Reg 9.01, 15.01, 15.02, 15.03, 15.04, 25.01, 25.02, 25.03, 25.04
- 21) Code 22-4-11(c) - In lieu of filing the lease or leases or other continuing contract or contracts, the applicant for a permit described herein may file the following:
  - (1) A brief description of the tract of land including the district and county wherein the tract is located;
  - (2) The identification of all parties to all leases or other continuing contractual agreements by which the right to extract, produce or market the oil or gas is claimed;
  - (3) The book and page number wherein each such lease or contract by which the right to extract, produce or market the oil or gas is recorded;
  - (4) A brief description of the royalty provisions of each such lease or contract.

22) Code 22-4-11(d) and 22-4-11(e).

23) Regulation 7.02 of the Department of Mines provides that the original and four copies of Form IV-2 must be filed with the Department, accompanied by (i) a plat in the form prescribed by Regulation 11, (ii) a bond in one of the forms prescribed by Regulation 12, or in lieu thereof the other security allowed by Code §22-4-2, (iii) Form IV-9, "Reclamation Plan", applicable to the reclamation required by Code §22-4-12b and Regulation 23, (iv) unless previously paid on the same well, the fee required by Code §22-4-12a, and (v) if applicable, the consent required by Code §22-4-8a from the owner of any water well or dwelling within 200 feet of the proposed well.

24) **The above named coal operator, coal owner(s), and coal lessee are hereby notified that any objection they wish to make or are required to make by Code §22-4-3 must be filed with the Department of Mines within fifteen (15) days after the receipt of this Application by the Department.**

The following waiver must be completed by the coal operator and by any coal owner or coal lessee who has recorded a declaration under Code 22-4-20, if the permit is to be issued within fifteen (15) days of receipt thereof.

WAIVER

08/18/2023

The undersigned coal operator \_\_\_\_\_ / owner \_\_\_\_\_ / lessee \_\_\_\_\_ / of the coal under this well location has examined this proposed well location. If a mine map exists which covers the area of the well location, the well location has been added to the mine map. The undersigned has no objection to the work proposed to be done at this location, provided, the well operator has complied with all applicable requirements of the West Virginia Code and the governing regulations.

Date: \_\_\_\_\_, 19\_\_\_\_

By \_\_\_\_\_

Its \_\_\_\_\_

JUNE 7, 1983

M.H. DAVIS D-1

State of West Virginia

FILE NO. 47 - 085 6644

Department of Mining  
Oil and Gas Division

CONSTRUCTION AND REVEGETATION PLAN

CLIENT NAME GENE STALNAKER, INC.

DESIGNATED AGENT GENE STALNAKER, INC.

Address P.O. BOX 178-220 W. MAIN ST.  
GLENVILLE, W. Va. 26351

Address P.O. BOX 178-220 W. MAIN ST.  
GLENVILLE, W. Va. 26351

Telephone 462-5701

Telephone 462-5701

LANDOWNER M. GRIMM

SOIL CONS. DISTRICT LITTLE KANAWHA

Revegetation to be carried out by GENE STALNAKER, INC.

This plan has been reviewed by Little Kanawha SCD. All corrections and additions become a part of this plan: 6-7-83

(Date)  
Jarrett Newton  
(SCD Agent)

ACCESS ROAD	LOCATION
Structure <u>DRAINAGE DITCH</u> (A)	Structure <u>DIVERSION DITCH</u>
Spacing <u>EARTHEN</u>	Material <u>EARTHEN</u>
Page Ref. Manual <u>2:12</u>	Page Ref. Manual <u>2:12</u>
Structure <u>CROSS DRAINS</u> (B)	Structure <u>ROCK-RIP-RAP</u>
Spacing <u>5% Grade 135' APART</u>	Material <u>ROCK</u>
Page Ref. Manual <u>2:4</u>	Page Ref. Manual <u>2:16, 2:4</u>
Structure <u>ROAD CULVERT</u> (C)	Structure <u>PIT</u>
Spacing _____	Material <u>EARTHEN</u>
Page Ref. Manual <u>2:7</u>	Page Ref. Manual <u>N/A</u>

All structures should be inspected regularly and repaired if necessary. All commercial timber is to be cut and stacked and all brush and small timber to be cut and removed from the site before dirt work begins.

REVEGETATION

Treatment Area I

Treatment Area II

Lime	<u>2</u> Tons/acre
or correct to pH	<u>6.5</u>
Fertilizer	<u>600</u> lbs/acre
(10-20-20 or equivalent)	
Mulch	<u>HAY</u> 2 Tons/acre
Seed*	<u>LADINO CLOVER</u> 3 lbs/acre
	<u>KY 31</u> 40 lbs/acre
	lbs/acre

Lime	<u>2</u> Tons/acre
or correct to pH	<u>6.5</u>
Fertilizer	<u>600</u> lbs/acre
(10-20-20 or equivalent)	
Mulch	<u>HAY</u> 2 Tons/acre
Seed*	<u>LADINO CLOVER</u> 3 lbs/acre
	<u>KY 31</u> 40 lbs/acre
	lbs/acre

08/18/2023

\*Inoculate all legumes such as vetch, trefoil and clovers with the proper bacterium. Inoculate with 3X recommended amount.



462-5565

PLAN PREPARED BY MARK C. ECHARD

STAR Rte. 71 BOX 6

ADDRESS GLENVILLE, W. Va. 26351

NOTES: Please request landowners' permission to protect new



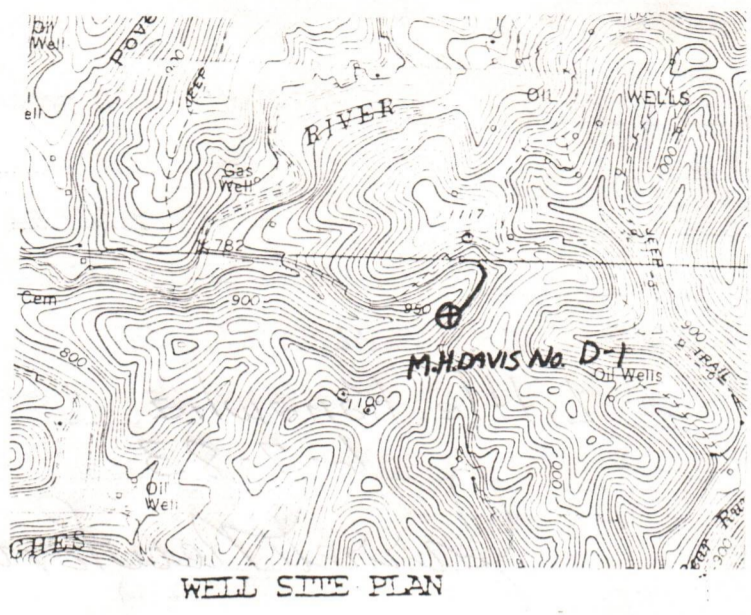



LEGEND  
 Well Site   
 Access Road 









WELL SITE PLAN

Sketch to include well location, existing access road, roads to be constructed, wellsite  
 drilling pits and necessary structures numbered or lettered to correspond with the first  
 part of this plan. Include all natural drainage.

LEGEND

- Property boundary 
- Fence 
- Existing fence 
- Planned fence 
- Stream 
- Open ditch 

- Diversion 
- Spring 
- Wet spot 
- Building 
- Drain pipe 
- Waterway 

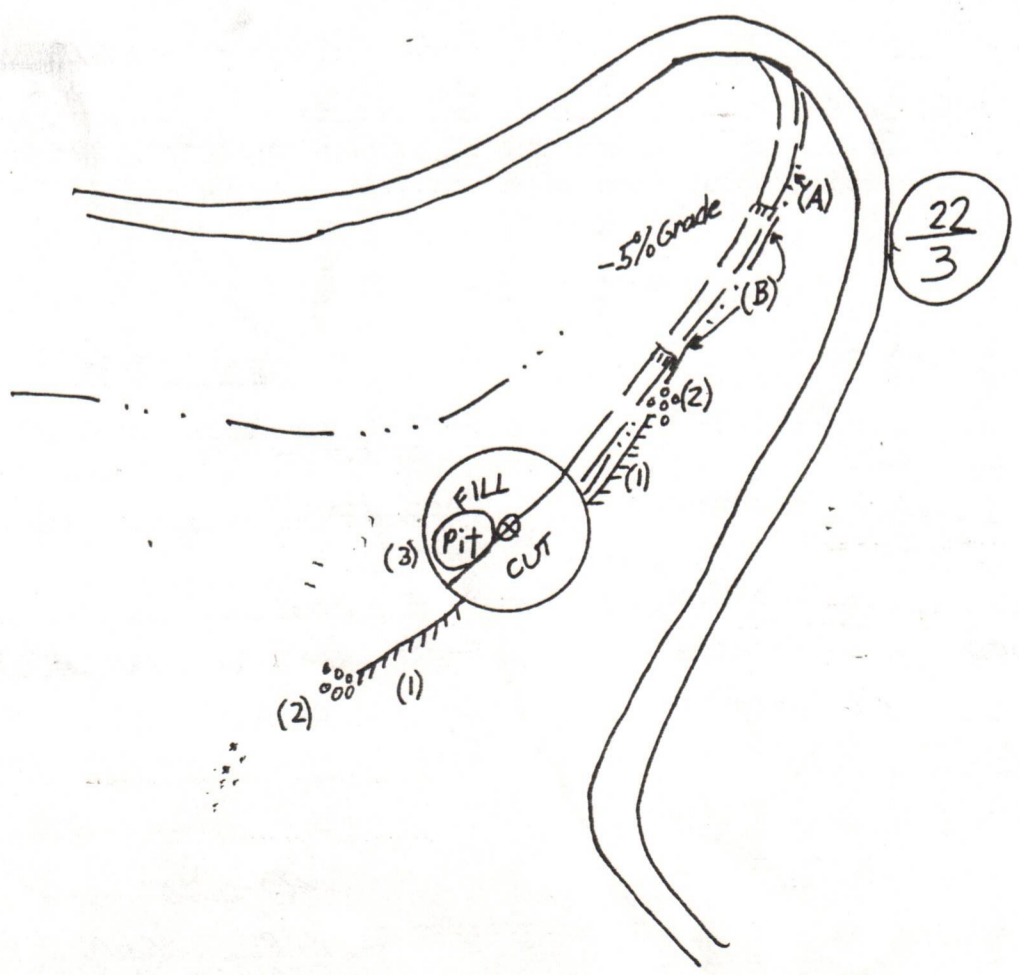

08/18/2023

STATE OF WEST VIRGINIA  
 DEPARTMENT OF MINES  
 OIL AND GAS DIVISION  
STATUS INSPECTION REQUEST  
INSPECTOR'S COMPLIANCE REPORT

**RECEIVED**  
 MAR 12 1985  
 OIL & GAS DIVISION  
 DEPT. OF MINES

Permit No. 47-085-6644

County. RITCHIE

Company. GENE STALNAKER INC

Farm. M. GRIMM

Inspector. SAMUEL HERSMAN

Well No. M. H. DAVIS 1-D

Date. 3-6-85

Issued. AUGUST 2-83

RULE	DESCRIPTION	IN COMPLIANCE	
		YES	NO
23.06	Notification Prior to starting Work	_____	_____
25.04	Prepared before Drilling to prevent Waste	_____	_____
25.03	High-Pressure Drilling	_____	_____
16.01	Required Permits at Wellsite	_____	_____
15.03	Adequate Fresh Water Casing	_____	_____
15.02	Adequate Coal Casing	_____	_____
15.01	Adequate Production Casing	_____	_____
15.04	Adequate Cement Strength	_____	_____
23.02	Maintained Access Roads	_____	_____
25.01	Necessary Equipment to prevent Waste	_____	_____
23.03	Reclaimed Drilling Site	_____	_____
23.04	Reclaimed Drilling Pits	_____	_____
23.05	No Surface or Underground Pollution	_____	_____
7.03	Identification Markings	_____	_____

COMMENTS: Cancelled on Expiration  
(No well drilled or location made)

I have inspected the above well and (Have/Have Not) found it to be in compliance with all of the rules and regulations of the Office of Oil and Gas-Department of Mines of the State of West Virginia.

SIGNED: Samuel M. Hersman

DATE: 3-6-85

08/18/2023



State of West Virginia

Department of Mines  
Oil and Gas Division

Charleston 25305

THEODORE M. STREIT  
ADMINISTRATOR

BARTON B. LAY, JR.  
DIRECTOR

March 13, 1985

Gene Stalnaker, Inc.  
P.O. Box 178  
Glennville, West Virginia 26351

In Re: Permit No: 47-085-6644  
Farm: M. Grimm  
Well No: M. H. Davis 1-D  
District: Union  
County: Ritchie  
Issued: 8-02-83

Gentlemen:

The FINAL INSPECTION REPORT for the above captioned well has been received in this office. Only the column checked below applies:

XXXXX The well designated by the above captioned permit number has been released under your Blanket Bond. (PERMIT CANCELLED - NEVER DRILLED)

Please return the enclosed cancelled single bond which covered the well designated by the above permit number to the surety company who executed said bond in your behalf, in order that they may give you credit on their records.

Your well record was received and reclamation requirements approved. In accordance with Chapter 22, Article 4, Section 2, the above captioned well will remain under bond coverage for life of the well.

Very truly yours,

Theodore M. Streit, Administrator  
Dept. Mines-Office of Oil & Gas

7-26-83

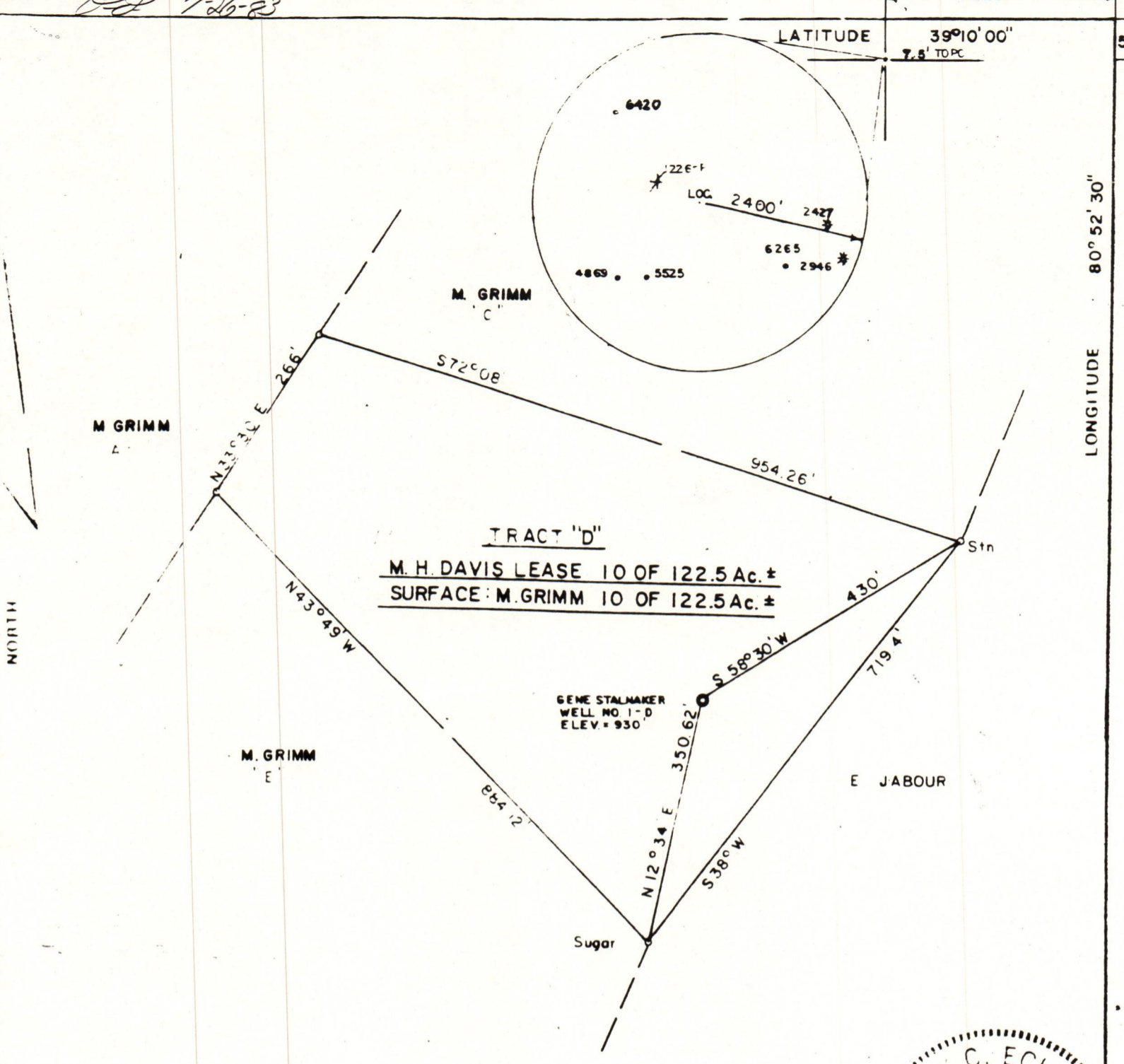

TRACT "D"  
 M. H. DAVIS LEASE 10 OF 122.5 Ac. ±  
 SURFACE: M. GRIMM 10 OF 122.5 Ac. ±

GENE STALAKER  
 WELL NO. 1-D  
 ELEV. = 930

FILE NO \_\_\_\_\_  
 DRAWING NO \_\_\_\_\_  
 SCALE 1" = 200'  
 MINIMUM DEGREE OF ACCURACY 1/200  
 PROVEN SOURCE OF ELEVATION INTERSECTION OF ROADS  
 2500' NW OF LOC. ELEV = 782'

I, THE UNDERSIGNED HEREBY CERTIFY THAT THIS PLAT IS CORRECT TO THE BEST OF MY KNOWLEDGE AND BELIEF AND SHOWS ALL THE INFORMATION REQUIRED BY LAW AND THE REGULATIONS ISSUED AND PRESCRIBED BY THE DEPARTMENT OF MINES

(SIGNED) Mark C. Echard  
 MARK C. ECHARD

RPE \_\_\_\_\_ LLS 490

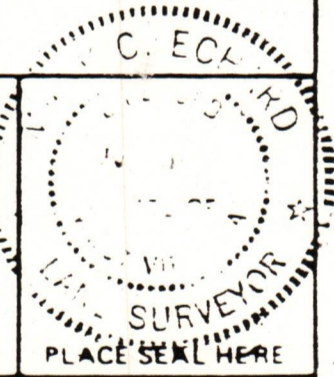

--- DENOTES LOCATION OF WELL ON UNITED STATES TOPOGRAPHIC MAPS

FORM IV-E (8-78)



DATE JUNE 6, 1983  
 OPERATOR'S WELL NO. ONE-D  
 API WELL NO. 47-085-6644  
 STATE WEST VIRGINIA COUNTY RITCHIE PERMIT 6644

STATE OF WEST VIRGINIA  
 DEPARTMENT OF MINES  
 OIL AND GAS DIVISION

WELL TYPE OIL  GAS  LIQUID INJECTION \_\_\_\_\_ WASTE DISPOSAL \_\_\_\_\_  
 (IF "GAS") PRODUCTION  STORAGE \_\_\_\_\_ DEEP \_\_\_\_\_ SHALLOW

LOCATION ELEVATION 930' WATER SHED SOUTH FORK HUGHES RIVER  
 DISTRICT UNION COUNTY RITCHIE  
 QUADRANGLE PULLMAN 7.5"

SURFACE OWNER M. GRIMM ACREAGE 10 OF 122.5 Ac ±  
 OIL & GAS ROYALTY OWNER M. H. DAVIS LEASE ACREAGE 10 OF 122.5 Ac ±  
 LEASE NO \_\_\_\_\_

PROPOSED WORK DRILL  CONVERT \_\_\_\_\_ DRILL DEEPER \_\_\_\_\_ REDRILL \_\_\_\_\_ FRACTURE OR STIMULATE \_\_\_\_\_ PLUG OFF OLD FORMATION \_\_\_\_\_ PERFORATE NEW FORMATION \_\_\_\_\_ OTHER PHYSICAL CHANGE IN WELL (SPECIFY) \_\_\_\_\_

08/18/2023

PLUG AND ABANDON \_\_\_\_\_ CLEAN OUT AND REPLUG \_\_\_\_\_  
 TARGET FORMATION ALEXANDER ESTIMATED DEPTH 5900'  
 WELL OPERATOR GENE STALAKER, INC. DESIGNATED AGENT GENE STALAKER, INC.  
 ADDRESS P.O. BOX 178-225 W. MAIN ST ADDRESS P.O. BOX 178-225 W. MAIN ST