

PROPOSED WORK ORDER

THIS IS AN ESTIMATE ONLY:
ACTUAL INFORMATION MUST BE SUBMITTED ON FORM IV-35 UPON COMPLETION

DRILLING CONTRACTOR (IF KNOWN) UNKNOWN

Address _____

GEOLOGICAL TARGET FORMATION, ELK

Estimated depth of completed well, 5050' feet Rotary x / Cable tools _____ /

Approximate water strata depths: Fresh, 150' feet; salt, 300' feet.

Approximate coal seam depths: 0' Is coal being mined in the area? Yes _____ / No x /

CASING AND TUBING PROGRAM

CASING OR TUBING TYPE	SPECIFICATIONS					FOOTAGE INTERVALS		CEMENT FILL-UP OR SACKS (Cubic feet)	PACKERS
	Size	Grade	Weight per ft	New	Used	For drilling	Left in well		
Conductor	11-3/4	cw	45#	x		45'	45'	40 sx	Kinds
Fresh Water	8-5/8	erw	23#	x		200'	200'	350 sx <u>CTS</u>	Baker
Coal									Sizes
Intermediate									
Production	4 1/2	erw	10.5#	x		0	5500'	700 sx	Depths set 4000'
Tubing	2-3/8	cw	4.7#	x		0	4000'	0	
Liners									Perforations: est. depth Top 3200' Bottom 5300'

NOTE: Regulation 7.02 of the Department of Mines provides that the original and four copies of Form IV-2 must be filed with the Department, accompanied by (i) a plat in the form prescribed by Regulation 11, (ii) a bond in one of the forms prescribed by Regulation 12, or in lieu thereof the other security allowed by Code § 22-4-2, (iii) Form IV-9, "Reclamation Plan", applicable to the reclamation required by Code § 22-4-12b and Regulation 23, (iv) unless previously paid on the same well, the fee required by Code § 22-4-12a, and (v) if applicable, the consent required by Code § 22-4-8a from the owner of any water well or dwelling within 200 feet of the proposed well.

A separate Form Iv-2 shall not be required for fracturing or stimulating a well where fracturing or stimulating is to be part of the work for which a permit is sought and is noted as such on the Form IV-2 filed in connection therewith.

THIS PERMIT MUST BE POSTED AT THE WELL SITE.
ALL PROVISIONS BEING IN ACCORDANCE WITH CHAPTER 22,
ARTICLE 4 OF THE W. VA. CODE, THE LOCATION IS HEREBY
APPROVED FOR drilling. THIS PERMIT SHALL EXPIRE
IF OPERATIONS HAVE NOT COMMENCED BY 1-19-83
BY [Signature]

The following waiver must be completed by the coal operator and by any coal owner or coal lessee who has recorded a declaration under Code 22-4-20, if the permit is to be issued within fifteen (15) days of receipt thereof.

WAIVER

The undersigned coal operator _____ / owner _____ / lessee _____ / of the coal under this well location 08/18/2023 has examined this proposed well location. If a mine map exists which covers the area of the well location, the well location has been added to the mine map. The undersigned has no objection to the work proposed to be done at this location, provided, the well operator has complied with all applicable requirements of the West Virginia Code and the governing regulations.

Date: _____, 19 _____

By _____
Its _____

V.M.S. 5/16/82

55 00

LATITUDE 39° 12' 30"

LONGITUDE 81° 00' 00"

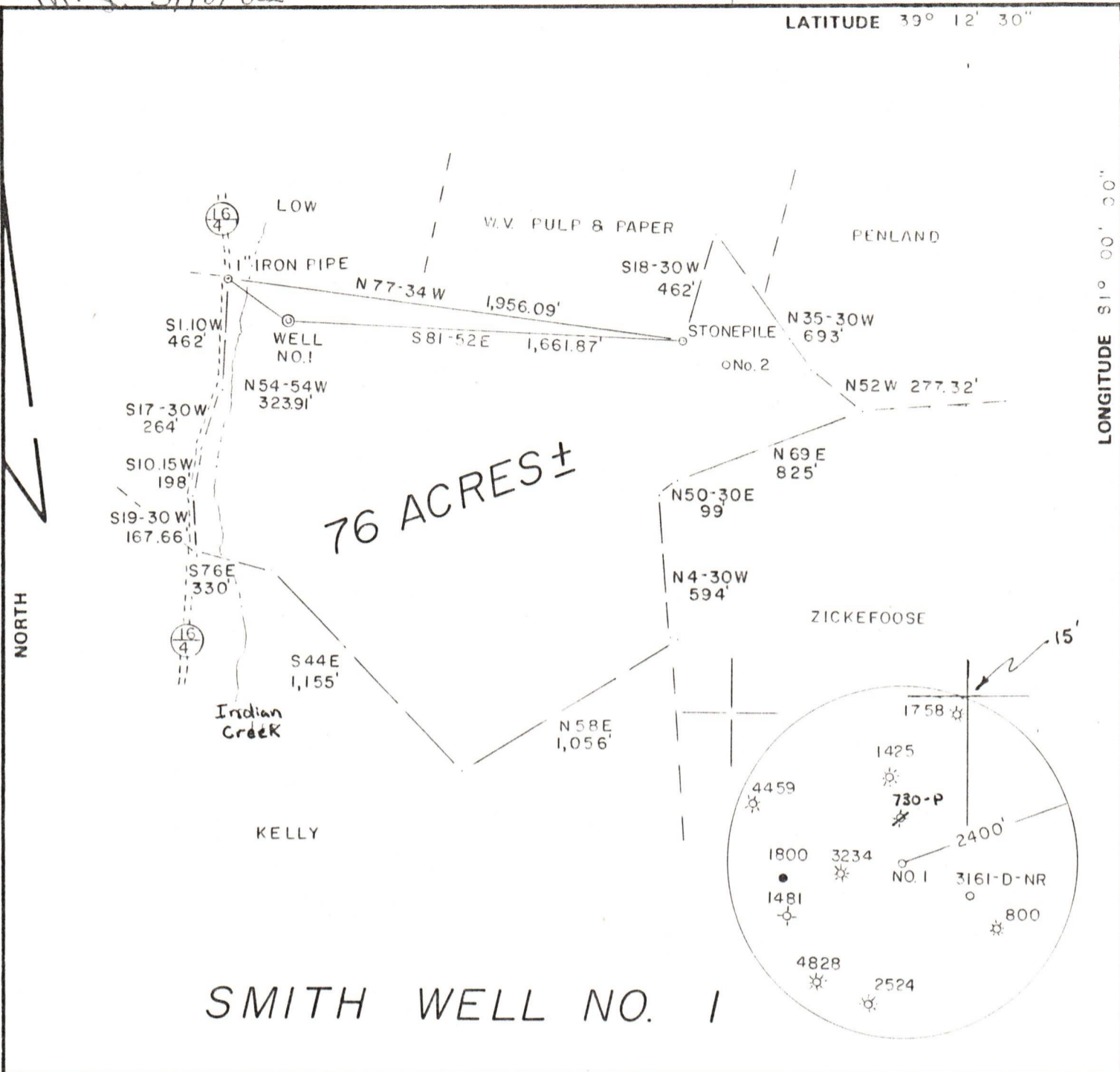

SMITH WELL NO. 1

FILE NO. 6-33
 DRAWING NO. _____
 SCALE 1" = 600'
 MINIMUM DEGREE OF ACCURACY 1/200
 PROVEN SOURCE OF ELEVATION JUNCTION OF ROADS ELEV. 844'

I THE UNDERSIGNED, HEREBY CERTIFY THAT THIS PLAT IS CORRECT TO THE BEST OF MY KNOWLEDGE AND BELIEF AND SHOWS ALL THE INFORMATION REQUIRED BY LAW AND THE REGULATIONS ISSUED AND PRESCRIBED BY THE DEPARTMENT OF MINES.
 (SIGNED) Gregory A. Smith
 R.P.E. _____ L.L.S. 677

PLACE SEAL HERE

(+) DENOTES LOCATION OF WELL ON UNITED STATES TOPOGRAPHIC MAPS
 FORM IV-6 (8-78)



STATE OF WEST VIRGINIA
 DEPARTMENT OF MINES
 OIL AND GAS DIVISION

DATE APRIL 21, 1982
 OPERATOR'S WELL NO. 1
 API WELL NO. 47-085-5624
 STATE COUNTY PERMIT

Cancelled

WELL TYPE: OIL GAS LIQUID INJECTION WASTE DISPOSAL
 (IF "GAS,") PRODUCTION STORAGE DEEP SHALLOW
 LOCATION: ELEVATION 850' WATER SHED INDIAN CREEK
 DISTRICT UNION COUNTY RITCHIE
 QUADRANGLE HARRISVILLE 7.5'
 SURFACE OWNER HELEN SMITH ACREAGE 76
 OIL & GAS ROYALTY OWNER HELEN SMITH, et al. LEASE ACREAGE 76 **08/18/2023**
 LEASE NO. _____
 PROPOSED WORK: DRILL CONVERT DRILL DEEPER REDRILL FRACTURE OR STIMULATE PLUG OFF OLD FORMATION PERFORATE NEW FORMATION OTHER PHYSICAL CHANGE IN WELL (SPECIFY) _____
 PLUG AND ABANDON CLEAN OUT AND REPLUG
 TARGET FORMATION ELK ESTIMATED DEPTH 5050'
 WELL OPERATOR RIMPOCK PRODUCTION CO. DESIGNATED AGENT ROBERT MURDOCK
 ADDRESS 4424-A EMERSON AVE. ADDRESS 4424-A EMERSON AVE.
PARKEPSBURG, W.V. 26101 PARKEPSBURG, W.V. 26101

ATTACH OR PHOTOCOOPY SECTION OF
INVOLVED TOPOGRAPHIC MAP.
QUADRANGLE HARRISVILLE 7.5'

LEGEND













Well Site 

Access Road 

WELL SITE PLAN

Sketch to include well location, existing access road, roads to be constructed, wellsite, drilling pits and necessary structures numbered or lettered to correspond with the first part of this plan. Include all natural drainage.

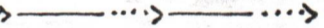
LEGEND

Property boundary 	Diversion 
Road 	Spring 
Existing fence 	Wet spot 
Planned fence 	Building 
Stream 	Drain pipe 
Open ditch 	Waterway 

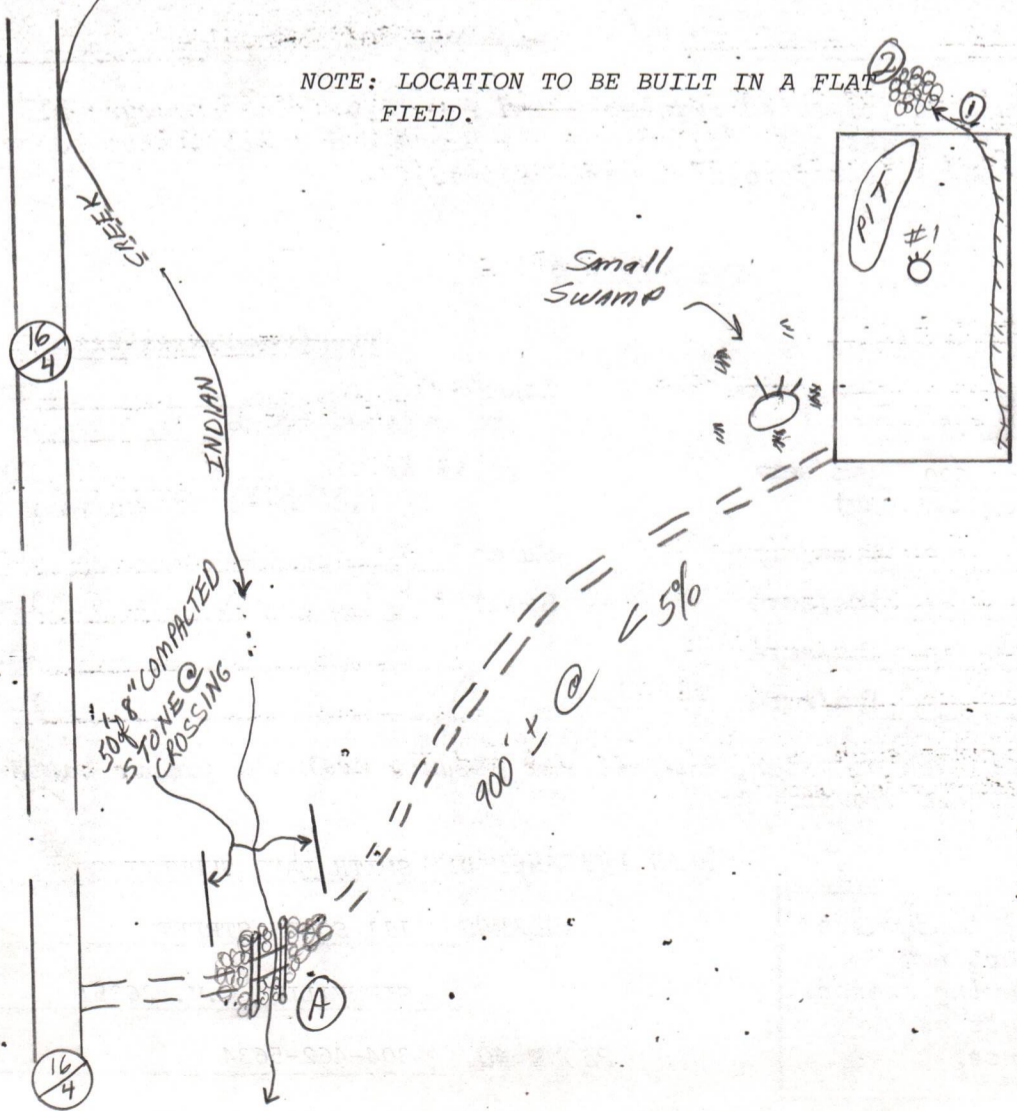

08/18/2023



DATE APRIL 24 1982

WELL NO. 1

State of West Virginia

API NO. 47-085-5624

Department of Mines
Oil and Gas Division

CONSTRUCTION AND RECLAMATION PLAN

COMPANY NAME RIMROCK PRODUCTION CORP.

DESIGNATED AGENT ROBERT MURDOCK

Address 4424A EMERSON AVE. PARKERSBURG, W.V. 26101 Address 4424A EMERSON AVE. PARKERSBURG W.V.

Telephone 304-428-1520

Telephone 304-428-1520

LANDOWNER HELEN SMITH

SOIL CONS. DISTRICT LITTLE KANAWHA

Revegetation to be carried out by RIMROCK PRODUCTION CORP. (Agent)

This plan has been reviewed by Little Kanawha SCD. All corrections and additions become a part of this plan: 5-6-82

(Date)

Jarrett Newton
(SCD Agent)

ACCESS ROAD

LOCATION

Structure TEMPORARY STREAM CROSSING (A)

Structure DIVERSION DITCH (1)

Spacing TWO 24" CULVERTS

Material EARTHEN

Page Ref. Manual I:18

Page Ref. Manual I:9

Structure _____ (B)

Structure SEDIMENT BARRIER (2)

Spacing _____

Material BRUSH OR STONE

Page Ref. Manual _____

Page Ref. Manual I:15

Structure _____ (C)

Structure _____ (3)

Spacing _____

Material _____

Page Ref. Manual _____

Page Ref. Manual _____

All structures should be inspected regularly and repaired if necessary. All commercial timber is to be cut and stacked and all brush and small timber to be cut and removed from the site before dirt work begins.

REVEGETATION

Treatment Area I & II

Treatment Area III

Lime _____ Tons/acre
or correct to pH 6.5

Lime _____ Tons/acre
or correct to pH _____

Fertilizer 600 lbs/acre
(10-20-20 or equivalent)

Fertilizer _____ lbs/acre
(10-20-20 or equivalent)

Mulch HAY 2 Tons/acre

Mulch _____ Tons/acre

Seed* KY-31 35 lbs/acre

Seed* _____ lbs/acre

CROWN VETCH 10 lbs/acre

_____ lbs/acre

_____ lbs/acre

_____ lbs/acre

*Inoculate all legumes such as vetch, trefoil and clovers with the proper bacterium. Inoculate with 3X recommended amount.

08/18/2023

PLAN PREPARED BY SMITH LAND SURVEYING

ADDRESS 111 SOUTH STREET

GLENVILLE, W.V. 26351

PHONE NO. 304-462-5634

NOTES: Please request landowners' cooperation to protect new seedling for one growing season. Attach separate sheets as necessary for comments.

RECEIVED

MAY 13 1902

OIL AND GAS DIVISION
WV DEPARTMENT OF MINES

08/18/2023

STATE OF WEST VIRGINIA

OFFICE OF OIL AND GAS

NOTICE OF EXPIRED PERMIT

Permit number: 47- 85-5624 County: RITCHIE
Company: RIMROCK PROD COMPANY Farm: HELEN SMITH #1
Date: 27-Nov-84 Well no.:
Date issued: 5/19/82 Date expired: / / 0

I have inspected the above wellsite and found no well work done. Please
cancel this well work permit.

Signed: *Samuel N. Hersman*

Date: 1-3-85

RECEIVED
JAN 8 - 1985
OIL & GAS DIVISION
DEPT. OF MINES

08/18/2023



State of West Virginia

Department of Mines
Oil and Gas Division
Charleston 25305
January 23, 1985

THEODORE M. STREIT
ADMINISTRATOR

BARTON B. LAY, JR.
DEPUTY DIRECTOR

Rimrock Production Corporation
4424-A Emerson Avenue
Parkersburg, WVa. 26101
Attn: Robert Murdock;

In Re: Permit No: 085-5624
Farm: Helen Smith etal.
Well No: One
District: Union
County: Ritchie
Issued: 5/19/82

Gentlemen:

The FINAL INSPECTION REPORT for the above captioned well has been received in this office. Only the column checked below applies:

The well designated by the above captioned permit number has been released XXXXX under your Blanket Bond. (PERMIT CANCELLED - NEVER DRILLED)

Please return the enclosed cancelled single bond which covered the well designated by the above permit number to the surety company who executed said bond in your behalf, in order that they may give you credit on their records.

Your well record was received and reclamation requirements approved. In accordance with Chapter 22, Article 4, Section 2, the above captioned well will remain under bond coverage for life of the well.

Very truly yours,

Theodore M. Streit, Administrator
Dept. Mines-Office of Oil & Gas

TMS/ chm

08/18/2023