

# GAS RIGHT DEED 28 LEASE 14,650 ACRES± WELL NO. WV 512935

BOTTOM HOLE  
WELL NO.  
WV 512935

**BOTTOM HOLE  
WELL NO. WV 512935  
STATE PLANE COORDINATES  
(SOUTH ZONE)**

N. 629,295  
E. 2,250,008

LAT=(N) 38.70846  
LONG=(W) 80.12390

UTM, NAD83

N. 4,284,802  
E. 576,192

LEASE # 190028

**WELL NO. WV 512935  
STATE PLANE COORDINATES  
(SOUTH ZONE)**

N. 613,840  
E. 2,253,264

LAT=(N) 38.68242  
LONG=(W) 80.11280

UTM, NAD83

N. 4,281,921  
E. 577,184

COASTAL FOREST  
RESOURCES  
12,070.039 ACRES±

PENN VIRGINIA  
OPERATING CO. LLC  
9743.586 ACRES±

WELL NO.  
WV 512935

## REFERENCES

### NOTES ON SURVEY

1. TIES TO WELLS AND CORNERS ARE BASED ON GRID NORTH FOR THE WV STATE PLANE COORDINATE SYSTEM SOUTH ZONE NAD '27.
2. TIES TO REFERENCES ARE BASED ON MAGNETIC NORTH 05/14/10.
3. LEASE BOUNDARY SHOWN HEREON TAKEN FROM DEED BOOK 241 PAGE 40B.
4. SURFACE OWNER AND ADJOINER INFORMATION TAKEN FROM THE ASSESSOR AND COUNTY CLERK RECORDS OF RANDOLPH COUNTY IN JULY, 2010.
5. WELL LAT./LONG. (NAD'27) ESTABLISHED BY DGPS(SUBMETER MAPPING GRADE).



WELL NO.  
WV 512935

THERE APPEAR TO BE  
NO KNOWN PERMITTED  
WELLS WITHIN 3,000'.

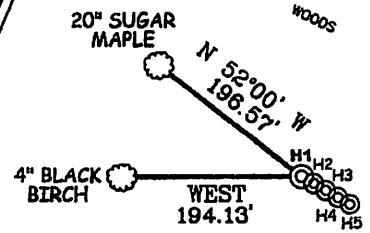

ADO 96 WELLS  
**H1-WV 512935**  
 H2-WV 512936  
 H3-WV 513401  
 H4-WV 513402  
 H5-WV 513403

(+) DENOTES LOCATION OF WELL ON UNITED STATES TOPOGRAPHIC MAPS.

DATE AUGUST 12, 20 10

OPERATORS WELL NO. WV 512935

API WELL NO. 47 - 083 - 012299  
 STATE COUNTY PERMIT

I THE UNDERSIGNED, HEREBY CERTIFY THAT THIS PLAT IS CORRECT TO THE BEST OF MY KNOWLEDGE AND BELIEF AND SHOWS ALL THE INFORMATION REQUIRED BY LAW AND THE REGULATIONS ISSUED AND PRESCRIBED BY THE DIVISION OF ENVIRONMENTAL PROTECTION.

P.S. 677

*Gregory A. Smith*

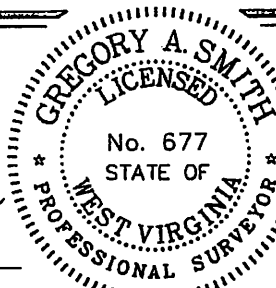

MINIMUM DEGREE OF ACCURACY 1/2500 FILE NO. 6985P512935R (296-44)  
 PROVEN SOURCE OF ELEVATION DGPS (SUBMETER MAPPING GRADE) SCALE 1" = 2000'

STATE OF WEST VIRGINIA  
 DIVISION OF ENVIRONMENTAL PROTECTION  
 OFFICE OF OIL AND GAS



WELL TYPE: OIL  GAS  INJECTION  WASTE DISPOSAL  IF "GAS" PRODUCTION  STORAGE  DEEP  SHALLOW

LOCATION: ELEVATION 3,420' WATERSHED BEAR RUN AND LICK RUN OF BEECH RUN

DISTRICT MIDDLE FORK COUNTY RANDOLPH QUADRANGLE ADOLPH 7.5'

SURFACE OWNER COASTAL FOREST RESOURCES ACREAGE 12,070.04±

ROYALTY OWNER EQT PRODUCTION COMPANY LEASE ACREAGE 14,650±

PROPOSED WORK: LEASE NO. 190028

DRILL  CONVERT  DRILL DEEPER  REDRILL  FRACTURE OR STIMULATE  PLUG OFF OLD   
 FORMATION  PERFORATE NEW FORMATION  PLUG AND ABANDON  CLEAN OUT AND REPLUG  OTHER

PHYSICAL CHANGE IN WELL (SPECIFY) \_\_\_\_\_ TARGET FORMATION MARCELLUS  
 ESTIMATED DEPTH \_\_\_\_\_

WELL OPERATOR EQT PRODUCTION COMPANY DESIGNATED AGENT REX C. RAY  
 ADDRESS 1710 PENNSYLVANIA AVENUE ADDRESS 1710 PENNSYLVANIA AVENUE  
CHARLESTON, WV 25302 CHARLESTON, WV 25302

# GAS RIGHT DEED 28 LEASE WELL NO. WV 512935

**PROPOSED  
GAS WELL  
NO. WV 512935**

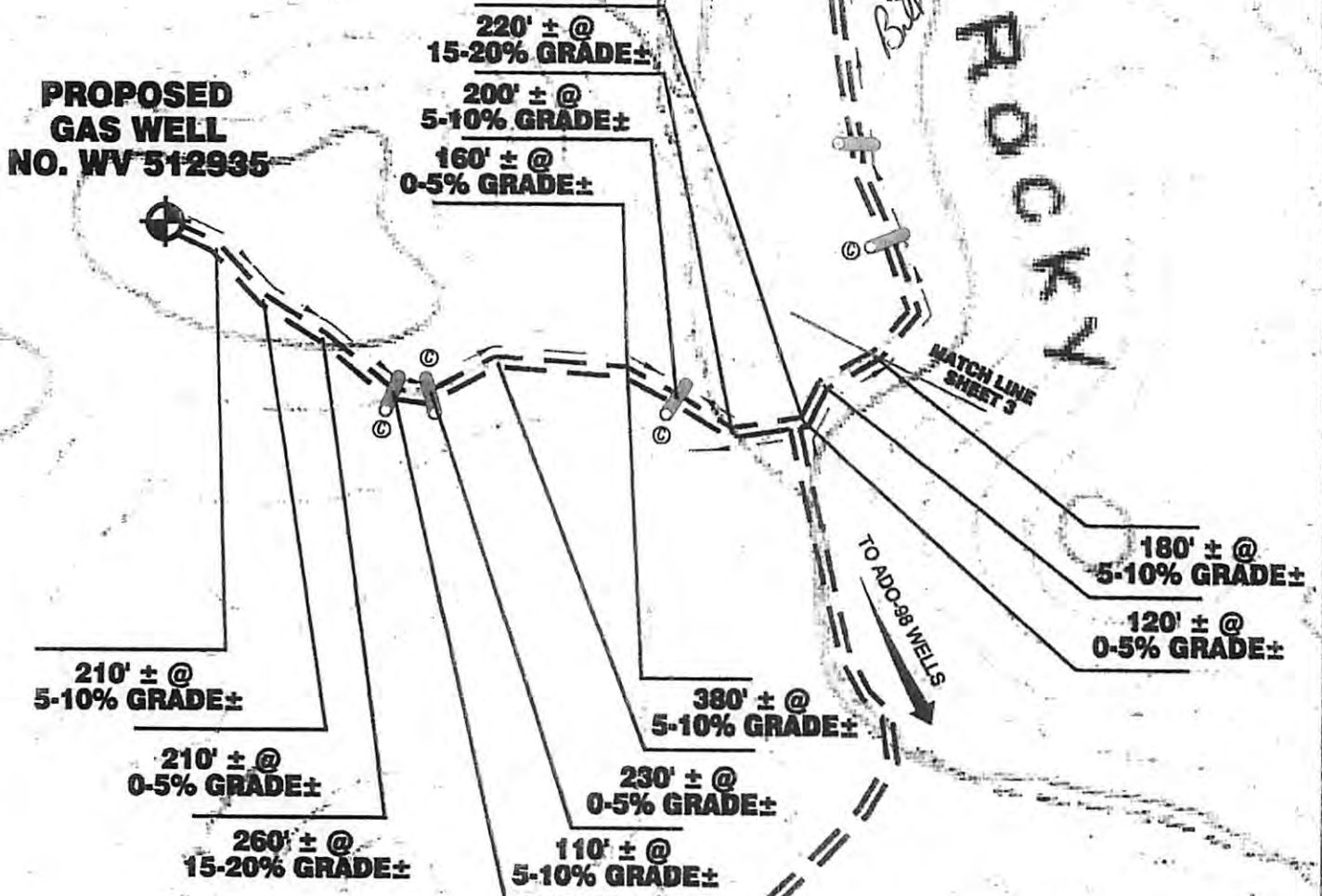

**RECEIVED**  
Office of Oil & Gas

OCT 25 2012

WV Department of  
Environmental Protection

Detail Sketch for Proposed Well WV 512935

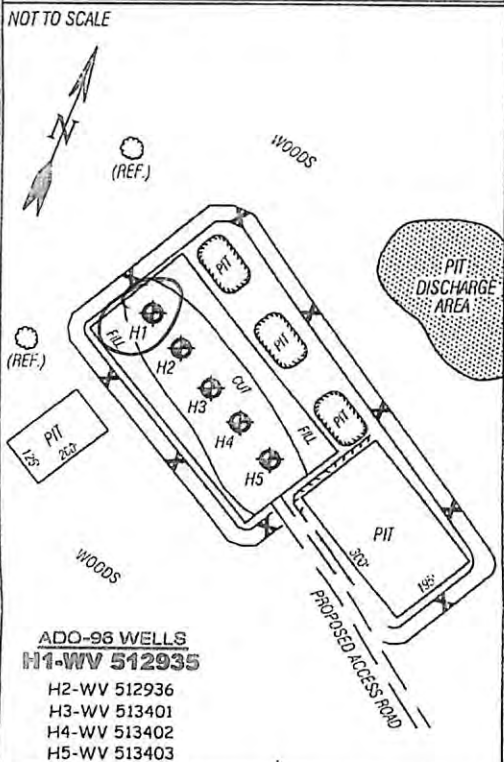

**SCALE: 1"=500'**



TOPO SECTION OF  
USGS ADOLPH 7.5' QUADRANGLE

PROPOSED CULVERT INVENTORY  
(FOR BID PURPOSES ONLY)

12" (MINIMUM) CULVERTS	16 CUL.
15" (MINIMUM) CULVERTS	

ADDITIONAL CULVERTS AND/OR OTHER DRAINAGE STRUCTURES & SEDIMENT CONTROL DEVICES MAY BE REQUIRED BY THE WV D.E.P. OIL & GAS INSPECTOR. OPERATOR IS RESPONSIBLE FOR COORDINATION WITH CONTRACTOR AND SLS REGARDING ANY CHANGES OR ADDITIONS THE STATE MAY REQUIRE.

Projected Earthen Disturbance Area

Well Location Site	5.00 ac. +/-
Access Road	6.80 ac. +/-
Approximate Total Disturbance	11.80 ac. +/-

ALL ROADS SHOWN HEREON ARE EXISTING UNLESS OTHERWISE NOTED AND SHALL BE MAINTAINED IN ACCORDANCE WITH WV D.E.P. OIL AND GAS BMP MANUAL ENTRANCES AT COUNTY/STATE ROADS SHALL BE MAINTAINED IN ACCORDANCE WITH WV D.O.T. REGULATION. SEPARATE PERMITS MAY BE REQUIRED BY THE D.O.T.

SEDIMENT BASINS (TRAPS) AND APPROPRIATE EROSION CONTROL BARRIERS ARE TO BE CONSTRUCTED AT ALL CULVERT AND CROSS DRAIN INLETS AND OUTLETS AS REQUIRED IN THE WV D.E.P. OIL AND GAS BMP MANUAL. FIELD CONDITIONS (ROCK OUTCROPS AND BEDROCK) MAY PROHIBIT INLET TRAPS BEING INSTALLED. WHEN THESE CONDITIONS EXIST ADDITIONAL EROSION CONTROL MEASURES SHALL BE EVALUATED AND UTILIZED AS NEEDED.

EARTHWORK CONTRACTORS ARE RESPONSIBLE FOR NOTIFICATION TO THE OPERATOR AND INSPECTOR PRIOR TO ANY DEVIATION FROM THIS PLAN.

TEMPORARY SEED & MULCH ALL SLOPES AFTER CONSTRUCTION OF LOCATION.

CUT & STACK ALL MARKETABLE TIMBER.

STACKED BRUSH MAY BE USED FOR SEDIMENT CONTROL.

APPLICATIONS FOR SEPARATE PLC PERMITS ON THE ACCESS ROAD STREAM CROSSINGS HAVE BEEN PREPARED (IF APPLIES).

- = EXISTING CULVERT
- = PROPOSED CULVERT 12" MIN. UNLESS OTHERWISE NOTED
- = PROPOSED STREAM CROSSING (IF APPLIES) \*SEE TABLE FOR CULVERT DETAIL
- = CONSTRUCT BROAD BASED DIP

**SLS**  
SMITH LAND SURVEYING, INC.  
P.O. BOX 150 GLENVILLE, WV. 26351  
PH: (304) 462-5634 FAX: (304) 462-5656 E-MAIL: sls@tol.net

DRAWN BY K.E.S.	FILE NO. 6985	DATE 05/24/10	CADD FILE: 6985RECWS12935.DWG
--------------------	------------------	------------------	----------------------------------