

LATITUDE 38° 40' 00"

CODE CARD PLOT

U.S. OF A. NATIONAL FOREST SERVICE OWNS SURFACE NORTH & EAST OF U.S. 250 MOWER LUMBER CO. OWNS MINERALS.

National Forest Service Tract 51-H 4796.8 acres D.B. Ref. 142/251

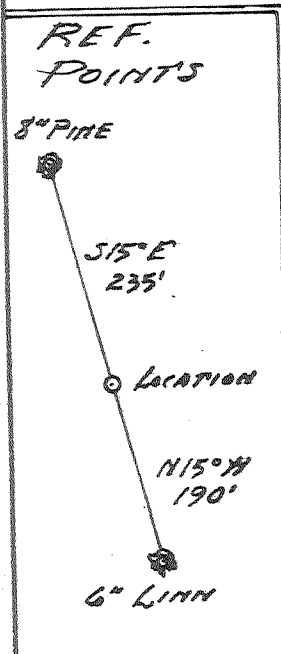

MOWER LUMBER CO. OWNS SURFACE & MINERALS SOUTH & WEST OF U.S. 250

LOCATION 7-1869

2095 307w

083-0610-P FOR SHAYERS

B.M. IN ROCK N. SIDE R.R. TRACK EL. 3555

7000 7.5

2095 092w

FILE NO. UDI 3-12

DRAWING NO. 83-7

SCALE 1" = 2000'

MINIMUM DEGREE OF ACCURACY 1 IN 200

PROVEN SOURCE OF ELEVATION B.M. IN ROCK, S. SIDE U.S. 250 - ON PLAT EL. 3632

I THE UNDERSIGNED, HEREBY CERTIFY THAT THIS PLAT IS CORRECT TO THE BEST OF MY KNOWLEDGE AND BELIEF AND SHOWS ALL THE INFORMATION REQUIRED BY LAW AND THE REGULATIONS ISSUED AND PRESCRIBED BY THE DEPARTMENT OF MINES.

(SIGNED) Thomas F. Weaver, Jr.

R.P.E. \_\_\_\_\_ L.L.S. 410

PLACE SEAL HERE

STATE OF WEST VIRGINIA DEPARTMENT OF MINES OIL AND GAS DIVISION



DATE MARCH 4, 1983

OPERATOR'S WELL NO. 7-1869

API WELL NO. 47-083-1033

STATE 47 COUNTY 083 PERMIT 1033

(+) DENOTES LOCATION OF WELL ON UNITED STATES TOPOGRAPHIC MAPS

WELL TYPE: OIL \_\_\_ GAS  LIQUID INJECTION \_\_\_ WASTE DISPOSAL \_\_\_

(IF "GAS,") PRODUCTION  STORAGE \_\_\_ DEEP  SHALLOW \_\_\_

LOCATION: ELEVATION 3750 WATER SHED STONECOAL RUN OF SHAYERS FORK

DISTRICT HUTTONSVILLE 3 COUNTY RANDOLPH

QUADRANGLE MILL CREEK 473 Durbin 055 CS

SURFACE OWNER U.S. OF A. NATIONAL FOREST SERVICE ACREAGE 43,305.73

OIL & GAS ROYALTY OWNER MOWER LUMBER CO. LEASE ACREAGE 43,305.73

LEASE NO. 1508

PROPOSED WORK: DRILL  CONVERT \_\_\_ DRILL DEEPER \_\_\_ REDRILL \_\_\_ FRACTURE OR STIMULATE  PLUG OFF OLD FORMATION \_\_\_ PERFORATE NEW FORMATION \_\_\_ OTHER PHYSICAL CHANGE IN WELL (SPECIFY) \_\_\_\_\_

PLUG AND ABANDON \_\_\_ CLEAN OUT AND REPLUG \_\_\_ 6.6 Shavers Fork (369) APR 29 1985

TARGET FORMATION ORISKANY ESTIMATED DEPTH 8000'

WELL OPERATOR UNION DRILLING, INC. DESIGNATED AGENT JOSEPH C. PETTEY

ADDRESS P.O. DRAWER 40 893 ADDRESS P.O. DRAWER 40 BUCKHANNON, W.VA. 26201

DS & PWS

RECEIVED  
JUN 10 1987



W. VA. OIL & GAS  
CONSERVATION COMMISSION

State of West Virginia  
Department of Mines  
Oil and Gas Division

Date June 8, 1987  
Operator's  
Well No. 7 - 1869  
Farm Mower Lumber Co. #7  
API No. 47 - 083 - 1033

TO BE HELD CONFIDENTIAL

WELL OPERATOR'S REPORT  
OF  
DRILLING, FRACTURING AND/OR STIMULATING, OR PHYSICAL CHANGE

WELL TYPE: Oil \_\_\_ / Gas X / Liquid Injection \_\_\_ / Waste Disposal \_\_\_ /  
(If "Gas," Production \_\_\_ / Underground Storage \_\_\_ / Deep XXX / Shallow \_\_\_ /)

LOCATION: Elevation: 3750' Watershed Stonecoal Run of Shavers Fork  
District: Huttonsville County Randolph Quadrangle Mill Creek

COMPANY Union Drilling, Inc.  
ADDRESS P.O. Drawer 40, Buckhannon, WV 26201  
DESIGNATED AGENT Joseph C. Pettey  
ADDRESS P.O. Drawer 40, Buckhannon, WV 26201  
SURFACE OWNER USA National Forest Service  
ADDRESS P.O. Box 67, Bartow, WV 24920  
MINERAL RIGHTS OWNER Mower Limited Partnership  
ADDRESS P.O. Box 27, Durbin, WV 26264  
OIL AND GAS INSPECTOR FOR THIS WORK \_\_\_\_\_  
Phil Tracy ADDRESS P.O. Box 2536, ELkins, WV 26241  
PERMIT ISSUED 4/22/85  
DRILLING COMMENCED 10/24/86  
DRILLING COMPLETED 11/16/86

Casing Tubing	Used in Drilling	Left in Well	Cement fill up Cu. ft.
Size 20-16 Cord.			
13-10"	38.00	38.00	
9 5/8	1831.80'	1831.80'	708 cf
8 5/8			
7			
5 1/2		8589.68'	759 cf
4 1/2			
3			
2 3/8"		8333.00'	
Liners used			

IF APPLICABLE: PLUGGING OF DRY HOLE ON  
CONTINUOUS PROGRESSION FROM DRILLING OR  
REWORKING. VERBAL PERMISSION OBTAINED  
ON \_\_\_\_\_

GEOLOGICAL TARGET FORMATION Oriskany Depth 8000' feet  
Depth of completed well 8610' feet Rotary XXX / Cable Tools \_\_\_\_\_  
Water strata depth: Fresh none feet; Salt none feet  
Coal seam depths: none Is coal being mined in the area? no

OPEN FLOW DATA  
Producing formation Oriskany Pay zone depth 8391/8439 feet  
Gas: Initial open flow 117 Mcf/d Oil: Initial open flow \_\_\_\_\_ Bbl/d  
Final open flow 1,300 Mcf/d Final open flow \_\_\_\_\_ Bbl/d  
Time of open flow between initial and final tests 2 hrs hours  
Static rock pressure 2850# psig (surface measurement) after \_\_\_\_\_ hours shut in  
(If applicable due to multiple completion--)  
Second producing formation \_\_\_\_\_ Pay zone depth \_\_\_\_\_ feet  
Gas: Initial open flow \_\_\_\_\_ Mcf/d Oil: Initial open flow \_\_\_\_\_ Bbl/d  
Final open flow \_\_\_\_\_ Mcf/d Oil: Final open flow \_\_\_\_\_ Bbl/d  
Time of open flow between initial and final tests \_\_\_\_\_ hours  
Static rock pressure \_\_\_\_\_ psig (surface measurement) after \_\_\_\_\_ hours shut in

DETAILS OF PERFORATED INTERVALS, FRACTURING OR STIMULATING, PHYSICAL CHANGE, ETC.

Halliburton - 1 stage Frac - 3/6/87

8391, 8392, 8407, 8408, 8409, 8410, 8411, 8412, 8414, 8422, 8424, 8425, 8426, 8432, 8433, 8434  
8435, 8436, 8437, 8438, 8439

Oriskany - 227,000# sand, 2485 gals fluid and 30 ton CO2

WELL LOG

FORMATION	COLOR	HARD OR SOFT	TOP FEET	BOTTOM FEET	REMARKS
					Including indication of all fresh and salt water, coal, oil and gas
Sand & Shale			0	1236	
Little Lime			1236	1260	
Big Lime			1345	1566	
Injun			1566	1762	
Lower Bayard			2488	2524	
Elizabeth			2590	2662	
Warren			2748	2792	
Speechly			2918	3009	
Balltown			3196	3206	
Bradford			3394	3429	
Riley			3740	3776	
Benson			3906	3949	
Benson Stray			4027	4124	
Alexander			4502	4510	
Lower Alexander			4724	4747	
Elk			4964	5056	
Sycamore 443			6794	6904	
Harrell Shale 438			7620	7798	
Tully Limestone 848			7798	7810	
Purcell 859			8015	8045	
Onondaga 461			8058	8092	
Huntersville Chert 463			8092	8241	
Needmore Shale 465			8241	8261	
Oriskany 475			8261	8446	
Helderberg 485			8446	8610	TD Gas Check @TD 117 mcf

(Attach separate sheets as necessary)

Union Drilling, Inc.

Well Operator

By: Joseph P. Sletten  
Date: Vice President of Production

6/8/87

Note: Regulation 2.02(i) provides as follows:  
"The term 'log' or 'well log' shall mean a systematic detailed geological record of all formations, including etc ..., encountered in the drilling of a well."

NOV 16 1988



1) Date: June 26, 19 84  
 2) Operator's Well No. 1869  
 3) API Well No. 47 083-1033  
 State County Permit

\*\*\* TO BE HELD CONFIDENTIAL \*\*\*

STATE OF WEST VIRGINIA  
 DEPARTMENT OF MINES, OIL AND GAS DIVISION  
 APPLICATION FOR A WELL WORK PERMIT

- 4) WELL TYPE: A Oil        / Gas XX /  
 B (If "Gas", Production XX / Underground storage        / Deep XX / Shallow       )
- 5) LOCATION: Elevation: 3750 Watershed: Stonecoal Run of Shavers Fork  
 District: Huttonsville County: Randolph Quadrangle: Mill Creek
- 6) WELL OPERATOR Union Drilling, Inc. 50550 7) DESIGNATED AGENT Joseph C. Vanzant, Jr.  
 Address Post Office Drawer 40 Address Post Office Drawer 40  
Buckhannon, WV 26201 Buckhannon, WV 26201
- 8) OIL & GAS INSPECTOR TO BE NOTIFIED 9) DRILLING CONTRACTOR:  
 Name Phillip Tracy Name Union Drilling, Inc.  
 Address Forest Festival Terrace #24 Address Post Office Drawer 40  
Elkins, WV 26241 Buckhannon, WV 26201
- 10) PROPOSED WELL WORK: Drill XX / Drill deeper        / Redrill        / Stimulate XX /  
 Plug off old formation        / Perforate new formation        /  
 Other physical change in well (specify)
- 11) GEOLOGICAL TARGET FORMATION, Oriskany
- 12) Estimated depth of completed well, 8000 feet  
 13) Approximate trata depths: Fresh, ? feet; salt, ? feet.  
 14) Approximate coal seam depths: ? Is coal being mined in the area? Yes        / No XX /

15) CASING AND TUBING PROGRAM

CASING OR TUBING TYPE	SPECIFICATIONS				FOOTAGE INTERVALS		CEMENT FILL-UP OR SACKS (Cubic feet)	PACKERS
	Size	Grade	Weight per ft.	New	Used	For drilling		
Conductor	13-3/8			X		40'	40'	Kinds
Fresh water								
Coal								Sizes
Intermediate	9-5/8			X		1500'	1500'	to surface by rule 15.05
Production	5-1/2			X		8000'	8000'	as required by rule 15.01
Tubing								Perforations:
Liners								Top Bottom

OFFICE USE ONLY  
 DRILLING PERMIT

Permit number 47-083-1033 Date April 22 19 85

This permit covering the well operator and well location shown below is evidence of permission granted to drill in accordance with the pertinent legal requirements subject to the conditions contained herein and on the reverse hereof. Notification must be given to the District Oil and Gas Inspector, (Refer to No. 8) Prior to the construction of roads, locations and pits for any permitted work. In addition, the well operator or his contractor shall notify the proper district oil and gas inspector 24 hours before actual permitted work has commenced.)

The permitted work is as described in the Notice and Application, plat, and reclamation plan, subject to any modifications and conditions specified on the reverse hereof. April 22 1987

Permit expires        unless well work is commenced prior to that date and prosecuted with due diligence.

Bond:	Agent:	Plat:	Casing	Fee
<u>162</u>	<u>SW</u>	<u>MH</u>	<u>MH</u>	<u>29489</u>

Margaret J. Hase  
 Administrator, Office of Oil and Gas

NOTE: Keep one copy of this permit posted at the drilling location.

See the reverse side of the APPLICANT'S COPY for instructions to the well operator.

File