

[08-78]

OIL AND GAS WELL PERMIT APPLICATION

Operator's Well No. Mc Neal #1

API Well No. #7 - 083 - 0433  
State County Permi

WELL TYPE: Oil  / Gas  /  
(If "Gas", Production  / Underground storage  / Deep  / Shallow  /)

LOCATION: Elevation: 2326' Watershed: Left Fork  
District: Middle Fork County: Randolph Quadrangle: Pickens

WELL OPERATOR Seneca-Upshur Petroleum, Inc.  
Address P. O. Drawer "P"  
Buckhannon, West Virginia 26201

DESIGNATED AGENT Seneca-Upshur Petroleum, Inc.  
Address P. O. Drawer "P"  
Buckhannon, West Virginia 26201

OIL & GAS ROYALTY OWNER Wilbur McNeal  
Address Helvetia  
West Virginia 26224

COAL OPERATOR NONE  
Address \_\_\_\_\_

ACREAGE 80.0  
SURFACE OWNER Wilbur McNeal  
Address Helvetia  
West Virginia 26224  
ACREAGE 80.0

COAL OWNER(S) WITH DECLARATION ON RECORD:  
Name Same  
Address \_\_\_\_\_  
**RECEIVED**  
MAR 12 1981

FIELD SALE (IF MADE) TO:  
Name \_\_\_\_\_  
Address \_\_\_\_\_

Name \_\_\_\_\_  
Address OIL & GAS DIVISION  
DEPT. OF MINES

OIL & GAS INSPECTOR TO BE NOTIFIED  
Name Robert Stewart  
Address Jane Lew, West Virginia  
884-7782

COAL LESSEE WITH DECLARATION ON RECORD:  
Name None  
Address \_\_\_\_\_

The undersigned well operator is entitled to operate for oil or gas purposes at the above location under a deed  / lease  / other contract  / dated Feb 19, 1981, to the undersigned well operator from \_\_\_\_\_

[If said deed, lease, or other contract has been recorded:]  
Recorded on 3-11, 1981, in the office of the Clerk of the County Commission of Randolph County, West Virginia, in \_\_\_\_\_ Book \_\_\_\_\_ at page \_\_\_\_\_. A permit is requested as follows:

PROPOSED WORK: Drill  / Drill deeper  / Redrill  / Fracture or stimulate  /  
Plug off old formation  / Perforate new formation  /  
Other physical change in well (specify) \_\_\_\_\_

--planned as shown on the work order on the reverse side hereof.

The above named coal operator, coal owner(s), and coal lessee are hereby notified that any objection they wish to make or are required to make by Code § 22-4-3 must be filed with the Department of Mines within fifteen (15) days after the receipt of this Application by the Department.

Copies of this Permit Application and the enclosed plat and reclamation plan have been mailed by registered mail or delivered by hand to the above named coal operator, coal owner(s), and coal lessee on or before the day of the mailing or delivery of this Permit Application to the Department of Mines at Charleston, West Virginia.

03/15/2024

PLEASE SUBMIT COPIES OF ALL GEOPHYSICAL LOGS DIRECTLY TO:  
WEST VIRGINIA OIL AND GAS CONSERVATION COMMISSION  
1615 WASHINGTON STREET EAST  
CHARLESTON, WV 25311  
TELEPHONE: (304) 348-3092

**BLANKET BOND**

Seneca-Upshur Petroleum, Inc.  
Well Operator  
By [Signature]  
Its Vice President

[08-78]

PROPOSED WORK ORDER

THIS IS AN ESTIMATE ONLY:  
ACTUAL INFORMATION MUST BE SUBMITTED ON FORM IV-35 UPON COMPLETION

DRILLING CONTRACTOR (IF KNOWN) Little Swiss Drilling Company

Address P. O. Drawer "P"  
Buckhannon, West Virginia 26201

GEOLOGICAL TARGET FORMATION, Benson

Estimated depth of completed well, 4500' feet Rotary X / Cable tools \_\_\_\_\_

Approximate water strata depths: Fresh, \_\_\_\_\_ feet; salt, \_\_\_\_\_ feet.

Approximate coal seam depths: None Is coal being mined in the area? Yes \_\_\_\_\_ / No \_\_\_\_\_

CASING AND TUBING PROGRAM

CASING OR TUBING TYPE	SPECIFICATIONS					FOOTAGE INTERVALS		CEMENT FILL-UP OR SACKS (Cubic feet)	PACKERS
	Size	Grade	Weight per ft	New	Used	For drilling	Left in well		
Conductor	13					20	20	To Surface	Kinis
Fresh water									
Coal									Liners
Intermediate	8 5/8					480	480	To Surface	
Production	4 1/2						4500	900	Depth set
Tubing									
Liners									Perforations: Top _____ Bottom _____

NOTE: Regulation 7.02 of the Department of Mines provides that the original and four copies of Form IV-2 must be filed with the Department, accompanied by (i) a plat in the form prescribed by Regulation 11, (ii) a bond in one of the forms prescribed by Regulation 12, or in lieu thereof the other security allowed by Code § 22-4-2, (iii) Form IV-9, "Reclamation Plan", applicable to the reclamation required by Code § 22-4-12b and Regulation 23, (iv) unless previously paid on the same well, the fee required by Code § 22-4-12a, and (v) if applicable, the consent required by Code § 22-4-8a from the owner of any water well or drilling within 200 feet of the proposed well.

A separate Form IV-2 shall not be required for fracturing or stimulating a well where fracturing or stimulation is to be part of the work for which a permit is sought and is shown on the Form IV-2 filed in connection therewith.

**THIS PERMIT MUST BE POSTED AT THE WELL SITE**

All provisions being in accordance with Chapter 22, of the W. Va. Code, the location is hereby approved for drilling. This permit shall expire if operations have not commenced by 11-12-81.

*[Signature]*  
Deputy Director - Oil & Gas Division

The following waiver must be completed by the coal operator and by any coal owner or coal lessee who has recorded a declaration under Code § 22-4-20, if the permit is to be issued within fifteen (15) days of receipt thereof:

W A I V E R

The undersigned coal operator \_\_\_\_\_ / owner \_\_\_\_\_ / lessee \_\_\_\_\_ / of the coal under this well location has examined this proposed well location. If a mine map exists which covers the area of the well location, the well location has been added to the mine map. The undersigned has no objection to the work proposed to be done at this location, provided, the well operator has complied with all applicable requirements of the West Virginia Code and the governing regulations.

03/15/2024

Date: \_\_\_\_\_, 19\_\_\_\_

By \_\_\_\_\_  
Its \_\_\_\_\_

Well Site Plan

RECEIVED  
MAR 15 1987  
OIL & GAS DIVISION  
DEPT. OF ENERGY

- Legend:
- Property Boundry
  - Road
  - Existing Fence
  - Planned Fence
  - Stream
  - Open Ditch

- Diversion
- Spring
- Wet Spot
- Building
- Drain Pipe
- Waterway

Sketch to include well location, existing access road, roads to be constructed wellsite, drilling pits and necessary structures numbered or lettered to correspond with first part of this plan. Include all natural drainage.

Access Road To Scale 1"=100'  
Well Location Not To Scale  
Location is in pasture

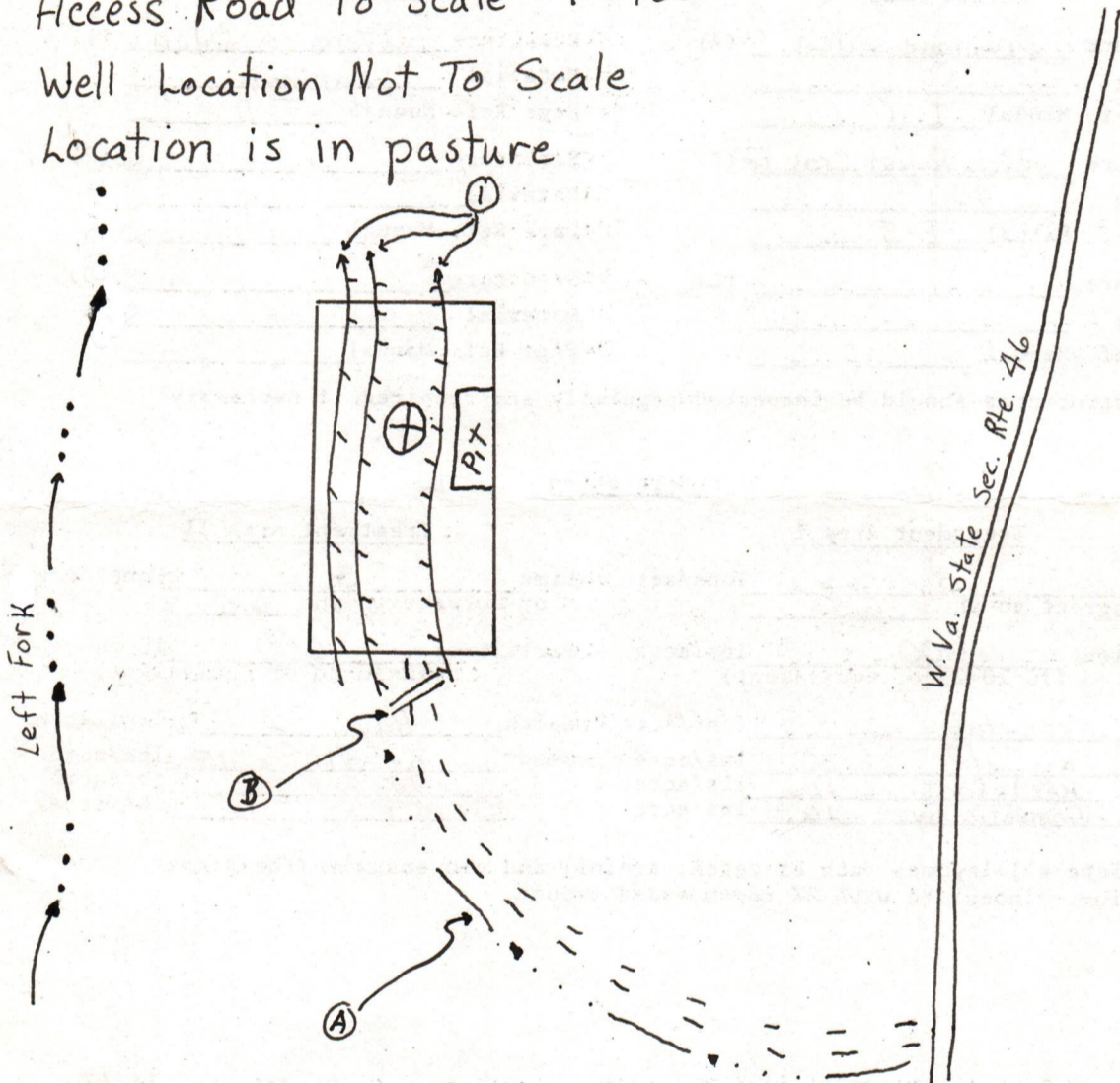

Ditches and culverts to be maintained after construction

Comments: Road banks and other cuts to be on 2:1 slope or less.  
Seed mixture #2 to be used on critical areas. Access road  
is on 0-2% slope.

Signature: \_\_\_\_\_

Agent

Address

Phone Number

03/15/2024

Please request landowners cooperation to protect new seeding for one growing season.

RECEIVED  
MAR 12 1981

RECEIVED  
MAR 3 1981  
Tygart Valley Soil Conservation District

Date 2/26 1981  
Well No. McNeal #1  
API No. 47 - 083 - 0433  
State County Permit

OIL & GAS DIVISION  
DEPT. OF MINES

STATE OF WEST VIRGINIA  
OFFICE OF OIL AND GAS

Company Name Seneca Upshur Pet. Inc. Designated Agent Joseph Hager  
Address P.O. Box P. Buckhannon W. Va. 26201 Address P.O. Box P. Buckhannon W. Va 26201  
Telephone 304-472-6396 Telephone 304-472-6396  
Landowner Wilbur McNeal Soil Cons. District Tygart Valley  
Revegetation to be carried out by Joseph Hager (Agent)

This plan has been reviewed by Tygart Valley SCD. All corrections and additions become a part of this plan. 3/3/81 (Date)  
Jean Freeman (SCD Agent)  
Junior Hedrick

Access Road	Location
Structure <u>Drainage Ditch</u> (A)	Structure <u>Diversion Ditch</u> (1)
Spacing _____	Material <u>Earthen</u>
Page Ref. Manual <u>I-11</u>	Page Ref. Manual <u>I-11</u>
Structure <u>Ditch Relief CrossDr.</u> (B)	Structure _____ (2)
Spacing <u>400'</u>	Material _____
Page Ref. Manual <u>I-5</u>	Page Ref. Manual _____
Structure _____ (C)	Structure _____ (3)
Spacing _____	Material _____
Page Ref. Manual _____	Page Ref. Manual _____

All structures should be inspected regularly and repaired if necessary.

Revegetation

Treatment Area I		Treatment Area II	
Lime <u>3</u> Tons/acre	or correct to pH <u>6.5</u>	Lime <u>3</u> Tons/Acre	or correct to pH <u>6.5</u>
Fertilizer <u>600</u> lbs/acre	(10-20-20 or equivalent)	Fertilizer <u>600</u> lbs/acre	(10-20-20 or equivalent)
Mulch <u>Hay 2</u> Tons/Acre		Mulch <u>Hay 2</u> Tons/Acre	
Seed* <u>Ky 31 30</u> lbs/acre		Seed* <u>Ky 31 30 45</u> lbs/acre	
<u>Birdsfoot 10</u> lbs/acre		<u>Birdsfoot 10</u> lbs/acre	
<u>Domestic Rye 10</u> lbs/acre		<u>Dom. Rye 10</u> lbs/acre	

\*Inoculate all legumes such as vetch, trefoil and clovers with the proper bacterium. Inoculate with 3X recommended amount.

Attach or photocopy section of involved Topographic map. Quadrangle Pickens

Legend: Well Site  
 Access Road



03/15/2024

DETAILS OF PERFORATED INTERVALS, FRACTURING OR STIMULATING, PHYSICAL CHANGE, ETC.

DATE: 4/16/81  
 WATER: 1400 BBLS.  
 SAND: 120,000#

WELL LOG

FORMATION	COLOR	HARD OR SOFT	TOP FEET	BOTTOM FEET	REMARKS
					Including indication of all fresh and salt water, coal, oil and gas
Clay			0	4	
Sand			4	45	
Sand & Shale			45	94	
Shale			94	100	
Sand & Shale			100	424	
Shale			424	435	
Red Rock			435	484	
Shale & Red Rock			484	619	
Big Monday			619	654	
Shale			654	730	
Sand & Shale			730	775	
Red Rock			775	796	
Sand & Shale			796	980	
Big Lime			980	1190	
Big Injun			1190	1220	
Sand & Shale			1220	1730	
Fourth Sand			1730	1755	
Sand & Shale			1755	1820	
Fifth Sand			1820	1860	
Sand & Shale			1860	2000	
Bayard			2000	2015	
Sand & Shale			2015	2195	
Speechley			2195	2210	
Sand & Shale			2210	2380	
Balltown			2380	2400	
Sand & Shale			2400	3140	
Riley			3140	3155	
Sand & Shale			3155	3420	
Benson			3420	3440	T.D.

(Attach separate sheets as necessary)

RECEIVED  
 AUG 30 1982  
 OIL AND GAS DIVISION  
 DEPARTMENT OF MINES

Seneca-Upshur Petroleum, Inc.  
 Well Operator

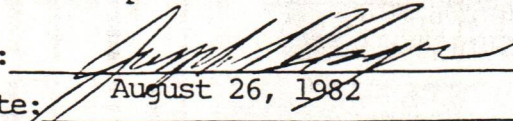
By:   
 Date: August 26, 1982

03/15/2024

Note: Regulation 2.02(i) provides as follows:  
 "The term 'log' or 'well log' shall mean a systematic detailed geological record of all formations, including coal, encountered in the drilling of a well."



Date August 26, 1982  
 Operator's  
 Well No. McNeal #1  
 Farm \_\_\_\_\_  
 API No. 47 - 083 - 0433

**RECEIVED**  
 AUG 30 1982  
 OIL AND GAS DIVISION  
 DEPARTMENT OF MINES

State of West Virginia  
 Department of Mines  
 Oil and Gas Division

WELL OPERATOR'S REPORT  
 OF

DRILLING, FRACTURING AND/OR STIMULATING, OR PHYSICAL CHANGE

WELL TYPE: Oil \_\_\_ / Gas X / Liquid Injection \_\_\_ / Waste Disposal \_\_\_ /  
 (If "Gas," Production X / Underground Storage \_\_\_ / Deep \_\_\_ / Shallow X /)

LOCATION: Elevation: 2326' Watershed Left Fork  
 District: Middle Fork County Randolph Quadrangle Pickens

COMPANY Seneca-Upshur Petroleum, Inc.  
 ADDRESS P.O. Box 2048, Buckhannon, WV 26201  
 DESIGNATED AGENT Seneca-Upshur Petroleum, Inc.  
 ADDRESS P.O. Box 2048, Buckhannon, WV 26201  
 SURFACE OWNER Wilbur McNeal  
 ADDRESS Helvetia, West Virginia 26224  
 MINERAL RIGHTS OWNER Wilbur McNeal  
 ADDRESS Helvetia, West Virginia 26224  
 OIL AND GAS INSPECTOR FOR THIS WORK Robert  
Stewart ADDRESS Jane Lew, WV  
 PERMIT ISSUED 3/12/81  
 DRILLING COMMENCED 3/14/81  
 DRILLING COMPLETED 3/21/81

Casing & Tubing	Used in Drilling	Left in Well	Cement fill up Cu. ft.
Size 20-16 Cond.	12	12	10
13-10"			
9 5/8			
8 5/8	410	410	220
7			
5 1/2			
4 1/2		3554	410
3			
2			
Liners used			

IF APPLICABLE: PLUGGING OF DRY HOLE ON CONTINUOUS PROGRESSION FROM DRILLING OR REWORKING. VERBAL PERMISSION OBTAINED ON \_\_\_\_\_

GEOLOGICAL TARGET FORMATION Benson Depth 4500 feet  
 Depth of completed well 3650 feet Rotary x / Cable Tools \_\_\_\_\_  
 Water strata depth: Fresh 20, 80 feet; Salt 435 feet  
 Coal seam depths: \_\_\_\_\_ Is coal being mined in the area? No

OPEN FLOW DATA

Producing formation Bayard Pay zone depth 2240 feet  
 Gas: Initial open flow Trace Mcf/d Oil: Initial open flow 0 Bbl/d  
 Final open flow 86 Mcf/d Final open flow 0 Bbl/d

Time of open flow between initial and final tests 2 hours

Static rock pressure 570 psig (surface measurement) after 24 hours shut in  
 (If applicable due to multiple completion--)

Second producing formation Benson/Riley Pay zone depth 3120 feet  
 Gas: Initial open flow Trace Mcf/d Oil: Initial open flow 0 Bbl/d  
 Final open flow 406 Mcf/d Oil: Final open flow 0 Bbl/d

Time of open flow between initial and final tests 2 hours

Static rock pressure 570 psig (surface measurement) after 24 hours shut in

STATE OF WEST VIRGINIA  
DEPARTMENT OF MINES  
OIL AND GAS WELLS DIVISION

INSPECTOR'S WELL REPORT

Permit No. 083-0433

Oil or Gas Well GAS  
KIND

Company	Address	Farm	Well No.	District	County	Drilling commenced	Drilling completed	Date shot	Initial open flow	Open flow after tubing	Volume	Rock pressure	Oil	Fresh water	Salt water	CASING AND TUBING	USED IN DRILLING	Left in Well	PACKERS
																Size	Kind of Packer	Size of	Depth set
<u>SENECA UPSTUR</u>	<u>BUCK HANNON</u>	<u>WILBUR McNEAL</u>	<u>#1</u>	<u>MIDDLE FORK</u>	<u>RANDOLPH</u>	<u>3-13-81</u>													

CASING CEMENTED \_\_\_\_\_ SIZE \_\_\_\_\_ No. FT \_\_\_\_\_ Date \_\_\_\_\_

NAME OF SERVICE COMPANY \_\_\_\_\_

COAL WAS ENCOUNTERED AT \_\_\_\_\_ FEET \_\_\_\_\_ INCHES

\_\_\_\_\_ FEET \_\_\_\_\_ INCHES \_\_\_\_\_ FEET \_\_\_\_\_ INCHES

\_\_\_\_\_ FEET \_\_\_\_\_ INCHES \_\_\_\_\_ FEET \_\_\_\_\_ INCHES

Drillers' Names LITTLE SWISS RIG - 1

Remarks: Move Rig SPD

RECEIVED  
MAR 17 1981

OIL & GAS DIVISION  
DEPT. OF MINES

3-13-81  
DATE

Robert Stewart  
DIRECTOR

03/15/2024

# DEPARTMENT OF MINES

## OIL AND GAS WELLS DIVISION

### INSPECTOR'S PLUGGING REPORT

Permit No. \_\_\_\_\_

Well No. \_\_\_\_\_

COMPANY \_\_\_\_\_ ADDRESS \_\_\_\_\_

FARM \_\_\_\_\_ DISTRICT \_\_\_\_\_ COUNTY \_\_\_\_\_

Filling Material Used \_\_\_\_\_

Liner	Location	Amount	Packer	Location
-------	----------	--------	--------	----------

PLUGS USED AND DEPTH PLACED			BRIDGES	CASING AND TUBING		
CEMENT-THICKNESS	WOOD-SIZE	LEAD	CONSTRUCTION LOCATION	RECOVERED	SIZE	LOST

Drillers' Names \_\_\_\_\_

Remarks: \_\_\_\_\_

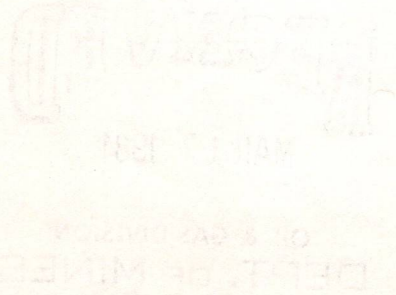

\_\_\_\_\_ hereby certify I visited the \_\_\_\_\_ well on this date

DATE

DISTRICT WELL INSPECTOR  
03/15/2024



STATE OF WEST VIRGINIA  
DEPARTMENT OF MINES  
OIL AND GAS WELLS DIVISION

RECEIVED

MAY 24 1982

OIL AND GAS DIVISION  
WV DEPARTMENT OF MINES

INSPECTOR'S WELL REPORT

Permit No. 083-0433

Oil or Gas Well GAS  
(KIND)

Company	CASING AND TUBING	USED IN DRILLING	LEFT IN WELL	PACKERS
<u>Seneca UPSHUR</u>	Size			
<u>Buck Hannon</u>	16			Kind of Packer
<u>Wilbur McNeal</u>	13			
<u>#1</u>	10			Size of
<u>Middle Fork</u> County <u>RANDOLPH</u>	8 1/4			
Drilling commenced <u>3-13-81</u>	6 5/8			Depth set
Drilling completed _____ Total depth _____	5 3/16			
Date shot _____ Depth of shot _____	3			Perf. top
Initial open flow _____ /10ths Water in _____ Inch	2			Perf. bottom
Open flow after tubing _____ /10ths Merc. in _____ Inch	Liners Used			Perf. top
Volume _____ Cu. Ft.				Perf. bottom
Lock pressure _____ lbs. _____ hrs.	CASING CEMENTED _____ SIZE _____ No. FT. _____ Date _____			
_____ bbls., 1st 24 hrs.	NAME OF SERVICE COMPANY _____			
Fresh water _____ feet _____ feet	COAL WAS ENCOUNTERED AT _____ FEET _____ INCHES			
Salt water _____ feet _____ feet	_____ FEET _____ INCHES _____ FEET _____ INCHES			
	_____ FEET _____ INCHES _____ FEET _____ INCHES			

Drillers' Names \_\_\_\_\_

Remarks:

O.K. To Release

5-21-82

Robert Stewart 511  
03/15/2024

RECEIVED

STATE OF WEST VIRGINIA  
DEPARTMENT OF MINES  
OIL AND GAS WELLS DIVISION  
INSPECTOR'S PLUGGING REPORT

Permit No. \_\_\_\_\_

Well No. \_\_\_\_\_

COMPANY \_\_\_\_\_ ADDRESS \_\_\_\_\_

FARM \_\_\_\_\_ DISTRICT \_\_\_\_\_ COUNTY \_\_\_\_\_

Filling Material Used \_\_\_\_\_

Liner	Location	Amount	Packer	Location		
PLUGS USED AND DEPTH PLACED			BRIDGES	CASING AND TUBING		
CEMENT-THICKNESS	WOOD-SIZE	LEAD	CONSTRUCTION-LOCATION	RECOVERED	SIZE	LOST

Drillers' Names \_\_\_\_\_

Remarks: \_\_\_\_\_

03/15/2024

DATE \_\_\_\_\_ I hereby certify I visited the above well on this date.



# State of West Virginia

Department of Mines  
Oil and Gas Division

Charleston 25305

WALTER N. MILLER  
DIRECTOR

THEODORE M. STREIT  
ADMINISTRATOR

July 13, 1982

Seneca-Upshur Petroleum Company  
P. O. Box P  
Buckhannon, West Virginia 26201

Dear Sir:

The required records and reports have been received in this office and the District Inspectors have submitted Final Inspections for the following wells listed below:

<u>PERMIT NO.</u>	<u>FARM AND WELL NUMBER</u>	<u>DISTRICT</u>
083-0398	F. A. Daetwyler, #1	Middle Fork
083-0416	James P. Morgan, #1-A	Middle Fork
083-0417	R. T. Evans, Jr., #1	Middle Fork
083-0418	Carl E. Marti, #1 (Arnold Tenney)	Middle Fork
083-0433	Wilbur McNeal, #1	Middle Fork
083-0436	R. T. Evans, Jr., #2	Middle Fork
083-0448	J. M. Huber, #72 (Coastal Lbr. Co.)	Middle Fork
083-0480	Geno J. Monti, #1-C	Middle Fork
083-0481	Geno J. Monti, #1-B	Middle Fork

In accordance with Chapter 22, Article 4, Section 2, the bond coverage for above captioned wells will stay in force for life of well. Reclamation requirements have been approved.

Very truly yours,

Theodore M. Streit

TMS:rl

03/15/2024

1.0 API well number: (If not available, leave blank. 14 digits.)	47-083-0433																				
2.0 Type of determination being sought: (Use the codes found on the front of this form.)	<table style="width:100%; border: none;"> <tr> <td style="text-align: center; width: 50%;"> <u>102</u> Section of NGPA                         </td> <td style="text-align: center; width: 50%;"> <u>4</u> Category Code                         </td> </tr> </table>	<u>102</u> Section of NGPA	<u>4</u> Category Code																		
<u>102</u> Section of NGPA	<u>4</u> Category Code																				
3.0 Depth of the deepest completion location: (Only needed if sections 103 or 107 in 2.0 above.)	_____ feet																				
4.0 Name, address and code number of applicant: (35 letters per line maximum. If code number not available, leave blank.)	<table style="width:100%; border: none;"> <tr> <td colspan="3"> <u>Seneca-Upshur Petroleum, Inc.</u> </td> <td style="text-align: right;">                 Seller Code             </td> </tr> <tr> <td colspan="4">                 Name <u>P.O. Drawer P</u> </td> </tr> <tr> <td colspan="2">                 Street <u>Buckhannon,</u> </td> <td style="text-align: center;"> <u>WV</u> </td> <td style="text-align: right;"> <u>26201</u> </td> </tr> <tr> <td colspan="2">                 City             </td> <td style="text-align: center;">                 State             </td> <td style="text-align: right;">                 Zip Code             </td> </tr> </table>	<u>Seneca-Upshur Petroleum, Inc.</u>			Seller Code	Name <u>P.O. Drawer P</u>				Street <u>Buckhannon,</u>		<u>WV</u>	<u>26201</u>	City		State	Zip Code				
<u>Seneca-Upshur Petroleum, Inc.</u>			Seller Code																		
Name <u>P.O. Drawer P</u>																					
Street <u>Buckhannon,</u>		<u>WV</u>	<u>26201</u>																		
City		State	Zip Code																		
5.0 Location of this well: [Complete (a) or (b).] (a) For onshore wells (35 letters maximum for field name.)	<table style="width:100%; border: none;"> <tr> <td colspan="2"> <u>Middle Fork</u> </td> </tr> <tr> <td colspan="2">                 Field Name             </td> </tr> <tr> <td> <u>Randolph</u> </td> <td style="text-align: right;"> <u>WV</u> </td> </tr> <tr> <td>                 County             </td> <td style="text-align: right;">                 State             </td> </tr> </table>	<u>Middle Fork</u>		Field Name		<u>Randolph</u>	<u>WV</u>	County	State												
<u>Middle Fork</u>																					
Field Name																					
<u>Randolph</u>	<u>WV</u>																				
County	State																				
(b) For OCS wells:	<table style="width:100%; border: none;"> <tr> <td>                 Area Name             </td> <td style="text-align: right;">                 Block Number             </td> </tr> <tr> <td colspan="2" style="text-align: center;">                 Date of Lease:             </td> </tr> <tr> <td colspan="2" style="text-align: center;"> <table style="width:100%; border: none;"> <tr> <td style="text-align: center;"> </td> <td style="text-align: center;"> </td> <td style="text-align: center;"> </td> <td style="text-align: center;"> </td> <td style="text-align: center;"> </td> <td style="text-align: center;"> </td> </tr> <tr> <td style="text-align: center;">Mo.</td> <td style="text-align: center;">Day</td> <td style="text-align: center;">Yr.</td> <td colspan="3"></td> </tr> </table> </td> </tr> <tr> <td colspan="2" style="text-align: right;">                 OCS Lease Number             </td> </tr> </table>	Area Name	Block Number	Date of Lease:		<table style="width:100%; border: none;"> <tr> <td style="text-align: center;"> </td> <td style="text-align: center;"> </td> <td style="text-align: center;"> </td> <td style="text-align: center;"> </td> <td style="text-align: center;"> </td> <td style="text-align: center;"> </td> </tr> <tr> <td style="text-align: center;">Mo.</td> <td style="text-align: center;">Day</td> <td style="text-align: center;">Yr.</td> <td colspan="3"></td> </tr> </table>								Mo.	Day	Yr.				OCS Lease Number	
Area Name	Block Number																				
Date of Lease:																					
<table style="width:100%; border: none;"> <tr> <td style="text-align: center;"> </td> <td style="text-align: center;"> </td> <td style="text-align: center;"> </td> <td style="text-align: center;"> </td> <td style="text-align: center;"> </td> <td style="text-align: center;"> </td> </tr> <tr> <td style="text-align: center;">Mo.</td> <td style="text-align: center;">Day</td> <td style="text-align: center;">Yr.</td> <td colspan="3"></td> </tr> </table>								Mo.	Day	Yr.											
Mo.	Day	Yr.																			
OCS Lease Number																					
(c) Name and identification number of this well: (35 letters and digits maximum.)	<u>McNeal #1</u>																				
(d) If code 4 or 5 in 2.0 above, name of the reservoir: (35 letters maximum.)	_____																				
6.0 (a) Name and code number of the purchaser: (35 letters and digits maximum. If code number not available, leave blank.)	<table style="width:100%; border: none;"> <tr> <td colspan="2"> <u>Columbia Gas</u> </td> <td style="text-align: right;">                 Buyer Code             </td> </tr> <tr> <td colspan="2">                 Name             </td> <td></td> </tr> </table>	<u>Columbia Gas</u>		Buyer Code	Name																
<u>Columbia Gas</u>		Buyer Code																			
Name																					
(b) Date of the contract:	<table style="width:100%; border: none;"> <tr> <td colspan="3" style="text-align: center;"> <u>Being Negotiated</u> </td> </tr> <tr> <td colspan="3" style="text-align: center;"> <table style="width:100%; border: none;"> <tr> <td style="text-align: center;"> </td> <td style="text-align: center;"> </td> <td style="text-align: center;"> </td> <td style="text-align: center;"> </td> <td style="text-align: center;"> </td> <td style="text-align: center;"> </td> </tr> <tr> <td style="text-align: center;">Mo.</td> <td style="text-align: center;">Day</td> <td style="text-align: center;">Yr.</td> <td colspan="3"></td> </tr> </table> </td> </tr> </table>	<u>Being Negotiated</u>			<table style="width:100%; border: none;"> <tr> <td style="text-align: center;"> </td> <td style="text-align: center;"> </td> <td style="text-align: center;"> </td> <td style="text-align: center;"> </td> <td style="text-align: center;"> </td> <td style="text-align: center;"> </td> </tr> <tr> <td style="text-align: center;">Mo.</td> <td style="text-align: center;">Day</td> <td style="text-align: center;">Yr.</td> <td colspan="3"></td> </tr> </table>									Mo.	Day	Yr.					
<u>Being Negotiated</u>																					
<table style="width:100%; border: none;"> <tr> <td style="text-align: center;"> </td> <td style="text-align: center;"> </td> <td style="text-align: center;"> </td> <td style="text-align: center;"> </td> <td style="text-align: center;"> </td> <td style="text-align: center;"> </td> </tr> <tr> <td style="text-align: center;">Mo.</td> <td style="text-align: center;">Day</td> <td style="text-align: center;">Yr.</td> <td colspan="3"></td> </tr> </table>									Mo.	Day	Yr.										
Mo.	Day	Yr.																			
(c) Estimated annual production:	<u>35</u> MMcf.																				
7.0 Contract price: (As of filing date. Complete to 3 decimal places.)	<table border="1" style="width:100%; border-collapse: collapse;"> <thead> <tr> <th style="width:25%;">(a) Base Price (\$/MMBTU)</th> <th style="width:25%;">(b) Tax</th> <th style="width:25%;">(c) All Other Prices [Indicate (+) or (-).]</th> <th style="width:25%;">(d) Total of (a), (b) and (c)</th> </tr> </thead> <tbody> <tr> <td style="text-align: center;"> <u>3.093</u> </td> <td style="text-align: center;"> <u>.247</u> </td> <td style="text-align: center;"> <u>---</u> </td> <td style="text-align: center;"> <u>3.340</u> </td> </tr> </tbody> </table>	(a) Base Price (\$/MMBTU)	(b) Tax	(c) All Other Prices [Indicate (+) or (-).]	(d) Total of (a), (b) and (c)	<u>3.093</u>	<u>.247</u>	<u>---</u>	<u>3.340</u>												
(a) Base Price (\$/MMBTU)	(b) Tax	(c) All Other Prices [Indicate (+) or (-).]	(d) Total of (a), (b) and (c)																		
<u>3.093</u>	<u>.247</u>	<u>---</u>	<u>3.340</u>																		
8.0 Maximum lawful rate: (As of filing date. Complete to 3 decimal places.)	<table border="1" style="width:100%; border-collapse: collapse;"> <thead> <tr> <th style="width:25%;">(a) Base Price (\$/MMBTU)</th> <th style="width:25%;">(b) Tax</th> <th style="width:25%;">(c) All Other Prices [Indicate (+) or (-).]</th> <th style="width:25%;">(d) Total of (a), (b) and (c)</th> </tr> </thead> <tbody> <tr> <td style="text-align: center;"> <u>3.093</u> </td> <td style="text-align: center;"> <u>.247</u> </td> <td style="text-align: center;"> <u>---</u> </td> <td style="text-align: center;"> <u>3.340</u> </td> </tr> </tbody> </table>	(a) Base Price (\$/MMBTU)	(b) Tax	(c) All Other Prices [Indicate (+) or (-).]	(d) Total of (a), (b) and (c)	<u>3.093</u>	<u>.247</u>	<u>---</u>	<u>3.340</u>												
(a) Base Price (\$/MMBTU)	(b) Tax	(c) All Other Prices [Indicate (+) or (-).]	(d) Total of (a), (b) and (c)																		
<u>3.093</u>	<u>.247</u>	<u>---</u>	<u>3.340</u>																		
9.0 Person responsible for this application:	<table style="width:100%; border: none;"> <tr> <td> <u>Joseph G. Hager</u> </td> <td style="text-align: right;"> <u>Vice President</u> </td> </tr> <tr> <td>                 Name             </td> <td style="text-align: right;">                 Title             </td> </tr> <tr> <td colspan="2" style="text-align: center;"> </td> </tr> <tr> <td colspan="2" style="text-align: center;">                 Signature             </td> </tr> <tr> <td> <u>April 19, 1982</u> </td> <td style="text-align: right;"> <u>(304) 472-6396</u> </td> </tr> <tr> <td>                 Date Application is Completed             </td> <td style="text-align: right;">                 Phone Number             </td> </tr> </table>	<u>Joseph G. Hager</u>	<u>Vice President</u>	Name	Title			Signature		<u>April 19, 1982</u>	<u>(304) 472-6396</u>	Date Application is Completed	Phone Number								
<u>Joseph G. Hager</u>	<u>Vice President</u>																				
Name	Title																				
Signature																					
<u>April 19, 1982</u>	<u>(304) 472-6396</u>																				
Date Application is Completed	Phone Number																				

Agency Use Only
Date Received by Juris. Agency <b>APR 21 1982</b>
Date Received by FERC

PARTICIPANTS:

DATE: \_\_\_\_\_

BUYER-SELLER CODE \_\_\_\_\_

WELL OPERATOR:

Seneca-Upshur Petroleum, Inc <sup>SEP</sup> 9/1982

FIRST PURCHASER:

Columbia Gas

OTHER: \_\_\_\_\_

W. Va. Department of Mines, Oil & Gas Division  
WELL DETERMINATION FILE NUMBER

820421-102-083-0433

Use Above File Number on all Communications  
Relating to Determination of this Well

QUALIFIED

~~defect~~  
(show new reservoir boundaries)  
attached

CHECK EACH ITEM AS COMPLETE OR NOTE WHAT IS MISSING

ITEM NO.

- 1. FERC -121  Items not completed - Line No. 7.0+8.0 c
- 2. IV-1 Agent  Joseph G. Hager
- 3. IV-2 Well Permit
- 4. IV-6 Well Plat
- 5. IV-35 Well Record  Drilling  Deepening
- 6. IV-36 Gas-Oil Test: Gas Only  Was Oil Produced? \_\_\_\_\_ Ratio \_\_\_\_\_
- 7. IV-39 Annual Production \_\_\_\_\_ years
- 8. IV-40 90 day Production \_\_\_\_\_ Days off line: \_\_\_\_\_
- 9. IV-48 Application for certification. Complete?
- 10-17. IV Form 51 - 52 (53) - 54 - 55 - 56 - 57 - 58 Complete?  Affidavit Signed
- 18-28. Other: Survey \_\_\_\_\_ Logs \_\_\_\_\_ Geological Charts \_\_\_\_\_  
Structure Map \_\_\_\_\_ 1: 4000 Map \_\_\_\_\_ Well Tabulations \_\_\_\_\_  
Gas Analyses \_\_\_\_\_
- (5) Date commenced: 3-14-81 Date completed 3-21-82 Deepened \_\_\_\_\_
- (5) Production Depth: 3120 2240
- (5) Production Formation: Benson / Riley, Bayard
- (5) Final Open Flow: 406 MCF 86 MCF
- (5) After Frac. R. P. 570# 24hrs.
- (6) Other Gas Test: \_\_\_\_\_
- (7) Avg. Daily Gas from Annual Production: \_\_\_\_\_
- (8) Avg. Daily Gas from 90-day ending w/1-120 days \_\_\_\_\_
- (8) Line Pressure: \_\_\_\_\_ PSIG from Daily Report \_\_\_\_\_
- (5) Oil Production: \_\_\_\_\_ From Completion Report \_\_\_\_\_
- 10-17. Does lease inventory indicate enhanced recovery being done NO
- 10-17. Is affidavit signed?  Notarized?
- Does official well record with the Department confirm the submitted information? 03/15/2024
- Additional information \_\_\_\_\_ Does computer program confirm? \_\_\_\_\_
- Was Determination Objected to \_\_\_\_\_ By Whom? \_\_\_\_\_

8

Are there any records not reasonably available to you which may contain information relevant to a determination of eligibility? Yes \_\_\_ No X. If yes, identify such records and indicate their location, if known:

Are you aware of any other information which would tend to be inconsistent with the information specified above? Yes \_\_\_ No X. If yes, indicate the type and source of the information

- 1) Was natural gas produced from the reservoir in commercial quantities prior to April 20, 1977? Yes \_\_\_ No X.
- 2) Was the reservoir penetrated by an old well from which oil or gas was produced in commercial quantities from any other reservoir? Yes \_\_\_ No X.
- 3) If the answer to 2) is "yes", could natural gas have been produced in commercial quantities prior to April 20, 1977 from any old well so indicated? Yes \_\_\_ No X.
- 4) If the gas is to be produced through an old well, were suitable production and gathering facilities available on April 20, 1977? Yes \_\_\_ No X.
- 5) If the answer to 3) or 4) is "yes", attach a separate sheet explaining why you believe the well, for which a determination is sought, can be qualified as a new onshore reservoir well and include any information which would support your conclusion.

BOTTOM HOLE PRESSURE DATA

Indicate the bottom hole pressure of the well and explain how this was calculated.

$$P_f = P_{we} \times GLS \quad X = \frac{1}{53.34 T} = .0000353729 \quad P_f = 597.16$$

$$P_w = 570 \quad G = .586$$

$$e = 2.71828 \quad L = 2246$$

$$S = 1$$

AFFIDAVIT

I, Joseph G. Hager, having been first sworn according to law, state that I have caused to be made a diligent search of those records hereinbefore indicated in the manner herein described, that the information contained in this document is true and accurate and that on the basis of the records and examinations hereinbefore described, and to the best of my information, knowledge and belief, the well for which this determination is sought is a well producing from a new onshore reservoir.



STATE OF WEST VIRGINIA,  
COUNTY OF Upshur, TO WIT:

I, Jerry Lee Jackson, a Notary Public in and for the state and county aforesaid, do certify that Joseph G. Hager, whose name is signed to the writing above, bearing date the 19th day of April, 1982, has acknowledged the same before me, in my county aforesaid.

Given under my hand and official seal this 19th day of April, 1982.

My term of office expires on the 3rd day of May, 1987.

[NOTARIAL SEAL]

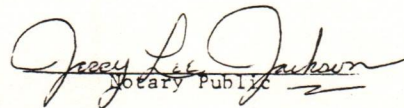
  
Notary Public

In and for the State of West Virginia

03/15/2024

DATE April 19, 19 82

STATE OF WEST VIRGINIA  
DEPARTMENT OF MINES, OIL AND GAS DIVISION

Operator's  
Well No. McNeal #1  
API Well No. 47 - 083 - 0433  
State County Permit

WELL CLASSIFICATION FORM

NEW ONSHORE RESERVOIR WELL

NGPA Section 102(c)(1)(C) Category 4

DESIGNATED AGENT Seneca-Upshur Petroleum, Inc.

ADDRESS P.O. Drawer P  
Buckhannon, West Virginia 26201

WELL OPERATOR Seneca-Upshur Petroleum, Inc. LOCATION: Elevation 2326'

ADDRESS P.O. Drawer P Watershed Left Fork  
Buckhannon, West Virginia 26201 Dist. Middle Fork County Randolph Quad. Pickens

GAS PURCHASER Columbia Gas Gas Purchase Contract No. Being Negotiated

ADDRESS P.O. Box 1273 Meter Chart Code \_\_\_\_\_  
Charleston, West Virginia 25325 Date of Contract \_\_\_\_\_

\* \* \* \* \*

List all records reasonably available to you which contain information relevant to a determination of eligibility (including production records, B&O Tax Records and royalty payment records) and indicate the location of such records:

W.Va. Department of Mines Records and Maps  
Consolidated Supply Maps  
Equitable Gas Maps  
No Other Pipelines in Area.

Describe the search made of any records listed above:

All of the above sources were checked. Seneca-Upshur Petroleum has the only gas facilities in the immediate area.

03/15/2024