

[08-78]

OIL AND GAS WELL PERMIT APPLICATION

Operator's J. M. Huber #60

Well No. \_\_\_\_\_

API Well No. 47 - 083 - 039

State County Perm \_\_\_\_\_

WELL TYPE: Oil \_\_\_\_\_ / Gas X /  
(If "Gas", Production X / Underground storage \_\_\_\_\_ / Deep \_\_\_\_\_ / Shallow X /)

LOCATION: Elevation: 2600' Watershed: Buckhannon River  
District: Middle Fork County: Randolph Quadrangle: Pickens

WELL OPERATOR Seneca-Upshur Petroleum, Inc.  
Address P. O. Drawer P  
Buckhannon, W. Va. 26201

DESIGNATED AGENT Seneca-Upshur Petroleum, Inc.  
Address P. O. Drawer P  
Buckhannon, W. Va. 26201

OIL & GAS ROYALTY OWNER Equitable Gas Company  
Address 420 Blvd. of the Allies  
Pittsburgh, Pa. 15219

COAL OPERATOR \_\_\_\_\_  
Address \_\_\_\_\_

Address 15,379  
SURFACE OWNER Coastal Lumber Company  
Address Buckhannon, West Virginia 26201  
Acreage 15,379

COAL OWNER(S) WITH DECLARATION ON RECORD:  
Name J. M. Huber Corporation  
Address Maryville, Tennessee 37801  
Name \_\_\_\_\_  
Address \_\_\_\_\_

FIELD SALE (IF MADE) TO:  
Name \_\_\_\_\_  
Address \_\_\_\_\_

COAL LESSEE WITH DECLARATION ON RECORD:  
Name \_\_\_\_\_  
Address \_\_\_\_\_

OIL & GAS INSPECTOR TO BE NOTIFIED  
Name Robert Stewart  
Address Jane Lew, West Virginia  
304-884-7782

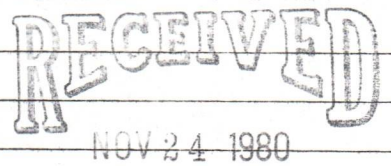

OIL & GAS DIVISION  
DEPT. OF MINES

The undersigned well operator is entitled to operate for oil or gas purposes at the above location under a deed #28 / lease \_\_\_\_\_ / other contract \_\_\_\_\_ / dated 12/1, 1927, to the undersigned well operator from \_\_\_\_\_

[If said deed, lease, or other contract has been recorded:]  
Recorded on 1/6, 1928, in the office of the Clerk of the County Commission of Upshur County, West Virginia, in \_\_\_\_\_ Book 129 at page 200. A permit is requested as follows:

PROPOSED WORK: Drill X / Drill deeper \_\_\_\_\_ / Redrill \_\_\_\_\_ / Fracture or stimulate X /  
Plug off old formation \_\_\_\_\_ / Perforate new formation \_\_\_\_\_ /  
Other physical change in well (specify) \_\_\_\_\_

--planned as shown on the work order on the reverse side hereof.

The above named coal operator, coal owner(s), and coal lessee are hereby notified that any objection they wish to make or are required to make by Code § 22-4-3 must be filed with the Department of Mines within fifteen (15) days after the receipt of this Application by the Department.

Copies of this Permit Application and the enclosed plat and reclamation plan have been mailed by registered mail or delivered by hand to the above named coal operator, coal owner(s), and coal lessee on or before the day of the mailing or delivery of this Permit Application to the Department of Mines at Charleston, West Virginia.

03/22/2024

Seneca-Upshur Petroleum, Inc.  
Well Operator \_\_\_\_\_

PLEASE SUBMIT COPIES OF ALL GEOPHYSICAL LOGS DIRECTLY TO:  
WEST VIRGINIA OIL AND GAS CONSERVATION COMMISSION  
1615 WASHINGTON STREET EAST  
CHARLESTON, WV 25311  
TELEPHONE: (304) 348-3092

**BLANKET BOND** By [Signature]  
Its Vice President

PROPOSED WORK ORDER

THIS IS AN ESTIMATE ONLY:  
ACTUAL INFORMATION MUST BE SUBMITTED ON FORM IV-35 UPON COMPLETION

DRILLING CONTRACTOR (IF KNOWN) Little Swiss Drilling Company

Address P. O. Drawer P  
Buckhannon, W. Va. 26201

GEOLOGICAL TARGET FORMATION, Benson

Estimated depth of completed well, 3450 feet Rotary  Cable tools

Approximate water strata depths: Fresh, \_\_\_\_\_ feet; salt, 600 feet.

Approximate coal seam depths: None Is coal being mined in the area: Yes \_\_\_\_\_ / No

CASING AND TUBING PROGRAM

CASING OR TUBING TYPE	SPECIFICATIONS				FOOTAGE INTERVALS		CEMENT FILL-UP OR SACKS (Cubic feet)	PACKERS	
	Size	Grade	Weight per ft	New	Used	For drilling			Left in well
Conductor	13					20	20	TO SURFACE	Kinis
Fresh water									
Coal									Liner
Intermediate	8 5/8		20	X		525	525	TO SURFACE	
Production	4 1/2		10.50	x			3500	900'	Deaths set
Tubing									
Liners									Perforations:
									Top Bottom

NOTE: Regulation 7.02 of the Department of Mines provides that the original and four copies of Form IV-2 must be filed with the Department, accompanied by (i) a plat in the form prescribed by Regulation 11, (ii) a bond in one of the forms prescribed by Regulation 12, or in lieu thereof the other security allowed by Code § 22-4-2, (iii) Form IV-9, "Reclamation Plan", applicable to the reclamation required by Code § 22-4-12b and Regulation 23, (iv) unless previously paid on the same well, the fee required by Code § 22-4-12a, and (v) if applicable, the consent required by Code § 22-4-8a from the owner of any water well or drilling within 200 feet of the proposed well.

A separate Form IV-2 shall not be required for fracturing or stimulating a well when fracturing or stimulating is a part of the work for which a permit is sought and is noted as such on the Form IV-2 filed in connection therewith.

**THIS PERMIT MUST BE POSTED AT THE WELL SITE**  
All provisions being in accordance with Chapter 22, of the W. Va. Code, the location is hereby approved for drilling. This permit shall expire if operations have not commenced by 8-10-81.

*J. H. Aughey*  
Deputy Director - Oil & Gas Division

The following waiver must be completed by the coal operator and by any coal owner or coal lessee who has recorded a declaration under Code § 22-4-20, if the permit is to be issued within fifteen (15) days of receipt thereof:

W A I V E R













The undersigned coal operator \_\_\_\_\_ / owner \_\_\_\_\_ / lessee \_\_\_\_\_ / of the coal under this well location has examined this proposed well location. If a mine map exists which covers the area of the well location, the well location has been added to the mine map. The undersigned has no objection to the work proposed to be done at this location, provided, the well operator has complied with all applicable requirements of the West Virginia Code and the governing regulations.

03/22/2024

Date: \_\_\_\_\_, 19\_\_\_\_

By \_\_\_\_\_  
Its \_\_\_\_\_

Well Site Plan

- Legend:
- Property Boundary 
  - Road 
  - Existing Fence 
  - Planned Fence 
  - Stream 
  - Open Ditch 
  - Diversion 
  - Spring 
  - Wet Spot 
  - Building 
  - Drain Pipe 
  - Waterway 

Sketch to include well location, existing access road, roads to be constructed, wellsite, drilling pits and necessary structures numbered or lettered to correspond with first part of this plan. Include all natural drainage.

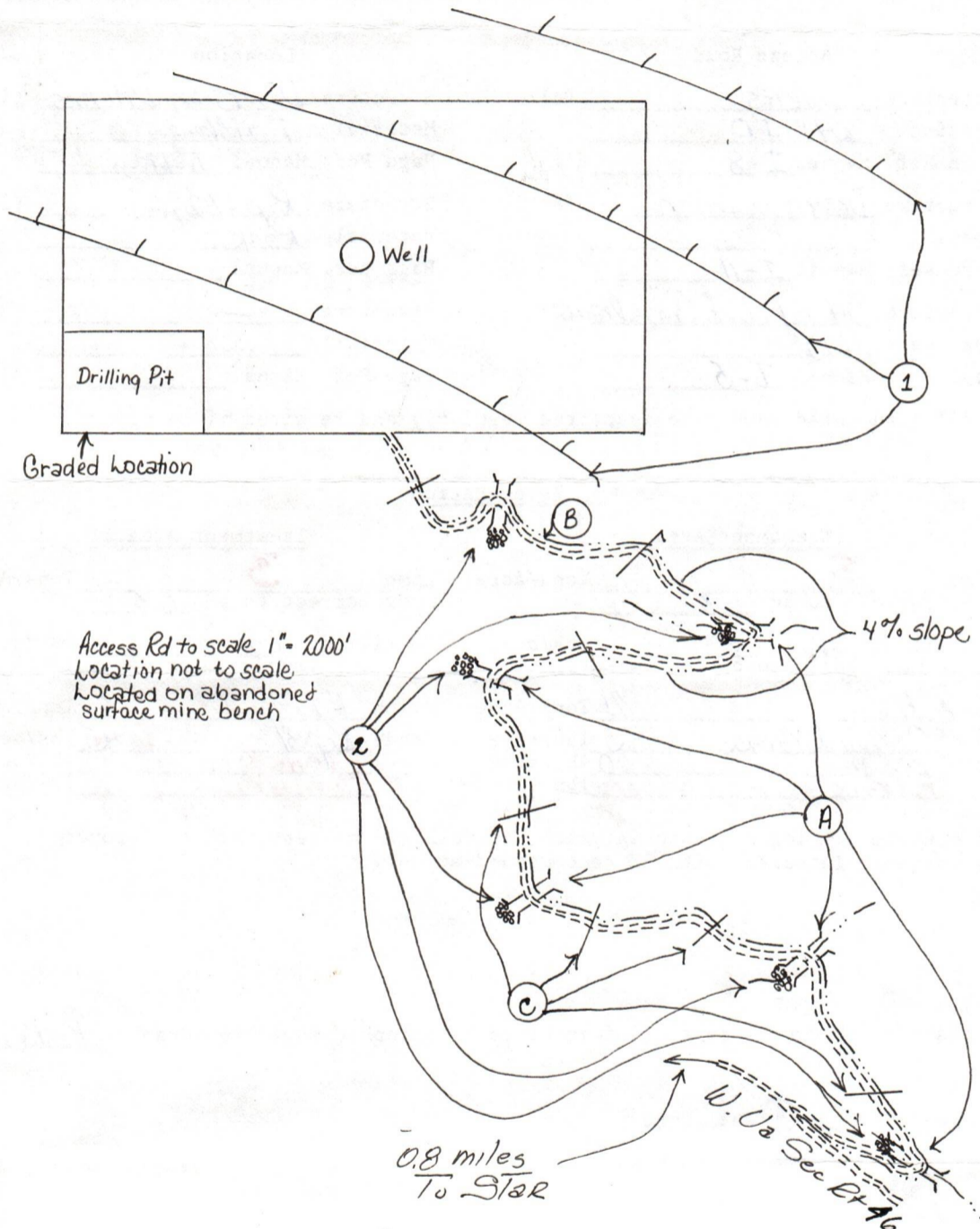

Comments: Access is on 0% slope except where marked (4% slope) Seeding mixture # 2 to be used in critical areas. All brush should be disposed of either by cutting and stacking or dragging off before earthwork begins.

Signature: \_\_\_\_\_

Agent

Address

Phone Number  
03/22/2024

Please request landowners cooperation to protect new seeding for one growing season.

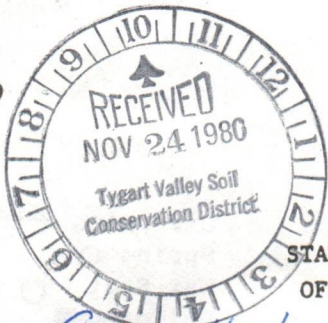

Date Sept 16 19 80  
Well No. Huber # 60  
API No. 47 - 083 - 0392  
State County Permit

STATE OF WEST VIRGINIA  
OFFICE OF OIL AND GAS

Company Name Seneca-Uoshur Pol. Co. Designated Agent Joseph Hager  
Address P.O. Box P Buckhannon, W. Va. Address P.O. Box P Buckhannon, W. Va.  
Telephone 472-6396 Telephone 472-6396  
Landowner Coastal Lumber Soil Cons. District Tygart Valley  
Revegetation to be carried out by Joseph Hager (Agent)  
This plan has been reviewed by Tygart Valley SCD All corrections and additions become a part of this plan. 1-24-80 James H. Hirsch (Date) (SCD Agent)

Access Road  
Structure Culverts (A)  
Spacing 24" ID  
Page Ref. Manual I-8  
Structure Drainage Ditch (B)  
Spacing \_\_\_\_\_  
Page Ref. Manual I-11  
Structure Ditch Relief Cross Drains (C)  
Spacing 400'  
Page Ref. Manual I-5

Location  
Structure Diversion Ditches (1)  
Material Earth  
Page Ref. Manual I-11  
Structure Rip-Rap (2)  
Material Rock DEC-5 1980  
Page Ref. Manual \_\_\_\_\_  
Structure \_\_\_\_\_ OIL & GAS DIVISION (3)  
Material \_\_\_\_\_ DEPT. OF MINES  
Page Ref. Manual \_\_\_\_\_

All structures should be inspected regularly and repaired if necessary.

Revegetation

Treatment Area I  
Lime 3 Tons/acre  
or correct to pH 6.5  
Fertilizer 600 lbs/acre  
(10-20-20 or equivalent)  
Mulch Hay 2 Tons/Acre  
Seed\* Orchard Grass 25 lbs/acre  
Ky 31 20 lbs/acre  
Birdsfoot 10 lbs/acre

Treatment Area II  
Lime 3 Tons/Acre  
or correct to pH 6.5  
Fertilizer 600 lbs/acre  
(10-20-20 or equivalent)  
Mulch Hay 2 Tons/Acre  
Seed\* Ky 31 30 lbs/acre  
Birdsfoot 10 lbs/acre  
Domest 12 Ry 6 10 lbs/acre

\*Inoculate all legumes such as vetch, trefoil and clovers with the proper bacterium. Inoculate with 3X recommended amount.

Attach or photocopy section of involved Topographic map. Quadrangle Pickens

Legend: ⊕ Well Site

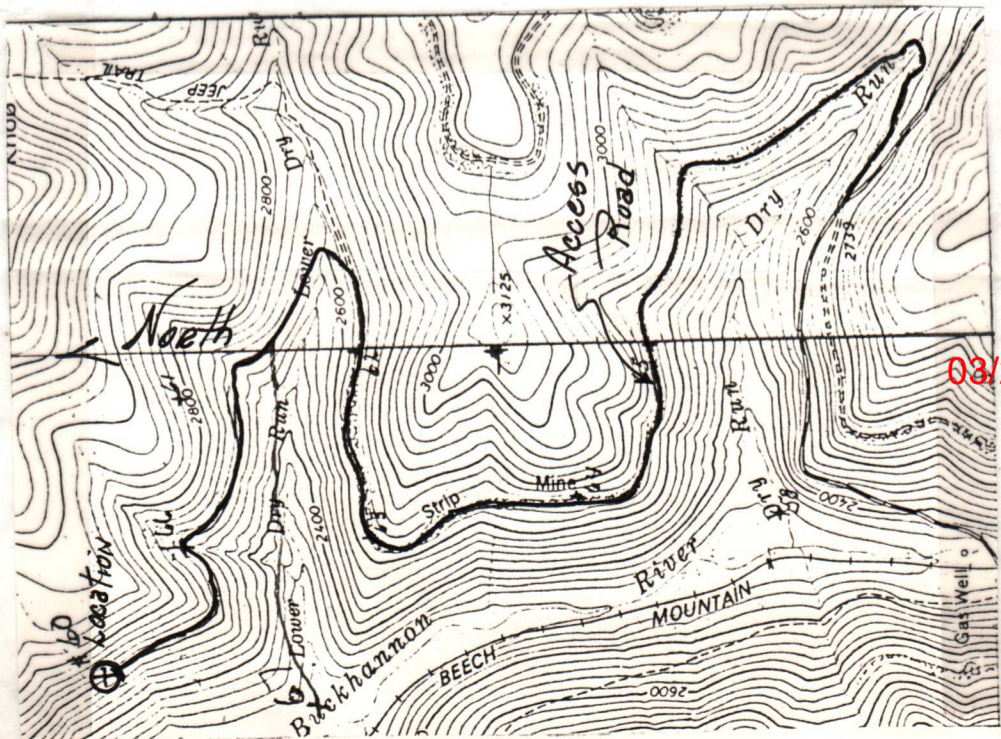

03/22/2024

STATE OF WEST VIRGINIA  
DEPARTMENT OF MINES  
OIL AND GAS WELLS DIVISION

<sup>B-5</sup>  
**RECEIVED**

DEC 17 1980

OIL & GAS DIVISION  
**INSPECTOR'S WELL REPORT DEPT. OF MINES**

Permit No. 083-0392

Oil or Gas Well GAS  
(KIND)

Company	CASING AND TUBING	USED IN DRILLING	Left in Well	PACKERS
<u>Seneca UPSHUR</u>				
<u>Buck Hannon</u>	Size			
<u>COASTAL LUMBER</u>	16			Kind of Packer
<u>JMH #60</u>	13			
<u>MIDDLE FORK</u> County <u>RANDOLPH</u>	10			Size of
<u>12-14-80</u>	8 1/4			
	6 3/4			Depth set
	5 3/16			
	3			Perf. top
	2			Perf. bottom
	Liners Used			Perf. top
				Perf. bottom
	CASING CEMENTED	SIZE	No. FT.	Date
	NAME OF SERVICE COMPANY			
	COAL WAS ENCOUNTERED AT			
	FEET	INCHES	FEET	INCHES
	FEET	INCHES	FEET	INCHES
	FEET	INCHES	FEET	INCHES

Drillers' Names LITTLE SWISS RIG 1

Remarks: MOVE RIG SPUD

12-15-80

03/22/2024 511  
Robert Stewart

STATE OF WEST VIRGINIA  
DEPARTMENT OF MINES  
OIL AND GAS WELLS DIVISION

INSPECTOR'S PLUGGING REPORT

RECEIVED  
OCT 5 1981  
OIL & GAS DIVISION  
DEPT. OF MINES

Well No. \_\_\_\_\_  
COMPANY \_\_\_\_\_ ADDRESS \_\_\_\_\_  
DISTRICT \_\_\_\_\_ COUNTY \_\_\_\_\_  
Drilling Material Used \_\_\_\_\_

Location			Amount	Packer	Location		
PLUGS USED AND DEPTH PLACED			BRIDGES		CASING AND TUBING		
CEMENT-THICKNESS	WOOD-SIZE	LEAD	CONSTRUCTION-LOCATION		RECOVERED	SIZE	LOST

Inspector's Names \_\_\_\_\_  
Date \_\_\_\_\_

I hereby certify I visited the above well on this date.

03/22/2024

STATE OF WEST VIRGINIA  
DEPARTMENT OF MINES  
OIL AND GAS WELLS DIVISION

RECEIVED  
DEC 19 1980

INSPECTOR'S WELL REPORT

OIL & GAS DIVISION  
DEPT. OF MINES

Permit No. 083-0392

Company Seneca UPHUR  
Address Buck Hannon  
Farm COASTAL LUMBER  
Well No. #60  
District Middle Fork County RANDOLPH

CASING AND TUBING	USED IN DRILLING	Left in Well	PACKERS
Size			
16			Kind of Packer
13			
10			Size of
8 5/8		709	220 SKS
6 3/4			Depth set
5 3/16			
3			Perf. top
2			Perf. bottom
Liners Used			Perf. top
			Perf. bottom

Drilling commenced 12-14-80  
Drilling completed \_\_\_\_\_ Total depth \_\_\_\_\_  
Date shot \_\_\_\_\_ Depth of shot \_\_\_\_\_  
Initial open flow \_\_\_\_\_ /10ths Water in \_\_\_\_\_ Inch  
Open flow after tubing \_\_\_\_\_ /10ths Merc. in \_\_\_\_\_ Inch

Vol. ac \_\_\_\_\_ Cu. Ft.  
Rock pressure \_\_\_\_\_ lbs. \_\_\_\_\_ hrs.  
Oil \_\_\_\_\_ bbls., 1st 24 hrs.  
Fresh water \_\_\_\_\_ feet \_\_\_\_\_ feet  
Salt water \_\_\_\_\_ feet \_\_\_\_\_ feet

CASING CEMENTED 8 5/8 SIZE 709 No. FT. \_\_\_\_\_ Date 12-17-80  
NAME OF SERVICE COMPANY Dowell  
COAL WAS ENCOUNTERED AT \_\_\_\_\_ FEET \_\_\_\_\_ INCHES  
\_\_\_\_\_ FEET \_\_\_\_\_ INCHES \_\_\_\_\_ FEET \_\_\_\_\_ INCHES  
\_\_\_\_\_ FEET \_\_\_\_\_ INCHES \_\_\_\_\_ FEET \_\_\_\_\_ INCHES

Drillers' Names LITTLE SWISS RIG 1

Remarks: Cement To SURFACE

12-17-80

Robert Steinhilber 03/22/2024 511

STATE OF WEST VIRGINIA  
DEPARTMENT OF MINES  
OIL AND GAS WELLS DIVISION

INSPECTOR'S PLUGGING REPORT

Form No. \_\_\_\_\_

Well No. \_\_\_\_\_

COMPANY \_\_\_\_\_ ADDRESS \_\_\_\_\_

FARM \_\_\_\_\_ DISTRICT \_\_\_\_\_ COUNTY \_\_\_\_\_

Filling Material Used \_\_\_\_\_

Location			Amount	Packer	Location		
PLUGS USED AND DEPTH PLACED			LEAD	BRIDGES CONSTRUCTION-LOCATION	CASING AND TUBING		
CEMENT-THICKNESS	WOOD-SIZE	RECOVERED			SIZE	LOST	

Inspector's Name \_\_\_\_\_

Date \_\_\_\_\_

I hereby certify I visited the above well on this date.

03/22/2024

DISTRICT WELL INSPECTOR



STATE OF WEST VIRGINIA  
DEPARTMENT OF MINES  
OIL AND GAS WELLS DIVISION

RECEIVED

DEC 18 1981

OIL AND GAS DIVISION  
WV DEPARTMENT OF MINES

INSPECTOR'S WELL REPORT

Permit No. 083-0392

Oil or Gas Well Gas  
(KIND)

		CASING AND TUBING	USED IN DRILLING	LEFT IN WELL	PACKERS
Company	<u>Seneca UPSHUR</u>	Size			
Address	<u>BUCK HANNON</u>	16			Kind of Packer
Farm	<u>COASTAL LUMBER</u>	13			
Well No.	<u>#60</u>	10			Size of
District	<u>MIDDLE FORK</u> County <u>RANDOLPH</u>	8 1/4			
Drilling commenced	<u>12-14-80</u>	6 5/8			Depth set
Drilling completed	Total depth	5 3/16			
Date shot	Depth of shot	3			Perf. top
Initial open flow	/10ths Water in Inch	2			Perf. bottom
Open flow after tubing	/10ths Merc. in Inch	Liners Used			Perf. top
Volume	Cu. Ft.				Perf. bottom
Rock pressure	lbs. hrs.	CASING CEMENTED _____ SIZE _____ No. FT. _____ Date _____			
Oil	bbls., 1st 24 hrs.	NAME OF SERVICE COMPANY _____			
Fresh water	feet feet	COAL WAS ENCOUNTERED AT _____ FEET _____ INCHES			
Salt water	feet feet	_____ FEET _____ INCHES _____ FEET _____ INCHES			
		_____ FEET _____ INCHES _____ FEET _____ INCHES			

Drillers' Names \_\_\_\_\_

Remarks:  
O.K. TO Release

12-16-81

Robert Stewart 511  
03/22/2024

RECEIVED

1991 7 1 3 11

STATE OF WEST VIRGINIA

DEPARTMENT OF MINES

OIL AND GAS WELLS DIVISION

# INSPECTOR'S PLUGGING REPORT

Permit No. \_\_\_\_\_

Well No. \_\_\_\_\_

COMPANY \_\_\_\_\_ ADDRESS \_\_\_\_\_

FARM \_\_\_\_\_ DISTRICT \_\_\_\_\_ COUNTY \_\_\_\_\_

Filling Material Used \_\_\_\_\_

Liner \_\_\_\_\_ Location \_\_\_\_\_ Amount \_\_\_\_\_ Packer \_\_\_\_\_ Location \_\_\_\_\_

PLUGS USED AND DEPTH PLACED			BRIDGES	CASING AND TUBING		
CEMENT-THICKNESS	WOOD-SIZE	LEAD	CONSTRUCTION-LOCATION	RECOVERED	SIZE	LOST

Drillers' Names \_\_\_\_\_

Remarks: \_\_\_\_\_

\_\_\_\_\_  
DATE I hereby certify I visited the above well on this date.

03/22/2024



State of West Virginia

Department of Mines  
Oil and Gas Division

Charleston 25305

WALTER N. MILLER  
DIRECTOR

January 26, 1982

Seneca-Upshur Petroleum, Inc.  
P. O. Drawer P  
Buckhannon, West Virginia 26201

Dear Sir:

The required records and reports have been received in this office and the District Inspectors have submitted Final Inspections for the following wells listed below:

<u>PERMIT NO.</u>	<u>FARM AND WELL NO.</u>	<u>DISTRICT</u>
RAN-0365	J.M.Huber/Coastal Lumber #66	Middle Fork
RAN-0366	J.M.Huber/Coastal Lumber #67	Middle Fork
→ RAN-0392	J. M. Huber #60	Middle Fork

In accordance with Chapter 22, Article 4, Section 2, the bond coverage for above captioned wells will stay in force for life of well. Reclamation requirements have been approved..... ..

Very truly yours,

Fred Burdette

*Poor copy*

FERC-121

**RECEIVED**  
 JAN 8 1981  
 OIL & GAS DIVISION  
 DEPT. OF MINES

1.0 API well number: (If not available, leave blank. 14 digits.)	47- 083 - 0392 - 0000			
2.0 Type of determination being sought: (Use the codes found on the front of this form)	102 Section of NGPA	4 Category Code		
3.0 Depth of the deepest completion location: (Only needed if sections 103 or 107 in 2.0 above.)	_____ feet			
4.0 Name, address and code number of applicant: (35 letters per line maximum. If code number not available, leave blank.)	Seneca-Upshur Petroleum, Inc. Name P. O. Drawer "P" Street Buckhannon, West Virginia City		Seller Code 26201 State Zip Code	
5.0 Location of this well: [Complete (a) or (b).] (a) For onshore wells (35 letters maximum for field name.)	Middle Fork Field Name Randolph County WV State			
(b) For OCS wells:	Area Name _____ Block Number _____ Date of Lease: _____ Mo. Day Yr. OCS Lease Number _____			
(c) Name and identification number of this well: (35 letters and digits maximum.)	J. M. Huber #60			
(d) If code 4 or 5 in 2.0 above, name of the reservoir: (35 letters maximum.)	_____			
6.0 (a) Name and code number of the purchaser: (35 letters and digits maximum. If code number not available, leave blank.)	Equitable Gas Company Name		05939 Buyer Code	
(b) Date of the contract:	08 16 75 Mo. Day Yr.			
(c) Estimated annual production:	45 MMcf.			
	(a) Base Price (\$/MMBTU)	(b) Tax	(c) All Other Prices [Indicate (+) or (-).]	(d) Total of (a) (b) and (c)
7.0 Contract price: (As of filing date. Complete to 3 decimal places.)	1.757	.157	---	2.114
8.0 Maximum lawful rate: (As of filing date. Complete to 3 decimal places.)	2.667	.213	---	2.880
9.0 Person responsible for this application:	Joseph G. Hager Name Vice President Title Signature 1/7/81 Date Application is Completed 304-472-6396 Phone Number			
Agency Use Only				
Date Received by Juris. Agency	JAN 8 1981			
Date Received by FERC				

FT7900806/2-2

03/22/2024

MAY 21 1981

PARTICIPANTS:

DATE:

BUYER-SELLER CODE

WELL OPERATOR: Seneca - Upshur Petroleum, Inc.

FIRST PURCHASER: Equitable Gas Company

005939

OTHER:

W. Va. Department of Mines, Oil & Gas Division  
 WELL DETERMINATION FILE NUMBER  
81-1-4 -102-083 = 0392  
 Use Above File Number on all Communications  
 Relating to Determination of this Well

CHECK EACH ITEM AS COMPLETE OR NOTE WHAT IS MISSING

ITEM NO.

- 1. FERC -121  Items not completed - Line No. 7.0 + 8.0 C
- 2. IV-1 Agent  Joseph G. Hayer
- 3. IV-2 Well Permit
- 4. IV-6 Well Plat
- 5. IV-35 Well Record  Drilling  Deepening
- 6. IV-36 Gas-Oil Test: Gas Only  Was Oil Produced?  Ratio
- 7. IV-39 Annual Production  years
- 8. IV-40 90 day Production  Days off line:
- 9. IV-48 Application for certification. Complete?
- 10-17. IV Form 51 - 52 - 53 - 54 - 55 - 56 - 57 - 58 Complete?  Affidavit Signed
- 18-28. Other: Survey  Logs  Geological Charts   
 Structure Map  1: 4000 Map  Well Tabulations   
 Gas Analyses  Isopach
- (5) Date commenced: 12-14-80 Date completed 12-21-80 Deepened
- (6) Production Depth: 1560, 3185
- (7) Production Formation: Fifth, Benson
- (5) Final Open Flow: 959 mcf
- (5) After Frac. R. P. N/A
- (6) Other Gas Test: \_\_\_\_\_
- (7) Avg. Daily Gas from Annual Production: \_\_\_\_\_
- (8) Avg. Daily Gas from 90-day ending w/1-120 days \_\_\_\_\_
- (8) Line Pressure: \_\_\_\_\_ PSIG from Daily Rep
- (5) Oil Production: \_\_\_\_\_ From Completion Report \_\_\_\_\_
- 10-17. Does lease inventory indicate enhanced recovery being done No
- 10-17. Is affidavit signed?  Notarized?
- Does official well record with the Department confirm the submitted information? yes
- Additional information \_\_\_\_\_ Does computer program confirm? \_\_\_\_\_
- Was Determination Objected to \_\_\_\_\_ By Whom? \_\_\_\_\_

03/22/2024

TS

DATE January 7 1981

STATE OF WEST VIRGINIA  
DEPARTMENT OF MINES, OIL AND GAS DIVISION

Operator's Well No. J. M. Huber #60  
API Well No: 47 - 083 - 0392  
State County Permit

WELL CLASSIFICATION FORM  
NEW ONSHORE RESERVOIR WELL

NGPA Section 102(c)(1)(C) Category 4

DESIGNATED AGENT Seneca-Upshur Petroleum, Inc.  
ADDRESS P. O. Drawer "P"  
Buckhannon, West Virginia 26201

WELL OPERATOR Seneca-Upshur Petroleum, Inc.  
ADDRESS P. O. Drawer "P"  
Buckhannon, West Virginia 26201

LOCATION Elevation 2600'  
Watershed Buckhannon River  
Dist Middle Fork County Randolph Quad Pickens

GAS PURCHASER Equitable Gas Company  
ADDRESS 420 Blvd. of the Allies  
Pittsburgh, Pa. 15219

Gas Purchase Contract No. 6640  
Meter Chart Code 243240 212598 01000  
Date of Contract 8/16/75

\* \* \* \* \*

List all records reasonably available to you which contain information relevant to a determination of eligibility (including production records, B&O Tax Records and royalty payment records) and indicate the location of such records:

W. Va. Department of Mines Records and Maps  
Consolidated Supply Maps  
Equitable Gas Maps  
No Other Pipelines in Area.

Describe the search made of any records listed above:

All of the above sources were checked. Seneca-Upshur Petroleum has the only gas facilities in the immediate area.

03/22/2024

Are there any records not reasonably available to you which may contain information relevant to a determination of eligibility? Yes \_\_\_ No X. If yes, identify such records and indicate their location, if known:

Are you aware of any other information which would tend to be inconsistent with the information specified above? Yes \_\_\_ No X. If yes, indicate the type and source of the information:

- 1) Was natural gas produced from the reservoir in commercial quantities prior to April 20, 1977? Yes \_\_\_ No X.
- 2) Was the reservoir penetrated by an old well from which oil or gas was produced in commercial quantities from any other reservoir? Yes \_\_\_ No X.
- 3) If the answer to 2) is "yes", could natural gas have been produced in commercial quantities prior to April 20, 1977 from any old well so indicated? Yes \_\_\_ No XX.
- 4) If the gas is to be produced through an old well, were suitable production and gathering facilities available on April 20, 1977? Yes \_\_\_ No X.
- 5) If the answer to 3) or 4) is "yes", attach a separate sheet explaining why you believe the well, for which a determination is sought, can be qualified as a new onshore reservoir well and include any information which would support your conclusion.

BOTTOM HOLE PRESSURE DATA

Indicate the bottom hole pressure of the well and explain how this was calculated.

AFFIDAVIT

I, Joseph G. Hager, having been first sworn according to law, state that I have caused to be made a diligent search of those records hereinbefore indicated in the manner herein described, that the information contained in this document is true and accurate and that on the basis of the records and examinations hereinbefore described, and to the best of my information, knowledge and belief, the well for which this determination is sought is a well producing from a new onshore reservoir.



STATE OF WEST VIRGINIA,

COUNTY OF Upshur, TO WIT:

I, Bradley R. Teets, a Notary Public in and for the state and county aforesaid, do certify that Joseph G. Hager, whose name is signed to the writing above, bearing date the 7th day of January, 1981, has acknowledged the same before me, in my county aforesaid

Given under my hand and official seal this 7th day of January, 1981.

My term of office expires on the 6th day of June, 1988.

[NOTARIAL SEAL]

Bradley R. Teets  
Notary Public

03/22/2024



RECEIVED

IV-35  
(Rev 8-81)

AUG 20 1982

State of West Virginia

OIL AND GAS DIVISION  
WV DEPARTMENT OF MINES  
Department of Mines  
Oil and Gas Division

Date August 18, 1982  
Operator's J.M. Huber #60  
Well No. \_\_\_\_\_  
Farm \_\_\_\_\_  
API No. 47 - 083 - 0392

WELL OPERATOR'S REPORT  
OF

DRILLING, FRACTURING AND/OR STIMULATING, OR PHYSICAL CHANGE

*Revised*

WELL TYPE: Oil \_\_\_ / Gas X / Liquid Injection \_\_\_ / Waste Disposal \_\_\_ /  
(If "Gas," Production X / Underground Storage \_\_\_ / Deep \_\_\_ / Shallow X /)

LOCATION: Elevation: 2600' Watershed Buckhannon River  
District Middle Fork County Randolph Quadrangle Pickens

COMPANY Seneca-Upshur Petroleum, Inc.  
ADDRESS P.O. Box 2048, Buckhannon, WV 26201  
DESIGNATED AGENT Seneca-Upshur Petroleum, Inc.  
ADDRESS P.O. Box 2048, Buckhannon, WV 26201  
SURFACE OWNER Coastal Lumber Company  
ADDRESS Buckhannon, WV 26201  
MINERAL RIGHTS OWNER Equitable Gas Company  
ADDRESS 420 Blvd. of the Allies, Pittsburgh, PA  
OIL AND GAS INSPECTOR FOR THIS WORK Robert Stewart  
ADDRESS Jane Lew, WV  
PERMIT ISSUED 12/10/80  
DRILLING COMMENCED 12/14/80  
DRILLING COMPLETED 12/21/80

Casing & Tubing	Used in Drilling	Left in Well	Cement fill up Cu. ft.
Size 20-16 Cond.	18	18	10
13-10"			
9 5/8			
8 5/8	718	718	220
7			
5 1/2			
4 1/2		3327	420
3			
2			
Liners used			

IF APPLICABLE: PLUGGING OF DRY HOLE ON CONTINUOUS PROGRESSION FROM DRILLING OR REWORKING. VERBAL PERMISSION OBTAINED ON \_\_\_\_\_

GEOLOGICAL TARGET FORMATION Benson Depth 3185 feet  
Depth of completed well 3399 feet Rotary X / Cable Tools \_\_\_\_\_  
Water strata depth: Fresh 48 feet; Salt 946 feet  
Coal seam depths: \_\_\_\_\_ Is coal being mined in the area? No

OPEN FLOW DATA

Producing formation Fifth Sand Pay zone depth 1560 feet  
Gas: Initial open flow 189 Mcf/d Oil: Initial open flow 0 Bbl/d  
Final open flow 959 Mcf/d Final open flow 0 Bbl/d  
Time of open flow between initial and final tests 2 hours  
Static rock pressure 490 psig (surface measurement) after 24 hours shut in  
(If applicable due to multiple completion--)  
Second producing formation Benson Pay zone depth 3185 feet  
Gas: Initial open flow Odor Mcf/d Oil: Initial open flow 0 Bbl/d  
Final open flow Trace Mcf/d Oil: Final open flow 0 Bbl/d  
Time of open flow between initial and final tests 2 hours  
Static rock pressure 490 psig (surface measurement) after 24 hours shut in

(Continue on reverse side)

03/22/2024



DETAILS OF PERFORATED INTERVALS, FRACTURING OR STIMULATING, PHYSICAL CHANGE, ETC.

DATE: 1/2/80  
 FRESH WATER: 979 BBLs.  
 SAND: 120,000#

WELL LOG

FORMATION	COLOR	HARD OR SOFT	TOP FEET	BOTTOM FEET	REMARKS
					Including indication of all fresh and salt water, coal, oil and gas
Sand & Shale			0	52	
Sand			52	201	
Sand, Shale & Red Rock			201	451	
Red Rock			451	600	
Shale			600	650	
Blue Monday			650	676	
Shale			676	780	
Big Lime			780	850	
Big Injun			850	920	
Sand & Shale			920	1128	
Gantz			1128	1162	
Sand & Shale			1162	1438	
Fourth Sand			1438	1484	
Sand & Shale			1484	1545	
Fifth Sand			1545	1590	
Sand & Shale			1590	1640	
Bayard			1640	1664	
Sand & Shale			1664	2762	
Riley			2762	2800	
Sand & Shale			2800	3178	
Benson			3178	3210	
Sand & Shale			3210	3394	T.D.

(Attach separate sheets as necessary)

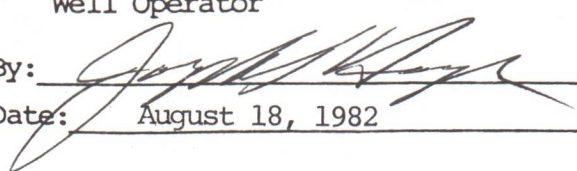
Seneca-Upshur Petroleum, Inc.  
 Well Operator  
 By:   
 Date: August 18, 1982 03/22/2024

Note: Regulation 2.02(i) provides as follows:  
 "The term 'log' or 'well log' shall mean a systematic detailed geological record of all formations, including coal, encountered in the drilling of a well."

Reverse

DETAILS OF PERFORATED INTERVALS, FRACTURING OR STIMULATING, PHYSICAL CHANGE, ETC.

DATE 1-2-80

FRESH WATER 979 BBL

SAND 120,000# 80/100 & 20/40

WELL LOG

FORMATION	Color	Hard or Soft	Top Feet	Bottom Feet	Remarks Including indication of all fresh and salt water, coal, oil and gas
Sand & Shale			-0-	52	
Sand			52	119	
Sand			119	183	
Sand			183	201	
Sand & Shale & Red Rock			201	451	
Red Rock			451	600	
Shale			600	650	
B. Monday			650	676	
Shale			676	681	
Big Lime			681	733	
Big Lime			733	740	
Big Lime			740	885	
Big Lime			885	922	
Injun/ Stream/ water			922	1100	
Red Rock			1100	1350	
Red Rock & Sand			1350	1572	
Sand & Shale			1572	1888	
Sand & Shale			1888	2275	
Sand & Shale			2275	2886	
Sand & Shale			2886	3228	
Sand & Shale			3238	3399	TD

(Attach separate sheets to complete as necessary.)

Seneca-Upshur Petroleum, Inc.  
Well Operator

By [Signature] 03/22/2024  
Its Vice President

NOTE: Regulation 2.02(d) provides as follows:

"The term 'log' or 'well log' shall mean a systematic, detailed geological record of all formations, including coal, encountered in the drilling of a well."

Date 1-6-80

083-0392

WELL TYPE: Oil \_\_\_ / Gas X / Liquid Injection \_\_\_ / Waste Disposal \_\_\_  
 (If "Gas", Production X / Underground storage \_\_\_ / Deep \_\_\_ / Shallow X)  
 LOCATION: Elevation: 2600 Watershed: BUCKHANNON RIVER  
 District: MIDDLEBURY County: WANDOLPH Quadrangle: PICKENS

WELL OPERATOR GENEZA-UPSHUR PETROLEUM DESIGNATED AGENT SAME  
 Address PO. BOX P Address \_\_\_\_\_  
BUCKHANNON WV 26201

PERMITTED WORK: Drill X / Convert \_\_\_ / Drill deeper \_\_\_ / Redrill \_\_\_ / Fracture or stimulate  
 Plug off old formation \_\_\_ / Perforate new formation \_\_\_  
 Other physical change in well (specify) \_\_\_\_\_

PERMIT ISSUED ON 12-10, 1980  
 OIL & GAS INSPECTOR FOR THIS WORK:  
 Name: ROBERT STEWART  
 Address JANE LEE WV

IF APPLICABLE: PLUGGING OF DRY HOLE OR CONTINUOUS PROGRESSION FROM DRILLING OR REWORKING. VERBAL PERMISSION OBTAINED \_\_\_\_\_, 19\_\_\_\_  
 GEOLOGICAL TARGET FORMATION: BENSON Depth 3185 feet  
 Depth of completed well, 3399 feet Rotary X / Cable Tools \_\_\_  
 Water strata depth: Fresh, 48 feet; salt, 946 feet.  
 Coal seam depths: \_\_\_\_\_ Is coal being mined in the area? NO  
 Work was commenced 12-14-80, 1980, and completed 12-21, 1980

CASING AND TUBING PROGRAM

CASING OR TUBING TYPE	Size	SPECIFICATIONS				FOOTAGE INTERVALS		CEMENT FILL-UP OR SACKS (Cubic Feet)	PACKERS
		Grade	Weight per ft	New	Used	For drilling	Left in well		
Conductor	16"					18	18	TO SURF	Kinds
Fresh water									
Coal									Sizes
Intermediate	8 7/8	20	X			718	718	220 SACKS	TO SURFACE
Production	4 1/2	10.5	X				3327	420 SACKS	Depths set
Tubing	1 1/2		X				1551		
Liners									Perforations:
									Top Bottom

OPEN FLOW DATA

Producing formation FIFTH Pay zone depth 1520 feet  
 Gas: Initial open flow, 189 Mcf/d Oil: Initial open flow, \_\_\_ Bbl/d  
 Final open flow, 959 Mcf/d Final open flow, \_\_\_ Bbl/d  
 Time of open flow between initial and final tests, \_\_\_ hours  
 Static rock pressure, \_\_\_ psig (surface measurement) after \_\_\_ hours shut in  
 [If applicable due to multiple completion--]

Second producing formation BENSON Pay zone depth 3185 feet  
 Gas: Initial open flow, GOOD Mcf/d Oil: Initial open flow, \_\_\_ Bbl/d  
 Final open flow, TRACE Mcf/d Final open flow, \_\_\_ Bbl/d  
 Time of open flow between initial and final tests, \_\_\_ hours  
 Static rock pressure, \_\_\_

03/22/2024