



9-22-80

SEP 18 1980

STATE OF WEST VIRGINIA  
DEPARTMENT OF MINES

OIL & GAS DIVISION  
DEPT. OF MINES

Oil and Gas Division

OIL AND GAS WELL PERMIT APPLICATION

TO THE DEPARTMENT OF MINES,  
Charleston, W. Va.

Surface Owner Frank Shreve  
Address Elkins, WV  
Mineral Owner Lewis Heire  
Address \_\_\_\_\_  
Coal Owner James J. LaRosa  
Address 420 Buckhannon Pike, Clarksburg, WV  
Coal Operator \_\_\_\_\_  
Address \_\_\_\_\_

DATE September 16, 1980  
Company NRM Petroleum Corporation  
Address PO Box 816, Buckhannon, WV  
Farm Lewis Acres 77 3/5  
Location (waters) Brooks Run  
Well No. Lewis #2 Elevation 2136  
District Roaring Creek County Randolph  
Quadrangle Ellamore

THIS PERMIT MUST BE POSTED AT THE WELL SITE

All provisions being in accordance with Chapter 22, of the W. Va. Code, the location is hereby approved for drilling. This permit shall expire if operations have not commenced by 6-3-81.

Frederick R. Russell  
Deputy Director - Oil & Gas Division

INSPECTOR TO BE NOTIFIED Robert Stewart  
ADDRESS PO Box 345, Jane Lew, WV  
PHONE 884-7782

GENTLEMEN:

The undersigned well operator is entitled to drill upon the above named farm or tract of land for oil and gas, having fee title thereto, (or as the case may be) under grant or lease dated August 18 1980 by GMR, INC. made to NRM Petroleum Corporation and recorded on the \_\_\_\_\_ day of \_\_\_\_\_ 19\_\_\_\_ in \_\_\_\_\_ County, Book \_\_\_\_\_ Page \_\_\_\_\_  
\_\_\_\_\_ NEW WELL \_\_\_\_\_ DRILL DEEPER \_\_\_\_\_ REDRILL \_\_\_\_\_ FRACTURE OR STIMULATE  
\_\_\_\_\_ OIL AND GAS WELL ORIGINALLY DRILLED BEFORE JUNE 5, 1960.

The enclosed plat was prepared by a registered engineer or licensed land surveyor and all coal owners and/or operators have been notified as of the above date.

The above named coal owners and/or operator are hereby notified that any objection they wish to make, or are required to make by Section 3 of the Code, must be received by, or filed with the Department of Mines within ten (10) days.

Copies of this notice and the enclosed plat were mailed by registered mail, or delivered to the above named coal operators or coal owners at their above shown respective address \_\_\_\_\_ day \_\_\_\_\_ before, or on the same day with the mailing or delivery of this copy to the Department of Mines at Charleston, West Virginia.

PLEASE SUBMIT COPIES OF ALL GEOPHYSICAL LOGS DIRECTLY TO:

WEST VIRGINIA GEOLOGICAL AND ECONOMIC SURVEY  
P. O. BOX 879  
MORGANTOWN, WEST VIRGINIA 26505  
AC-304 - 292-6331

Very truly yours,  
(Sign Name) Bill Hall  
Well Operator

Address of Well Operator  
PO Box 816 Street  
Buckhannon City or Town  
WV State

\*SECTION 3 . . . If no objections are filed or found by the Department of mines, within said period of ten days from the receipt of notice and plat by the department of mines, to said proposed location, the department shall forthwith issue to the well operator a permit reciting the filing of such plat, that no objections have been made by the coal operators or found thereto by the department and that the same is approved and the well operator authorized to proceed.

03/22/2024

BLANKET BOND











"I have read and understand the reclamation requirements as set forth in Chapter 22, Article 4, Section 12-b and will carry out the specified requirements."

Signed by \_\_\_\_\_

47-083-0364 PERMIT NUMBER

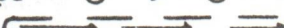

Well Site Plan

- Legend:
- Property Boundry 
  - Road 
  - Existing Fence 
  - Planned Fence 
  - Stream 
  - Open Ditch 
  - Diversion 
  - Spring 
  - Wet Spot 
  - Building 
  - Drain Pipe 
  - Waterway 

Sketch to include well location, existing access road, roads to be constructed, wellsite, drilling pits and necessary structures numbered or lettered to correspond with first part of this plan. Include all natural drainage.

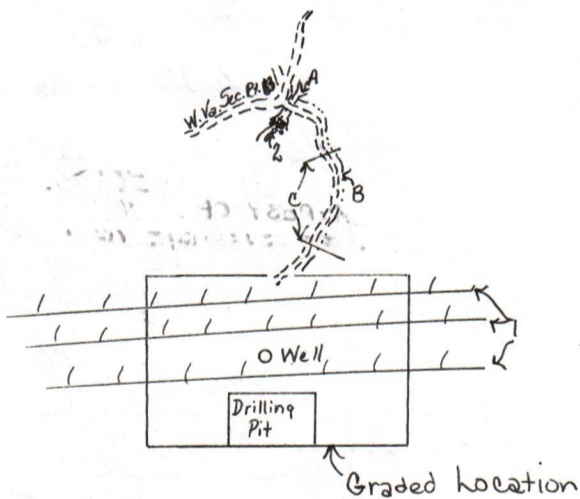

Access Rd to Scale 1"=2000  
 Location not to scale  
 All brush + debris to be cut + disposed  
 of prior to earthwork  
 All marketable timber to be cut  
 and stacked.

Comments: Site is located in woods, Access Rd is 4% ~~on~~, Seed mixture #2 to be used on critical areas. ROAD BANKS TO BE CUT ON A 2:1 SLOPE

Signature: \_\_\_\_\_

Agent

Address

Phone Number

03/22/2024

Please request landowners cooperation to protect new seeding for one growing season.



Date Sept 15 19 80  
Well No. Lewis # 2  
API No. 47 - 083 -  
State County Permit

STATE OF WEST VIRGINIA  
OFFICE OF OIL AND GAS

Company Name NEM Petroleum Corp. Designated Agent R. L. Hopkins  
Address Box 816, Buckhannon, W. Va. Address Box 816, Buckhannon, W. Va.  
Telephone 472-9113 Telephone 472-9113  
Landowner Frank Shreve Soil Cons. District Tygart's Valley

Revegetation to be carried out by Homer Zirkle (Agent)

This plan has been reviewed by Tygart's Valley SCD. All corrections and additions become a part of this plan. 9-17-1980 John R. Hedrick (Date) (SCD Agent)

Access Road	Location
Structure <u>Culverts</u> (A)	Structure <u>Diversion Ditches</u> (1)
Spacing <u>Min. size - 18' ID</u>	Material <u>Earthen</u>
Page Ref. Manual <u>I-8</u>	Page Ref. Manual <u>I-11</u>
Structure <u>Drainage Ditch</u> (B)	Structure <u>Riprap</u> (2)
Spacing _____	Material <u>Rock</u>
Page Ref. Manual <u>I-11</u>	Page Ref. Manual _____
Structure <u>Ditch Relief Cross Drains</u>	Structure _____
Spacing <u>400'</u>	Material _____
Page Ref. Manual <u>I-5</u>	Page Ref. Manual _____

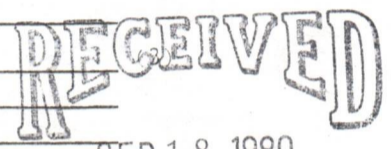

All structures should be inspected regularly and repaired if necessary.

OIL & GAS DIVISION  
DEPT. OF MINES

Revegetation

Treatment Area I		Treatment Area II	
Lime <u>3</u> Tons/acre	or correct to pH <u>6.5</u>	Lime <u>3</u> Tons/Acre	or correct to pH <u>6.5</u>
Fertilizer <u>600</u> lbs/acre	(10-20-20 or equivalent)	Fertilizer <u>600</u> lbs/acre	(10-20-20 or equivalent)
Mulch <u>Hay</u> <u>2</u> Tons/Acre		Mulch <u>Hay</u> <u>2</u> Tons/Acre	
Seed* <u>Ky 31</u> <u>30</u> <u>45</u> lbs/acre		Seed* <u>Ky 31</u> <u>30</u> <u>45</u> lbs/acre	
<u>Birdsfoot</u> <u>10</u> lbs/acre		<u>Birdsfoot</u> <u>10</u> lbs/acre	
<u>Domestic Ryegrass</u> <u>10</u> lbs/acre		<u>Domestic Ryegrass</u> <u>10</u> lbs/acre	

\*Inoculate all legumes such as vetch, trefoil and clovers with the proper bacterium. Inoculate with 3X recommended amount.

Attach or photocopy section of involved Topographic map. Quadrangle Ellamore

Legend: Well Site  
 Access Road

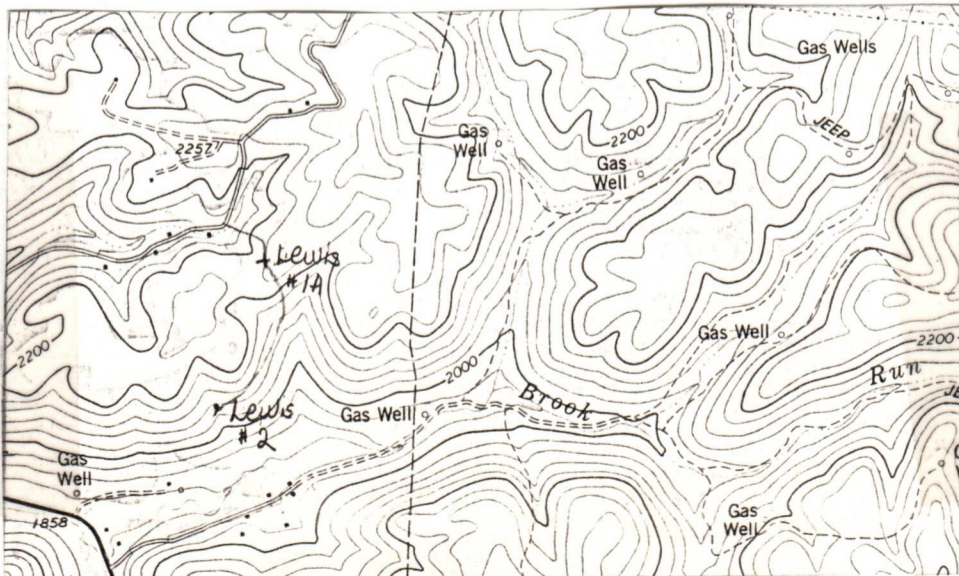

Formation	Color	Hard or Soft	Top Feet	Bottom Feet	Oil, Gas or Water	Remarks
Big Injun			1097	1224		
Gantz			1224	1280		
Sand and Shale			1280	1782		
Fifth Sand			1782	1903		
Siltstone and Shale			1903	1976		
Bayard			1976	2016		Gas Chk. @ 2011' - No Show
Siltstone and Shale			2016	2742		
Balltown			2742	2952		
Siltstone and Shale			2952	3219		
Riley			3219	3462		
Siltstone and Shale			3462	3543		Gas Chk. @ 3508' - 15 M
Benson			3543	3557		
Shale			3557	3571		
Siltstone			3571	3632		
Siltstone and Shale			3632	3748		Gas Chk. @ 3728' - 15 M
Alexander			3748	3879		
Siltstone and Shale			3879	3902		
Elk			3902	4067		Gas Chk. @ 3915' - 15 M
Siltstone and Shale			4067			
TOTAL DEPTH				4182		Gas Chk. @ TD - 11 M

Well Logged By Allegheny Nuclear Surveys

Initial Open Flow - 11 Mcf/Day

Benson Perforations - 12 holes, 3546-3554  
 Besnon Frac - Breakdown 2500#, average pressure 2300#, average rate 36.1 BPM, total fluid 412 bbl., shut-in pressure 1100#  
 10,000# of 80/100 sand and 40,000# of 20/40 sand.

Riley Perforations - 12 holes, 3243-3442  
 Riley Frac - Breakdown 2300#, average pressure 2000#, average rate 38.9 BPM, total fluid 409 bbl., shut-in pressure 900#  
 10,000# of 80/100 sand and 40,000# of 20/40 sand.

03/22/2024

Date Nov. 19 1980

APPROVED NRM Petroleum Corporation Owner  
*John C. Moore* Gen. Supt.



RECEIVED

NOV 21 1980

STATE OF WEST VIRGINIA  
DEPARTMENT OF MINES

OIL & GAS DIVISION  
DEPT. OF MINES

Oil and Gas Division  
WELL RECORD

Union Drilling  
Rig #8  
Rotary  Oil \_\_\_\_\_  
Cable \_\_\_\_\_ Gas   
Recycling \_\_\_\_\_ Comb. \_\_\_\_\_  
Water Flood \_\_\_\_\_ Storage \_\_\_\_\_  
Disposal \_\_\_\_\_ (Kind)

Quadrangle Ellamore 7 1/2

Permit No. 47-083-0364

Company NRM Petroleum Corporation  
Address P.O. Box 816, Buckhannon, WV 26201  
Farm Lewis Acres 77 3/5  
Location (waters) \_\_\_\_\_  
Well No. 2 Elev. 2136'  
District Roaring Creek County Randolph  
The surface of tract is owned in fee by \_\_\_\_\_  
Frank Shreve  
Address Elkins, WV  
Mineral rights are owned by \_\_\_\_\_  
Address \_\_\_\_\_  
Drilling Commenced 10-23-80  
Drilling Completed 10-27-80  
Initial open flow 11 M cu. ft. \_\_\_\_\_ bbls.  
Final production 1,237 cu. ft. per day \_\_\_\_\_ bbls.  
Well open 3 hrs. before test 1050 RP.

Casing and Tubing	Used in Drilling	Left in Well	Cement fill up Cu. ft. (Sks.)
Size			
20-16			
Cond.			
13-10"			
9 5/8			
8 5/8	817.16	817.16	
7			
5 1/2			
4 1/2	-	4106	
3			
2			
Liners Used			

Well treatment details:

Attach copy of cementing record.

Elk Perforations - 12 holes 3990-4024  
Elk Frac - Breakdown 2300#, average pressure 2400#, average rate 33 BPM,  
total fluid 420 bbl.s; shut-in pressure 1200#  
10,000# of 80/100 sand and 40,000# of 20/40 sand

Coal was encountered at 237', 361', 525' Feet \_\_\_\_\_ Inches  
Fresh water 40', 240' Feet \_\_\_\_\_ Salt Water \_\_\_\_\_ Feet \_\_\_\_\_  
Producing Sand Elk, Riley and Benson Depth \_\_\_\_\_

Formation	Color	Hard or Soft	Top Feet	Bottom Feet	Oil, Gas or Water	* Remarks
Clay			0	5		
Shale			5	15		
Sand			15	40	1/2" Water @ 40'	
Sandy Shale			40	59		
Sand			59	139		
Sand and Shale			139	148		
Sand			148	178		
Sand and Shale			178	223		
Sand			223	237		
Coal			237	242	1 1/2" Water @ 240'	
Sand and Shale			242	328		
Sand			328	361		
Coal			361	364		
Sand			364	377		
Sand and Shale			377	473		
Sand			473	525		
Coal			525	530		
Sand			530	620		
Red Rock and Shale			610	645		
Sandy Shale			645	926		
Little Lime			926	942		
Shale			942	992		
Big Lime			992	1097		

03/22/2024

STATE OF WEST VIRGINIA  
DEPARTMENT OF MINES  
OIL AND GAS WELLS DIVISION

RECEIVED

OCT 24 1980

INSPECTOR'S WELL REPORT OIL & GAS DIVISION

DEPT. OF MINES

Oil or Gas Well GAS  
(KIND)

Permit No. 083-0364

Company	CASING AND TUBING	USED IN DRILLING	Left in Well	PACKERS
<u>NRM Petroleum</u>				
<u>Buck Hannon</u>	Size			
<u>FRANK SHREVE</u>	16			Kind of Packer
<u>Lewis #2</u>	13			
<u>Roaring Creek</u> County <u>RANDOLPH</u>	10			Size of
<u>10-22-80</u>	8 1/4			
	6 3/4			Depth set
	5 3/16			
	3			Perf. top
	2			Perf. bottom
	Liners Used			Perf. top
				Perf. bottom
	CASING CEMENTED	SIZE	No. FT.	Date
	NAME OF SERVICE COMPANY			
	COAL WAS ENCOUNTERED AT			
	FEET	INCHES	FEET	INCHES
	FEET	INCHES	FEET	INCHES
	FEET	INCHES	FEET	INCHES

Drillers' Names UNION DRIG RiG - 8

Remarks: Move RiG SPD

10-22-80

03/22/2024  
Robert Stewart





STATE OF WEST VIRGINIA  
DEPARTMENT OF MINES  
OIL AND GAS WELLS DIVISION

INSPECTOR'S WELL REPORT

Permit No. 083-0364

Oil or Gas Well GAS  
(KIND)

Company <u>VRM Petroleum</u>	CASING AND TUBING	USED IN DRILLING	Left in Well	PACKERS
Address <u>Buck Hannon</u>	Size			
Farm <u>Lewis - Lamb</u>	16			Kind of Packer
Well No. <u># 2</u>	13			
District <u>Roaring Creek</u> County <u>Randolph</u>	10			Size of
Drilling commenced <u>10-22-80</u>	8 1/4			Depth set
Drilling completed _____ Total depth _____	6 5/8			
Date shot _____ Depth of shot _____	5 3/16			Perf. top
Initial open flow _____ /10ths Water in _____ Inch	3			Perf. bottom
Open flow after tubing _____ /10ths Merc. in _____ Inch	2			Perf. top
Volume _____ Cu. Ft.	Liners Used			Perf. bottom
Rock pressure _____ lbs. _____ hrs.	CASING CEMENTED _____ SIZE _____ No. FT. _____ Date _____			
Oil _____ bbls., 1st 24 hrs.	NAME OF SERVICE COMPANY _____			
Fresh water _____ feet _____ feet	COAL WAS ENCOUNTERED AT _____ FEET _____ INCHES			
Salt water _____ feet _____ feet	_____ FEET _____ INCHES _____ FEET _____ INCHES			
	_____ FEET _____ INCHES _____ FEET _____ INCHES			

Drillers' Names \_\_\_\_\_

RECEIVED

Remarks:

OCT 5 - 1981

O.K. To Release

OIL AND GAS DIVISION  
WV DEPARTMENT OF MINES

10-1-81

DATE

Robert Schmitt 03/22/2024 511  
DISTRICT WELL INSPECTOR

**STATE OF WEST VIRGINIA**  
**DEPARTMENT OF MINES**  
**OIL AND GAS WELLS DIVISION**  
**INSPECTOR'S PLUGGING REPORT**

Permit No. \_\_\_\_\_

Well No. \_\_\_\_\_

COMPANY \_\_\_\_\_ ADDRESS \_\_\_\_\_

FARM \_\_\_\_\_ DISTRICT \_\_\_\_\_ COUNTY \_\_\_\_\_

Filling Material Used \_\_\_\_\_

Liner	Location	Amount	Packer	Location		
PLUGS USED AND DEPTH PLACED			BRIDGES	CASING AND TUBING		
CEMENT-THICKNESS	WOOD-SIZE	LEAD	CONSTRUCTION-LOCATION	RECOVERED	SIZE	LOST

Drillers' Names \_\_\_\_\_

Remarks: \_\_\_\_\_

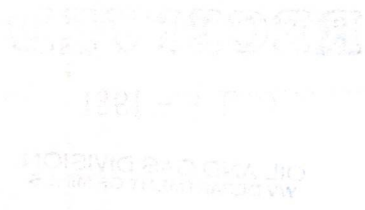

\_\_\_\_\_  
 DATE I hereby certify I visited the above well on this date.

**03/22/2024**  
 \_\_\_\_\_  
 DISTRICT WELL INSPECTOR



State of West Virginia

Department of Mines  
Oil and Gas Division

Charleston 25305

WALTER N. MILLER  
DIRECTOR

January 26, 1982

NRM Petroleum Corporation  
Box 816  
Buckhannon, West Virginia 26201

Dear Sir:

The required records and reports have been received in this office and the District Inspectors have submitted Final Inspections for the following wells listed below:

<u>PERMIT NO.</u>	<u>FARM AND WELL NO.</u>	<u>DISTRICT</u>
RAN-0363	Strader & Arnold Lamb/Lewis Hrs. 1#A	Roaring Creek
→ RAN-0364	Frank Shreve, #Lewis ##2	Roaring Creek

In accordance with Chapter 22, Article 4, Section 2, the bond coverage for above captioned wells will stay in force for life of well. Reclamation requirements have been approved..... ..

Very truly yours,

Fred Burdette

1.0 API well number: (If not available, leave blank. 14 digits.)	<u>47-083-0364</u>						
2.0 Type of determination being sought (Use the codes found on the front of this form!)	103 Section of NGPA	Category Code DEPT. 013849NEE					
3.0 Depth of the deepest completion location: (Only needed if sections 103 or 107 in 2.0 above.)	_____ feet OIL & GAS DIVISION						
4.0 Name, address and code number of applicant: (35 letters per line maximum. If code number not available, leave blank.)	Name <u>NRM PETROLEUM CORP.</u> <u>P. O. BOX 816</u> Street <u>BUCKHANNON, W. VA. 26201</u> City State Zip Code		Seller Code <u>DEPT. 013849NEE</u>				
5.0 Location of this well. (Complete (a) or (b).) (a) For onshore wells (35 letters maximum for field name.)	Field Name <u>ELLAMORE</u> County <u>Randolph</u>		State <u>WV</u>				
(b) For OCS wells	Area Name _____ Block Number _____ Date of Lease Mo. Day Yr. _____ OCS Lease Number _____						
(c) Name and identification number of this well: (35 letters and digits maximum.)	<u>LEWIS #2</u> ✓						
(d) If code 4 or 5 in 2.0 above, name of the reservoir: (35 letters maximum.)							
6.0 (a) Name and code number of the purchaser: (35 letters and digits maximum. If code number not available, leave blank.)	Name <u>Columbia Gas Transmission Corp.</u>		Buyer Code <u>004030</u>				
(b) Date of the contract:	Mo. Day Yr. _____						
(c) Estimated annual production:	_____ MMcf						
	(a) Base Price (\$/MMBTU)	(b) Tax	(c) All Other Prices (Indicate +/-)	(d) Total of (a), (b) and (c)			
7.0 Contract price: (As of filing date. Complete to 3 decimal places.)	-----	-----	-----	-----			
8.0 Maximum lawful rate: (As of filing date. Complete to 3 decimal places.)	2.346	.235	-----	2.581			
9.0 Person responsible for this application	Name <u>R.L. Hopkins</u> Title <u>V-Pres.</u> Signature _____ Date Application is Completed _____ Phone Number <u>304-472-9113</u>						
<table border="1" style="width:100%; border-collapse: collapse;"> <tr> <td style="text-align: center; font-weight: bold;">Agency Use Only</td> </tr> <tr> <td>Date Received by Juris. Agency <b>DEC 17 1980</b></td> </tr> <tr> <td>Date Received by FERC</td> </tr> </table>	Agency Use Only	Date Received by Juris. Agency <b>DEC 17 1980</b>	Date Received by FERC				
Agency Use Only							
Date Received by Juris. Agency <b>DEC 17 1980</b>							
Date Received by FERC							

03/22/2024

PARTICIPANTS:

DATE: MAY 6 1981

BUYER-SELLER CODE

WELL OPERATOR: NRM Petroleum Corp.

013849

FIRST PURCHASER: Columbia Gas Trans. Corp.

004030

OTHER: \_\_\_\_\_

W. Va. Department of Mines, Oil & Gas Division  
 WELL DETERMINATION FILE NUMBER  
80-12-17 - 103-083 - 0364  
 Use Above File Number on all Communications  
 Relating to Determination of this Well

*check map. 1500'*

*✓ OK*

*Localities J G Huggins*

CHECK EACH ITEM AS COMPLETE OR NOTE WHAT IS MISSING

ITEM NO.

- 1. FERC -121  Items not completed - Line No. All 7.0, 8.0 c
- 2. IV-1 Agent Richard L. Hopkins
- 3. IV-2 Well Permit
- 4. IV-6 Well Plat
- 5. IV-35 Well Record  Drilling  Deepening
- 6. IV-36 Gas-Oil Test: Gas Only  Was Oil Produced?  Ratio
- 7. IV-39 Annual Production  years
- 8. IV-40 90 day Production  Days off line:
- 9. IV-48 Application for certification. Complete?
- 10-17. IV Form 51 - 52 - 53 - 54 - 55 - 56 - 57 - 58 Complete?  Affidavit Signed
- 18-28. Other: Survey \_\_\_\_\_ Logs \_\_\_\_\_ Geological Charts \_\_\_\_\_  
 Structure Map \_\_\_\_\_ 1: 4000 Map \_\_\_\_\_ Well Tabulations \_\_\_\_\_  
 Gas Analyses \_\_\_\_\_
- (5) Date commenced: 10-23-80 Date completed 10-27-80 Deepened
- (5) Production Depth: 3990-4024, 3546-54, 3243-3442
- (5) Production Formation: Elk, Riley, Benson
- (5) Final Open Flow: 1237 mcf
- (5) After Frac. R. P. 1050# 3 hrs.
- (6) Other Gas Test: \_\_\_\_\_
- (7) Avg. Daily Gas from Annual Production: \_\_\_\_\_
- (8) Avg. Daily Gas from 90-day ending w/1-120 days \_\_\_\_\_
- (8) Line Pressure: \_\_\_\_\_ PSIG from Daily Report
- (5) Oil Production: \_\_\_\_\_ From Completion Report \_\_\_\_\_
- 10-17. Does lease inventory indicate enhanced recovery being done NO
- 10-17. Is affidavit signed?  Notarized?
- Does official well record with the Department confirm the submitted information? yes 03/22/2024
- Additional information \_\_\_\_\_ Does computer program confirm? \_\_\_\_\_
- Was Determination Objected to \_\_\_\_\_ By Whom? \_\_\_\_\_

*J*

STATE OF WEST VIRGINIA  
DEPARTMENT OF MINES, OIL AND GAS

Date 12-17 80  
Inspector's Well No. LEWIS #2  
Well No. 083 0364

WELL CLASSIFICATION FORM  
NEW ONSHORE PRODUCTION WELL  
MGS Section 103

DESIGNATED AGENT Rickard L. Hopkins  
ADDRESS Rt. 1 Box 107-D  
Buckhannon, WV 26201

WELL OPERATOR NRM PETROLEUM CORP.  
ADDRESS P. O. BOX 816  
BUCKHANNON, W. VA. 26201  
Columbia Gas Transmission  
P. O. Box 1273  
Charleston, WV 25325

LOCATION ELEVATION 2136'  
Watershed Boaring Creek  
Dist. BOARING CREEK: Randolph ELLAMORE  
Purchase Contract # N/A  
Meter Chart # N/A  
Date of Contract N/A

Date of drilling was begun 10-23-80

Bottom hole pressure of the well and explain how it was calculated

Bottom hole pressure 1463.7  
Calculated by multiplying the total depth by .35 lb/ft.

R.L. Hopkins

AFFIDAVIT

having been first sworn according to the laws of the State of West Virginia, do hereby certify that the well for which this determination is sought was begun on or after the date of the applicable state or federal well spacing requirements and the well is a separate production unit, in existence at the time surface drilling began, which was approved by the State of West Virginia, and which gas is or will be produced and which applied to any other well producing or capable of producing gas in commercial quantities, I state, further, that I have concluded on the basis of my information, knowledge and belief, that the well for which this determination is sought is a new onshore production well and that I am not aware of any information not described in the application which is inconsistent with this conclusion.

STATE OF WEST VIRGINIA,  
COUNTY OF Randolph, TO WIT:

I, Glenda Maitz, a Notary Public in and for the state and county aforesaid,

do hereby certify that R.L. Hopkins, whose name is signed to the writing above, bearing date

the 17 day of DEC. 1980, has acknowledged the same before me, in my county aforesaid,

given under my hand and official seal this 17 day of DEC. 1980

my term of office expires on the 31 day of JAN. 1989

*Glenda Maitz*  
Notary Public

03/22/2024

03/22/2024