



STATE OF WEST VIRGINIA
DEPARTMENT OF MINES

RECEIVED
SEP 17 1980

Oil and Gas Division

OIL AND GAS WELL PERMIT APPLICATION

OIL & GAS DIVISION
DEPT. OF MINES

TO THE DEPARTMENT OF MINES,
Charleston, W. Va.

DATE September 9, 1980

Surface Owner Meadowlark Farms Inc.

Company AMAX Petroleum Corporation

Address 345 N. Main, Sullivan, Ind. 47882

Address 1300 West Belt, Houston, TX 77042

Mineral Owner See Attachment

Farm J. Moyle Tract Acres 100

Address _____

Location (waters) Big Laurel Run of Tygart River

Coal Owner Meadowlark Farms, Inc.

Well No. J. Moyle #1 Elevation 2420

Address 105 S. Meridian, Indianapolis, Ind. 46225

District Roaring Creek County Randolph

Coal Operator Meadowlark Farms, Inc.

Quadrangle Ellamore, W. VA. 7.5 minute

Address 105 S. Meridian, Indianapolis, Ind. 46225

THIS PERMIT MUST BE POSTED AT THE WELL SITE

All provisions being in accordance with Chapter 22, of the W. Va. Code, the location is hereby approved for drilling. This permit shall expire if operations have not commenced by 8-30-81.

INSPECTOR Robert Stewart
TO BE NOTIFIED _____

ADDRESS P. O. Box 345, Jane Lew, W. VA 2637

PHONE 884-7782

Reg. J. Burnett
Deputy Director - Oil & Gas Division

GENTLEMEN:

The undersigned well operator is entitled to drill upon the above named farm or tract of land for oil and gas, having fee title thereto, (or as the case may be) under grant or lease dated April 3 1980 by AMAX Coal Company made to AMAX Petroleum Corporation and recorded on the 12th day of May 1980, in Randolph County, Book 330 Page 424

NEW WELL DRILL DEEPER REDRILL FRACTURE OR STIMULATE
 OIL AND GAS WELL ORIGINALLY DRILLED BEFORE JUNE 5, 1969.

The enclosed plat was prepared by a registered engineer or licensed land surveyor and all coal owners and/or operators have been notified as of the above date.

The above named coal owners and/or operator are hereby notified that any objection they wish to make, or are required to make by Section 3 of the Code, must be received by, or filed with the Department of Mines within ten (10) days. *

Copies of this notice and the enclosed plat were mailed by registered mail, or delivered to the above named coal operators or coal owners at their above shown respective address _____ day _____ before, or on the same day with the mailing or delivery of this copy to the Department of Mines at Charleston, West Virginia.

PLEASE SUBMIT COPIES OF ALL
GEOPHYSICAL LOGS DIRECTLY TO:

WEST VIRGINIA GEOLOGICAL AND
ECONOMIC SURVEY
P. O. BOX 879
MORGANTOWN, WEST VIRGINIA 26505
AC-304 - 292-6331

Very truly yours,

(Sign Name) AMAX Petroleum Corporation
Well Operator

Address of Well Operator
1300 West Belt Street
Houston City or Town
Texas 77042 State

03/22/2024

*SECTION 3 If no objections are filed or found by the Department of mines, within said period of ten days from the receipt of notice and plat by the department of mines, to said proposed location, the department shall forthwith issue to the well operator a permit reciting the filing of such plat, that no objections have been made by the coal operators or found thereto by the department and that the same is approved and the well operator authorized to proceed.

BLANKET BOND

47-083-0361

PERMIT NUMBER

"I have read and understand the reclamation requirements as set forth in Chapter 22, Article 4, Section 12-6 and will carry out the specified requirements."

Signed by

Ch. Remick

WELL SITE PLAN

- | | | | |
|---------------------------|--|------------|--|
| Legend: Property Boundary | | Diversion | |
| Road | | Spring | |
| Existing Fence | | Wet Spot | |
| Planned Fence | | Building | |
| Stream | | Drain Pipe | |
| Open Ditch | | Waterway | |

Sketch to include well location, existing access road, roads to be constructed, wellsite, drilling pits and necessary structures numbered or lettered to correspond with first part of this plan. Include all natural drainage.

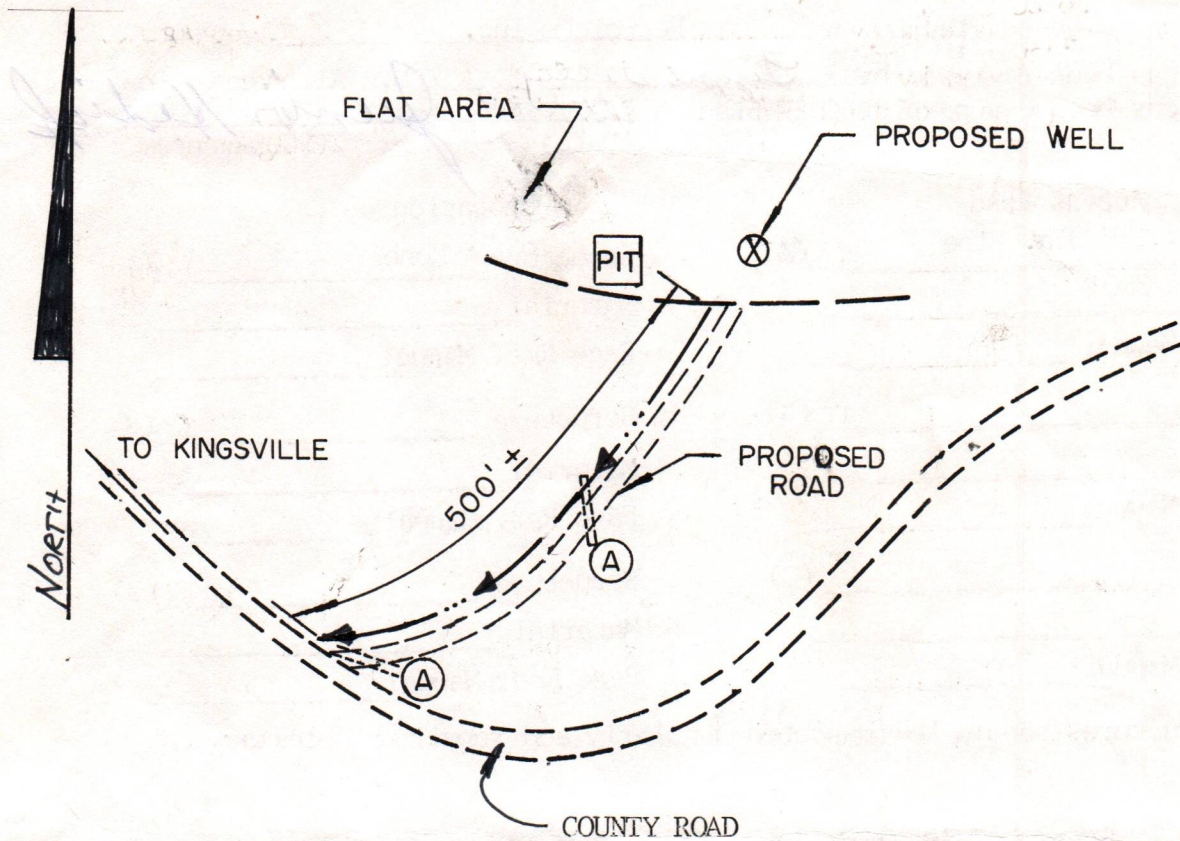

- Comments:
- 1.) Disturbed area to be kept to a minimum
 - 2.) Cut slopes to be 2:1.
 - 3.) Trees and brush to be cut, stacked and burned.
-
-
-
-
-
-

Please request landowners cooperation to protect new seeding for one planting season.

03/22/2024

ATTACHMENT TO OIL & GAS WELL PERMIT APPLICATION

Well No.: J. Moyle #1
County: Randolph

Mineral Owners

Coal - Meadowlark Farms, Inc.
105 S. Meridian
Indianapolis, Indiana 46225

Oil & Gas - AMAX Petroleum Corporation
1300 West Belt - P. O. Box 42806
Houston, Texas 77042

RECEIVED

SEP 17 1980

OIL & GAS DIVISION
DEPT. OF MINES

03/22/2024



PETROLEUM CORPORATION

1300 WEST BELT

P. O. BOX 42806

HOUSTON, TEXAS 77042

TELEPHONE (713) 978-7700

TELEX 79-1435

FENTON EASTERLING
Vice President
Production

April 30, 1981

RECEIVED
JFH
MAY - 4 1981

State of West Virginia
Department of Mines
Oil & Gas Division
Charleston, West Virginia 25305

OIL & GAS DIVISION
DEPT. OF MINES

Gentlemen:

We respectfully request permission to change the names of the following wells located in Randolph County:

<u>Present Lease & Well No.</u>	<u>Permit No.</u>	<u>Proposed Lease & Well No.</u>
B. Hamilton No. 1	47-083-0356	Parks No. 1
B. Hamilton No. 2	47-083-0357	Parks No. 2
B1 Hamilton No. 3	47-083-0358	Parks No. 3
B. Hamilton No. 4	47-083-0359	Towers No. 1
B. Hamilton No. 5	47-083-0360	Towers No. 2
J. Moyle No. 1	47-083-0361	Blackburn No. 1
J. Moyle No. 2	47-083-0362	Blackburn No. 2
J. Brown No. 1	47-083-0452	Crowl No. 1
J. Brown No. 2	47-083-0453	Crowl No. 2
J.T. Cain No. 1	47-083-0454	Crowl No. 3
P.J. Coyne No. 1	47-083-0455	Greer No. 1
P.J. Coyne No. 2	47-083-0456	Greer No. 2

If additional information is required, please advise.

Regards,

H. Fenton Easterling

HFE:mlm

03/22/2024

Formation	Color	Hard or Soft	Top Feet	Bottom Feet	Oil, Gas or Water	Remarks
Big Lime			1,282'	1,370'		
Big Injun			1,371'	1,502'		
Sand & Shale			1,503'	1,635'		
Pocono			1,636'	1,670'		
Sand & Shale			1,671'	2,048'		
4th Sand			2,049'	2,081'		
Sand & Shale			2,082'	2,240'		
5th Sand			2,241'	2,260'		
Sand & Shale			2,261'	2,305'		
Speechly			2,306'	2,348'		
Sand & Shale			2,349'	2,423'		
Balltown			2,424'	2,436'		
Sand & Shale			2,437'	3,664'		
Riley			3,665'	3,775'		
Sand & Shale			3,776'	3,873'		
Benson			3,874'	3,916'		
Sand & Shale			3,917'	4,149'		
1st Elk			4,150'	4,182'		
Sand & Shale			4,183'	4,259'		
2nd Elk			4,260'	4,292'		
Sand & Shale			4,293'	5,095'		
Haverty			5,096'	5,117'		
Sand & Shale			5,118'	5,131'		
4th Elk			5,132'	5,140'		
Sand & Shale			5,141'	5,317'		
Fox			5,318'	5,328'		
Sand & Shale			5,329'	5,375'		
Total Depth				5,375'		

Date August 26, **03/22/2024**, 19 **81**

APPROVED AMAX Petroleum Corp. Owner

By *Reggie Johnson*
Reggie Johnson

Date: August 26, 1981
 Operator's Well No. Blackburn #1
 API Well No. 47-083-0361

RECEIVED

AUG 31 1981

OIL AND GAS DIVISION of West Virginia
 WV DEPARTMENT OF MINES
 Department of Mines
 Oil and Gas Division

WELL RECORD

Well Type: Oil / Gas X / Liquid Injection / Waste Disposal /
 (If "Gas", Production X / Underground storage / Deep / Shallow X /
 Location: Elevation: 2,420' Watershed Big Laurel Run of Tygart River 7.5 min.
 District: Roaring Creek County: Randolph Quadrangle: Ellamore, W.Va
 Well Operator AMAX PETROLEUM CORP. Designated Agent W. M. Woodroe
 Address 1300 West Address Charleston National Plaza
Houston, Texas 77042 Charleston, W. Va. 25301

Permitted Work: Drill X / Covert / Drill deeper / Redrill /
 Fracture or stimulate / Plug off old formation /
 Preforate new formation / Other physical change in well (specify)

Permit Issued on 9/30/80

Oil & Gas Inspector for This Work:

Name: Robert Stewart
 Address: P. O. Box 345
Jane Lew, W. Va. 26378

Geological Target Formation: Elk Depth 5,200 feet
 Depth of completed well, 5,375' feet Rotary X / Cable Tools /
 Water strata depth: Fresh 25 feet; Salt; feet.
 Coal seam depths: Is coal being mined in the area?
 Work was commenced 2/5/81, and completed 2/27/81

Casing and Tubing Program

Casing or Tubing Type	Specifications				Footage Intervals		Cement Fill-Up Or Sacks (cubic feet)	
	Size	Grade	Weight per ft	New	Used	For drilling		Left in well
Conductor	11 ³ / ₄ "			X		32'	32'	15 sxs. std. 1 sx. CaCl ₂
Fresh Water								
Coal								
Intermediate	8 ⁵ / ₈ "		23#/ft.	X		1241'	1241'	Cmt. to surf.
Production	4 ¹ / ₂ "		10.5#/ft	X		5333'	5333'	Cmt. to 3000'
Tubing								
Liners								

Well Treatment details:

Perforated Haverty @ 5,110'-16' & 5,097'-106' w/1SPF. Frac'd w/250 gal. 15% HCl & 100 bbls. gel & 10,000# 80/100 @ 34 BPM & 2,600#. Followed w/385 bbls. gel & 30,000# 20/40 @ 34 BPM & 2,600#. Perforated Benson @ 3,905-12' & 3,875'-82' w/1SPF. Frac'd w/500 gal. 15% HCl & 100 bbls. gel & 10,000# 80/100 @ 38 BPM & 2,200#. Followed w/364 bbls. gel & 30,000# 20/40 @ 38 BPM & 2,200#. Perforated Riley @ 3,734'-46', 3,687'-92' & 3,665'-69' w/1SPF. Frac'd w/500 gal. 15% HCl & 100 bbls. gel & 10,000# 80/100 @ 38 BPM & 1,450#. Followed w/360 bbls. gel & 30,000# 20/40 @ 38 BPM & 1,450#.

Gas: Initial open flow, Mcf/d Oil: Initial open flow, Bbl/d
 Final open flow, 1,100 Mcf/d Final open flow, Bbl/d
 Static Rock Pressure, 1,775 psig (surface measurement) after 72 hours shut in.

(Well log on reverse side)

03/22/2024

STATE OF WEST VIRGINIA
DEPARTMENT OF MINES
OIL AND GAS WELLS DIVISION

RECEIVED

FEB - 9 1981

INSPECTOR'S WELL REPORT

OIL & GAS DIVISION
DEPT. OF MINES & GEOLOGICAL SURVEY

OGAS

Permit No. 083-0361

Company <u>AMAX Petroleum</u>	CASING AND TUBING	USED IN DRILLING	Left in Well	PACKERS
Address <u>HOUSTON TEXAS</u>	Size			
Farm <u>J. Moyle</u>	16			Kind of Packer
Well No. <u># 1</u>	13			
District <u>REARING CREEK County RANDOLPH</u>	10			Size of
Drilling commenced <u>2-5-81</u>	8 1/4			Depth set
Drilling completed _____ Total depth _____	6 1/4			
Date shot _____ Depth of shot _____	5 3/16			Perf. top
Initial open flow _____ /10ths Water in _____ Inch	3			Perf. bottom
Open flow after tubing _____ /10ths Merc. in _____ Inch	2			Perf. top
Volume _____ Cu Ft.	Liners Used			Perf. bottom
Rock pressure _____ lbs. _____ hrs.	CASING CEMENTED _____ SIZE _____ No. FT _____ Date _____			
Oil _____ bbls., 1st 24 hrs.	NAME OF SERVICE COMPANY _____			
Fresh water _____ feet _____ feet	COAL WAS ENCOUNTERED AT _____ FEET _____ INCHES			
Salt water _____ feet _____ feet	_____ FEET _____ INCHES _____ FEET _____ INCHES			
	_____ FEET _____ INCHES _____ FEET _____ INCHES			

Drillers' Names RAY Resources

Remarks: Move Rig STD

2-5-81
DATE

Robert Stewart
DISTRICT SUPERVISOR

03/22/2024

STATE OF WEST VIRGINIA
DEPARTMENT OF MINES
OIL AND GAS WELLS DIVISION

RECEIVED
APR 29 1983

INSPECTOR'S WELL REPORT

OIL & GAS DIVISION
DEPT. OF MINES

Permit No. 083-0361

Oil or Gas Well _____
(KIND)

Company ANAX Petroleum
 Address HOUSTON TEXAS
 Farm J. Noyle
 Well No. #1
 District ROARING CREEK County RANDOLPH
 Drilling commenced 2-5-81
 Drilling completed _____ Total depth _____
 Date shot _____ Depth of shot _____
 Initial open flow _____ /10ths Water in _____ Inch
 Open flow after tubing _____ /10ths Merc. in _____ Inch
 Volume _____ Cu. Ft.
 Rock pressure _____ lbs. _____ hrs.
 Oil _____ bbls., 1st 24 hrs.
 Fresh water _____ feet _____ feet
 Salt water _____ feet _____ feet

CASING AND TUBING	USED IN DRILLING	LEFT IN WELL	PACKERS
Size			
16			Kind of Packer _____
13			
10			Size of _____
8 1/4			
6 5/8			Depth set _____
5 3/16			
3			Perf. top _____
2			Perf. bottom _____
Liners Used			Perf. top _____
			Perf. bottom _____

CASING CEMENTED _____ SIZE _____ No. FT. _____ Date _____
 NAME OF SERVICE COMPANY _____
 COAL WAS ENCOUNTERED AT _____ FEET _____ INCHES
 _____ FEET _____ INCHES _____ FEET _____ INCHES
 _____ FEET _____ INCHES _____ FEET _____ INCHES

Drillers' Names _____

Remarks: _____

O.K. To Release

4-27-83
DATE

Robert Stewart 03/22/2024 511
DISTRICT WELL INSPECTOR

Form 26
2/16/82

STATE OF WEST VIRGINIA
DEPARTMENT OF MINES
OIL AND GAS WELLS DIVISION
INSPECTOR'S PLUGGING REPORT

Permit No. _____

Well No. _____

COMPANY _____ ADDRESS _____

FARM _____ DISTRICT _____ COUNTY _____

Filling Material Used _____

Liner Location Amount Packer Location

PLUGS USED AND DEPTH PLACED			BRIDGES	CASING AND TUBING		
CEMENT-THICKNESS	WOOD-SIZE	LEAD	CONSTRUCTION-LOCATION	RECOVERED	SIZE	LOST

Drillers' Names _____

Remarks: _____

DATE I hereby certify I visited the above well on this date.

03/22/2024

DISTRICT WELL INSPECTOR



State of West Virginia
Department of Mines
Oil and Gas Division
Charleston 25305

WALTER N. MILLER
DIRECTOR

THEODORE M. STREIT
ADMINISTRATOR

May 9, 1983

Amax Petroleum Corporation
1300 West Belt
P. O. Box 42806
Houston, Texas 77042

Gentlemen:

The required records and reports have been received in this office and the District Inspectors have submitted FINAL INSPECTIONS for the following wells listed below:

<u>PERMIT NUMBER</u>	<u>FARM AND WELL NUMBER</u>	<u>DISTRICT</u>
RAN-0361	Meadowlark Farms, Inc./Blackburn #1	Roaring Creek
RAN-0362	Meadowlark Farms, Inc./Blackburn #2	Roaring Creek
RAN-0455	Meadowlark Farms, Inc./Greer #1	Roaring Creek
RAN-0456	Meadowlark Farms, Inc./Greer #2	Roaring Creek

In accordance with Chapter 22, Article 4, Section 2, the above captioned wells will remain under bond coverage for "life of wells." Reclamation requirements have been approved.....

Very truly yours,

Theodore M. Streit, Administrator
Office of Oil & Gas-Dept. Mines

TMS/

03/22/2024

1.0 API well number: (If not available, leave blank. 14 digits.)	<u>47-083-0361</u>			
2.0 Type of determination being sought: (Use the codes found on the front of this form.)	<u>103</u> Section of NGPA		_____ Category Code	
3.0 Depth of the deepest completion location: (Only needed if sections 103 or 107 in 2.0 above.)	<u>5116</u> feet			
4.0 Name, address and code number of applicant: (35 letters per line maximum. If code number not available, leave blank.)	<u>AMAX Petroleum Corporation</u> Name		<u>000446</u> Seller Code	
	<u>P. O. Box 42806</u> Street			
	<u>Houston</u> City	<u>TX</u> State	<u>77042</u> Zip Code	
5.0 Location of this well: [Complete (a) or (b).] (a) For onshore wells (35 letters maximum for field name.)	<u>Roaring Creek</u> Field Name			
	<u>Randolph</u> County		<u>W. Va.</u> State	
(b) For OCS wells:	Area Name _____ Block Number _____			
	Date of Lease: Mo. Day Yr. OCS Lease Number _____			
(c) Name and identification number of this well: (35 letters and digits maximum.)	<u>Blackburn No. 1</u>			
(d) If code 4 or 5 in 2.0 above, name of the reservoir: (35 letters maximum.)	_____			
6.0 (a) Name and code number of the purchaser: (35 letters and digits maximum. If code number not available, leave blank.)	<u>Columbia Gas Transmission Corporation</u> Name		<u>004030</u> Buyer Code	
(b) Date of the contract:	<u>0310141812</u> Mo. Day Yr.			
(c) Estimated annual production:	<u>180</u> MMcf.			
	(a) Base Price (\$/MMBTU)	(b) Tax	(c) All Other Prices [Indicate (+) or (-).]	(d) Total of (a), (b) and (c)
7.0 Contract price: (As of filing date. Complete to 3 decimal places.)	<u>2.634</u>	_ _ _	_ _ _	_ _ _
8.0 Maximum lawful rate: (As of filing date. Complete to 3 decimal places.)	<u>2.634</u>	_ _ _	_ _ _	_ _ _
9.0 Person responsible for this application:	<u>Norman B. Gove</u> Name			
Agency Use Only	<u>Senior Vice President</u> Title			
Date Received by Juris. Agency	<u>Norman B. Gove</u> Signature			
DEC 14 1981	<u>Amended May 7, 1982</u> Date Application is Completed			
Date Received by FERC	<u>December 9, 1981</u>		<u>713/978-7700</u> Phone Number	

U.S. DEPARTMENT OF ENERGY
 Federal Energy Regulatory Commission
 Washington, D.C. 20426

APPLICATION FOR DETERMINATION OF THE MAXIMUM LAWFUL
 PRICE UNDER THE NATURAL GAS POLICY ACT (NGPA)
 (Sections 102, 103, 107 and 108)

PLEASE READ BEFORE COMPLETING THIS FORM:

General Instructions:

Complete this form if you are applying for price classification under sections 102, 103, 107 or 108 of the NGPA. A separate application is required for each well. If any reservoir qualifies for a category which differs from the category applicable to the producing well, separate applications must be made for the producing well and the reservoir. Complete each appropriate item on the reverse side of this page. The code numbers used in items 4.0 and 6.0 can be obtained from the Buyer/Seller Code Book. If there is more than one purchaser or contract, identify the additional information in the space below. Enter any additional remarks in the space below.

Submit the completed application to the appropriate Jurisdictional Agency as listed in title 18 of the CFR, part 274.501. If there are any questions, call (202) 275-4539.

Specific Instructions for Item 2.0, Type of Determination:

<u>Section of NGPA</u>	<u>Category Code</u>	<u>Description</u>
102	1	New OCS Lease
102	2	New onshore well (2.5 mile test)
102	3	New onshore well (1,000 feet deeper test)
102	4	New onshore reservoir
102	5	New reservoir on old OCS Lease
103	-	New onshore production well
107	-	High cost natural gas
108	-	Stripper well

Other Purchasers/Contracts:

<u>Contract Date</u> (Mo. Day Yr.)	<u>Purchaser</u>	<u>Buyer Code</u>
_____	_____	_____
_____	_____	_____
_____	_____	_____

Remarks:

PARTICIPANTS:

DATE: MAY 17 1982

BUYER-SELLER CO

WELL OPERATOR:

AMAX Petroleum Corp.

000446

FIRST PURCHASER:

Columbia Gas Transmission

OTHER:

W. Va. Department of Mines, Oil & Gas Division
 WELL DETERMINATION FILE NUMBER
 811214-103-083-0361
 Use Above File Number on all Communications
 Relating to Determination of this Well

CK 1500
QUALIFIED
 Checked by
~~Depend for a complete well record~~
~~Logistics~~ J. J. Huggins
 2-24-82

CHECK EACH ITEM AS COMPLETE OR NOTE WHAT IS MISSING

ITEM NO.

- 1. FERC -121 Items not completed - Line No. 7.0 + 8.0 b,c,d
- 2. IV-1 Agent W. M. Woodroe
- 3. IV-2 Well Permit _____
- 4. IV-6 Well Plat
- 5. IV-35 Well Record Drilling Deepening _____
- 6. IV-36 Gas-Oil Test: Gas Only _____ Was Oil Produced? _____ Ratio _____
- 7. IV-39 Annual Production _____ years
- 8. IV-40 90 day Production _____ Days off line: _____
- 9. IV-48 Application for certification. Complete?
- 10-17. IV Form 51 - 52 - 53 - 54 - 55 - 56 - 57 - 58 Complete? Affidavit Signed
- 18-28. Other: Survey _____ Logs _____ Geological Charts _____
 Structure Map _____ 1: 4000 Map _____ Well Tabulations _____
 Gas Analyses _____
- (5) Date commenced: 2-5-81 Date completed 2-27-81 Deepened _____
- (5) Production Depth: 5110-16, 3905-12, 3734-46,
- (5) Production Formation: Haverty, Benson, Riley,
- (5) Final Open Flow: 1100 MCF
- (5) After Frac. R. P. 1775 ~~###~~ 72 hrs.
- (6) Other Gas Test: _____
- (7) Avg. Daily Gas from Annual Production: _____
- (8) Avg. Daily Gas from 90-day ending w/1-120 days _____
- (8) Line Pressure: _____ PSIG from Daily R _____
- (5) Oil Production: _____ From Completion Report _____
- 10-17. Does lease inventory indicate enhanced recovery being done NO
- 10-17. Is affidavit signed? Notarized?
- Does official well record with the Department confirm the submitted information? yes 03/22/2024
- Additional information _____ Does computer program confirm? _____
- Was Determination Objected to _____ By Whom? _____

FS

Date December 9 19 81

STATE OF WEST VIRGINIA

Blackburn #1
NGPA Sec. 103

DEPARTMENT OF MINES, OIL AND GAS DIVISION

Operator's
Well No. -

API Well No. 47
State 038
County 0361
Permit

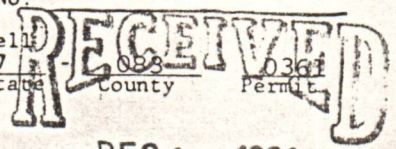

DEC 14 1981

WELL CLASSIFICATION FORM
NEW ONSHORE PRODUCTION WELL

NGPA Section 103

DESIGNATED AGENT W. M. Wood OIL & GAS DIVISION

ADDRESS Charleston National Plaza DEPT. OF MINES

Charleston, Va. 25301

WELL OPERATOR AMAX Petroleum Corporation

LOCATION: Elevation 420'

ADDRESS P. O. Box 42806

Watershed Big Laurel Run of Tygart River

Houston, Texas 77042

Roaring

Dist. Creek County Randolph Quad. Ellamore 7.5

GAS PURCHASER Col Gas Transmission

Gas Purchase

ADDRESS *

Contract No. *

*

Meter Chart Code -

Date of Contract *

* No contract has been finalized or sales made as of the date of this application.

Date surface drilling was begun: February 5, 1981

Indicate the bottom hole pressure of the well and explain how this was calculated:

BHP = 1994

PSI = Shut-in wellhead pressure in PSIA

BHP = PSI + $\frac{(0.01878) (PSI) (G) (L)}{TSI}$

G = Gas gravity (assuming 0.65)

L = Average length of flow string (feet)

PSI = 1790

TSI = Average shut-in well temperature (degrees R)

G = .65

L = 5113

TSI = 547

$$\frac{BHT + 520}{2} = TSI$$

BHT = degrees R absolute

AFFIDAVIT

I, Norman B. Gove, having been first sworn according to law state that surface drilling of the well for which this determination is sought was begun on or after February 19, 1977; the well satisfies applicable state or federal well spacing requirements and the well is not within a proration unit, in existence at the time surface drilling began, which was applicable to the reservoir from which gas is or will be produced and which applied to any other well producing gas in commercial quantities or on which surface drilling began on or after February 19, 1977, and which was capable of producing gas in commercial quantities. I state, further, that I have concluded, to the best of my information, knowledge and belief, that the well for which this determination is sought is a new onshore production well and that I am not aware of any information not described in the application which is inconsistent with this conclusion.

Norman B. Gove

TEXAS

STATE OF ~~XXXXXXXXXXXX~~

COUNTY OF HARRIS, TO WIT:

I, Denise Rosenblum, a Notary Public in and for the state and county aforesaid, do certify that Norman B. Gove, whose name is signed to the writing above, bearing date the 9 day of December, 1981, has acknowledged the same before me, in my county aforesaid.

Given under my hand and official seal this 10 day of December, 19 81.

My term of office expires on the 10 day of November, 19 85.

[NOTARIAL SEAL]

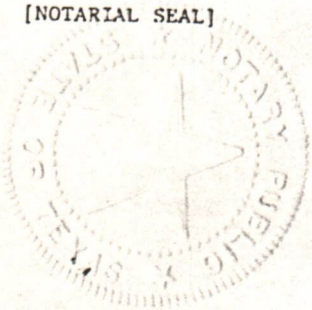

Denise Rosenblum
Notary Public

DENISE ROSENBLUM
Notary Public State of Texas
My Commission Expires November 10, 1985
Bonded by L. Alexander Lovett, Lawyers Surety Corp.

03/22/2024