



STATE OF WEST VIRGINIA  
DEPARTMENT OF MINES

Oil and Gas Division

RECEIVED

SEP 17 1980

OIL & GAS DIVISION  
DEPT. OF MINES

OIL AND GAS WELL PERMIT APPLICATION

TO THE DEPARTMENT OF MINES,  
Charleston, W. Va.

DATE September 9, 1980

Surface Owner AMAX Coal Co. a Div. of AMAX Inc. Company AMAX Petroleum Corporation  
 Address 105 S. Meridian, Indianapolis, Ind. 46225 Address 1300 West Belt, Houston, TX 77042  
 Mineral Owner AMAX Coal Co., a Div. of AMAX Inc. Farm B. Hamilton Tract Acres 198  
 Address (Same as above) Location (waters) Laurel Creek of Middle Fork Riv  
 Coal Owner AMAX Coal Co., a Div. of AMAX Inc. Well No. B. Hamilton #2 Elevation 2170  
 Address (Same as above) District Roaring Creek County Randolph  
 Coal Operator AMAX Coal Co., a Div. of AMAX Inc. Quadrangle Ellamore, W. Va. 7.5 minute  
 Address (Same as above)

THIS PERMIT MUST BE POSTED AT THE WELL SITE

All provisions being in accordance with Chapter 22, of the W. Va. Code, the location is hereby approved for drilling. This permit shall expire if operations have not commenced by 5-30-81.

*Deputy Director - Oil & Gas Division*

INSPECTOR  
TO BE NOTIFIED Robert Stewart  
ADDRESS P. O. Box 345, Jane Lew, W. Va. 26378  
PHONE 844-7782

GENTLEMEN:

The undersigned well operator is entitled to drill upon the above named farm or tract of land for oil and gas, having fee title thereto, (or as the case may be) under grant or lease dated April 3 1980 by AMAX Coal Company made to AMAX Petroleum Corporation and recorded on the 12th day of May 1980 in Randolph County, Book 330 Page 424

NEW WELL  DRILL DEEPER  REDRILL  FRACTURE OR STIMULATE  
 OIL AND GAS WELL ORIGINALLY DRILLED BEFORE JUNE 5, 1969.

The enclosed plat was prepared by a registered engineer or licensed land surveyor and all coal owners and/or operators have been notified as of the above date.

The above named coal owners and/or operator are hereby notified that any objection they wish to make, or are required to make by Section 3 of the Code, must be received by, or filed with the Department of Mines within ten (10) days. \*

Copies of this notice and the enclosed plat were mailed by registered mail, or delivered to the above named coal operators or coal owners at their above shown respective address \_\_\_\_\_ day \_\_\_\_\_ before, or on the same day with the mailing or delivery of this copy to the Department of Mines at Charleston, West Virginia.

PLEASE SUBMIT COPIES OF ALL GEOPHYSICAL LOGS DIRECTLY TO:

WEST VIRGINIA GEOLOGICAL AND ECONOMIC SURVEY  
P. O. BOX 879  
MORGANTOWN, WEST VIRGINIA 26505  
AC-304 - 292-6331

Address of Well Operator

Very truly yours,  
(Sign Name) AMAX Petroleum Corporation  
Well Operator  
1300 West Belt  
Street  
Houston  
City or Town  
Texas 77042  
State

03/22/2024

\*SECTION 3 . . . . If no objections are filed or found by the Department of mines, within said period of ten days from the receipt of notice and plat by the department of mines, to said proposed location, the department shall forthwith issue to the well operator a permit reciting the filing of such plat, that no objections have been made by the coal operators or found thereto by the department and that the same is approved and the well operator authorized to proceed.

BLANKET BOND

47-083-0357

PERMIT NUMBER

"I have read and understand the reclamation requirements as set forth in Chapter 22, Article 4, Section 12-b and will carry out the specified requirements."

Signed by *Deputy Director - Oil & Gas Division*







WELL SITE PLAN

- |         |                   |  |            |  |
|---------|-------------------|--|------------|--|
| Legend: | Property Boundary |  | Diversion  |  |
|         | Road              |  | Spring     |  |
|         | Existing Fence    |  | Wet Spot   |  |
|         | Planned Fence     |  | Building   |  |
|         | Stream            |  | Drain Pipe |  |
|         | Open Ditch        |  | Waterway   |  |

Sketch to include well location, existing access road, roads to be constructed, wellsite, drilling pits and necessary structures numbered or lettered to correspond with first part of this plan. Include all natural drainage.

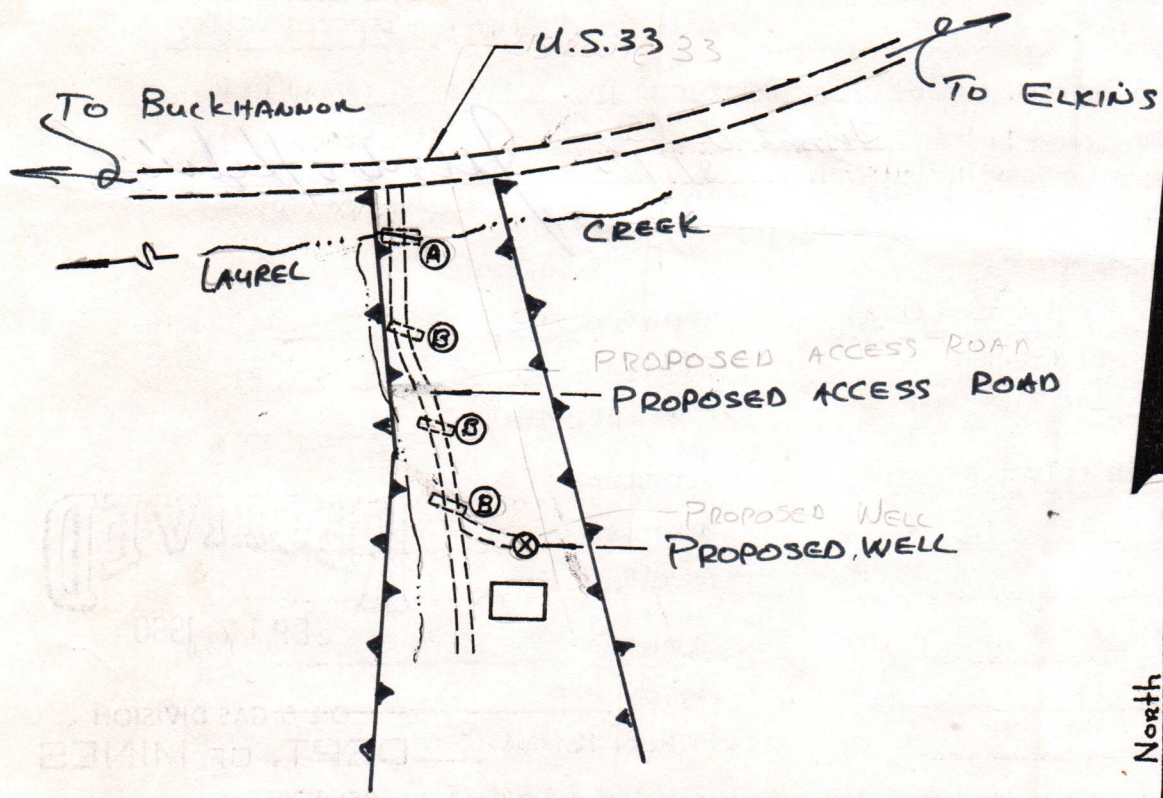

- Comments:
- 1.) Disturbed area to be kept to a minimum.
  - 2.) Cut slopes to be 2:1.
  - 3.) New access road to follow old logging road. Road to be widened with the trees and brush to be stacked and burned.
  - 4.) New 30" culverts to replace old bridge across Laurel Creek.
  - 5.) New culverts to be at natural drain areas or at 300' maximum spacing. Ditches to be cut on the uphill side of access road where necessary.

Please request landowners cooperation to protect new seeding for one planting season.

03/22/2024



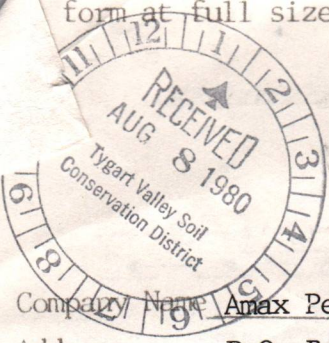

Date \_\_\_\_\_ 19\_\_\_\_  
Well No. B. HAMILTON # 2  
API No. 47-083-0357

STATE OF WEST VIRGINIA  
OFFICE OF OIL AND GAS

Company Name Amax Petroleum Inc.  
Address P.O. Box 42806  
Telephone Houston, Texas 77042  
Landowner Amax Inc.

Designated Agent Kenneth I. Reiss  
Address P.O. Box 42806 Houston, Texas  
Telephone 1-713-978-7700  
Soil Cons. District Tygart's Valley

Revegetation to be carried out by Amax Petroleum Inc. (Agent)

This plan has been reviewed by Tygart Valley SCD. All corrections and additions become a part of this plan. 8/9/80 (Date) J. J. Reiss (SCD Agent)

Access Road \_\_\_\_\_ Location \_\_\_\_\_  
Structure 30" Dia culverts (2) (A)  
Spacing in Laurel Creek  
Page Ref. Manual I-24

Structure None (1)  
Material \_\_\_\_\_  
Page Ref. Manual \_\_\_\_\_

Structure 12" Dia culverts (B)  
Spacing 300'  
Page Ref. Manual I-8

Structure \_\_\_\_\_ (2)  
Material \_\_\_\_\_  
Page Ref. Manual \_\_\_\_\_

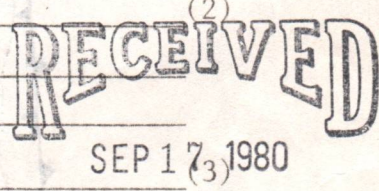

Structure \_\_\_\_\_ (C)  
Spacing \_\_\_\_\_  
Page Ref. Manual \_\_\_\_\_

Structure \_\_\_\_\_  
Material \_\_\_\_\_  
Page Ref. Manual \_\_\_\_\_  
OIL & GAS DIVISION  
DEPT. OF MINES

All structures should be inspected regularly and repaired if necessary.

Revegetation

Treatment Area I  
Lime Estimated 3 Tons/acre  
or correct to pH 6.5  
Fertilizer 600 lbs./acre  
(10-20-20 or equivalent)  
Mulch Hay 2 Tons/acre  
Seed\* Kentucky 31 40 lbs./acre  
Birdsfoot Trefoil 10 lbs./acre  
Ryegrass 10 lbs./acre

Treatment Area II  
Lime Estimated 3 Tons/acre  
or correct to pH 6.5  
Fertilizer 600 lbs./acre  
(10-20-20 or equivalent)  
Mulch Hay 2 Tons/acre  
Seed\* Kentucky 31 40 lbs./acre  
Birdsfoot Trefoil 10 lbs./acre  
Ryegrass 10 lbs./acre

\*Inoculate all legumes such as vetch, trefoil and clovers with the proper bacterium. Inoculate with 3X recommended amount.

**ROAD DRILL**

Attach or photocopy section of involved Topographic map. Quadrangle Ellamore, W.Va.

Legend: Well Site  
 Access Road





# AMAX PETROLEUM CORPORATION

1300 WEST BELT P. O. BOX 42806 HOUSTON, TEXAS 77042  
TELEPHONE (713) 978-7700 TELEX 79-1435

FENTON EASTERLING  
Vice President  
Production

April 30, 1981

RECEIVED  
JFH  
MAY - 4 1981

State of West Virginia  
Department of Mines  
Oil & Gas Division  
Charleston, West Virginia 25305

OIL & GAS DIVISION  
DEPT. OF MINES

Gentlemen:

We respectfully request permission to change the names of the following wells located in Randolph County:

<u>Present Lease &amp; Well No.</u>	<u>Permit No.</u>	<u>Proposed Lease &amp; Well No.</u>
B. Hamilton No. 1	47-083-0356	Parks No. 1
B. Hamilton No. 2	47-083-0357	Parks No. 2
B1 Hamilton No. 3	47-083-0358	Parks No. 3
B. Hamilton No. 4	47-083-0359	Towers No. 1
B. Hamilton No. 5	47-083-0360	Towers No. 2
J. Moyle No. 1	47-083-0361	Blackburn No. 1
J. Moyle No. 2	47-083-0362	Blackburn No. 2
J. Brown No. 1	47-083-0452	Crowl No. 1
J. Brown No. 2	47-083-0453	Crowl No. 2
J.T. Cain No. 1	47-083-0454	Crowl No. 3
P.J. Coyne No. 1	47-083-0455	Greer No. 1
P.J. Coyne No. 2	47-083-0456	Greer No. 2

If additional information is required, please advise.

Regards,

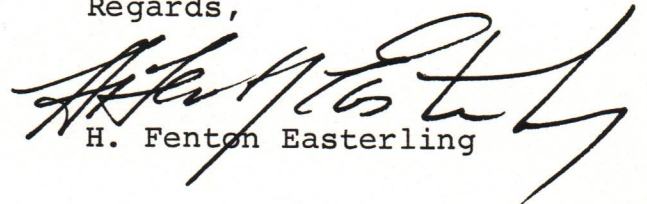
  
H. Fenton Easterling

HFE:mlm

03/22/2024



Formation	Color	Hard or Soft	Top Feet	Bottom Feet	Oil, Gas or Water	Remarks
Pocono			1,292'	1,303'		
Sand & Shale			1,304'	1,577'		
4th Sand			1,578'	1,614'		
Sand & Shale			1,615'	1,851'		
5th Sand			1,852'	1,868'		
Sand & Shale			1,869'	2,008'		
Speechly			2,009'	2,031'		
Sand & Shale			2,032'	2,098'		
Balltown			2,099'	2,106'		
Sand & Shale			2,107'	3,301'		
Riley			3,302'	3,369'		
Sand & Shale			3,370'	3,457'		
Benson			3,458'	3,550'		
Sand & Shale			3,551'	3,689'		
1st Elk			3,690'	3,720'		
Sand & Shale			3,721'	3,823'		
2nd Elk			3,824'	3,844'		
Sand & Shale			3,845'	4,776'		
Haverty			4,777'	4,822'		
Sand & Shale			4,823'	4,889'		
4th Elk			4,890'	4,895'		
Sand & Shale			4,896'	5,008'		
Fox			5,009'	5,019'		
Sand & Shale			5,020'	5,134'		
Total Depth				5,134'		

Date August 26 03/22/2024, 19 81

APPROVED AMAX PETROLEUM CORP. Owner

By Reggie Johnson  
Reggie Johnson



**RECEIVED**

AUG 31 1981  
 State of West Virginia  
 OIL AND GAS DIVISION  
 WV DEPARTMENT OF MINES  
 Oil and Gas Division  
 WELL RECORD

Well Type: Oil  / Gas  / Liquid Injection  / Waste Disposal   
 (If "Gas", Production  / Underground storage  / Deep  / Shallow  /  
 Location: Elevation: 2,170' Watershed Laurel Creek of Middle Fork River  
Ellamore, W. Va.  
 District: Roaring Creek County: Randolph Quadrangle: 7.5 Min.  
 Well Operator AMAX Petroleum Corporation Designated Agent W. M. Woodroe  
 Address 1300 West Belt Address Charleston National Plaza  
Houston, Texas 77042 Charleston, W. Va. 25301  
 Permitted Work: Drill  / Covert  / Drill deeper  / Redrill  /  
 Fracture or stimulate  / Plug off old formation  /  
 Preforate new formation  / Other physical change in well (specify) \_\_\_\_\_

Permit Issued on 9/30/80

Oil & Gas Inspector for This Work:

Name: Robert Stewart  
 Address: P. O. Box 345  
Jane Lew, W. Va. 26378

Geological Target Formation: ELK Depth 5,000 feet  
 Depth of completed well, 5,134 feet Rotary  / Cable Tools  /  
 Water strata depth: Fresh 30 feet; Salt; \_\_\_\_\_ feet.  
 Coal seam depths: \_\_\_\_\_ Is coal being mined in the area? \_\_\_\_\_  
 Work was commenced 3/31/81, and completed 4/15/81

Casing and Tubing Program

Casing or Tubing Type	Size	Specifications		Footage Intervals		Cement Fill-Up Or Sacks (cubic feet)		
		Grade	Weight per ft	New	Used		For drilling	Left in well
Conductor	16"			X		36'	36'	10 sx. std. 1 sx. CaCl <sub>2</sub>
Fresh Water	11 <sup>3</sup> / <sub>4</sub> "			X		45'	45'	15 sx. std. 1 sx. CaCl <sub>2</sub>
Coal								
Intermediate	8 <sup>5</sup> / <sub>8</sub> "		23#/ft.	X		1,222'	1,222'	Cmt. to surf
Production	4 <sup>1</sup> / <sub>2</sub> "		10.5#/ft	X		5,064'	5,064'	Cmt. to 2000'
Tubing								
Liners								

Well Treatment details:

Perforate Haverty @ 4,813'-15', 4,803'-07', 4,790'-800', 4,780'-86' w/1SPF. Frac'd w/250 gal. 15% HCl + 120 bbls. gel & 15,000# 80/100 sd. @ 32 BPM & 2,600#. Followed w/390 bbls. gel & 60,000# 20/40 sd. @ 34 BPM & 2,500#. Perforate Benson @ 3,518'-26, 3,491'-99' & 3,467'-75' w/1SPF. Frac'd w/500 Gal. 15% HCl + 120 bbls gel & 15,000#. 80/100 @ 38 BPM & 2,100#. Followed w/240 bbls. gel & 35,000# 20/40 @ 41 BPM & 2,100#.

03/22/2024

Gas: Initial open flow, \_\_\_\_\_ Mcf/d Oil: Initial open flow, \_\_\_\_\_ Bbl/d  
 Final open flow, 1,160 Mcf/d Final open flow, \_\_\_\_\_ Bbl/d  
 Static Rock Pressure, 1,650 psig (surface measurement) after 72 hours shut in.

(Well log on reverse side)



STATE OF WEST VIRGINIA  
DEPARTMENT OF MINES  
OIL AND GAS WELLS DIVISION

RECEIVED

APR 1 1981

INSPECTOR'S WELL REPORT

OIL & GAS DIVISION  
DEPT. OF MINES

Report No. 083-0357

Company	Address	Farm	Well No.	District	Drilling commenced	Drilling completed	Date shot	Initial open flow	Open flow after tubing	Volume	Rock pressure	Oil	Fresh water	Salt water	Casing and Tubing	Used in Drilling	Left in Well	Packers		
																			Size	Kind of Packer
<u>ANAX PRODUCTIONS</u>	<u>HOUSTON TEXAS</u>	<u>B. HAMILTON</u>	<u># 2</u>	<u>REARING CREEK County RANDOLPH</u>	<u>3-30-81</u>															
															CASING CEMENTED	SIZE	No. FT	Date		
															NAME OF SERVICE COMPANY					
															COAL WAS ENCOUNTERED AT				FEET	INCHES
															FEET	INCHES	FEET	INCHES		
															FEET	INCHES	FEET	INCHES		

Drillers' Names RAY Resources Rig - 14

Remarks: Move Rig SPUD

3-30-81  
DATE

Robert Stewart  
DISTRICT INSPECTOR

03/22/2024







STATE OF WEST VIRGINIA  
DEPARTMENT OF MINES  
OIL AND GAS WELLS DIVISION

INSPECTOR'S WELL REPORT

Permit No. 093-0357

Oil or Gas Well GAS  
KIND

Company	CASING AND TUBING	USED IN DRILLING	Left in Well	PACKERS
<u>AMAX PRODUCTION</u>				
<u>HOUSTON TEXAS</u>	Size			
<u>B. HAMILTON</u>	16			Kind of Packer
<u># 2</u>	13			
<u>RRADING CREEK County RANDOLPH</u>	10			Size of
<u>3-30-81</u>	<u>8 5/8</u>		<u>1222</u>	<u>310 SKS</u>
<u>3-30-81</u>	6			Depth set
	5 3/16			
	3			Perf top
	2			Perf bottom
	Liners Used			Perf top
				Perf bottom
	CASING CEMENTED <u>8 5/8</u>	SIZE <u>1222</u>	No. FT <u>4-3-81</u>	Date
	NAME OF SERVICE COMPANY <u>HALLIBURTON</u>			
	COAL WAS ENCOUNTERED AT _____ FEET _____ INCHES			
	_____ FEET _____ INCHES _____ FEET _____ INCHES			
	_____ FEET _____ INCHES _____ FEET _____ INCHES			

Drillers' Names RAY Resources Rig-14

Remarks: Cement to SURFACE  
LOGGED Hole NO COAL

RECEIVED  
APR - 7 1981

OIL & GAS DIVISION  
DEPT. OF MINES

4-3-81

DATE

Robert Stewart 511  
DISTRICT INSPECTOR

03/22/2024







STATE OF WEST VIRGINIA  
DEPARTMENT OF MINES  
OIL AND GAS WELLS DIVISION

RECEIVED

DEC 13 1982

OIL AND GAS DIVISION  
WV DEPARTMENT OF MINES

INSPECTOR'S WELL REPORT

Permit No. 083-0357

Oil or Gas Well \_\_\_\_\_  
(KIND)

Company ANAX PET

Address \_\_\_\_\_

Farm B. HAMILTON

Well No. #2

District BOARING CREEK County RANDOLPH

Drilling commenced 3-30-81

Drilling completed \_\_\_\_\_ Total depth \_\_\_\_\_

Date shot \_\_\_\_\_ Depth of shot \_\_\_\_\_

Initial open flow \_\_\_\_\_ /10ths Water in \_\_\_\_\_ Inch

Open flow after tubing \_\_\_\_\_ /10ths Merc. in \_\_\_\_\_ Inch

Volume \_\_\_\_\_ Cu. Ft.

Rock pressure \_\_\_\_\_ lbs. \_\_\_\_\_ hrs.

Oil \_\_\_\_\_ bbls., 1st 24 hrs.

Fresh water \_\_\_\_\_ feet \_\_\_\_\_ feet

Salt water \_\_\_\_\_ feet \_\_\_\_\_ feet

CASING AND TUBING	USED IN DRILLING	LEFT IN WELL	PACKERS
Size			
16			Kind of Packer _____
13			
10			Size of _____
8 1/4			
6 3/8			Depth set _____
5 3/16			
3			Perf. top _____
2			Perf. bottom _____
Liners Used			Perf. top _____
			Perf. bottom _____

CASING CEMENTED \_\_\_\_\_ SIZE \_\_\_\_\_ No. FT. \_\_\_\_\_ Date \_\_\_\_\_

NAME OF SERVICE COMPANY \_\_\_\_\_

COAL WAS ENCOUNTERED AT \_\_\_\_\_ FEET \_\_\_\_\_ INCHES

\_\_\_\_\_ FEET \_\_\_\_\_ INCHES FEET \_\_\_\_\_ INCHES

\_\_\_\_\_ FEET \_\_\_\_\_ INCHES FEET \_\_\_\_\_ INCHES

Drillers' Names \_\_\_\_\_

Remarks: \_\_\_\_\_

O.K. To Release

12-10-82

DATE

Robert Stewart 03/22/2024 54

DISTRICT WELL INSPECTOR









State of West Virginia

Department of Mines

Oil and Gas Division

Charleston 25305

WALTER N. MILLER  
DIRECTOR

January 6, 1983

Amax Petroleum Corp.  
P. O. Box 42806  
Houston, Texas 77042

Dear Sir:

The required records and reports have been received in this office and the District Inspectors have submitted Final Inspections for the following wells listed below:

<u>PERMIT NO.</u>	<u>FARM AND WELL NUMBER</u>	<u>DISTRICT</u>
RAN-0356	B. Hamilton Farm, Parks #1 Well	Roaring Creek
RAN-0357	B. Hamilton Farm, Parks #2 Well	Roaring Creek
RAN-0452	J. Brown Farm, Crowl #1 Well	Roaring Creek
RAN-0453	J. Brown Farm, Crowl #2 Well	Roaring Creek
RAN-0454	J. T. Cain Farm, Crowl #3 Well	Roaring Creek

In accordance with Chapter 22, Article 4, Section 2, the bond coverage for above captioned wells will stay in force for life of well. Reclamation requirements have been approved..... ..

Very truly yours,

Theodore M. Streit

03/22/2024



1.0 API well number: (If not available, leave blank. 14 digits.)	_____ 47-083-0357				
2.0 Type of determination being sought: (Use the codes found on the front of this form.)	103 Section of NGPA	Category Code <u>13</u>			
3.0 Depth of the deepest completion location: (Only needed if sections 103 or 107 in 2.0 above.)	_____ 4815 feet				
4.0 Name, address and code number of applicant: (35 letters per line maximum. If code number not available, leave blank.)	AMAX Petroleum Corporation Name		000446 Seller Code		
	P.O. Box 42806 Street				
	Houston City	TX State	77042 Zip Code		
5.0 Location of this well: [Complete (a) or (b).] (a) For onshore wells (35 letters maximum for field name.)	Roaring Creek Field Name				
	Randolph County		WV State		
(b) For OCS wells:	_____ Area Name		_____ Block Number		
	Date of Lease: _____ Mo. Day Yr.				
(c) Name and identification number of this well: (35 letters and digits maximum.)	_____ Parks No. 2				
(d) If code 4 or 5 in 2.0 above, name of the reservoir: (35 letters maximum.)	_____				
6.0 (a) Name and code number of the purchaser: (35 letters and digits maximum. If code number not available, leave blank.)	* Name		_____ Buyer Code		
(b) Date of the contract:	* _____ Mo. Day Yr.				
(c) Estimated annual production:	_____ 180 MMcf.				
		(a) Base Price (\$/MMBTU)	(b) Tax	(c) All Other Prices [Indicate (+) or (-).]	(d) Total of (a), (b) and (c)
7.0 Contract price: (As of filing date. Complete to 3 decimal places.)		* ---	* ---	* ---	* ---
8.0 Maximum lawful rate: (As of filing date. Complete to 3 decimal places.)		2 5 1 4 ---	---	---	---
9.0 Person responsible for this application:	Norman B. Gove Name				
Agency Use Only	Vice President Title				
Date Received by Juris. Agency OCT 13 1981	_____ Signature				
Date Received by FERC	October 2, 1981 Date Application is Completed		713/978-7700 Phone Number		

\* No contract has been finalized or sales made as of the date of this application.

FT7900806/2-2

03/22/2024



PARTICIPANTS:

DATE: JAN 14 1982

BUYER-SELLER CODE

WELL OPERATOR: AMAX Petroleum Corp

000446

FIRST PURCHASER: Columbia Gas Trans.

OTHER: \_\_\_\_\_

W. Va. Department of Mines, Oil & Gas Division  
WELL DETERMINATION FILE NUMBER

81-10-13 - 103-083 = 0357

Use Above File Number on all Communications  
Relating to Determination of this Well

083-0158 = 700' FFE

083-0158 = 700' FFE  
Payant  
T.D. 2139

*Qualifies J. H. Huggins*

CHECK EACH ITEM AS COMPLETE OR NOTE WHAT IS MISSING

ITEM NO.

- 1. FERC -121  Items not completed - Line No. 7.0 all 8.0 bcd
- 2. IV-1 Agent W.M. Woodroe
- 3. IV-2 Well Permit —
- 4. IV-6 Well Plat
- 5. IV-35 Well Record  Drilling — Deepening —
- 6. IV-36 Gas-Oil Test: Gas Only — Was Oil Produced? — Ratio —
- 7. IV-39 Annual Production — years
- 8. IV-40 90 day Production — Days off line: —
- 9. IV-48 Application for certification. Complete?
- 10-17. IV Form 51 - 52 - 53 54 - 55 - 56 - 57 - 58 Complete?  Affidavit Signed
- 18-28. Other: Survey — Logs — Geological Charts —  
 Structure Map — 1: 4000 Map — Well Tabulations —  
 Gas Analyses —
- (5) Date commenced: 3-31-81 Date completed 4-15-81 Deepened —
- (5) Production Depth: 4780 - 4815 3467 - 3526
- (5) Production Formation: Haverly Benson
- (5) Final Open Flow: 1160 mcf
- (5) After Frac. R. P. 1650 # 72 hrs
- (6) Other Gas Test: —
- (7) Avg. Daily Gas from Annual Production: —
- (8) Avg. Daily Gas from 90-day ending w/1-120 days —
- (8) Line Pressure: — PSIG from Daily Repo
- (5) Oil Production: — From Completion Report —
- 10-17. Does lease inventory indicate enhanced recovery being done No
- 10-17. Is affidavit signed?  Notarized?  03/22/2024
- Does official well record with the Department confirm the submitted information? yes
- Additional information — Does computer program confirm? —
- Was Determination Objected to — By Whom? —

*HTT*



Parks No. 2  
NGPA Sec. 103

STATE OF WEST VIRGINIA  
DEPARTMENT OF MINES, OIL AND GAS DIVISION

Date October 2 19 81

Operator's Well No. \_\_\_\_\_  
API Well No. 47 - 083 - 0357  
State County Permit

WELL CLASSIFICATION FORM

NEW ONSHORE PRODUCTION WELL

NGPA Section 103

DEPT. OF MINES

DESIGNATED AGENT W. M. Woodroe

ADDRESS Charleston National Plaza  
Charleston, W. Va. 25301

WELL OPERATOR AMAX Petroleum Corporation

LOCATION: Elevation 2170'

ADDRESS P. O. Box 42806

Watershed Laurel Creek of Middle Fork River  
Roaring

Houston, Texas 77042

Dist. Creek County Randolph Quad. Ellamore 7.5

GAS PURCHASER \*

Gas Purchase Contract No. \*

ADDRESS \*

Meter Chart Code -

\*

Date of Contract \*

\* No contract has been finalized or sales made as of the date of this application.

\* \* \* \* \*

Date surface drilling was begun: March 31, 1981

Indicate the bottom hole pressure of the well and explain how this was calculated:

BHP = 1844

BHP = PSI +  $\frac{(0.01878)(PSI)(G)(L)}{TSI}$

PSI = 1665

G = .65

L = 4814

TSI = 548

PSI = Shut-in wellhead pressure in PSIA  
G = Gas gravity (assuming 0.65)  
L = Average length of flow string (feet)  
TSI = Average shut-in well temperature (degrees R)

$\frac{BHT + 520}{2} = TSI$

BHT = degrees R absolute

AFFIDAVIT

I, Norman B. Gove, having been first sworn according to law state that surface drilling of the well for which this determination is sought was begun on or after February 19, 1977; the well satisfies applicable state or federal well spacing requirements and the well is not within a proration unit, in existence at the time surface drilling began, which was applicable to the reservoir from which gas is or will be produced and which applied to any other well producing gas in commercial quantities or on which surface drilling began on or after February 19, 1977, and which was capable of producing gas in commercial quantities. I state, further, that I have concluded, to the best of my information, knowledge and belief, that the well for which this determination is sought is a new onshore production well and that I am not aware of any information not described in the application which is inconsistent with this conclusion.

Norman B. Gove

TEXAS  
STATE OF ~~WEST VIRGINIA~~,  
COUNTY OF HARRIS, TO WIT:

I, Gloria Kessler, a Notary Public in and for the state and county aforesaid, do certify that Norman B. Gove, whose name is signed to the writing above, bearing date the 2 day of October, 19 81, has acknowledged the same before me, in my county aforesaid.

Given under my hand and official seal this 6<sup>th</sup> day of October, 1981.

My term of office expires on the 5<sup>th</sup> day of January, 1984.

[NOTARIAL SEAL]

Gloria G. Kessler  
Notary Public

03/22/2024