

Latitude 38° 50'

Longitude 79° 40'

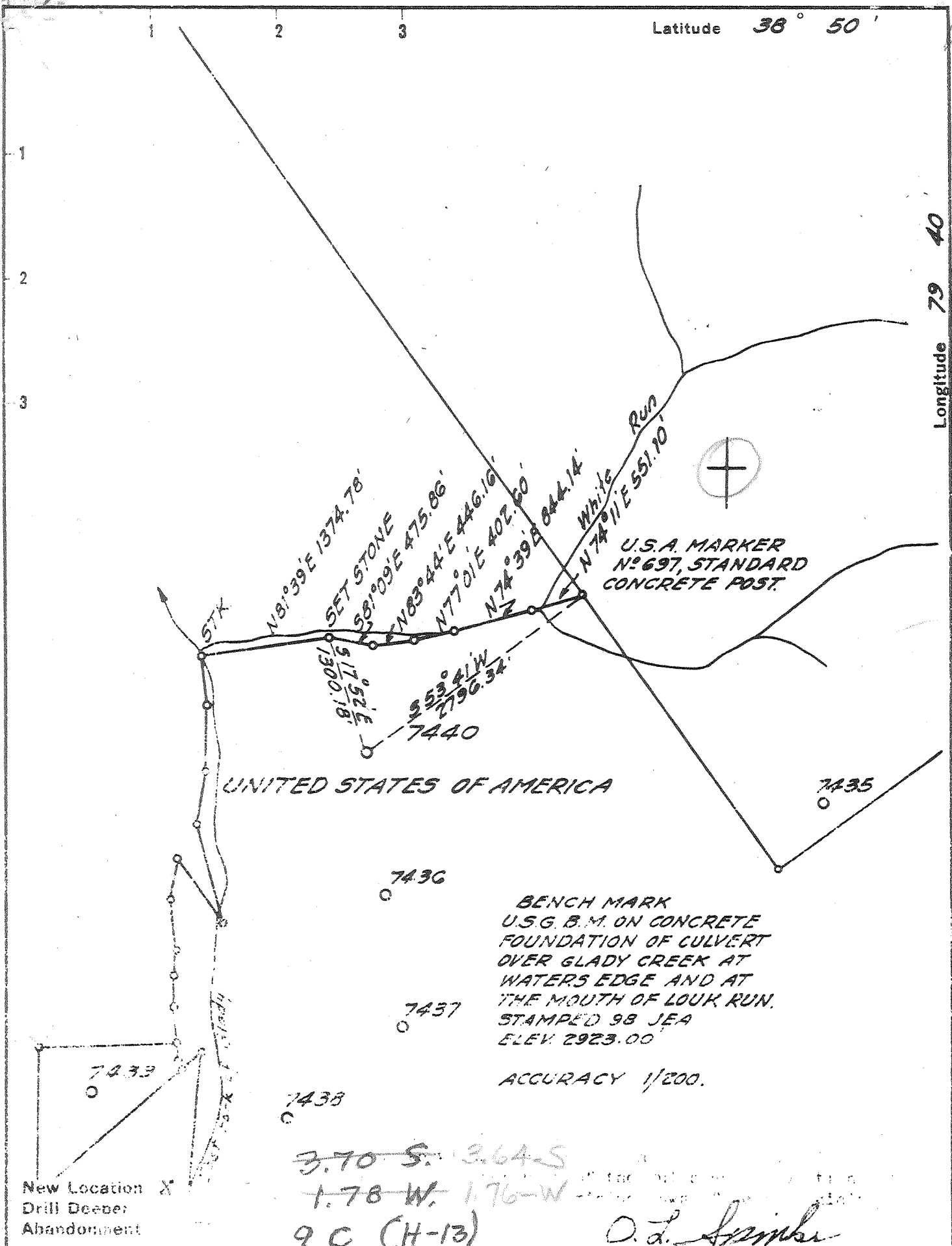

BENCH MARK
 U.S.G. B.M. ON CONCRETE
 FOUNDATION OF CULVERT
 OVER GLADY CREEK AT
 WATERS EDGE AND AT
 THE MOUTH OF LOUK RUN.
 STAMPED 98 JEA
 ELEV. 2923.00

ACCURACY 1/200.

New Location X
 Drill Deeper
 Abandonment

~~3.70 S. 3.64 S~~
~~1.78 W. 1.76 W~~
 9 C (H-13)

O. L. Jenkins

Company ATLANTIC SEABOARD CORP.
 Address CHARLESTON, W.V.A.
 Farm U.S.A. DEPT. OF INTERIOR
 Tract A032800 Acres 1730.90 Lease No. A5-700
 Well (Farm) No. _____ Serial No. 7440
 Elevation (Spirit Level) 3238.39'
 Quadrangle HORTON - SW
 County RANDOLPH District DRY FORK
 Engineer O. L. Jenkins
 Engineer's Registration No. 2712
 File No. 166-89 Drawing No. _____
 Date JUNE 9, 1964 Scale 1" = 1320'

STATE OF WEST VIRGINIA
 DEPARTMENT OF MINES
 OIL AND GAS DIVISION
 CHARLESTON

WELL LOCATION MAP
 FILE NO. RAN-118

+ Denotes location of well on United States Topographic Maps, scale 1 to 62,500, latitude and longitude lines being represented by border lines as shown.

- Denotes one inch spaces on border line of original tracing.

Samples ?? Oriskany Gas Storage 9-0 201 Deep Well



STATE OF WEST VIRGINIA
DEPARTMENT OF MINES
OIL AND GAS DIVISION

Quadrangle Horton

WELL RECORD

Permit No. RAN-118

Oil or Gas Well Gas Storage
(KIND)

Company Atlantic Seaboard Corp.
Address P.O. Box 1273 Charleston, W. Va. 25325
Farm U.S.A. Dept. of Interior Acres 1730.9
Location (waters) Glady Creek
Well No. X-77-7440 Elev. 3238.39'
District Dry Fork County Randolph
The surface of tract is owned in fee by _____
Address _____

Casing and Tubing	Used in Drilling	Left in Well	Packers
Size			Kind of Packer
16			
13 3/8"	63'	Cemented to surface.	
10			Size of
9 5/8"	1082'	Cemented to surface.	
7"	4984'	Cemented to surface.	Depth set
5 3/16			
3			Perf. top
2		5186'	Perf. bottom
Liners Used			Perf. top
			Perf. bottom

Mineral rights are owned by United States Geological Survey
Address Washington 25, D.C.

Drilling commenced Nov. 11, 1964
Drilling completed Dec. 13, 1964

Date Shot _____ From _____ To _____
With _____

Open Flow _____ /10ths Water in _____ Inch
_____ /10ths Merc. in _____ Inch

Volume 56,000 M - Oriskany Cu. Ft.

Rock Pressure 1020 lbs. 24 hrs.

Oil _____ bbls., 1st 24 hrs.

WELL ACIDIZED _____

WELL FRACTURED _____

CASING CEMENTED _____ SIZE _____ No. Ft. _____ Date _____

COAL WAS ENCOUNTERED AT _____ FEET _____ INCHES

_____ FEET _____ INCHES _____ FEET _____ INCHES

_____ FEET _____ INCHES _____ FEET _____ INCHES

RESULT AFTER TREATMENT _____

ROCK PRESSURE AFTER TREATMENT _____

Fresh Water 1382' Feet _____ Salt Water _____ Feet _____

Formation	Color	Hard or Soft	Top	Bottom	Oil, Gas or Water	Depth	Remarks
Sand and Shale			0	4476	Fresh water	1382'	
✓ Tully Lime			4476	4500	Gas 5007'	Est. 750 M	
✓ Marcellus Shale			4500	4803	Gas 5065'	Est. 1,500 M	
✓ Metabentonite				4803	Gas 5088'	Est. 3,500 M	
✓ Onondaga Lime			4803	4836	Gas 5135'	Est. 3 to 4,000 M	
✓ Chert - HRVL			4836	4915			
✓ Needmore Shale			4915	4974			
✓ Oriskany Sand			4974	5170			
✓ Helderberg Lime			5170	5203			
Total Depth			5203'				
			(485)				
			4974				
			3238				
			1736				
					Test before acidized - 3,800 M		
					Acidized 12-21-64 with 20,000 gals.		
					15% Hcl with 170,000 standard cu.		
					ft. Nitrogen.		
					Test after acidized - 56,000 M		
					Shut in 12-22-64 in 2" tubing.		
					LOGS RUN:		
					Gamma Ray - 4400-5203'		

(over)

