

Company Seneca-Upshur Petroleum

Address PO BOX P- Buckhannon W.Va.

Farm Elk Horn Coal Corp.

Tract \_\_\_\_\_ Acres 15379 Lease No. \_\_\_\_\_

Well (Farm) No. 1 Serial No. \_\_\_\_\_

Elevation (Spirit Level) 2288.5

Quadrangle Pickens NW 2  $\frac{1}{2}$  Pickens 7.5

County Randolph District Middle Fork

Engineer James D. Jeffries

Engineer's Registration No. 1084

File No. 180/40 Drawing No. \_\_\_\_\_

Date 11-3-53 Scale 1" = 500'

811

STATE OF WEST VIRGINIA  
DEPARTMENT OF MINES  
OIL AND GAS DIVISION  
CHARLESTON

WELL LOCATION MAP

FILE NO. RAN-28-RED

REDOBT CANCELLED

+ Denotes location of well on United States Topographic Maps, scale 1 to 62,500, latitude and longitude lines being represented by border lines as shown.

MAY 11 1987

- Denotes one inch spaces on border line of original tracing.

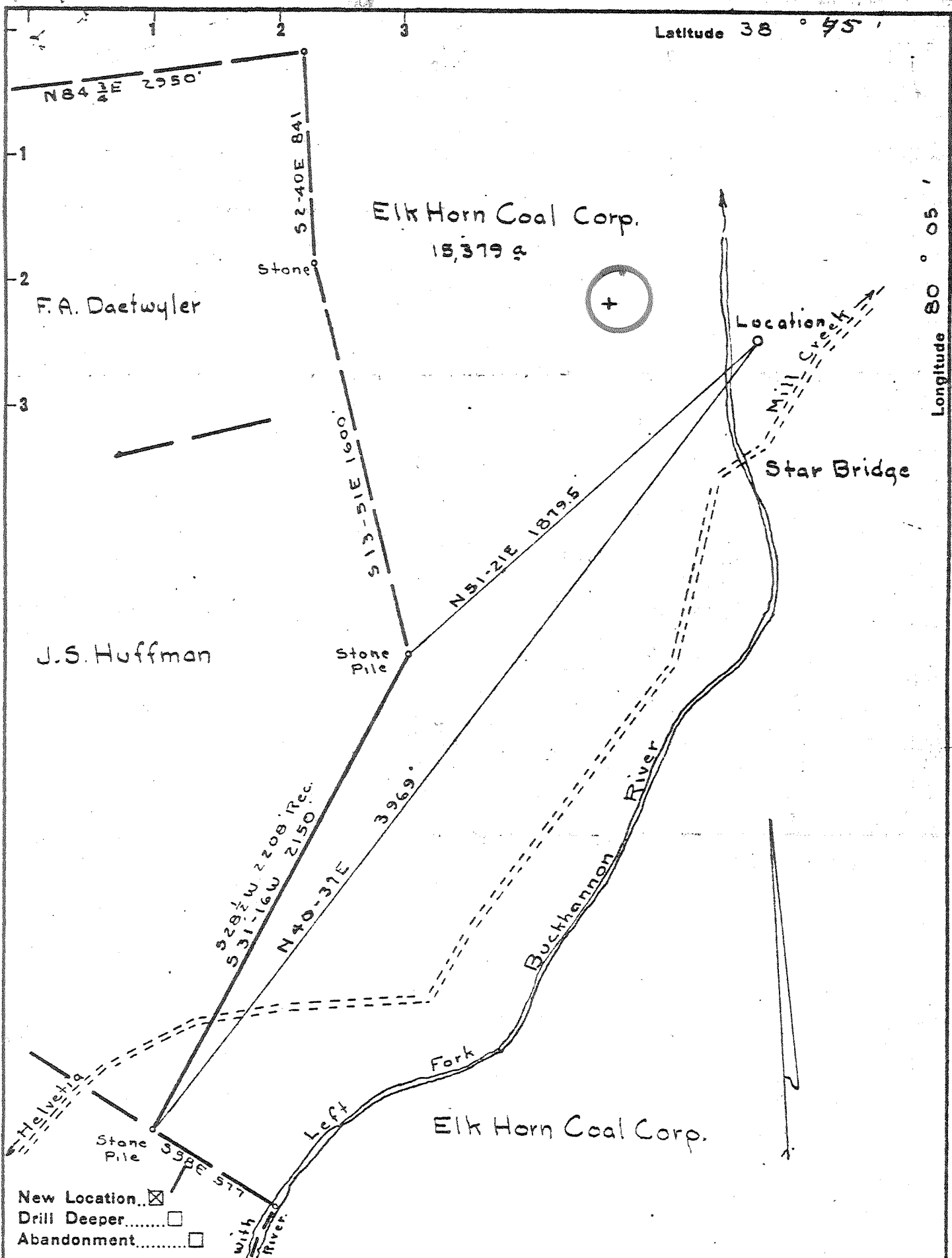

Company Seneca-Upshur Petroleum  
 Address PO BOX P - Buckhannon W.Va.  
 Farm Elk Horn Coal Corp.  
 Tract \_\_\_\_\_ Acres 15379 Lease No. \_\_\_\_\_  
 Well (Farm) No. 1 Serial No. \_\_\_\_\_  
 Elevation (Spirit Level) 2288.5  
 Quadrangle Pickens NW 2 1/2  
 County Randolph District Middle Fork  
 Engineer James D. Jeffries  
 Engineer's Registration No. 1084  
 File No. 150/40 Drawing No. \_\_\_\_\_  
 Date 11-3-53 Scale 1" = 500'

STATE OF WEST VIRGINIA  
 DEPARTMENT OF MINES  
 OIL AND GAS DIVISION  
 CHARLESTON

WELL LOCATION MAP  
 FILE NO. RAN-28-RED  
083-

+ Denotes location of well on United States Topographic Maps, scale 1 to 62,500, latitude and longitude lines being represented by border lines as shown.

- Denotes one inch spaces on border line of original tracing.

JAN 13 1981

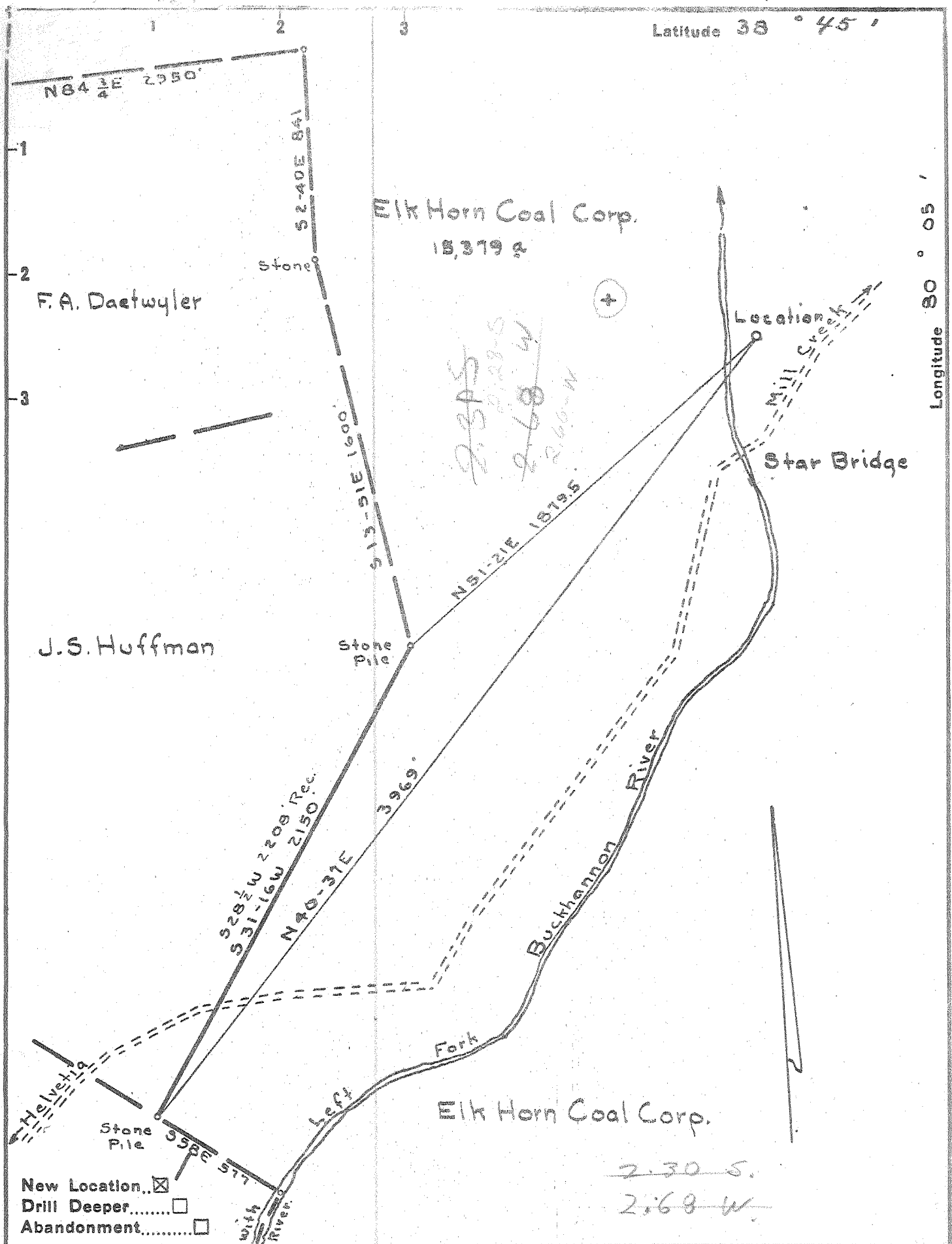

Company P.C. McKenzie Co.  
 Address Pittsburgh Pa.  
 Farm Elk Horn Coal Corp.  
 Tract \_\_\_\_\_ Acres 15,379 Lease No. \_\_\_\_\_  
 Well (Farm) No. 1 Serial No. \_\_\_\_\_  
 Elevation (Spirit Level) 2288.5  
 Quadrangle Pickens - NW 2 1/2  
 County Randolph District Middle Fork  
 Engineer James D. Jeffries  
 Engineer's Registration No. 1084  
 File No. 180/40 Drawing No. \_\_\_\_\_  
 Date 11-3-53 Scale 1" = 500'

STATE OF WEST VIRGINIA  
 DEPARTMENT OF MINES  
 OIL AND GAS DIVISION  
 CHARLESTON

**WELL LOCATION MAP**  
 FILE NO. RAN-28

+ Denotes location of well on United States Topographic Maps, scale 1 to 62,500, latitude and longitude lines being represented by border lines as shown.  
 - Denotes one inch spaces on border line of original tracing.

1-0 0  
 Deep Well ✓

STATE OF WEST VIRGINIA  
DEPARTMENT OF MINES  
OIL AND GAS DIVISION /Z

Well plugged back to 1285'

2  
Pickens NW 2 4  
Permit No. RAN-28

WELL RECORD

Oil or Gas Well Gas  
(KIND)

Company P. C. McKenzie Company, Agent  
Address P. O. Box 10396, Pgh. 34, Penna.  
Owner Elk Horn Coal Corp. Acres 15,379  
Location (waters) Left Fork, Buckhannon River  
Well No. 1 Elev. 22,885  
District Middle Fork County Randolph  
The surface of tract is owned in fee by Equitable Gas Co.  
10 Blvd. of the Allies address Pgh. 19, Pa.  
General rights are owned by \_\_\_\_\_  
Name as above Address \_\_\_\_\_  
Drilling commenced December 1, 1953  
Drilling completed December 4, 1954  
Date Shot From \_\_\_\_\_ To \_\_\_\_\_

Casing and Tubing	Used in Drilling	Left in Well	Packers
Size			Kind of Packer
16			
13			
10	709	709	Size of
8 3/4	3484	<del>3484</del>	
6 3/4	6897	<del>6897</del>	Depth set
5 3/16		<del>3484</del> <del>6897</del>	
3			Perf. top
2			Perf. bottom
Liners Used			Perf. top
			Perf. bottom

Open Flow /10ths Water in \_\_\_\_\_ Inch  
/10ths Merc. in \_\_\_\_\_ Inch  
Volume 43,000 Cu. Ft.  
Back Pressure 2,750 lbs. 312 hrs.  
\_\_\_\_\_ bbls., 1st 24 hrs.  
Fresh water \_\_\_\_\_ feet  
Salt water \_\_\_\_\_ feet

CASING CEMENTED \_\_\_\_\_ SIZE \_\_\_\_\_ No. Ft. \_\_\_\_\_ Date \_\_\_\_\_  
See below  
COAL WAS ENCOUNTERED AT \_\_\_\_\_ FEET \_\_\_\_\_ INCHES  
\_\_\_\_\_ FEET \_\_\_\_\_ INCHES FEET \_\_\_\_\_ INCHES  
\_\_\_\_\_ FEET \_\_\_\_\_ INCHES FEET \_\_\_\_\_ INCHES

Formation	Color	Hardness Softness	Top	Bottom	Remarks	Oil, Gas or Water	Depth Found
			TOP	BOTTOM			
Sand - Brown			0	19			
Gravel			19	27			
Sand - Red			27	50			
Gravel			50	80			
Gravel & Shale			80	125			
Conglomerate			125	135			
Sand			135	175			
Red Rock			175	185			
Red Lime			185	225	Hole full water at 200 ft.		
Slate & Shell			225	280			
Lime			280	320			
Slate & Shell			320	340	Very soft, balled up on Tools		
Webster Springs							
Sand, Red & Gray			340	395			
Lime Big Lime			395	523			
Red Rock Break			523	525			
Lime - Big Lime			525	645			
Sand - Big Inguin							
White			645	665			
Sand - Big Inguin, Red			665	695			
Lime			695	711	Steel Line Run 709ft. 10" Casing set 709 ft.		
Red R.			711	738			
Slate & Shell			738	761			
Lime			761	790			
Red Rock			790	868			
Slate & Shell - White			868	929			
Lime - White			929	951			
Red Rock & Shells			951	1020			
Slate - White			1020	1031			
Lime White			1031	1045			
Slate "			1045	1048			
Gordon Stray Sand							
White			1048	1078	Sh. Gas at 1053		

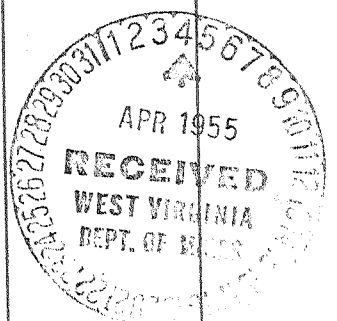

Formation	Color	Depth TOP	Depth BOTTOM	Remarks	Oil, Gas or Water	Depth Found	Remarks
		TOP	BOTTOM				
Slate - Pink		1078	1081	Sh. Gas at 1080			
Gordon Sand		1081	1087				
Red Rock		1087	1089				
Lime		1089	1104				
Red Rock		1104	1110				
4th Sand		1110	1120				
Red R. Break		1120	1140				
4th Sand		1140	1181	Little Gas 1153 and 1170'			
Red R		1181	1198				
5th Sand		1198	1242	Gas 1214' )			
Red R Break		1242	1247	" 1265' ) O.F. = 35,000 cu. ft.			
5th Sand		1247	1344	" 1275' )			
Slate & Shells		1344	2195				
Lime		2195	2532				
Sand		2532	2557				
Slate & Shells		2557	2705				
Sand		2705	2720				
Slate & Shell		2720	2934				
Lime		2934	3040				
Shale		3040	3091				
Slate & Shell		3091	3185				
Shale		3185	3200				
Lime		3200	3247				
Slate & Shell		3247	3267				
Lime		3267	3275				
Slate & Shell		3275	3481	Steel Line Run 3381'			
Lime		3381	3496	8-5/8" Casing set 3484'			
Slate & Shell		3496	3541				
Lime - White		3541	3767	Slight Blowouts following depths: Sh. Gas 3686')			
Sand - Pink		3767	3787	Sh. Gas 3808' ) O.F. 12,400 cu. ft.			
Lime		3787	3865	Sh. Gas 3887' ) Exhausted in a few days.			
Slate & Shell		3865	3941	Sh. Gas 3955' )			
Lime		3941	4443				
Slate & Shell		4442	5490				
Lime		5490	5710				
Slate & Shell		5710	5775				
Lime, very hard -black		5775	5812				
Slate, very hard							
Settled in bailer like		5812	5818				
Lime Water Sand		5818	6035				
Shale		6035	6045				
Lime		6045	6084				
Slate & Shell - Dark		6084	6455				
Lime		6455	6470				
Slate & Shells		6470	6532	Steel Line run at 6519'. Bad blowout top			
Shale, dark to black		6532	6630	black shale at 6552' - lost tools. Cemented			
Shale, dark, cal.		6630	6634	tools in. Drilled by 1st string, had another			
Shale, dark		6634	6638	blowout at 6552'. Lost 2nd string tools.			
Shale, dark black		6638	6644	Cemented 2nd string & successfully drilled by.			
Shale, black, cal.		6644	6824				
Shale, black, cal. hard		6824	6858				
" " " "		6858	6889				
Top Chert, Shale -		6889	6896	Top Chert 6895' - steel line 6897'			
Cal. Chert							
Top Shale, Cal. chert		6896	6897	7" Casing set at 6897'			
Chert - light gray		6897	6980				
Chert - some B. Shale (Gray)		6980	6985				

CONTINUED

Date

APPROVED

6895  
2289  
4606

19

07



STATE OF WEST VIRGINIA  
DEPARTMENT OF MINES  
OIL AND GAS DIVISION 12A

Quadrangle Pickens NW

Permit No. RAN-28 Page #2

WELL RECORD

Oil or Gas Well (KIND)

Company \_\_\_\_\_  
 Address \_\_\_\_\_  
 Farm \_\_\_\_\_ Acres \_\_\_\_\_  
 Location (waters) \_\_\_\_\_  
 Well No. \_\_\_\_\_ Elev. \_\_\_\_\_  
 District \_\_\_\_\_ County \_\_\_\_\_  
 The surface of tract is owned in fee by \_\_\_\_\_  
 Address \_\_\_\_\_  
 Mineral rights are owned by \_\_\_\_\_  
 Address \_\_\_\_\_  
 Drilling commenced \_\_\_\_\_  
 Drilling completed \_\_\_\_\_  
 Date Shot \_\_\_\_\_ From \_\_\_\_\_ To \_\_\_\_\_  
 With \_\_\_\_\_  
 Open Flow /10ths Water in \_\_\_\_\_ Inch  
 /10ths Merc. in \_\_\_\_\_ Inch  
 Volume \_\_\_\_\_ Cu. Ft.  
 Rock Pressure \_\_\_\_\_ lbs. \_\_\_\_\_ hrs.  
 Oil \_\_\_\_\_ bbls., 1st 24 hrs.  
 Fresh water \_\_\_\_\_ feet \_\_\_\_\_ feet  
 Salt water \_\_\_\_\_ feet \_\_\_\_\_ feet

Casing and Tubing	Used in Drilling	Left in Well	Packers
Size			
16			Kind of Packer
13			
10			Size of
8 3/4			
6 3/4			Depth set
5 3/16			
3			Perf. top
2			Perf. bottom
Liners Used			Perf. top
			Perf. bottom

CASING CEMENTED	SIZE	No. Ft.	Date
COAL WAS ENCOUNTERED AT		FEET	INCHES
		FEET	INCHES
		FEET	INCHES

Formation	Color	<del>EXPOS</del> Soft	<del>TOP</del> TOP	<del>EXPOS</del> BOTTOM	Oil, Gas or Water	Depth Found	Remarks
		TOP	BOTTOM	CONTINUED			
Chert, Non-Cal.		6985	7085				
Chert " " dark		7085	7100				
Sand - Cal.		7100	7144				
Sand Slightly Cal.		7144	7167				
Calcareous Silt		7167	7174				
Sand, Good		7174	7187				
Cal. Sand & Silt		7187	7218		Very Hard - Salt Water at 7178' - 12 gal. per hr.		7100
" Chert		7218	7236		Bottom Oriskany - 7210'		2289
" Chert & Sand		7236	7274		Gas 7273-1/2'		4811
" " "		7274	7276		OF 43,000 cu. ft.		
Good Sand, Little Chert		7276	7280		Minute Rise above Atmos. =		
					20 min 6#	40 min 12#	24 hrs. 395#
Silt -little cal. very hard		7280	7287				72 hrs. 1000#
Sand, Chert, very limey		7287	7298				144 hrs 1750#
Little Sand, Chert very limey		7298	7303				13 days 2750#
Chert, very limey		7303	7309		Very hard		
Little Sand, Chert very limey		7309	7324		Very hard		
Lime & Chert		7324	7348		Very hard		
Dark shale, limey chert		7348	7359				
TOTAL DEPTH 7359 ft.							

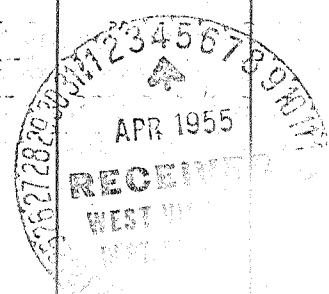

485

Formation	Color	Hard or Soft	Top <i>124</i>	Bottom	Oil, Gas or Water	Depth Found	Remarks
							<p><b>NOTE:</b> Spang cementing shoe on bottom 7" with cage for measuring etc. Bottom casing cemented with 80 sacks unflow cement (5 to 1 mix) or enough cement to fill the area between the outside 7" and the wall of the 8-5/8" hole about 1000 ft. from bottom 7" casing. 8-5/8 and 7" casing hangers, together with 5000# working pressure control, and drill through Va. Ives.</p>

Date \_\_\_\_\_

[08-78]

OIL AND GAS WELL PERMIT APPLICATION

Operator's  
Name: J. M. Huber #69

API Well No. 083 - 28  
State RAN County Permit  
Redrill

WELL TYPE: Oil      / Gas X /  
(If "Gas", Production X / Underground storage      / Deep      / Shallow X /  
LOCATION: Elevation: 2288.5 Watershed: Left Fork of Buckhannon River  
District: Middle Fork County: Randolph Substratum: Sago

WELL OPERATOR Seneca-Upshur Petroleum, Inc.  
Address P. O. Drawer P  
Buckhannon, W. Va. 26201

DEMONSTRATION AGENT Seneca-Upshur Petroleum, Inc.  
Address P.O. Drawer P  
Buckhannon, W. Va. 26201

OIL & GAS ROYALTY OWNER Equitable Gas Company  
Address 420 Blvd. of the Allies  
Pittsburgh, Pa. 15219

COAL OPERATOR NONE  
Address     

ACREAGE 15.379  
SURFACE OWNER Coastal Lumber Company  
Address Buckhannon  
West Virginia 26201  
ACREAGE 15.379

COAL OWNER(S) WITH DECLARATION ON RECORD:  
Name J. M. Huber Corporation  
Address Maryville  
Tennessee  
Name 15.379  
Address     

FIELD SALE (IF MADE) TO:  
Name       
Address     

COAL LESSEE WITH DECLARATION ON RECORD:  
Name       
Address       
NOV 17 1980

OIL & GAS INSPECTOR TO BE NOTIFIED  
Name Robert Stewart  
Address Jane Lew, W. Va.  
304-884-7782

OIL & GAS DIVISION  
DEPT. OF MINES

The undersigned well operator is entitled to operate for oil or gas purposes in the above location under a deed      / lease X / other contract      dated     , 19    , to undersigned well operator from     

[If said deed, lease, or other contract has been recorded:]  
Recorded on     , 19    , in the office of the Clerk of the County Commission of      County, West Virginia, in      Book      at page      and with the following:

PROPOSED WORK: Drill      / Drill deeper      / Redrill X / Plug or stimulate X /  
Plug off old formation      / Perforate new formation      /  
Other physical change in well (specify)     

--planned as shown on the work order on the reverse side hereof.

The above named coal operator, coal owner(s), and coal lease are hereby notified that any objection they wish to make or are required to make by Code § 20-2-1 must be filed with the Department of Mines within fifteen (15) days after the receipt of this Application by the Department.

Copies of this Permit Application and the enclosed plan and declaration plan have been mailed by registered mail or delivered by hand to the above named coal operator, coal owner(s), and coal lease on or before the day of the mailing or delivery of this Permit Application to the Department of Mines in Charleston, West Virginia.

PLEASE SUBMIT COPIES OF ALL GEOPHYSICAL LOGS DIRECTLY TO:  
WEST VIRGINIA OIL AND GAS CONSERVATION COMMISSION  
1615 WASHINGTON STREET EAST  
CHARLESTON, WV 25311  
TELEPHONE: (304) 328-3392

Seneca-Upshur Petroleum, Inc.  
Well Operator

BLANKET BOND

By Joseph M. Huber  
Its Vice President



[08-78]

PROPOSED WORK ORDER

ACTUAL INFORMATION MUST BE SUBMITTED ON FORM IV-1

DRILLING CONTRACTOR (IF KNOWN) Seneca-Upshur Petroleum, Inc.

Address P. O. Drawer P  
Buckhannon, W. Va. 26201

GEOLOGICAL TARGET FORMATION, Benson

Estimated depth of proposed well, 4,000 feet  X

Approximate water column depths: Fresh, 30' feet;

Approximate coal seam depths: None Is coal being mined in the area Yes  / No  X

CASING AND TUBING PROGRAM

CASING OR TUBING TYPE	SPECIFICATIONS				FOOTAGE INTERVALS		REMARKS
	Size	Grade	Wt. per ft.	New	Used	For drilling	
Conductor							
Fresh water							
Coal							
Intermediate	<u>10 3/4</u>					<u>700'</u>	<u>CTS</u>
Production	<u>4 1/2</u>		<u>10.5</u>	<u>X</u>		<u>4000'</u>	<u>400 SKS ST</u>
Tubing							<u>As regd. by</u>
Liners							<u>rule 15.010</u>

NOTE: Regulation 2.05 of the Department of Mines provides that the original Form IV-2 must be filed with the department, accompanied by a copy of the permit by Regulation 15.010 (1) a bond in any of the forms or copies of Regulation 15.010, or any other security allowed by Rule 15.010, (2) a copy of the permit, and (3) a copy of the declaration required by Rule 15.010. The permit shall be returned to the department upon completion of the work. The fee required by Regulation 15.010, shall be returned to the department within 30 days of the date of the permit. The permit shall be valid for a period of 180 days from the date of issuance. If the permit is not used within the 180-day period, the permit shall be null and void. The permit shall be returned to the department upon completion of the work. The permit shall be valid for a period of 180 days from the date of issuance. If the permit is not used within the 180-day period, the permit shall be null and void. The permit shall be returned to the department upon completion of the work.

A separate Form IV-2 shall not be required for fracturing or stimulating operations where fracturing or stimulating is to be part of the work for which a permit is sought. THIS PERMIT MUST BE POSTED AT THE WELL SITE in accordance with Rule 15.010.

All provisions being in accordance with Chapter 22, of the W. Va. Code, the location is hereby approved for redrilling. This permit shall expire if operations have not commenced by 8-19-81.

J. J. Haggerty  
Deputy Director of Gas Division

W A I V E R

The undersigned, as owner of the well, hereby certifies that the location has been examined and that the well is being drilled in accordance with the provisions of the West Virginia Code and the regulations of the Department of Mines. The undersigned certifies that the well is being drilled in accordance with the provisions of the West Virginia Code and the regulations of the Department of Mines. The undersigned certifies that the well is being drilled in accordance with the provisions of the West Virginia Code and the regulations of the Department of Mines. The undersigned certifies that the well is being drilled in accordance with the provisions of the West Virginia Code and the regulations of the Department of Mines.

*Survey*