

- Abandonment - 5/30/74
- ~~RECONSTRUCTION~~
- ~~RECONDITION~~
- ~~DRILL DEEPER~~
- ~~ABANDONMENT~~

CERTIFICATE

"I, the undersigned, hereby certify that this map is correct to the best of my knowledge and belief and shows all the information required by paragraph 6 of the rules and regulations of the oil and gas section of the mining laws of West Virginia." Minimum degree of accuracy is one part in 500

Signed W. D. Perry, L.L.S. #325

JACKSON DEP. CO. INC. (NOTE: THIS MAP CORRECTED FOR TOPO LOCATION)

COMPANY JACKSON DEPARTMENT OF MINE MANAGEMENT, INC.
 ADDRESS 201 W. MAIN ST. BLDG. CHAS. WVA
 FARM GILLESPIE - JACOBS
 MAP _____ ACRES 16.2 LEASE NO. _____
 WELL (FARM) NO. N-7 SERIAL NO. _____
 ELEVATION (SPIRIT LEVEL) 727.85
 QUADRANGLE GLENWOOD T. 11 S. E.
 COUNTY PUTNAM DISTRICT TRAYS VALLEY
 POINT OF PROVEN ELEVATION PINE GROVE CHURCH

FILE NO. _____ DRAWING NO. _____
 DATE 10/28/72 (ORIGINAL 9/10/72) SCALE 1" = 400'

STATE OF WEST VIRGINIA
 DEPARTMENT OF MINES
 OIL AND GAS DIVISION
 CHARLESTON
WELL LOCATION MAP

FILE NO. PUT-773-R-P
Corrected Topo. Location

+ DENOTES LOCATION OF WELL ON UNITED STATES TOPOGRAPHIC MAPS SCALE 1 TO 62 500. LATITUDE AND LONGITUDE LINES BEING REPRESENTED BY BORDER LINES AS SHOWN

-- DENOTES ONE INCH SPACES ON BORDER LINE OF ORIGINAL TRACING

Deep well

JUN 24 1974

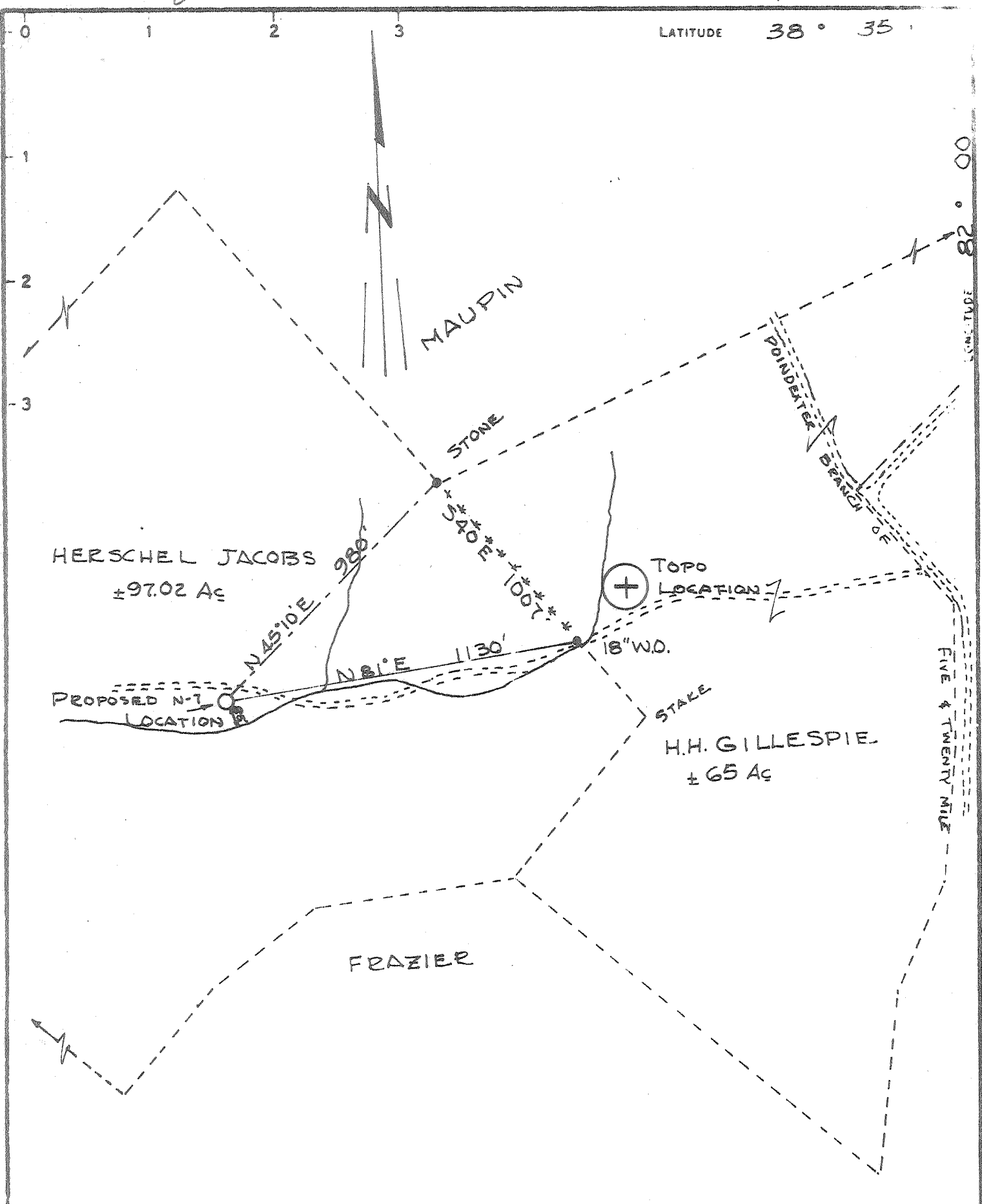

CERTIFICATE

"I, the undersigned, hereby certify that this map is correct to the best of my knowledge and belief and shows all the information required by paragraph 6 of the rules and regulations of the oil and gas section of the mining laws of West Virginia."

Minimum degree of accuracy is one part in 500

Signed P. D. Jerry, LLS#325

(NOTE: THIS MAP CORRECTED FOR TOPO LOCATION)

- NEW LOCATION
- RECONDITION
- DRILL DEEPER
- ABANDONMENT

2-6-74

COMPANY NATURAL RESOURCE MANAGEMENT, INC.
 ADDRESS 1901 KANAWHA VALLEY BLDG. CHAS, WVA
 FARM GILLISPIE - JACOBS
 MAP _____ ACRES 167 LEASE NO. _____
 WELL (FARM) NO. N-7 SERIAL NO. _____
 ELEVATION (SPIRIT LEVEL) 727.85
 QUADRANGLE GLENWOOD SW
 COUNTY PUTNAM DISTRICT TRAYS VALLEY
 POINT OF PROVEN ELEVATION PINE GROVE CHURCH
 FILE NO. _____ DRAWING NO. _____
 DATE 10/28/72 (ORIGINAL 9/10/72) SCALE 1" = 400'

STATE OF WEST VIRGINIA
 DEPARTMENT OF MINES
 OIL AND GAS DIVISION
 CHARLESTON
WELL LOCATION MAP

FILE NO. PUT-773-P
Corrected Topo-Location

+ DENOTES LOCATION OF WELL ON UNITED STATES TOPOGRAPHIC MAPS SCALE 1 TO 62 500 LATITUDE AND LONGITUDE LINES BEING REPRESENTED BY BORDER LINES AS SHOWN
 - DENOTES ONE INCH SPACES ON BORDER LINE OF ORIGINAL TRACING

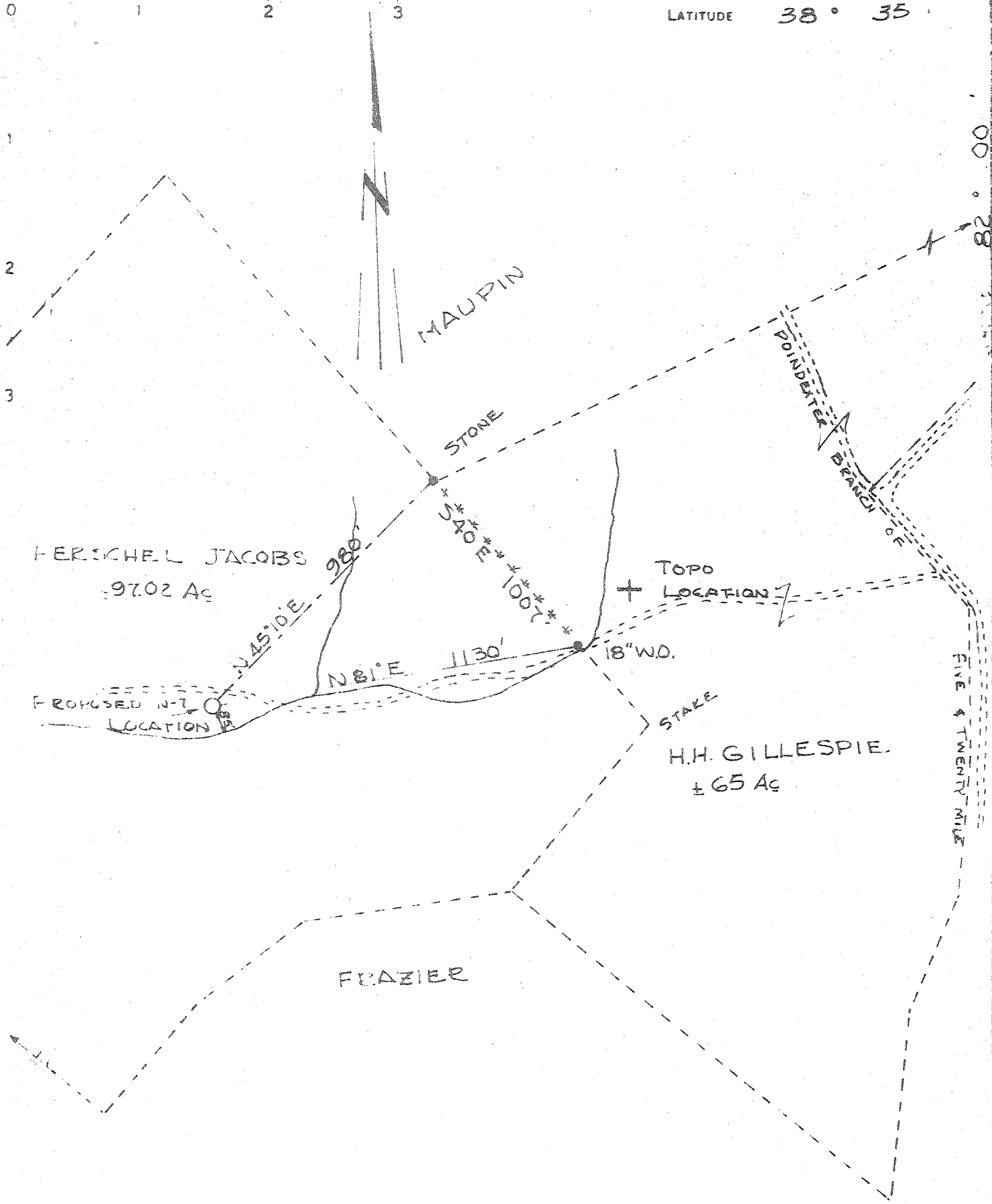

- NEW LOCATION
- RECONDITION
- DRILL DEEPER
- ABANDONMENT

CERTIFICATE

"I, the undersigned, hereby certify that this map is correct to the best of my knowledge and belief and shows all the information required by paragraph 4 of the rules and regulations of the oil and gas section of the mining laws of West Virginia."

Minimum degree of accuracy is one part in 500

Signed P. A. Jerry, LLS #325

(NOTE: THIS MAP CORRECTED FOR TOPO LOCATION)

COMPANY	NATURAL RESOURCE MANAGEMENT, INC
ADDRESS	1201 KANAWHA VALLEY BLDG. CHAS, WVA
FARM	GILLESPIE-JACOBS
MAP	ACRES 162 LEASE NO
WELL (FIRM) NO	N-1 SERIAL NO
ELEVATION (SPIRIT) LEVEL	721.85
QUADRANGLE	COLENWOOD SE
COUNTY	PUTNAM DISTRICT TEAYS VALLEY
POINT OF PROVEN ELEVATION	PINE GROVE CHURCH
FILE NO	DRAWING NO
DATE	10/28/72 (ORIGINAL 9/19/72) SCALE 1" = 400'

STATE OF WEST VIRGINIA
 DEPARTMENT OF MINES
 OIL AND GAS DIVISION
 CHARLESTON
WELL LOCATION MAP

FILE NO PUT-773
Corrected Topo. Location

+ DENOTES LOCATION OF WELL ON UNITED STATES TOPOGRAPHIC MAPS SCALE 1 TO 62 500 LATITUDE AND LONGITUDE LINES BEING REPRESENTED BY BORDER LINES AS SHOWN.

- DENOTES ONE INCH SPACES ON BORDER LINE OF ORIGINAL TRACING

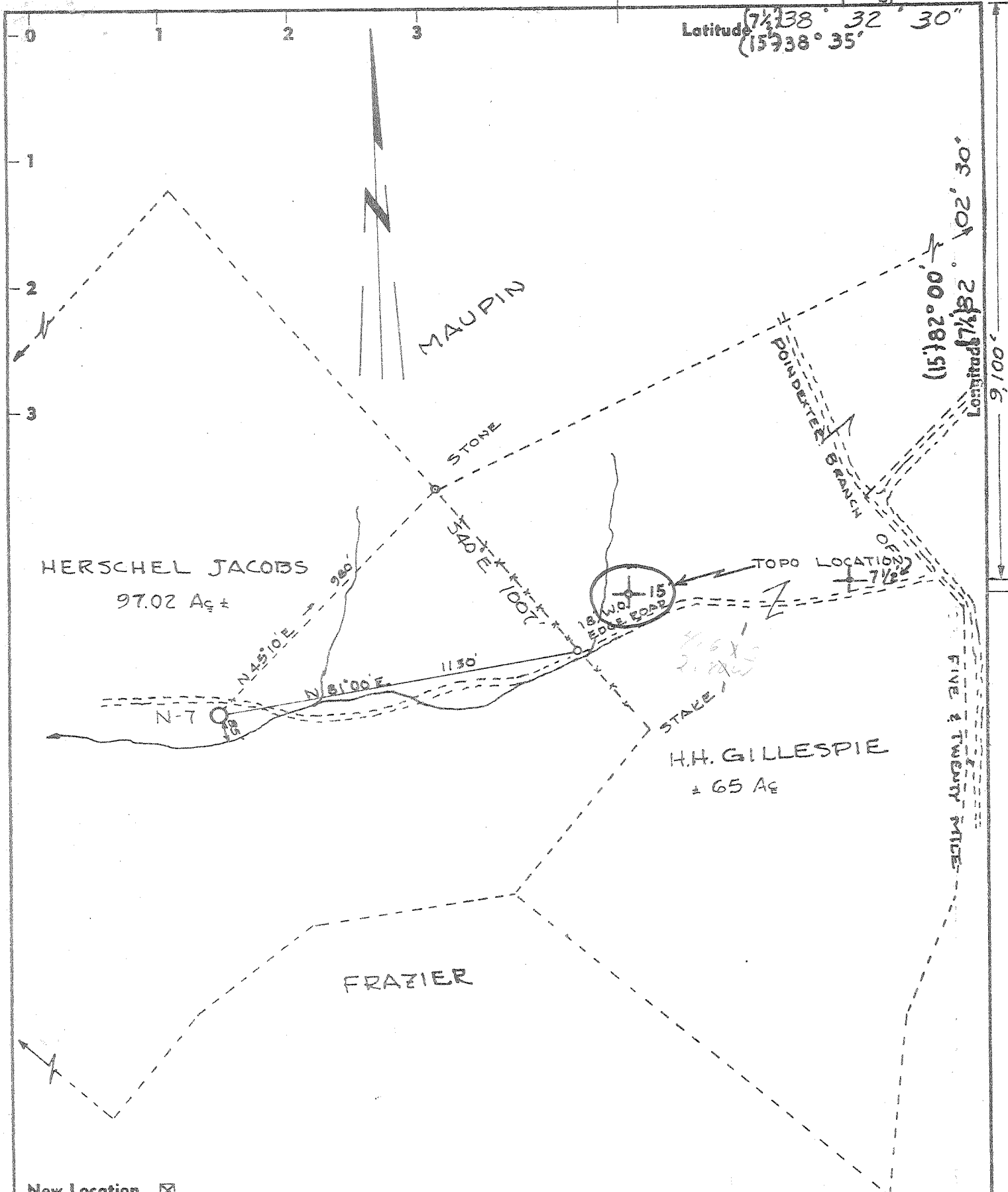

- New Location .
- Drill Deeper
- Redrill
- Abandonment

"I, the undersigned, hereby certify that this map is correct to the best of my knowledge and belief and shows all the information required by paragraph 6 of the rules and regulations of the oil and gas section of the mining laws of West Virginia."

Company NATURAL RESOURCE MANAGEMENT, INC.
 Address 1901 KANAWHA VALLEY BUILDING, CHAS. WV.
 Farm GILLESPIE - JACOBS
 Tract _____ Acres 162 Lease No. _____
 Well (Farm) No. N-7 Serial No. _____
 Elevation (Spirit Level) 727.85
 Quadrangle (MOUNT OLIVE - 7 1/2') Glenwood - 15'
 County PUTNAM District TEAYS VALLEY
 Engineer O. D. TERRY, SURVEYOR
 Engineer's Registration No. 325
 File No. _____ Drawing No. _____
 Date 9/19/72 Scale 1" = 400'

STATE OF WEST VIRGINIA
 DEPARTMENT OF MINES
 OIL AND GAS DIVISION
 CHARLESTON

WELL LOCATION MAP
 FILE NO. PUT. - 773

+ Denotes location of well on United States Topographic Maps, scale 1 to 62,500, latitude and longitude lines being represented by border lines as shown.

- Denotes one inch spaces on border line of original tracing.



RECEIVED

JAN 21 1974

OIL & GAS DIVISION
DEPT. OF MINES

STATE OF WEST VIRGINIA
DEPARTMENT OF MINES

Oil and Gas Division
WELL RECORD

38-45
④ 9-52

Quadrangle Glenwood
Permit No. 773

Rotary Oil _____
Cable _____ Gas _____
Recycling _____ Comb. _____
Water Flood _____ Storage _____
Disposal Dry (Kind)

Company Natural Resource Management Corp
Address 1901 Kanawha Valley Building
Farm Gillespie Jacobs Acres 162
Location (waters) Five and twenty mile
Well No. N 7 Elev. 727 85
District Teays Valley County Putnam
The surface of tract is owned in fee by Hersehell
Jacobs and H A Gillespie
Address _____
Mineral rights are owned by _____
Address _____
Drilling Commenced 10 25 72
Drilling Completed 11 9 72
Initial open flow 0 cu. ft. _____ bbls.
Final production 0 cu. ft. per day _____ bbls.
Well open _____ hrs. before test _____ RP.

Casing and Tubing	Used in Drilling	Left in Well	Cement fill up Cu. ft. (Sks.)
Size 20-16			
Cond. 13-10" 10 3/4	156'	156'	50 Sacks
9 5/8			
8 5/8			
7	2056'	2056'	60 Sacks
5 1/2			
4 1/2			
3			
2			
Liners Used			

Well treatment details:

Attach copy of cementing record.

No treatment

Coal was encountered at _____ Feet _____ Inches
Fresh water _____ Feet _____ Salt Water _____ Feet _____
Producing Sand none Depth _____

Formation	Color	Hard or Soft	Top Feet	Bottom Feet	Oil, Gas or Water	* Remarks
Red Rock			0	0		
Slate			50	125		
Sand			125	145		
Slate			145	220		
Red Rock			220	280		
Sand			280	300		
Slate			300	520		
Red Rock			520	560		
Slate			560	666		
Sand			666	690		
Red Rock			690	700		
Slate			700	880		
Sand			880	910		
Slate			910	950		
Salt Sand			950	1020		
Red Rock			1020	1340		
Sand			1340	1410		
Slate			1410	1550		
Sand			1550	1700		
Slate			1700	1730		
Big Lime			1730	1815		
Sand			1815	2005		
Slate & Shale			2005	2323		

(over)

* Indicates Electric Log tops in the remarks section.

FEB 7 1974

Formation	Color	Hard or Soft	Top Feet	Bottom Feet	Oil, Gas or Water	Remarks
Berea			2323	2354		
Shale			2354	4148		
Coniferous Lime		Onondaga	4148	4211		
Sandy Lime		Oniskang	4213	4218		
Lime and Sand			4218	5034		
Helderberg + Salina						
					4148	4213
					728	728
					<u>3470</u>	<u>3485</u>

Date _____, 19__

APPROVED _____, Owner

By _____
(Title)



STATE OF WEST VIRGINIA
DEPARTMENT OF MINES

Oil and Gas Division

OIL AND GAS WELL PERMIT APPLICATION

TO THE DEPARTMENT OF MINES,

Charleston, W. Va.

Hershel

Hershel

Surface Owner Gillispie etux and Jacobs etux

Address Fraziers Bottom, West Virginia

Mineral Owner Same

Address 5 & 20 Mile Rd.

Coal Owner _____

Address _____

Coal Operator _____

Address _____

DATE 1-27-73

Company Resource Management Corp.

Address 1901 Kanawha Valley Bldg.

Address Charleston, West Virginia 25301

Farm Jacobs-Gillispie Acres 162

Location (waters) 5 & 20 Mile Creek

Well No. N-7 Elevation _____

District Teays Valley County Putnam

Quadrangle Glenwood

THIS PERMIT MUST BE POSTED AT THE WELL SITE

All provisions being in accordance with Chapter 22, of the W. Va. Code, the location is hereby approved for drilling. This permit shall expire if operations have not been started by 1-27-73

Robert Hood
Deputy Director - Oil & Gas Division

Kenneth
INSPECTOR TO BE NOTIFIED Butcher
Barboursville, W. Va. PH: 736-4885

GENTLEMEN:

The undersigned well operator is entitled to drill upon the above named farm or tract of land for oil and gas, having fee title thereto, (or as the case may be) under grant or lease dated October 26 1970 by Gillispie & Jacobs made to Teavee Oil & Gas, Inc. and recorded on the _____ day of _____ 19 , in Putnam County, Book 55 Page 710 & 739

NEW WELL _____ DRILL DEEPER _____ REDRILL _____ FRACTURE OR STIMULATE
_____ OIL AND GAS WELL ORIGINALLY DRILLED BEFORE JUNE 5, 1969.

The enclosed plat was prepared by a registered engineer or licensed land surveyor and all coal owners and/or operators have been notified as of the above date.

The above named coal owners and/or operator are hereby notified that any objection they wish to make, or are required to make by Section 3 of the Code, must be received by, or filed with the Department of Mines within ten (10) days. *

Copies of this notice and the enclosed plat were mailed by registered mail, or delivered to the above named coal operators or coal owners at their above shown respective address _____ day _____ before, or on the same day with the mailing or delivery of this copy to the Department of Mines at Charleston, West Virginia.

Very truly yours,
(Sign Name) J. Hoyle Pinner
Well Operator

Address _____ Street _____
of _____
Well Operator _____ City or Town _____
State _____

*SECTION 3 If no objections are filed or found by the Department of mines, within said period of ten days from the receipt of notice and plat by the department of mines, to said proposed location, the department shall forthwith issue to the well operator a permit reciting the filing of such plat, that no objections have been made by the coal operators or found thereto by the department and that the same is approved and the well operator authorized to proceed.

**THIS IS AN ESTIMATE ONLY
ACTUAL INFORMATION WILL BE SUBMITTED ON OG-10 UPON COMPLETION**

PROPOSED WORK ORDER TO DRILL DEEPEN FRACTURE-STIMULATE

DRILLING CONTRACTOR: (If Known) RESPONSIBLE AGENT:
 NAME Gerald Jones Drilling Co., Inc. NAME J. Hoyle Rymer
 ADDRESS Spencer, West Virginia ADDRESS 1901 Kanawha Valley Bldg. Charleston, West Virginia
 TELEPHONE _____ TELEPHONE 342 2125
 ESTIMATED DEPTH OF COMPLETED WELL: 4500 ROTARY CABLE TOOLS _____
 PROPOSED GEOLOGICAL FORMATION: Oriskany
 TYPE OF WELL: OIL _____ GAS COMB. _____ STORAGE _____ DISPOSAL _____
 RECYCLING _____ WATER FLOOD _____ OTHER _____

TENTATIVE CASING PROGRAM:

CASING AND TUBING SIZE	USED FOR DRILLING	LEFT IN WELL	CEMENT FILL UP OR SACKS - CUBIC FT.
20 - 16 16½	10'	10'	3 sacks
13 - 10 11 3/4	250'	250'	150 cu. ft.
9 - 5/8			
8 - 5/8			
7	1950	1950	50 sacks
5 ½			
4 ½			
3 3½	4700	4700	Perf. Top
2			Perf. Bottom
Liners			Perf. Top
			Perf. Bottom

APPROXIMATE FRESH WATER DEPTHS 100 FEET SALT WATER 1130 FEET 1620
 APPROXIMATE COAL DEPTHS None
 IS COAL BEING MINED IN THE AREA? No BY WHOM? _____

TO DRILL:

SUBMIT FIVE (5) COPIES OF OG - 1, \$100.00 PERMIT FEE, PERFORMANCE BOND AND PERMANENT COPY OF PLAT.

TO DRILL DEEPER OR REDRILL:

SUBMIT FIVE (5) COPIES OF OG - 1, SHOWING ORIGINAL PERMIT NUMBER AND PERFORMANCE BOND. ON WELLS DRILLED PRIOR TO 1929, A PERMANENT COPY OF THE PLAT AND THE ORIGINAL WELL RECORD MUST ALSO BE SUBMITTED.

TO FRACTURE - STIMULATE:

OIL AND/OR GAS WELL ORIGINALLY DRILLED BEFORE JUNE 5, 1929, FIVE (5) COPIES OG - 1, PERFORMANCE BOND, PERMANENT PLAT AND ORIGINAL WELL RECORD.

OIL AND/OR GAS WELL ORIGINALLY DRILLED ON AND/OR AFTER JUNE 5, 1929, FIVE COPIES OG - 1, SHOWING ORIGINAL PERMIT NUMBER, AND PERFORMANCE BOND.

Required forms must be filed within ninety (90) days of completion for bond release. Inspector to be notified twenty-four (24) hours in advance.

The following waiver must be completed by the coal operator if the permit is to be issued within ten days of receipt thereof.

WAIVER: I the undersigned, Agent for _____ Coal Company, Owner or Operator of the coal under this lease have examined and place on our mine maps this proposed well location.

We the _____ Coal Company have no objections to said well being drilled at this location, providing operator has complied with all rules and regulations in Articles 4, 5, and 7, Chapter 22 of the West Virginia Code.

For Coal Company

Official Title