

Company UNITED FUEL GAS CO.
 Address CHARLESTON, W. VA.
 Farm B. T. DUDDING
 Tract _____ Acres 60 Lease No. 53010
 Well (Farm) No. _____ Serial No. 8388
 Elevation (Spirit Level) 630.87'
 Quadrangle SAINT ALBANS 15E15
 County PUTNAM District POCA
 Engineer Paul E. Cochran
 Engineer's Registration No. 669
 File No. 52-65 Drawing No. _____
 Date 10-25-55 Scale 1" = 400'

STATE OF WEST VIRGINIA
 DIVISION OF ENVIRONMENTAL PROTECTION
 OFFICE OF OIL & GAS
 NITRO, WEST VIRGINIA 25143

WELL LOCATION MAP
 APD Well No. 47-079-00590-P

Well Drilled in 1955
TD. 1551'
Big Lime Production

JUL 22 1996

Latitude 38 30'

Longitude 81 45'

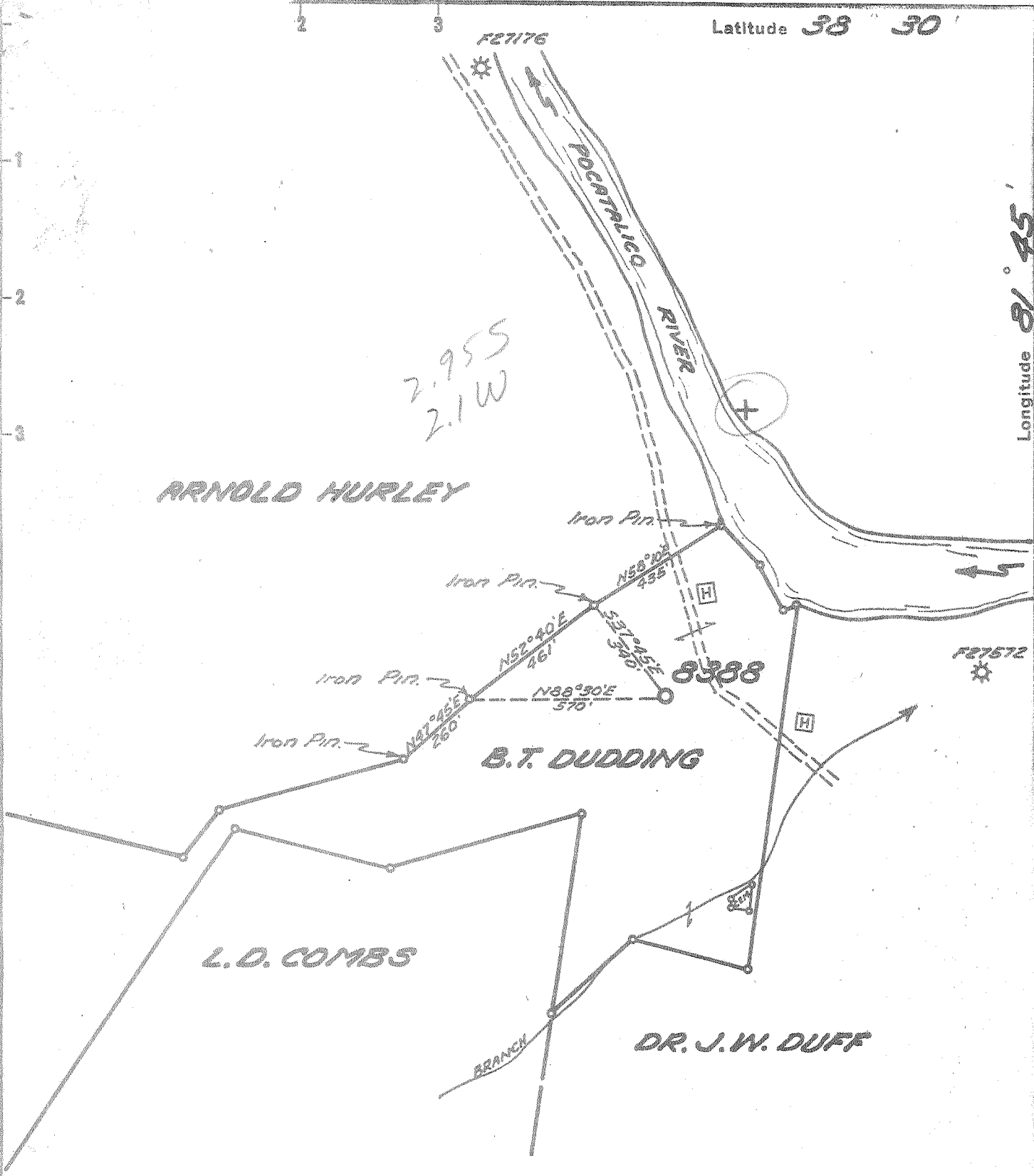

- New Location.
- Drill Deeper.....
- Abandonment.....

Company UNITED FUEL GAS CO.
 Address CHARLESTON, W. VA.
 Farm B. T. DUDDING
 Tract _____ Acres 60 Lease No. 53010
 Well (Farm) No. _____ Serial No. 8388
 Elevation (Spirit Level) 630.87'
 Quadrangle SAINT ALBANS - NE
 County PUTNAM District POCA
 Engineer Paul E. Roach
 Engineer's Registration No. 669
 File No. 52-65 Drawing No. _____
 Date 10-25-55 Scale 1" = 400'

STATE OF WEST VIRGINIA
 DEPARTMENT OF MINES
 OIL AND GAS DIVISION
 CHARLESTON

WELL LOCATION MAP
 FILE NO. Put-590

- + Denotes location of well on United States Topographic Maps, scale 1 to 62,500, latitude and longitude lines being represented by border lines as shown.
- Denotes one inch spaces on border line of original tracing.

6-6-192



STATE OF WEST VIRGINIA
DEPARTMENT OF MINES
OIL AND GAS DIVISION

Quadrangle St. Albans

WELL RECORD

Permit No. PUT-590

Oil or Gas Well Gas

(KIND)

Company UNITED FUEL GAS COMPANY
Address P.O. Box 1273, Charleston 25, W. Va.
Farm B. T. Dudding Acres 60
Location (waters) Poca River
Well No. 8388 Elev. 630.87'
District Poca County Putnam
The surface of tract is owned in fee by _____
Address _____
Mineral rights are owned by B. T. Dudding
Address Charleston, W. Va.
Drilling commenced 11-25-55
Drilling completed 12-19-55
Date ~~started~~ acidized 12-27-55 From _____ To _____
With 2,000 gallons acid
Open Flow 12# Spring Gauge _____ 3" _____ Inch
_____/10ths Merc. in _____ Inch
Volume 5,440,000 _____ Cu. Ft.
Rock Pressure 465 _____ lbs. 48 _____ hrs.
Oil _____ _____ bbls., 1st 24 hrs.
Fresh water 75-80, 230' _____ feet 412' _____ feet
Salt water 695-700 _____ feet 1060' _____ feet

Casing and Tubing	Used in Drilling	Left in Well	Packers
Size			Kind of Packer _____
18			Hookwall & Anchor
13 <u>-3/8"</u>		88'	Size of _____
10 <u>-3/4"</u>		302'	<u>3 1/2" x 7"</u>
EX <u>7"</u>		1491'	Depth set _____
6 5/8			<u>1516'</u>
5 3/16			Perf. top _____
3 <u>1/2"</u>		1551'	Perf. bottom _____
2			Perf. top _____
Liners Used _____			Perf. bottom _____

CASING CEMENTED _____ SIZE _____ No. Ft. _____ Date _____

COAL WAS ENCOUNTERED AT _____ FEET _____ INCHES
_____ FEET _____ INCHES FEET _____ INCHES
_____ FEET _____ INCHES FEET _____ INCHES

Formation	Color	Hard or Soft	Top	Bottom	Oil, Gas or Water	Depth Found	Remarks
Soil			0	5	Water 75-80', 1/8 bailer per hr.		
Red Rock			5	75			
Quick Sand			75	100	Water 230'		
Slate			100	212			
Lime			212	223	Water 412' 1 bailer every 2 hours		
Sand			223	303			
Slate & Shells			303	370	Salt Water 695-700' 3 bailers per hr.		
Sand			370	385			
Slate			385	395	Hole full Salt Water 1060'		
Sand			395	420			
Slate & Shells			420	467	Gas 1543-1548		
Sand			367	581			
Slate & Shells			581	610	Gas 1548' 80/10 W 2" 377 M		
Sand			610	640			
Slate & Shells			640	690	Gas 1548-1550' 180/10 W 3" 1,273 M		
Lime			690	720			
Slate & Shells			720	750	Gas 1550-1551' 158/10 W 3" 1,192 M		
Broken Lime			750	760			
Slate & Shells			760	832			
Sand			832	853	Test before acidized 158/10 W 3" 1,193 M		
Slate & Shells			853	913	Acidized 12-27-55 with 2000 gallons acid		
Sand			913	962	Test after opened 2nd time for 1 hr.		
Slate & Shells			962	975	12# Spring Gauge thru 3" 5,440 M		
Lime			975	1005			
Salt Sand			1005	1447			
Little Lime			1447	1482	FINAL OPEN FLOW 5,440 M - Big Lime		
Big Lime			1482	1551	48 Hr. R.P. 465#		
Total depth			1551'				

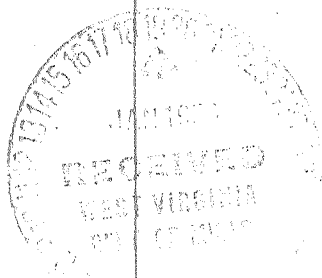

RECEIVED
WV Division of
Environmental Protection

TR-38
0-Sep-96

API # 47- 79-00590-P

SEP 23 1996

STATE OF WEST VIRGINIA
DIVISION OF ENVIRONMENTAL PROTECTION
OFFICE OF OIL AND GAS

Permitting
Office of Oil & Gas
AFFIDAVIT OF PLUGGING AND FILLING WELL

AFFIDAVIT SHOULD BE IN TRIPLICATE, one copy mailed to the Division, one copy to be retained by the Well Operator and the third copy (and extra copies if required) should be mailed to each coal operator at their respective addresses.

Farm name: LEE, SAMUEL F., JR. Operator Well No.: 8388

LOCATION: Elevation: 630.87 Quadrangle: SAINT ALBANS
District: POCATALICO County: PUTNAM
Latitude: 180 Feet South of 38 Deg. 27 Min. 30 Sec.
Longitude: 10930 Feet West of 81 Deg. 45 Min. 0 Sec.

Well Type: OIL _____ GAS x

Company: CE Richner
PO Box 310
Pineville WV 24874

Coal Operator _____
or Owner _____

Agent: Chuck E. Richner

Coal Operator _____
or Owner _____

Permit Issued: 07/16/96

AFFIDAVIT

STATE OF WEST VIRGINIA,
County of Lincoln

ss:

Scott Parsons and James Hoosier being first duly sworn according to law depose and say that they are experienced in the work of plugging and filling oil and gas wells and were employed by the above named well operator, and participated in the work of plugging and filling the above well, and Carlos Hively Oil and Gas Inspector representing the Director, say that said work was commenced on the 22nd day of July, 1996, and that the well was plugged and filled in the following manner:

TYPE	FROM	TO	PIPE REMOVED	LEFT
Gel Hole	surface	1518'		
Cut 3"		1518'	1518'-3"	41'-3"
Cement	1518'	1400'		
Cut 7"		1008'	1008'-7"	479'-7"
Cement	1023'	900'		
Cement	713'	600'		
Cement	372'	surface		
Perforate 10"	230'	10' at water zones		

Description of monument: erect monument with API No. 47-79-0590P and that the work of plugging and filling said well was completed on the 29th day of July, 1996.

And further deponents saith not.

Scott Parsons
James Hoosier

Sworn and subscribe before me this 11th day of September, 1996

My commission expires: DECEMBER 9, 1997

Irlan Dale Coleman
Notary Public



NOTARY PUBLIC
STATE OF WEST VIRGINIA
IRLAN DALE COLEMAN
158 Ranch Lake Boulevard
Scott Depot, West Virginia 25560
My Commission Expires Dec. 9, 1997

Oil and Gas Inspector: Carlos W. Hively

OCT 03 1996