

P 591 457 133

RECEIPT FOR CERTIFIED MAIL

NO INSURANCE COVERAGE PROVIDED  
NOT FOR INTERNATIONAL MAIL

(See Reverse)

\* U.S.G.P.O. 1983-403-517

PS Form 3800, Feb. 1982

Sent to	Mr. I.V. Cunningham	
Street and No.	431 McKinley Ave.	
P.O., State and ZIP Code	Charleston, W.V. 25314	
Postage	\$	56
Certified Fee		.75
Special Delivery Fee		
Restricted Delivery Fee		
Return Receipt Showing to whom and Date Delivered		.70
Return receipt showing to whom, Date, and Address of Delivery		
TOTAL Postage and Fees	\$	2.01
Postmark or Date		

P 591 457 135

RECEIPT FOR CERTIFIED MAIL

NO INSURANCE COVERAGE PROVIDED  
NOT FOR INTERNATIONAL MAIL

(See Reverse)

\* U.S.G.P.O. 1983-403-517

PS Form 3800, Feb. 1982

Sent to	Amherst Industries, Inc.	
Street and No.	Port Amherst	
P.O., State and ZIP Code	Charleston, W.V. 25306	
Postage	\$	56
Certified Fee		.75
Special Delivery Fee		
Restricted Delivery Fee		
Return Receipt Showing to whom and Date Delivered		.70
Return receipt showing to whom, Date, and Address of Delivery		
TOTAL Postage and Fees	\$	2.01
Postmark or Date		

P 591 457 134

RECEIPT FOR CERTIFIED MAIL

NO INSURANCE COVERAGE PROVIDED  
NOT FOR INTERNATIONAL MAIL

(See Reverse)

\* U.S.G.P.O. 1983-403-517

PS Form 3800, Feb. 1982

Sent to	Ms. Carrie Chancey	
Street and No.	Rt. 1, Box 151	
P.O., State and ZIP Code	Poca, W.V. 25159	
Postage	\$	56
Certified Fee		.75
Special Delivery Fee		
Restricted Delivery Fee		
Return Receipt Showing to whom and Date Delivered		.70
Return receipt showing to whom, Date, and Address of Delivery		
TOTAL Postage and Fees	\$	2.01
Postmark or Date		

09/29/2023

*Winfield Case*

1397

079-0533

SERIAL NO. 1397 OPERATING DISTRICT PN Map Square Lot No. Warrant No. 41-29  
 FARM Black Betsey Land Co. NO. 5 LEASE NO.  
 COUNTY Putnam TAX DISTRICT TOWNSHIP Pocatalico STATE W. Va.  
 DRILLING COMMENCED October 29, 1952 DRILLING COMPLETED March 30, 1953

CONTRACTOR Company tools ADDRESS

ROCK PRESSURE RECORD				PRODUCING SAND RECORD			
Oriskany	Sand	1245 lbs., in	72 hrs.	Oriskany	Sand, from 4809 to 4832	Init. Prod. 1,107	M. C. F. G
	Sand	lbs., in	hrs.		Sand, from to	Init. Prod.	M. C. F. G
	Sand	lbs., in	hrs.		Sand, from to	Init. Prod.	M. C. F. G

OPEN FLOW				CASING RECORD				
Time, Condition: After shot				SIZE WEIGHT USED IN DRILLING LEFT IN WELL HOW CASING SET				
10ths Mercury in <del>two</del> three inch opening				13"	48#	323	323	Shoe.
Volume 2,157 M. C. F.				10"	35.75#	806	806	Shoe.
24 HOUR PRODUCTION TEST AFTER TUBING				8-5/8"	21#	2013	2013	BH Packer & Anchor Packer with 163' of anchor. <i>1850'</i>
M. C. F. Line Pressure				7"	21#	4731	4731	Shoe (10 sacks cement)
Bbls. Oil in 24 Hours				2 3/8"		48x6	48x6	<i>2w Rd. Thd. (Welded)</i>
<i>UNDER PRESS.</i> TUBED AND SHUT IN Date 6/16/53				SHOOTING RECORD				
Packer, Size — Kind —				Shot with 40 qts. from 4811 to 4832 Date 3/30/53				
Set, Depth — Size Anchor —				Gauge Before { <i>Shot</i> } Shot 1,107 Mcf Gauge 1 1/2 Hrs. After { <i>Shot</i> } Shot 2,157 M				
Perf. Top 4816 Bottom 48x6								
Perf. Top — Bottom —								
ELEVATION: 815								

FORMATION	COLOR	TOP	BOTTOM	STEEL LINE MEASUREMENTS	HARD OR SOFT	OIL, GAS OR WATER	DEPTH FOUND	REMARKS
Soil		0	40					
Slate & Shell		40	74					
Sand		74	95					
Slate		95	116					
Red Rock		116	122					
Slate		122	210					
Red Rock		210	320					
Lime	Blue	320	328					
Red Rock		328	378					
Slate		378	393					
Red Rock		393	400					
Sand	Gray	400	444					
Slate & Shell		444	470					
Red Rock		470	483					
Slate		483	534					
Sand		534	690					
Lime		690	704					
Sand		704	932			Water	840	1 - 10" blr. per hr.
Slate & Shell		932	1267					
Sand		1267	1278					
Slate & Shell		1278	1340			Water	1427	Hole filling up.
Salt Sand		1340	1658					
Slate		1658	1665					
Little Lime		1665	1700			Gas	1875	Show.
BIG LIME		1700	1906					
Injun Sand		1906	1945					
Lime	Black	1945	2090					
Slate & Shell		2090	2330					
Shale	Brown	2330	2351					
BEPEA	-1536	2351	2368					
Lime		2368	2410					
Slate		2410	2420					
Slate & Shell		2420	3536			Oil & Gas @	3236	show.
Shale	Brown	3536	3600			Gas	3551	100 Mcf decreased to 82 Mcf at 3558.
Shale & Shell		3600	3824					

*2351 / 815 / 1536*  
**RECEIVED**  
 JUN 21 1985  
 OIL & GAS DIVISION  
 DEPT. OF MINES

09/29/2023



SERIAL NO. 1397

FARM

Black Betsey

NO

5

OPERATING DIST. TOWNSHIP

PN

MAP SQUARE LOT NO. WARRANT NO.

1397

41-29

FORMATION	COLOR	TOP	BOTTOM	STEEL LINE MEASUREMENTS	HARD OR SOFT	OIL, GAS OR WATER	DEPTH FOUND	REMARKS
Shale	Brown	3824	4045	221			24	
Slate & Shell		4045	4230				221	
Shale	White	4230	4490				285	
Shale	Brown	4490	4721	231				
CORNIFEROUS	(-3906)	4721	4809	4731				
CRISKANY	(-3909)	4809	4832	4809		Gas	4819	327 Mcf increased
Lime		4832				Gas	4824	926 Mcf increased
						Gas	4830	1,107. Mcf.
Total Depth			4832					

4045  
3536  
509

09/29/2023

TOTAL DEPTH

DATE

APPROVED

FOREMAN





STATE OF WEST VIRGINIA  
DEPARTMENT OF ENERGY  
OIL AND GAS WELLS DIVISION

INSPECTOR'S WELL REPORT

Permit No. \_\_\_\_\_

Oil or Gas Well \_\_\_\_\_  
(KIND)

Company _____ Address _____ Farm _____ Well No. _____ District _____ County _____ Drilling commenced _____ Drilling completed _____ Total depth _____ Date shot _____ Depth of shot _____ Initial open flow _____ /10ths Water in _____ Inch Open flow after tubing _____ /10ths Merc. in _____ Inch Volume _____ Cu. Ft. Rock pressure _____ lbs. _____ hrs. Oil _____ bbls., 1st 24 hrs. Fresh water _____ feet _____ feet Salt water _____ feet _____ feet	CASING AND TUBING	USED IN DRILLING	LEFT IN WELL	PACKERS
	Size 16 13 10 8 1/4 6 5/8 5 3/16 3 2 Liners Used			
CASING CEMENTED _____ SIZE _____ No. FT. _____ Date _____				
NAME OF SERVICE COMPANY _____				
COAL WAS ENCOUNTERED AT _____ FEET _____ INCHES				
_____ FEET _____ INCHES _____ FEET _____ INCHES				
_____ FEET _____ INCHES _____ FEET _____ INCHES				

Drillers' Names \_\_\_\_\_

Remarks: \_\_\_\_\_

09/29/2023







STATE OF WEST VIRGINIA  
DEPARTMENT OF ENERGY  
OIL AND GAS WELLS DIVISION

INSPECTOR'S WELL REPORT

Permit No. \_\_\_\_\_

Oil or Gas Well \_\_\_\_\_  
(KIND)

Company _____	CASING AND TUBING	USED IN DRILLING	LEFT IN WELL	PACKERS
Address _____	Size			Kind of Packer _____
Farm _____	16			
Well No. _____	13			
District _____ County _____	10			Size of _____
Drilling commenced _____	8 1/4			
Drilling completed _____ Total depth _____	6 5/8			Depth set _____
Date shot _____ Depth of shot _____	5 3/16			
Initial open flow _____ /10ths Water in _____ Inch	3			Perf. top _____
Open flow after tubing _____ /10ths Merc. in _____ Inch	2			Perf. bottom _____
Volume _____ Cu. Ft.	Liners Used			Perf. top _____
Rock pressure _____ lbs. _____ hrs.				Perf. bottom _____
Oil _____ bbls., 1st 24 hrs.	CASING CEMENTED _____ SIZE _____ No. FT. _____ Date _____			
Fresh water _____ feet _____ feet	NAME OF SERVICE COMPANY _____			
Salt water _____ feet _____ feet	COAL WAS ENCOUNTERED AT _____ FEET _____ INCHES			
	_____ FEET _____ INCHES _____ FEET _____ INCHES			
	_____ FEET _____ INCHES _____ FEET _____ INCHES			

Drillers' Names \_\_\_\_\_

Remarks:

09/29/2023







RECEIVED  
AUG 1 1950

STATE OF WEST VIRGINIA  
DEPARTMENT OF ENERGY  
OIL AND GAS WELLS DIVISION

DIVISION OF OIL & GAS  
DEPARTMENT OF ENERGY

INSPECTOR'S WELL REPORT

Permit No. \_\_\_\_\_

Oil or Gas Well \_\_\_\_\_  
(KIND)

	CASING AND TUBING	USED IN DRILLING	LEFT IN WELL	PACKERS
Company _____				
Address _____	Size			
Farm _____	16			Kind of Packer _____
Well No. _____	13			
District _____ County _____	10			Size of _____
Drilling commenced _____	8 1/4			
Drilling completed _____ Total depth _____	6 3/8			Depth set _____
Date shot _____ Depth of shot _____	5 3/16			
Initial open flow _____ /10ths Water in _____ Inch	3			Perf. top _____
Open flow after tubing _____ /10ths Merc. in _____ Inch	2			Perf. bottom _____
Volume _____ Cu. Ft.	Liners Used			Perf. top _____
Rock pressure _____ lbs. _____ hrs.				Perf. bottom _____
Oil _____ bbls., 1st 24 hrs.	CASING CEMENTED _____ SIZE _____ No. FT. _____ Date _____			
Fresh water _____ feet _____ feet	NAME OF SERVICE COMPANY _____			
Salt water _____ feet _____ feet	COAL WAS ENCOUNTERED AT _____ FEET _____ INCHES			
	_____ FEET _____ INCHES _____ FEET _____ INCHES			
	_____ FEET _____ INCHES _____ FEET _____ INCHES			

Drillers' Names \_\_\_\_\_

Remarks: \_\_\_\_\_

09/29/2023



STATE OF WEST VIRGINIA  
DEPARTMENT OF ENERGY  
OIL AND GAS WELLS DIVISION

RECEIVED  
SEP 10 1985

DIVISION OF OIL & GAS  
DEPARTMENT OF ENERGY

INSPECTOR'S WELL REPORT

Permit No. 079-0533-P

Oil or Gas Well \_\_\_\_\_  
(KIND)

Company Gabot Oil + Gas

Address \_\_\_\_\_

Farm Garnie Chancey

Well No. Black Betsy #5

District Pocatalico County Putnam

Drilling commenced \_\_\_\_\_

Drilling completed \_\_\_\_\_ Total depth \_\_\_\_\_

Date shot \_\_\_\_\_ Depth of shot \_\_\_\_\_

Initial open flow \_\_\_\_\_ /10ths Water in \_\_\_\_\_ Inch

Open flow after tubing \_\_\_\_\_ /10ths Merc. in \_\_\_\_\_ Inch

Volume \_\_\_\_\_ Cu. Ft.

Rock pressure \_\_\_\_\_ lbs. \_\_\_\_\_ hrs.

Oil \_\_\_\_\_ bbls., 1st 24 hrs.

Fresh water \_\_\_\_\_ feet \_\_\_\_\_ feet

Salt water \_\_\_\_\_ feet \_\_\_\_\_ feet

CASING AND TUBING	USED IN DRILLING	LEFT IN WELL	PACKERS
Size			Kind of Packer _____
16			
13			Size of _____
10			
8 1/4			Depth set _____
6 3/8			
5 3/16			Perf. top _____
3			Perf. bottom _____
2			Perf. top _____
Liners Used			Perf. bottom _____

CASING CEMENTED \_\_\_\_\_ SIZE \_\_\_\_\_ No. FT. \_\_\_\_\_ Date \_\_\_\_\_

NAME OF SERVICE COMPANY \_\_\_\_\_

COAL WAS ENCOUNTERED AT \_\_\_\_\_ FEET \_\_\_\_\_ INCHES

\_\_\_\_\_ FEET \_\_\_\_\_ INCHES \_\_\_\_\_ FEET \_\_\_\_\_ INCHES

\_\_\_\_\_ FEET \_\_\_\_\_ INCHES \_\_\_\_\_ FEET \_\_\_\_\_ INCHES

Drillers' Names \_\_\_\_\_

Remarks:  
Location reclaimed + seeded.

9-5-85  
DATE

09/29/2023  
Carlos W. Hively  
DISTRICT WELL INSPECTOR









1) Date: June 18, 1985  
 2) Operator's Well No. Black Betsy #5  
 3) API Well No. 47 - 079 - 0533 P  
 State County Permit

STATE OF WEST VIRGINIA  
OFFICE OF OIL AND GAS, DEPARTMENT OF MINES

APPLICATION FOR A PERMIT TO PLUG AND ABANDON A WELL

4) WELL TYPE: A Oil \_\_\_\_\_ / Gas X / Liquid injection \_\_\_\_\_ / Waste disposal \_\_\_\_\_  
 B (If "Gas", Production \_\_\_\_\_ X / Underground storage) \_\_\_\_\_ / Deep \_\_\_\_\_ Shallow X /)  
 5) LOCATION: Elevation: 815.05 Watershed: Heizer Creek  
 District: Pocatalico 3 County: Putnam Quadrangle: Winfield Bancroft  
 6) WELL OPERATOR Cabot Oil & Gas Corp. of W.V. 7) DESIGNATED AGENT Robert E. Horrell  
 Address P.O. Box 454 Address P.O. Box 454  
Glasgow, W.V. 25086 8150 Glasgow, W.V. 25086  
 8) OIL & GAS INSPECTOR TO BE NOTIFIED 9) PLUGGING CONTRACTOR  
 Name Carlos W. Hively Name \_\_\_\_\_  
 Address 223 Pinch Ridge Road Address \_\_\_\_\_  
Elkview, W.V. 25071

10) WORK ORDER: The work order for the manner of plugging this well is as follows:

- 13" @ 323'                      10" @ 806'
- 8-5/8" @ 2013' on bottom hole packer and anchor pkr. @ 1850'      PBTD = 4660'
- 7" @ 4731' cemented w/10 sks.    Water @ 840'.
- 5 1/2" drilling tools hung in hole @ 3435'-3539'
- 7" casing cut @ 3230', 60', 90' and 3530', 60', 90'.

- (1) Run tubing to 3430' and pump cement plug 3430'-3130'. Circulate hole with gel. Pull tubing.
- (2) Cut 7" casing @ 2100' and pull out of hole. Set 7-7/8" bridge plug @ 2095'.
- (3) Cut 8" casing @ 1800' and pull out of hole.
- (4) Run tubing and pump cement plug 2100'-1750'.
- (5) Pull tubing to 900' and pump cement 900'-750'.
- (6) Cut 10" casing @ 350' and fill with cement from 350' to surface.
- (7) Erect monument.

RECEIVED  
 JUN 21 1985  
 OIL & GAS DIVISION  
 DEPT. OF MINES

OFFICE USE ONLY

PLUGGING PERMIT

Permit number 47-079-0533-P Date July 12 1985

This permit covering the well operator and well location shown below is evidence of permission granted to plug in accordance with the pertinent legal requirements subject to the conditions contained herein and on the reverse hereof. **Notification must be given to the District Oil and Gas Inspector 24 hours before actual permitted work has commenced.**

The permitted work is as described in the Notice and Application, plat, subject to any modifications and conditions on the reverse hereof.

Permit expires July 12, 1987 unless plugging is commenced prior to that date and prosecuted with due diligence.

Bond:	Agent: <input checked="" type="checkbox"/>	Plat:	Casing	Fee
<u>30</u>	<u>ALB</u>	<u>MH</u>	<u>MH</u>	<u>NA</u>

Margaret J. Rasse  
 Administrator, Office of Oil and Gas

NOTE: Keep one copy of this permit posted at the plugging location.

File

See the reverse side of the APPLICANT'S COPY for instructions to the well operator.

09/29/2023



OFFICE USE ONLY

PERMIT MODIFICATIONS AND CONDITIONS (IF ANY) TO THE PROPOSED PLUGGING

OFFICE OF OIL AND GAS DEPARTMENT OF MINES  
APPLICATION FOR A PERMIT TO PLUG AND ABANDON A WELL

WELL TYPE:  Oil  Gas  Other

LOCATION:  Production  Injection  Other

WELL OPERATOR: Good Oil & Gas Corp. of W.V.  
Address: P.O. Box 654  
Clarksburg, W.V. 26308

PLUGGING CONTRACTOR:  
Name: Carlton W. Hively  
Address: 223 Birch Hill Road  
Clarksburg, W.V. 26301

WORK ORDER: The work order for the proposed plugging is as follows:  
1. 2 1/2" casing to 3430', and plug cement plug 3430'-3130'. Circulate hole with gel pill-chasing.  
2. 2 1/2" casing to 2100', and pull out of hole. Set 7-7/8" bridge plug at 2095'.  
3. 2 1/2" casing to 2013', on bottom hole packer and anchor pack. Set 1850'. YIELD = 1000 LBS.  
4. 2 1/2" casing to 140' & 800'.

OFFICE USE ONLY

This part of Form IV-4(b) is to record the dates of certain occurrences and any follow-up inspections.

	Date	Follow-up inspection(s)	Date(s)
Application received			
Plugging started		" "	
Plugging completed		" "	
Well Record received		" "	

OTHER INSPECTIONS  
This permit covering the well operator and well location information provided is valid only in accordance with the conditions contained herein and on the exact location. Notification must be given to the District Oil and Gas Inspector if any change in the location or conditions of the well is made. Notification must be given to the District Oil and Gas Inspector if any change in the location or conditions of the well is made.

Reason: \_\_\_\_\_  
Reason: \_\_\_\_\_

Permit expires: July 10, 1997

Permit number: 67-079-0533-2

Signature: [Signature]  
Title: Agent  
Agency: APG

Inspector: [Signature]  
Title: Chief





1) Date: June 18 19 85  
2) Operator's Well No. Black Betsy #5  
3) API Well No. 47 - 079 - 0533  
State County Permit

STATE OF WEST VIRGINIA  
OFFICE OF OIL AND GAS, DEPARTMENT OF MINES  
NOTICE OF APPLICATION TO PLUG AND ABANDON A WELL

4) SURFACE OWNER(S) OF RECORD TO BE SERVED

- (i) Name Carrie Chancey  
Address Rt. 1, Box 151  
Poca, W.V. 25159
- (ii) Name Amherst Industries, Inc.  
Address Port Amherst  
Charleston, W.V. 25306
- (iii) Name \_\_\_\_\_  
Address \_\_\_\_\_

5 (i) COAL OPERATOR Not Operated

Address \_\_\_\_\_

5 (ii) COAL OWNER(S) WITH DECLARATION ON RECORD:

Name I.V. Cunningham  
Address 431 McKinley Ave.  
Charleston, W.V. 25314

Name \_\_\_\_\_  
Address \_\_\_\_\_

5 (iii) COAL LESSEE WITH DECLARATION ON RECORD:

Name \_\_\_\_\_  
Address \_\_\_\_\_

TO THE PERSON(S) NAMED ABOVE: You should have received this Form and the following documents:

- (1) The Application to Plug and Abandon a Well on Form IV-4(B), which sets out the parties involved in the work, and describes the well and its location and the plugging work order; and
- (2) The plat (surveyor's map) showing the well location on Form IV-6.

THE REASON YOU RECEIVED THESE DOCUMENTS IS THAT YOU HAVE RIGHTS REGARDING THE APPLICATION WHICH ARE SUMMARIZED IN THE "INSTRUCTIONS" ON THE REVERSE SIDE OF THE COPY OF THE APPLICATION (FORM IV-4(B)) DESIGNATED FOR YOU. HOWEVER, YOU ARE NOT REQUIRED TO TAKE ANY ACTION AT ALL.

Take notice that under Chapter 22 of the West Virginia Code, the undersigned well operator proposes to file or has filed this Notice and Application and accompanying documents for a Permit to plug and abandon a well with the Administrator of the Office of Oil and Gas, West Virginia Department of Mines, with respect to the well at the location described on the attached Application and depicted on the attached Form IV-6. Copies of this Notice, the Application, and the plat have been mailed by registered or certified mail or delivered by hand to the person(s) named above (or by publication in certain circumstances) on or before the day of mailing or delivery to the Administrator.

RECEIVED  
JUN 21 1985  
DEPT. OF MINES

The truth of the information on the Notice and Application is verified and sworn to and the Notice is signed on behalf of the Well Operator in my County and State by

WELL OPERATOR Cabot Oil & Gas Corp. of W.V.

By Robert E. Howell  
Its District Production Superintendent

this 18 day of June, 19 85.  
My commission expires March 5, 19 89.

Address P.O. Box 454  
Glasgow, W.V. 25086

Telephone (304) 595-5015

Loren Miller  
Notary Public, Kanawha County,  
State of West Virginia

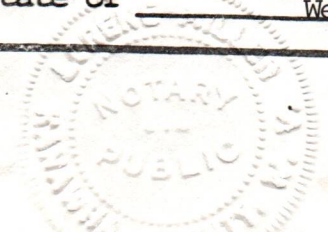



I N S T R U C T I O N S T O A P P L I C A N T

CONCERNING THE LINE ITEMS:

- 1) Date of Notice.
- 2) Your well name and number.
- 3) To be filled out by the Office of Oil & Gas.
- 4) & 5) Use separate sheet if necessary.
- 4) Surface owner(s) of record to be served with Notice and Application. However, see also Code § 22-4-1m(b) if "more than three tenants in common or other co-owners of interest described in subsection (a) of this section hold interests in such lands".
- 5(i) "Coal Operator" means any person, firm, partnership, partnership association or corporation that proposes to or does operate a coal mine.
- 5(ii, iii) See Code § 22-4-20.

CONCERNING THE REQUIRED COPIES FOR FILING AND SERVICE:

Filing. Code § 22-4-1k and Regulation 7.02 provide that the original and two copies of the Application must be filed with the Administrator, accompanied by (i) an original and four copies of the Notice, (ii) an original and four copies of a plat in the form prescribed by Regulation 11, and (iii) a bond in one of the forms prescribed by Regulation 11 or in lieu thereof the other security allowed by Code § 22-4-9.

Service. In addition, service must be made on the surface owner(s) and the person(s) who has an interest in the coal. See Code §§ 22-4-1m and 22-4-9.



09/29/2023













**RECEIVED**  
DEPARTMENT OF ENERGY  
OIL AND GAS

JAN 8 1986

State of West Virginia  
Department of Energy  
Oil and Gas Division  
Charleston 25311  
FINAL INSPECTION REPORT  
INSPECTORS COMPLIANCE REPORT  
September 13, 1985

COMPANY Cabot Oil & Gas Corp. of WV PERMIT NO 079-0533-P (7-12-85)  
P. O. Box 434 FARM & WELL NO Carrie Chancey #5  
Glasgow, West Virginia 25086 DIST. & COUNTY Pocatalico/Putnam

RULE	DESCRIPTION	IN COMPLIANCE	
		Yes	No
23.06	Notification Prior to Starting Work	_____	_____
16.01	Required Permits at Wellsite	_____	_____
17.02	Method of Plugging	_____	_____
18.01	Materials used in Plugging	_____	_____
23.02	Maintained Access Roads	_____	_____
25.01	Necessary Equipment to Prevent Waste	_____	_____
23.04	Reclaimed Drilling Pits	_____	_____
23.05	No Surface or Underground Pollution	_____	_____
17.06	Statutory Affidavit	_____	_____
7.06	Parties Responsible	_____	_____
7.05	Identification Markings	_____	_____

I HAVE INSPECTED THE ABOVE CAPTIONED WELL AND RECOMMEND THAT IT BE RELEASED:

SIGNED Carlos Hively  
DATE 1/3/86

Your Affidavit of Plugging was received and reclamation requirements approved. The well designated by the above permit number has been released under your bond.

T. L. ...  
Director- Division of Oil & Gas  
January 14, 1986  
DATE



8800'

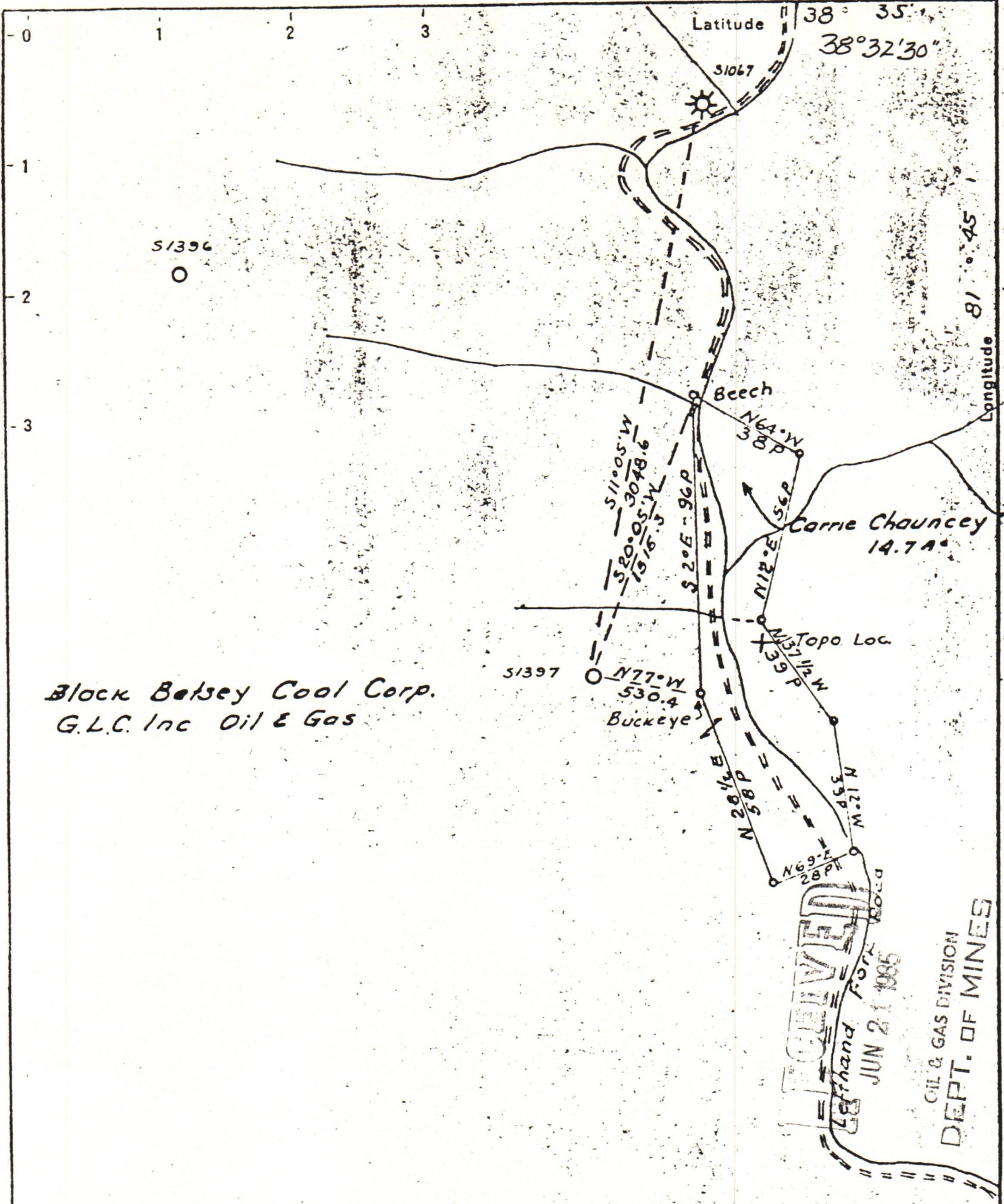

Black Betsy Coal Corp.  
G.L.C. Inc Oil & Gas

RECEIVED  
JUN 21 1985  
OIL & GAS DIVISION  
DEPT. OF MINES

New Location   
 Drill Deeper   
 Abandonment  - 7-12-85

CABOT OIL & GAS CORP. OF W.VA.  
 P.O. Box 454- Glasgow, WVa. 25086  
 Surface: Carrie Chancey  
 Farm Black Betsy Land Corp  
 Tract \_\_\_\_\_ Acres 2500 Lease No. 3-468  
 Well (Farm) No. 5 Serial No. 1397  
 Elevation (Spirit Level) 815.05  
 Quadrangle Winfield  
 County Putnam District Pocotalico  
 Engineer H.J. Simmons Jr  
 Engineer's Registration No. 1652  
 File No. \_\_\_\_\_ Drawing No. \_\_\_\_\_  
 Date 9-24-52 Scale 1"=660'

STATE OF WEST VIRGINIA  
 DEPARTMENT OF MINES  
 OIL AND GAS DIVISION  
 CHARLESTON

WELL LOCATION MAP  
 FILE NO. 079-0533-P

09/29/2023

+ Denotes location of well on United States Topographic Maps, scale 1 to 62,500, latitude and longitude lines being represented by border lines as shown.  
 - Denotes one inch spaces on border line of original tracing.