

New Location
 Drill Deeper
 Abandonment issued 3/12/75

Company McDunkin Corporation
Box 573 Charleston
 Address Finerite WVA 25322
 Farm L.A. Landers et al
 Tract _____ Acres 5.3 1/2 Lease No. _____
 Well (Farm) No. 1 Serial No. 1
 Elevation (Spirit Level) 936.1
 Quadrangle Winfield SE
 County Putnam District Pocahontas
 Engineer H. J. Johnson Jr.
 Engineer's Registration No. 1652
 File No. _____ Drawing No. _____
 Date 2-25-50 Scale 1" = 660'

STATE OF WEST VIRGINIA
 DEPARTMENT OF MINES
 OIL AND GAS DIVISION
 CHARLESTON

WELL LOCATION MAP
 FILE NO. PUL-435-P

+ Denotes location of well on United States Topographic Maps, scale 1 to 62,500, latitude and longitude lines being represented by border lines as shown.

- Denotes one inch spaces on border line of original tracing.

47-079

deep well

MAR 24 1975

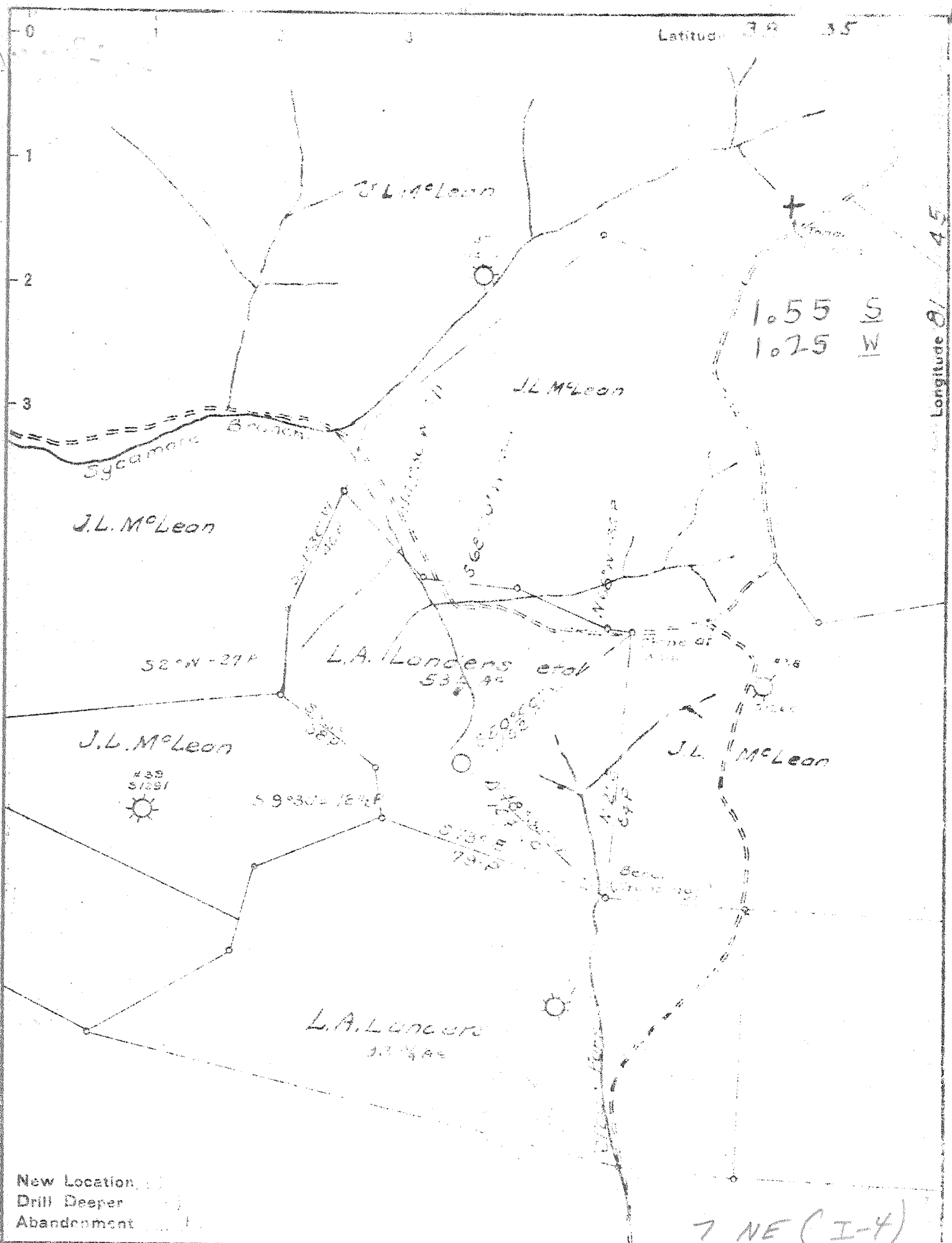

New Location
 Drill Deeper
 Abandonment

7 NE (I-4)

Company C.L. Samples
 Address Pineville W.Va.
 Farm L.A. Landers et al
 Tract _____ Acres 5 3/4 Lease No. _____
 Well (Farm) No. 1 Serial No. 1
 Elevation (Spirit Level) 936.1
 Quadrangle Winfield - SE.
 County Putnam District Pocotalica
 Engineer _____
 Engineer's Registration No. _____
 File No. _____ Drawing No. _____
 Date 2-25-50 Scale 1" = 660'

STATE OF WEST VIRGINIA
 DEPARTMENT OF MINES
 OIL AND GAS DIVISION
 CHARLESTON

WELL LOCATION MAP
 FILE NO. Put-435

+ Denotes location of well on United States Topographic Maps, scale 1 to 62,500, latitude and longitude lines being represented by border lines as shown.
 --- Denotes one inch spaces on border line of original tracing.

6-6-50 192

Deep Well

WEST VIRGINIA DEPARTMENT OF MINES
OIL & GAS DIVISION
W E L L R E C O R D

Gas Well
CASING & TUBING

Permit No. Put 435	C.L. Sample			
Winfield Quad.	Allison Park, Pa.	16	20	20
Company	L.A. Landers Estate Acres 56	10	914	914
Address	Clear Fork	8 1/2	2134	1323
Farm	1 Elev. 936	7	4963	4963
Location	Pocatalico Putnam County	2	5040	5040
Well No.	L.A. Landers Est.			
District	Landers Est., Liberty, W.Va.		Perf. bot 30	
Surface	4-17-50		Perf. top 5011	
Mineral	7-19-50			
Commenced	7-21-50 Depth 5019 to 5035			
Completed	with 40 qts.			
Date shot	60/10ths W in 7" 23 1/2			
Open Flow	3,700,000 C.F.			
Volume	825 lbs. 10 hrs.			
Rock Pressure	1675'; 1720' H.F.; 2085'			
Salt Water				

CASING CEMENTED:
7" 200' 7-12-50

No coal

Shale	Red	S	0	50
Shale	Gr	S	50	90
Slate	Red		90	155
Sand	Gr		155	195
Shale	Red		195	245
Sand	Gr		245	305
Shale	Bl		305	318
Shale	Red		318	400
Shale	Gr		400	413
Sand	Gr		413	425
Shale	Wh		425	435
Shale	Bl		435	525
Sand	Gr		525	530
Shale	Red		530	608
Sand	Gr		608	625
Shale	Red		625	640
Shale	Gr		640	675
Lime	Dk		675	725
Shale	Dk		725	756
Shale	Red		756	770
Lime			770	820
Shale	Red		820	845
Sand	Gr		845	898
Shale	Red		898	913
Sand	Wh		913	955
Shale	Gr		955	1090
Sand	Wh		1090	1235
Shale	Dk		1235	1480
Sand	Wh		1480	1570
Shale	Dk		1570	1608
- Sand	Wh <i>falt</i>		1608	1871
- Lime	Dk	H	1871	2080
Sand	Inj.		2080	2146
- Shale	Dk		2146	2555
- Sand	Gr		2555	2576
Slate	Dk		2576	3807
Shale	Br		3807	3877
Lime	Gr		3877	3898
Shale	Dk		3898	4028
Shale	Dr		4028	4293
Slate	Dk		4293	4655
Shale	Br		4655	4923
Shale	Br		4923	4932
- Shale	Blk		4932	4949
- Lime	Gr		4949	5018
- Sand	Wh	Oriskany	5018	5036
Lime	Wh		5036	5040
T.D.			5040	

Gas show 1720

Gas 5018-5036