

3-30-82

8000'

LATITUDE 39° 15' 00"

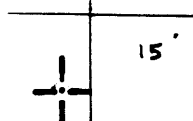

LONGITUDE 79° 45' 30"

R. BOLYARD

J. BOLYARD

BOWMAN

INTERSTATE LUMBER

SANDERS

R. M. WAGNER, et. al.

MINEAR

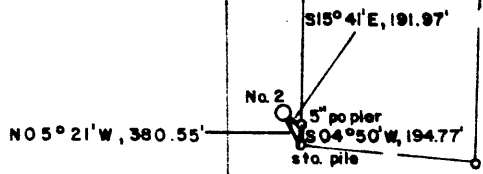

NORTH

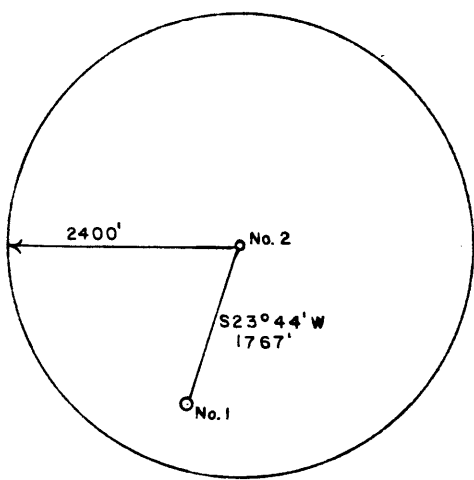

FILE NO. _____
 DRAWING NO. _____
 SCALE 1" = 2000'
 MINIMUM DEGREE OF ACCURACY 1 in 200
 PROVEN SOURCE OF ELEVATION TOP OF KNOB
 ELEV. 2030'

I THE UNDERSIGNED, HEREBY CERTIFY THAT THIS PLAT IS CORRECT TO THE BEST OF MY KNOWLEDGE AND BELIEF AND SHOWS ALL THE INFORMATION REQUIRED BY LAW AND THE REGULATIONS ISSUED AND PRESCRIBED BY THE DEPARTMENT OF MINES.
 (SIGNED) Robert B. Sand
 R.P.E. 5580 L.L.S. _____

PLACE SEAL HERE

STATE OF WEST VIRGINIA
 DEPARTMENT OF MINES
 OIL AND GAS DIVISION



DATE MARCH 19 19 82
 OPERATOR'S WELL NO. WAGNER NO. 2
 API WELL NO. 47-077-0227
 STATE COUNTY PERMIT

(+) DENOTES LOCATION OF WELL ON UNITED STATES TOPOGRAPHIC MAPS
 WELL TYPE: OIL ___ GAS X LIQUID INJECTION ___ WASTE DISPOSAL ___
 (IF "GAS,") PRODUCTION ___ STORAGE ___ DEEP ___ SHALLOW X

CANCELLED

LOCATION: ELEVATION 1936.50' WATER SHED SANDY CREEK
 DISTRICT RENO COUNTY PRESTON
 QUADRANGLE COLEBANK 7.5 min.

SURFACE OWNER R.M. WAGNER, et. al. ACREAGE 810
 OIL & GAS ROYALTY OWNER R.M. WAGNER, et. al. LEASE ACREAGE 810
 LEASE NO. _____

PROPOSED WORK: DRILL X CONVERT ___ DRILL DEEPER ___ REDRILL ___ FRACTURE OR STIMULATE ___ PLUG OFF OLD FORMATION ___ PERFORATE NEW FORMATION ___ OTHER PHYSICAL CHANGE IN WELL (SPECIFY) _____

JUN 10 1984

PLUG AND ABANDON ___ CLEAN OUT AND REPLUG ___
 TARGET FORMATION FOX ESTIMATED DEPTH 5600'
 WELL OPERATOR MERT DEVELOPMENT, INC. DESIGNATED AGENT JERRY POLING
 ADDRESS RT. 8, BOX 336AA ADDRESS RT. 8, BOX 336AA
 FAIRMONT, WV 26554 FAIRMONT, WV 26554

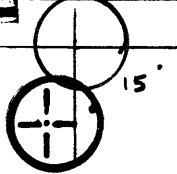

0.245
3 80w

R. BOLYARD

J. BOLYARD

BOWMAN

INTERSTATE LUMBER

SANDERS

R. M. WAGNER, et. al.

MINEAR

No. 2
N05°21'W, 380.55'
S04°50'W, 194.77'
5" poplar
sto. pile

S15°41'E, 191.87'

No. 1

79° 45'
79° 47' 30'

LONGITUDE

NORTH

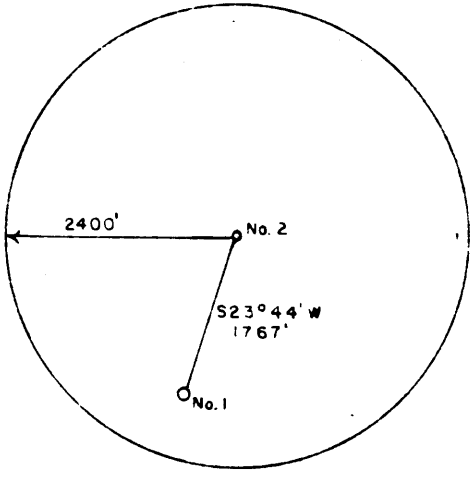

FILE NO. _____
DRAWING NO. _____
SCALE 1" = 2000'
MINIMUM DEGREE OF ACCURACY 1 in 200
PROVEN SOURCE OF ELEVATION TOP OF KNOB
ELEV. 2030'

I THE UNDERSIGNED, HEREBY CERTIFY THAT THIS PLAT IS CORRECT TO THE BEST OF MY KNOWLEDGE AND BELIEF AND SHOWS ALL THE INFORMATION REQUIRED BY LAW AND THE REGULATIONS ISSUED AND PRESCRIBED BY THE DEPARTMENT OF MINES.
(SIGNED) _____
R.P.E. 5580 L.L.S. _____

PLACE SEAL HERE

STATE OF WEST VIRGINIA
DEPARTMENT OF MINES
OIL AND GAS DIVISION



DATE MARCH 19, 1982
OPERATOR'S WELL NO. WAGNER NO. 2
API WELL NO. _____
47 - 077 - 0227
STATE COUNTY PERMIT

(+) DENOTES LOCATION OF WELL ON UNITED STATES TOPOGRAPHIC MAPS
WELL TYPE: OIL ___ GAS X LIQUID INJECTION ___ WASTE DISPOSAL ___
(IF "GAS,") PRODUCTION ___ STORAGE ___ DEEP ___ SHALLOW X
LOCATION: ELEVATION 1936.50' WATER SHED SANDY CREEK
DISTRICT RENO COUNTY PRESTON
QUADRANGLE COLEBANK 7.5 min. Belington 15' NE
SURFACE OWNER R. M. WAGNER, et. al. ACREAGE 810
OIL & GAS ROYALTY OWNER R. M. WAGNER, et. al. LEASE ACREAGE 810
LEASE NO. _____
PROPOSED WORK: DRILL X CONVERT ___ DRILL DEEPER ___ REDRILL ___ FRACTURE OR STIMULATE ___ PLUG OFF OLD FORMATION ___ PERFORATE NEW FORMATION ___ OTHER PHYSICAL CHANGE IN WELL (SPECIFY) _____

PLUG AND ABANDON ___ CLEAN OUT AND REPLUG ___
TARGET FORMATION FOX ESTIMATED DEPTH 5600'
WELL OPERATOR MERT DEVELOPMENT, INC. DESIGNATED AGENT JERRY POLING
ADDRESS RT. 8, BOX 336AA ADDRESS RT. 8, BOX 336AA
FAIRMONT, WV 26554 FAIRMONT, WV 26554

APR 16 1982



STATE OF WEST VIRGINIA
OFFICE OF OIL AND GAS - DEPARTMENT OF MINES

OIL AND GAS WELL PERMIT APPLICATION

WELL TYPE: Oil ___ / Gas X / _____
(If "Gas", Production ___ / Underground storage ___ / Deep X / Shallow ___ /)
LOCATION: Elevation: 1936.50 Watershed: Sandy Creek
District: Reno County: Preston Quadrangle: Colebank 7.5 min.

WELL OPERATOR MERT DEVELOPMENT INC.
Address Route 8 - Box 336-AA
Fairmont, W. Va. 26554

DESIGNATED AGENT Jerry Poling
Address Route 8 - Box 336-AA
Fairmont, W. Va. 26554

OIL AND GAS ROYALTY OWNER R. M. Wagner, et al
Address Box 99 - RR 2
Newtown, Pa. 18940
Acreage 810

COAL OPERATOR R. M. Wagner et al
Address Box 99 RR 2
Newtown, Pa. 18940

SURFACE OWNER R. M. Wagner, et al
Address Box 99 - RR 2
Newtown, Pa. 18940
Acreage 810

COAL OWNER(S) WITH DECLARATION ON RECORD:
NAME NA
Address _____
NAME NA
Address _____

FIELD SALE (IF MADE) TO:
NAME NA
Address _____

COAL LESSEE WITH DECLARATION ON RECORD:
NAME _____
Address _____

OIL AND GAS INSPECTOR TO BE NOTIFIED:
NAME Bill Blosser
Address Route 4 - Box 317
Fairmont, W. Va. 26554
Telephone 363-9105

RECEIVED

MAR 29 1982

OIL AND GAS DIVISION
WV DEPARTMENT OF MINES

The undersigned well operator is entitled to operate for oil or gas purposes at the above location under a deed ___ / lease X / other contract ___ / dated Feb. 2, 1982, to the undersigned well operator from R. M. Wagner, et, al.

(If said deed, lease, or other contract has been recorded:)

Recorded on Feb. 5, 1982, in the office of the Clerk of County Commission of Preston County, West Virginia, in 496 Book at page 989. A permit is requested as follows:

PROPOSED WORK: Drill X / Drill Deeper ___ / Redrill ___ / Fracture or stimulate ___ / Plug off old formation ___ / Perforate new formation ___ / Other physical change in well (specify) _____

--planned as shown on the work order on the reverse side hereof.

The above named coal operator, coal owner(s), and coal lessee are hereby notified that any objection they wish to make or are required to make by Code §22-4-3 must be filed with the Department of Mines within fifteen (15) days after receipt of this Application by the Dept. Copies of this Permit Application and the enclosed plat and reclamation plan have been mailed by registered mail or delivered by hand to the above named coal operator, coal owner(s), and coal lessees on or before the day of the mailing or delivery of this Application to the Department of Mines at Charleston, West Virginia.

PLEASE SUBMIT COPIES OF ALL GEOPHYSICAL LOGS DIRECTLY TO:

WEST VIRGINIA OIL AND GAS CONSERVATION COMMISSION
1613 WASHINGTON ST., E.
CHARLESTON, WV 25311
Telephone - 304/348-3092

BLANKET BOND

MERT Development, Inc.
Well Operator

By: [Signature]
Its: Geologist

(Reverse)

(Revised 3-81)

PROPOSED WORK ORDER

THIS IS AN ESTIMATE ONLY:
ACTUAL INFORMATION MUST BE SUBMITTED ON FORM IV-35 UPON COMPLETION

DRILLING CONTRACTOR (IF KNOWN) _____

Address _____

GEOLOGICAL TARGET FORMATION

Devonian Shale

Estimated depth of completed well 5862 feet. Rotary X / Cable tools /
Approximate water strata depths: Fresh, 287 feet; salt, 1613 feet.
Approximate coal seam depths: 107, 232, 287
Is coal being mined in this area: Yes / No X /

CASING AND TUBING PROGRAM

CASING OR TUBING TYPE	SPECIFICATIONS					FOOTAGE INTERVALS		CEMENT FILL UP OR SACKS Cubic ft.	PACKERS
	Size	Grade	Weight per ft	New	Used	For Drilling	Left in Well		
Conductor	11 3/4			X		290'	290'	CTS	Kinds
Fresh water:									
Coal									Sizes
Intermed.	8 5/8			X		1553	1553	100 SK	CTS
Production	4 1/2			X		5800	5800	300 SK	Depths set
Tubing	1 5/8			X		5762	5762		
Liners									Perforations:
									Top Bottom
									4008 5462

NOTE: Regulation 7.02 of the Department of Mines provides that the original and four copies of Form IV-2 must be filed with the Department, accompanied by (i) a plat in the form prescribed by Regulation 11, (ii) a bond in one of the forms prescribed by Regulation 12, or in lieu thereof the other security allowed by Code §22-4-2, (iii) Form IV-9, "Reclamation Plan" applicable to the reclamation required by Code §22-4-12b and Regulation 23, (iv) unless previously paid on the same well, the fee required by Code §22-4-12a, and (v) if applicable, the consent required by Code §22-4-8a from the owner of any water well or dwelling within 200 feet of the proposed well.

A separate Form IV-2 shall not be required for fracturing or stimulating a well where fracturing or stimulating is to be part of the work for which a permit is sought and is noted as such on the Form IV-2 filed in connection therewith.

THIS PERMIT MUST BE POSTED AT THE WELL SITE.

ALL PROVISIONS BEING IN ACCORDANCE WITH CHAPTER 22,

ARTICLE 4 OF THE W. VA. CODE, THE LOCATION IS HEREBY

APPROVED FOR drilling THIS PERMIT SHALL EXPIRE

IF OPERATIONS HAVE NOT COMMENCED BY 12-2-82

BY [Signature]

The following waiver must be completed by the coal operator and by any coal owner or coal lessee who has recorded a declaration under Code §22-4-20, if the permit is to be issued within fifteen (15) days of receipt thereof:

W A I V E R

The undersigned coal operator / owner / lessee / of the coal under this well location has examined this proposed well location. If a mine map exists which covers the area of the well location, the well location has been added to the mine map. The undersigned has no objection to the work proposed to be done at this location, provided the well operator has complied with all applicable requirements of the West Virginia Code and the governing regulations.

Date: , 19 .

By: _____

Its: _____