

Minimum Error of Closure 1' IN 200'  
 Source of Elevation ROAD FORKS - Jct. W.VA. SLS-66 & W.VA. SLS-66/2. FELLOWSVILLE 7 1/2' TOPO MAP - ELEV. 1540'  
 "I, the undersigned, hereby certify that this map is correct to the best of my knowledge and belief and shows all the information required by paragraph 6 of the rules and regulations of the oil and gas section of the mining laws of West Virginia."

- New Location
- Drill Deeper
- Abandonment

MAP SHEET-1133 B-3 F.B. 1554 Pg. 17-19

Company CONSOLIDATED GAS SUPPLY CORP  
 Address CLARKSBURG, W.VA.  
 Farm GERALD McDANIEL  
 Tract \_\_\_\_\_ Acres 152± Lease No. 75266  
 Well (Farm) No. \_\_\_\_\_ Serial No. 11302  
 Elevation (Spirit Level) 1824'  
 Quadrangle THORNTON EC  
 County PRESTON District RENO  
 Engineer Jackson M. Jarvis  
 Engineer's Registration No. 2397  
 File No. \_\_\_\_\_ Drawing No. \_\_\_\_\_  
 Date 7-20-70 Scale 1" = 1320'

STATE OF WEST VIRGINIA  
 DEPARTMENT OF MINES  
 OIL AND GAS DIVISION  
 CHARLESTON

**WELL LOCATION MAP**  
 FILE NO. PRES-152

+ Denotes location of well on United States Topographic Maps, scale 1 to 62,500, latitude and longitude lines being represented by border lines as shown.  
 — Denotes one inch spaces on border line of original tracing.

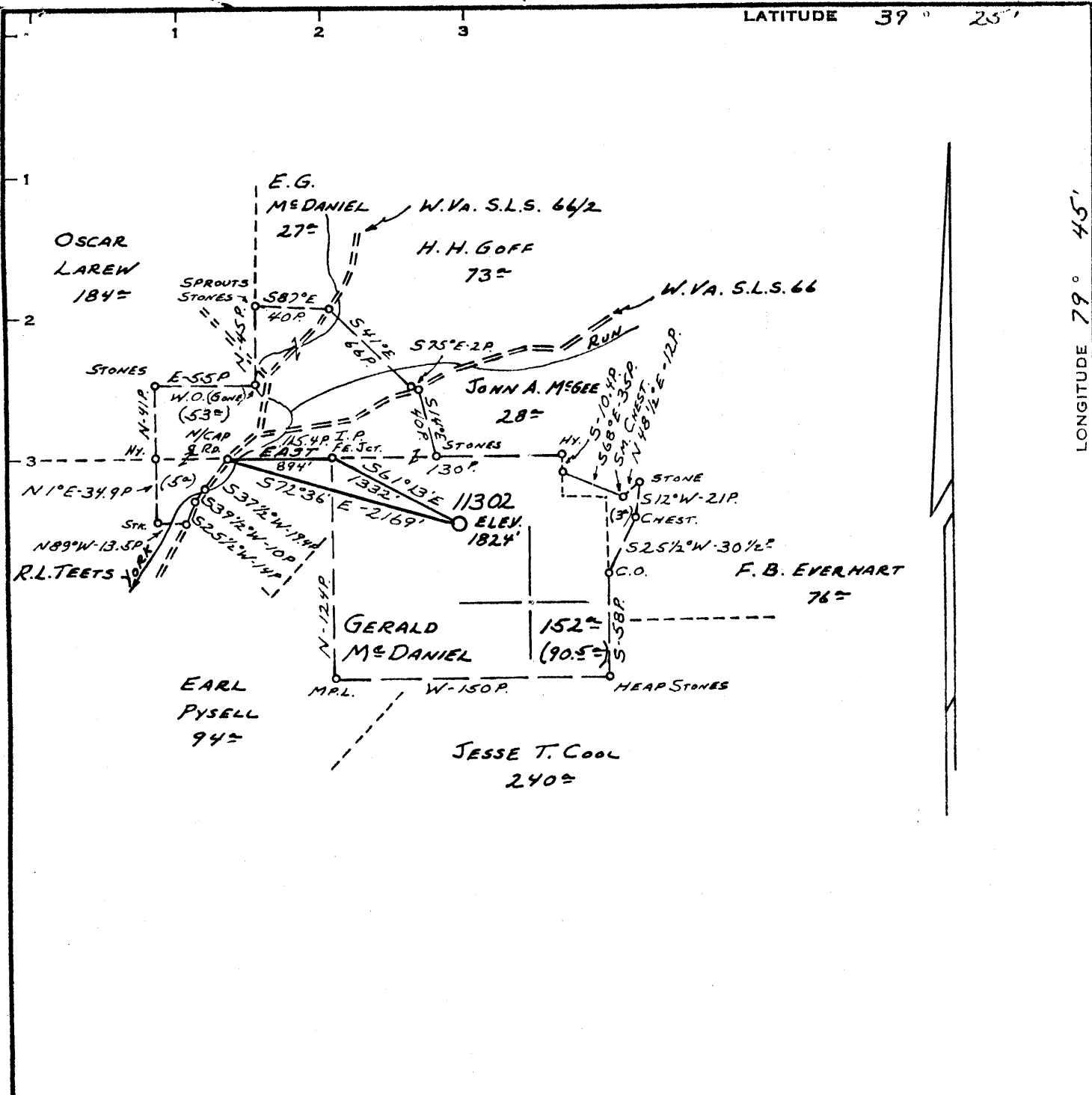

Minimum Error of Closure 1' IN 200'

Source of Elevation ROAD FORKS - Jct. W.V.A. SLS-66 & W.V.A. SLS-66/2. FELLOWSVILLE 7 1/2' TOPO MAP - ELEV. 1540'

"I, the undersigned, hereby certify that this map is correct to the best of my knowledge and belief and shows all the information required by paragraph 6 of the rules and regulations of the oil and gas section of the mining laws of West Virginia."

New Location   
 Drill Deeper   
 Abandonment

issued 29<sup>th</sup> Aug., 1970

MAP SHEET-1133 B-3 F.B. 1554 Pg. 17-19

Company CONSOLIDATED GAS SUPPLY CORP  
 Address CLARKSBURG, W.VA.  
 Farm GERALD McDANIEL  
 Tract \_\_\_\_\_ Acres 152± Lease No. 75266  
 Well (Farm) No. \_\_\_\_\_ Serial No. 11302  
 Elevation (Spirit Level) 1824'  
 Quadrangle THORNTON EC  
 County PRESTON District RENO  
 Engineer Jackson M. Jarvis  
 Engineer's Registration No. 2397  
 File No. \_\_\_\_\_ Drawing No. \_\_\_\_\_  
 Date 7-20-70 Scale 1" = 1320'

STATE OF WEST VIRGINIA  
 DEPARTMENT OF MINES  
 OIL AND GAS DIVISION  
 CHARLESTON

WELL LOCATION MAP  
 FILE NO. PRES-152-P

+ Denotes location of well on United States Topographic Maps, scale 1 to 62,500, latitude and longitude lines being represented by border lines as shown.  
 - Denotes one inch spaces on border line of original tracing.



RECEIVED

SEP 2 1970

STATE OF WEST VIRGINIA  
DEPARTMENT OF MINES  
OIL AND GAS WELLS DIVISION

OIL & GAS DIVISION  
DEPT. OF MINES

Rotary  XXXX  
Sounding   
Cable Tools   
Storage

WELL RECORD

Oil or Gas Well  Dry Hole (KIND)

Quadrangle THORNTON  
Permit No. PRES-152

Company Consolidated Gas Supply Corporation  
Address Clarksburg, W. Va.  
Farm Gerald McDaniel Acres 152  
Location (waters) \_\_\_\_\_  
Well No. 11302 Elev. 1821'  
District Reno, County Preston  
The surface of tract is owned in fee by \_\_\_\_\_  
Address \_\_\_\_\_  
Mineral rights are owned by \_\_\_\_\_  
Address \_\_\_\_\_  
Drilling commenced 8-20-70  
Drilling completed 8-28-70  
Date Shot Not shot From \_\_\_\_\_ To \_\_\_\_\_  
With \_\_\_\_\_

Casing and Tubing	Used in Drilling	Left in Well	Packers
Size			Kind of Packer
16			
13			Size of
11" x 10	23	23	
8 1/4	1151	1151	Depth set
6 3/8			
5 3/16			Perf. top
4 1/2			Perf. bottom
3			Perf. top
2			Perf. bottom
Liners Used			

Open Flow /10ths Water in \_\_\_\_\_ Inch  
/10ths Merc. in \_\_\_\_\_ Inch  
Volume No. gas Dry Cu. Ft.  
Rock Pressure Not taken lbs hrs.  
Oil \_\_\_\_\_ bbls., 1st 24 hrs.  
WELL ACIDIZED (DETAILS) No  
WELL FRACTURED (DETAILS) No

Attach copy of cementing record.  
CASING CEMENTED \_\_\_\_\_ SIZE \_\_\_\_\_ No. Ft. \_\_\_\_\_ Date \_\_\_\_\_  
Amount of cement used (bags) Both strings to surface \_\_\_\_\_  
Name of Service Co. Halliburton  
COAL WAS ENCOUNTERED AT 120 FEET 36 INCHES  
205 FEET 60 INCHES 307 FEET 36 INCHES  
\_\_\_\_\_ FEET \_\_\_\_\_ INCHES \_\_\_\_\_ FEET \_\_\_\_\_ INCHES

RESULT AFTER TREATMENT (Initial open Flow or bbls.) \_\_\_\_\_  
ROCK PRESSURE AFTER TREATMENT \_\_\_\_\_ HOURS \_\_\_\_\_  
Fresh Water 35' 255' Feet Salt Water None Feet \_\_\_\_\_  
Producing Sand Benson Exploratory Depth 1360-75'

Formation	Color	Hard or Soft	Top	Bottom	Oil, Gas or Water	Depth	Remarks
Sand & Shale			0	120	Water	35'	Fresh
Coal			120	123			
Sand & Shale			123	205			
Coal			205	210			
Sand & Shale			210	307	Water	255'	Fresh
Coal			307	310			
Sand & Shale			310	1310			
Red Rock & Shale			1310	1185			
Big Lime			1185	1520			
Shale & Red Rock			1520	1900			
Gantz			1900	1920			
Sand & Shale			1920	3230			
Speechley			3230	3275			
Sand & Shale			3275	3150			
Balltown			3150	3550			
Sand & Shale			3550	1200			
Riley			1200	1210			
Shale			1210	1260			
BENSON			1260	1375	No shows in any formation		
Total Depth				1565'			

Consolidated Gas Supply Corporation  
145 West Main Street  
Clarksburg, W. Va.