

NOTES: - THIS MAP IS FOR WELL LOCATION ONLY AND DOES NOT REPRESENT A COMPLETE PROPERTY SURVEY
 - ALL PROPERTY OWNERS WITHIN 1000' LISTED ON PLAT ARE ON WELL WATER
 - FARM MAP NO. 170-13, X-70-STORAGE INV. MAP 6500 / 500
 - W.V. 107-00003-71000-100275-5001

(+) DENOTES LOCATION OF WELL ON UNITED STATES TOPOGRAPHIC MAPS (7 1/2")

FILE NO. _____
 DRAWING NO. _____
 SCALE 1" = 400'
 MINIMUM DEGREE OF ACCURACY 1/200'
 PROVEN SOURCE OF ELEVATION INDIAN ROCK IN BOY OF DOUBLE WHITE OAK ON NORTH SIDE OF BRAD 600' BELOW KINGSDOR ROW ELEV. 1070.40'

I THE UNDERSIGNED, HEREBY CERTIFY THAT THIS PLAT IS CORRECT TO THE BEST OF MY KNOWLEDGE AND BELIEF AND SHOWS ALL THE INFORMATION REQUIRED BY LAW AND THE REGULATIONS ISSUED AND PRESCRIBED BY THE DEPARTMENT OF ENERGY.
 (SIGNED) Charles Douglas Davidson
 R.P.E. _____ L.L.S. 812



STATE OF WEST VIRGINIA
 DEPARTMENT OF ENERGY
 OIL AND GAS DIVISION



DATE MARCH 4, 1996
 OPERATOR'S WELL NO. 7422
 API WELL NO. _____

WELL TYPE: OIL _____ GAS X LIQUID INJECTION _____ WASTE DISPOSAL _____
 (IF "GAS,") PRODUCTION _____ STORAGE X DEEP _____ SHALLOW _____
 LOCATION: ELEVATION 2026.10 WATER SHED GWARY RUN OF SALT LICK CREEK
 DISTRICT UNION COUNTY PRESTON
 QUADRANGLE TERRA ALTA, W.V.A. COORDINATES LAT: 39°24'03" LONG: 79°35'34"
 SURFACE OWNER UPTOP INC. (c/o PHIL SCHENK) ACREAGE 123
 OIL & GAS ROYALTY OWNER CLARENCE JONES HEIRS (c/o MADENE BOLDYARD) LEASE ACREAGE 123
 COAL OWNER _____ LEASE NO. 30401

PROPOSED WORK: DRILL _____ CONVERT _____ DRILL DEEPER _____ REDRILL _____ FRACTURE OR STIMULATE _____ PLUS OFF OLD FORMATION _____ PERFORATE NEW FORMATION X OTHER PHYSICAL CHANGE IN WELL (SPECIFY) STORAGE RECONDITION
Set well life cement drill pipe & frac.
 PLUS AND ABANDON _____ CLEAN OUT AND REPLUG _____
 TARGET FORMATION Carlsburg ESTIMATED DEPTH 5162'
 WELL OPERATOR COLUMBIA GAS TRANS. CORP. DESIGNATED AGENT RICHARD L. COY
 ADDRESS P.O. BOX 1273, CHARLESTON, W.V.A. 25325 ADDRESS P.O. BOX 1273, CHARLESTON, W.V.A. 25325

APR 26 1996

DEEP WELL

FORM 9-MA 1991

PRESTON COUNTY NAME PERMIT 0017

Latitude 39° 25'

Longitude 79° 35'

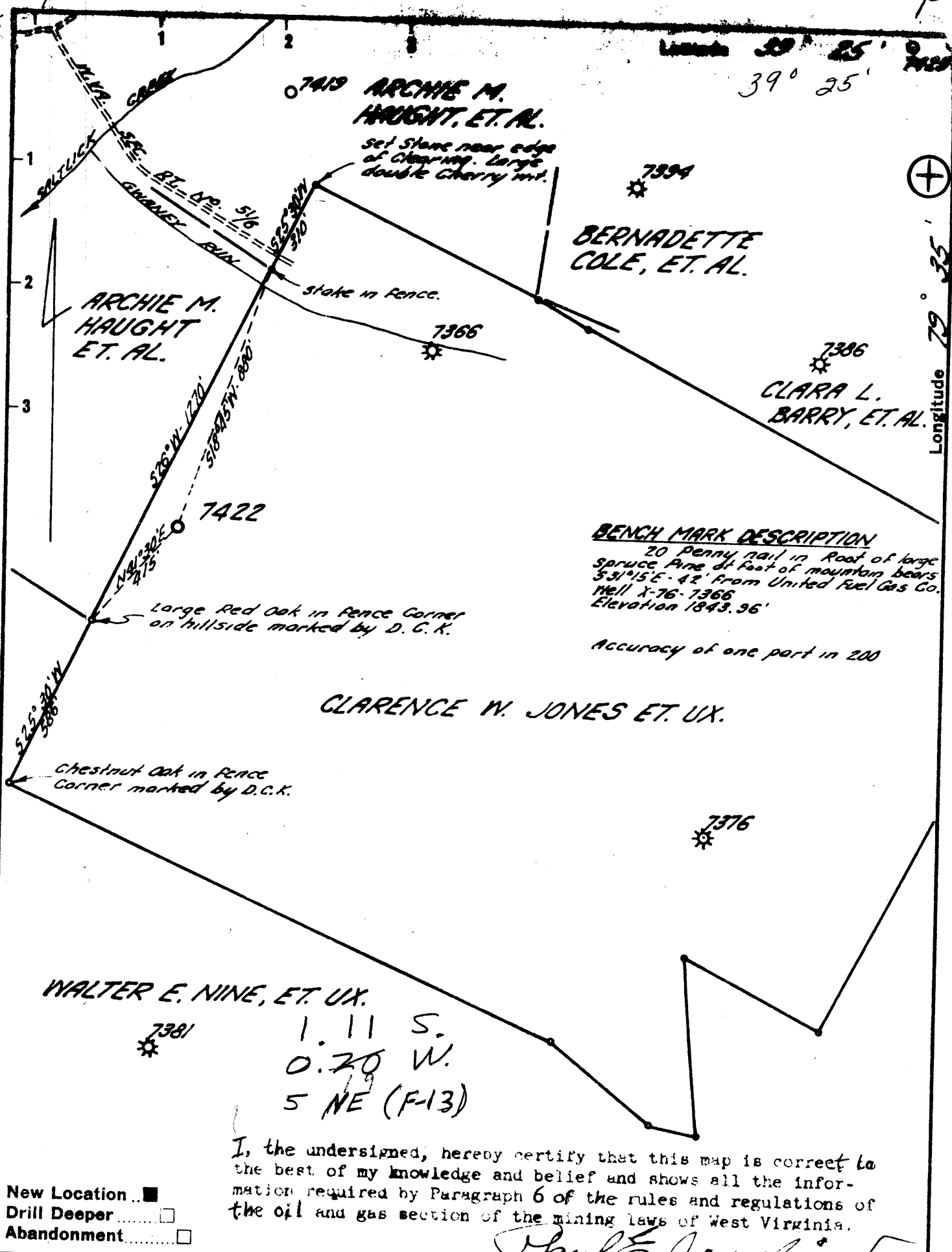

BENCH MARK DESCRIPTION
 20 Penny nail in Roof of large spruce Pine at foot of mountain bears 53°15'E - 42' from United Fuel Gas Co. Well X-76-7366 Elevation 1843.96'

Accuracy of one part in 200

CLARENCE W. JONES ET. UX.

WALTER E. NINE, ET. UX.

1.11 S.
 0.20 W.
 5 NE (F-13)

I, the undersigned, hereby certify that this map is correct to the best of my knowledge and belief and shows all the information required by Paragraph 6 of the rules and regulations of the oil and gas section of the mining laws of West Virginia.

Paul E. Joachims

New Location
 Drill Deeper
 Abandonment

STATE OF WEST VIRGINIA
 DEPARTMENT OF MINES
 OIL AND GAS DIVISION
 CHARLESTON

WELL LOCATION MAP
 FILE NO. PRES-117

+ Denotes location of well on United States Topographic Maps, scale 1 to 62,500, latitude and longitude lines being represented by border lines as shown.

- Denotes one inch spaces on border line of original tracing.

Company	ATLANTIC SEABOARD CORP.
Address	CHARLESTON, W. VA.
Farm	CLARENCE W. JONES ET. UX.
Tract	Acres <u>123</u> Lease No. <u>AS-401</u>
Well (Farm) No.	Serial No. <u>7422</u>
Elevation (Spirit Level)	<u>2013.24'</u>
Quadrangle	<u>KINGWOOD - C</u>
County	<u>PRESTON</u> District <u>UNION</u>
Engineer	<i>Paul E. Joachims</i>
Engineer's Registration No.	<u>669</u>
File No.	<u>172-131</u> Drawing No.
Date	<u>6-25-63</u> Scale <u>1" = 400'</u>

3 Sample 4040 - 5170' 9-1-2-70 Deep Well

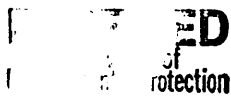

July 7 1997

State of West Virginia
Division of Environmental Protection
Section of Oil and Gas

Permitting
Office of Oil & Gas

Well Operator's Report of Well Work

Farm name: UpTop Inc. c/o Phil Schenk Operator well no.: 7422

LOCATION Elevation: 2013.24' Quadrangle: Terra Alta

District: Union County: Preston
Latitude: 2803 Feet South of 39 Deg. 25 Min. 0 Sec.
Longitude: 1503 Feet West of 79 Deg. 35 Min. 0 Sec.

Company: Columbia Gas Transmission
P.O. Box 1273
Charleston, WV 25325-1273

Agent: Richard L. Coty

Inspector: Phil Tracey

Permit Issued: 4/22/96

Well Work Commenced: 6/11/96

Well Work Completed: 8/14/96

Verbal Plugging

Permission granted on: N/A

Rotary Yes Cable Rig

Total Depth (ft) 5211'(DPM)

Fresh water depths (ft) See previous records

Salt water depths (ft) See previous records

Is coal being mined in the area (Y/N) ? N

Coal Depths (ft) N/A

Casing & Tubing Size	Used in Drilling	Left in Well	Cement Fill Up Cu. Ft.
13 3/8"	28'	28'	20 sxs surf.
9 5/8"	1368'	1368'	252ft3LitPoz 302 sxs surf.
7"	4791'	4791'	550ft3LitPoz 550sxs, 170 galClmt, Surf.
4 1/2"	740'	740'	Liner*** 125 sxs

Open Flow Data

Producing formation Chert Pay zone depth (ft) 4750'-4948**

Gas: Initial open flow N/A MCF/d Oil: Initial open flow N/A Bbl/d
 Final open flow N/A MCF/d Final open flow N/A Bbl/d
 Time of open flow between initial and final tests N/A Hours

Static rock Pressure N/A psig (surface pressure) after N/A Hours

Second producing formation Oriskany Pay zone depth (ft) 4980'-5094***

Gas: Initial open flow N/A MCF/d Oil: Initial open flow N/A Bbl/d
 Final open flow N/A MCF/d Final open flow N/A Bbl/d
 Time of open flow between initial and final tests N/A Hours

Static rock Pressure N/A psig (surface pressure) after N/A Hours

NOTE: On the back of this form put the following: 1). Details of perforated intervals, fracturing or stimulating, physical change etc. 2). The well log which is a systematic detailed geological record of all formations including coal encountered by the wellbore.

Notes: * Misplaced perms. 4960'-4980'
** Misplaced perms. 5094'-5111' & 5115'-5125'
** *4 1/2" liner run from 4448'-5210'

For: Columbia Gas Transmission Corp.
By:
Date:

**State of West Virginia
Division of Environmental Protection
Section of Oil and Gas**

Well Operator's Report of Well Work

Prior to rigging up the service rig, it was determined that the 2 3/8" tubing was plugged. Rigged up and tripped into the hole with Nowsco's coiled tubing. Tagged a bridge at 4727'. Washed through multiple bridges and cleaned out the fill in the tubing down to 5126' (EOT @ 5162'). Started to lose hole and determined that the tubing had been cleaned out down to the perforated joint and that fill from the annulus was falling into the tubing. Rigged down the coiled tubing unit. Halliburton started to kill the well down the tubing, but the tubing pressured up. Killed the well down the 7" x 2 3/8" annulus. Killed the well with 164 bbls of 9.2 ppg kill wt. workover fluid. Rigged up the service rig and pulled out of the hole with 160 jts. (5147.07') of 2 3/8", 10 rd. tubing. Atlas ran a Vertilog and CBL from 4730' to the surface. Attempted to set a Baker Model C retrievable bridge plug, but it stuck and set at 3237'. Fished out bridge plug, redressed and set at 4720'. Installed a new wellhead. Coated and protected the new wellhead as required. Tripped in the hole with 2 7/8" drill pipe and a Baker retrievable packer. Set the packer multiple times and pressure tested the casing. The final test was performed with the packer unset and 1200 psi surface pressure. Retrieved the bridge plug that was set at 4720'. Used as 6 1/8" bit to clean out the hole to 5160'. (Original TD was reported at 5171', but drilling measurements suggested that the TD was actually at 5160'.) Drilled a new hole to 5211'. The loggers TD'd the hole at 5184'. Atlas logged the hole with a Hex-Dip, CIBL and MacSonic. Lost hole while logging. Tripped in the hole with the drill pipe and cleaned out the hole to 5211'. Attempted to set 23 jts. of 4 1/2", 11.6#/ft N-80 LT&C casing liner from 4448'-5210'. The Baker hanger/packer assembly did not set properly. Attempted to pull out of the hole with all of the drill pipe and liner. Dropped the liner and hanger/packer assembly in the hole. Recovered all of the fish. Made a clean out trip to 5211' with the 6 1/8" bit and the 3 1/2" drill pipe. Tripped in the hole with a second Baker liner hanger/packer assembly and the 4 1/2" liner. Set the liner hanger to place the top of the liner at 4448' and the bottom at 5210'. Cemented the liner in place with 125 sxs of Standard cement with additives. Pulled off of the liner and circulated out the excess cement. Tripped in the hole and cleaned out the hole to the top of the liner at 4448'. Did not find any cement. Pressure tested the liner top to 2700 psi with 5550 psi surface pressure on top of a column of 9.2 ppg workover fluid. The top of the liner tested ok. Finished cleaning out the liner to the latch down collar at 5175.8' with a 3 7/8" MT bit. Displaced all of the completion fluid out of the hole. Atlas logged the hole with an SBT, Dir. Surv., and a GR/Neut. Atlas perforated the Oriskany from 4980'-5094' and the Chert from 4750'-4948'. All perforating was with 3 3/8" EHSC's, 21 gram RDX charges, 6 SPF and 60 deg phasing. Atlas had generator problems while perforating the intervals. Used Halliburton's coiled tubing truck to pickle the 4 1/2" casing and hydroblast the perforations with 2000 gal of 7 1/2% FE acid with additives. Attempted to treat both the Oriskany and Chert perforations in 5' intervals with the Halliburton Selective Injection Packer and 500 gals of 10% FE acid. Had problems treating several intervals (could not establish injection). While attempting to treat the 38' interval from 4910'-4948' could only locate 20' of perforations. Jetted the coil with N2 to unload the well to the 500 bbl frac. tank. The well was placed back in service on 8/14/96.

Due to the discrepancies with the perforated intervals Atlas ran a Vertilog on 9/3/96. As suspected there was a problem with the perforations. Seven of the initial 11 perforating runs were off depth by 31'. The well was reperforated on 9/4/96 to correct the previous problem. During this reperforating, one interval 4960'-4980' was again incorrectly perforated. All of the other reperforating was completed on depth as designed.



STATE OF WEST VIRGINIA
DEPARTMENT OF MINES
OIL AND GAS DIVISION 13

Quadrangle Kingwood

Permit No. Pres. 117

WELL RECORD

Oil or Gas Well Storage

Company Atlantic Seaboard Corporation
Address Terra Alta, West Virginia
Farm Clarence W. Jones Et UX Acres 123
Location (waters) Salt Lick Creek
Well No. 7422 Elev 2013.24
District Union County Putnam

Casing and Tubing	Used in Drilling	Left in Well	Packers
Size			
10 3/8"	38'	38'	Kind of Packer None
12 9 5/8"	1370'	1370'	Size of
8 1/4"			
Jones 7" O.D.	4758'	4758'	Depth set
53/16"			
3"			Perf. top
2 3/8"	5162'	5162'	Perf. bottom
Liners Used			Perf. top
			Perf. bottom

The surface of tract is owned in fee by _____
Address _____
Mineral rights are owned by Clarence W. Jones & Evelyn
Route #1 Address Terra Alta, W. Va.

Drilling commenced August 6, 1963
Drilling completed August 19, 1963
Date Shot _____ From _____ To _____
With _____

Open Flow /10ths Water in _____ Inch
/10ths Merc. in _____ Inch
Volume Sea reverse Ca. Ft.
Rock Pressure Storage lbs. hrs.
Oil _____ bbls. 1st 24 hrs.
WELL ACIDIZED Sea reverse

CASING CEMENTED _____ SIZE _____ No. Ft. _____ Date _____
Sea reverse
COAL WAS ENCOUNTERED AT _____ FEET _____ INCHES
_____ FEET _____ INCHES _____ FEET _____ INCHES
_____ FEET _____ INCHES _____ FEET _____ INCHES

WELL FRACTURED _____
RESULT AFTER TREATMENT Sea reverse
ROCK PRESSURE AFTER TREATMENT Storage
Fresh Water _____ Feet _____ Salt Water _____ Feet _____

Formation	Color	Hard or Soft	Top	Bottom	Oil, Gas or Water	Depth	Remarks
Siltstone & Shale			0	4247			
Tully Lime			4247	4273			
Siltstone & Shale			4273	4738			
Onondaga Limestone			4738	4758			
Chert			4758	4973			
Shale			4973	4985			
Oriskany Sand			4985	5118			
Helderberg			5118				
Total Depth				5171			



(over)

Formation	Color	Hard or Soft	Top 25	Bottom	Oil Gas or Water	Depth Found	Remarks
<u>Logging:</u>							
Gamma Ray			4200	5170	8-19-63	McCullough	
Temperature			4400	5171	8-19-63	McCullough	
<u>Casing & Cement:</u>							
13-3/8", 43#/ft. H-40 casing - 28' (threads on) - set 038' (KB). Cemented 20 sacks 8-6-63.							
9-5/8", 32#/ft. H-40 casing - 1368' (threads on) set G1370' (KB) - Cemented 252 cu. ft. "Litepoz" and 252 sacks Class A cement tailed w/50 sacks neat cement 1% Flac and 3% Na Cl 8-19-63 - Dowell							
7" 23#/ft J-55 casing - 4791' (threads on) - Set 44758' (KB) - Two stage Cemented to surface. 1st Stage - 150 cu. ft. "Litepoz" and 150 sacks Class A cement tailed w/170 gallon "Coalment" (latex cement). 2nd Stage - 400 cu. ft. "Litepoz" and 400 sacks Class A cement tailed w/20 sacks regular cement and 2% Ca Cl 8-15-63 - Dowell							
2-3/8", 4.60#/ft. J-55 tubing - 5162' (threads on) - Suspended from tubing hanger flange. Siphon string w/bottom joint slotted and end closed. 8-19-63							
<u>Stimulation:</u>							
5000 gal. 15% Retarded HCl Acid; 5000 gal. 15% Regular HCl Acid; 5000 gal. water overflush and 115,000 scf of N ₂ . 8-30-63 - Dowell.							
<u>Production:</u>							
During Drilling: Chert gas 253 Mcf 8-18-63 Chert & Oriskany - 280 Mcf 8-19-63							
Before Acid: No test							
After Acid: 11,000 Mcf @2350 psig (Back Pressure Test) 9-9-63							
Final Shut-in: 9-9-63							

Date OCT 3 1963 12

APPROVED ATLANTIC SEABOARD CORPORATION Owner

By H. J. [Signature] (Title)



STATE OF WEST VIRGINIA
DEPARTMENT OF MINES
OIL AND GAS DIVISION 13

Quadrangle Kingwood

Permit No. Pres. 117

WELL RECORD

Oil or Gas Well Storage
(KIND)

Company Atlantic Seaboard Corporation
Address Terra Alta, West Virginia
Farm Clarence W. Jones ET UX Acres 123
Location (waters) Salt Lick Creek
Well No. 7422 Elev. 2013.24
District Union County Preston
The surface of tract is owned in fee by _____
Address _____

Mineral rights are owned by Clarence W. Jones & Evelyn Jones
Route # 1 Address Terra Alta, W. Va.

Drilling commenced August 6, 1963
Drilling completed August 19, 1963

Date Shot _____ From _____ To _____
With _____

Open Flow _____ /10ths Water in _____ Inch
_____ /10ths Merc. in _____ Inch

Volume See reverse Cu. Ft.

Rock Pressure Storage lbs. _____ hrs.

Oil _____ bbls., 1st 24 hrs.

WELL ACIDIZED See reverse

WELL FRACTURED _____

Casing and Tubing	Used in Drilling	Left in Well	Packers
Size			Kind of Packer
16			None
13 3/8"	38'	38'	Size of
10 9 5/8"	1370'	1370'	Depth set
8 1/4"			Perf. top
5 3/16"			Perf. bottom
3"			Perf. top
2 3/8"	5162'	5162'	Perf. bottom
Liners Used			

CASING CEMENTED _____ SIZE _____ No. Ft. _____ Date _____

See reverse

COAL WAS ENCOUNTERED AT _____ FEET _____ INCHES

_____ FEET _____ INCHES _____ FEET _____ INCHES

_____ FEET _____ INCHES _____ FEET _____ INCHES

RESULT AFTER TREATMENT See reverse

ROCK PRESSURE AFTER TREATMENT Storage

Fresh Water _____ Feet _____ Salt Water _____ Feet _____

Formation	Color	Hard or Soft	Top	Bottom	Oil, Gas or Water	Depth	Remarks
Siltstone & Shale			0	4247			
Tully Lime			4247	4273			
Siltstone & Shale			4273	4738			
Onondaga Lime			4738	4758			
Chert			4758	4973			
Shale			4973	4985			
Oriskany Sand			4985	5118			
Helderberg			5118				
Total Depth				5171			

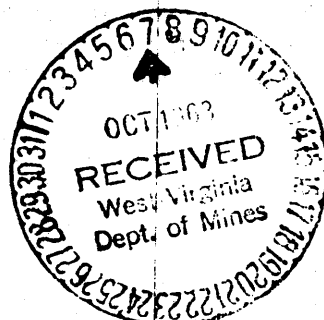

4738 4985 5118
2013 2013

2725 2972 3105

Formation	Color	Hard or Soft	Top ¹³	Bottom	Oil, Gas or Water	Depth Found	Remarks
<u>Logging:</u>							
	Gamma Ray		4200	5170	8-19-63	McCullough	
	Temperature		4400	5171	8-19-63	McCullough	
<u>Casing & Cement:</u>							
13-3/8", 48#/ft. H-40 casing - 28' (threads on) - set @38' (KB). Cemented 20 sacks 8-6-63.							
9-5/8", 32#/ft, H-40 casing - 1368' (threads on) set @1370' (KB) - Cemented 252 cu. ft. "Litepoz" and 252 sacks Class A cement tailed w/50 sacks neat cement 1% Flac and 3% Na Cl 8-10-63 - Dowell							
7", 23#/ft J-55 casing - 4791' (threads on) - Set @4758' (KB) - Two stage Cemented to surface. 1st Stage - 150 cu. ft. "Litepoz" and 150 sacks Class A cement tailed w/170 gallon "Cealment" (latex Cement). 2nd Stage - 400 cu. ft. "Litepoz" and 400 sacks Class A cement tailed w/20 sacks regular cement and 2% Ca Cl 8-15-63 - Dowell							
2-3/8", 4.60#/ft. J-55 tubing - 5162' (threads on) - Suspendes from tubing hanger flange. Siphon string w/bottom joint slotted and end closed. 8-19-63							
<u>Stimulation:</u>							
5000 gal. 15% Retarded HCl Acid; 5000 gal. 15% Regular HCl Acid; 5000 gal. water overflush and 115,000 scf of N ₂ . 8-30-63 - Dowell.							
<u>Production:</u>							
During Drilling: Chert gas 253 Mcf 8-18-63 Chert & Oriskany - 280 Mcf 8-19-63							
Before Acid: No test							
After Acid: 11.000 Mcf @2350 psig (Back Pressure Test) 9-9-63							
Final Shut-in: 9-9-63							

Date OCT 3 1963, 19

APPROVED ATLANTIC SEABOARD CORPORATION, Owner

By *H. Mafford* Supt
(Title)

APR 04 1996 STATE OF WEST VIRGINIA

DIVISION OF ENVIRONMENTAL PROTECTION, OFFICE OF OIL AND GAS

Office of Oil & Gas Permitting WELL WORK PERMIT APPLICATION

(7) 637

Well Operator: COLUMBIA GAS TRANSMISSION CORPORATION 10450

Operator's Well Number: 7422 3) Elevation: 2213.27

Well type: (a) Oil / or Gas X/ Issued 04/22/96 Expires 04/22/98 (b) If Gas: Production / Underground Storage X/ Deep X/ Shallow / 475

Proposed Target Formation(s): CHERT-ORISKANY (WORKOVER/DRILL DEEPER)

- 6) Proposed Total Depth: feet
7) Approximate fresh water strata depths:
8) Approximate salt water depths:
9) Approximate coal seam depths:
10) Does land contain coal seams tributary to active mine? Yes / No
11) Proposed Well Work: KILL WELL; REMOVE TUBING; INSTALL NEW WELLHEAD; DRILL DEEPER THROUGH ORISKANY; LOG; RUN 4-1/2" LINER; CEMENT; PERFORATE; ACIDIZE; FRACTURE.
12) CASING AND TUBING PROGRAM

Existing Storage well

Table with columns: TYPE, SPECIFICATIONS (Size, Grade, Weight per ft.), FOOTAGE INTERVALS (For drilling, Left in well), CEMENT (Fill-up cu. ft.). Rows include Conductor, Fresh Water, Coal, Intermediate, Production, Tubing, and Liners.

PACKERS : Kind None *Tubing to be removed
Sizes
Depths set

For Office of Oil and Gas Use Only

Fee(s) paid: Well Work Permit Reclamation Fund WPCP
Plat WW-9 WW-2B Bond (Type) Agent

Handwritten notes: 0099 433 11

RECEIVED
WV Division of
Environmental Protection

APR 04 1996

Permitting
Office of Oil & Gas

Page 1 of _____
Form WW2-A
(6/94)
File Copy

1) Date: 2/28/96
2) Operator's well number
7422
3) API Well No: 47 - 077 - 00117
State County Permit

STATE OF WEST VIRGINIA - BUREAU OF ENVIRONMENT
DIVISION OF ENVIRONMENTAL PROTECTION
OFFICE OF OIL AND GAS

NOTICE AND APPLICATION FOR A WELL WORK PERMIT

4) Surface Owner(s) to be served:
 (a) Name UPTOP INC.
 Address P.O. BOX 27 % PHIL SCHENK
TERRA ALTA, W.V. 26767
 (b) Name _____
 Address _____
 (c) Name _____
 Address _____

5) (a) Coal Operator:
 Name _____
 Address _____
 (b) Coal Owner(s) with Declaration:
 Name UPTOP INC.
 Address P.O. BOX 27, % PHIL SCHENK
TERRA ALTA, W.V. 26767
 Name _____
 Address _____

6) Inspector: PHILLIP TRACY
 Address ROUTE 2, BOX 37-A
MONROSE, WV 26283
 Telephone (304) - 636-8798

(c) Coal Lessee with Declaration
 Name _____
 Address _____
Copy of Monroe Lease in Columbia

TO THE PERSON(S) NAMED ABOVE TAKE NOTICE THAT:

Included is the lease or leases *Deanna office for review upon Request.* or other containing contract or contracts by which I hold the right to extract oil and gas OR *Sel. Dist. City*
 Included is the information required by Chapter 22, Article 6, Section 8(d) of the Code of West Virginia (see page 2)
 I certify that as required under Chapter 22 of the West Virginia Code I have served copies of this notice and application, a location plat, and accompanying documents pages 1 through _____ on the above named parties, by:
 Personal Service (Affidavit attached)
 Certified Mail (Postmarked postal receipt attached)
 Publication (Notice of Publication attached)

I have read and understand Chapter 22-6 and 38 CSR 11-18, and I agree to the terms and conditions of any permit issued under this application.
 I certify under penalty of law that I have personally examined and am familiar with the information submitted on this application form and all attachments, and that based on my inquiry of those individuals immediately responsible for obtaining the information, I believe that the information is true, accurate, and complete.
 I am aware that there are significant penalties for submitting false information, including the possibility of fine and imprisonment.

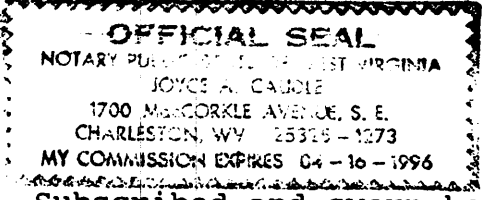

Well Operator COLUMBIA GAS TRANSMISSION CORP.
 By: Richard A. Coley
 Its: MANAGER - WELL SERVICES
 Address P.O. BOX 1273
CHARLESTON, WV 25325-1273
 Telephone (304) 357-3034

Subscribed and sworn before me this 27th day of March, 1996

 My commission expires April 16, 1996 Notary Public