

Latitude 39 ° 25'

Longitude 81 ° 10'

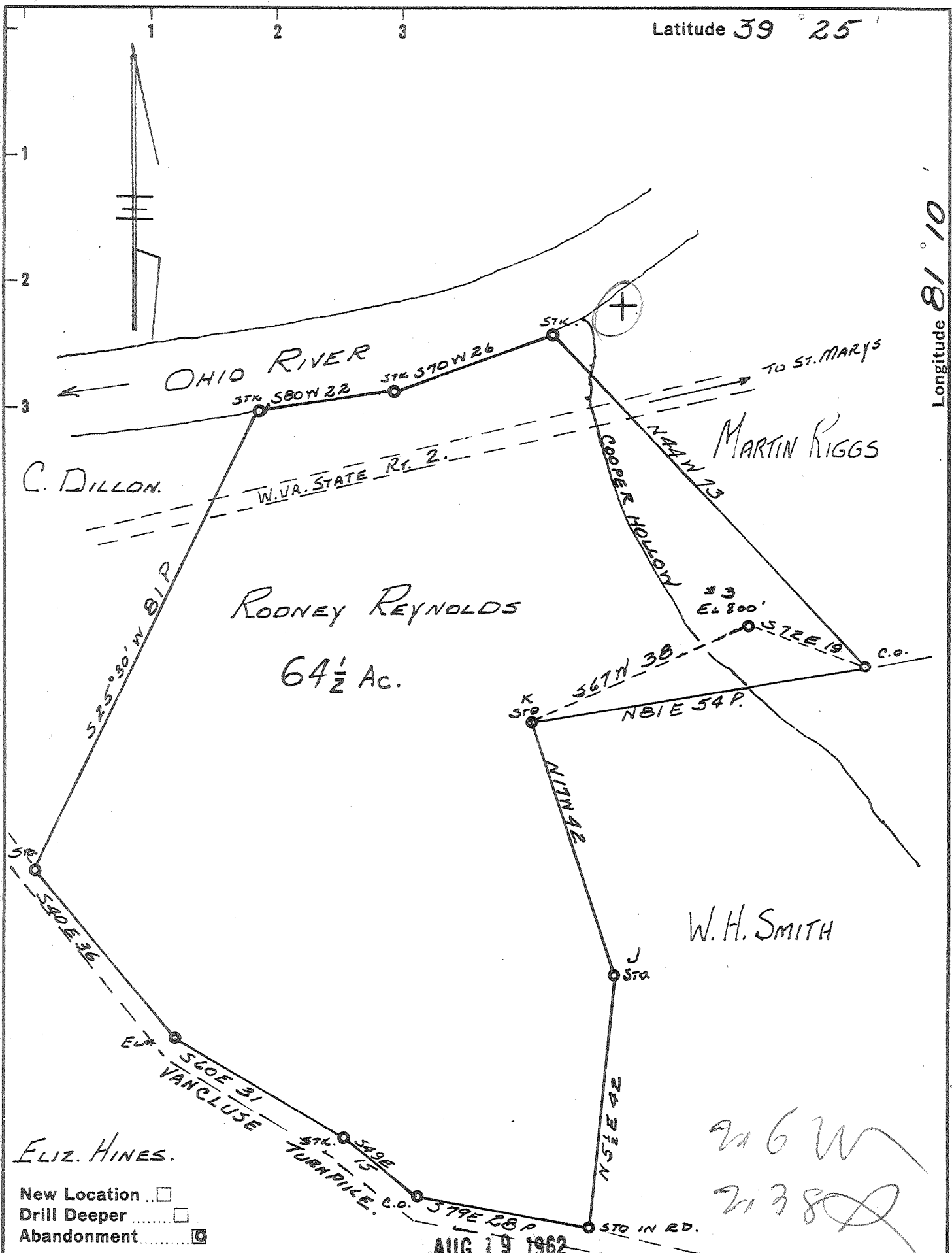

New Location
 Drill Deeper
 Abandonment

AUG 19 1962

Company LEONARD HART
 Address ST. MARYS, W.VA.
 Farm RODNEY REYNOLDS
 Tract _____ Acres 64 1/2 Lease No. 3 1/4
 Well (Farm) No. 3 Serial No. (circled 20)
 Elevation (Spirit Level) 800'
 Quadrangle ST. MARYS
 County PLEASANTS District WASHINGTON
 Engineer JOHN W. HAMILTON
 Engineer's Registration No. 2274
 File No. _____ Drawing No. 250
 Date SEPT 20, 1960 Scale 1" = 20 FEET

STATE OF WEST VIRGINIA
 DEPARTMENT OF MINES
 OIL AND GAS DIVISION
 CHARLESTON

WELL LOCATION MAP
 FILE NO. PLEAS-996-A

+ Denotes location of well on United States Topographic Maps, scale 1 to 62,500, latitude and longitude lines being represented by border lines as shown.
 - Denotes one inch spaces on border line of original tracing.