

State of West Virginia  
Department of Environmental Protection - Office of Oil and Gas  
Well Operator's Report of Well Work

RECEIVED  
Office Of Oil and Gas

152023

API 47 - 073 - 02603 County Pleasants District Union  
Quad Bens Run 7 1/2' Pad Name P6 Field/Pool Name Environmental Protection  
Farm name Billy D. Hanlin Heirs Well Number P6N3U  
Operator (as registered with the OOG) 24610  
Address 429 Simonton Road City Ellenboro State WV Zip 26346

As Drilled location NAD 83/UTM Attach an as-drilled plat, profile view, and deviation survey  
Top hole Northing 4363282.86 Easting 491762.52  
Landing Point of Curve Northing 4363240.26 Easting 491605.99  
Bottom Hole Northing 4365397.83 Easting 490391.57

Elevation (ft) 887.6 GL Type of Well  New  Existing Type of Report  Interim  Final  
Permit Type  Deviated  Horizontal  Horizontal 6A  Vertical Depth Type  Deep  Shallow  
Type of Operation  Convert  Deepen  Drill  Plug Back  Redrilling  Rework  Stimulate  
Well Type  Brine Disposal  CBM  Gas  Oil  Secondary Recovery  Solution Mining  Storage  Other \_\_\_\_\_  
Type of Completion  Single  Multiple Fluids Produced  Brine  Gas  NGL  Oil  Other \_\_\_\_\_  
Drilled with  Cable  Rotary

Drilling Media Surface hole  Air  Mud  Fresh Water Intermediate hole  Air  Mud  Fresh Water  Brine  
Production hole  Air  Mud  Fresh Water  Brine

Mud Type(s) and Additive(s)  
Synthetic Based Mud (SOBM), K-49 (Base Oil), Barite, Anco Mul P, Anco Mul OW, Anco Mul XL, Anco Mul Mod  
Anco Mul OW Claytone 3, Lime, Calcium Chloride Powder, Phalt S, Mica, Cal-Carb

Date permit issued 1-4-2021 Date drilling commenced 7-10-2022 Date drilling ceased 8-4-2022  
Date completion activities began n/a Date completion activities ceased n/a  
Verbal plugging (Y/N) N Date permission granted n/a Granted by n/a

Please note: Operator is required to submit a plugging application within 5 days of verbal permission to plug

Freshwater depth(s) ft 120'-125' Open mine(s) (Y/N) depths N  
Salt water depth(s) ft n/a Void(s) encountered (Y/N) depths N  
Coal depth(s) ft n/a Cavern(s) encountered (Y/N) depths N  
Is coal being mined in area (Y/N) N

Reviewed by:

**APPROVED**

  
05/05/2023

API 47- 073 - 02603 Farm name Billy D. Hanlin Heirs Well number P6N3U

CASING STRINGS	Hole Size	Casing Size	Depth	New or Used	Grade wt/ft	Basket Depth(s)	Did cement circulate (Y/ N) * Provide details below*	
Conductor	30"	26"	30'	New	n/a	n/a	Grouted	
Surface	24"	18.625"	368'	New	87.5# K-55	81'	Yes	
Coal								
Intermediate 1	17.5"	13.375"	2030'	New	54.5# J-55	1986' - 293'	Yes	
Intermediate 2	12.25"	9.625"	9342'	New	47# HCP-110	2059' - 9148'	Yes	
Intermediate 3								
Production	8.5"	5.5"	18,636'	New	23# P-110	n/a	Yes	
Tubing							Office	
Packer type and depth set		n/a						

RECEIVED  
Office Of Oil and Gas  
MAR 16 2023

Comment Details Surface CTS with 20% OH excess / Intermediate 1 CTS with 30% OH excess / Intermediate 2 CTS with 25% OH excess  
Production 2000' from surface with 15 % OH excess

WV Department of  
Environmental Protection

CEMENT DATA	Class/Type of Cement	Number of Sacks	Slurry wt (ppg)	Yield (ft <sup>3</sup> /sks)	Volume (ft <sup>3</sup> )	Cement Top (MD)	WOC (hrs)
Conductor	Class A	n/a	n/a	n/a	n/a	CTS	8 hours
Surface	Class A	431	15.6	1.19	510	CTS	8 hours
Coal							
Intermediate 1	Class A	1466	15.6	1.19	1733	CTS	8 hours
Intermediate 2	Class A	1701	Lead 12.5 Tail 15.0	Lead 2.29 Tail 1.31	3585	CTS	8 hours
Intermediate 3							
Production	Class H	3888	Lead 15.6 Tail 16.50	Lead 1.19 Tail 1.05	4292	2000'	24 hours
Tubing							

Drillers TD (ft) 18,868' Loggers TD (ft) 18,668'  
Deepest formation penetrated Point Pleasant Shale Plug back to (ft) n/a  
Plug back procedure n/a

Kick off depth (ft) 9560'

Check all wireline logs run  caliper  density  deviated/directional  induction  
 neutron  resistivity  gamma ray  temperature  sonic

Well cored  Yes  No Conventional Sidewall Were cuttings collected  Yes  No

DESCRIBE THE CENTRALIZER PLACEMENT USED FOR EACH CASING STRING \_\_\_\_\_  
5.5" vertical centralizers every 500' horizontal and curve centralizers every other joint or one every 84'  
9.625" bow spring centralizers spaced every 10th joint \_\_\_\_\_  
13.375" bow spring centralizers or centralizing basket every 10th joint \_\_\_\_\_  
18.625" bow spring centralizers or centralizing basket every 100' \_\_\_\_\_

WAS WELL COMPLETED AS SHOT HOLE  Yes  No DETAILS \_\_\_\_\_

WAS WELL COMPLETED OPEN HOLE?  Yes  No DETAILS \_\_\_\_\_

WERE TRACERS USED  Yes  No TYPE OF TRACER(S) USED \_\_\_\_\_

05/05/2023

API 47- 073 - 02603

Farm name Billy D. Hanlin Heirs

Well number P6N3U

PERFORATION RECORD

Stage No.	Perforation date	Perforated from MD ft.	Perforated to MD ft.	Number of Perforations	Formation(s)
1	11-7-22	18542	18394	84	Point Pleasant
2	11-7-22	18354	18215	84	Point Pleasant
3	11-8-22	18160	17978	84	Point Pleasant
4	11-8-22	17908	17762	84	Point Pleasant
5	11-9-22	17698	17552	84	Point Pleasant
6	11-9-22	17478	17326	84	Point Pleasant
7	11-9-22	17274	17138	84	Point Pleasant
8	11-10-22	17074	16932	84	Point Pleasant
9	11-10-22	16888	16758	84	Point Pleasant
10	11-10-22	16712	16546	84	Point Pleasant
11	11-11-22	16485	16342	84	Point Pleasant
12	11-11-22	16269	16116	84	Point Pleasant
13	11-11-22	16050	15894	84	Point Pleasant
14	11-11-22	15813	15634	84	Point Pleasant
15	11-12-22	15566	15404	84	Point Pleasant
16	11-13-22	15348	15200	84	Point Pleasant

Please insert additional pages as applicable.

RECEIVED  
Office Of Oil and Gas  
MAR 16 2023  
WV Department of  
Environmental Protection

STIMULATION INFORMATION PER STAGE

Complete a separate record for each stimulation stage.

Stage No.	Stimulations Date	Ave Pump Rate (BPM)	Ave Treatment Pressure (PSI)	Max Breakdown Pressure (PSI)	ISIP (PSI)	Amount of Proppant (lbs)	Amount of Water (bbls)	Amount of Nitrogen/other (units)
1	11-7-22	75.5	8991	7732	5983	385091	8987	N/A
2	11-8-22	73.2	9489	9128	6450	387133	9204	N/A
3	11-8-22	74.2	9703	9758	6258	385438	9555	N/A
4	11-8-22	75.1	9081	7828	6359	386803	9222	N/A
5	11-9-22	74.8	9345	9869	6438	386095	9131	N/A
6	11-9-22	74.7	9228	9581	6631	382810	11239	N/A
7	11-9-22	75	9177	8190	6398	386506	8886	N/A
8	11-10-22	74.9	9336	9920	6787	388588	9291	N/A
9	11-10-22	74.9	9258	9521	6691	386117	9148	N/A
10	11-10-22	74.8	9215	9519	6540	388550	9208	N/A
11	11-11-22	74.7	9044	8247	6330	385826	9136	N/A
12	11-11-22	75	9238	10432	6631	346200	9124	N/A
13	11-11-22	75.7	9266	8740	6682	386004	9141	N/A
14	11-12-22	74.3	9296	11156	6378	385015	9130	N/A
15	11-13-22	74.6	9288	10085	6559	362580	8828	N/A
16	11-13-22	74.6	9202	10077	6865	386668	9042	N/A

Please insert additional pages as applicable.

05/05/2023

API 47-0730 - 02603 Farm name Billy D. Hanlin Heirs Well number P6N3U

PERFORATION RECORD

Stage No.	Perforation date	Perforated from MD ft.	Perforated to MD ft.	Number of Perforations	Formation(s)
17	11-13-22	15158	15016	84	Point Pleasant
18	11-13-22	14956	14824	84	Point Pleasant
19	11-15-22	14778	14634	84	Point Pleasant
20	11-15-22	14590	14446	84	Point Pleasant
21	11-15-22	14404	14264	84	Point Pleasant
22	11-16-22	14220	14070	84	Point Pleasant
23	11-16-22	14027	13886	84	Point Pleasant
24	11-16-22	13828	13668	84	Point Pleasant
25	11-16-22	13586	13438	84	Point Pleasant
26	11-17-22	13380	13222	84	Point Pleasant
27	11-17-22	13170	12994	84	Point Pleasant
28	11-18-22	12914	12760	84	Point Pleasant
29	11-18-22	12700	12530	84	Point Pleasant
30	11-18-22	12477	12318	84	Point Pleasant
31	11-19-22	12260	12097	84	Point Pleasant
32	11-19-22	12048	11874	84	Point Pleasant

Please insert additional pages as applicable.

RECEIVED  
Office Of Oil and Gas  
MAR 16 2023  
WV Department of Environmental Protection

STIMULATION INFORMATION PER STAGE

Complete a separate record for each stimulation stage.

Stage No.	Stimulations Date	Ave Pump Rate (BPM)	Ave Treatment Pressure (PSI)	Max Breakdown Pressure (PSI)	ISIP (PSI)	Amount of Proppant (lbs)	Amount of Water (bbls)	Amount of Nitrogen/other (units)
17	11-13-22	75.2	9101	9638	6842	388012	9080	N/A
18	11-14-22	74.9	9145	9158	7063	384985	8841	N/A
19	11-15-22	74.8	9216	9105	6865	384105	9009	N/A
20	11-15-22	74.6	9313	9492	6823	383101	8983	N/A
21	11-15-22	75.4	9329	9329	6949	382666	8899	N/A
22	11-16-22	75.1	9313	9292	7003	385127	8669	N/A
23	11-16-22	74.5	9432	9450	7015	385540	8963	N/A
24	11-16-22	75.9	9379	10059	6861	381854	8475	N/A
25	11-17-22	75.1	9374	10783	6936	375170	8562	N/A
26	11-17-22	75	9206	9451	6959	368130	8714	N/A
27	11-18-22	74.8	9227	9806	6949	366976	9081	N/A
28	11-18-22	75.2	9212	9921	6829	385458	8963	N/A
29	11-18-22	75.4	9183	10105	6831	376065	8978	N/A
30	11-18-22	75.7	9100	8483	6885	385227	9057	N/A
31	11-19-22	75.4	9124	9204	6882	384996	8919	N/A
32	11-19-22	75.4	9890	9890	6900	384854	8711	N/A

Please insert additional pages as applicable.

05/05/2023







<b>PAD-WELL / WR - 35</b>	<b>P6 N3U</b>	
<b>GROUND ELEVATION</b>	<b>887</b>	
<b>PERMIT</b>	<b>47- 73-02603</b>	
	<b>TOP TVD</b>	<b>BOTTOM TVD</b>
<b>1st Cow Run Sand</b>	<b>330</b>	<b>367</b>
<b>2nd Cow Run Sand</b>	<b>459</b>	<b>480</b>
<b>Dunkard Sand</b>	<b>521</b>	<b>550</b>
<b>Burning Springs Sand</b>	<b>760</b>	<b>777</b>
<b>Gas Sand</b>	<b>817</b>	<b>872</b>
<b>Horseneck Sand</b>	<b>1134</b>	<b>1182</b>
<b>1st Salt</b>	<b>1294</b>	<b>1350</b>
<b>2nd Salt</b>	<b>1430</b>	<b>1512</b>
<b>3rd Salt</b>	<b>1600</b>	<b>1780</b>
<b>Maxon</b>	<b>1797</b>	<b>1825</b>
<b>Big Lime</b>	<b>1865</b>	<b>1938</b>
<b>Big Injun Sand</b>	<b>2005</b>	<b>2066</b>
<b>Squaw Sand</b>		
<b>Berea Sand</b>	<b>2210</b>	<b>2220</b>
<b>Gordon Sand</b>	<b>2492</b>	<b>2528</b>
<b>Fifth Sand</b>	<b>2830</b>	<b>2825</b>
<b>Warren Shale</b>	<b>3491</b>	<b>3588</b>
<b>Riley Shale</b>	<b>4488</b>	<b>4524</b>
<b>Alexander Shale</b>	<b>5122</b>	<b>5250</b>
<b>Hamilton Shale</b>	<b>5250</b>	<b>5642</b>

RECEIVED  
Office Of Oil and Gas

MAR 16 2023

WV Department of  
Environmental Protection

05/05/2023

<b>PAD-WELL / WR - 35</b>	<b>P6 N3U</b>		
<b>GROUND ELEVATION</b>	<b>887</b>		
<b>PERMIT</b>	<b>47- 73-02603</b>		
<b>Geneseo Shale</b>	<b>5642</b>	<b>5671</b>	<b>show gas</b>
<b>Tully Lime</b>	<b>5671</b>	<b>5675</b>	
<b>Marcellus Shale</b>	<b>5725</b>	<b>5801</b>	
<b>Onondaga Lime</b>	<b>5801</b>	<b>5988</b>	
<b>Oriskany Sand</b>	<b>5988</b>	<b>6045</b>	
<b>Helderberg</b>	<b>6045</b>	<b>6458</b>	
<b>Bass Island</b>	<b>6458</b>	<b>6524</b>	
<b>Salina Anhydrite</b>	<b>6524</b>	<b>7147</b>	
<b>Wills Creek</b>	<b>7147</b>	<b>7384</b>	
<b>Lockport Dolomite</b>	<b>7384</b>	<b>7618</b>	
<b>McKenzie</b>	<b>7618</b>	<b>7720</b>	
<b>Rose Hill</b>	<b>7720</b>	<b>7948</b>	
<b>Packer Shell</b>	<b>7948</b>	<b>7970</b>	
<b>Tuscarora Sand</b>	<b>8068</b>	<b>8252</b>	
<b>Medina</b>	<b>8268</b>	<b>8283</b>	
<b>Queenston Shale</b>	<b>8316</b>	<b>9097</b>	
<b>Reedsville Shale</b>	<b>9097</b>	<b>9905</b>	<b>show gas</b>
<b>Utica Shale</b>	<b>9905</b>	<b>10041</b>	<b>show gas</b>
<b>Pt. Pleasants Shale</b>	<b>10041</b>		<b>show gas</b>

RECEIVED  
Office Of Oil and Gas

MAR 16 2023

WV Department of  
Environmental Protection

05/05/2023



## Hydraulic Fracturing Fluid Product Component Information Disclosure

Job Start Date:	11/7/2022
Job End Date:	11/21/2022
State:	West Virginia
County:	Pleasants
API Number:	47-073-02603-00-00
Operator Name:	Jay-Bee Oil & Gas, Inc.
Well Name and Number:	P6 N3U
Latitude:	39.41903040
Longitude:	-81.09569720
Datum:	NAD83
Federal Well:	NO
Indian Well:	NO
True Vertical Depth:	10,061
Total Base Water Volume (gal):	14,501,039
Total Base Non Water Volume:	0



### Hydraulic Fracturing Fluid Composition:

Trade Name	Supplier	Purpose	Ingredients	Chemical Abstract Service Number (CAS #)	Maximum Ingredient Concentration in Additive (% by mass)**	Maximum Ingredient Concentration in HF Fluid (% by mass)**	Comments
Water	Supplied by Operator	Base Fluid					
	RECEIVED Office Of Oil and Gas WV Department of Environmental Protection MAR 16 2023		Water	7732-18-5	100.00000	89.41502	
Hydrochloric Acid		Clean Perforations					
				Listed Below			



DynaRate™ 6459	CWS	Friction Reducer					
				Listed Below			
USB-123	(blank)	(blank)					
				Listed Below			
CalGuard™ 9100	CWS	Corrosion Inhibitor					
				Listed Below			
Sand (Proppant)	CWS	Propping Agent					
				Listed Below			
DynaScale™ 3511	CWS	Scale Inhibitor					
				Listed Below			
Other Chemical (s)	Listed Above	See Trade Name (s) List					
				Listed Below			

Items above are Trade Names with the exception of Base Water . Items below are the individual ingredients.

		Crystalline silica (Quartz)	14808-60-7	100.00000	10.08090	
		Hydrochloric acid	7647-01-0	37.00000	0.36750	
		Calcite	471-34-1	1.00000	0.05436	
		Illite	12173-60-3	1.00000	0.04645	
		Apatite	64476-38-6	0.10000	0.01008	
		Biotite	1302-27-8	0.10000	0.01008	
		Goethite	1310-14-1	0.10000	0.01008	
		Ilmenite	98072-94-7	0.10000	0.00464	
		Ethylene Glycol	107-21-1	40.00000	0.00026	

RECEIVED  
 Office Of Oil and Gas  
 MAR 16 2023  
 WV Department of  
 Environmental Protection

			Diethylene glycol, monomethyl ether	34590-94-8	20.00000	0.00013	
			Distillates (petroleum), hydrotreated light	64742-47-8	3.00000	0.00010	
			Ammonium chloride ((NH4)Cl)	12125-02-9	5.00000	0.00010	
			Ethoxylated Alcohols	68131-39-5	10.00000	0.00006	
			Formic acid	64-18-6	10.00000	0.00006	
			Cinnamaldehyde	104-55-2	10.00000	0.00006	
			Tar bases, quinolone derivs, benzyl chloride- quatenized	72480-70-7	10.00000	0.00006	
			Isopropyl alcohol	67-63-0	5.00000	0.00003	
			Inorganic Salt	Proprietary			Proprietary CAS & Additive Concentration
			Inorganic Acid Salt	Proprietary			Proprietary CAS & Additive Concentration
			Proprietary Polymer 1	Proprietary			Proprietary CAS & Additive Concentration
			Organic Acid Ether	Proprietary			Proprietary CAS & Additive Concentration

\* Total Water Volume sources may include various types of water including fresh water, produced water, and recycled water

\*\* Information is based on the maximum potential for concentration and thus the total may be over 100%

\*\*\* If you are calculating a percentage of total ingredients do not add the water volume below the green line to the water volume above the green line

Note: For Field Development Products (products that begin with FDP), MSDS level only information has been provided.

Ingredient information for chemicals subject to 29 CFR 1910.1200(i) and Appendix D are obtained from suppliers Material Safety Data Sheets (MSDS)

RECEIVED  
Office Of Oil and Gas  
MAR 16 2023  
WV Department of  
Environmental Protection







form www

**P6N3U**  
**UNIT SIZE**  
170.5273 ± AC.

Detail Scale: 1" = 500'

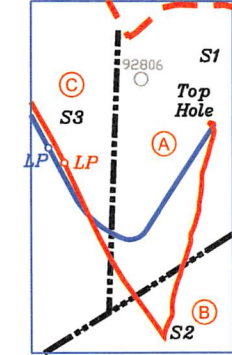

Detail "A"  
— As Drilled Leg  
— Proposed Leg

Detail Scale: 1" = 500'

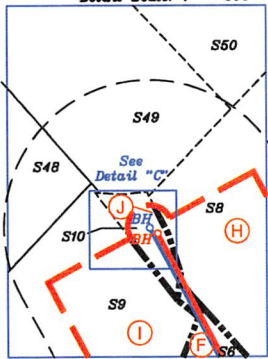

Detail "B"

Detail C N.T.S.

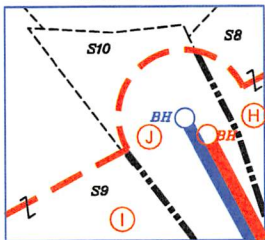

Detail "C"



P.S. 708

*David L Jackson*

**ADJOINING OWNERS TABLE**

TRACT	SURFACE OWNER	TAX PARCEL	ACRES
S1 A	MICHAEL WILLIAM HANLIN	07-11-50	58.5
S2 B	MICHAEL BLAINE BEAGLE	07-11-48	112.25
S3 C	HAESSLEY LAND AND TIMBER, LLC	07-11-53	80.0
S4 D	WEST VIRGINIA DIVISION OF NATURAL RESOURCES	MIDDLE ISLAND CREEK	2,539 CALC.
S5 E	HEARTWOOD FORESTLAND FUND IV LIMITED PARTNERSHIP	07-10-18A	600.097
S6 F	BB LAND, LLC	07-05-62	60.5
S7 G	PAM PFALZGRAF	07-05-62.1	2.924
S8 H	SPRING MOUNTAIN HOLDINGS LLC	07-05-56	117.41
S9 I	NELLIE M BARNHART	07-05-65	28.0
S10 J	VIRGILENE S GIBONEY	07-05-65.1	0.944
S11	RONALD M METZ, LIFE ESTATE	07-05-37	20.0
S12	NATHAN WADE BENNETT	07-06-109	5.011
S13	HEARTWOOD FORESTLAND FUND IV LIMITED PARTNERSHIP	07-06-100	17.29
S14	DAVID ROGER MCCARTNEY & PATTY SUE MCCARTNEY	07-06-31	0.75
S15	DAVID ROGER MCCARTNEY & PATTY SUE MCCARTNEY	07-06-30.1	6.0
S16	CHARLES R MANKINS & BETH ANN MANKINS	07-06-30	45.0
S17	LOUIE A STANLEY	07-06-37	60.0
S18	LISA STANLY, TRUSTEE OF THE R DEAN SMITH 2009 TRUST FBO LISA STANLEY	07-06-64	69.887
S19	BB LAND, LLC	07-06-66	85.0
S20	BMB ENTERPRISES, LLC & JOHN S. GRIM	07-11-01	157.5
S21	EDWARD B HOLMES & MELISSA K HOLMES	07-11-3.2	3.447
S22	GARY BURIAN & BEVERLY BURIAN	07-11-2	6.1
S23	KENNETH G HOLMES, SANDRA K LAMM, ROGER Q HOLMES & RONALD S HOLMES	07-11-25.7	40.88
S24	JOSHUA NEAL MYERS & LUKE ALAN MYERS	07-11-24	0.21
S25	JAMES K STOUT	07-11-23.1	0.524
S26	JAMES K STOUT	07-11-23.2	0.084
S27	SCOTT & KELLY BYERS	07-11-23	0.93
S28	GRANT HOSKINSON	07-11-22	3.63
S29	KENNETH G HOLMES & DORIS A HOLMES	07-11-25.3	5.621
S30	SUGAR VALLEY SCHOOL	07-11-25.1	0.57
S31	PATRICK DEAN SOLE	07-11-26	49.1769
S32	DEPT. OF NATURAL RESOURCES	07-11-22.1	1.37
S33	MICHAEL BLAINE BEAGLE	07-11-21	1.0
S34	JOHN TICE	07-11-51.1	1.0
S35	JED BATES & EVELYN BATES	07-11-51	5.564
S36	JOHN P RIGGS & BRENDA J. RIGGS	04-01-01	65.0
S37	JED H BATES & MARIE BATES	07-10-36.3	17.10
S38	JED BATES & MARIE BATES	07-10-49	4.0
S39	LARRY O. BARNHART & BRENDA L. BARNHART, JESSE M. BARNHART & JUDITH K. BARNHART	07-10-26	1.0
S40	LARRY O. BARNHART & BRENDA L. BARNHART, JESSE M. BARNHART & JUDITH K. BARNHART	07-10-17	20.5
S41	LARRY O. BARNHART & BRENDA L. BARNHART, JESSE M. BARNHART & JUDITH K. BARNHART	07-10-25	10
S42	LARRY O. BARNHART & BRENDA L. BARNHART, JESSE M. BARNHART & JUDITH K. BARNHART	07-10-7.1	1.0
S43	RICHARD C BEANE & REBECCA D BEANE	07-10-07	30.0
S44	RICHARD C BEANE & DIANE BEANE	07-10-06	20.0
S45	RICHARD C BEANE & DIANE BEANE	07-10-55	3.647
S46	JOSEPH AYERS & CYNTHIA AYERS	07-05-61	35.98
S47	MARY BARNHART	07-05-54	12.5
S48	NELLIE M BARNHART	07-05-67	44.25
S49	NELLIE M BARNHART	07-05-66	19.88
S50	HAROLD E BARNHART, HENRY REUBEN BARNHART & PHYLLIS MARIE BARNHART HARBERT	07-05-34	72
S51	SHARON MARIEA DALRYMPLE	07-05-34.1	1.0
S52	MT. NEBO CHURCH OF CHRIST TRUST	07-05-35	1.0
S53	BENS RUN LAND COMPANY LIMITED PARTNERSHIP	07-05-03	176.05
S54	CARROLL L ASH	07-05-36	15.0
S55	HEARTWOOD FORESTLAND FUND IV LIMITED PARTNERSHIP	07-05-56.1	15.0

RECEIVED  
Office of Oil and Gas

MAR 16 2023

WV Department of  
Environmental Protection



Jay Bee  
Oil & Gas

DRILLING  
into the future

OPERATOR'S  
WELL #: P6N3U  
DISTRICT: UNION  
COUNTY: PLEASANTS  
STATE: WV  
API #: 47-073-02603

WELL PLAT

PAGE 2 OF 3

DATE: 02/08/2023

05/05/2023

form well

JACKSON SURVEYING  
INC.  
2413 East Pike Street  
#112  
Clarksburg, WV 26301  
304-623-5851

P6N3U  
UNIT SIZE  
170.5273 ± AC.

Tracts	District Tax Map/Parcel	Lease #	Lessor, Grantor, etc.
A	07-11-50	P7021	Kathy McHenry
A	07-11-50	P7021	Michael William Hanlin
A	07-11-50	P7021	Siltstone
B	07-11-48	P7069	Ridgetop Capital IV, LP
B	07-11-48	P7069	BB Land, LLC
C	07-11-53	P7020	Haessly Land and Timber, LLC
D	MIDDLE ISLAND CREEK	DNR 6	West Virginia Division of Natural Resources
E	07-10-18A	P7098	Erma K. Pethtel
E	07-10-18A	P7098	BMB Enterprises, LLC
E	07-10-18A	P7098	Jay-Bee Royalty purchased interest of John S. Grim
F	07-05-62	P7044	Barbara L. Lemasters
F	07-05-62	P7044	Gala Lee Buchanan
F	07-05-62	P7044	Kathy Jean Leasure
F	07-05-62	P7044	Larry G. Hall
F	07-05-62	P7044	Ridgetop Capital IV, LP
F	07-05-62	P7044	Robert D. Hall
F	07-05-62	P7044	Truman A. Buchanan
F	07-05-62	P7044	BB Land, LLC
G	07-05-62.1	P7232B	Pamela Pfalzgraf
H	07-05-56	P7123A&B	James Allen & Lenora Ellen Renner
I	07-05-65	P7232	Mary Joyce Barnhart
I	07-05-65	P7232	Gary L. Hartmann
I	07-05-65	P7232	Joye L. Scott
I	07-05-65	P7232	Pamela K. Bullard
I	07-05-65	P7232	Henry Reuben Barnhart
I	07-05-65	P7232	Harold Eugene Barnhart
I	07-05-65	P7232	Phyllis Marie Harbert
I	07-05-65	P7232	Paul Dean Miller
I	07-05-65	P7232	Richard Lee Miller
I	07-05-65	P7232	Rhonda P. Stamm
J	07-05-65.1	P7232A	Virgilene S. Giboney



P.S.  
708

*David L Jackson*

**Top Hole**  
Geo NAD 83- 39.419030 N. 81.096697 W  
UTM NAD 83(Meters)-4363282.88 N. 491762.51 E  
UTM NAD 83(Feet)-14315203.93 N. 1613876.63 E

**Landing Point**  
Geo NAD 83- 39.416780 N. 81.097708 W  
UTM NAD 83(Meters)-4363255.32 N. 491589.37 E  
UTM NAD 83(Feet)-14315113.52 N. 1612822.80 E

**Bottom Hole**  
Geo NAD 83- 39.439128 N. 81.111781 W  
UTM NAD 83(Meters)-4365403.95 N. 490383.29 E  
UTM NAD 83(Feet)-14322162.79 N. 1608865.82 E

RECEIVED  
Office of Oil and Gas  
MAY 16 2023  
WV Department of  
Environmental Protection

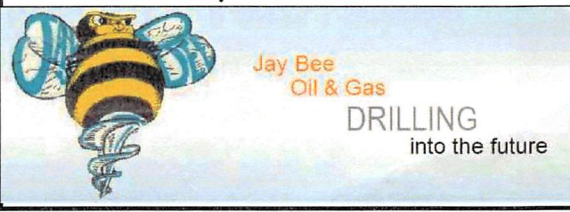

OPERATOR'S  
WELL #: P6N3U  
DISTRICT: UNION  
COUNTY: PLEASANTS  
STATE: WV  
API #: 47-073-02603

WELL PLAT  
PAGE 3 OF 3  
DATE: 2/08/2023

05/05/2023





## JAY-BEE COMPANIES

JAY-BEE OIL & GAS, INC.  
P.O. BOX 380  
BRIGDEPORT, WV 26330  
(304)-933-3878

March 2, 2023

WV DEP  
Attn: Wade Stansberry  
601 57<sup>th</sup> St SE  
Charleston, WV 25304

RECEIVED  
Office Of Oil and Gas

MAR 16 2023

WV Department of  
Environmental Protection

Mr. Stansberry,

Enclosed you will find the Completion Reports for the following Jay-Bee Oil & Gas, Inc wells: P6N3U, P6S3U, P7N3U, P7S2U, P8N4U, P8S3U. These wells are located in Pleasants County, WV. I believe all information is included, and each set of documents is held together with binder clip.

If there are any corrections needed, further information required, or any questions, please don't hesitate to contact me by phone or email. My cell is 304-203-0665, and email is [epotesta@jaybeeoil.com](mailto:epotesta@jaybeeoil.com).

Sincerely,

Emily Potesta

*Attached Addendum*

05/05/2023



References:

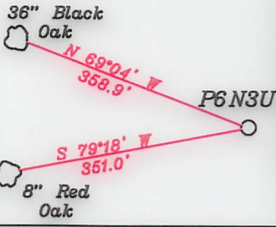

Notes:

**Bottom Hole 7,997'**  
**LATITUDE 39-27-30 N (BH)**

- All wells within 500' of the horizontal leg are shown on this plat based upon information taken from DEP mapping, well plats, & aerial photos.
- Ties to wells and corners are based on State Plane Grid North-WV North Zone NAD 83.

4. All vertical deep wells within 3000' & all horizontal deep wells within 1000' of well bore path are shown on this plat.

**P6N3U**  
**UNIT SIZE**  
**170.5273 ± AC.**

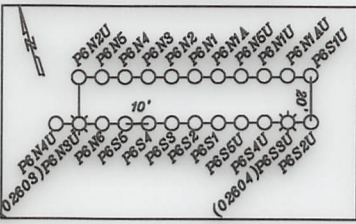

**LEGEND**

- Well Lateral
- Point Pleasant Legs within 3000' (proposed)
- Leased Tracts
- Surface Tracts
- Tracts within unit boundary (A)
- Unit Boundary Line 400' from Bore Path
- 500' from Bore Path

3. No water wells were found within 250' of the well location. No dwellings or buildings were found within 625' from the center of the proposed pad. No perennial streams are located within 100' of LOD. No producing trout stream is located within 300' of LOD.

NORTH

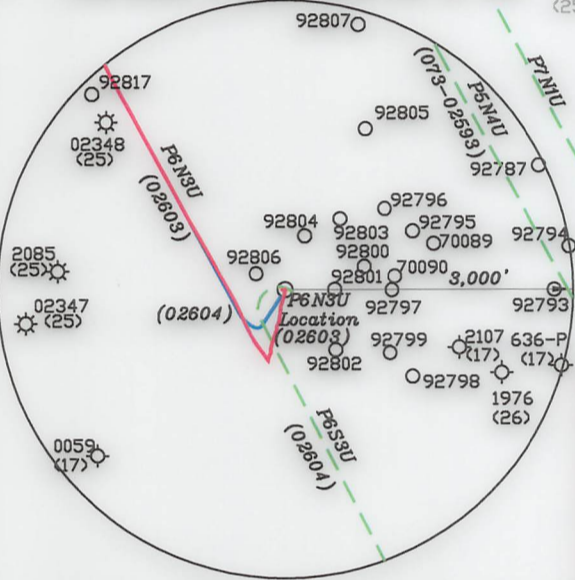

**Top Hole**  
 Geo NAD 83- 39.419030 N. 81.095697 W  
 UTM NAD 83(Meters)-4363282.86 N. 491762.52 E  
 UTM NAD 83(Feet)-14315203.85 N. 1613390.86 E

**Landing Point**  
 Geo NAD 83- 39.418645 N. 81.097515 W  
 UTM NAD 83(Meters)-4363240.26 N. 491805.99 E  
 UTM NAD 83(Feet)-14315064.10 N. 1612877.32 E

**Bottom Hole**  
 Geo NAD 83- 39.438073 N. 81.111654 W  
 UTM NAD 83(Meters)-4365397.83 N. 490391.57 E  
 UTM NAD 83(Feet)-14322142.71 N. 1608893.02 E

NUMBER	DIRECTION	DISTANCE
L1	N37°43' E	1,061.12'
L2	N83°10' W	1,389.15'
L3	S75°44' W	532.40'

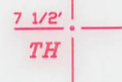

As Drilled Leg  
 Proposed Leg

(+) DENOTES LOCATION OF WELL ON UNITED STATES TOPOGRAPHIC MAPS

FILE NO. \_\_\_\_\_  
 DRAWING NO. 1  
 SCALE 1" = 2000'  
 MINIMUM DEGREE OF ACCURACY 1 in 200  
 PROVEN SOURCE OF ELEVATION GPS  
submeter unit

I THE UNDERSIGNED, HEREBY CERTIFY THAT THIS PLAT IS CORRECT TO THE BEST OF MY KNOWLEDGE AND BELIEF AND SHOWS ALL THE INFORMATION REQUIRED BY LAW AND THE RULES ISSUED AND PRESCRIBED BY THE DEPARTMENT OF ENVIRONMENTAL PROTECTION.

(SIGNED) David L Jackson  
 R.P.E. \_\_\_\_\_ P.S. 708

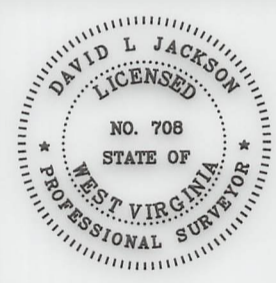

STATE OF WEST VIRGINIA  
 Division of Environmental Protection  
 OFFICE OF OIL AND GAS

DATE February 8, 2023  
 OPERATOR'S WELL NO. P6N3U  
 API WELL NO. \_\_\_\_\_

WELL TYPE: OIL GAS  LIQUID INJECTION \_\_\_\_\_ WASTE DISPOSAL \_\_\_\_\_  
 (IF "GAS") PRODUCTION  STORAGE \_\_\_\_\_ DEEP  SHALLOW \_\_\_\_\_

LOCATION: ELEVATION 887.6' WATER SHED Outlet Middle Island Creek (HUC-10)  
 DISTRICT Union COUNTY Pleasants  
 QUADRANGLE Bens Run 7 1/2'

SURFACE OWNER Billy D. Hanlin Heirs ACREAGE 58.5 Ac.  
 OIL & GAS ROYALTY OWNER Billy D. Hanlin Heirs LEASE ACREAGE 58.5 Ac.  
 LEASE NO. 05/05/2023

PROPOSED WORK: DRILL \_\_\_\_\_ CONVERT \_\_\_\_\_ DRILL DEEPER \_\_\_\_\_ REDRILL \_\_\_\_\_ FRACTURE OR STIMULATE \_\_\_\_\_ PLUG OFF OLD FORMATION \_\_\_\_\_ PERFORATE NEW FORMATION \_\_\_\_\_ OTHER PHYSICAL CHANGE IN WELL (SPECIFY) As Drilled

PLUG AND ABANDON \_\_\_\_\_ CLEAN OUT AND REPLUG \_\_\_\_\_  
 TARGET FORMATION Point Pleasant ESTIMATED DEPTH TVD = 10,062'; TMD = 18,668'  
 WELL OPERATOR Jay-Bee Oil & Gas, Inc. DESIGNATED AGENT Deborah Broda-Morgan  
 ADDRESS 16 South Avenue W, Ste 118, Cranford NJ 07016 ADDRESS 429 Simonton Road, Ellenboro, WV 26346

LONGITUDE 81-05-00 W (BH) Bottom Hole 7,380'  
 LONGITUDE 81-05-00 W (TH) Top Hole 14,316'



form ww6

**P6N3U**  
**UNIT SIZE**  
**170.5273 ± AC.**

Detail Scale: 1" = 500'

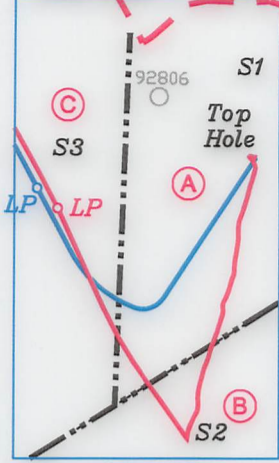

Detail "A"

— As Drilled Leg  
 — Proposed Leg

Detail Scale: 1" = 500'

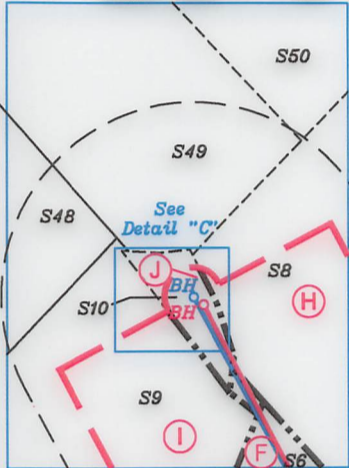

Detail "B"

Detail C N.T.S.

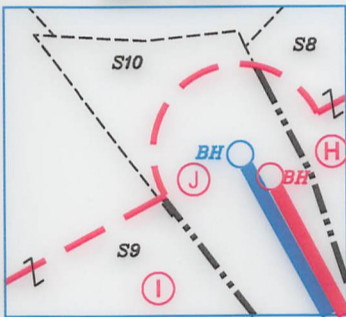

Detail "C"



P.S.  
708

*David L Jackson*

05/05/2023

**ADJOINING OWNERS TABLE**

TRACT	SURFACE OWNER	TAX PARCEL	ACRES
S1 A	MICHAEL WILLIAM HANLIN	07-11-50	58.5
S2 B	MICHAEL BLAINE BEAGLE	07-11-48	112.25
S3 C	HAESSLEY LAND AND TIMBER, LLC	07-11-53	80.0
S4 D	WEST VIRGINIA DIVISION OF NATURAL RESOURCES	MIDDLE ISLAND CREEK	2,539 CALC.
S5 E	HEARTWOOD FORESTLAND FUND IV LIMITED PARTNERSHIP	07-10-18A	600.097
S6 F	BB LAND, LLC	07-05-62	60.5
S7 G	PAM PFALZGRAF	07-05-62.1	2.924
S8 H	SPRING MOUNTAIN HOLDINGS LLC	07-05-56	117.41
S9 I	NELLIE M BARNHART	07-05-65	28.0
S10 J	VIRILENE S GIBONEY	07-05-65.1	0.944
S11	RONALD M METZ, LIFE ESTATE	07-05-37	20.0
S12	NATHAN WADE BENNETT	07-06-109	5.011
S13	HEARTWOOD FORESTLAND FUND IV LIMITED PARTNERSHIP	07-06-100	17.29
S14	DAVID ROGER MCCARTNEY & PATTY SUE MCCARTNEY	07-06-31	0.75
S15	DAVID ROGER MCCARTNEY & PATTY SUE MCCARTNEY	07-06-30.1	6.0
S16	CHARLES R MANKINS & BETH ANN MANKINS	07-06-30	45.0
S17	LOUIE A STANLEY	07-06-37	60.0
S18	LISA STANLY, TRUSTEE OF THE R DEAN SMITH 2009 TRUST	07-06-64	69.887
S19	BB LAND, LLC	07-06-66	85.0
S20	BMB ENTERPRISES, LLC & JOHN S. GRIM	07-11-01	157.5
S21	EDWARD B HOLMES & MELISSA K HOLMES	07-11-3.2	3.447
S22	GARY BURIAN & BEVERLY BURIAN	07-11-2	6.1
S23	KENNETH G HOLMES, SANDRA K LAMM, ROGER Q HOLMES & RONALD S HOLMES	07-11-25.7	40.88
S24	JOSHUA NEAL MYERS & LUKE ALAN MYERS	07-11-24	0.21
S25	JAMES K STOUT	07-11-23.1	0.524
S26	JAMES K STOUT	07-11-23.2	0.084
S27	SCOTT & KELLY BYERS	07-11-23	0.93
S28	GRANT HOSKINSON	07-11-22	3.63
S29	KENNETH G HOLMES & DORIS A HOLMES	07-11-25.3	5.621
S30	SUGAR VALLEY SCHOOL	07-11-25.1	0.57
S31	PATRICK DEAN SOLE	07-11-26	49.1769
S32	DEPT. OF NATURAL RESOURCES	07-11-22.1	1.37
S33	MICHAEL BLAINE BEAGLE	07-11-21	1.0
S34	JOHN TICE	07-11-51.1	1.0
S35	JED BATES & EVELYN BATES	07-11-51	5.564
S36	JOHN P RIGGS & BRENDA J. RIGGS	04-01-01	65.0
S37	JED H BATES & MARIE BATES	07-10-36.3	17.10
S38	JED BATES & MARIE BATES	07-10-49	4.0
S39	LARRY O. BARNHART & BRENDA L. BARNHART, JESSE M. BARNHART & JUDITH K. BARNHART	07-10-26	1.0
S40	LARRY O. BARNHART & BRENDA L. BARNHART, JESSE M. BARNHART & JUDITH K. BARNHART	07-10-17	20.5
S41	LARRY O. BARNHART & BRENDA L. BARNHART, JESSE M. BARNHART & JUDITH K. BARNHART	07-10-25	10
S42	LARRY O. BARNHART & BRENDA L. BARNHART, JESSE M. BARNHART & JUDITH K. BARNHART	07-10-7.1	1.0
S43	RICHARD C BEANE & REBECCA D BEANE	07-10-07	30.0
S44	RICHARD C BEANE & DIANE BEANE	07-10-06	20.0
S45	RICHARD C BEANE & DIANE BEANE	07-10-55	3.647
S46	JOSEPH AYERS & CYNTHIA AYERS	07-05-61	35.98
S47	MARY BARNHART	07-05-54	12.5
S48	NELLIE M BARNHART	07-05-67	44.25
S49	NELLIE M BARNHART	07-05-66	19.88
S50	HAROLD E BARNHART, HENRY REUBEN BARNHART & PHYLLIS MARIE BARNHART HARBERT	07-05-34	72
S51	SHARON MARIEA DALRYMPLE	07-05-34.1	1.0
S52	MT. NEBO CHURCH OF CHRIST TRUST	07-05-35	1.0
S53	BENS RUN LAND COMPANY LIMITED PARTNERSHIP	07-05-03	176.05
S54	CARROLL L ASH	07-05-36	15.0
S55	HEARTWOOD FORESTLAND FUND IV LIMITED PARTNERSHIP	07-05-56.1	12.5



Jay Bee  
Oil & Gas

DRILLING  
into the future

OPERATOR'S  
 WELL #: P6N3U  
 DISTRICT: UNION  
 COUNTY: PLEASANTS  
 STATE: WV  
 API #: 47-073-02603

WELL PLAT  
 PAGE 2 OF 3  
 DATE: 02/08/2023



form wv6

JACKSON SURVEYING  
 INC.  
 2413 East Pike Street  
 #112  
 Clarksburg, WV 26301  
 304-623-5851

P6N3U  
UNIT SIZE  
 170.5273 ± AC.

<u>Tracts</u>	<u>District</u> <u>Tax Map/Parcel</u>	<u>Lease #</u>	<u>Lessor, Grantor, etc.</u>
A	07-11-50	P7021	Kathy McHenry
A	07-11-50	P7021	Michael William Hanlin
A	07-11-50	P7021	Siltstone
B	07-11-48	P7069	Ridgetop Capital IV, LP
B	07-11-48	P7069	BB Land, LLC
C	07-11-53	P7020	Haessly Land and Timber, LLC
D	MIDDLE ISLAND CREEK	DNR 6	West Virginia Division of Natural Resources
E	07-10-18A	P7098	Erma K. Pethtel
E	07-10-18A	P7098	BMB Enterprises, LLC
E	07-10-18A	P7098	Jay-Bee Royalty purchased interest of John S. Grim
F	07-05-62	P7044	Barbara L. Lemasters
F	07-05-62	P7044	Gala Lee Buchanan
F	07-05-62	P7044	Kathy Jean Leasure
F	07-05-62	P7044	Larry G. Hall
F	07-05-62	P7044	Ridgetop Capital IV, LP
F	07-05-62	P7044	Robert D. Hall
F	07-05-62	P7044	Truman A. Buchanan
F	07-05-62	P7044	BB Land, LLC
G	07-05-62.1	P7232B	Pamela Pfalzgraf
H	07-05-56	P7123A&B	James Allen & Lenora Ellen Renner
I	07-05-65	P7232	Mary Joyce Barnhart
I	07-05-65	P7232	Gary L. Hartmann
I	07-05-65	P7232	Joye L. Scott
I	07-05-65	P7232	Pamela K. Bullard
I	07-05-65	P7232	Henry Reuben Barnhart
I	07-05-65	P7232	Harold Eugene Barnhart
I	07-05-65	P7232	Phyllis Marie Harbert
I	07-05-65	P7232	Paul Dean Miller
I	07-05-65	P7232	Richard Lee Miller
I	07-05-65	P7232	Rhonda P. Stamm
J	07-05-65.1	P7232A	Virgilene S. Giboney

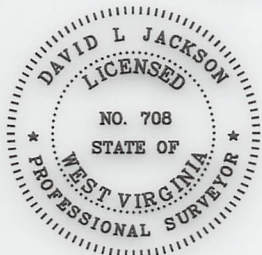

P.S.  
708

*David L Jackson*

**Top Hole**  
 Geo NAD 83- 39.419030 N. 81.096697 W  
 UTM NAD 83(Meters)-4363282.88 N. 491762.51 E  
 UTM NAD 83(Feet)-14315203.93 N. 1613390.83 E

**Landing Point**  
 Geo NAD 83- 39.418780 N. 81.097708 W  
 UTM NAD 83(Meters)-4363255.32 N. 491589.37 E  
 UTM NAD 83(Feet)-14315113.52 N. 1612822.80 E

**Bottom Hole**  
 Geo NAD 83- 39.438128 N. 81.111751 W  
 UTM NAD 83(Meters)-4365403.95 N. 490383.28 E  
 UTM NAD 83(Feet)-14322162.79 N. 1608865.82 E

05/05/2023



Jay Bee  
Oil & Gas

DRILLING  
into the future

OPERATOR'S  
 WELL #: P6N3U  
 DISTRICT: UNION  
 COUNTY: PLEASANTS  
 STATE: WV  
 API #: 47-073-02603

WELL PLAT  
 PAGE 3 OF 3  
 DATE: 2/08/2023