

LATITUDE 39-27-30 N (TH) Bottom Hole 11,125'
 LATITUDE 39-25-00 N (BH)

References:

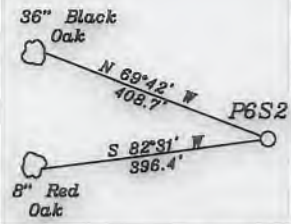

NUMBER	DIRECTION	DISTANCE
L1	N40°11' E	1,080.8'
L2	N83°30' W	1,339.8'
L3	N58°11' E	376.7'

Top Hole
 Geo NAD 83- 39.418995 N, 81.095526 W
 UTM NAD 83(Meters)-4363278.97 N, 491777.23 E
 UTM NAD 83(Feet)-14315191.08 N, 1613439.13 E

Landing Point
 Geo NAD 83- 39.419556 N, 81.094406 W
 UTM NAD 83(Meters)-4363341.10 N, 491873.74 E
 UTM NAD 83(Feet)-14315394.93 N, 1613755.76 E

Bottom Hole
 Geo NAD 83- 39.400461 N, 81.081041 W
 UTM NAD 83(Meters)-4361220.79 N, 493022.28 E
 UTM NAD 83(Feet)-14308438.58 N, 1617523.86 E

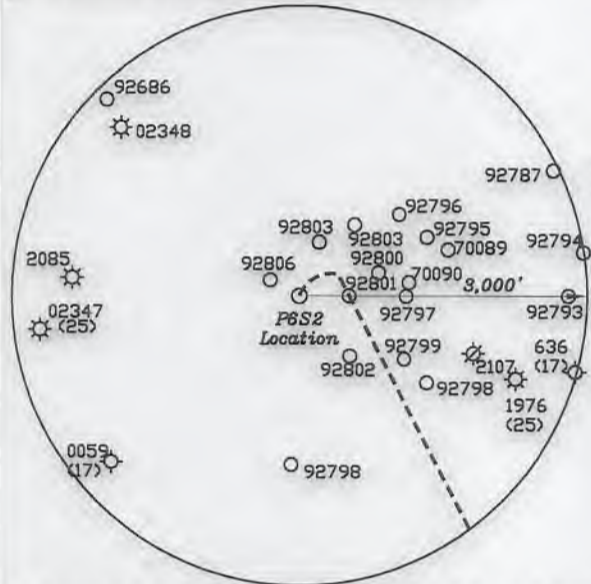

- Notes:**
- All wells within 500' of the horizontal leg are shown on this plat based upon information taken from DEP mapping, well plats, & aerial photos.
 - Ties to wells and corners are based on State Plane Grid North-WV North Zone NAD 83.
 - No water wells were found within 250' of the well location. No dwellings or buildings were found within 625' from the center of the proposed pad. No perennial streams are located within 100' of LOD. No producing trout stream is located within 300' of LOD.

LEGEND

- 500' from Bore Path
- Well Lateral
- Unit Boundary
- Lease Tracts
- Surface Tracts

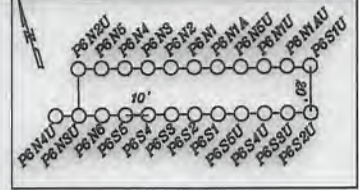

Bottom Hole 5,903'
 Top Hole 14,330'
 LONGITUDE 81-02-30 W (BH)
 LONGITUDE 81-05-00 W (TH)

(+) DENOTES LOCATION OF WELL ON UNITED STATES TOPOGRAPHIC MAPS

FILE NO. _____
 DRAWING NO. 1
 SCALE 1" = 2000'
 MINIMUM DEGREE OF ACCURACY 1 in 200
 PROVEN SOURCE OF ELEVATION GPS
submeter unit

I THE UNDERSIGNED, HEREBY CERTIFY THAT THIS PLAT IS CORRECT TO THE BEST OF MY KNOWLEDGE AND BELIEF AND SHOWS ALL THE INFORMATION REQUIRED BY LAW AND THE RULES ISSUED AND PRESCRIBED BY THE DEPARTMENT OF ENVIRONMENTAL PROTECTION.

(SIGNED) David L. Jackson
 R.P.E. _____ P.S. 708



STATE OF WEST VIRGINIA
 Division of Environmental Protection
 OFFICE OF OIL AND GAS

DATE August 17, 2018
 OPERATOR'S WELL NO. P6S2
 API WELL NO. _____

WELL TYPE: OIL GAS LIQUID INJECTION _____ WASTE DISPOSAL _____
 (IF "GAS") PRODUCTION X STORAGE _____ DEEP _____ SHALLOW X

LOCATION: ELEVATION 887.0' WATER SHED Sugar Creek of Outlet Middle Island Creek (HUC-10)
 DISTRICT Union COUNTY Pleasants
 QUADRANGLE Bens Run 7 1/2'

SURFACE OWNER Billy D. Hanlin ACREAGE 58.5 Ac.
 OIL & GAS ROYALTY OWNER Billy D. Hanlin et al LEASE ACREAGE 58.5 Ac.
 LEASE NO. P7021

PROPOSED WORK: DRILL X CONVERT _____ DRILL DEEPER _____ REDRILL _____ FRACTURE OR STIMULATE X PLUG OFF OLD FORMATION _____ PERFORATE NEW FORMATION _____ OTHER PHYSICAL CHANGE IN WELL (SPECIFY) _____

PLUG AND ABANDON _____ CLEAN OUT AND REPLUG _____
 TARGET FORMATION Marcellus ESTIMATED DEPTH TVD = 5,919'; TMD = 14,710'
 WELL OPERATOR Jay-Bee Oil & Gas, Inc. DESIGNATED AGENT Randy Broda
 ADDRESS 1720 Route 22 E, Union, NJ 07083 ADDRESS 3570 Shields Hill Rd., Cairo, WV 26337

TRACT	SURFACE OWNER	TAX MAP/PARCEL	ACRES
S1	CLINTON C. HALL JR.	04-4-7	39.5
S2	JOHN P. & BRENDA J. RIGGS	04-4-6	39.0
S3	CLINTON C. HALL JR., MAX E. HALL, ROCKIE HALL, KATHY BAYLESS, VICKI E. NAZELROD, & JULIE G. EFAW	04-2-2	27.5
S4	JOHN P. & BRENDA J. RIGGS	04-2-5	3.5
S5	ROBERT TIMOTHY & LISA DAWN CUMM, JED & EVELYN BATES	04-4-24	51.0
S6	JIMMY M. THAXTON II	07-11-51	5.564
S7	JOHN TICE	07-11-51.1	1.0
S8	MICHAEL BLAINE BEACLE	07-11-21	1.0
S9	WVDNR	07-11-22.1	1.37
S10	LINDA L. SHIMER	07-11-22	3.63
S11	CLINTON C. HALL JR., MAX E. & LINDA L. HALL	07-11-43	18.6
S12	GOLDEN EAGLES RESOURCES LLC & HUMMER PROPERTIES LLC	07-11-40	62.063
S13	CLINTON C. HALL JR., MAX E. & LINDA L. HALL	07-11-49	6.36
S14	GOLDEN EAGLES RESOURCES LLC & HUMMER PROPERTIES LLC	07-15-12	28.944
S15	HEARTWOOD FORESTLAND FUND IV LIMITED PARTNERSHIP	07-15-2	27.0



47-073-02589

P.S.
708

David L. Jackson



Jay Bee
Oil & Gas

DRILLING
into the future

OPERATOR'S
WELL #: P6S2
DISTRICT: UNION
COUNTY: PLEASANTS
STATE: WV

WELL PLAT
PAGE 2 OF 2
DATE: 08/17/2018