

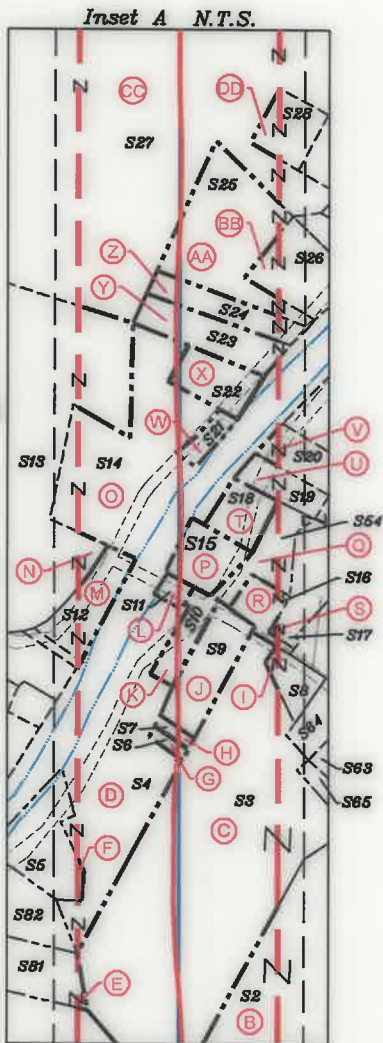



WELL - P4N2U  
UNIT BOUNDARY AREA -  
182.32 ACRES ±



P.S.  
708

*David L Jackson*



Jay Bee  
Oil & Gas

DRILLING  
into the future

TRACT	SURFACE OWNER	TM PARCEL	ACRES
S1	JOHN A. & EDITH U. SMITH	11 / 16	189.21
S2	JOHN A. & EDITH U. SMITH	6 / 106	21.46
S3	DOUGLAS D. & LORI K. RENNER	6 / 90.3	20.791
S4	KATHRINE LOUISE FLEMING	6 / 90.1	8.08
S5	PAMELA JO. & CHARLES R. BOWIE	6 / 91	1.95
S6	RODNEY RAY & CRAIG ALLEN HOLMES	6 / 88	0.17
S7	RODNEY RAY & CRAIG ALLEN HOLMES	6 / 87	0.17
S8	TANYA L. RENNER KALINOWSKI	6 / 90	0.75
S9	RODNEY RAY & CRAIG ALLEN HOLMES	6 / 89	1.73
S10	BENNY DALE & CARRIE DARLENE WHARTON	6 / 98	0.686
S11	BENNY DALE & CARRIE DARLENE WHARTON	6 / 107	0.002
S12	DAN W. & RENE H. ENRIGHT	6 / 75.3	2.287
S13	JACK E. & HILDA M. RENNER	6 / 75	39.13
S14	WILLIAM R. & ANNELLE L. EDWARDS	6 / 95	4.93
S15	STEPHEN E. & AMY JO GROSE	6 / 78.1	0.74
S16	RONALD D. TUCKER	6 / 78	0.52
S17	JAMES ALLEN & LENORA ELLEN RENNER	6 / 78.5	0.31
S18	HAROLD J. & EDNA I. KIMBALL	6 / 78.2	1.06
S19	JOHN V. & LISA P. ONESTINGHEL	6 / 78.3	1.2
S20	JAMES ALLEN & LENORA ELLEN RENNER	6 / 78.4	1.2
S21	DONALD WAYNE BENNETT, VICKI JANE & LOGAN VICTOR	6 / 96.1	0.56
S22	WILLIAM R. & ANNELLE EDWARDS	6 / 77	2.75
S23	DENNIS L. & KRIS-TIANNA S. VENDERLIC	6 / 76.1	1.93
S24	DENNIS L. & KRIS-TIANNA S. VENDERLIC	6 / 76.2	1.27
S25	CHAD M. EDWARDS	6 / 76.3	4.57
S26	EVERETT & KATHINE CURRY	6 / 76	2.067
S27	JEFFREY T. & LORI M. RENNER	6 / 46	84.51
S28	RICK R. & DEBORAH K. DAY	6 / 46.3	0.66
S29	BB LAND LLC	6 / 47	12.79
S30	ELIZABETH M. BREMEN ET AL	6 / 45	30.0
S31	EUGENE HUBERT STEWART	6 / 34	26.83
S32	WILLIAM D. PAYNE & JODI L. GREEN	6 / 28	66.848
S33	ASBURY TICE	6 / 29	2.25
S34	RALPH, CHAD, & BRIAN NORTHCRAFT	6 / 19	10.0
S35	RALPH, CHAD, & BRIAN NORTHCRAFT	6 / 18	31.75
S36	RALPH, CHAD, & BRIAN NORTHCRAFT	6 / 20	0.9
S37	RALPH, CHAD, & BRIAN NORTHCRAFT	6 / 21	0.75
S38	RALPH, CHAD, & BRIAN NORTHCRAFT	6 / 24	16.55
S39	EUGENE HUBERT STEWART	6 / 36	44
S40	BB LAND LLC	6 / 48	20.75
S41	FRANKLIN SR. & ANNIE OWENS	6 / 50.1	2.22
S42	KENNETH DALE DECKER & EMILY ELIZABETH	6 / 51	0.76
S43	KENNETH DALE DECKER & EMILY ELIZABETH	6 / 51.1	0.37
S44	WILLIAM LEWIS JR. & KAREN SUE DECKER	6 / 52	1.26
S45	WILLIAM LEWIS JR. & KAREN SUE DECKER	6 / 52.1	0.51
S46	BARRY & VICTORIA ADAMS	6 / 53	0.768
S47	RODNEY RAY HOLMES, ET AL	6 / 54 + 55	0.99
S48	DEENA M. HATCHER & DANIEL RODNEY HIGGINS	6 / 56 + 46.2	0.93
S49	JOHN ANDREW WILLIAMS & JOHN A. WILLIAMS SR.	6 / 57	1.0
S50	DAVID GREGG & SANDRA COWAN	6 / 58	1.0
S51	MARSHALL R. SATTERFIELD	6 / 59	0.77
S52	MARSHALL R. SATTERFIELD	6 / 60	0.74
S53	RICK R. & DEBORAH K. DAY	6 / 46.1	0.35
S54	JAMES ALLEN & LENORA ELLEN RENNER	6 / 78.6	31
S55	JAMES ALLEN & LENORA ELLEN RENNER	6 / 80	3.995
S56	JAMES ALLEN & LENORA ELLEN RENNER	6 / 82	16.286
S57	JAMES A. JR. & BEVERLY K. RENNER	6 / 82.3	0.913
S58	JAMES A. JR. & BEVERLY K. RENNER	6 / 80.1	4.463
S59	REGULAR BAPTIST CHURCH OF JESUS CHRIST	6 / 80.2	2.0
S60	ALLAN F. & NANCY L. HARMAN	6 / 81.1	0.50
S61	ALLAN F. & NANCY L. HARMAN	6 / 81	0.50
S62	ALLAN F. & NANCY L. HARMAN	6 / 94.1	0.33
S63	DANNY J. & LINDA C. NAGLE	6 / 94	2.67
S64	DANNY J. & LINDA C. NAGLE	6 / 93	1.13
S65	DANNY J. & LINDA C. NAGLE	6 / 90.2	0.5
S66	DANNY J. NAGLE	6 / 82.2	1.65
S67	JAMES A. & LENORA E. RENNER	6 / 82.1	1.0
S68	ANTHONY D. & MARY M. DRANE	6 / 106.1	1.5
S69	KEVIN S. BUZZARD	6 / 84	10.5
S70	REGULAR BAPTIST CHURCH OF JESUS CHRIST	6 / 109	2.0
S71	JERRY CORRIGAN	6 / 105	2.165
S72	WELLS CATTLE FARMS, INC.	7 / 28	34.46
S73	ANTHONY L. & DEVIN L. LAUER	11 / 16.1	1.5
S74	ANTHONY L. & DEVIN L. LAUER	11 / 16.2	3.29
S75	BB LAND LLC	11 / 18	28.75
S76	JAY BEE OIL AND GAS, INC.	11 / 30	25.14
S77	JAY BEE OIL AND GAS, INC.	11 / 32	13.11
S78	DARIN J. BARBER	11 / 27	165
S79	MELISSA A. BLAKE	11 / 12	5.0
S80	PAMELA JO. BOWIE	11 / 14	12.955
S81	PAMELA JO. BOWIE	11 / 13	3.25
S82	PAMELA JO. BOWIE	6 / 92	1.00
S83	JACK L. & PAMELA I. STOLLINGS	6 / 75.6	1.5
S84	HENRY R. & JUDITH ANN BARNHART	6 / 74	5.54
S85	MARTHA L. SAMS	6 / 71	6.5
S86	HENRY R. & JUDITH ANN BARNHART	6 / 73	1.25
S87	CHERYL SATTERFIELD	6 / 75.2	0.24
S88	CHARLES A. RUMBERG	6 / 75.1	0.53
S89	MICHAEL K. DELANCY	6 / 75.4	0.893
S90	MICHAEL K. DELANCY	6 / 75.5	0.42
S91	SARAH E. MEES	6 / 70	141.361
S92	BRADY A. SMITH	6 / 43	30
S93	BRADY A. SMITH	6 / 44	21.5
S94	BRADY A. SMITH	6 / 42	8.5
S95	SILTSTONE RESOURCES II, LLC	6 / 33	51.478
S96	WILLIAM E. GREEN	6 / 17	21.567
S97	JODI L. GREEN	6 / 28.1	1.152
S98	MARK S. & DONNA M. MAYNE	6 / 5.1	2.0
S99	EARLY O. & DEBRA E. DALRYMPLE	6 / 5.4	0.23
S100	JEFFERY SCOTT & KERRI L. DALRYMPLE	6 / 5.0	0.5
S101	EARLY O. & DEBRA E. DALRYMPLE	6 / 5.6	1.75
S102	STACY L. BILLS & RONALD A. MORGAN	6 / 5.2	1.5
S103	EARLY O. & DEBRA E. DALRYMPLE	6 / 5.2	1.5

06/18/2021

OPERATOR'S  
WELL #: P4N2U - 02578  
DISTRICT: UNION  
COUNTY: PLEASANTS  
STATE: WV

WELL PLAT  
PAGE 2 OF 5  
DATE: 06/29/2020

form WWS

**WELL - P4N2U  
UNIT BOUNDARY AREA -  
182.32 ACRES ±**

Tracts	Tax Map/Parcel	Lease #	Mineral Owner
A	11/16	P7019	John A. Smith & Edith U. Smith
B	6/106	P7190	Ervin V. Flesher etal c/o Tim Casey
B	6/106	P7190	John A. Smith & Edith U. Smith
C	6/90.3	P7072	BB Land LLC
C	6/90.3	P7072	Ridgetop Capital IV LP
D	6/90.1	P7077	BB Land LLC
D	6/90.1	P7077	Clay Holmes
D	6/90.1	P7077	Craig Allen Holmes
D	6/90.1	P7077	Katherine Louise Fleming
D	6/90.1	P7077	Ridgetop Capital IV LP
D	6/90.1	P7077	Rodney Ray Holmes
D	p/o 6/90.1	P7077A	Katherine Louise Fleming
D	p/o 6/90.1	P7077B	Katherine Louise Fleming
D	p/o 6/90.1	P7077C	Katherine Louise Fleming
E	p/o 11/13	P7196	Union Bank of Middlebourne
E	p/o 11/13	P7196	Francis L. McKee
E	p/o 11/13	P7196	Melvin Cheney Trust No. 1
E	p/o 11/13	P7196	Presbyterian Church USA Foundation
E	p/o 11/13	P7196	Ronald D. Alexander
E	p/o 11/13	P7196	David Wade
E	p/o 11/13	P7196	Allan Zaring
E	p/o 11/13	P7196	Donald Hartley
E	p/o 11/13	P7196	Janet LaForce
E	p/o 11/13	P7196	Robert R. Reynolds
E	p/o 11/13	P7196	Marilyn Sue Ryan
E	p/o 11/13	P7196	LaVerne Lee
E	p/o 11/13	P7196	Helen Ann Hodkins
E	p/o 11/13	P7196	Blanche Day
E	p/o 11/13	P7196	Robert (Bobby) L. Boles
E	p/o 11/13	P7196	Janice Elaine Weisenhorn
E	p/o 11/13	P7196	Mary Lou Callahan
E	p/o 11/13	P7196	Betty Levings
E	p/o 11/13	P7196	Beulah Embree
E	p/o 11/13	P7196	Judith E. McKee
E	p/o 11/13	P7196	Linda Roberts
E	p/o 11/13	P7196	Verna Herman
E	p/o 11/13	P7196	Nadine Reams
E	p/o 11/13	P7196	Clyde M. Reams
E	p/o 11/13	P7196	Doris McKee
E	p/o 11/13	P7196	Robert Davis
E	p/o 11/13	P7196	Mary Jane Halbert
E	p/o 11/13	P7196	Alberta Johnson
E	p/o 11/13	P7196	Jay-Bee Royalty, LLC
E	p/o 11/13	P7196	Joanna M. Boles Living Trust
E	p/o 11/13	P7196	Mary Lee Tecca
E	p/o 11/13	P7196	Kayla Ware
E	p/o 11/13	P7196	Denise Isom
E	p/o 11/13	P7196	Mercy Zavattero
E	p/o 11/13	P7196	Allen McGee
E	p/o 11/13	P7196	General Board of Global Ministries of The United Methodist Church Leased by Special Commissioner B. Scott Wolfe on 2/22/18 DB 322/440. Civil Action Number 17-P-15
E	p/o 11/13	P7196	Millard James Ernstsen
E	p/o 11/13	P7196	Jack R. Palmer
E	p/o 11/13	P7196	Margit Eliene Ernstsen
E	p/o 11/13	P7196	Candy Steven Serval
E	p/o 11/13	P7196	Kathryn E. Shear
E	p/o 11/13	P7196	Barry L. Bise
E	p/o 11/13	P7196	Diane McKee
E	p/o 11/13	P7196	Douglas M. Baird
E	p/o 11/13	P7196	Richard Kent Boles
E	p/o 11/13	P7196	Roger Conklin
E	p/o 11/13	P7196	Christopher W. Crane
E	p/o 11/13	P7196	Una Henry
E	p/o 11/13	P7196	Deborah Lynn Krieger
E	p/o 11/13	P7196	Gerald Avon LaForce
E	p/o 11/13	P7196	Bruce LaForce "Loree Berry, Conservator"
E	p/o 11/13	P7196	Arlen Patrick McGee
E	p/o 11/13	P7196	Aaron McGee
E	p/o 11/13	P7196	Andrew "Trey" McGee III
E	p/o 11/13	P7196	Ora A. Watson
E	p/o 11/13	P7196	Marilyn, K. Zaring
E	p/o 11/13	P7196	Heirs of Michael Wayne Palmer
E	p/o 11/13	P7196	Heirs of Lois Bernadyne Bryan Meacham
E	p/o 11/13	P7196	Heirs of Warren Spencer Roberts
E	p/o 11/13	P7196	Heirs of Darwin Curtis Dinsmoor
E	p/o 11/13	P7196	Heirs of Elsie Doris Dinsmoor Holland
E	p/o 11/13	P7196	Heirs of Alfred Henry Zavattero
E	p/o 11/13	P7196	Heirs of Janette Madeline Stephens
E	p/o 11/13	P7196	Heirs of Patricia Abrahamson
E	p/o 11/13	P7196C2	Union Bank, Inc.
E	p/o 11/13	P7196C2	Pamela Jo & Charles R., Bowie
F	6/91	P7072A & P7196C1	Union Bank, Inc.
F	6/91	P7072A & P7196C1	Pamela Jo & Charles R., Bowie
G	6/88	P7077	BB Land LLC
G	6/88	P7077	Clay Holmes
G	6/88	P7077	Craig Allen Holmes
G	6/88	P7077	Katherine Louise Fleming
G	6/88	P7077	Ridgetop Capital IV LP
G	6/88	P7077	Rodney Ray Holmes
H	6/87	P7077	BB Land LLC
H	6/87	P7077	Clay Holmes
H	6/87	P7077	Craig Allen Holmes
H	6/87	P7077	Katherine Louise Fleming
H	6/87	P7077	Ridgetop Capital IV LP
H	6/87	P7077	Rodney Ray Holmes
I	6/90	P7077	BB Land LLC
I	6/90	P7077	Clay Holmes
I	6/90	P7077	Craig Allen Holmes
I	6/90	P7077	Katherine Louise Fleming
I	6/90	P7077	Ridgetop Capital IV LP
I	6/90	P7077	Rodney Ray Holmes
J	6/89	P7077E	BB Land LLC
J	6/89	P7077	Clay Holmes
J	6/89	P7077	Craig Allen Holmes
J	6/89	P7077	Katherine Louise Fleming
J	6/89	P7077	Ridgetop Capital IV LP
J	6/89	P7077	Rodney Ray Holmes



P.S. 708

*David L Jackson*

06/18/2021



Jay Bee  
Oil & Gas

**DRILLING**  
into the future

OPERATOR'S  
WELL #: P4N2U - 02578  
DISTRICT: UNION  
COUNTY: PLEASANTS  
STATE: WV

WELL PLAT  
PAGE 3 OF 5  
DATE: 06/29/2020



form wv6

**WELL - P4N2U  
UNIT BOUNDARY AREA -  
182.32 ACRES ±**

Tracts	Tax Map/Parcel	Lease #	Mineral Owner
A	11/16	P7019	John A. Smith & Edith U. Smith
B	6/106	P7190	Ervin V. Flesher etal c/o Tim Casey
B	6/106	P7190	John A. Smith & Edith U. Smith
C	6/90.3	P7072	BB Land LLC
C	6/90.3	P7072	Ridgetop Capital IV LP
D	6/90.1	P7077	BB Land LLC
D	6/90.1	P7077	Clay Holmes
D	6/90.1	P7077	Craig Allen Holmes
D	6/90.1	P7077	Katherine Louise Fleming
D	6/90.1	P7077	Ridgetop Capital IV LP
D	6/90.1	P7077	Rodney Ray Holmes
D	p/o 6/90.1	P7077A	Katherine Louise Fleming
D	p/o 6/90.1	P7077B	Katherine Louise Fleming
D	p/o 6/90.1	P7077C	Katherine Louise Fleming
E	p/o 11/13	P7196	Union Bank of Middlebourne
E	p/o 11/13	P7196	Francis L. McKee
E	p/o 11/13	P7196	Melvin Cheney Trust No. 1
E	p/o 11/13	P7196	Presbyterian Church USA Foundation
E	p/o 11/13	P7196	Ronald D. Alexander
E	p/o 11/13	P7196	David Wade
E	p/o 11/13	P7196	Allan Zaring
E	p/o 11/13	P7196	Donald Hartley
E	p/o 11/13	P7196	Janet LaForce
E	p/o 11/13	P7196	Robert R. Reynolds
E	p/o 11/13	P7196	Marilyn Sue Ryan
E	p/o 11/13	P7196	LaVerne Lee
E	p/o 11/13	P7196	Helen Ann Hodkins
E	p/o 11/13	P7196	Blanche Day
E	p/o 11/13	P7196	Robert (Bobby) L. Boles
E	p/o 11/13	P7196	Janice Elaine Weisenhorn
E	p/o 11/13	P7196	Mary Lou Callahan
E	p/o 11/13	P7196	Betty Levings
E	p/o 11/13	P7196	Beulah Embree
E	p/o 11/13	P7196	Judith E. McKee
E	p/o 11/13	P7196	Linda Roberts
E	p/o 11/13	P7196	Verna Herrman
E	p/o 11/13	P7196	Nadine Reams
E	p/o 11/13	P7196	Clyde M. Reams
E	p/o 11/13	P7196	Doris McKee
E	p/o 11/13	P7196	Robert Davis
E	p/o 11/13	P7196	Mary Jane Halbert
E	p/o 11/13	P7196	Alberta Johnson
E	p/o 11/13	P7196	Jay-Bee Royalty, LLC
E	p/o 11/13	P7196	Joanna M. Boles Living Trust
E	p/o 11/13	P7196	Mary Lee Tecca
E	p/o 11/13	P7196	Kajls Ware
E	p/o 11/13	P7196	Denise Isom
E	p/o 11/13	P7196	Mercy Zavattero
E	p/o 11/13	P7196	Allen McGee
E	p/o 11/13	P7196	General Board of Global Ministries of The United Methodist Church Leased by Special Commissioner B. Scott wolfe on 2/22/18 DB 322/440. Civil Action Number 17-P-15
E	p/o 11/13	P7196	Millard James Ernstsen
E	p/o 11/13	P7196	Jack R. Palmer
E	p/o 11/13	P7196	Margit Eliene Ernstsen
E	p/o 11/13	P7196	Candy Steven Serval
E	p/o 11/13	P7196	Kathryn E. Shear
E	p/o 11/13	P7196	Barry L. Bise
E	p/o 11/13	P7196	Diane McKee
E	p/o 11/13	P7196	Douglas M. Baird
E	p/o 11/13	P7196	Richard Kent Boles
E	p/o 11/13	P7196	Roger Conklin
E	p/o 11/13	P7196	Christopher W. Crane
E	p/o 11/13	P7196	Una Henry
E	p/o 11/13	P7196	Deborah Lynn Krieger
E	p/o 11/13	P7196	Gerald Avon LaForce
E	p/o 11/13	P7196	Bruce LaForce "Loree Berry, Conservator"
E	p/o 11/13	P7196	Arlen Patrick McGee
E	p/o 11/13	P7196	Aaron McGee
E	p/o 11/13	P7196	Andrew "Trey" McGee III
E	p/o 11/13	P7196	Ora A. Watson
E	p/o 11/13	P7196	Marilyn, K. Zaring
E	p/o 11/13	P7196	Heirs of Michael Wayne Palmer
E	p/o 11/13	P7196	Heirs of Lois Bernadyne Bryan Meacham
E	p/o 11/13	P7196	Heirs of Warren Spencer Roberts
E	p/o 11/13	P7196	Heirs of Darwin Curtis Dinsmoor
E	p/o 11/13	P7196	Heirs of Elsie Doris Dinsmoor Holland
E	p/o 11/13	P7196	Heirs of Alfred Henry Zavattero
E	p/o 11/13	P7196	Heirs of Janette Madeline Stephens
E	p/o 11/13	P7196	Heirs of Patricia Abrahamson
E	p/o 11/13	P7196C2	Union Bank, Inc.
E	p/o 11/13	P7196C2	Pamela Jo & Charles R.,Bowie
F	6/91	P7072A & P7196C1	Union Bank, Inc.
F	6/91	P7072A & P7196C1	Pamela Jo & Charles R.,Bowie
G	6/88	P7077	BB Land LLC
G	6/88	P7077	Clay Holmes
G	6/88	P7077	Craig Allen Holmes
G	6/88	P7077	Katherine Louise Fleming
G	6/88	P7077	Ridgetop Capital IV LP
G	6/88	P7077	Rodney Ray Holmes
H	6/87	P7077	BB Land LLC
H	6/87	P7077	Clay Holmes
H	6/87	P7077	Craig Allen Holmes
H	6/87	P7077	Katherine Louise Fleming
H	6/87	P7077	Ridgetop Capital IV LP
H	6/87	P7077	Rodney Ray Holmes
I	6/90	P7077	BB Land LLC
I	6/90	P7077	Clay Holmes
I	6/90	P7077	Craig Allen Holmes
I	6/90	P7077	Katherine Louise Fleming
I	6/90	P7077	Ridgetop Capital IV LP
J	6/89	P7077E	BB Land LLC
J	6/89	P7077	Clay Holmes
J	6/89	P7077	Craig Allen Holmes
J	6/89	P7077	Katherine Louise Fleming
J	6/89	P7077	Ridgetop Capital IV LP
J	6/89	P7077	Rodney Ray Holmes



P.S. 708

*David L Jackson*

06/18/2021



Jay Bee Oil & Gas

DRILLING into the future

OPERATOR'S  
WELL #: P4N2U - 02578  
DISTRICT: UNION  
COUNTY: PLEASANTS  
STATE: WV

WELL PLAT  
PAGE 4 OF 5  
DATE: 06/29/2020

form wv6

**WELL - P4N2U  
UNIT BOUNDARY AREA -  
182.32 ACRES ±**

K	6/98	P7077	BB Land LLC
K	6/98	P7077	Clay Holmes
K	6/98	P7077	Craig Allen Holmes
K	6/98	P7077	Katherine Louise Fleming
K	6/98	P7077	Ridgetop Capital IV LP
K	6/98	P7077	Rodney Ray Holmes
L	6/107	P7077	BB Land LLC
L	6/107	P7077	Clay Holmes
L	6/107	P7077	Craig Allen Holmes
L	6/107	P7077	Katherine Louise Fleming
L	6/107	P7077	Ridgetop Capital IV LP
L	6/107	P7077	Rodney Ray Holmes
M	6/75.3	P7192C	Sharon McGee
M	6/75.3	P7192C	Martha Hunt
M	6/75.3	P7192C	June Tabb
M	6/75.3	P7192C	Larry D. Smith
M	6/75.3	P7192C	Jeannette Marlene Brakeman
M	6/75.3	P7192C	Patricia Estelle Wells
M	6/75.3	P7192C	Linda Meston
M	6/75.3	P7192C	Charles R. Smith
M	6/75.3	P7192C	Kathy D. Schroeder
M	6/75.3	P7192C	Helen F. Smith Wescott
M	6/75.3	P7192C	Barbara Opal Stuart
M	6/75.3	P7192C	Treva M. Burris
M	6/75.3	P7192C	Chester Lee Smith
M	6/75.3	P7192C	Lori J. Smith
M	6/75.3	P7192C	William, T. Smith
M	6/75.3	P7192C	Michael L. Bates
M	6/75.3	P7192C	Joann Smith
M	6/75.3	P7192C	Richard E. Dutton
M	6/75.3	P7192C	Carol J. McAlhaneay
M	6/75.3	P7192C	Glenda M. Morgan
M	6/75.3	P7192C	Jerry L. Morgan
M	6/75.3	P7192C	Mark W. Bates
M	6/75.3	P7192C	Connie L. Brown
M	6/75.3	P7192C	Pat Allen Bates
M	6/75.3	P7192C	Howard Raymond
M	6/75.3	P7192C	Max Bates
M	6/75.3	P7192C	Patty L. Smith Cox
M	6/75.3	P7192C	Mary R. Smith
M	6/75.3	P7192C	Lisa A. Debban
M	6/75.3	P7192C	Isaac E. Washington
M	6/75.3	P7192C	Cheyenne Washington
M	6/75.3	P7192C	Betty Jean Bailey
M	6/75.3	P7192C	Kathryn R. Myers
M	6/75.3	P7192C	Constance "Connie" Morgan Eneboe
M	6/75.3	P7192C	Cheryl Ann Patrick
M	6/75.3	P7192C	Betty J. Cottle
M	6/75.3	P7192C	James Oscar Smith Jr.
M	6/75.3	P7192C	Jerry Ellis
M	6/75.3	P7192C	Pamela Kyle
M	6/75.3	P7192C	Joseph Ellis
M	6/75.3	P7192C	James A. Daily
M	6/75.3	P7192C	Carl Edward Smith
M	6/75.3	P7192C	Carol Sue Cooke Family Trust
M	6/75.3	P7192C	Timothy S. Myers
M	6/75.3	P7192C	Richard Marcus Marshall
M	6/75.3	P7192C	Samuel W. Marshall
M	6/75.3	P7192C	Leroy P. Stanford
M	6/75.3	P7192C	Elaine Stanford
M	6/75.3	P7192C	Robert H. Goss Marital Trust
M	6/75.3	P7192C	Clifford William Smith, Jr.
M	6/75.3	P7192C	Mario Griego
M	6/75.3	P7192C	Juliann Marie Brooks
M	6/75.3	P7192C	Sasha N. Van Roy
M	6/75.3	P7192C	Jay-Bee Royalty, LLC
M	6/75.3	P7192C	Jay-Bee Royalty, LLC
M	6/75.3	P7192C	Jay-Bee Royalty, LLC
M	6/75.3	P7192C	Jay-Bee Royalty, LLC
M	6/75.3	P7192C	Leased by Special Commissioner Judith McCullough on 3/228/18 DB 322/164 Civil Action Number 17-P-30
M	6/75.3	P7192C	Tamitha M Beasley
M	6/75.3	P7192C	Shannon Irene, Hudson
M	6/75.3	P7192C	Kaylene S Polly
M	6/75.3	P7192C	Lulu Smith
M	6/75.3	P7192C	Homer W. Smith
M	6/75.3	P7192C	Kenneth Douglas Smith
M	6/75.3	P7192C	Pamela Sue Smith
M	6/75.3	P7192C	Fred DeWayn Stanford
M	6/75.3	P7192C	Heirs of Arthur P. Smith
N	6/75	P7192	Jack E. Renner
N	6/75	P7192	Jack E. Renner & Hilda M Renner
O	6/95	P7092	BB Land LLC
O	6/95	P7092	Ridgetop Capital IV LP
P	6/78.1	P7188C	Mr. and Mrs. Stephen E. Grose & Amy Jo Grose
Q	6/78.6	P7188	Culpepper Cattle Company
R	6/78	P7188D	Ronald D. Tucker
S	6/78.5	P7188	Culpepper Cattle Company
T	6/78.2	P7188B	Harold J. Edna I. Kimball
U	6/78.3	P7188	Miranda L. Bunne
V	6/78.4	P7188A	Barron Kidd
W	6/95.1	P7092	BB Land LLC
W	6/95.1	P7092	Ridgetop Capital IV LP
X	6/77	P7192B	William & Anelle Edwards
Y	6/76.1	P7075A	Ridgetop Capital IV LP
Y	6/76.1	P7075A	BB Land, LLC
Z	6/76.2	P7075A	Ridgetop Capital IV LP
Z	6/76.2	P7075A	BB Land, LLC
AA	6/76.3	P7075A	Ridgetop Capital IV LP
AA	6/76.3	P7075A	BB Land, LLC
BB	6/76	P7075A	Ridgetop Capital IV LP
BB	6/76	P7075A	BB Land, LLC
CC	6/46	P7075	BB Land LLC
CC	6/46	P7075	Donald James Wagner
CC	6/46	P7075	Marshall R. Satterfield
CC	6/46	P7075	Ridgetop Capital IV LP
DD	6/46.3	P7075A	BB Land, LLC
DD	6/46.3	P7075A	Ridgetop Capital IV LP
EE	6/47	P7075	BB Land LLC
EE	6/47	P7075	Donald James Wagner
EE	6/47	P7075	Marshall R. Satterfield
EE	6/47	P7075	Ridgetop Capital IV LP
FF	6/34	P7184	Pamela Fucy
GG	6/45	P7185	James Renne
GG	6/45	P7185	Lenora Renner
HH	6/28	P7180	Jodi L. Green
HH	6/28	P7180	William D. Payne
II	6/19	P7181A	Barron Kidd
II	6/19	P7181A	Ralph/Chad Northcraft & c/o Brian Northcraft
II	6/19	P7181A	Trio Petroleum Corp - Waco Oil and Gas
JJ	6/29	P7181B	Trio Petroleum Corp - Waco Oil and Gas
KK	6/18	P7181	Ralph/Chad Northcraft & c/o Brian Northcraft
KK	6/18	P7181	Trio Petroleum Corp - Waco Oil and Gas



P.S. 708 *David L Jackson*

06/18/2021



Jay Bee Oil & Gas  
**DRILLING**  
into the future

OPERATOR'S  
WELL #: P4N2U - 02578  
DISTRICT: UNION  
COUNTY: PLEASANTS  
STATE: WV

WELL PLAT  
PAGE 5 OF 5  
DATE: 06/29/2020