



RECEIVED

MAR 25 1981

STATE OF WEST VIRGINIA
DEPARTMENT OF MINES

OIL & GAS DIVISION
DEPT. OF MINES

Oil and Gas Division

OIL AND GAS WELL PERMIT APPLICATION

TO THE DEPARTMENT OF MINES,
Charleston, W. Va.

DATE March 24, 1981
Company Big Injun Drilling Corp.
Address 225 Putnam St., Marietta, Ohio
Farm Leroy Templeton Acres 50
Location (waters) Waters of French Creek
Well No. #1 Elevation 1098
District Jefferson County Pleasants
Quadrangle Schultz

Surface Owner Leroy & Rebecca M. Templeton
Address Rt. #2, Box 142, St. Marys, W.Va.
Mineral Owner Leroy & Rebecca M. Templeton
Address Rt. #2, Box 142, St. Marys, W.Va.
Coal Owner _____
Address _____
Coal Operator _____
Address _____

THIS PERMIT MUST BE POSTED AT THE WELL SITE

All provisions being in accordance with Chapter 22, of the W. Va. Code, the location is hereby approved for drilling. This permit shall expire if operations have not commenced by 12-14-81.

INSPECTOR TO BE NOTIFIED Phillip L. Tracy
Rt. #3
ADDRESS Alma, W. Va. 26320
PHONE 758-4573

J. E. Huggins
Deputy Director - Oil & Gas Division

GENTLEMEN:

The undersigned well operator is entitled to drill upon the above named farm or tract of land for oil and gas, having fee title thereto, (or as the case may be) under grant or lease dated March 16, 1981 by Leroy & Rebecca M. Templeton made to Big Injun Drilling Corp. and recorded on the 16 day of March 1981, in Pleasants County, Book 161 Page 698

NEW WELL _____ DRILL DEEPER _____ REDRILL _____ FRACTURE OR STIMULATE
_____ OIL AND GAS WELL ORIGINALLY DRILLED BEFORE JUNE 5, 1969.

The enclosed plat was prepared by a registered engineer or licensed land surveyor and all coal owners and/or operators have been notified as of the above date.

The above named coal owners and/or operator are hereby notified that any objection they wish to make, or are required to make by Section 3 of the Code, must be received by, or filed with the Department of Mines within ten (10) days. *

Copies of this notice and the enclosed plat were mailed by registered mail, or delivered to the above named coal operators or coal owners at their above shown respective address _____ day _____ before, or on the same day with the mailing or delivery of this copy to the Department of Mines at Charleston, West Virginia.

PLEASE SUBMIT COPIES OF ALL GEOPHYSICAL LOGS DIRECTLY TO:

WEST VIRGINIA GEOLOGICAL AND ECONOMIC SURVEY
P. O. BOX 879
MORGANTOWN, WEST VIRGINIA 26505
AC-304 - 292-6331

Very truly yours,
(Sign Name) Big Injun Drilling Corp.
Well Operator
225 Putnam Street
Street
Marietta
City or Town
Ohio 45750
State

Address of Well Operator

47-073-1167

PERMIT NUMBER

"I have read and understand the reclamation requirements as set forth in Chapter 22, Article 4, Section 12-b and will carry out the specified requirements."

Signed by D. B. Coleman

BLANKET BOND

THIS IS AN ESTIMATE ONLY
ACTUAL INFORMATION WILL BE SUBMITTED ON OG-10 UPON COMPLETION

PROPOSED WORK ORDER TO X DRILL _____ DEEPEN _____ FRACTURE-STIMULATE _____
 DRILLING CONTRACTOR: (If Known) _____ RESPONSIBLE AGENT: _____
 NAME Big Injun Drilling Corp. NAME D. R. Higgins
 ADDRESS 225 Putnam St., Marietta, Ohio ADDRESS Route 1, Box 221, St. Marys, W. Va.
 TELEPHONE 614-373-4463 TELEPHONE 304-684-26170
 ESTIMATED DEPTH OF COMPLETED WELL: 4,400' ROTARY _____ CABLE TOOLS X
 PROPOSED GEOLOGICAL FORMATION: Ohio Shale
 TYPE OF WELL: OIL _____ GAS _____ COMB. X STORAGE _____ DISPOSAL _____
 RECYCLING _____ WATER FLOOD _____ OTHER _____

TENTATIVE CASING PROGRAM:

CASING AND TUBING SIZE	USED FOR DRILLING	LEFT IN WELL	CEMENT FILL UP OR SACKS - CUBIC FT.
20 - 16			
13 - 10 300'		300	Cement to surface
9 - 5/8			
8 - 5/8 950'		950	CTS
7 1,800'			
5 1/2			Rule 1501
4 1/2		4400	440 Sks
3			Perf. Top
2			Perf. Bottom
Liners			Perf. Top
			Perf. Bottom

APPROXIMATE FRESH WATER DEPTHS 200 FEET _____ SALT WATER 1,500 FEET _____
 APPROXIMATE COAL DEPTHS Unknown
 IS COAL BEING MINED IN THE AREA? _____ BY WHOM? _____

TO DRILL:
 SUBMIT FIVE (5) COPIES OF OG - 1, \$100.00 PERMIT FEE, PERFORMANCE BOND AND PERMANENT COPY OF PLAT.

TO DRILL DEEPER OR REDRILL:
 SUBMIT FIVE (5) COPIES OF OG - 1, SHOWING ORIGINAL PERMIT NUMBER AND PERFORMANCE BOND. ON WELLS DRILLED PRIOR TO 1929, A PERMANENT COPY OF THE PLAT AND THE ORIGINAL WELL RECORD MUST ALSO BE SUBMITTED.

TO FRACTURE - STIMULATE:
 OIL AND/OR GAS WELL ORIGINALLY DRILLED BEFORE JUNE 5, 1929, FIVE (5) COPIES OG - 1, PERFORMANCE BOND, PERMANENT PLAT AND ORIGINAL WELL RECORD.
 OIL AND/OR GAS WELL ORIGINALLY DRILLED ON AND/OR AFTER JUNE 5, 1929, FIVE COPIES OG - 1, SHOWING ORIGINAL PERMIT NUMBER, AND PERFORMANCE BOND.
 Required forms must be filed within ninety (90) days of completion for bond release. Inspector to be notified twenty-four (24) hours in advance.

The following waiver must be completed by the coal operator if the permit is to be issued within ten days of receipt thereof.

WAIVER: I the undersigned, Agent for _____ Coal Company, Owner or Operator of the coal under this lease have examined and place on our mine maps this proposed well location.
 We the _____ Coal Company have no objections to said well being drilled at this location, providing operator has complied with all rules and regulations in Articles 4, 5, and 7, Chapter 22 of the West Virginia Code.

 For Coal Company

 Official Title

Well Site Plan

- Legend:
- Property Boundry
 - Road
 - Existing Fence
 - Planned Fence
 - Stream
 - Open Ditch
 - Diversion
 - Spring
 - Wet Spot
 - Building
 - Drain Pipe
 - Waterway

Sketch to include well location, existing access road, roads to be constructed, wellsite, drilling pits and necessary structures numbered or lettered to correspond with first part of this plan. Include all natural drainage.

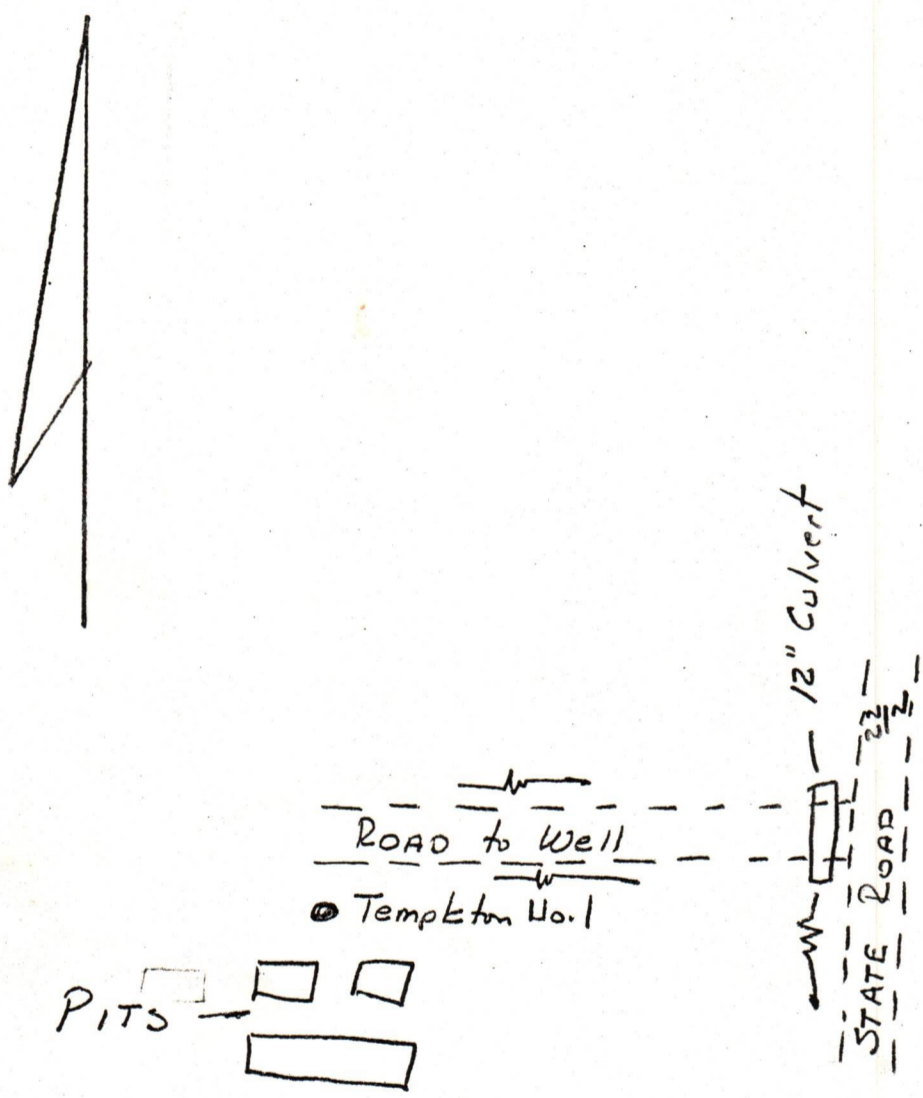

Comments: Access road 10% . Location is in an old field, no clearing is necessary.

Signature: Don B Coleman Rt #3 Stockport, Ohio 614-749-3209
Agent Address Phone

Please request landowners cooperation to protect new seeding for one growing season.

#426

Date March 16, 19 81
Well No. #1
API No. 47 - 073 - 1167-DD
State County Permit

STATE OF WEST VIRGINIA
OFFICE OF OIL AND GAS

Company Name Big Injun Drilling Corp. Designated Agent D. R. Higgins
Address 225 Putnam St., Marietta, O. Address Route 1, Box 221, St. Marys, W.V.
Telephone 614-373-4463 Telephone 304-684-7587
Landowner Leroy & Rebecca M. Templeton Soil Cons. District Upper Ohio

Revegetation to be carried out by U.D.S.C.D. (Agent)

This plan has been reviewed by Upper Ohio SCD. All corrections
and additions become a part of this plan. 3/16/81 Kenneth R. Flann
(Date) (SCD Agent)

Access Road		Location	
Structure	<u>N/A</u> (A)	Structure	<u>N/A</u> (1)
Spacing	_____	Material	_____
Page Ref. Manual	_____	Page Ref. Manual	_____
Structure	_____ (B)	Structure	_____ (2)
Spacing	_____	Material	_____
Page Ref. Manual	_____	Page Ref. Manual	_____
Structure	_____ (C)	Structure	_____ (3)
Spacing	_____	Material	_____
Page Ref. Manual	_____	Page Ref. Manual	_____

RECEIVED

All structures should be inspected regularly and repaired if necessary. MAR 25 1981

Revegetation

Treatment Area I

Lime _____ Tons/acre
or correct to pH 6.5

Fertilizer 500 lbs/acre
(10-20-20 or equivalent)

Mulch two Tons/Acre

Seed* Kg 31 30 lbs/acre
Red Top 10 lbs/acre
_____ lbs/acre

Treatment Area II OIL & GAS DIVISION
DEPT. OF MINES

Lime _____ Tons/Acre
or correct to pH _____

Fertilizer _____ lbs/acre
(10-20-20 or equivalent)

Mulch _____ Tons/Acre

Seed* _____ lbs/acre
_____ lbs/acre
_____ lbs/acre

*Inoculate all legumes such as vetch, trefoil and clovers with the proper bacterium. Inoculate with 3X recommended amount.

Attach or photocopy section of involved Topographic map. Quadrangle Schultz



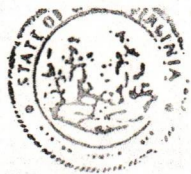

STATE OF WEST VIRGINIA
OFFICE OF OIL AND GAS - DEPARTMENT OF MINES

OIL AND GAS WELL PERMIT APPLICATION

WELL TYPE: Oil X / Gas X /

(If "Gas", Production ___ / Underground storage ___ / Deep ___ / Shallow ___ /

LOCATION: Elevation: 1098 Watershed: Waters of French Creek
District: Jefferson County: Pleasants Quadrangle: Schultz

WELL OPERATOR Big Injun Drilling Corp.
Address 225 Putnam St.
Marietta, Ohio 45750

DESIGNATED AGENT D. R. Higgins
Address Route 1, Box 221
St. Marys, W. Va.

OIL AND GAS ROYALTY OWNER Leroy & Rebecca M. Templeton
Address Rt. #2, Box 142
St. Marys, W. Va.
Acreage 50

COAL OPERATOR N/A
Address _____

SURFACE OWNER Leroy & Rebecca M. Templeton
Address Rt. #2, Box 142
St. Marys, W. Va.
Acreage 50

COAL OWNER(S) WITH DECLARATION ON RECORD:
NAME N/A
Address _____

FIELD SALE (IF MADE) TO:
NAME _____
Address _____

NAME _____
Address _____

COAL LESSEE WITH DECLARATION ON RECORD:
NAME _____
Address _____

OIL AND GAS INSPECTOR TO BE NOTIFIED:

NAME Phillip L. Tracy
Address Rt. #3
Alma, W. Va. 26320
Telephone 758-4573

RECEIVED

MAR 05 1982

OIL AND GAS DIVISION
WV DEPARTMENT OF MINES

The undersigned well operator is entitled to operate for oil or gas purposes at the above location under a deed ___ / lease X / other contract ___ / dated Mar. 16, 1981, to the undersigned well operator from Leroy & Rebecca M. Templeton.

(If said deed, lease, or other contract has been recorded:)

Recorded on March 16, , 1981, in the office of the Clerk of County Commission of Pleasants County, West Virginia, in 161 Book at page 698. A permit is requested as follows:

PROPOSED WORK: Drill ___ / Drill Deeper X / Redrill ___ / Fracture or stimulate ___ / Plug off old formation ___ / Perforate new formation ___ / Other physical change in well (specify) _____

--planned as shown on the work order on the reverse side hereof.

The above named coal operator, coal owner(s), and coal lessee are hereby notified that any objection they wish to make or are required to make by Code §22-4-3 must be filed with the Department of Mines within fifteen (15) days after receipt of this Application by the Dept. Copies of this Permit Application and the enclosed plat and reclamation plan have been mailed by registered mail or delivered by hand to the above named coal operator, coal owner(s), and coal lessees on or before the day of the mailing or delivery of this Application to the Department of Mines at Charleston, West Virginia.

PLEASE SUBMIT COPIES OF ALL GEOPHYSICAL LOGS DIRECTLY TO:
WEST VIRGINIA OIL AND GAS CONSERVATION COMMISSION
1613 WASHINGTON ST., E.
CHARLESTON, WV 25311
Telephone - 304/348-3092

Big Injun Drilling Corp.
Well Operator

By: Don B. Coleman

Its: Vice President

(Revised 3-81)

PROPOSED WORK ORDER

THIS IS AN ESTIMATE ONLY:
ACTUAL INFORMATION MUST BE SUBMITTED ON FORM IV-35 UPON COMPLETION

DRILLING CONTRACTOR (IF KNOWN) Big Injun Drilling Corp.
Address 225 Putnam St.
Marietta, Ohio 45750

GEOLOGICAL TARGET FORMATION Ohio Shale ✓
Estimated depth of completed well 5,200 feet. Rotary / Cable tools X /
Approximate water strata depths: Fresh, 200 feet; salt, 1500 feet.
Approximate coal seam depths: N/A
Is coal being mined in this area: Yes / No X /

CASING AND TUBING PROGRAM

CASING OR TUBING TYPE	SPECIFICATIONS				FOOTAGE INTERVALS		CEMENT FILL UP OR SACKS Cubic ft.	PACKERS
	Size	Grade	Weight per ft	New	Used	For Drill-ling		
Conductor	10"							Kinds
Fresh water	10"						300'	Cemented to surface
Coal	8 5/8"					950'		Sizes
Intermed.	7"					1800'		Rule 15.01
Production	4 1/2"						5200'	440 Sacks
Tubing								Depths set
Liners								Perforations:
								Top Bottom

NOTE: Regulation 7.02 of the Department of Mines provides that the original and four copies of Form IV-2 must be filed with the Department, accompanied by (i) a plat in the form prescribed by Regulation 11, (ii) a bond in one of the forms prescribed by Regulation 12, or in lieu thereof the other security allowed by Code §22-4-2, (iii) Form IV-9, "Reclamation Plan" applicable to the reclamation required by Code §22-4-12b and Regulation 23, (iv) unless previously paid on the same well, the fee required by Code §22-4-12a, and (v) if applicable, the consent required by Code §22-4-8a from the owner of any water well or dwelling within 200 feet of the proposed well.
A separate Form IV-2 shall not be required for fracturing or stimulating a well where fracturing or stimulating is to be part of the work for which a permit is sought and is noted as such on the Form IV-2 filed in connection therewith.

THIS PERMIT MUST BE POSTED AT THE WELL SITE.
ALL PROVISIONS BEING IN ACCORDANCE WITH CHAPTER 22,
ARTICLE 4 OF THE W. VA. CODE, THE LOCATION IS HEREBY
APPROVED FOR deepening THIS PERMIT SHALL EXPIRE
IF OPERATIONS HAVE NOT COMMENCED BY 11-15-82
BY [Signature]

The following waiver must be completed by the coal operator and by any coal owner or coal lessee who has recorded a declaration under Code §22-4-20, if the permit is to be issued within fifteen (15) days of receipt thereof:

W A I V E R

The undersigned coal operator / owner / lessee / of the coal under this well location has examined this proposed well location. If a mine map exists which covers the area of the well location, the well location has been added to the mine map. The undersigned has no objection to the work proposed to be done at this location, provided the well operator has complied with all applicable requirements of the West Virginia Code and the governing regularions.

Date: , 19 .
By:
Its:

DETAILS OF PERFORATED INTERVALS, FRACTURING OR STIMULATING, PHYSICAL CHANGE, ETC.

4290 to 4300 4 Shots per Foot

4326 to 4330 4 Shots per Foot

Fraced W/850 SFC of N2

WELL LOG

FORMATION	COLOR	HARD OR SOFT	TOP FEET	BOTTOM FEET	REMARKS Including indication of all fresh and salt water, coal, oil and gas
Top Soil			0	10	
Sand Rock			10	30	
Blue			30	49	
Red Rock			49	62	Water 62 Feet
Gray			62	73	Show Oil 1820-1830
Red Rock			73	138	Water 1832
Slate & Shews			138	380	
Red Rock			380	428	
Gray			428	465	Very slight show oil 2790
Red Rock			465	512	Slight show gas 2940
Sand			512	552	
Shale			552	568	
Sand <i>1st Cow Run</i>			568	610	
Red Rock			610	652	
Sand <i>2nd Cow Run</i>			652	660	
Gray Shale			660	808	
Red Rock			808	850	
Red Shale			850	1110	
Sand <i>1st Salt</i>			1110	1160	
Shale			1160	1423	
Sand <i>2nd Salt</i>			1423	1538	
Shale			1538	1565	
Sand <i>3rd Salt</i>			1565	1624	
Shale			1624	1645	
Sand			1645	1700	
Shale			1700	1735	
Sand			1735	1767	
Shale			1767	1822	
Sand <i>MAXTON</i>			1822	1885	
Shale			1885	1910	
Sand & Lime <i>Maener</i>			1910	1947	
Sand <i>Big INJUN</i>			1947	2060	
Shale			2060	2450	
Sand <i>Berea</i>			2450	2456	
Shale			2456	2770	
Gordon			2770	2799	
Limy Shale			2799	4996	

Riley 4290-4330

(Attach separate sheets as necessary)

Big Injun Drilling Corp.

Well Operator

By: *Don B. Coleman Vice Pres.*

Date: *10-31-84*

Note: Regulation 2.02(i) provides as follows:
 "The term 'log' or 'well log' shall mean a systematic detailed geological record of all formations, including coal, encountered in the drilling of a well."



RECEIVED
JAN 2 - 1985

State of West Virginia
Department of Mines
Oil and Gas Division
Charleston 25305

OIL & GAS DIVISION
DEPT. OF MINES

FINAL INSPECTION REPORT
INSPECTORS COMPLIANCE REPORT
November 30, 1984

COMPANY Big Injun Drilling Corp.
225 Putnam Street
Marietta, Ohio 45750

PERMIT NO 073-1167
FARM & WELL NO Leroy Templeton #1
DIST. & COUNTY Jefferson/Pleasants

RULE	DESCRIPTION	IN COMPLIANCE	
		YES	NO
23.06	Notification Prior to Starting Work	<input checked="" type="checkbox"/>	<input type="checkbox"/>
25.04	Prepared before Drilling to Prevent Waste	<input checked="" type="checkbox"/>	<input type="checkbox"/>
25.03	High-Pressure Drilling	<input checked="" type="checkbox"/>	<input type="checkbox"/>
16.01	Required Permits at Wellsite	<input checked="" type="checkbox"/>	<input type="checkbox"/>
15.03	Adequate Fresh Water Casing	<input checked="" type="checkbox"/>	<input type="checkbox"/>
15.02	Adequate Coal Casing	<input checked="" type="checkbox"/>	<input type="checkbox"/>
15.01	Adequate Production Casing	<input checked="" type="checkbox"/>	<input type="checkbox"/>
15.04	Adequate Cement Strenght	<input checked="" type="checkbox"/>	<input type="checkbox"/>
15.05	Cement Type	<input checked="" type="checkbox"/>	<input type="checkbox"/>
23.02	Maintained Access Roads	<input checked="" type="checkbox"/>	<input type="checkbox"/>
25.01	Necessary Equipment to Prevent Waste	<input checked="" type="checkbox"/>	<input type="checkbox"/>
23.04	Reclaimed Drilling Pits	<input checked="" type="checkbox"/>	<input type="checkbox"/>
23.05	No Surface or Underground Pollution	<input checked="" type="checkbox"/>	<input type="checkbox"/>
23.07	Requirements for Production & Gathering Pipelines	<input checked="" type="checkbox"/>	<input type="checkbox"/>
16.01	Well Records on Site	<input checked="" type="checkbox"/>	<input type="checkbox"/>
16.02	Well Records Filed	<input checked="" type="checkbox"/>	<input type="checkbox"/>
7.05	Identification Markings	<input checked="" type="checkbox"/>	<input type="checkbox"/>

I HAVE INSPECTED THE ABOVE CAPTIONED WELL AND RECOMMEND THAT IT BE RELEASED:

SIGNED R.A. Lowther
DATE Dec 28, 1984

Your well record was received and reclamation requirements approved. In accordance with Chapter 22, Article 4, Section 2, the above well will remain under bond coverage for the life of the well.

T.L. [Signature]
Administrator-Oil & Gas Division

January 23, 1985

DATE

SEP 14 1983

<p>1.0 API well number: (If not available, leave blank. 14 digits.)</p>	<p><u>47-073-1167</u></p>															
<p>2.0 Type of determination being sought: (Use the codes found on the front of this form.)</p>	<p><u>103</u> Section of NGPA</p> <p style="text-align: right;">OIL & GAS DIVISION DEPT. OF MINES Category Code</p>															
<p>3.0 Depth of the deepest completion location: (Only needed if sections 103 or 107 in 2.0 above.)</p>	<p><u>4,995</u> feet</p>															
<p>4.0 Name, address and code number of applicant: (35 letters per line maximum. If code number not available, leave blank.)</p>	<p><u>Big Spring Drilling Corp</u> Seller Code _____ <u>225 Putnam St.</u> Street <u>Marion</u> <u>Ohio</u> <u>45750</u> City State Zip Code</p>															
<p>5.0 Location of this well: [Complete (a) or (b).] (a) For onshore wells (35 letters maximum for field name.)</p>	<p><u>French Creek</u> Field Name <u>Pleasant</u> <u>W. Va.</u> County State</p>															
<p>(b) For OCS wells:</p>	<p>Area Name _____ Block Number _____ Date of Lease: _____ Mo. Day Yr. OCS Lease Number _____</p>															
<p>(c) Name and identification number of this well: (35 letters and digits maximum.)</p>	<p><u>Leroy Templeton #1</u></p>															
<p>(d) If code 4 or 5 in 2.0 above, name of the reservoir: (35 letters maximum.)</p>	<p><u>Riley</u></p>															
<p>6.0 (a) Name and code number of the purchaser: (35 letters and digits maximum. If code number not available, leave blank.)</p>	<p><u>Consolidated Gas</u> Buyer Code _____ Name</p>															
<p>(b) Date of the contract:</p>	<p>_____ Mo. Day Yr.</p>															
<p>(c) Estimated annual production:</p>	<p>_____ MMcf.</p>															
<p>7.0 Contract price: (As of filing date. Complete to 3 decimal places.)</p>	<table border="1" style="width:100%; border-collapse: collapse;"> <thead> <tr> <th style="width:25%;"></th> <th style="width:25%;">(a) Base Price (\$/MMBTU)</th> <th style="width:25%;">(b) Tax</th> <th style="width:25%;">(c) All Other Prices [Indicate (+) or (-).]</th> <th style="width:25%;">(d) Total of (a), (b) and (c)</th> </tr> </thead> <tbody> <tr> <td>7.0 Contract price:</td> <td style="text-align: center;">---</td> <td style="text-align: center;">---</td> <td style="text-align: center;">---</td> <td style="text-align: center;">---</td> </tr> <tr> <td>8.0 Maximum lawful rate:</td> <td style="text-align: center;">---</td> <td style="text-align: center;">---</td> <td style="text-align: center;">---</td> <td style="text-align: center;">---</td> </tr> </tbody> </table>		(a) Base Price (\$/MMBTU)	(b) Tax	(c) All Other Prices [Indicate (+) or (-).]	(d) Total of (a), (b) and (c)	7.0 Contract price:	---	---	---	---	8.0 Maximum lawful rate:	---	---	---	---
	(a) Base Price (\$/MMBTU)	(b) Tax	(c) All Other Prices [Indicate (+) or (-).]	(d) Total of (a), (b) and (c)												
7.0 Contract price:	---	---	---	---												
8.0 Maximum lawful rate:	---	---	---	---												
<p>8.0 Maximum lawful rate: (As of filing date. Complete to 3 decimal places.)</p>	<table border="1" style="width:100%; border-collapse: collapse;"> <thead> <tr> <th style="width:25%;"></th> <th style="width:25%;">(a) Base Price (\$/MMBTU)</th> <th style="width:25%;">(b) Tax</th> <th style="width:25%;">(c) All Other Prices [Indicate (+) or (-).]</th> <th style="width:25%;">(d) Total of (a), (b) and (c)</th> </tr> </thead> <tbody> <tr> <td>8.0 Maximum lawful rate:</td> <td style="text-align: center;">---</td> <td style="text-align: center;">---</td> <td style="text-align: center;">---</td> <td style="text-align: center;">---</td> </tr> </tbody> </table>		(a) Base Price (\$/MMBTU)	(b) Tax	(c) All Other Prices [Indicate (+) or (-).]	(d) Total of (a), (b) and (c)	8.0 Maximum lawful rate:	---	---	---	---					
	(a) Base Price (\$/MMBTU)	(b) Tax	(c) All Other Prices [Indicate (+) or (-).]	(d) Total of (a), (b) and (c)												
8.0 Maximum lawful rate:	---	---	---	---												
<p>9.0 Person responsible for this application:</p>	<p><u>Don B. Coleman</u> <u>Vice Pres.</u> Name Title <u>Don B. Coleman</u> Signature <u>7-30-82</u> <u>614-373-4463</u> Date Application is Completed Phone Number</p>															

Agency Use Only
Date Received by Jurisdictional Agency
SEP 14 1983
Date Received by FERC

PARTICIPANTS:

DATE: DEC 1 1983

BUYER-SELLER CODE

WELL OPERATOR: Big Injun Drilling Corp.

FIRST PURCHASER: Consolidated Gas

004228

OTHER: _____

W. Va. Department of Mines, Oil & Gas Division
 WELL DETERMINATION FILE NUMBER
830914-103-073-1167
 Use Above File Number on all Communications
 Relating to Determination of this Well

~~Defunct Well~~
~~* BHP calculations not shown~~
~~* 22486 Formations not listed by name~~

QUALIFIED

CHECK EACH ITEM AS COMPLETE OR NOTE WHAT IS MISSING

ITEM NO.

- 1. FERC -121 Items not completed - Line No. 7.0 + 8.0 All
- 2. IV-1 Agent D. R. Higgins
- 3. IV-2 Well Permit _____
- 4. IV-6 Well Plat
- 5. IV-35 Well Record Drilling Deepening
- 6. IV-36 Gas-Oil Test: Gas Only Was Oil Produced? Ratio
- 7. IV-39 Annual Production _____ years
- 8. IV-40 90 day Production _____ Days off line: _____
- 9. IV-48 Application for certification. Complete?
- 10-17. IV Form 51 - 52 - 53 - (54) - 55 - 56 - 57 - 58 Complete? Affidavit Signed
- 18-28. Other: Survey _____ Logs _____ Geological Charts _____
 Structure Map _____ 1: 4000 Map _____ Well Tabulations _____
 Gas Analyses _____
- (5) Date commenced: 8-6-81 Date completed 3-22-82 Deepened
- (5) Production Depth: 4290-4330
- (5) Production Formation: Riley
- (5) Final Open Flow: 728 MCF
- (5) After Frac. R. P. 1120# 72 hrs.
- (6) Other Gas Test: _____
- (7) Avg. Daily Gas from Annual Production: _____
- (8) Avg. Daily Gas from 90-day ending w/1-120 days _____
- (8) Line Pressure: _____ PSIG from Daily Report _____
- (5) Oil Production: _____ From Completion Report _____
- 10-17. Does lease inventory indicate enhanced recovery being done NO
- 10-17. Is affidavit signed? Notarized?
- Does official well record with the Department confirm the submitted information? yes
- Additional information _____ Does computer program confirm? _____
- Was Determination Objected to _____ By Whom? _____

STATE OF WEST VIRGINIA
DEPARTMENT OF MINES, OIL AND GAS DIVISION

Date 7-30, 1982

Operator's #
Well # 1

API Well
No. 47 - 073 - 1167
State County Permit

STATE APPLICATION FOR WELL CLASSIFICATION

Previous File No. (If Applicable)

WELL OPERATOR Big Texan Drilling Corp.
ADDRESS 225 Putnam St.
Marietta, Ohio 45750

DESIGNATED AGENT D. B. Higgins
ADDRESS Route #1 Box 231
St. Marys W. Va. 26170

Gas Purchase Contract No. _____ and Date _____
Meter Chart Code _____ (Month, day and year)

Name of First Purchaser Consolidated Gas
445 West Main St.
(Street or P. O. Box)
Clarksburg W. Va.
(City) (State) 26301
(Zip Code)

FERC Seller Code _____ FERC Buyer Code _____

TYPE OF DETERMINATION BEING SOUGHT:

- (1) Initial determination (See FERC Form 121.) 103 Section of NGPA Category Code _____
- (2) Determination that increased production is the result of enhanced recovery technology.
- (3) Determination of a seasonally affected well.

Don B. Coleman _____
Name (Print) Title

Don B. Coleman
Signature

Route #3
Street or P. O. Box

Stockport, Ohio 45787
City State (Zip Code)

(614) 749-3209
Area Phone Number
Code

(Certificate of Proof of Service to Purchaser)

(All of the above to be completed by the Operator/Applicant)

(To be completed by Jurisdictional Agency. Executed copy to be returned to Operator/Applicant and purchaser, if known).

The Department of Mines has received a request, for certification of the above described well as meeting the requirements of Section _____ under the Natural Gas Policy Act of 1976 (NGPA); or for determination that increased production is the result of enhanced recovery technology under Section 103 of (NGPA); or for determination of a seasonally affected well under Section 105 of (NGPA).

All interested parties are hereby notified that on the _____ day of _____, 19____ at the office of the Oil and Gas Division in Charleston, West Virginia, or as soon thereafter as it may be heard, there will be a public hearing, if requested, or if objection is filed.

This Application is assigned File No. _____

Initial review of information submitted indicates the well is, is not entitled to certification as claimed under the Natural Gas Policy Act (NGPA). A review of this evidence and any additional evidence will be made at the time appointed for a public hearing or as soon thereafter as the matter may be heard.

Unless objections are timely filed or a request for a hearing is made within fifteen (15) days, a hearing will not be held except on ex parte motion of the department and the matter will go to determination.

WEST VIRGINIA DEPARTMENT OF MINES

SEP 14 1983

[Signature]
Director

Date received by
Jurisdictional Agency _____

By _____
Title _____

STATE OF WEST VIRGINIA
DEPARTMENT OF MINES, OIL AND GAS DIVISION

Date 7-30 1982

Operator's Well No. #1

API Well No. 47 - 073 - 1167
State County Permit

WELL CLASSIFICATION FORM
NEW ONSHORE PRODUCTION WELL

NGPA Section 103

DESIGNATED AGENT D. R. Higgins

ADDRESS Route # 1 Box 221
St. Marys W. Va. 26190

WELL OPERATOR Big Injun Drilling Corp.

LOCATION: Elevation 1098

ADDRESS 225 Putnam St.

Watershed Waters of French Creek

Marion, Ohio 45750

Dist. Jefferson County Pleasants Quad. Schultz

GAS PURCHASER Consolidated Gas

Gas Purchase Contract No. _____

ADDRESS 445 West Main St.

Meter Chart Code _____

Clarksburg, W. Va. 26301

Date of Contract _____

* * * * *

Date surface drilling was begun: 8-6-81

Indicate the bottom hole pressure of the well and explain how this was calculated:

Bottom hole pressure: 1862#

This is calculated by taking the depth of the bottom perforation and multiplying it by a rock radient factor of .43.

AFFIDAVIT

I, Don B. Coleman, having been first sworn according to law state that surface drilling of the well for which this determination is sought was begun on or after February 19, 1977; the well satisfies applicable state or federal well spacing requirements and the well is not within a proration unit, in existence at the time surface drilling began, which was applicable to the reservoir from which gas is or will be produced and which applied to any other well producing gas in commercial quantities or on which surface drilling began on or after February 19, 1977, and which was capable of producing gas in commercial quantities. I state, further, that I have concluded, to the best of my information, knowledge and belief, that the well for which this determination is sought is a new onshore production well and that I am not aware of any information not described in the application which is inconsistent with this conclusion.

Don B. Coleman

^{OHIO}
STATE OF ~~WEST VIRGINIA~~,

COUNTY OF WASHINGTON, TO WIT:

I, Michael L Miller, a Notary Public in and for the state and county aforesaid, do certify that Don B. Coleman, whose name is signed to the writing above, bearing date the 30 day of JULY, 1982, has acknowledged the same before me, in my county aforesaid.

Given under my hand and official seal this 30 day of JULY, 1982.

My term of office expires on the 05 day of JUNE, 1986.

Michael L Miller
Notary Public



dr 9/12

39°20' 8900'

W. VA. PULP & PAPER

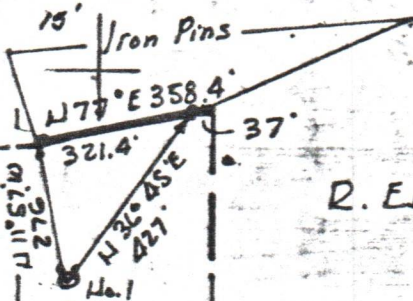

R. EDDY

E. SCADDELL

E. WAGNER

J. SCADDELL

- FRACTURE
- REDRILL
- NEW LOCATION...
- DRILL DEEPER
- ABANDONMENT.....

Source of Elevation USGS

I, the undersigned, hereby certify that this map is correct to the best of my knowledge and belief and shows all the information required by paragraph 6 of the rules and regulations of the oil and gas section of the mining laws of West Virginia.

ELEVATION (Spirit Level) 1098'
DATE 3-2-81 SCALE 1"=400'

MINIMUM ACCURACY, one part in 200

Ohio Shale 4,400

COMPANY BIG INJUN DRILLING CO.
 ADDRESS 225 PUTNAM MARIETTA, OHIO
 FARM LEROY TEMPLETON
 TRACT _____ ACRES 50 LEASE NO. _____
 QUADRANGLE SCHULTZ
 COUNTY PLEASANT DISTRICT JEFFERSON
 WELL (FARM) SERIAL NO. _____
 SURVEYOR OR ENGINEER Thomas D. Schultze
 SURVEYORS OR ENGINEERS REGISTRATION NO. 604

STATE OF WEST VIRGINIA
 DEPARTMENT OF MINES
 OIL AND GAS DIVISION
 CHARLESTON

WELL LOCATION MAP
 FILE NO. _____

* Denotes location of well on United States Topographic Maps, Scale 1 to 24,000 latitude and longitude lines being represented by border lines as shown.

47-073-1167-DD

- Denotes one inch spaces on border line of original tracing.

Ohio Shale 4400'