



west virginia department of environmental protection

Office of Oil and Gas
601 57th Street, S.E.
Charleston, WV 25304
(304) 926-0450
fax: (304) 926-0452

Harold D. Ward, Cabinet Secretary
www.dep.wv.gov

Tuesday, August 15, 2023
WELL WORK PLUGGING PERMIT
Vertical Plugging

UNKNOWN - DEP PAID PLUGGING CONTRACT
601 57TH STREET

CHARLESTON, WV 25304

Re: Permit approval for 1
47-073-00680-00-00

This well work permit is evidence of permission granted to perform the specified well work at the location described on the attached pages and located on the attached plat, subject to the provisions of Chapter 22 of the West Virginia Code of 1931, as amended, and all rules and regulations promulgated thereunder, and to any additional specific conditions and provisions outlined in the pages attached hereto. Notification shall be given by the operator to the Oil and Gas Inspector at least 24 hours prior to the construction of roads, locations, and/or pits for any permitted work. In addition, the well operator shall notify the same inspector 24 hours before any actual well work is commenced and prior to running and cementing casing. Spills or emergency discharges must be promptly reported by the operator to 1-800-642-3074 and to the Oil and Gas Inspector.

Upon completion of the plugging well work, the above named operator will reclaim the site according to the provisions of WV Code 22-6-30. Please be advised that form WR-38, Affidavit of Plugging and Filling Well, is to be submitted to this office within 90 days of completion of permitted well work, as should form WR-34 Discharge Monitoring Report within 30 days of discharge of pits, if applicable. Failure to abide by all statutory and regulatory provisions governing all duties and operations hereunder may result in suspension or revocation of this permit and, in addition, may result in civil and/or criminal penalties being imposed upon the operators.

Per 35 CSR 4-5.2.g this permit will expire in two (2) years from the issue date unless permitted well work is commenced. If there are any questions, please feel free to contact me at (304) 926- 0450.

James A. Martin
Chief

Operator's Well Number:
Farm Name: COKELEY, C.E.
U.S. WELL NUMBER: 47-073-00680-00-00
Vertical Plugging
Date Issued: 8/15/2023

PERMIT CONDITIONS

West Virginia Code §22-6-11 allows the Office of Oil and Gas to place specific conditions upon this permit. Permit conditions have the same effect as law. Failure to adhere to the specified permit conditions may result in enforcement action.

CONDITIONS

1. In the event of an accident or explosion causing loss of life or serious personal injury in or about the well or while working on the well, the well operator or its contractor shall give notice, stating the particulars of the accident or explosion, to the oil and gas inspector and the Chief within twenty-four (24) hours.
2. Well work activities shall not constitute a hazard to the safety of persons.
3. Notification shall be given by the operator to the Oil and Gas Inspector at least 24 hours prior to the construction of roads, locations and/or pits for any permitted work. In addition, the well operator shall notify the same inspector 24 hours before any actual well work is commenced and prior to running and cementing casing.

WW-4B
Rev. 2/01

1) Date June 30, 2023
2) Operator's
Well No. C.E. Cokeley No. 1
3) API Well No. 47-073 - 00680

STATE OF WEST VIRGINIA
DEPARTMENT OF ENVIRONMENTAL PROTECTION
OFFICE OF OIL AND GAS

APPLICATION FOR A PERMIT TO PLUG AND ABANDON

- 4) Well Type: Oil ___ / Gas X / Liquid injection ___ / Waste disposal ___ /
(If "Gas, Production ___ or Underground storage ___) Deep ___ / Shallow X
- 5) Location: Elevation 817' Watershed Horseneck Run of Bull Creek
District Grant County Pleasants Quadrangle Willow Island 7.5'
- 6) Well Operator Unknown- WV DEP Paid Plugging Contract 7) Designated Agent Jason Harmon
Address 601 57th Street, SE Address 601 57th Street, SE
Charleston, WV 25304 Charleston, WV 25304
- 8) Oil and Gas Inspector to be notified 9) Plugging Contractor
Name Isaiah Richards Name Next LVL Energy
Address 114 Turkey Lick Road Address 104 Heliport Loop
West Union, WV 26456 Bridgeport, WV 26330

10) Work Order: The work order for the manner of plugging this well is as follows:

See attached Work Procedure

RECEIVED
Office of Oil and Gas
JUL 14 2023
WV Department of
Environmental Protection

Notification must be given to the district oil and gas inspector 24 hours before permitted work can commence.

Work order approved by inspector



Date 7/7/2023

08/25/2023

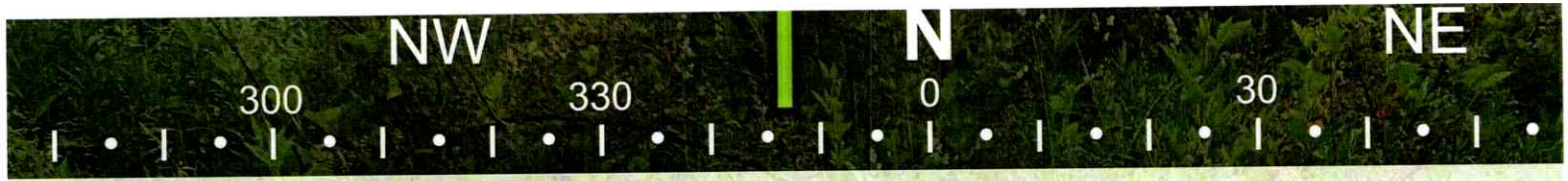

☉ 347°N (T) LAT: 39.328705 LON: -81.323405 ±13ft ▲ 814ft



Office of Oil and Gas
JUL 14 2023
Department of

47-073-00680

07 Jun 2023 09:25:45



Select County: (073) Pleasants (Check All)

Enter Permit #: 00680

Location Production Plugging
 Owner/Completion Stratigraphy Sample
 Pay/Show/Water Logs Btm Hole Loc

- [Table Descriptions](#)
- [County Code Translations](#)
- [Permit Numbering Schemas](#)
- [License Notes](#)
- [Contact Information](#)
- [Disclaimer](#)
- [WVGES Main](#)
- ["Pipeline-Plus"](#)

WV Geological & Economic Survey

Report Time: Tuesday, August 01, 2023 2:09:16 PM

Well: County = 73 Permit = 00680 [Link to all digital records for well](#)

Location Information: [View Map](#)

API	COUNTY	PERMIT	TAX DISTRICT	QUAD	15	LAT	DD	LONG	DD	UTME	UTM
4707300680	Pleasants	680	Willow Island	Marietta	39.32886	-81.323009	472160	4353321.3			

There is no Bottom Hole Location data for this well

Owner Information:

API	CMP_DT	SUFFIX	STATUS	SURFACE_OWNER	WELL_NUM	CO_NUM	LEASE	LEASE_NUM	MINERAL_OWN	OPERATOR	AT_COMPLETION	PROP_VD	PROP_TRGT_FM	TFM_EST_PR
4707300680	9/22/1973		Original Loc	Completed	C E Cokeley	1				Big B Drilling Co., Inc.				

Completion Information:

API	CMP_DT	SPUD_DT	ELEV DATUM	FIELD	DEEPEST_FM	DEEPEST_FMT	INITIAL_CLASS	FINAL_CLASS	TYPE	RIG	CMP_MTHD	TVD	TMD	NEW	FTG	KOD	G_BEF	G_AFT	O_BEF	O_AFT	NGL_BEF	NGL_AFT	P_BEF	TI_BE	
4707300680	9/22/1973	8/13/1973	823	Ground Level	Waverly	Udev undrf/Berf/LoHURN	Udev undrf/Berf/LoHURN	Development Well	Unsuccessful	Dry w/ Gas Show	Cable Tool	Nat/Open H	2550				1	0	0	0	0	0	0	0	0

Pay/Show/Water Information:

API	CMP_DT	ACTIVITY	PRODUCT	SECTION	DEPTH_TOP	FM_TOP	DEPTH_BOTTOM	FM_BOTTOM	G_BEF	G_AFT	O_BEF	O_AFT	WATER_QNTY
4707300680	9/22/1973	Water	Salt Water	Vertical	1685								0
4707300680	9/22/1973	Show	Gas	Vertical	2172		2175	Berea Ss	1	0			0

There is no Production Gas data for this well

There is no Production Oil data for this well ** some operators may have reported NGL under Oil

There is no Production NGL data for this well ** some operators may have reported NGL under Oil

There is no Production Water data for this well

Stratigraphy Information:

API	SUFFIX	FM	FM_QUALITY	DEPTH_TOP	DEPTH_BOTTOM	DEPTH_QUALITY	THICKNESS	THICKNESS_QUALITY	ELEV DATUM
4707300680		Original Loc	Greenbrier Group	Well Record	1670	Reasonable	15	Reasonable	823
4707300680		Original Loc	Big Lime	Well Record	1670	Reasonable	15	Reasonable	823
4707300680		Original Loc	Big Injun (Price&seq)	Well Record	1730	Reasonable	40	Reasonable	823
4707300680		Original Loc	Udev undrf/Berf/LoHURN	Well Record	2175	Reasonable	0	Reasonable	823

Wireline (E-Log) Information:

- * There is no Scanned/Raster Log data for this well
 - * There is no Digitized/LAS Log data for this well
 - * There is no Scanned or Digital Logs available for download
- There is no Plugging data for this well
- There is no Sample data for this well

08/25/2023



STATE OF WEST VIRGINIA
DEPARTMENT OF MINES

Oil and Gas Division

WELL RECORD

Quadrangle Marietta
Permit No. PLEAS-680

Rotary XX Oil _____
Cable _____ Gas _____
Recycling _____ Comb. _____
Water Flood _____ Storage _____
Disposal _____ Dry _____
(Kind)

Company Big B Drilling Co. Inc.
Address P.O. Box 20, Sissonville, W.Va.
Farm C. E. Cokeley Acres 96
Location (waters) Branch of Bull Ck./Ohio River
Well No. One Elev 823'
District Grant County Pleasants
The surface of tract is owned in fee by C. E. Cokeley
Address Rt. 3, St. Marys, W.Va.
Mineral rights are owned by Same
Address _____
Drilling Commenced 8/13/73
Drilling Completed 9/22/73
Initial open flow _____ cu. ft. _____ bbls.
Final production _____ cu. ft. per day _____ bbls.
Well open _____ hrs. before test _____ RP.
Well treatment details:

Casing and Tubing	Used in Drilling	Left in Well	Cement fill up Cu. ft. (Sks.)
Size 20-16			
Cond. 13-10" 3/4"	204'	204'	
9 5/8			
8 5/8	1023'	1018'	
7	1816'	1816'	
5 1/2			
4 1/2			
3			
2			
Liners Use:			

Attach copy of cementing record.

Coal was encountered at None Feet _____ Inches _____
Fresh water None Feet _____ Salt Water 1685' Feet _____
Producing Sand _____ Depth 2552'

Formation	Color	Hard or Soft	Top Feet	Bottom Feet	Oil, Gas or Water	* Remarks
						<p><u>Sold to Landowner - 11-9-73</u> <u>Mr. Clyde E. Cokeley</u> <u>Rt. 3. St. Marys, W.Va. 26170</u></p> <p>Show Gas @ 2150' - 2170' (Not enough to Test)</p>

(over)

* Indicates Electric Log tops in the remarks section.

08/25/2023



STATE OF WEST VIRGINIA
DEPARTMENT OF MINES

Oil and Gas Division

WELL RECORD

RECEIVED

JUN - 2 1978

OIL & GAS DIVISION
DEPT. OF MINES

Quadrangle Marietta
Permit No. Pleas # 680

Rotary _____ Oil _____
Cable XX Gas XX
Recycling _____ Comb. _____
Water Flood _____ Storage _____
Disposal _____ (Kind)

Company Six B Drilling Co Inc.
Address Sissonville W.Va
Farm C.E. Cokeley Acres _____
Location (waters) Bull Creek
Well No. One Elev. 825'
District Grant County Pleasants
The surface of tract is owned in fee by _____
C.E. Cokeley
Address Rt. 3 St. Marys W.Va.
Mineral rights are owned by Same
Address 8/13/73
Drilling Commenced 9/22/73
Drilling Completed _____
Initial open flow _____ cu. ft. _____ bbls.
Final production 1,000 cu. ft. per day _____ bbls.
Well open _____ hrs. before test _____ RP.
Well treatment details:

Casing and Tubing	Used in Drilling	Left in Well	Cement fill up Cu. ft. (Sks.)
Size 20-16			
Cond. 13-10"			
7 5/8			
8 5/8			
7			
5 1/2			
4 1/2			
3			
2			
Linerr Used			

Attach copy of cementing record.

(Well sold to Landowner for Domestic use of Gas)

Coal was encountered at None Feet _____ Inches _____
Fresh water None Feet _____ Salt Water 1685 Feet _____
Producing Sand Trace of gas 2172 - 2175 Depth 2550

Formation	Color	Hard or Soft	Top Feet	Bottom Feet	Oil, Gas or Water	* Remarks
Red Rock			0	795		
Slate & Shells			795	1670		
Lime			1670	1685		
Engine Sand			1685	1710	Show Of Gas	1685
Slate & Shells			1710	1730	Water	1685 to 1710
Engine Sand			1730	1770	Water	1730 " 1770
Slate & Shells			1770	2172*		
Sandy Lime Shell			2172*	2175		
Slate & Shells			2175	2550	Trace Of Gas	2173

(over)

* Indicates Electric Log tops in the remarks section.



STATE OF WEST VIRGINIA
DEPARTMENT OF MINES

Oil and Gas Division

WELL RECORD

RECEIVED
JUN - 9 1978
OIL & GAS DIVISION
DEPT. OF MINES

Quadrangle Marietta
Permit No. PLEAS-680

Rotary XX Oil _____
Cable _____ Gas _____
Recycling _____ Comb. _____
Water Flood _____ Storage _____
Disposal _____ Dry _____
(Kind)

Company <u>Big B Drilling Co. Inc.</u>	Casing and Tubing	Used in Drilling	Left in Well	Cement fill up Cu. ft. (Sks.)
Address <u>P.O. Box 20, Sissonville, W.Va.</u>				
Farm <u>C. E. Cokeley</u> Acres <u>96</u>				
Location (waters) <u>Branch of Bull Ck./Ohio River</u>				
Well No. <u>One</u> Elev. <u>823'</u>	Size			
District <u>Grant</u> County <u>Pleasants</u>	<u>20-16</u>			
The surface of tract is owned in fee by <u>G. E. Cokeley</u>	Cond.			
Address <u>Rt. 3, St. Marys, W.Va.</u>	<u>4 10" 3/4"</u>	<u>204'</u>	<u>204'</u>	
Mineral rights are owned by <u>Same</u>	<u>9 5/8</u>			
Address _____	<u>8 5/8</u>	<u>1023'</u>	<u>1018'</u>	
Drilling Commenced <u>8/13/73</u>	<u>7</u>	<u>1816'</u>	<u>1816'</u>	
Drilling Completed <u>9/22/73</u>	<u>5 1/2</u>			
Initial open flow _____ cu. ft. _____ bbls.	<u>4 1/2</u>			
Final production _____ cu. ft. per day _____ bbls.	<u>3</u>			
Well open _____ hrs. before test _____ RP.	<u>2</u>			
Well treatment details:	Liners Used			

Attach copy of cementing record.

Coal was encountered at None Feet _____ Inches _____
Fresh water None Feet _____ Salt Water 1685' Feet _____
Producing Sand _____ Depth 2552'

Formation	Color	Hard or Soft	Top Feet	Bottom Feet	Oil, Gas or Water	Remarks
Surface			0	40		
Shale			40	120		
Red Rock			120	230		
Shale			230	250		
Sand			250	260		
Red Rock			260	320		
Shale			320	375		
Red Rock			375	385		
Shale			385	405		
Red Rock			405	410		
Shale			410	472		
Red Rock			472	482		
Sand			482	500		
Shale			500	530		
Red Rock			530	550		
Shale			550	570		
Sand			570	580		
Red Rock			580	680		
Shale			680	705		
Red Rock			705	710		
Shale			710	795		
Lime			795	815		
Sand			815	850		
Shale			850	865		

Sold to Landowner - 11-9-73
Mr. Clyde E. Cokeley
Rt. 3, St. Marys, W.Va. 26170

Show Gas @ 2150' - 2170'
(Not enough to Test)

(over)

* Indicates Electric Log tops in the remarks section.

08/25/2023

Formation	Color	Hard or Soft	Top Feet	Bottom Feet	Oil, Gas or Water	Remarks
Lime			865	875		
Shale			875	980		
Sand			980	1085		
Shale			1085	1120		
Sand			1120	1160		
Shale			1160	1190		
Sand			1190	1220		
Shale			1220	1350		
Sandy Shale			1350	1375		
Sand			1375	1405		
Shale			1405	1495		
Sand			1495	1822	Water @ 1685	
Sand Shaley			1822	1870		
Shale			1870	2152		
Coffee Shale			2152	2172		
Berna			2172	2185		
Shale			2185	2552		
				2552	TOTAL DEPTH	

Date _____, 19____

APPROVED _____, Owner

By _____
(Title)

08/25/2023

PLUGGING PROGNOSIS

West Virginia, Pleasants County
API # 47-073-00680

Casing Schedule

10-3/4" csg @ 204' (no cement date)
8-5/8" csg @ 1018' (no cement date)
7" csg @ 1816' (no cement date)
TD @ 2550'

Completion:

Fresh Water: None Reported
Saltwater: 1685'-1710'; 1730'-1770'
Coal: None Reported
Oil Show: None Reported
Gas Show: 2150'-2173'
Elevation: 823'

RECEIVED
Office of Oil and Gas

JUL 14 2023

WV Department of
Environmental Protection

1. Notify inspector, Isaiah Richards @ (304) 205-3032, 48 hrs. prior to commencing operations.
2. Check wellhead pressure and kill well as needed.
3. RIH w/ wireline to check TD and run CBM to determine TOC behind 7" csg
4. Run in to depth @ 2550'. Kill well as needed with 6% bentonite gel and fill rat hole. Pump at least 10 bbls gel. Pump 100' Class A/Class L cement plug from **2550' to 2450' (Bottom hole plug)**. Tag TOC. Top off as needed.
5. TOOH w/ tbg to 2450'. Pump 6% bentonite gel from 2450' to 2173'
6. TOOH w/ tbg to 2173'. Pump 123' Class A/Class L Cement plug from **2173' to 2050' (Gas show plug)**
7. TOOH w/ tbg to 2050'. Pump 6% bentonite gel from 2050' to 1866'
8. TOOH w/ tbg to 1866'. Pump 231' Class A/Class L Cement plug from **1866' to 1635' (7" csg shoe and Salt water plug)**
9. TOOH w/ tbg to 1635'. Pump 6% bentonite gel from 1635' to 1068'
10. Free point 7" csg. Cut and TOOH. Set 100' Class A/Class L cement plug across csg cut. 50' in/out of cut. TOOH w/ tbg to top of plug. **Do not omit any plugs listed below. Perforate as needed.**
11. TOOH w/ tbg to 1068'. Pump 295' Class A/Class L Cement plug from **1068' to 773' (8-5/8" csg shoe and elevation plug)**
12. TOOH w/ tbg to 773'. Pump 6% bentonite gel from 773' to 254'
13. Free point 8-5/8" csg. Cut and TOOH. Set 100' Class A/Class L cement plug across csg cut. 50' in/out of cut. TOOH w/ tbg to top of plug. **Do not omit any plugs listed below. Perforate as needed.**
14. TOOH w/ tbg to 100'. Pump 254' Class A/Class L Cement plug from **254' to surface (Surface plug)**.
15. Erect monument with API#.
16. Reclaim location and road to WV-DEP specifications.



7/7/2023

08/25/2023

WW-4A
Revised 6-07

1) Date: June 30, 2023
2) Operator's Well Number
C.E. Cokeley No. 1

3) API Well No.: 47 - 073 - 00680

STATE OF WEST VIRGINIA
DEPARTMENT OF ENVIRONMENTAL PROTECTION, OFFICE OF OIL AND GAS
NOTICE OF APPLICATION TO PLUG AND ABANDON A WELL

4) Surface Owner(s) to be served:	5) (a) Coal Operator
(a) Name <u>Gene M. & Sandra L. Cokeley</u>	Name <u>N/A</u>
Address <u>1665 Oak Grove Rd.</u>	Address _____
<u>Waverly, WV 26184</u>	_____
(b) Name _____	(b) Coal Owner(s) with Declaration
Address _____	Name <u>No Declarations found</u>
_____	Address _____
(c) Name _____	Name _____
Address _____	Address _____
_____	_____
6) Inspector <u>Isaiah Richards</u>	(c) Coal Lessee with Declaration
Address <u>114 Turkey Lick Road</u>	Name <u>No Declarations found</u>
<u>West Union, WV 26456</u>	Address _____
Telephone <u>304-205-3032</u>	_____

TO THE PERSONS NAMED ABOVE: You should have received this Form and the following documents:

- (1) The application to Plug and Abandon a Well on Form WW-4B, which sets out the parties involved in the work and describes the well its and the plugging work order; and
- (2) The plat (surveyor's map) showing the well location on Form WW-6.

The reason you received these documents is that you have rights regarding the application which are summarized in the instructions on the reverses side. However, you are not required to take any action at all.

Take notice that under Chapter 22-6 of the West Virginia Code, the undersigned well operator proposes to file or has filed this Notice and Application and accompanying documents for a permit to plug and abandon a well with the Chief of the Office of Oil and Gas, West Virginia Department of Environmental Protection, with respect to the well at the location described on the attached Application and depicted on the attached Form WW-6. Copies of this Notice, the Application, and the plat have been mailed by registered or certified mail or delivered by hand to the person(s) named above (or by publication in certain circumstances) on or before the day of mailing or delivery to the Chief.

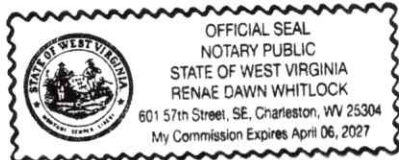
	Well Operator	<u>Unknown - WVDEP Paid Plugging Contract</u>	<p style="text-align: right;">RECEIVED Office of Oil and Gas JUL 14 2023 WV Department of Environmental Protection</p>
	By:	<u>Jason Harmon</u>	
	Its:	<u>WV Office of Oil & Gas Deputy Chief</u>	
	Address	<u>601 57th Street, SE Charleston, WV 25304</u>	
	Telephone	<u>304-926-0452</u>	

Subscribed and sworn before me this 20th day of July 2023
Renae Dawn Whitlock Notary Public
My Commission Expires April 6, 2027

Oil and Gas Privacy Notice

The Office of Oil and Gas processes your personal information, such as name, address and phone number, as a part of our regulatory duties. Your personal information may be disclosed to other State agencies or third parties in the normal course of business or as needed to comply with statutory or regulatory requirements, including Freedom of Information Act requests. Our office will appropriately secure your personal information. If you have any questions about our use of your personal information, please contact DEP's Chief Privacy Officer at depprivacyofficer@wv.gov.

08/25/2023



info@sllwv.com
www.sllwv.com

June 29, 2023

Gene M. & Sandra L. Cokeley
1665 Oak Grove Rd.
Waverly, WV 26184

Mrs. Cokeley,

Please find enclosed a Permit Application to plug and abandon a Well for API# 47-073-00680, in Grant District, Pleasants County, WV which records in the County Courthouse indicate that you are the surface owner. Through the West Virginia DEP Paid Plugging Contract, orphaned and abandoned wells have been proposed to be plugged. I have included an extra Surface owner signature form highlighted in yellow for you to sign if you approve of the proposed work, please sign and send it back to SLS Land & Energy Development in the self-addressed envelope provided for you. The Permit Application is yours to keep for your records. If you have any questions, please do not hesitate to contact me.

Jim Mencer
SLS Land & Development
Permitting Tech.
304-462-5634

RECEIVED
Office of Oil and Gas
JUL 14 2023
WV Department of
Environmental Protection

12 Vanhorn Drive, Glenville, WV 26351
1412 Kanawha Boulevard East, Charleston, WV 25301
254 East Beckley Bypass, Beckley, WV 25801
304-462-5634

08/25/2023

CERTIFIED MAIL



7021 2720 0001 6303 7267
7021 2720 0001 6303 7267

US POSTAGE
\$ 0.69 48

U.S. Postal Service®
CERTIFIED MAIL™ RECEIPT
Postage Due Only

OFFICIAL USE

Postage: 1.98
Total: 1.98

Gene M. & Sandra L. Cokeley
1665 Oak Grove Rd.
Waverly, WV 26184

SMITH LAND SURVEYING, INC.
12 Vanhorn Drive
PO Box 150
Glenville, WV 26351

TO: Gene M. & Sandra L. Cokeley
1665 Oak Grove Rd.
Waverly, WV 26184

SENDER: COMPLETE THIS SECTION	COMPLETE THIS SECTION ON DELIVERY																
<ul style="list-style-type: none"> Complete items 1, 2, and 3. Print your name and address on the reverse so that we can return the card to you. Attach this card to the back of the mailpiece, or on the front if space permits. <p>1. Article Addressed to:</p> <p>Gene M. & Sandra L. Cokeley 1665 Oak Grove Rd. Waverly, WV 26184</p> <p>2. Article Number (Transfer from service label)</p> <p>7021 2720 0001 6303 7267</p>	<p>A. Signature <input checked="" type="checkbox"/> Agent <input checked="" type="checkbox"/> Addressee</p> <p>B. Received by (Printed Name) C. Date of Delivery</p> <p>D. Is delivery address different from item 1? <input type="checkbox"/> Yes If YES, enter delivery address below: <input type="checkbox"/> No</p> <p>3. Service Type</p> <table border="0"> <tr> <td><input type="checkbox"/> Adult Signature</td> <td><input type="checkbox"/> Priority Mail Express®</td> </tr> <tr> <td><input type="checkbox"/> Adult Signature Restricted Delivery</td> <td><input type="checkbox"/> Registered Mail™</td> </tr> <tr> <td><input type="checkbox"/> Certified Mail®</td> <td><input type="checkbox"/> Registered Mail Restricted Delivery</td> </tr> <tr> <td><input type="checkbox"/> Certified Mail Restricted Delivery</td> <td><input type="checkbox"/> Signature Confirmation™</td> </tr> <tr> <td><input type="checkbox"/> Collect on Delivery</td> <td><input type="checkbox"/> Signature Confirmation Restricted Delivery</td> </tr> <tr> <td><input type="checkbox"/> Collect on Delivery Restricted Delivery</td> <td></td> </tr> <tr> <td><input type="checkbox"/> Insured Mail</td> <td></td> </tr> <tr> <td><input type="checkbox"/> Insured Mail Restricted Delivery (over \$500)</td> <td></td> </tr> </table>	<input type="checkbox"/> Adult Signature	<input type="checkbox"/> Priority Mail Express®	<input type="checkbox"/> Adult Signature Restricted Delivery	<input type="checkbox"/> Registered Mail™	<input type="checkbox"/> Certified Mail®	<input type="checkbox"/> Registered Mail Restricted Delivery	<input type="checkbox"/> Certified Mail Restricted Delivery	<input type="checkbox"/> Signature Confirmation™	<input type="checkbox"/> Collect on Delivery	<input type="checkbox"/> Signature Confirmation Restricted Delivery	<input type="checkbox"/> Collect on Delivery Restricted Delivery		<input type="checkbox"/> Insured Mail		<input type="checkbox"/> Insured Mail Restricted Delivery (over \$500)	
<input type="checkbox"/> Adult Signature	<input type="checkbox"/> Priority Mail Express®																
<input type="checkbox"/> Adult Signature Restricted Delivery	<input type="checkbox"/> Registered Mail™																
<input type="checkbox"/> Certified Mail®	<input type="checkbox"/> Registered Mail Restricted Delivery																
<input type="checkbox"/> Certified Mail Restricted Delivery	<input type="checkbox"/> Signature Confirmation™																
<input type="checkbox"/> Collect on Delivery	<input type="checkbox"/> Signature Confirmation Restricted Delivery																
<input type="checkbox"/> Collect on Delivery Restricted Delivery																	
<input type="checkbox"/> Insured Mail																	
<input type="checkbox"/> Insured Mail Restricted Delivery (over \$500)																	
<p>9590 9402 7774 2152 3735 49</p> <p>PS Form 3811, July 2020 PSN 7530-02-000-9053</p>	<p>Domestic Return Receipt</p>																

RECEIVED
Office of Oil and Gas
JUL 14 2023
WV Department of
Environmental Protection

08/25/2023

WW-4B

API No. 47-073-00680
Farm Name C.E. Cokeley Lease
Well No. No. 1

**INSTRUCTIONS TO COAL OPERATORS
OWNERS AND LESSEE**

The well operator named on the obverse side of WW-4 (B) is about to abandon the well described in the enclosed materials and will commence the work of plugging and abandoning said well on the date the inspector is notified. Which date shall not be less than five days after the day on which this notice and application so mailed is received, or in due course should be received by the Department of Environmental Protection Office of Oil & Gas.

This notice and application is given to you in order that your respective representatives may be present at the plugging and filling of said well. You are further notified that whether you are represented or not the operator will proceed to plug and fill said well in the manner required by Section 24, Article 6, Chapter 22 of the Code and given in detail on obverse side of this application.

NOTE: If you wish this well to be plugged according to 22-6-24(d) then as per Regulation 35CSR4-13.9 you must complete and return to this office on form OB-16 "Request by Coal Operator, Owner, or Lessee for plugging" prior to the issuance of this plugging permit.

WAIVER

The undersigned coal operator _____ / owner _____ / lessee _____ / of the coal under this well location has examined this proposed plugging work order. The undersigned has no objection to the work proposed to be done at this location, provided, the well operator has complied with all applicable requirements of the West Virginia Code and the governing regulations.

Date: _____

By: _____

Its _____

RECEIVED
Office of Oil and Gas

JUL 14 2023

WV Department of
Environmental Protection

08/25/2023



west virginia department of environmental protection

Office of Oil and Gas
601 57th Street, SE
Charleston, WV 25304
Phone (304) 926-0450

Harold D. Ward, Cabinet Secretary
dep.wv.gov

**BEFORE THE OFFICE OF OIL AND GAS
DEPARTMENT OF ENVIRONMENTAL PROTECTION
STATE OF WEST VIRGINIA**

**IN THE MATTER OF A VARIANCE FROM)
LEGISLATIVE RULE 35CSR4)
SECTION 14.1. AND LEGISLATIVE RULE)
35CSR8 SECTION 20.1,)
RELATING TO THE CEMENTING)
OF OIL AND GAS WELLS)**

ORDER NO. 2022-13

RECEIVED
Office of Oil and Gas
JUL 14 2023
WV Department of
Environmental Protection

REPORT OF THE OFFICE

In response to industry requests, the West Virginia Department of Environmental Protection, Office of Oil and Gas has reviewed the proposed use of American Petroleum Institute (API) Class L cement to be used in place of API Class A cement for well plugging.

FINDINGS OF FACT

1. On July 28, 2022, Diversified Gas & Oil Co. (DGO) submitted a variance request from Legislative Rule 35CSR4 for the use of API Class L cement in place of API Class A cement, relating to the plugging of conventional wells.
2. Laboratory analysis submitted by DGO on July 28, 2022, indicates API Class L cement is comparable to API Class A cement and thereby satisfies the requirements of the West Virginia Code.
3. Contemporaneously, the Chief of the Office of Oil and Gas also chose to consider a variance to Legislative Rule 35CSR8 Section 20.1., for the use of API Class L cement in place of API Class A cement, relating to the plugging of horizontal wells.

Promoting a healthy environment.

08/25/2023

4. On August 18, 2022, the Office of Oil and Gas provided public notice of acceptance of public comments on the variance consideration. During the 20-day public comment period, no comments were received.

CONCLUSIONS OF LAW

Pursuant to Article 6 and Article 6A, Chapter 22 of the Code of West Virginia, the Office of Oil and Gas has jurisdiction over the subject matter, and the persons interested therein, and jurisdiction to promulgate the hereinafter prescribed Order.

Pursuant to Legislative Rule 35CSR4, Section 18 and Legislative Rule 35CSR8, Section 14, the Chief of the Office of Oil and Gas may grant a variance from any requirement of these rules.

ORDER

It is ordered that the Class L cement product approved and monogrammed by API is approved for use in place of API Class A cement for well plugging subject to the provisions of Legislative Rule 35CSR4 and Legislative Rule 35CSR8.

Dated this, the 13th day of September, 2022.

IN THE NAME OF THE STATE OF WEST VIRGINIA

OFFICE OF OIL AND GAS
DEPARTMENT OF ENVIRONMENTAL PROTECTION
OF THE STATE OF WEST VIRGINIA



James Martin, Chief
Office of Oil and Gas

RECEIVED
Office of Oil and Gas
JUL 14 2023
WV Department of
Environmental Protection

08/25/2023

WW-9
(5/16)

API Number 47 - 073 - 00680
Operator's Well No. C.E. Cokeley No. 1

STATE OF WEST VIRGINIA
DEPARTMENT OF ENVIRONMENTAL PROTECTION
OFFICE OF OIL AND GAS
FLUIDS/ CUTTINGS DISPOSAL & RECLAMATION PLAN

Operator Name Unknown - WV DEP Paid Plugging Contract OP Code _____

Watershed (HUC 10) Horseneck Run of Bull Creek Quadrangle Willow Island 7.5'

Do you anticipate using more than 5,000 bbls of water to complete the proposed well work? Yes No

Will a pit be used? Yes No

If so, please describe anticipated pit waste: _____

Will a synthetic liner be used in the pit? Yes No If so, what ml.? _____

Proposed Disposal Method For Treated Pit Wastes:

- Land Application (if selected provide a completed form WW-9-GPP)
- Underground Injection (UIC Permit Number #25-774)
- Reuse (at API Number _____)
- Off Site Disposal (Supply form WW-9 for disposal location)
- Other (Explain _____)

Will closed loop system be used? If so, describe: N/A

Drilling medium anticipated for this well (vertical and horizontal)? Air, freshwater, oil based, etc. N/A

-If oil based, what type? Synthetic, petroleum, etc. N/A

Additives to be used in drilling medium? N/A

Drill cuttings disposal method? Leave in pit, landfill, removed offsite, etc. Offsite

-If left in pit and plan to solidify what medium will be used? (cement, lime, sawdust) N/A

-Landfill or offsite name/permit number? N/A

Permittee shall provide written notice to the Office of Oil and Gas of any load of drill cuttings or associated waste rejected at any West Virginia solid waste facility. The notice shall be provided within 24 hours of rejection and the permittee shall also disclose where it was properly disposed.

I certify that I understand and agree to the terms and conditions of the GENERAL WATER POLLUTION PERMIT issued on April 1, 2016, by the Office of Oil and Gas of the West Virginia Department of Environmental Protection. I understand that the provisions of the permit are enforceable by law. Violations of any term or condition of the general permit and/or other applicable law or regulation can lead to enforcement action.

I certify under penalty of law that I have personally examined and am familiar with the information submitted on this application form and all attachments thereto and that, based on my inquiry of those individuals immediately responsible for obtaining the information, I believe that the information is true, accurate, and complete. I am aware that there are significant penalties for submitting false information, including the possibility of fine or imprisonment.

Company Official Signature *Jason Harmon*
Company Official (Typed Name) Jason Harmon
Company Official Title Deputy Chief

RECEIVED
Office of Oil and Gas
JUL 14 2023

WV Department of
Environmental Protection

Subscribed and sworn before me this 20th day of July, 2023
Renaee Dawn Whitlock
My commission expires April 06, 2027

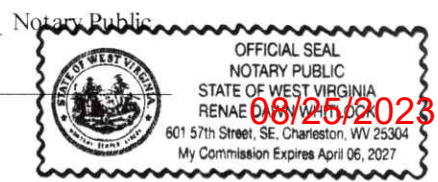

Proposed Revegetation Treatment: Acres Disturbed Less than an acre Prevegetation pH _____

Lime 3 Tons/acre or to correct to pH 6.0

Fertilizer type 20-20-20

Fertilizer amount 500 lbs/acre

Mulch 2-3 Tons/acre

Seed Mixtures

Temporary		Permanent	
Seed Type	lbs/acre	Seed Type	lbs/acre
		Fescue	30
		Clover	3
		Contractor Mix	10

Attach:

Maps(s) of road, location, pit and proposed area for land application (unless engineered plans including this info have been provided). If water from the pit will be land applied, provide water volume, include dimensions (L, W, D) of the pit, and dimensions (L, W), and area in acres, of the land application area.

Photocopied section of involved 7.5' topographic sheet.

Plan Approved by: 

Comments: No pit will be used.

RECEIVED
Office of Oil and Gas
JUL 14 2023
WV Department of
Environmental Protection

Title: OOG Inspector Date: 7/7/2023

Field Reviewed? () Yes () No

C. E. COLELEY LEASE WELL NO. 1 47-073-00680

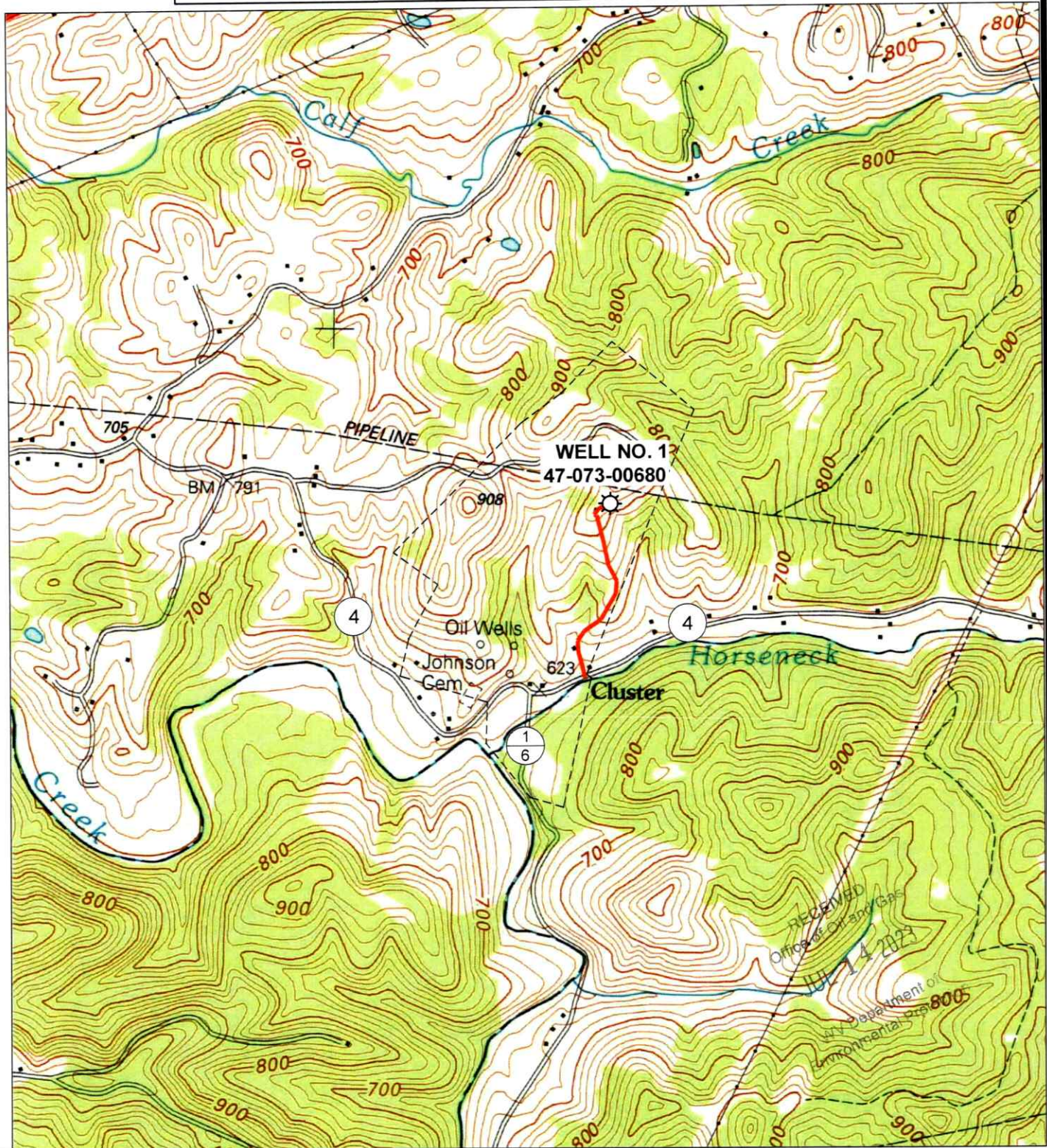

12 Vanhorn Drive | P.O. Box 150 | Glenville, WV 26351 | 304.462.5634
1412 Kanawha Boulevard, East | Charleston, WV 25301 | 304.346.3952
254 East Beckley Bypass | Beckley, WV 25801 | 304.255.5296
slswv.com

SCALE: 1"=2000'

0' 2000' 4000'



TOPO SECTION OF WILLOW ISLAND, WV
7.5' TOPO QUADRANGLE

08/25/2023

DRAWN BY GF	FILE NO. 9381	DATE 06-23-23	CADD FILE: 9381-SURV-REC-000- GF-230623.DWG
-----------------------	-------------------------	-------------------------	----------------------------------------------------------

C. E. COKELY LEASE
183 ACRES
WELL NO. 1
47-073-00680

2-7-49.2
TIMOTHY JOE &
MARGARET ANNE
MILLER (LIFE)
22.101 AC.

NAD'83 GEO. LAT-(N) 39.328710 LONG-(W) 81.323408
NAD'83 UTM (M)(ZONE 17) N. 4,353,305 E. 472,128

P/O 2-7-48
GENE M. & SANDRA
L. COKELEY,
TRUSTEES
183.00 AC.

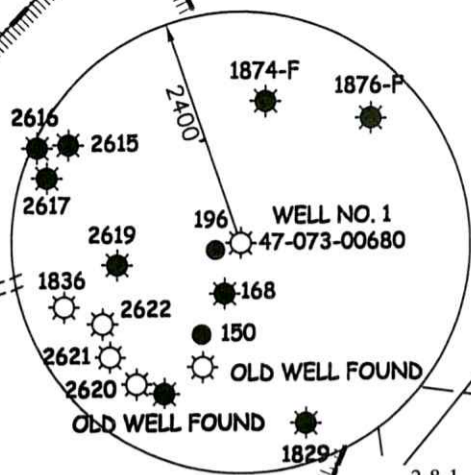

2-8-1
ELLIOT LAND &
CATTLE CO., LLC
71.75 AC.

2-8-28
DAVID CARL
FARSON
57.29 AC.

2-8-27
GENE M. & SANDRA
L. COKELEY
TRUSTEES
109.5 AC.

S 80°26' W
1313.70'

S 27°40' W
1761.63'

2-7-55
TIMOTHY
BRAMMER
43.12 AC.

2-7-48
GENE M. & SANDRA
L. COKELEY,
TRUSTEES
183.00 AC.

2-7-66
CYNTHIA MARIE
HICKS
26.7 AC.

2-7-67
GENE M. &
SANDRA L.
COKELEY
TRUSTEES
11 AC.

LEGEND

- LEASE LINE
- SURFACE LINE
- TIE LINE
- CREEK
- ROAD
- COUNTY ROUTE
- PROPOSED WELL
- EXISTING WELL
- PERMITTED WELL
- DISTRICT-TAXMAP-PARCEL 00-00-00

NOTES ON SURVEY

- WELL SPOT CIRCLE & TOPO MARK SCALE IS 1"=2000'.



12 Vanhorn Drive | P.O. Box 150 | Glenville, WV 26351 | 304.462.5634
1412 Kanawha Boulevard, East | Charleston, WV 25301 | 304.346.5952
254 East Beckley Bypass | Beckley, WV 25801 | 304.255.5296
slswv.com

I THE UNDERSIGNED, HEREBY CERTIFY THAT THIS PLAT IS CORRECT TO THE BEST OF MY KNOWLEDGE AND BELIEF AND SHOWS ALL THE INFORMATION REQUIRED BY LAW AND THE REGULATIONS ISSUED AND PRESCRIBED BY THE DIVISION OF ENVIRONMENTAL PROTECTION.

P.S. 877 Gregory A. Smith



(+) DENOTES LOCATION OF WELL ON UNITED STATES TOPOGRAPHIC MAPS.

DATE JUNE 22, 20 23
 REVISED _____, 20 ____
 OPERATORS WELL NO. 1
 API WELL NO. 47 - 073 - 00680-P
 STATE COUNTY PERMIT

MINIMUM DEGREE OF ACCURACY 1/200 FILE NO. 9381-SURV-4707300680-MT-R00-230622.dwg
 HORIZONTAL & VERTICAL CONTROL DETERMINED BY DGPS (SUBMETER MAPPING GRADE TIE TO CORS NETWORK) SCALE 1" = 500'

STATE OF WEST VIRGINIA
DIVISION OF ENVIRONMENTAL PROTECTION
OFFICE OF OIL AND GAS



WELL TYPE: OIL GAS LIQUID INJECTION _____ WASTE DISPOSAL _____ IF "GAS" PRODUCTION _____ STORAGE _____ DEEP _____ SHALLOW

LOCATION: ELEVATION 817' WATERSHED HORSENECK RUN OF BULL CREEK
 DISTRICT GRANT COUNTY PLEASANTS QUADRANGLE WILLOW ISLAND 7.5'
 SURFACE OWNER GENE M. & SANDRA L. COKELEY, TRUSTEES ACREAGE 183±
 ROYALTY OWNER GENE M. & SANDRA L. COKELEY, TRUSTEES ACREAGE 183±
 PROPOSED WORK: LEASE NO. 08/25/2023
 DRILL _____ CONVERT _____ DRILL DEEPER _____ REDRILL _____ FRACTURE OR STIMULATE _____ PLUG OFF OLD FORMATION _____ PERFORATE NEW FORMATION _____ PLUG AND ABANDON CLEAN OUT AND REPLUG _____ OTHER _____
 PHYSICAL CHANGE IN WELL (SPECIFY) _____ TARGET FORMATION BEREA
 ESTIMATED DEPTH 2552'

WELL OPERATOR UNKNOWN WVDEP PAID PLUGGING CONTRACT DESIGNATED AGENT JASON HARMON, WVDEP
 ADDRESS 601 57TH STREET ADDRESS 601 57TH STREET
 CHARLESTON, WV 25304 (WVDEP) CHARLESTON, WV 25304

C. E. COKELEY LEASE WELL NO. 1 47-073-00680

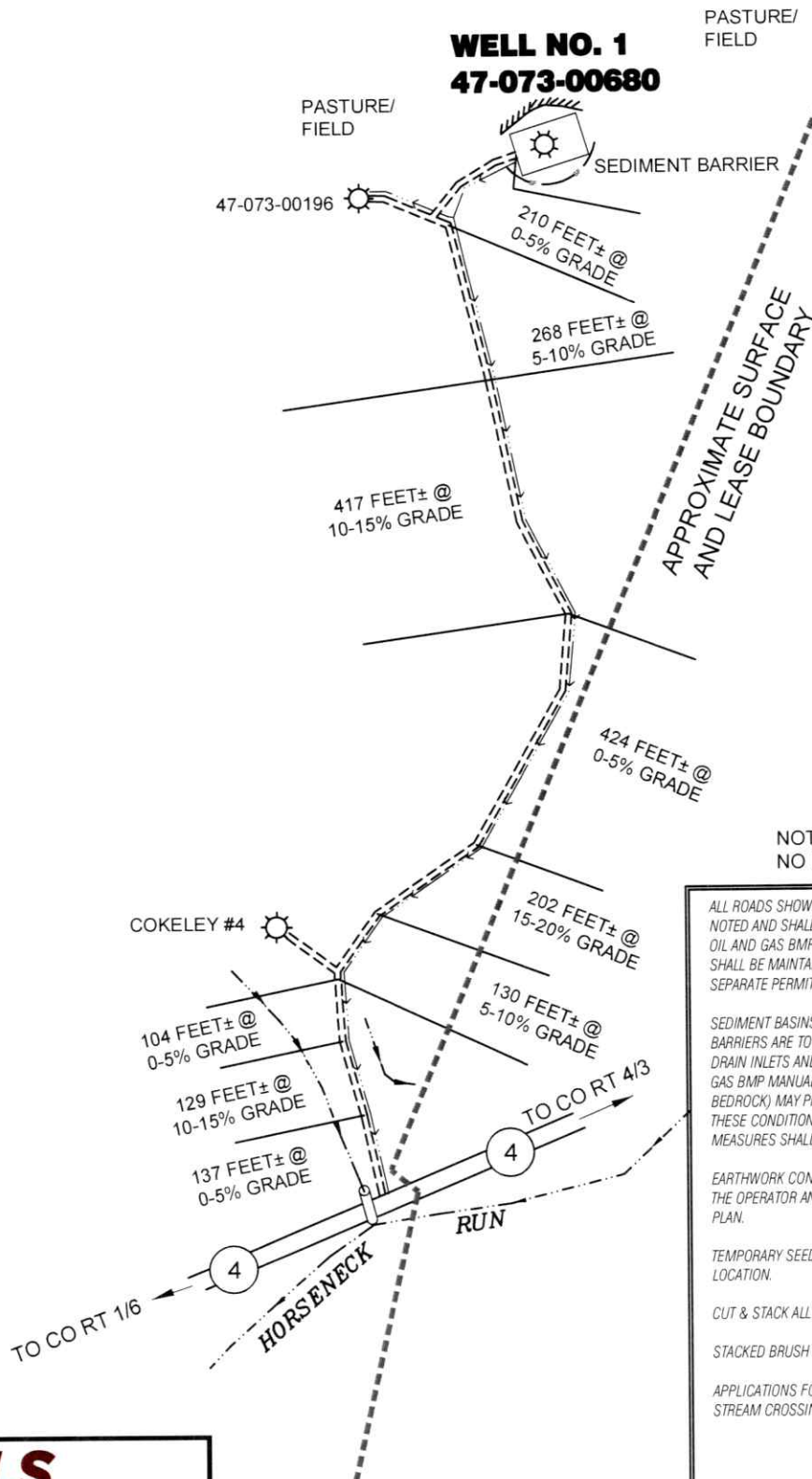

RECEIVED
Office of Oil and Gas
JUL 14 2023
WV Department of
Environmental Protection

NOTE: LOCATED IN FLAT FIELD,
NO DRAINAGE NECESSARY.

ALL ROADS SHOWN HEREON ARE EXISTING UNLESS OTHERWISE NOTED AND SHALL BE MAINTAINED IN ACCORDANCE WITH WV D.E.P. OIL AND GAS BMP MANUAL ENTRANCES AT COUNTY/STATE ROADS SHALL BE MAINTAINED IN ACCORDANCE WITH WV D.O.T. REGULATION. SEPARATE PERMITS MAY BE REQUIRED BY THE D.O.T.

SEDIMENT BASINS (TRAPS) AND APPROPRIATE EROSION CONTROL BARRIERS ARE TO BE CONSTRUCTED AT ALL CULVERT AND CROSS DRAIN INLETS AND OUTLETS AS REQUIRED IN THE WV D.E.P. OIL AND GAS BMP MANUAL. FIELD CONDITIONS (ROCK OUTCROPS AND BEDROCK) MAY PROHIBIT INLET TRAPS BEING INSTALLED. WHEN THESE CONDITIONS EXIST ADDITIONAL EROSION CONTROL MEASURES SHALL BE EVALUATED AND UTILIZED AS NEEDED.

EARTHWORK CONTRACTORS ARE RESPONSIBLE FOR NOTIFICATION TO THE OPERATOR AND INSPECTOR PRIOR TO ANY DEVIATION FROM THIS PLAN.

TEMPORARY SEED & MULCH ALL SLOPES AFTER CONSTRUCTION OF LOCATION.

CUT & STACK ALL MARKETABLE TIMBER.

STACKED BRUSH MAY BE USED FOR SEDIMENT CONTROL.

APPLICATIONS FOR SEPARATE PLC PERMITS ON THE ACCESS ROAD STREAM CROSSINGS HAVE BEEN PREPARED (IF APPLIES).

- = EXISTING CULVERT
- = PROPOSED CULVERT 15' MIN. UNLESS OTHERWISE NOTED
- = PROPOSED STREAM CROSSING
- = APPROXIMATE LIMITS OF DISTURBANCE

SCALE: 1"=300'



12 Vanhorn Drive | P.O. Box 150 | Glenville, WV 26351 | 304.462.5634
1412 Kanawha Boulevard, East | Charleston, WV 25301 | 304.346.3952
254 East Beckley Bypass | Beckley, WV 25801 | 304.255.5296
slsvv.com

DRAWN BY MRH	FILE NO. 9381	DATE 6-23-23	CADD FILE: 9381-SURV-REC-R00-MRH-230623.DWG
-----------------	------------------	-----------------	------------------------------------------------

08/25/2023

STATE OF WEST VIRGINIA
DEPARTMENT OF MINES
OIL AND GAS WELLS DIVISION

INSPECTOR'S WELL REPORT

Permit No. Pleasants-680

Oil or Gas Well _____
(KIND)

Company <u>Big B. Drilling Co. Inc.</u> Address <u>Box 20 Sissonville, W. Va.</u> Farm <u>C. E. Cokaley</u> Well No. <u>1</u> District <u>Grant</u> County <u>Pleasants</u> Drilling commenced _____ Drilling completed _____ Total depth _____ Date shot _____ Depth of shot _____ Initial open flow _____ /10ths Water in _____ Inch Open flow after tubing _____ /10ths Merc. in _____ Inch Volume _____ Cu. Ft. Rock pressure _____ lbs. _____ hrs. Oil _____ bbls., 1st 24 hrs. Fresh water _____ feet _____ feet Salt water _____ feet _____ feet	CASING AND TUBING	USED IN DRILLING	LEFT IN WELL	PACKERS
	Size			Kind of Packer _____
	16			
	13			Size of _____
	10			
	8 1/2			Depth set _____
	6 3/8			
	5 3/16			Perf. top _____
	3			Perf. bottom _____
	2			Perf. top _____
	Liners Used _____			Perf. bottom _____
	CASING CEMENTED _____ SIZE _____ No. FT _____ Date _____			
	NAME OF SERVICE COMPANY _____			
	COAL WAS ENCOUNTERED AT _____ FEET _____ INCHES			
	_____ FEET _____ INCHES _____ FEET _____ INCHES			
	_____ FEET _____ INCHES _____ FEET _____ INCHES			

Drillers' Names _____

Remarks: Rigging up.

RECEIVED

AUG 13 1973

OIL & GAS DIVISION
DEPT. OF MINES

8/10/1973
DATE

Paul W. Bennett
DISTRICT WELL INSPECTOR

08/25/2023

STATE OF WEST VIRGINIA
DEPARTMENT OF MINES
OIL AND GAS WELLS DIVISION

RECEIVED
AUG 20 1973

INSPECTOR'S WELL REPORT

OIL & GAS DIVISION
DEPT. OF MINES

Permit No. Pleasants-680

Oil or Gas Well _____
(KIND)

Company <u>Big B. Drilling Co. Inc.</u> Address <u>Box 20 Sissonville, W. Va.</u> Farm <u>C. E. Cakelax</u> Well No. <u>1</u> District <u>GRANT</u> County <u>Pleasants</u> Drilling commenced <u>8/13/1973</u> Drilling completed _____ Total depth _____ Date shot _____ Depth of shot _____ Initial open flow _____ /10ths Water in _____ Inch Open flow after tubing _____ /10ths Merc. in _____ Inch Volume _____ Cu. Ft. Rock pressure _____ lbs. _____ hrs. Oil _____ bbls., 1st 24 hrs. Fresh water _____ feet _____ feet Salt water _____ feet _____ feet	CASING AND TUBING	USED IN DRILLING	LEFT IN WELL	PACKERS
	Size			Kind of Packer
	16			
	13			
	10 $\frac{3}{4}$ "	204	Cemented	To Surface
	8 $\frac{1}{4}$ "			
	6 $\frac{3}{8}$ "			Depth set
	5 $\frac{3}{16}$ "			
	3			Perf. top
	2			Perf. bottom
	Liners Used			Perf. top _____ Perf. bottom _____
CASING CEMENTED <u>10 $\frac{3}{4}$"</u> SIZE <u>204</u> No. FT. <u>8/17/73</u> Date NAME OF SERVICE COMPANY <u>Lawson</u> COAL WAS ENCOUNTERED AT _____ FEET _____ INCHES _____ FEET _____ INCHES _____ FEET _____ INCHES _____ FEET _____ INCHES _____ FEET _____ INCHES				

Drillers' Names _____

Remarks: Cementing 10 $\frac{3}{4}$ " casing.

8/17/1973
DATE

Paul W. Garrett
DISTRICT WELL INSPECTOR
08/25/2023



Kennedy, James P <james.p.kennedy@wv.gov>

Plugging permits issued 4707300680 07300490

1 message

Kennedy, James P <james.p.kennedy@wv.gov>

Tue, Aug 15, 2023 at 10:37 AM

To: Henry J Harmon <henry.j.harmon@wv.gov>, Chris Veazey <CVeazey@dgoc.com>, Austin Sutler <asutler@nexttlvenergy.com>, Isaiah M Richards <isaiah.m.richards@wv.gov>, vgorrell@assessor.state.wv.us

to whom it may concern, plugging permits have been issued for 4707300490 07300680.

James Kennedy
WVDEP OOG

2 attachments

 **4707300490.pdf**
4770K

 **4707300680.pdf**
3871K

08/25/2023