

STATE OF WEST VIRGINIA  
DEPARTMENT OF MINES  
OIL AND GAS DIVISION

NOTICE OF PROPOSED LOCATION OF OIL AND GAS WELL

To THE DEPARTMENT OF MINES,  
Charleston, W. Va.

<p style="text-align: center; font-size: small;">COAL OPERATOR OR COAL OWNER</p>	<p style="text-align: center;">Schultz Oil Co.,</p> <p style="text-align: center; font-size: small;">NAME OF WELL OPERATOR</p>
<p style="text-align: center; font-size: small;">ADDRESS</p>	<p style="text-align: center;">Saint Marys, W.Va.</p> <p style="text-align: center; font-size: small;">COMPLETE ADDRESS</p>
<p style="text-align: center; font-size: small;">COAL OPERATOR OR COAL OWNER</p>	<p style="text-align: center;">May 14, 1941, 193—</p> <p style="text-align: center; font-size: small;">PROPOSED LOCATION</p>
<p style="text-align: center; font-size: small;">ADDRESS</p>	<p style="text-align: center;">Jefferson</p> <p style="text-align: right; font-size: small;">District</p>
<p style="text-align: center;">T. C. Hammett Jr.</p> <p style="text-align: center; font-size: small;">OWNER OF MINERAL RIGHTS</p>	<p style="text-align: center;">Pleasants</p> <p style="text-align: right; font-size: small;">County</p>
<p style="text-align: center;">R.F.D. No. 4</p> <p style="text-align: center;">Saint Marys, W.Va.</p> <p style="text-align: center; font-size: small;">ADDRESS</p>	<p style="text-align: center;">Well No. 9</p> <p style="text-align: right; font-size: small;">39° 20' 81° 10'</p>
	<p style="text-align: center;">T. C. Hammett Hrs.</p> <p style="text-align: right; font-size: small;">Farm</p>

GENTLEMEN:

The undersigned well operator is entitled to drill upon the above named farm or tract of land for oil and gas, having fee title thereto, (or as the case may be) under grant or lease dated Jan. 5, 1917, made by T. C. Hammett, et al., to C. D. Sloan & R. O. Murphy, and recorded on the 29th day of Jan. 1917, in the office of the County Clerk for said County in Book 56, page 437.

The enclosed plat was prepared by a competent engineer and shows the proposed location of a well to be drilled for oil and gas by the undersigned well operator on the farm and in the Magisterial District and County above named, determined by survey and courses and distances from two permanent points, or land marks.

The undersigned well operator is informed and believes there are no coal operators operating beds of coal beneath said farm or tract of land on which said well is located, or within 500 feet of the boundaries of the same, who have mapped their workings and filed their maps as required by law, excepting the coal operators or coal owners (if any) above named as addressees.

The above named coal operators or coal owners (if any) are notified that any objections they may desire to make to such proposed location, or which they are required to make by Section 3 of said Code, if the drilling of a well at said proposed location will cause a dangerous condition in or about their respective coal mines, must be received by, or filed with the Department of Mines within ten\* days from the receipt of a copy of this notice and accompanying plat by said Department. Said coal operators are further notified that forms for use in making such objections will be furnished to them by the Department of Mines promptly on request and that all such objections must set forth as definitely as is reasonably possible the ground or grounds on which such objections are based and indicate the direction and distance the proposed location should be moved to overcome same.

(The next paragraph is to be completed only in Department's copy.)

Copies of this notice and the enclosed plat were mailed by registered mail, or delivered to the above named coal operators or coal owners at their above shown respective address \_\_\_\_\_ day \_\_\_\_\_ before, or on the same day with the mailing or delivery of this copy to the Department of Mines at Charleston, West Virginia.

Very truly yours, Schultz Oil co.

*Frank Kester*

WELL OPERATOR

Saint Marys, W.Va.

STREET

CITY OR TOWN

STATE

Address  
of  
Well Operator }



\*Section 3 . . . If no such objections be filed or be found by the department of mines, within said period of ten days from the receipt of said notice and plat by the department of mines, to said proposed location, the department shall forthwith issue to the well operator a drilling permit reciting the filing of such plat, that no objections have been made by the coal operators to the location, or found thereto by the department, and that the same is approved and the well operator authorized to proceed to drill at said location.

STATE OF WEST VIRGINIA  
DEPARTMENT OF MINES  
OIL AND GAS DIVISION

NOTICE OF PROPOSED LOCATION OF OIL AND GAS WELL

To The DEPARTMENT OF MINES  
Charleston, W. Va.

NAME OF WELL OPERATOR \_\_\_\_\_  
 ADDRESS \_\_\_\_\_  
 CITY OR TOWN \_\_\_\_\_  
 STATE \_\_\_\_\_

NAME OF WELL OPERATOR \_\_\_\_\_  
 ADDRESS \_\_\_\_\_  
 CITY OR TOWN \_\_\_\_\_  
 STATE \_\_\_\_\_

NAME OF WELL OPERATOR \_\_\_\_\_  
 ADDRESS \_\_\_\_\_  
 CITY OR TOWN \_\_\_\_\_  
 STATE \_\_\_\_\_

NAME OF WELL OPERATOR \_\_\_\_\_  
 ADDRESS \_\_\_\_\_  
 CITY OR TOWN \_\_\_\_\_  
 STATE \_\_\_\_\_

The undersigned well operator is entitled to drill upon the above named land or part of land for oil and gas having fee title thereto, (or as the case may be) under grant or lease dated \_\_\_\_\_ made by \_\_\_\_\_ to \_\_\_\_\_, and recorded on the \_\_\_\_\_ day of \_\_\_\_\_ in the office of the County Clerk for said County in \_\_\_\_\_

The enclosed plan was prepared by a competent engineer and shows the proposed location of a well to be drilled for oil and gas by the undersigned well operator on the land and in the Magisterial District and County above named, determined by survey and courses and distances from two permanent points or true marks.

The undersigned well operator is informed and believes there are no coal operators operating hereof coal beneath and part of tract of land on which said well is located, or within 500 feet of the boundary of the same, who have mapped their workings and filed their maps as required by law, excepting the coal operators or well owners (if any) whose names are given below.

The above named coal operators or well owners (if any) are notified that any objections they may desire to make to such proposed location, or which they are required to make by Section 1 of said Code, if the drilling of a well at such proposed location will cause a dangerous condition in or about their respective coal mines must be received by or filed with the Department of Mines within ten days from the receipt of a copy of this notice and accompanying plan by said Department. Said coal operators are further notified that terms for use in making such objections will be furnished to them by the Department of Mines promptly on request and that all such objections must set forth as definitely as is reasonably possible the ground or grounds on which such objections are based and indicate the direction and distance the proposed location should be moved to overcome same.

(The next paragraph is to be completed only in Department's copy.)  
 Copies of this notice and the enclosed plan were mailed by registered mail, or delivered to the above named coal operators or well owners at their above shown respective addresses \_\_\_\_\_ day \_\_\_\_\_ before \_\_\_\_\_ on the same day with the mailing or delivery of this copy to the Department of Mines at Charleston, West Virginia.

Very truly yours,  
 \_\_\_\_\_  
 WELL OPERATOR  
 \_\_\_\_\_  
 ADDRESS  
 \_\_\_\_\_  
 CITY OR TOWN  
 \_\_\_\_\_  
 STATE  
 \_\_\_\_\_

Section 1. If no such objections be filed or be found by the Department of Mines within said period of ten days from the receipt of such notice and plan by the Department of Mines, to said proposed location, the department shall forthwith issue to the well operator a drilling permit vesting the title of such land, then no objection have been made by the coal operators to the location, or found thereby by the department, and that the same is approved and the well operator authorized to proceed to drill at said location.

VICTOR E. RODEN

OFFICE 684-7879  
RES. 684-3135

P. O. BOX 269 - DAVIS BUILDING - ST. MARYS, WEST VIRGINIA

July 28, 1964

Marie E. Griffith, exc. sec,y  
Oil and Gas Division  
Department of Mines  
Charleston 5, W. Va.

Re Our phone conversation of last week

Dear Mrs. Griffith;

This letter will introduce my daughter Odessa Roden on my behalf on this errand.

I am enclosing an application and work order and plugging permit for Well Number 9, T. C. Hammett et al. We would like to start work on Thursday, July 30.

Also enclosed is a drilling premit application for the Ross et al farm.

I would appreciate it if you could process these so that she may bring them back with her.

Also enclosed is our blanket bond properly executed. I hope you find this to be in order.

I am enclosing a log for Hammett Well Number 9 which we are plugging. I do not know whether it will be of value to you.

As I do not have Mr. Harry Stevens address and telephone number will you please give this to me?

I am needing some supplies and a list is attached. I will appreciate this greatly.

I am sincerely grateful for your help that you gave me on the phone and your cooperation in processing these papers.

Sincerely,

*Victor E. Roden*  
Victor E. Roden

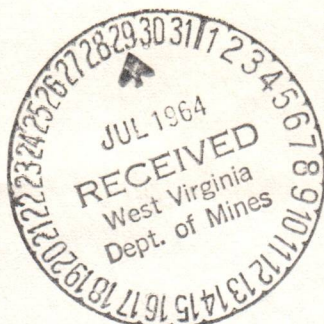



State of West Virginia

Department of Mines  
Oil and Gas Division  
Charleston 5

W. F. EIGENBROD  
DIRECTOR

MARIE GRIFFITH  
EXECUTIVE SECRETARY

GURMER WAMOCK  
DEPUTY DIRECTOR

January 20, 1965

*Winters Oil, Inc.  
Development Co.*

Schultz Oil Company  
Saint Marys, West Virginia

Att: Mr. Frank Hester

RE: PERMIT PLEAS-1980P  
WELL 9  
FARM T. C. Hammett  
DISTRICT Jefferson  
COUNTY Pleasants

Gentlemen:

Please send us the affidavit of filling and plugging for the above described well. If plugging has not been completed, please advise.

We will appreciate the information within the next ten days.

Very truly yours,

*Marie E. Griffith*  
Marie E. Griffith  
Executive Secretary  
OIL AND GAS DIVISION

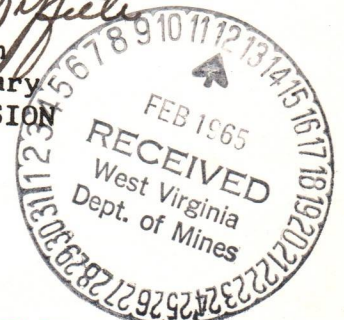

*Sorry -  
We did not plug  
this well.  
We sold this lease  
in 1962 to Victor  
Roden of Sams Bros.*

*Victor Roden  
of St. Marys is  
manager. Respectfully,  
Frank Hester.*

*Sold  
about  
July 1, 1962*

MEG/ap

AFFIDAVIT, FORM OG-8, MANNER WELL PLUGGED MUST BE  
SUBMITTED TO OBTAIN RELEASE OF WELL UNDER BOND.

STATE OF WEST VIRGINIA  
DEPARTMENT OF MINES  
OIL AND GAS DIVISION

WELL RECORD

Permit No. *198*

Oil or Gas Well *Oil*  
(KIND)

*St. Marys*  
*Blues*

Company *Schultz Oil Co.*  
Address *St. Marys, R. F. D. 1.*  
Farm *J. G. Hammett Mrs.* Acres *150*  
Location (waters) *Bull Creek*  
Well No. *9* Elev. *995*  
District *Jefferson* County *Pleasants*  
The surface of tract is owned in fee by *J. G. Hammett Mrs.*  
Address \_\_\_\_\_  
Mineral rights are owned by *Same*  
Address \_\_\_\_\_  
Drilling commenced *July 9, 1941*  
Drilling completed *Aug. 9, 1941*  
Date shot \_\_\_\_\_ Depth of shot \_\_\_\_\_  
Open Flow /10ths Water in \_\_\_\_\_ Inch  
/10ths Merc. in \_\_\_\_\_ Inch  
Volume \_\_\_\_\_ Cu. Ft.  
Rock Pressure \_\_\_\_\_ lbs. \_\_\_\_\_ hrs.  
Oil *7.0 (natural)* bbls., 1st 24 hrs.  
Fresh water \_\_\_\_\_ feet \_\_\_\_\_ feet  
Salt water \_\_\_\_\_ feet \_\_\_\_\_ feet

Casing and Tubing	Used in Drilling	Left in Well	Packers
Size			Kind of Packer
16			
13			
10 <i>2.00</i>			Size of
<i>8 1/4 1.018</i>			
<i>6 5/8 1.683</i>		<i>1.683</i>	Depth set
<i>5 3/16</i>			
3			Perf. top
2			Perf. bottom
Liners Used			Perf. top
			Perf. bottom

CASING CEMENTED \_\_\_\_\_ SIZE \_\_\_\_\_ No. Ft. \_\_\_\_\_ Date \_\_\_\_\_  
COAL WAS ENCOUNTERED AT \_\_\_\_\_ FEET \_\_\_\_\_ INCHES  
\_\_\_\_\_ FEET \_\_\_\_\_ INCHES \_\_\_\_\_ FEET \_\_\_\_\_ INCHES  
\_\_\_\_\_ FEET \_\_\_\_\_ INCHES \_\_\_\_\_ FEET \_\_\_\_\_ INCHES

Formation	Color	Hard or Soft	Top	Bottom	Oil, Gas or Water	Depth Found	Remarks
<i>Slate</i>			<i>0</i>	<i>15</i>			
<i>Red Rock</i>			<i>15</i>	<i>60</i>			
<i>White slate</i>			<i>60</i>	<i>160</i>			
<i>Shells</i>			<i>160</i>	<i>180</i>			
<i>Red Rock</i>			<i>180</i>	<i>240</i>			
<i>White slate</i>			<i>240</i>	<i>360</i>			
<i>Red Rock</i>			<i>360</i>	<i>430</i>			
<i>Gritty Lime</i>			<i>430</i>	<i>470</i>			
<i>Red Rock</i>			<i>470</i>	<i>500</i>			
<i>White Slate</i>			<i>500</i>	<i>625</i>			
<i>Red Rock</i>			<i>625</i>	<i>735</i>			
<i>White Slate</i>			<i>735</i>	<i>775</i>			
<i>Sand</i>			<i>775</i>	<i>810</i>			
<i>White Slate</i>			<i>810</i>	<i>820</i>			
<i>Red Rock</i>			<i>820</i>	<i>865</i>			
<i>White Slate</i>			<i>865</i>	<i>870</i>			
<i>Red Rock</i>			<i>870</i>	<i>900</i>			
<i>Sand</i>			<i>900</i>	<i>925</i>			
<i>White Slate</i>			<i>925</i>	<i>935</i>			
<i>Black "</i>			<i>935</i>	<i>945</i>			
<i>White "</i>			<i>945</i>	<i>965</i>			

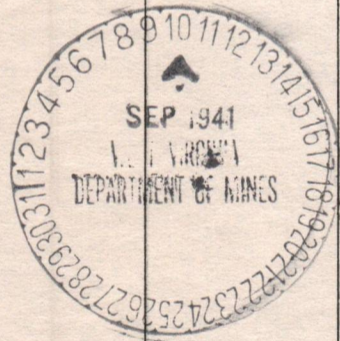

*P.A.S.*

WELL RECORD

APPROVED *John O. Co.*

By *John O. Co. manager* (Title)

Date *Sept 5*, 1947

Formation	Color	Hard or Soft	Top	Bottom	Oil, Gas or Water	Depth Found	Remarks
Black slate			965	1000			
fine			1000	1008			
Pink Rock			1008	1018			
White slate			1018	1136			
band			1136	1200			
White slate			1200	1275			
band			1275	1350		1304-08	30,000
White slate			1350	1375			
Black "			1375	1430			
band			1430	1515			
Black slate			1515	1570			
band			1570	1652		1589-92	small.
Black slate			1652	1658			
band			1658	1675			
Big fine			1675	1751			
<del>band</del>							
Keener band			1751	1775		1765-71	small
Break			1775	1780			
Synum band			1780	1825		1802-07	1000 ft. Nat.
Break			1825	1830			
band.			1830	1880			
Slate (Black)			1880	1882			
Synum band			1882	1901		1884-1901	70 ft.
Black slate			1901	1912			

*has not been shot.*

STATE OF WEST VIRGINIA  
DEPARTMENT OF MINES  
OIL AND GAS DIVISION

**INSPECTOR'S PLUGGING REPORT**

Permit No. Pleas-198-P Well No. 9

COMPANY W.Va. Development Co. ADDRESS \_\_\_\_\_

FARM T.S. Hammett DISTRICT Jefferson COUNTY Pleasant

Filling Material Used Clay, Stone & Cement

Liner	Location	Amount	Packer	Location		
PLUGS USED AND DEPTH PLACED						
CEMENT-THICKNESS	WOOD-SIZE	LEAD	BRIDGES			
			CONSTRUCTION-LOCATION	CASING AND TUBING		
				RECOVERED	SIZE	LOST
Clay	1912-18	1860				
Stone	1860-	1855				
Cement	1855-	1845				
Clay	1845-	1731				
Stone	1731-	1726				
Bridge	1000'					
Clay	1000-	990				
Cement	990-	980				
Trying to cut and pull at 800'						

Drillers' Names Joe Souza Harry Westbrook  
Victor Boden, Foreman

Remarks:



8-7-64 I hereby certify I visited the above well on this date.  
DATE

Dreyer Shuman  
DISTRICT WELL INSPECTOR

STATE OF WEST VIRGINIA  
DEPARTMENT OF MINES  
OIL AND GAS DIVISION

- Rotary
- Spudder
- Cable Tools
- Storage

### INSPECTOR'S WELL REPORT

Permit No. \_\_\_\_\_

Oil or Gas Well \_\_\_\_\_  
(KIND)

	CASING AND TUBING	USED IN DRILLING	LEFT IN WELL	PACKERS
Company _____	Size			
Address _____	16			Kind of Packer _____
Farm _____	13			
Well No. _____	10			Size of _____
District _____ County _____	8 1/4			
Drilling commenced _____	6 5/8			Depth set _____
Drilling completed _____ Total depth _____	5 3/16			
Date shot _____ Depth of shot _____	3			Perf. top _____
Initial open flow _____ /10ths Water in _____ Inch	2			Perf. bottom _____
Open flow after tubing _____ /10ths Merc. in _____ Inch	Liners Used			Perf. top _____
Volume _____ Cu. Ft.				Perf. bottom _____
Rock pressure _____ lbs. _____ hrs.	CASING CEMENTED _____ SIZE _____ No. FT. _____ Date _____			
Oil _____ bbls., 1st 24 hrs.	NAME OF SERVICE COMPANY _____			
Fresh water _____ feet _____ feet	COAL WAS ENCOUNTERED AT _____ FEET _____ INCHES			
Salt water _____ feet _____ feet	_____ FEET _____ INCHES _____ FEET _____ INCHES			
	_____ FEET _____ INCHES _____ FEET _____ INCHES			

Drillers' Names \_\_\_\_\_

Remarks: \_\_\_\_\_

DATE

DISTRICT WELL INSPECTOR





STATE OF WEST VIRGINIA  
DEPARTMENT OF MINES  
OIL AND GAS DIVISION

Rotary   
Spudder   
Cable Tools   
Storage

## INSPECTOR'S WELL REPORT

Permit No. \_\_\_\_\_

Oil or Gas Well \_\_\_\_\_  
(KIND)

	CASING AND TUBING	USED IN DRILLING	LEFT IN WELL	PACKERS
Company _____	Size			Kind of Packer _____
Address _____	16			
Farm _____	13			Size of _____
Well No. _____	10			
District _____ County _____	8 1/4			Depth set _____
Drilling commenced _____	6 5/8			
Drilling completed _____ Total depth _____	5 3/16			Perf. top _____
Date shot _____ Depth of shot _____	3			
Initial open flow _____ /10ths Water in _____ Inch	2			Perf. bottom _____
Open flow after tubing _____ /10ths Merc. in _____ Inch	Liners Used _____			Perf. top _____
Volume _____ Cu. Ft.				Perf. bottom _____
Rock pressure _____ lbs. _____ hrs.	CASING CEMENTED _____ SIZE _____ No. FT. _____ Date _____			
Oil _____ bbls., 1st 24 hrs.	NAME OF SERVICE COMPANY _____			
Fresh water _____ feet _____ feet	COAL WAS ENCOUNTERED AT _____ FEET _____ INCHES			
Salt water _____ feet _____ feet	_____ FEET _____ INCHES _____ FEET _____ INCHES			
	_____ FEET _____ INCHES _____ FEET _____ INCHES			

Drillers' Names \_\_\_\_\_

Remarks:

DATE

DISTRICT WELL INSPECTOR



STATE OF WEST VIRGINIA  
DEPARTMENT OF MINES  
OIL AND GAS WELLS DIVISION

INSPECTOR'S WELL REPORT

Permit No. \_\_\_\_\_

Oil or Gas Well \_\_\_\_\_  
(KIND)

	CASING AND TUBING	USED IN DRILLING	LEFT IN WELL	PACKERS
Company _____	Size			Kind of Packer _____
Address _____	16 _____			
Farm _____	13 _____			
Well No. _____	10 _____			Size of _____
District _____ County _____	8 1/4 _____			
Drilling commenced _____	6 5/8 _____			Depth set _____
Drilling completed _____ Total depth _____	5 3/16 _____			
Date shot _____ Depth of shot _____	3 _____			Perf. top _____
Initial open flow _____ /10ths Water in _____ Inch	2 _____			Perf. bottom _____
Open flow after tubing _____ /10ths Merc. in _____ Inch	Liners Used _____			Perf. top _____
Volume _____ Cu. Ft.				Perf. bottom _____
Rock pressure _____ lbs. _____ hrs.	CASING CEMENTED _____ SIZE _____ No. FT. _____ Date _____			
Oil _____ bbls., 1st 24 hrs.	NAME OF SERVICE COMPANY _____			
Fresh water _____ feet _____ feet	COAL WAS ENCOUNTERED AT _____ FEET _____ INCHES			
Salt water _____ feet _____ feet	_____ FEET _____ INCHES _____ FEET _____ INCHES			
	_____ FEET _____ INCHES _____ FEET _____ INCHES			

Drillers' Names \_\_\_\_\_

Remarks: \_\_\_\_\_



STATE OF WEST VIRGINIA  
DEPARTMENT OF MINES  
OIL AND GAS WELLS DIVISION

## INSPECTOR'S WELL REPORT

Permit No. \_\_\_\_\_

Oil or Gas Well \_\_\_\_\_  
(KIND)

	CASING AND TUBING	USED IN DRILLING	LEFT IN WELL	PACKERS
Company _____	Size			
Address _____	16			Kind of Packer _____
Farm _____	13			
Well No. _____	10			Size of _____
District _____ County _____	8 1/4			
Drilling commenced _____	6 5/8			Depth set _____
Drilling completed _____ Total depth _____	5 3/16			
Date shot _____ Depth of shot _____	3			Perf. top _____
Initial open flow _____ /10ths Water in _____ Inch	2			Perf. bottom _____
Open flow after tubing _____ /10ths Merc. in _____ Inch	Liners Used			Perf. top _____
Volume _____ Cu. Ft.				Perf. bottom _____
Rock pressure _____ lbs. _____ hrs.	CASING CEMENTED _____ SIZE _____ No. FT. _____ Date _____			
Oil _____ bbls., 1st 24 hrs.	NAME OF SERVICE COMPANY _____			
Fresh water _____ feet _____ feet	COAL WAS ENCOUNTERED AT _____ FEET _____ INCHES			
Salt water _____ feet _____ feet	_____ FEET _____ INCHES _____ FEET _____ INCHES			
	_____ FEET _____ INCHES _____ FEET _____ INCHES			

Drillers' Names \_\_\_\_\_

Remarks: \_\_\_\_\_



Plat Filed  
Schultz Oil Co.  
Permit # 198

STATE OF WEST VIRGINIA  
DEPARTMENT OF MINES  
OIL AND GAS DIVISION

NOTICE OF INTENTION TO PLUG AND ABANDON WELL

(REQUIRED BY SECTION 9, ARTICLE 4, CHAPTER 22 OF THE CODE)

To THE DEPARTMENT OF MINES,  
Charleston, W. Va.

None  
Coal Operator

W. Va. Development Co.  
Name of Well Operator

None  
Address

P. O. Box 269 St. Marys, W. Va. 26170  
Complete Address

None  
Coal Owner

July 28, 1964  
Date

WELL TO BE ABANDONED

None  
Address

Jefferson District

T. C. Hammett et al  
Lease or Property Owner

Pleasants County

St. Marys, W. Va.  
Address

Well No. 9

T. C. Hammett Farm

Inspector to be notified Mr. Bryan Shuman Telephone Number TU-9-5674  
Wileyville, West Virginia

Gentlemen:— **24 HRS. IN ADVANCE OF PLUGGING**

The undersigned well operator is about to abandon the above described well and will commence

the work of plugging and abandoning said well on the date inspector is notified (which date shall not be less than five days after the day on which this notice so mailed is received, or in due course should be received by the Department of Mines).

This notice is given you in order that your respective representatives may be present at the plugging and filling of said well. You are further notified that whether you are represented or not represented the undersigned will proceed on that date, or shortly thereafter, to plug and fill said well in the manner required by Section 10, Article 4, Chapter 22 of the Code and given in detail on the reverse side of this notice, in "Work Order."

This notice is being mailed by registered mail to each of you at the above addresses on the above date.

Very truly yours,  
W. Va. Development Co.  
Victor E. Roden  
Well Operator

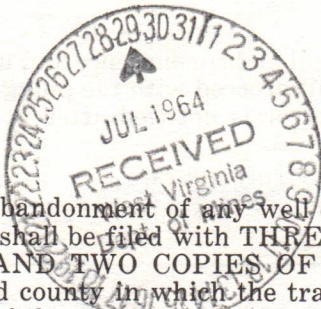

NOTE: Upon the abandonment of any well drilled prior to June 1, 1929, a plat prepared by a registered engineer, shall be filed with THREE COPIES OF APPLICATION, (OG-9) AND "WORK ORDER" AND TWO COPIES OF THE WELL RECORD, (OG-10). The map must show the district and county in which the tract of land is located, the name and acreage of same, the name or names of the owners and names of adjacent tracts and the location of the well to be abandoned, determined by survey with the courses and distances of such well from two permanent points or landmarks on said tract.

NOTE: In case plugging is not commenced within four months from the date of permit, same shall expire and be of no further force or effect.

NOTE: PERMIT IS NOT TRANSFERABLE.

BLANKET BOND

PLEAS-198-P

Permit Number

Pleas-198-P

PROPOSED MANNER OF PLUGGING AND FILLING WELL

(REQUIRED BY RULES AND REGULATIONS)

WEST VIRGINIA DEPARTMENT OF MINES

OIL AND GAS DIVISION

WORK ORDER

Well to be plugged and filled as follows:

Fill with red clay in shot hole and up to 1862 feet. Set permanent bridge 1862, 20 feet above shot hole. 2 sacks Best Cement and 5 feet of crushed stone.

Fill with clay to 1731, 20 feet above keener sand. Set permanent bridge 1731, 20 feet above keener sand. 2 sacks Best Cement and 5 feet crushed stone.

Start to pull 7 inch casing set at 1683 feet. Fill with clay to 1255, 20 feet above salt sand. Set permanent bridge 1255, 2 bags Best Cement and 5 feet of crushed stone. Continue to fill to 220 feet, 20 feet below fresh water point. Set permanent bridge, 2 sacks Best Cement and 5 feet crushed stone, fill with clay to surface.

Erect marker such as is described in Rule 12 of July 1, 1963 regulations.

To the Department of Mines  
Coal Owner or Operator,  
Lease or Property Owner.

Gentlemen:

This "work order" is submitted for your approval and concurrence and unless notified of your disapproval or non-concurrence, the undersigned will proceed with the plugging and filling of said well in the above described manner on the date inspector is notified after permit is issued.

Very truly yours,  
W. Va. Development Co.

Well Operator

No objections have been filed by the coal owner or coal operator, or any available adjacent lease or property owners or interposed by the Department of Mines to the manner herein described for the plugging and filling of the well above mentioned. Therefore, the same is hereby approved this

29th day of July, 1964.

DEPARTMENT OF MINES  
Oil and Gas Division

By: Marie E. Griffith

NOTE: This "work order" shall be filed in triplicate, one copy for the files of the Department of Mines; one to be approved or corrected and returned to the well operator as his authority for plugging said well; and one for the well inspector.







State of West Virginia

Department of Mines

Oil and Gas Division

Charleston 25305

W.Va. Development Company  
Victor E. Roden  
P.O. Box 269  
St. Marys, W.Va. 26170

In Re: Permit No. PLEAS-198-P  
Farm T. C. Hammett  
Well No. 9  
District Jefferson  
County Pleasants

Gentlemen:

The final inspection report for the well which is described above has been received in this office. Only the column checked below applies.

XXXXXX The bond covering the well designated by the above permit number has been released under your Blanket Bond.

         Please return the enclosed cancelled bond which covered the well designated by the above permit number to the Surety Company who executed said bond in your behalf, in order that they may give you credit on their records.

Very truly yours,

Deputy Director  
Oil and Gas Division

RLD/ch  
Enclosure:

**RECEIVED**  
MAY 10 1985  
OIL & GAS DIVISION  
DEPT. OF MINES



**RECEIVED**  
MAY 3 - 1985  
OIL & GAS DIVISION  
DEPT. OF MINES

**State of West Virginia**  
**Department of Mines**  
**Oil and Gas Division**  
**Charleston 25305**

FINAL INSPECTION REPORT  
INSPECTORS COMPLIANCE REPORT  
July 27, 1984

COMPANY West Virginia Development Co.

PERMIT NO 073-0198-P

P. O. Box 269

FARM & WELL NO T. C. Hammett #9

St. Marys, West Virginia 26170

DIST. & COUNTY Jefferson/Pleasants

RULE	DESCRIPTION	IN COMPLIANCE	
		Yes	No
23.06	Notification Prior to Starting Work	<input checked="" type="checkbox"/>	<input type="checkbox"/>
16.01	Required Permits at Wellsite	<input checked="" type="checkbox"/>	<input type="checkbox"/>
17.02	Method of Plugging	<input checked="" type="checkbox"/>	<input type="checkbox"/>
18.01	Materials used in Plugging	<input checked="" type="checkbox"/>	<input type="checkbox"/>
23.02	Maintained Access Roads	<input checked="" type="checkbox"/>	<input type="checkbox"/>
25.01	Necessary Equipment to Prevent Waste	<input checked="" type="checkbox"/>	<input type="checkbox"/>
23.04	Reclaimed Drilling Pits	<input checked="" type="checkbox"/>	<input type="checkbox"/>
23.05	No Surface or Underground Pollution	<input checked="" type="checkbox"/>	<input type="checkbox"/>
17.06	Statutory Affidavit	<input checked="" type="checkbox"/>	<input type="checkbox"/>
7.06	Parties Responsible	<input checked="" type="checkbox"/>	<input type="checkbox"/>
7.05	Identification Markings	<input checked="" type="checkbox"/>	<input type="checkbox"/>

I HAVE INSPECTED THE ABOVE CAPTIONED WELL AND RECOMMEND THAT IT BE RELEASED:

SIGNED P. A. Lowther

DATE Apr 28, 1985

Your Affidavit of Plugging was received and reclamation requirements approved.  
The well designated by the above permit number has been released under your bond.

T. H. B.

Administrator-Oil & Gas Division

May 6, 1985  
DATE

DEPT. OF MINES  
OIL & GAS DIVISION  
MAY 3 - 1932  
RECEIVED

DEPT. OF MINES  
OIL & GAS DIVISION  
MAY 1 9 32  
RECEIVED

*Handwritten signature*

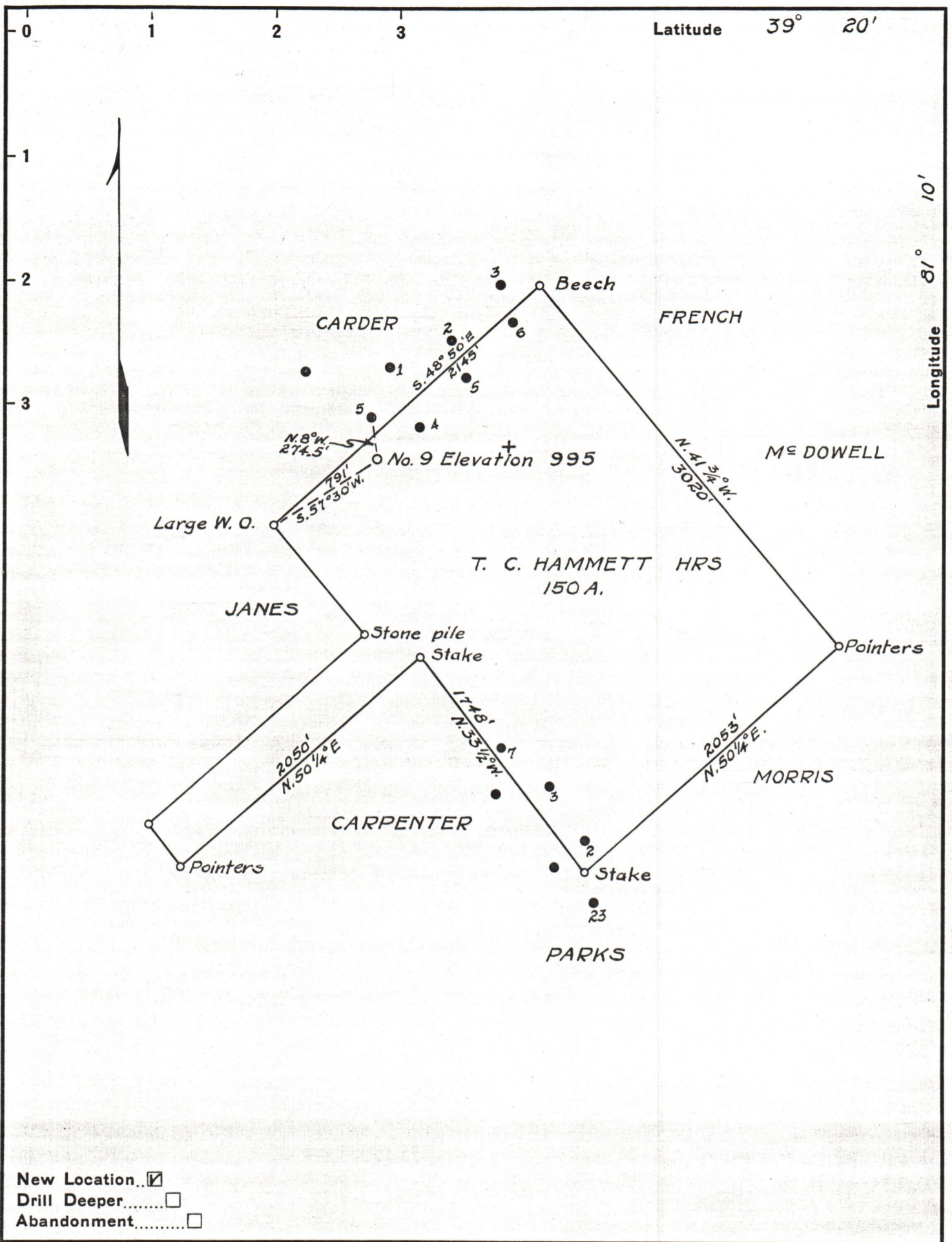

New Location...    
 Drill Deeper.....    
 Abandonment.....

Company SCHULTZ OIL CO   
 Address SAINT MARYS, W.VA.   
 Farm T. C. HAMMETT HRS.   
 Tract \_\_\_\_\_ Acres 150 Lease No. \_\_\_\_\_   
 Well (Farm) No. 9 Serial No. \_\_\_\_\_   
 Elevation (Spirit Level) 995   
 Quadrangle SAINT MARYS   
 County PLEASANTS District JEFFERSON   
 Engineer B. F. Rinchart   
 Engineer's Registration No. 648   
 File No. \_\_\_\_\_ Drawing No. 268-J-P   
 Date May 14, 1945 Scale 1 in. = 800 ft.

STATE OF WEST VIRGINIA   
 DEPARTMENT OF MINES   
 OIL AND GAS DIVISION   
 CHARLESTON

WELL LOCATION MAP   
 FILE NO. PLEAS-198

+ Denotes location of well on United States Topographic Maps, scale 1 to 62,500, latitude and longitude lines being represented by border lines as shown.

- Denotes one inch spaces on border line of original tracing.



State of West Virginia

Department of Mines

Oil and Gas Division

Charleston 25305

May 19, 1975

W.Va. Development Company  
P.O. Box 269  
St. Marys, W.Va. 26170

Attn: Mr. Victor E. Roden

# S 5721

In Re: \$10,000.00 Blanket Bond  
dated - 7-20-64

Dear Mr. Roden:

As of July 11, 1973, status changes were made increasing blanket bonds from \$10,000.00 to \$15,000.00 and Single Bonds from \$1,000.00 to \$2,500.00.

We have the above blanket bond on file for your company that is invalid and should be cancelled. We are enclosing revised Blanket Bond forms, if you should wish to execute one for the amount of \$15,000.00.

Before the \$10,000.00 Blanket Bond can be cancelled, however, we need the affidavit of plugging for PLEAS-198-P - T. C. Hammett # 9 well in Jefferson district of Pleasants county. We have made several requests for this affidavit without any response from you. A violation will be posted for this well and you will be given so many days to submit the affidavit. The above bond can be forfeited if you do not comply with the rules and regulations of the W.Va. Code.

We have enclosed, OG-8 (Affidavit forms) and copies of the inspector's reports to aide you with this affidavit...If you should have any questions, please call - 348-2055 or 2057..

Very truly yours,

Robert L. Dodd, Deputy Director  
Oil & Gas Division  
1204 Kanawha Blvd. E.  
Charleston, W.Va. 25301

RLD/cc

Encl: bond forms, OG-8's, memo of status changes  
cc: National Grange Mutual Ins. Co., Keene, New Hampshire 03431-Thomas Dotson