

Wm. HIGGINS

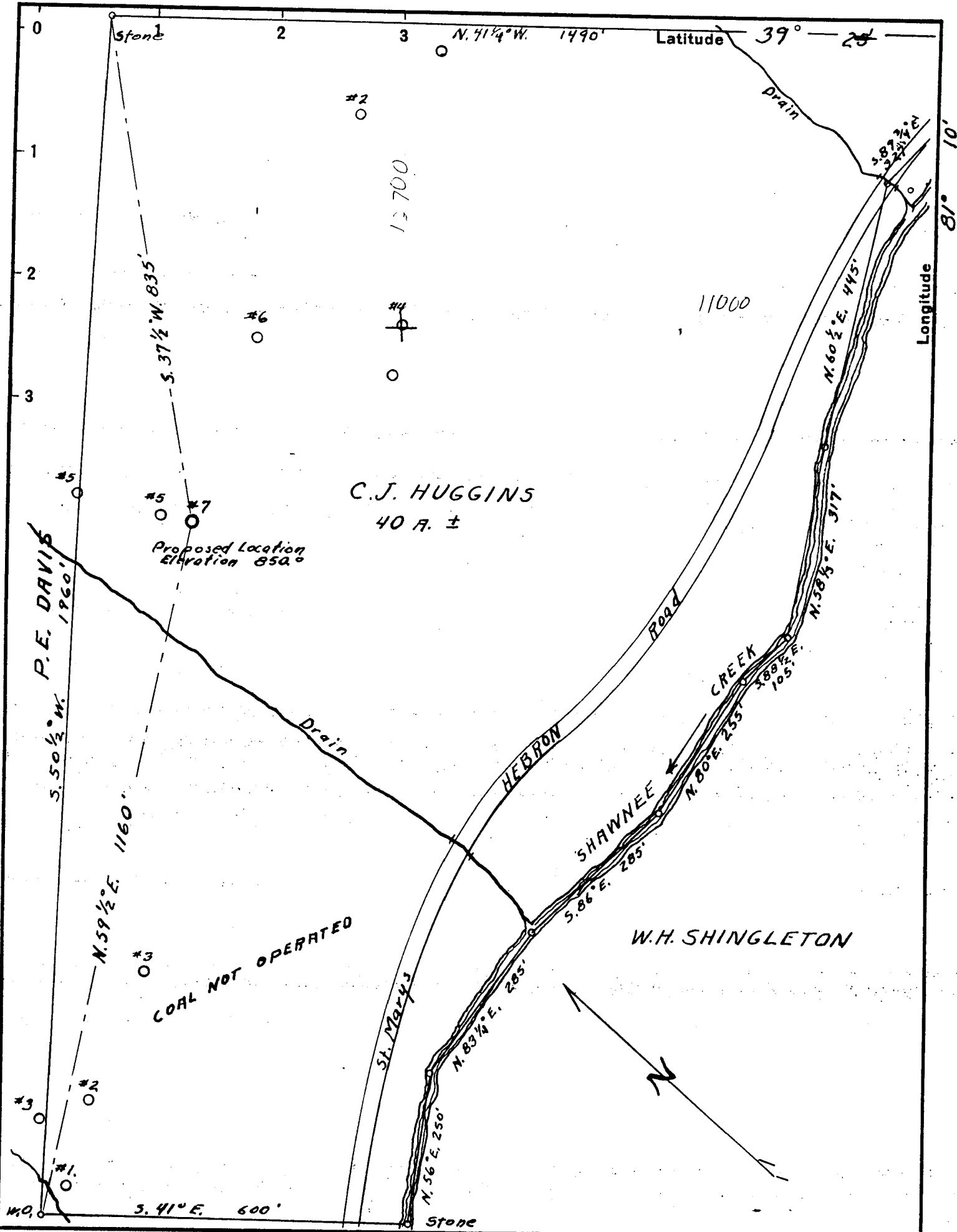

C.J. HUGGINS
40 A. ±

Proposed Location
Elevation 850.0

COAL NOT OPERATED

W.H. SHINGLETON

Company DINSMOOR AND COMPANY
 Address SAINT MARYS, W.VA.
 Farm C.J. HUGGINS
 Tract 40 Acres _____ Lease No. _____
 Well (Farm) No. 7 Serial No. _____
 Elevation (Spirit Level) 850.0
 Quadrangle St. Marys
 County Pleasants District McKim
 Engineer F.M. Chambers
 Engineer's Registration No. 771
 File No. _____ Drawing No. _____
 Date 11-16-1936 Scale 1" = 200'

STATE OF WEST VIRGINIA
DEPARTMENT OF MINES
OIL AND GAS DIVISION
CHARLESTON

WELL LOCATION MAP
FILE NO. PLEAS-79

+ Denotes location of well on United States Topographic Maps, scale 1 to 62,500, latitude and longitude lines being represented by border lines as shown.

- Denotes one inch spaces on border line of original tracing.

WEST VIRGINIA DEPARTMENT OF MINES

OIL AND GAS DIVISION

WELL RECORD

Permit No. Pleas-79

Gas Well

St. Marys Quid.

Company - Dinamor & Company
 Address - St. Marys, W. Va.
 Farm - C. J. Huggins. Acres- 40
 Location -
 Well No. - Seven. Elev. 350
 District - ~~McKin~~, County- Pleasants
 Surface & Mineral - ~~C. H. Huggins Estate,~~
 R.#39, St. Marys, W.Va.
 C. H. McCullough,
 R.#2, Pennsboro, W.Va.
 Drilling - Commenced-
 Completed
 Date Shot - Depth- 832-848
 Open Flow -
 Rock Press.-
 Oil -
 Fresh Water-
 Salt Water -

CASING & TUBING

10	11'
8 $\frac{1}{2}$	340'
6 $\frac{1}{2}$	820'

Formation	Color ^{H₀₁}			Result	Formation	Color ^{H₀₁}			Result
	Top	Bottom	Result			Top	Bottom	Result	
Shale & Sand		620							
Big Red (shale)		620	710						
Interval (shale)		710	745						
Shale Black		745	752						
Interval (slate & shale)		752	820						
Cow Run Sand 2 nd		820	851						
Parting in sand		832	833						
Pebbles		825	330						
Pebbles		840	845						
Oil		832							

RECEIVED

MAY 11 1937

WEST VIRGINIA
GEOLOGICAL SURVEY