



SWN PRODUCTION COMPANY, LLC



Location: Ohio County, WV
 Field: Ohio
 Facility: Roy Riggle OHI Pad

Slot: 201H
 Well: Roy Riggle OHI 201H
 Wellbore: Roy Riggle OHI 201H AWB

Plot reference wellpath is Roy Riggle OHI 201H awp Proj: 22250'	Grid System: NAD83 / UTM Zone 17 North, US feet
True vertical depths are referenced to SDC 40 (KB)	North Reference: Grid north
Reference wellpath measured depths are referenced to SDC 40 (KB)	Scale: True distance
SDC 40 (KB) to Mean Sea Level: 1277.9 feet	Coordinates are in feet referenced to Slot
Mean Sea Level to Ground level (At Slot: 201H): -1252.3 feet	Depths are in feet
Offset wellpath MDs are referenced to each path's default MD datum	Created by: tranlam on 2023-12-12; Database: WA_MPL_EASTERNUS_Defn

Location Information

Facility Name			Grid East (US ft)	Grid North (US ft)	Latitude	Longitude
Roy Riggle OHI Pad			1773447.520	14582274.947	40°09'5.5690"N	80°31'26.1230"W
Slot	Local N (ft)	Local E (ft)	Grid East (US ft)	Grid North (US ft)	Latitude	Longitude
201H	7.87	-17.47	1773430.060	14582282.810	40°09'5.6477"N	80°31'26.3474"W
SDC 40 (KB) to Ground level (At Slot: 201H)					25.6ft	
Mean Sea Level to Ground level (At Slot: 201H)					-1252.3ft	
SDC 40 (KB) to Mean Sea Level					1277.9ft	

Bottom Hole Location

MD (ft)	Inc (°)	Az (°)	TVD (ft)	Local N (ft)	Local E (ft)	Grid East (US ft)	Grid North (US ft)	Latitude	Longitude
22250.00	90.340	340.860	6225.39	13153.13	-6906.25	1766526.45	14595430.92	40°11'15.9820"N	80°32'54.4250"W

API: 47069003640000
 BH JOB: 112037083
 DURATION: 12/2/2023 - 12/8/2023
 RIG: SDC 40

RECEIVED
 Office Of Oil and Gas
 APR 30 2024
 WV Department of
 Environmental Protection

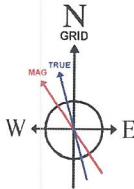

User specified Dip: 67.17° Field: 52162 nT
 Magnetic North is 8.55 degrees West of True North (at 11/27/2023)
 Grid North is 0.31 degrees East of True North
 To correct azimuth from True to Grid subtract 0.31 degrees
 To correct azimuth from Magnetic to Grid subtract 8.86 degrees

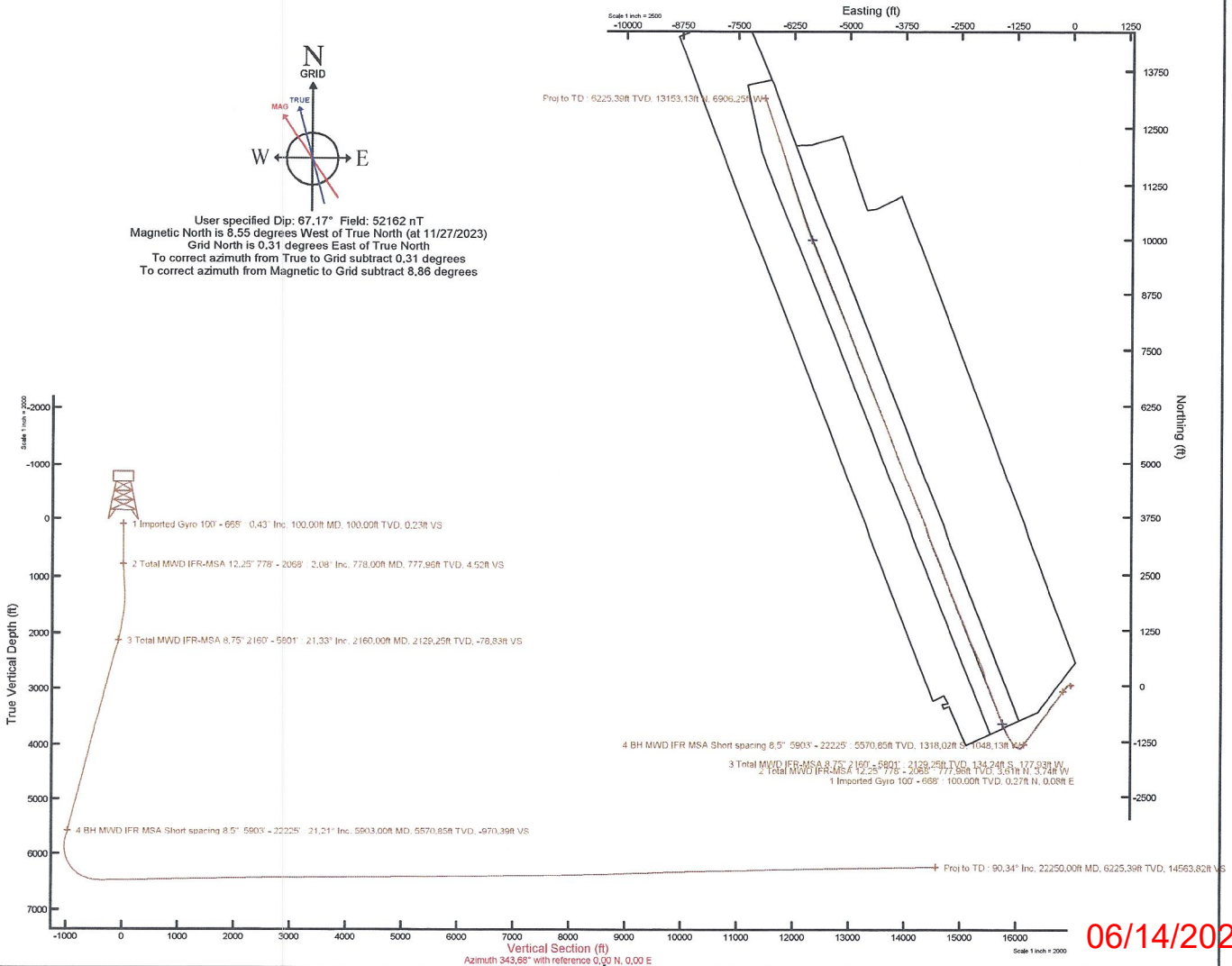

06/14/2024

REFERENCE WELLPATH IDENTIFICATION

Operator	SWN PRODUCTION COMPANY, LLC	Well	Roy Riggle OHI 201H
Field	Ohio	API	47069003640000
Facility	Roy Riggle OHI Pad	Wellbore	Roy Riggle OHI 201H AWB
Slot	201H		

REPORT SETUP INFORMATION

Projection System	NAD83 / UTM Zone 17 North, US feet	Software System	WellArchitect® 6.0
North Reference	Grid	User	Tranlam
Scale	0.999620	Report Generated	12/12/2023 at 11:40:45 AM
Convergence at slot	0.31° East	Database	WA_MPL_EASTERNU_Defn

WELLPATH LOCATION

	Local coordinates		Grid coordinates		Geographic coordinates	
	North[ft]	East[ft]	Easting[US ft]	Northing[US ft]	Latitude	Longitude
Slot Location	7.87	-17.47	1773430.06	14582282.81	40°09'5.6477"N	80°31'26.3474"W
Facility Reference Pt			1773447.52	14582274.95	40°09'5.5690"N	80°31'26.1230"W
Field Reference Pt			0.00	0.00	0°00'0.0000"	85°29'19.4780"W

WELLPATH DATUM

Calculation method	Minimum curvature	SDC 40 (KB) to Facility Vertical Datum	1277.90ft
Horizontal Reference Pt	Slot	SDC 40 (KB) to Mean Sea Level	1277.90ft
Vertical Reference Pt	SDC 40 (KB)	SDC 40 (KB) to Ground Level at Slot (201H)	25.60ft
MD Reference Pt	SDC 40 (KB)	Section Origin	N 0.00, E 0.00 ft
Field Vertical Reference	Mean Sea Level	Section Azimuth	343.68°

RECEIVED
Office Of Oil and Gas
APR 30 2024
WV Department of
Environmental Protection

RECEIVED
Office Of Oil and Gas
APR 30 2024
WV Department of
Environmental Protection



Southwestern Energy®

RECEIVED
Office Of Oil and Gas

APR 30 2024

WV Department of
Environmental Protection

Actual Wellpath Report

Roy Riggle OHI 201H awp Proj: 22250'

Page 2 of 11



REFERENCE WELLPATH IDENTIFICATION

Operator	SWN PRODUCTION COMPANY, LLC	Well	Roy Riggle OHI 201H
Field	Ohio	API	47069003640000
Facility	Roy Riggle OHI Pad	Wellbore	Roy Riggle OHI 201H AWB
Slot	201H		

WELLPATH DATA (247 stations) † = interpolated, ‡ = extrapolated station

MD [ft]	Inclination [°]	Azimuth [°]	TVD [ft]	Vert Sect [ft]	North [ft]	East [ft]	Grid East [US ft]	Grid North [US ft]	Latitude	Longitude	Closure Dist [ft]	Closure Dir [°]	DLS [°/100ft]
0.00†	0.000	16.120	0.00	0.00	0.00	0.00	1773430.06	14582282.81	40°09'5.6477"N	80°31'26.3474"W	0.00	0.000	0.00
26.00	0.000	16.120	26.00	0.00	0.00	0.00	1773430.06	14582282.81	40°09'5.6477"N	80°31'26.3474"W	0.00	0.000	0.00
100.00	0.430	16.120	100.00	0.23	0.27	0.08	1773430.14	14582283.08	40°09'5.6503"N	80°31'26.3464"W	0.28	16.120	0.58
150.00	0.330	358.140	150.00	0.53	0.59	0.12	1773430.18	14582283.40	40°09'5.6535"N	80°31'26.3457"W	0.60	11.899	0.31
200.00	0.380	323.530	200.00	0.83	0.87	0.02	1773430.08	14582283.68	40°09'5.6562"N	80°31'26.3471"W	0.87	1.405	0.43
250.00	0.340	324.220	250.00	1.12	1.12	-0.16	1773429.90	14582283.93	40°09'5.6588"N	80°31'26.3494"W	1.13	351.683	0.08
300.00	0.300	329.350	300.00	1.39	1.35	-0.32	1773429.74	14582284.16	40°09'5.6611"N	80°31'26.3514"W	1.39	346.812	0.10
350.00	0.260	320.690	349.99	1.62	1.56	-0.46	1773429.60	14582284.36	40°09'5.6631"N	80°31'26.3532"W	1.62	343.656	0.12
400.00	0.180	295.210	399.99	1.78	1.68	-0.60	1773429.46	14582284.49	40°09'5.6643"N	80°31'26.3550"W	1.78	340.338	0.25
450.00	0.110	286.400	449.99	1.86	1.72	-0.72	1773429.34	14582284.53	40°09'5.6647"N	80°31'26.3565"W	1.87	337.437	0.15
500.00	0.140	283.060	499.99	1.91	1.75	-0.82	1773429.24	14582284.56	40°09'5.6650"N	80°31'26.3579"W	1.93	334.859	0.06
550.00	0.170	288.030	549.99	1.98	1.79	-0.95	1773429.11	14582284.60	40°09'5.6654"N	80°31'26.3595"W	2.03	331.969	0.07
600.00	0.150	341.450	599.99	2.09	1.87	-1.04	1773429.02	14582284.68	40°09'5.6662"N	80°31'26.3607"W	2.14	330.882	0.29
650.00	0.580	306.710	649.99	2.36	2.09	-1.27	1773428.79	14582284.90	40°09'5.6683"N	80°31'26.3636"W	2.44	328.730	0.93
668.00	0.740	308.100	667.99	2.53	2.21	-1.43	1773428.63	14582285.02	40°09'5.6696"N	80°31'26.3657"W	2.63	327.096	0.89
778.00	2.080	298.760	777.96	4.52	3.61	-3.74	1773426.32	14582286.42	40°09'5.6835"N	80°31'26.3953"W	5.20	313.991	1.23
870.00	2.490	324.660	869.89	7.59	6.04	-6.36	1773423.70	14582288.85	40°09'5.7077"N	80°31'26.4289"W	8.77	313.543	1.19
963.00	3.100	322.460	962.77	11.84	9.69	-9.06	1773421.00	14582292.49	40°09'5.7439"N	80°31'26.4634"W	13.26	316.911	0.67
1054.00	4.190	316.070	1053.59	17.08	14.03	-12.87	1773417.20	14582296.84	40°09'5.7870"N	80°31'26.5121"W	19.04	317.481	1.28
1141.00	6.000	297.160	1140.25	23.03	18.40	-19.12	1773410.95	14582301.20	40°09'5.8305"N	80°31'26.5923"W	26.53	313.899	2.81
1233.00	6.960	277.860	1231.67	28.62	21.35	-28.92	1773401.15	14582304.16	40°09'5.8602"N	80°31'26.7183"W	35.95	306.443	2.57
1323.00	7.930	258.390	1320.92	31.36	20.85	-40.40	1773389.67	14582303.65	40°09'5.8558"N	80°31'26.8663"W	45.47	297.296	2.99
1414.00	8.980	243.450	1410.94	30.62	16.41	-52.91	1773377.17	14582299.22	40°09'5.8126"N	80°31'27.0276"W	55.40	287.234	2.67
1504.00	10.860	228.990	1499.61	25.83	7.71	-65.59	1773364.49	14582290.51	40°09'5.7273"N	80°31'27.1916"W	66.04	276.702	3.45
1596.00	13.130	223.790	1589.60	17.00	-5.53	-79.37	1773350.72	14582277.29	40°09'5.5973"N	80°31'27.3698"W	79.56	266.018	2.73
1688.00	13.820	219.550	1679.07	5.63	-21.54	-93.59	1773336.50	14582261.28	40°09'5.4397"N	80°31'27.5542"W	96.04	257.039	1.31
1778.00	14.990	217.590	1766.24	-7.26	-39.05	-107.54	1773322.56	14582243.77	40°09'5.2674"N	80°31'27.7350"W	114.41	250.041	1.41
1870.00	16.620	217.010	1854.75	-22.13	-58.99	-122.72	1773307.39	14582223.84	40°09'5.0712"N	80°31'27.9318"W	136.16	244.327	1.78
1961.00	18.210	217.260	1941.58	-38.34	-80.70	-139.16	1773290.95	14582202.14	40°09'4.8576"N	80°31'28.1451"W	160.87	239.891	1.75
2004.00	18.630	216.210	1982.38	-46.51	-91.59	-147.29	1773282.83	14582191.26	40°09'4.7504"N	80°31'28.2505"W	173.44	238.125	1.24

06/14/2024

REFERENCE WELLPATH IDENTIFICATION

Operator	SWN PRODUCTION COMPANY, LLC	Well	Roy Riggle OHI 201H
Field	Ohio	API	47069003640000
Facility	Roy Riggle OHI Pad	Wellbore	Roy Riggle OHI 201H AWB
Slot	201H		

WELLPATH DATA (247 stations)

MD [ft]	Inclination [°]	Azimuth [°]	TVD [ft]	Vert Sect [ft]	North [ft]	East [ft]	Grid East [US ft]	Grid North [US ft]	Latitude	Longitude	Closure Dist [ft]	Closure Dir [°]	DLS [°/100ft]
2068.00	19.130	215.700	2042.93	-59.18	-108.35	-159.45	1773270.68	14582174.50	40°09'4.5854"N	80°31'28.4082"W	192.78	235.801	0.82
2160.00	21.330	215.370	2129.25	-78.83	-134.24	-177.93	1773252.20	14582148.62	40°09'4.3305"N	80°31'28.6480"W	222.89	232.967	2.39
2251.00	23.920	215.010	2213.24	-100.63	-162.85	-198.10	1773232.04	14582120.02	40°09'4.0488"N	80°31'28.9097"W	256.44	230.577	2.85
2341.00	25.180	213.560	2295.11	-124.36	-193.75	-219.15	1773210.99	14582089.13	40°09'3.7446"N	80°31'29.1830"W	292.52	228.520	1.55
2432.00	25.060	216.060	2377.50	-148.60	-225.47	-241.20	1773188.95	14582057.43	40°09'3.4324"N	80°31'29.4690"W	330.17	226.931	1.17
2525.00	24.070	216.980	2462.08	-171.96	-256.54	-264.20	1773165.96	14582026.37	40°09'3.1265"N	80°31'29.7674"W	368.26	225.843	1.14
2618.00	24.100	215.650	2546.99	-194.99	-287.12	-286.67	1773143.49	14581995.80	40°09'2.8255"N	80°31'30.0589"W	405.73	224.956	0.58
2710.00	22.890	216.620	2631.36	-217.35	-316.74	-308.30	1773121.88	14581966.19	40°09'2.5339"N	80°31'30.3394"W	442.01	224.226	1.38
2802.00	22.660	215.050	2716.19	-239.20	-345.61	-329.15	1773101.04	14581937.33	40°09'2.2498"N	80°31'30.6099"W	477.27	223.602	0.71
2893.00	22.750	215.580	2800.13	-261.00	-374.27	-349.45	1773080.74	14581908.68	40°09'1.9676"N	80°31'30.8734"W	512.05	223.036	0.25
2984.00	22.770	214.400	2884.05	-283.00	-403.11	-369.64	1773060.56	14581879.85	40°09'1.6837"N	80°31'31.1353"W	546.93	222.520	0.50
3074.00	22.900	215.720	2967.00	-304.80	-431.70	-389.70	1773040.51	14581851.27	40°09'1.4022"N	80°31'31.3956"W	581.58	222.073	0.59
3165.00	23.000	214.950	3050.79	-326.81	-460.65	-410.22	1773019.99	14581822.34	40°09'1.1173"N	80°31'31.6619"W	616.83	221.686	0.35
3256.00	22.580	215.050	3134.69	-348.84	-489.52	-430.44	1772999.78	14581793.48	40°09'0.8330"N	80°31'31.9242"W	651.85	221.325	0.46
3346.00	23.220	216.020	3217.60	-370.47	-518.02	-450.80	1772979.44	14581764.99	40°09'0.5525"N	80°31'32.1884"W	686.70	221.031	0.83
3436.00	23.210	216.210	3300.31	-392.10	-546.68	-471.71	1772958.53	14581736.34	40°09'0.2704"N	80°31'32.4596"W	722.05	220.790	0.08
3528.00	24.690	219.790	3384.39	-413.84	-576.07	-494.72	1772935.53	14581706.96	40°08'59.9811"N	80°31'32.7579"W	759.34	220.655	2.25
3618.00	26.580	219.220	3465.53	-435.72	-606.12	-519.48	1772910.78	14581676.92	40°08'59.6855"N	80°31'33.0789"W	798.27	220.599	2.12
3709.00	26.780	218.440	3546.84	-459.07	-637.95	-545.10	1772885.17	14581645.11	40°08'59.3723"N	80°31'33.4110"W	839.11	220.512	3.03
3803.00	23.930	218.320	3631.77	-482.33	-669.50	-570.09	1772860.19	14581613.57	40°08'59.0619"N	80°31'33.7350"W	879.33	220.415	3.04
3894.00	22.030	215.840	3715.55	-503.48	-697.81	-591.53	1772838.76	14581585.26	40°08'58.7832"N	80°31'34.0130"W	914.80	220.287	2.34
3985.00	21.830	213.940	3799.97	-524.76	-725.69	-610.97	1772819.33	14581557.40	40°08'58.5087"N	80°31'34.2652"W	948.63	220.095	0.81
4077.00	22.120	213.090	3885.28	-546.97	-754.39	-629.97	1772800.33	14581528.71	40°08'58.2261"N	80°31'34.5120"W	982.84	219.864	0.47
4168.00	21.420	214.500	3969.79	-568.62	-782.44	-648.74	1772781.57	14581500.67	40°08'57.9499"N	80°31'34.7556"W	1016.40	219.663	0.96
4259.00	21.010	216.880	4054.63	-588.89	-809.18	-667.94	1772762.37	14581473.94	40°08'57.6866"N	80°31'35.0047"W	1049.25	219.538	1.05
4349.00	22.440	217.770	4138.23	-608.63	-835.67	-688.15	1772742.18	14581447.46	40°08'57.4260"N	80°31'35.2667"W	1082.54	219.470	1.63
4441.00	23.100	215.160	4223.07	-630.17	-864.30	-709.30	1772721.04	14581418.84	40°08'57.1441"N	80°31'35.5410"W	1118.09	219.374	1.31
4532.00	22.560	214.730	4306.94	-652.26	-893.24	-729.52	1772700.82	14581389.91	40°08'56.8592"N	80°31'35.8034"W	1153.29	219.239	0.62
4622.00	22.690	217.590	4390.01	-673.34	-921.19	-749.95	1772680.40	14581361.97	40°08'56.5841"N	80°31'36.0684"W	1187.86	219.149	1.23
4712.00	22.870	219.570	4472.99	-693.37	-948.43	-771.68	1772658.68	14581334.75	40°08'56.3161"N	80°31'36.3501"W	1222.70	219.133	0.87

APR 30 2024

WV Department of
Environmental Protection

Actual Wellpath Report
Roy Riggle OHI 201H awp Proj: 22250'

Page 4 of 11

REFERENCE WELLPATH IDENTIFICATION	
Operator	SWN PRODUCTION COMPANY, LLC
Field	Ohio
Facility	Roy Riggle OHI Pad
Slot	201H
Well	Roy Riggle OHI 201H
API	47069003640000
Wellbore	Roy Riggle OHI 201H AWB

WELLPATH DATA (247 stations)

MD [ft]	Inclination [°]	Azimuth [°]	TVD [ft]	Vert Sect [ft]	North [ft]	East [ft]	Grid East [US ft]	Grid North [US ft]	Latitude	Longitude	Closure Dist [ft]	Closure Dir [°]	DLS [°/100ft]
4806.00	23.250	218.160	4559.48	-714.39	-977.09	-794.77	1772635.59	14581306.09	40°08'56.0340"N	80°31'36.6495"W	1259.52	219.125	0.71
4897.00	22.590	217.580	4643.30	-735.12	-1005.07	-816.53	1772613.84	14581278.13	40°08'55.7587"N	80°31'36.9316"W	1294.95	219.091	0.77
4987.00	22.490	216.870	4726.42	-755.79	-1032.66	-837.23	1772593.15	14581250.54	40°08'55.4871"N	80°31'37.2001"W	1329.42	219.033	0.61
5078.00	22.580	215.890	4810.48	-777.09	-1060.87	-857.75	1772572.64	14581222.35	40°08'55.2095"N	80°31'37.4662"W	1364.25	218.957	0.15
5170.00	22.760	216.950	4895.37	-798.56	-1089.40	-878.80	1772551.60	14581193.83	40°08'54.9287"N	80°31'37.7392"W	1399.67	218.893	0.49
5261.00	23.290	217.480	4979.12	-819.71	-1117.74	-900.33	1772530.08	14581165.49	40°08'54.6497"N	80°31'38.0184"W	1435.25	218.851	0.63
5352.00	23.850	215.720	5062.53	-841.65	-1146.96	-922.02	1772508.40	14581136.29	40°08'54.3622"N	80°31'38.2997"W	1471.61	218.795	0.99
5443.00	23.390	216.660	5145.90	-863.85	-1176.38	-943.54	1772486.88	14581106.88	40°08'54.0725"N	80°31'38.5789"W	1508.03	218.732	0.65
5533.00	22.700	217.290	5228.72	-884.91	-1204.53	-964.73	1772465.70	14581078.74	40°08'53.7955"N	80°31'38.8536"W	1543.24	218.692	0.81
5625.00	22.730	215.760	5313.59	-906.36	-1233.08	-985.87	1772444.57	14581050.20	40°08'53.5145"N	80°31'39.1278"W	1578.74	218.643	0.64
5715.00	22.630	215.920	5396.63	-927.65	-1261.21	-1006.19	1772424.25	14581022.08	40°08'53.2376"N	80°31'39.3914"W	1613.40	218.583	0.13
5801.00	22.280	217.590	5476.11	-947.38	-1287.53	-1025.84	1772404.61	14580995.78	40°08'52.9785"N	80°31'39.6463"W	1646.23	218.546	0.85
5903.00	21.210	214.670	5570.85	-970.39	-1318.02	-1048.13	1772382.33	14580965.29	40°08'52.6783"N	80°31'39.9354"W	1683.98	218.493	1.49
5994.00	21.600	214.750	5655.57	-991.28	-1345.33	-1067.05	1772363.42	14580938.00	40°08'52.4095"N	80°31'40.1808"W	1717.12	218.420	0.43
6084.00	20.860	214.880	5739.46	-1011.73	-1372.08	-1085.65	1772344.82	14580911.25	40°08'52.1461"N	80°31'40.4223"W	1749.64	218.353	0.82
6175.00	17.660	233.610	5825.44	-1026.63	-1393.59	-1106.05	1772324.43	14580889.75	40°08'51.9346"N	80°31'40.6864"W	1779.17	218.438	7.60
6265.00	18.200	259.790	5911.21	-1029.83	-1404.20	-1130.92	1772299.58	14580879.15	40°08'51.8311"N	80°31'41.0073"W	1802.98	218.847	8.90
6356.00	21.320	285.400	5997.00	-1019.60	-1402.32	-1160.91	1772269.59	14580881.03	40°08'51.8512"N	80°31'41.3935"W	1820.50	219.620	10.02
6447.00	26.830	297.190	6080.10	-996.73	-1388.52	-1195.18	1772235.34	14580894.82	40°08'51.9894"N	80°31'41.8338"W	1832.06	220.720	8.01
6537.00	32.520	311.140	6158.36	-962.28	-1363.28	-1231.53	1772199.00	14580920.26	40°08'52.2408"N	80°31'42.3002"W	1837.17	222.094	9.91
6628.00	40.140	321.680	6231.69	-914.35	-1324.07	-1268.23	1772162.31	14580959.24	40°08'52.6301"N	80°31'42.7701"W	1833.46	223.766	10.80
6718.00	48.440	325.460	6296.07	-855.35	-1273.48	-1305.38	1772125.18	14581009.82	40°08'53.1320"N	80°31'43.2451"W	1823.67	225.709	9.67
6810.00	56.390	327.220	6352.14	-785.80	-1212.82	-1345.71	1772084.87	14581070.46	40°08'53.7336"N	80°31'43.7602"W	1811.59	227.973	8.77
6900.00	63.870	330.870	6396.94	-710.34	-1145.91	-1385.73	1772044.86	14581137.34	40°08'54.3969"N	80°31'44.2710"W	1798.15	230.412	9.02
6991.00	71.530	334.410	6431.46	-627.77	-1071.17	-1424.32	1772006.28	14581212.05	40°08'55.1375"N	80°31'44.7629"W	1782.16	233.055	9.15
7082.00	79.920	335.360	6453.87	-540.69	-991.38	-1461.71	1771988.91	14581291.81	40°08'55.9278"N	80°31'45.2389"W	1766.19	235.854	9.28
7173.00	85.970	337.690	6465.05	-451.13	-908.59	-1497.65	1771932.98	14581374.57	40°08'56.7479"N	80°31'45.6961"W	1751.71	238.756	7.12
7263.00	89.880	337.930	6468.31	-361.68	-825.32	-1531.62	1771899.03	14581457.80	40°08'57.5725"N	80°31'46.1278"W	1739.83	241.682	4.35
7354.00	90.520	337.590	6467.99	-271.17	-741.09	-1566.06	1771864.60	14581542.00	40°08'58.4067"N	80°31'46.5656"W	1732.56	244.675	0.80
7444.00	90.580	337.280	6467.12	-181.71	-657.99	-1600.59	1771830.08	14581625.07	40°08'59.2297"N	80°31'47.0046"W	1730.56	247.653	0.36

RECEIVED
Office Of Oil and Gas
APR 30 2024



Actual Wellpath Report

Roy Riggle OHI 201H awp Proj: 22250'
Page 5 of 11



WV Department of
Environmental Protection

REFERENCE WELLPATH IDENTIFICATION	
Operator	SWN PRODUCTION COMPANY, LLC
Field	Ohio
Well	Roy Riggle OHI 201H
API	47069003640000
Wellbore	Roy Riggle OHI 201H AWB
Slot	201H

WELLPATH DATA (247 stations)

MD	Inclination [°]	Azimuth [°]	TVD [ft]	Vert Sect [ft]	North [ft]	East [ft]	Grid East [US ft]	Grid North [US ft]	Latitude	Longitude	Closure Dist [ft]	Closure Dir [°]	DLS ["/100ft]
7535.00	90.890	340.600	6465.96	-91.04	-573.08	-1633.29	1771797.40	14581709.94	40°09'0.0704"N	80°31'47.4199"W	1730.91	250.665	3.66
7625.00	91.630	338.980	6463.98	-1.27	-488.65	-1664.37	1771766.33	14581794.35	40°09'0.9064"N	80°31'47.8144"W	1734.62	253.638	1.98
7716.00	90.520	337.000	6462.27	89.26	-404.30	-1698.46	1771732.24	14581878.66	40°09'1.7417"N	80°31'48.2477"W	1745.92	256.611	2.49
7807.00	91.850	339.020	6460.39	179.79	-319.95	-1732.53	1771698.19	14581962.99	40°09'2.5771"N	80°31'48.6807"W	1761.82	259.537	2.66
7897.00	90.220	338.230	6458.76	269.42	-236.15	-1765.33	1771665.41	14582046.75	40°09'3.4068"N	80°31'49.0973"W	1781.05	262.381	2.01
7988.00	91.540	338.920	6457.36	360.05	-151.46	-1798.56	1771632.19	14582131.41	40°09'4.2456"N	80°31'49.5195"W	1804.93	265.187	1.64
8079.00	91.110	339.140	6455.26	450.72	-66.51	-1831.12	1771599.64	14582216.33	40°09'5.0867"N	80°31'49.9330"W	1832.33	267.920	0.53
8170.00	91.940	337.460	6452.84	541.29	18.01	-1864.75	1771566.02	14582300.82	40°09'5.9237"N	80°31'50.3604"W	1864.84	270.553	2.06
8258.00	91.010	339.180	6450.57	628.87	99.76	-1897.25	1771533.53	14582382.53	40°09'6.7332"N	80°31'50.7733"W	1899.87	273.010	2.22
8349.00	90.180	347.070	6449.63	719.79	186.76	-1923.64	1771507.15	14582469.50	40°09'7.5943"N	80°31'51.1073"W	1932.69	275.545	8.72
8441.00	92.460	347.200	6447.51	811.59	276.42	-1944.12	1771486.68	14582559.13	40°09'8.4814"N	80°31'51.3649"W	1963.67	278.092	2.48
8531.00	90.890	340.700	6444.87	901.50	362.83	-1968.98	1771461.83	14582645.50	40°09'9.3366"N	80°31'51.6792"W	2002.13	280.441	7.43
8622.00	91.080	336.520	6443.31	992.11	447.53	-2002.16	1771428.67	14582730.17	40°09'10.1753"N	80°31'52.1007"W	2051.56	282.600	4.60
8713.00	89.750	335.960	6442.65	1082.34	530.81	-2038.82	1771392.02	14582813.42	40°09'11.0002"N	80°31'52.5672"W	2106.79	284.593	1.59
8804.00	90.710	335.260	6442.28	1172.43	613.69	-2076.40	1771354.46	14582896.27	40°09'11.8212"N	80°31'53.0455"W	2165.19	286.465	1.31
8895.00	91.880	335.290	6440.23	1262.43	696.32	-2114.45	1771316.42	14582978.87	40°09'12.6397"N	80°31'53.5299"W	2226.15	288.228	1.29
8986.00	89.230	336.320	6439.35	1352.56	779.32	-2151.74	1771279.14	14583061.83	40°09'13.4618"N	80°31'54.0045"W	2288.52	289.909	3.12
9076.00	91.170	334.980	6439.03	1441.67	861.31	-2188.84	1771242.05	14583143.79	40°09'14.2740"N	80°31'54.4768"W	2352.21	291.480	2.62
9167.00	91.390	335.750	6437.00	1531.69	944.00	-2226.77	1771204.14	14583226.45	40°09'15.0931"N	80°31'54.9596"W	2418.60	292.974	0.88
9259.00	89.880	338.260	6435.98	1623.05	1028.68	-2262.70	1771168.23	14583311.09	40°09'15.9317"N	80°31'55.4166"W	2485.55	294.448	3.18
9349.00	90.620	338.680	6433.97	1712.65	1112.37	-2295.72	1771135.22	14583394.75	40°09'16.7605"N	80°31'55.8362"W	2551.01	295.852	3.15
9441.00	90.680	338.530	6431.32	1804.24	1197.99	-2329.26	1771101.69	14583480.34	40°09'17.6083"N	80°31'56.2624"W	2619.28	297.218	2.25
9533.00	90.400	338.140	6430.50	1895.84	1283.49	-2363.22	1771067.74	14583565.81	40°09'18.4550"N	80°31'56.6940"W	2689.27	298.507	0.49
9623.00	90.990	338.150	6429.41	1985.41	1367.01	-2396.73	1771034.25	14583649.30	40°09'19.2821"N	80°31'57.1198"W	2759.17	299.699	0.66
9716.00	90.430	337.780	6428.26	2077.94	1453.21	-2431.61	1770999.37	14583735.47	40°09'20.1357"N	80°31'57.5632"W	2832.77	300.864	0.72
9807.00	91.630	337.900	6426.62	2168.46	1537.47	-2465.93	1770965.07	14583819.70	40°09'20.9702"N	80°31'57.9995"W	2905.97	301.943	1.33
9900.00	91.080	338.510	6424.42	2261.00	1623.80	-2500.45	1770930.56	14583905.99	40°09'21.8251"N	80°31'58.4382"W	2981.44	303.000	0.88
9991.00	90.620	338.150	6423.07	2351.60	1708.36	-2534.05	1770896.98	14583990.52	40°09'22.6624"N	80°31'58.8652"W	3056.13	303.986	0.64
10083.00	90.620	337.760	6422.08	2443.13	1793.63	-2568.58	1770862.46	14584075.75	40°09'23.5068"N	80°31'59.3041"W	3132.84	304.926	0.42
10174.00	90.430	337.090	6421.24	2533.59	1877.65	-2603.51	1770827.54	14584159.74	40°09'24.3390"N	80°31'59.7483"W	3209.96	305.799	0.77

06/14/2024

RECEIVED
Office Of Oil and Gas

APR 30 2024



WV Department of
Environmental Protection

Southwestern Energy®

Actual Wellpath Report

Roy Riggle OHI 201H awp Proj: 22250'

Page 6 of 11



REFERENCE WELLPATH IDENTIFICATION

Operator	SWN PRODUCTION COMPANY, LLC		Well	Roy Riggle OHI 201H	
Field	Ohio		API	47069003640000	
Facility	Roy Riggle OHI Pad		Wellbore	Roy Riggle OHI 201H AWB	
Slot	201H				

WELLPATH DATA (247 stations)

MID [ft]	Inclination [°]	Azimuth [°]	TVD [ft]	Vert Sect [ft]	North [ft]	East [ft]	Grid East [US ft]	Grid North [US ft]	Latitude	Longitude	Closure Dist [ft]	Closure Dir [°]	DLS [°/100ft]
10264.00	90.280	339.950	6420.69	2623.21	1961.39	-2636.46	1770794.60	14584243.45	40°09'25.1682"N	80°32'0.1671"W	3286.03	306.647	3.18
10356.00	90.030	337.630	6420.44	2714.87	2047.15	-2669.75	1770761.33	14584329.18	40°09'26.0174"N	80°32'0.5899"W	3364.28	307.481	2.54
10447.00	91.170	337.270	6419.48	2805.33	2131.19	-2704.64	1770726.45	14584413.19	40°09'26.8496"N	80°32'1.0336"W	3443.41	308.237	1.31
10538.00	90.860	338.660	6417.87	2895.86	2215.53	-2738.78	1770692.33	14584497.49	40°09'27.6848"N	80°32'1.4676"W	3522.70	308.971	1.56
10630.00	90.220	338.510	6417.00	2987.49	2301.17	-2772.36	1770658.75	14584583.10	40°09'28.5329"N	80°32'1.8944"W	3602.97	309.694	0.71
10722.00	90.150	338.010	6416.71	3079.08	2386.63	-2806.44	1770624.69	14584668.52	40°09'29.3791"N	80°32'2.3275"W	3684.03	310.378	0.55
10813.00	90.430	338.710	6416.25	3169.68	2471.21	-2840.00	1770591.15	14584753.08	40°09'30.2167"N	80°32'2.7540"W	3764.63	311.028	0.83
10903.00	91.020	338.180	6415.11	3259.30	2554.91	-2873.06	1770558.10	14584836.74	40°09'31.0455"N	80°32'3.1741"W	3844.74	311.646	0.88
10994.00	90.950	339.860	6413.54	3349.98	2639.86	-2905.64	1770525.53	14584921.66	40°09'31.8867"N	80°32'3.5880"W	3925.76	312.256	1.85
11092.00	89.380	338.380	6413.26	3447.67	2731.42	-2940.56	1770490.62	14585013.19	40°09'32.7933"N	80°32'4.0316"W	4013.42	312.888	2.20
11188.00	89.420	337.890	6414.27	3543.21	2820.51	-2976.31	1770454.89	14585102.24	40°09'33.6756"N	80°32'4.4859"W	4100.45	313.460	0.50
11285.00	90.310	338.090	6414.50	3639.73	2910.44	-3012.65	1770418.56	14585192.14	40°09'34.5661"N	80°32'4.9480"W	4188.88	314.011	0.94
11381.00	90.340	338.840	6413.95	3735.33	2999.74	-3047.89	1770383.34	14585281.40	40°09'35.4504"N	80°32'5.3958"W	4276.45	314.544	0.78
11478.00	90.220	338.370	6413.48	3831.95	3090.05	-3083.27	1770347.96	14585371.68	40°09'36.3447"N	80°32'5.8454"W	4365.20	315.063	0.50
11574.00	90.280	336.720	6413.06	3927.40	3178.77	-3119.94	1770311.31	14585460.37	40°09'37.2233"N	80°32'6.3117"W	4454.06	315.535	1.72
11671.00	91.630	337.890	6411.44	4023.78	3268.24	-3157.36	1770273.91	14585549.81	40°09'38.1094"N	80°32'6.7876"W	4544.26	315.989	1.84
11767.00	90.680	338.550	6409.51	4119.32	3357.37	-3192.97	1770238.31	14585638.90	40°09'38.9920"N	80°32'7.2403"W	4633.25	316.438	1.20
11864.00	90.490	339.050	6408.52	4215.97	3447.80	-3228.04	1770203.25	14585729.30	40°09'39.8874"N	80°32'7.6860"W	4723.09	316.885	0.55
11960.00	90.120	338.670	6408.00	4311.63	3537.34	-3262.67	1770168.64	14585818.80	40°09'40.7740"N	80°32'8.1258"W	4812.25	317.313	0.55
12057.00	91.230	336.770	6406.86	4408.09	3627.09	-3299.44	1770131.88	14585908.51	40°09'41.6628"N	80°32'8.5934"W	4903.27	317.708	2.27
12153.00	89.720	338.320	6406.07	4503.53	3715.80	-3336.10	1770095.23	14585997.19	40°09'42.5413"N	80°32'9.0597"W	4993.67	318.082	2.25
12250.00	90.220	338.480	6406.12	4600.12	3805.99	-3371.81	1770059.54	14586087.35	40°09'43.4344"N	80°32'9.5135"W	5084.75	318.462	0.54
12346.00	90.400	338.240	6405.60	4695.70	3895.22	-3407.21	1770024.15	14586176.54	40°09'44.3180"N	80°32'9.9635"W	5175.12	318.823	0.31
12443.00	90.430	337.950	6404.89	4792.24	3985.21	-3443.40	1769987.98	14586266.50	40°09'45.2092"N	80°32'10.4235"W	5266.78	319.172	0.30
12540.00	90.310	337.860	6404.27	4888.75	4075.09	-3479.88	1769951.51	14586356.34	40°09'46.0992"N	80°32'10.8874"W	5358.73	319.505	0.15
12636.00	90.460	337.980	6403.62	4984.26	4164.05	-3515.97	1769915.43	14586445.27	40°09'46.9802"N	80°32'11.3462"W	5449.89	319.823	0.20
12732.00	90.280	338.130	6403.00	5079.80	4253.09	-3551.84	1769879.57	14586534.28	40°09'47.8619"N	80°32'11.8023"W	5541.15	320.134	0.24
12829.00	90.280	337.460	6402.53	5176.28	4342.89	-3588.50	1769842.93	14586624.05	40°09'48.7512"N	80°32'12.2685"W	5633.66	320.433	0.69
12926.00	90.430	338.080	6401.93	5272.76	4432.68	-3625.20	1769806.24	14586713.80	40°09'49.6404"N	80°32'12.7351"W	5726.32	320.723	0.66
13022.00	90.400	338.540	6401.23	5368.34	4521.88	-3660.68	1769770.78	14586802.97	40°09'50.5237"N	80°32'13.1861"W	5817.90	321.008	0.48

06/14/2024

RECEIVED
Office Of Oil and Gas

APR 30 2024

WV Department of
Environmental Protection



Southwestern Energy®

Actual Wellpath Report

Roy Riggle OHI 201H awp Proj: 22250'

Page 7 of 11



REFERENCE WELLPATH IDENTIFICATION

Operator	SWN PRODUCTION COMPANY, LLC	Well	Roy Riggle OHI 201H
Field	Ohio	API	47069003640000
Facility	Roy Riggle OHI Pad	Wellbore	Roy Riggle OHI 201H AWB
Slot	201H		

WELLPATH DATA (247 stations)

MD [ft]	Inclination [°]	Azimuth [°]	TVD [ft]	Vert Sect [ft]	North [ft]	East [ft]	Grid East [US ft]	Grid North [US ft]	Latitude	Longitude	Closure Dist [ft]	Closure Dir [°]	DLS [°/100ft]
13119.00	90.430	337.840	6400.53	5464.89	4611.94	-3696.72	1769734.76	14586892.99	40°09'51.4155"N	80°32'13.6442"W	5910.64	321.286	0.72
13216.00	90.800	337.430	6399.49	561.35	4701.63	-3733.62	1769697.86	14586982.65	40°09'52.3038"N	80°32'14.1136"W	6003.77	321.547	0.57
13312.00	91.630	338.420	6397.45	5656.84	4790.57	-3769.69	1769661.81	14587071.56	40°09'53.1845"N	80°32'14.5722"W	6095.92	321.801	1.35
13409.00	90.680	338.090	6395.50	5753.38	4880.65	-3805.62	1769625.89	14587161.60	40°09'54.0765"N	80°32'15.0289"W	6188.98	322.055	1.04
13505.00	90.770	337.740	6394.28	5848.89	4969.60	-3841.71	1769589.81	14587250.51	40°09'54.9574"N	80°32'15.4878"W	6281.38	322.294	0.38
13602.00	90.180	338.120	6393.48	5945.40	5059.49	-3878.16	1769553.38	14587340.37	40°09'55.8475"N	80°32'15.9513"W	6374.84	322.529	0.72
13698.00	90.550	338.260	6392.87	6040.96	5148.62	-3913.82	1769517.73	14587429.46	40°09'56.7301"N	80°32'16.4047"W	6467.32	322.759	0.41
13795.00	90.920	338.960	6391.62	6137.57	5238.93	-3949.20	1769482.37	14587519.74	40°09'57.6243"N	80°32'16.8543"W	6560.68	322.990	0.82
13891.00	89.970	336.670	6390.88	6233.06	5327.81	-3985.44	1769446.14	14587608.59	40°09'58.5045"N	80°32'17.3152"W	6653.52	323.202	2.58
13988.00	90.000	339.010	6390.90	6329.54	5417.64	-4022.03	1769409.57	14587698.38	40°09'59.3941"N	80°32'17.7804"W	6747.41	323.410	2.41
14085.00	90.990	338.760	6390.06	6426.20	5508.12	-4056.97	1769374.64	14587788.83	40°10'0.2900"N	80°32'18.2244"W	6840.94	323.627	1.05
14182.00	90.800	338.550	6388.55	6522.82	5598.46	-4092.27	1769339.35	14587879.13	40°10'0.1845"N	80°32'18.6731"W	6934.65	323.835	0.29
14278.00	90.550	338.420	6387.42	6618.41	5687.76	-4127.48	1769304.16	14587968.40	40°10'0.0688"N	80°32'19.1206"W	7027.57	324.032	0.29
14375.00	90.550	337.930	6386.49	6714.96	5777.81	-4163.54	1769268.11	14588058.41	40°10'0.29605"N	80°32'19.5791"W	7121.66	324.223	0.51
14472.00	91.110	339.290	6385.08	6811.57	5868.11	-4198.91	1769232.75	14588148.68	40°10'0.38547"N	80°32'20.0287"W	7215.65	324.414	1.52
14569.00	89.850	337.770	6384.27	6908.17	5958.37	-4234.41	1769197.27	14588238.91	40°10'0.47485"N	80°32'20.4799"W	7309.75	324.600	2.04
14665.00	91.600	337.690	6383.06	7003.64	6047.20	-4270.79	1769160.90	14588327.70	40°10'0.56281"N	80°32'20.9426"W	7403.26	324.769	1.82
14762.00	90.340	339.060	6381.41	7100.21	6137.36	-4306.53	1769125.18	14588417.82	40°10'0.65209"N	80°32'21.3969"W	7497.56	324.943	1.92
14859.00	90.400	337.350	6380.79	7196.76	6227.42	-4342.54	1769089.18	14588507.85	40°10'0.74127"N	80°32'21.8548"W	7592.00	325.111	1.76
14955.00	90.310	337.970	6380.19	7292.23	6316.21	-4379.03	1769052.70	14588596.61	40°10'0.82920"N	80°32'22.3189"W	7685.73	325.266	0.65
15052.00	90.580	337.960	6379.44	7388.74	6406.12	-4415.42	1768980.16	14588686.49	40°10'0.91824"N	80°32'22.7816"W	7780.38	325.423	0.28
15148.00	90.520	337.730	6378.52	7484.24	6495.03	-4451.62	1768916.33	14588775.36	40°10'10.0628"N	80°32'23.2420"W	7874.16	325.574	0.25
15245.00	90.150	337.820	6377.95	7580.73	6584.82	-4488.31	1768894.46	14588865.12	40°10'10.9520"N	80°32'23.7086"W	7968.99	325.721	0.39
15341.00	90.490	337.970	6377.41	7676.23	6673.76	-4524.44	1768897.35	14588954.03	40°10'11.8328"N	80°32'24.1681"W	8062.86	325.865	0.39
15438.00	90.680	338.190	6376.42	7772.77	6763.75	-4560.64	1768871.16	14589043.98	40°10'12.7238"N	80°32'24.6285"W	8157.68	326.009	0.30
15535.00	91.170	339.450	6374.86	7869.40	6854.18	-4595.69	1768836.13	14589134.37	40°10'13.6193"N	80°32'25.0738"W	8252.28	326.158	1.39
15631.00	91.540	338.080	6372.59	7965.02	6943.64	-4630.45	1768801.38	14589223.79	40°10'14.5050"N	80°32'25.5156"W	8345.96	326.302	1.48
15727.00	92.000	338.480	6369.62	8060.55	7032.78	-4665.95	1768765.89	14589312.90	40°10'15.3877"N	80°32'25.9671"W	8439.85	326.437	0.63
15824.00	90.770	337.620	6367.28	8157.05	7122.72	-4702.20	1768729.65	14589402.81	40°10'16.2784"N	80°32'26.4280"W	8534.86	326.568	1.55
15921.00	91.570	337.600	6365.30	8253.49	7212.38	-4739.14	1768692.73	14589492.44	40°10'17.1663"N	80°32'26.8979"W	8630.06	326.692	0.82

06/14/2024

RECEIVED
Office Of Oil and Gas

APR 30 2024

WV Department of
Environmental Protection



Southwestern Energy

Actual Wellpath Report

Roy Riggle OHI 201H awp Proj: 22250'

Page 8 of 11



REFERENCE WELLPATH IDENTIFICATION

Operator	SWN PRODUCTION COMPANY, LLC	Well	Roy Riggle OHI 201H
Field	Ohio	API	47069003640000
Facility	Roy Riggle OHI Pad	Wellbore	Roy Riggle OHI 201H AWB
Slot	201H		

WELLPATH DATA (247 stations)

MD [ft]	Inclination [°]	Azimuth [°]	TVD [ft]	Vert Sect [ft]	North [ft]	East [ft]	Grid East [US ft]	Grid North [US ft]	Latitude	Longitude	Closure Dist [ft]	Closure Dir [°]	DLS ["/100ft]
16017.00	92.740	337.520	6361.69	8348.87	7301.05	-4775.76	1768656.12	14589581.07	40°10'18.0444"N	80°32'27.3637"W	8724.29	326.811	1.22
16114.00	91.110	338.950	6358.43	8445.37	7391.08	-4811.70	1768620.19	14589671.07	40°10'18.9359"N	80°32'27.8208"W	8819.33	326.935	2.23
16211.00	90.310	338.340	6357.23	8541.99	7481.41	-4847.02	1768584.89	14589761.37	40°10'19.8304"N	80°32'28.2697"W	8914.32	327.062	1.04
16308.00	93.510	338.400	6353.99	8638.51	7571.52	-4882.75	1768549.17	14589851.44	40°10'20.7226"N	80°32'28.7240"W	9009.40	327.183	3.30
16404.00	90.430	338.970	6350.69	8734.07	7660.89	-4917.62	1768514.31	14589940.77	40°10'21.6075"N	80°32'29.1673"W	9103.42	327.303	3.26
16501.00	93.880	337.720	6347.05	8830.57	7750.96	-4953.39	1768478.56	14590030.82	40°10'22.4995"N	80°32'29.6220"W	9198.56	327.419	3.78
16597.00	91.450	339.560	6342.58	8926.08	7840.26	-4988.31	1768443.66	14590120.08	40°10'23.3837"N	80°32'30.0659"W	9292.63	327.534	3.17
16694.00	90.980	337.570	6340.53	9022.67	7930.53	-5023.75	1768408.23	14590210.31	40°10'24.2775"N	80°32'30.5164"W	9387.83	327.647	2.11
16790.00	91.290	337.500	6338.62	9118.10	8019.23	-5060.42	1768371.57	14590298.98	40°10'25.1559"N	80°32'30.9830"W	9482.40	327.747	0.33
16887.00	91.450	338.210	6336.31	9214.57	8109.05	-5096.98	1768335.03	14590388.76	40°10'26.0453"N	80°32'31.4479"W	9577.88	327.848	0.75
16983.00	90.680	337.360	6334.52	9310.04	8197.90	-5133.27	1768298.75	14590477.58	40°10'26.9252"N	80°32'31.9095"W	9672.44	327.947	1.19
17080.00	92.120	338.280	6332.15	9406.50	8287.69	-5169.87	1768262.16	14590567.34	40°10'27.8144"N	80°32'32.3751"W	9767.98	328.044	1.76
17177.00	92.490	338.600	6328.25	9503.02	8377.83	-5205.49	1768226.56	14590657.45	40°10'28.7070"N	80°32'32.8280"W	9863.33	328.146	0.50
17273.00	90.860	336.840	6325.44	9598.45	8466.62	-5241.87	1768190.19	14590746.20	40°10'29.5862"N	80°32'33.2907"W	9957.96	328.237	2.50
17370.00	93.110	338.010	6322.08	9694.81	8556.13	-5279.08	1768152.99	14590835.67	40°10'30.4726"N	80°32'33.7642"W	10053.66	328.326	2.61
17466.00	90.120	338.460	6319.38	9790.33	8645.24	-5314.66	1768117.43	14590924.75	40°10'31.3550"N	80°32'34.2166"W	10148.19	328.419	3.15
17562.00	92.370	336.190	6317.29	9885.70	8733.79	-5351.65	1768080.45	14591013.26	40°10'32.2319"N	80°32'34.6873"W	10243.01	328.502	3.33
17659.00	90.090	339.110	6315.21	9982.13	8823.46	-5388.52	1768043.59	14591102.91	40°10'33.1200"N	80°32'35.1563"W	10338.75	328.587	3.82
17755.00	94.160	338.210	6311.65	10077.67	8912.80	-5423.43	1768008.70	14591192.21	40°10'34.0048"N	80°32'35.6000"W	10433.20	328.680	4.34
17852.00	91.600	338.520	6306.78	10174.13	9002.85	-5459.14	1767973.00	14591282.22	40°10'34.8962"N	80°32'36.0542"W	10528.70	328.768	2.66
17948.00	91.020	338.550	6304.58	10269.71	9092.16	-5494.26	1767937.90	14591371.50	40°10'35.7806"N	80°32'36.5007"W	10623.29	328.856	0.60
18045.00	90.950	338.710	6302.92	10366.32	9182.48	-5529.60	1767902.57	14591461.79	40°10'36.6749"N	80°32'36.9500"W	10718.88	328.944	0.18
18141.00	90.990	338.310	6301.29	10461.92	9271.80	-5564.76	1767867.42	14591551.07	40°10'37.5593"N	80°32'37.3971"W	10813.55	329.029	0.42
18238.00	90.710	338.330	6299.85	10558.48	9361.92	-5600.59	1767831.60	14591641.16	40°10'38.4518"N	80°32'37.8527"W	10909.27	329.111	0.29
18334.00	91.260	337.430	6298.20	10653.98	9450.84	-5636.74	1767795.47	14591730.05	40°10'39.3323"N	80°32'38.3125"W	11004.15	329.187	1.10
18431.00	91.360	338.580	6295.98	10750.47	9540.76	-5673.06	1767759.17	14591819.93	40°10'40.2227"N	80°32'38.7744"W	11099.98	329.264	1.19
18527.00	91.480	338.070	6293.60	10846.03	9629.94	-5708.50	1767723.74	14591909.08	40°10'41.1058"N	80°32'39.2252"W	11194.77	329.341	0.55
18624.00	91.260	337.620	6291.29	10942.49	9719.76	-5745.07	1767687.18	14591998.85	40°10'41.9951"N	80°32'39.6904"W	11290.68	329.414	0.52
18721.00	91.720	337.710	6288.76	11038.93	9809.45	-5781.92	1767650.35	14592088.51	40°10'42.8833"N	80°32'40.1592"W	11386.65	329.484	0.48
18817.00	91.390	337.670	6286.16	11134.37	9898.23	-5818.35	1767613.93	14592177.26	40°10'43.7625"N	80°32'40.6226"W	11481.64	329.552	0.35

06/14/2024

RECEIVED
Office Of Oil and Gas

APR 30 2024

WV Department of
Environmental Protection



Actual Wellpath Report

Roy Riggle OHI 201H awp Proj: 22250'

Page 9 of 11



REFERENCE WELLPATH IDENTIFICATION

Operator	SWN PRODUCTION COMPANY, LLC	Well	Roy Riggle OHI 201H
Field	Ohio	API	47069003640000
Facility	Roy Riggle OHI Pad	Wellbore	Roy Riggle OHI 201H AWB
Slot	201H		

WELLPATH DATA (247 stations)

MD [ft]	Inclination [°]	Azimuth [°]	TVD [ft]	Vert Sect [ft]	North [ft]	East [ft]	Grid East [US ft]	Grid North [US ft]	Latitude	Longitude	Closure Dist [ft]	Closure Dir [°]	DLS ["/100ft]
18914.00	91.850	340.050	6283.42	11230.98	9988.66	-5853.32	1767578.98	14592267.65	40°10'44.6579"N	80°32'41.0671"W	11577.33	329.630	2.50
19010.00	91.760	339.830	6280.39	11326.73	10078.79	-5886.23	1767546.08	14592357.75	40°10'45.5502"N	80°32'41.4852"W	11671.75	329.714	0.25
19106.00	91.760	342.440	6277.44	11422.58	10169.58	-5917.25	1767515.07	14592448.51	40°10'46.4490"N	80°32'41.8789"W	11765.81	329.807	2.72
19202.00	91.510	341.980	6274.70	11518.51	10260.95	-5946.57	1767485.76	14592539.85	40°10'47.3534"N	80°32'42.2506"W	11859.55	329.906	0.55
19299.00	91.320	341.730	6272.31	11615.43	10353.10	-5976.77	1767455.57	14592631.96	40°10'48.2655"N	80°32'42.6336"W	11954.43	330.002	0.32
19396.00	91.320	341.880	6270.07	11712.35	10445.23	-6007.05	1767425.30	14592724.05	40°10'49.1775"N	80°32'43.0176"W	12049.37	330.097	0.15
19492.00	90.770	341.590	6268.32	11808.28	10536.37	-6037.13	1767395.23	14592815.16	40°10'50.0797"N	80°32'43.3991"W	12143.40	330.188	0.65
19588.00	91.020	341.430	6266.82	11904.20	10627.41	-6067.57	1767364.80	14592906.16	40°10'50.9808"N	80°32'43.7853"W	12237.53	330.276	0.31
19685.00	90.990	341.700	6265.12	12001.12	10719.42	-6098.24	1767334.14	14592998.13	40°10'51.8916"N	80°32'44.1744"W	12332.66	330.365	0.28
19782.00	90.310	340.190	6264.02	12098.00	10811.09	-6129.91	1767302.49	14593089.77	40°10'52.7991"N	80°32'44.5763"W	12428.01	330.447	1.71
19878.00	91.940	342.770	6262.14	12193.90	10902.09	-6160.39	1767272.02	14593180.74	40°10'53.6999"N	80°32'44.9631"W	12522.22	330.531	3.18
19974.00	90.340	342.260	6260.23	12289.86	10993.63	-6189.23	1767243.19	14593272.25	40°10'54.6060"N	80°32'45.3286"W	12616.12	330.621	1.75
20070.00	91.910	340.400	6258.34	12385.75	11084.56	-6219.95	1767212.48	14593363.14	40°10'55.5060"N	80°32'45.7184"W	12710.44	330.702	2.54
20167.00	90.400	343.020	6256.39	12482.66	11176.63	-6250.38	1767182.06	14593455.17	40°10'56.4174"N	80°32'46.1044"W	12805.64	330.784	3.12
20263.00	91.910	341.480	6254.45	12578.61	11268.03	-6279.64	1767152.81	14593546.54	40°10'57.3221"N	80°32'46.4754"W	12899.71	330.869	2.25
20359.00	90.150	342.130	6252.73	12674.53	11359.22	-6309.61	1767122.86	14593637.69	40°10'58.2247"N	80°32'46.8555"W	12993.96	330.949	1.95
20456.00	90.460	342.540	6252.21	12771.51	11451.64	-6339.05	1767093.43	14593730.08	40°10'59.1395"N	80°32'47.2286"W	13089.06	331.033	0.53
20552.00	91.290	343.290	6250.74	12867.48	11543.39	-6367.25	1767065.24	14593821.80	40°11'00.0476"N	80°32'47.5859"W	13183.01	331.119	1.17
20649.00	90.680	340.290	6249.08	12964.41	11635.51	-6397.55	1767034.95	14593913.88	40°11'00.9594"N	80°32'47.9703"W	13278.32	331.197	3.16
20745.00	91.480	343.400	6247.27	13060.33	11726.70	-6427.46	1767005.06	14594005.04	40°11'01.8621"N	80°32'48.3496"W	13372.65	331.273	3.34
20841.00	90.860	342.450	6245.31	13156.30	11818.45	-6455.64	1766976.89	14594096.75	40°11'02.7702"N	80°32'48.7067"W	13466.66	331.355	1.18
20938.00	91.480	342.450	6243.32	13253.25	11910.92	-6484.88	1766947.66	14594189.18	40°11'03.6854"N	80°32'49.0773"W	13561.84	331.434	0.64
21034.00	91.020	342.440	6241.23	13349.21	12002.42	-6513.83	1766918.72	14594280.65	40°11'04.5911"N	80°32'49.4443"W	13656.06	331.511	0.48
21130.00	90.550	342.160	6239.92	13445.17	12093.87	-6543.01	1766889.54	14594372.06	40°11'05.4962"N	80°32'49.8143"W	13750.37	331.586	0.57
21227.00	90.770	341.010	6238.80	13542.10	12185.89	-6573.65	1766858.92	14594464.05	40°11'06.4072"N	80°32'50.2030"W	13845.90	331.655	1.21
21323.00	90.890	340.910	6237.41	13637.98	12276.63	-6604.97	1766827.61	14594554.76	40°11'07.3054"N	80°32'50.6006"W	13940.63	331.719	0.16
21420.00	90.830	340.600	6235.95	13734.84	12368.20	-6636.94	1766795.66	14594646.29	40°11'08.2119"N	80°32'51.0064"W	14036.43	331.781	0.33
21516.00	90.950	341.080	6234.46	13830.71	12458.87	-6668.44	1766764.17	14594736.93	40°11'09.1095"N	80°32'51.4064"W	14131.23	331.843	0.52
21613.00	91.020	342.600	6232.79	13927.65	12551.02	-6698.67	1766733.95	14594829.04	40°11'10.0216"N	80°32'51.7898"W	14226.75	331.911	1.57
21709.00	90.000	341.320	6231.94	14023.60	12642.30	-6728.39	1766704.24	14594920.28	40°11'10.9251"N	80°32'52.1668"W	14321.28	331.978	1.70

REFERENCE WELLPATH IDENTIFICATION

Operator	SWN PRODUCTION COMPANY, LLC	Well	Roy Riggle OHI 201H
Field	Ohio	API	47069003640000
Facility	Roy Riggle OHI Pad	Wellbore	Roy Riggle OHI 201H AWB
Slot	201H		

WELLPATH DATA (247 stations) † = interpolated, ‡ = extrapolated station

MD [ft]	Inclination [°]	Azimuth [°]	TVD [ft]	Vert Sect [ft]	North [ft]	East [ft]	Grid East [US ft]	Grid North [US ft]	Latitude	Longitude	Closure Dist [ft]	Closure Dir [°]	DLS ["/100ft]
21805.00	91.910	340.010	6230.34	14119.44	12732.87	-6760.17	1766672.47	14595010.81	40°11'11.8217"N	80°32'52.5703"W	14416.16	332.035	2.41
21902.00	91.140	341.800	6227.76	14216.29	12824.49	-6791.89	1766640.76	14595102.41	40°11'12.7287"N	80°32'52.9730"W	14511.97	332.094	2.01
21999.00	89.690	341.480	6227.05	14313.22	12916.55	-6822.44	1766610.22	14595194.43	40°11'13.6399"N	80°32'53.3606"W	14607.63	332.157	1.53
22095.00	90.580	339.950	6226.83	14409.09	13007.16	-6854.15	1766578.53	14595285.00	40°11'14.5369"N	80°32'53.7632"W	14702.57	332.213	1.84
22191.00	90.620	340.330	6225.82	14504.90	13097.44	-6886.76	1766545.93	14595375.25	40°11'15.4308"N	80°32'54.1775"W	14797.65	332.264	0.40
22225.00	90.340	340.860	6225.54	14538.85	13129.51	-6898.05	1766534.64	14595407.31	40°11'15.7482"N	80°32'54.3209"W	14831.29	332.283	1.76
22250.00‡	90.340	340.860	6225.39	14563.82	13153.13	-6906.25	1766526.45	14595430.92	40°11'15.9820"N	80°32'54.4250"W	14856.01	332.298	0.00

HOLE & CASING SECTIONS - Ref Wellbore: Roy Riggle OHI 201H AWB Ref Wellpath: Roy Riggle OHI 201H awp Proj: 22250'

String/Diameter	Start MD [ft]	End MD [ft]	Interval [ft]	Start TVD [ft]	End TVD [ft]	Start N/S [ft]	Start E/W [ft]	End N/S [ft]	End E/W [ft]
13.375in Casing	26.00	679.00	653.00	26.00	678.99	0.00	0.00	2.30	-1.55
9.625in Casing	26.00	2075.00	2049.00	26.00	2049.54	0.00	0.00	-110.22	-160.79
5.5in Casing	26.00	22250.00	22224.00	26.00	6225.39	0.00	0.00	13153.13	-6906.25

RECEIVED
Office Of Oil and Gas
APR 30 2024
WV Department of
Environmental Protection

REFERENCE WELLPATH IDENTIFICATION

Operator	SWN PRODUCTION COMPANY, LLC			Well	Roy Riggle OHI 201H		
Field	Ohio			API	47069003640000		
Facility	Roy Riggle OHI Pad			Wellbore	Roy Riggle OHI 201H AWB		
Slot	201H						

TARGETS

Name	TVD [ft]	North [ft]	East [ft]	Grid East [US ft]	Grid North [US ft]	Latitude	Longitude	Shape
Roy Riggle OHI 201H BHL Rev 2	6223.00	13156.69	-6901.77	1766530.92	14595434.48	40°11'16.0170"N	80°32'54.3671"W	point
Roy Riggle OHI 201H wp1	6299.60	9987.14	-5829.91	1767602.38	14592266.14	40°10'44.6417"N	80°32'40.7656"W	point
Roy Riggle OHI 201H LP Rev 3	6460.00	-859.22	-1526.65	1771903.99	14581423.92	40°08'57.2373"N	80°31'46.0662"W	point

WELLPATH COMPOSITION - Ref Wellbore: Roy Riggle OHI 201H AWB Ref Wellpath: Roy Riggle OHI 201H awp Proj: 22250'

Start MD [ft]	End MD [ft]	Positional Uncertainty Model	Log Name/Comment	Wellbore	Survey Date
26.00	668.00	Gyrodata 2015 - GC+WIR+DPIPE	1 Imported Gyro 100' - 668'	Roy Riggle OHI 201H AWB	12/4/2023
668.00	2068.00	OWSG MWD rev2 + IFR1 + Multi-Station Correction	2 Total MWD IFR-MSA 12.25" 778' - 2068'	Roy Riggle OHI 201H AWB	12/4/2023
2068.00	5801.00	OWSG MWD rev2 + IFR1 + Multi-Station Correction	3 Total MWD IFR-MSA 8.75" 2160' - 5801'	Roy Riggle OHI 201H AWB	12/4/2023
5801.00	22250.00	OWSG MWD rev2 + IFR1 + Multi-Station Correction	4 BH MWD IFR MSA Short spacing 8.5" 5903' - 22225'	Roy Riggle OHI 201H AWB	12/4/2023

RECEIVED
Office Of Oil and Gas
APR 30 2024
WV Department of
Environmental Protection

RECEIVED
Office Of Oil and Gas
APR 30 2024
WV Department of
Environmental Protection