



SWN PRODUCTION COMPANY, LLC



Location: Ohio County, WV
 Field: Ohio
 Facility: Dallas Hall OHI Pad

Slot: 406H
 Well: Dallas Hall OHI 406H
 Wellbore: Dallas Hall OHI 406H AWB

Plot reference wellpath is Dallas Hall OHI 406H awp Proj: 18084'
 Grid System: NAD83 / UTM Zone 17 North, US feet
 True vertical depths are referenced to SDC 41 (KB)
 North Reference: Grid north
 Scale: True distance
 Reference wellpath measured depths are referenced to SDC 41 (KB)
 SDC 41 (KB) to Mean Sea Level: 1300.6 feet
 Coordinates are in feet referenced to Slot
 Depths are in feet
 Mean Sea Level to Ground level (At Slot: 406H): -1274.6 feet
 Offset wellpath MDs are referenced to each path's default MD datum
 Created by: tranlam on 2023-08-14; Database: WA_MPL_EASTERNUS_Defn

Location Information

Facility Name			Grid East (US ft)	Grid North (US ft)	Latitude	Longitude
Dallas Hall OHI Pad			1748601.815	14575539.433	40°08'0.1760"N	80°36'46.5880"W
Slot	Local N (ft)	Local E (ft)	Grid East (US ft)	Grid North (US ft)	Latitude	Longitude
406H	-27.25	-14.31	1748587.510	14575512.190	40°07'59.9073"N	80°36'46.7738"W
SDC 41 (KB) to Ground level (At Slot: 406H)					26ft	
Mean Sea Level to Ground level (At Slot: 406H)					-1274.6ft	
SDC 41 (KB) to Mean Sea Level					1300.6ft	

Bottom Hole Location

MD (ft)	Inc (°)	Az (°)	TVD (ft)	Local N (ft)	Local E (ft)	Grid East (US ft)	Grid North (US ft)	Latitude	Longitude
18084.00	88.370	150.370	6290.27	-10728.33	1266.90	1749853.92	14564788.02	40°06'13.8349"N	80°36'31.0709"W

API: 47069003540000
 BH JOB: 111896979
 DURATION: 08.02.2023 to 08.07.2023
 RIG: SDC 41

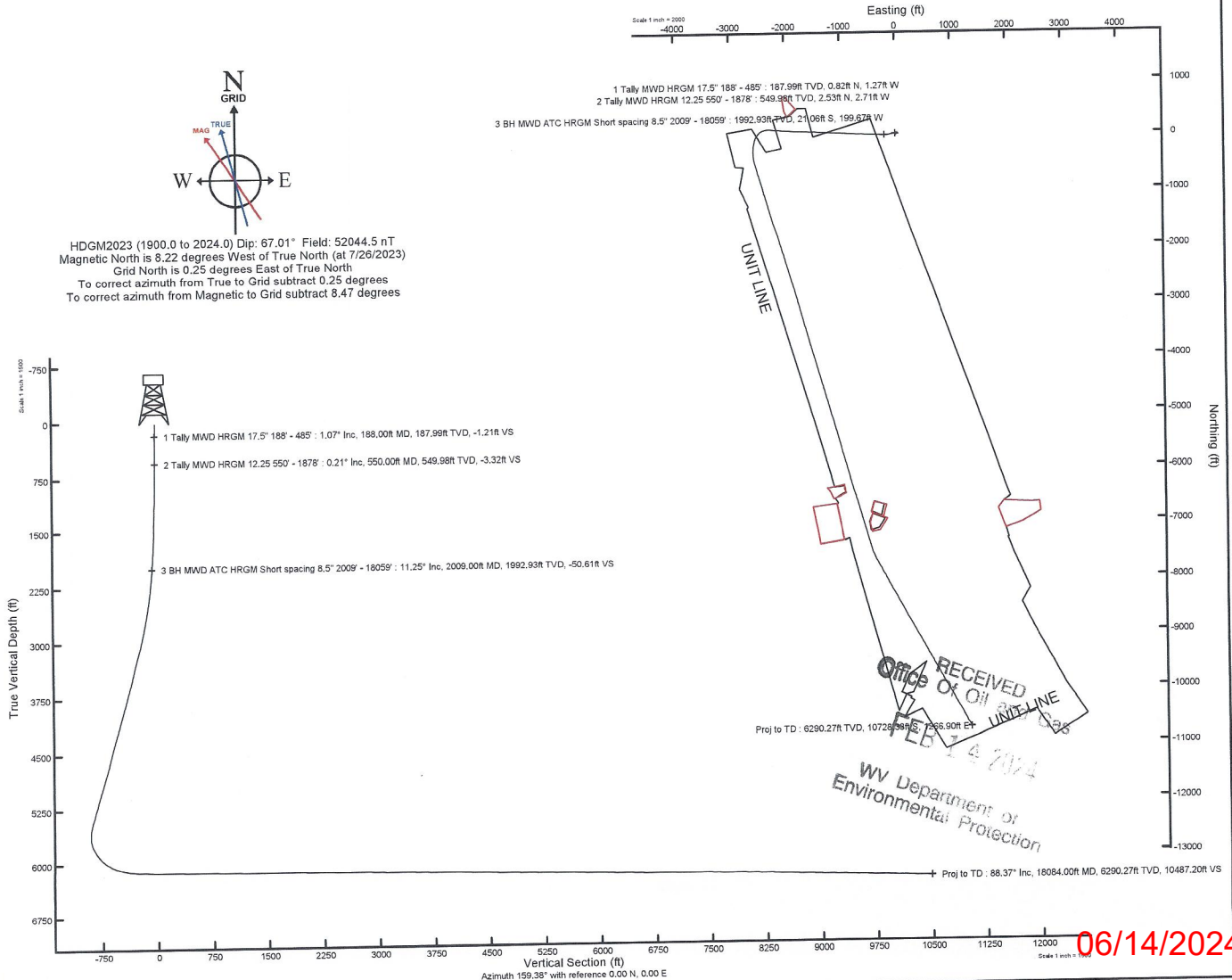

REFERENCE WELLPATH IDENTIFICATION

Operator	SWN PRODUCTION COMPANY, LLC	Well	Dallas Hall OHI 406H
Field	Ohio	API	47069003540000
Facility	Dallas Hall OHI Pad	Wellbore	Dallas Hall OHI 406H AWB
Slot	406H		

REPORT SETUP INFORMATION

Projection System	NAD83 / UTM Zone 17 North, US feet	Software System	WellArchitect® 6.0
North Reference	Grid	User	Tranlam
Scale	0.999613	Report Generated	8/14/2023 at 12:59:45 PM
Convergence at slot	0.25° East	Database	WA_MPL_EASTERNUS_Defn

WELLPATH LOCATION

	Local coordinates		Grid coordinates		Geographic coordinates	
	North[ft]	East[ft]	Easting[US ft]	Northing[US ft]	Latitude	Longitude
Slot Location	-27.25	-14.31	1748587.51	14575512.19	40°07'59.9073"N	80°36'46.7738"W
Facility Reference Pt			1748601.82	14575539.43	40°08'0.1760"N	80°36'46.5880"W
Field Reference Pt			0.00	0.00	0°00'0.0000"	85°29'19.4780"W

WELLPATH DATUM

Calculation method	Minimum curvature	SDC 41 (KB) to Facility Vertical Datum	1300.60ft
Horizontal Reference Pt	Slot	SDC 41 (KB) to Mean Sea Level	1300.60ft
Vertical Reference Pt	SDC 41 (KB)	SDC 41 (KB) to Ground Level at Slot (406H)	26.00ft
MD Reference Pt	SDC 41 (KB)	Section Origin	N 0.00, E 0.00 ft
Field Vertical Reference	Mean Sea Level	Section Azimuth	159.38°

RECEIVED
 Office of Oil and Gas
 Department of
 Environmental Protection
 8/14/2023

REFERENCE WELLPATH IDENTIFICATION

Operator	SWN PRODUCTION COMPANY, LLC	Well	Dallas Hall OHI 406H
Field	Ohio	API	47069003540000
Facility	Dallas Hall OHI Pad	Wellbore	Dallas Hall OHI 406H AWB
Slot	406H		

WELLPATH DATA (201 stations) † = interpolated, ‡ = extrapolated station

MD [ft]	Inclination [°]	Azimuth [°]	TVD [ft]	Vert Sect [ft]	North [ft]	East [ft]	Grid East [US ft]	Grid North [US ft]	Latitude	Longitude	Closure Dist [ft]	Closure Dir [°]	DLS [°/100ft]
0.00†	0.000	302.610	0.00	0.00	0.00	0.00	1748587.51	14575512.19	40°07'59.9073"N	80°36'46.7738"W	0.00	0.000	0.00
26.00	0.000	302.610	26.00	0.00	0.00	0.00	1748587.51	14575512.19	40°07'59.9073"N	80°36'46.7738"W	0.00	0.000	0.00
188.00	1.070	302.610	187.99	-1.21	0.82	-1.27	1748586.24	14575513.00	40°07'59.9154"N	80°36'46.7901"W	1.51	302.610	0.66
233.00	0.850	300.540	232.98	-1.81	1.21	-1.92	1748585.60	14575513.40	40°07'59.9193"N	80°36'46.7984"W	2.27	302.305	0.49
323.00	0.320	323.760	322.98	-2.57	1.75	-2.64	1748584.87	14575513.94	40°07'59.9247"N	80°36'46.8077"W	3.17	303.596	0.63
415.00	0.090	35.060	414.98	-2.86	2.02	-2.75	1748584.76	14575514.21	40°07'59.9274"N	80°36'46.8091"W	3.41	306.297	0.33
485.00	0.310	9.650	484.98	-3.05	2.25	-2.69	1748584.82	14575514.44	40°07'59.9297"N	80°36'46.8082"W	3.50	309.965	0.33
550.00	0.210	335.940	549.98	-3.32	2.53	-2.71	1748584.81	14575514.72	40°07'59.9324"N	80°36'46.8085"W	3.71	313.120	0.27
595.00	0.410	271.530	594.98	-3.47	2.61	-2.90	1748584.61	14575514.80	40°07'59.9332"N	80°36'46.8110"W	3.90	312.021	0.82
685.00	1.800	257.090	684.96	-3.78	2.31	-4.60	1748582.91	14575514.49	40°07'59.9303"N	80°36'46.8329"W	5.15	296.624	1.56
776.00	3.320	260.480	775.86	-4.48	1.55	-8.59	1748578.92	14575513.74	40°07'59.9230"N	80°36'46.8843"W	8.73	280.230	1.68
867.00	4.980	262.680	866.62	-5.89	0.61	-15.11	1748572.41	14575512.80	40°07'59.9140"N	80°36'46.9683"W	15.12	272.317	1.83
957.00	6.750	262.770	956.15	-8.02	-0.55	-24.23	1748563.29	14575511.64	40°07'59.9029"N	80°36'47.0858"W	24.24	268.695	1.97
1049.00	8.630	263.550	1047.32	-10.96	-2.01	-36.45	1748551.07	14575510.18	40°07'59.8890"N	80°36'47.2432"W	36.51	266.847	2.05
1141.00	10.020	263.770	1138.10	-14.64	-3.65	-51.27	1748536.26	14575508.54	40°07'59.8734"N	80°36'47.4341"W	51.40	265.926	1.51
1231.00	10.900	261.200	1226.60	-18.33	-5.80	-67.46	1748520.07	14575506.39	40°07'59.8528"N	80°36'47.6427"W	67.71	265.083	1.11
1322.00	10.780	259.230	1315.98	-21.54	-8.71	-84.33	1748503.22	14575503.48	40°07'59.8249"N	80°36'47.8599"W	84.77	264.103	0.43
1412.00	10.540	256.960	1404.43	-24.07	-12.14	-100.61	1748486.94	14575500.05	40°07'59.7917"N	80°36'48.0698"W	101.34	263.120	0.54
1502.00	10.100	256.810	1492.97	-26.18	-15.80	-116.32	1748471.24	14575496.40	40°07'59.7562"N	80°36'48.2722"W	117.38	262.265	0.49
1593.00	9.500	258.810	1582.64	-28.44	-19.08	-131.45	1748456.11	14575493.12	40°07'59.7244"N	80°36'48.4672"W	132.83	261.743	0.76
1686.00	8.690	262.840	1674.47	-31.33	-21.44	-145.95	1748441.61	14575490.76	40°07'59.7017"N	80°36'48.6541"W	147.52	261.643	1.11
1779.00	8.790	268.750	1766.40	-35.32	-22.47	-160.03	1748427.54	14575489.73	40°07'59.6921"N	80°36'48.8353"W	161.60	262.006	0.97
1869.00	9.540	272.900	1855.25	-40.58	-22.24	-174.35	1748413.23	14575489.95	40°07'59.6950"N	80°36'49.0197"W	175.76	262.729	1.11
1878.00	9.720	272.980	1864.12	-41.18	-22.17	-175.85	1748411.72	14575490.03	40°07'59.6958"N	80°36'49.0391"W	177.25	262.815	2.01
2009.00	11.250	272.410	1992.93	-50.61	-21.06	-199.67	1748387.92	14575491.14	40°07'59.7078"N	80°36'49.3456"W	200.77	263.980	1.17
2098.00	11.230	272.260	2080.22	-57.38	-20.35	-217.00	1748370.59	14575491.85	40°07'59.7155"N	80°36'49.5687"W	217.95	264.643	0.04
2188.00	12.840	271.990	2168.24	-64.63	-19.66	-235.75	1748351.85	14575492.54	40°07'59.7232"N	80°36'49.8101"W	236.57	265.234	1.79
2279.00	15.360	272.630	2256.49	-73.27	-18.75	-257.90	1748329.71	14575493.45	40°07'59.7331"N	80°36'50.0952"W	258.58	265.841	2.77
2370.00	17.580	272.150	2343.75	-83.35	-17.68	-283.68	1748303.94	14575494.51	40°07'59.7447"N	80°36'50.4270"W	284.23	266.433	2.44
2461.00	19.560	272.210	2430.01	-94.58	-16.58	-312.63	1748275.00	14575495.62	40°07'59.7569"N	80°36'50.7997"W	313.07	266.964	2.18

REFERENCE WELLPATH IDENTIFICATION

Operator	SWN PRODUCTION COMPANY, LLC	Well	Dallas Hall OHI 406H
Field	Ohio	API	47069003540000
Facility	Dallas Hall OHI Pad	Wellbore	Dallas Hall OHI 406H AWB
Slot	406H		

WELLPATH DATA (201 stations)

MD [ft]	Inclination [°]	Azimuth [°]	TVD [ft]	Vert Sect [ft]	North [ft]	East [ft]	Grid East [US ft]	Grid North [US ft]	Latitude	Longitude	Closure Dist [ft]	Closure Dir [°]	DLS [°/100ft]
2552.00	21.750	272.850	2515.16	-107.21	-15.15	-344.70	1748242.94	14575497.04	40°07'59.7724"N	80°36'51.2125"W	345.03	267.483	2.42
2643.00	23.500	272.690	2599.15	-121.11	-13.46	-379.67	1748207.99	14575498.73	40°07'59.7906"N	80°36'51.6626"W	379.90	267.969	1.92
2734.00	25.430	272.570	2681.98	-135.98	-11.74	-417.31	1748170.36	14575500.46	40°07'59.8092"N	80°36'52.1471"W	417.48	268.389	2.12
2826.00	26.460	272.800	2764.70	-151.90	-9.85	-457.52	1748130.17	14575502.34	40°07'59.8296"N	80°36'52.6647"W	457.62	268.767	1.12
2917.00	28.010	272.050	2845.61	-168.20	-8.09	-499.12	1748088.58	14575504.10	40°07'59.8487"N	80°36'53.2002"W	499.19	269.071	1.74
3007.00	30.200	272.250	2924.24	-185.14	-6.45	-542.87	1748044.86	14575505.74	40°07'59.8669"N	80°36'53.7633"W	542.90	269.319	2.44
3098.00	31.710	271.560	3002.28	-203.07	-4.90	-589.65	1747998.09	14575507.29	40°07'59.8842"N	80°36'54.3655"W	589.67	269.524	1.70
3191.00	33.740	271.710	3080.51	-222.11	-3.46	-639.90	1747947.86	14575508.73	40°07'59.9005"N	80°36'55.0124"W	639.91	269.690	2.18
3282.00	35.190	272.920	3155.54	-242.19	-1.37	-691.35	1747896.43	14575510.82	40°07'59.9234"N	80°36'55.6747"W	691.35	269.886	1.76
3373.00	35.080	273.230	3229.96	-263.23	1.44	-743.65	1747844.15	14575513.63	40°07'59.9534"N	80°36'56.3478"W	743.65	270.111	0.23
3464.00	32.670	273.740	3305.51	-283.94	4.51	-794.27	1747793.55	14575516.70	40°07'59.9859"N	80°36'56.9994"W	794.28	270.325	2.67
3555.00	30.270	273.990	3383.12	-303.62	7.71	-841.66	1747746.17	14575519.90	40°08'0.0196"N	80°36'57.6094"W	841.70	270.525	2.64
3646.00	29.540	274.020	3462.00	-322.53	10.88	-886.92	1747700.93	14575523.06	40°08'0.0528"N	80°36'58.1919"W	886.99	270.703	0.80
3737.00	32.210	273.770	3540.10	-341.90	14.05	-933.51	1747654.36	14575526.23	40°08'0.0861"N	80°36'58.7915"W	933.62	270.862	2.94
3828.00	34.460	273.290	3616.12	-362.35	17.12	-983.42	1747604.47	14575529.30	40°08'0.1186"N	80°36'59.4339"W	983.57	270.997	2.49
3920.00	35.750	272.870	3691.38	-383.61	19.96	-1036.25	1747551.66	14575532.14	40°08'0.1489"N	80°37'0.1139"W	1036.44	271.103	1.43
4011.00	33.460	272.950	3766.28	-404.24	22.58	-1087.86	1747500.07	14575534.76	40°08'0.1770"N	80°37'0.7783"W	1088.09	271.189	2.52
4102.00	36.110	273.030	3841.01	-425.04	25.29	-1139.70	1747448.25	14575537.47	40°08'0.2060"N	80°37'1.4455"W	1139.98	271.271	2.91
4193.00	35.850	273.470	3914.65	-446.67	28.32	-1193.07	1747394.90	14575540.50	40°08'0.2382"N	80°37'2.1326"W	1193.41	271.360	0.40
4285.00	36.130	272.720	3989.09	-468.41	31.24	-1247.06	1747340.94	14575543.42	40°08'0.2693"N	80°37'2.8274"W	1247.45	271.435	0.57
4376.00	35.710	272.840	4062.78	-489.61	33.83	-1300.38	1747287.63	14575546.00	40°08'0.2972"N	80°37'3.5138"W	1300.82	271.490	0.47
4467.00	35.690	273.540	4136.68	-511.05	36.78	-1353.40	1747234.64	14575548.96	40°08'0.3286"N	80°37'4.1962"W	1353.90	271.557	0.45
4559.00	36.420	273.420	4211.06	-533.16	40.07	-1407.45	1747180.61	14575552.24	40°08'0.3634"N	80°37'4.8919"W	1408.02	271.631	0.80
4650.00	35.990	272.870	4284.49	-554.82	43.02	-1461.12	1747126.96	14575555.19	40°08'0.3948"N	80°37'5.5827"W	1461.75	271.686	0.59
4742.00	35.450	272.040	4359.18	-575.88	45.32	-1514.78	1747073.32	14575557.49	40°08'0.4199"N	80°37'6.2734"W	1515.46	271.714	0.79
4833.00	35.300	272.050	4433.38	-596.18	47.20	-1567.43	1747020.69	14575559.37	40°08'0.4407"N	80°37'6.9512"W	1568.14	271.725	0.16
4925.00	34.640	271.470	4508.77	-616.25	48.82	-1620.13	1746968.01	14575560.99	40°08'0.4590"N	80°37'7.6296"W	1620.87	271.726	0.80
5016.00	33.540	272.450	4584.13	-635.83	50.56	-1671.10	1746917.05	14575562.73	40°08'0.4783"N	80°37'8.2858"W	1671.87	271.733	1.35
5108.00	33.630	272.320	4660.78	-655.72	52.68	-1721.95	1746866.23	14575564.85	40°08'0.5014"N	80°37'8.9403"W	1722.76	271.752	0.13
5199.00	36.300	272.630	4735.34	-676.18	54.94	-1774.05	1746814.15	14575567.10	40°08'0.5259"N	80°37'9.6109"W	1774.90	271.774	2.94

REFERENCE WELLPATH IDENTIFICATION				
Operator	SWN PRODUCTION COMPANY, LLC		Well	Dallas Hall OHI 406H
Field	Ohio		API	47069003540000
Facility	Dallas Hall OHI Pad		Wellbore	Dallas Hall OHI 406H AWB
Slot	406H			

WELLPATH DATA (201 stations)													
MD [ft]	Inclination [°]	Azimuth [°]	TVD [ft]	Vert Sect [ft]	North [ft]	East [ft]	Grid East [US ft]	Grid North [US ft]	Latitude	Longitude	Closure Dist [ft]	Closure Dir [°]	DLS [°/100ft]
5291.00	36.350	272.370	4809.47	-697.58	57.31	-1828.49	1746759.73	14575569.48	40°08'0.5517"N	80°37'10.3117"W	1829.39	271.795	0.18
5383.00	36.500	274.150	4883.49	-719.69	60.42	-1883.03	1746705.21	14575572.59	40°08'0.5847"N	80°37'11.0137"W	1884.00	271.838	1.16
5476.00	35.950	274.640	4958.52	-742.93	64.63	-1937.82	1746650.44	14575576.80	40°08'0.6286"N	80°37'11.7189"W	1938.90	271.910	0.67
5567.00	35.900	274.350	5032.21	-765.59	68.82	-1991.05	1746597.23	14575580.98	40°08'0.6722"N	80°37'12.4040"W	1992.24	271.979	0.19
5659.00	32.490	274.960	5108.29	-787.65	73.00	-2042.58	1746545.72	14575585.16	40°08'0.7157"N	80°37'13.0671"W	2043.88	272.047	3.73
5751.00	33.880	274.680	5185.29	-809.28	77.23	-2092.76	1746495.57	14575589.39	40°08'0.7596"N	80°37'13.7129"W	2094.18	272.113	1.52
5843.00	36.040	273.160	5260.68	-831.16	80.81	-2145.34	1746443.00	14575592.97	40°08'0.7973"N	80°37'14.3898"W	2146.86	272.157	2.53
5934.00	34.790	274.600	5334.85	-853.01	84.37	-2197.95	1746390.41	14575596.53	40°08'0.8346"N	80°37'15.0669"W	2199.57	272.198	1.65
6026.00	35.920	273.990	5409.88	-875.44	88.35	-2251.04	1746337.35	14575600.51	40°08'0.8762"N	80°37'15.7501"W	2252.77	272.248	1.29
6117.00	33.010	270.950	5484.90	-895.67	90.62	-2302.46	1746285.94	14575602.78	40°08'0.9008"N	80°37'16.4121"W	2304.25	272.254	3.71
6209.00	34.410	257.090	5561.55	-908.39	85.22	-2352.94	1746235.49	14575597.38	40°08'0.8496"N	80°37'17.0622"W	2354.48	272.074	8.48
6300.00	34.700	245.590	5636.57	-910.13	68.75	-2401.64	1746186.80	14575580.92	40°08'0.6889"N	80°37'17.6901"W	2402.62	271.640	7.17
6392.00	37.200	231.330	5711.18	-899.76	40.50	-2447.29	1746141.17	14575552.67	40°08'0.4116"N	80°37'18.2794"W	2447.62	270.948	9.48
6483.00	39.780	217.940	5782.52	-876.01	0.27	-2486.74	1746101.74	14575512.46	40°08'0.0158"N	80°37'18.7895"W	2486.74	270.006	9.57
6575.00	44.080	207.250	5851.04	-839.12	-51.48	-2519.55	1746068.94	14575460.73	40°07'59.5057"N	80°37'19.2147"W	2520.07	268.830	9.05
6666.00	48.970	196.780	5913.72	-790.52	-112.61	-2544.00	1746044.50	14575399.63	40°07'58.9027"N	80°37'19.5329"W	2546.49	267.466	9.92
6758.00	54.740	189.590	5970.57	-730.40	-182.98	-2560.30	1746028.20	14575329.28	40°07'58.2079"N	80°37'19.7467"W	2566.83	265.912	8.78
6849.00	62.560	184.790	6017.90	-661.68	-260.01	-2569.88	1746018.63	14575252.28	40°07'57.4471"N	80°37'19.8742"W	2583.00	264.223	9.70
6940.00	69.010	178.190	6055.24	-584.84	-342.87	-2571.92	1746016.59	14575169.45	40°07'56.6284"N	80°37'19.9049"W	2594.67	262.406	9.69
7032.00	76.110	171.170	6082.82	-500.27	-430.13	-2563.69	1746024.82	14575082.22	40°07'55.7657"N	80°37'19.8037"W	2599.52	260.476	10.60
7124.00	81.260	166.500	6100.88	-411.34	-518.58	-2546.20	1746042.30	14574993.82	40°07'54.8910"N	80°37'19.5834"W	2598.47	258.488	7.49
7215.00	85.750	163.780	6111.17	-321.41	-605.93	-2523.01	1746065.48	14574906.49	40°07'54.0267"N	80°37'19.2897"W	2594.75	256.495	5.76
7307.00	88.250	163.010	6115.99	-229.77	-693.97	-2496.75	1746091.73	14574818.49	40°07'53.1557"N	80°37'18.9565"W	2591.40	254.467	2.84
7398.00	88.120	163.540	6118.87	-139.02	-781.08	-2470.58	1746117.89	14574731.42	40°07'52.2938"N	80°37'18.6243"W	2591.11	252.456	0.60
7490.00	88.150	162.560	6121.86	-47.26	-869.03	-2443.77	1746144.69	14574643.50	40°07'51.4235"N	80°37'18.2840"W	2593.69	250.424	1.07
7581.00	89.380	163.180	6123.82	43.55	-955.97	-2416.98	1746171.47	14574556.59	40°07'50.5632"N	80°37'17.9438"W	2599.17	248.420	1.51
7673.00	89.910	163.260	6124.39	135.34	-1044.05	-2390.42	1746198.02	14574468.54	40°07'49.6917"N	80°37'17.6067"W	2608.47	246.406	0.58
7764.00	89.320	163.240	6125.00	226.13	-1131.19	-2364.19	1746224.24	14574381.44	40°07'48.8295"N	80°37'17.2738"W	2620.88	244.430	0.65
7856.00	89.450	163.940	6125.99	317.87	-1219.44	-2338.20	1746250.22	14574293.23	40°07'47.9563"N	80°37'16.9441"W	2637.09	242.457	0.77
7947.00	89.080	162.910	6127.16	408.64	-1306.65	-2312.25	1746276.16	14574206.05	40°07'47.0934"N	80°37'16.6147"W	2655.90	240.529	1.20

REFERENCE WELLPATH IDENTIFICATION			
Operator	SWN PRODUCTION COMPANY, LLC	Well	Dallas Hall OHI 406H
Field	Ohio	API	47069003540000
Facility	Dallas Hall OHI Pad	Wellbore	Dallas Hall OHI 406H AWB
Slot	406H		

WELLPATH DATA (201 stations)													
MD [ft]	Inclination [°]	Azimuth [°]	TVD [ft]	Vert Sect [ft]	North [ft]	East [ft]	Grid East [US ft]	Grid North [US ft]	Latitude	Longitude	Closure Dist [ft]	Closure Dir [°]	DLS [°/100ft]
8039.00	90.250	164.250	6127.70	500.39	-1394.89	-2286.24	1746302.16	14574117.84	40°07'46.2203"N	80°37'16.2847"W	2678.17	238.612	1.93
8130.00	89.540	162.690	6127.86	591.15	-1482.13	-2260.35	1746328.04	14574030.64	40°07'45.3572"N	80°37'15.9562"W	2702.94	236.747	1.88
8222.00	90.220	164.400	6128.06	682.90	-1570.35	-2234.29	1746354.09	14573942.45	40°07'44.4842"N	80°37'15.6256"W	2730.95	234.899	2.00
8314.00	89.480	159.970	6128.30	774.77	-1657.92	-2206.15	1746382.21	14573854.92	40°07'43.6177"N	80°37'15.2681"W	2759.67	233.075	4.88
8405.00	88.620	158.790	6129.81	865.75	-1743.08	-2174.11	1746414.24	14573769.79	40°07'42.7748"N	80°37'14.8603"W	2786.59	231.279	1.60
8497.00	89.080	164.650	6131.65	957.62	-1830.38	-2145.27	1746443.07	14573682.52	40°07'41.9109"N	80°37'14.4938"W	2820.01	229.529	6.39
8588.00	89.320	163.820	6132.92	1048.28	-1917.94	-2120.55	1746467.78	14573594.99	40°07'41.0445"N	80°37'14.1804"W	2859.24	227.872	0.95
8680.00	89.350	163.210	6133.99	1140.04	-2006.16	-2094.45	1746493.88	14573506.81	40°07'40.1717"N	80°37'13.8492"W	2900.24	226.233	0.66
8771.00	89.690	162.620	6134.76	1230.86	-2093.14	-2067.71	1746520.60	14573419.87	40°07'39.3110"N	80°37'13.5098"W	2942.22	224.650	0.75
8863.00	89.510	162.740	6135.40	1322.71	-2180.96	-2040.32	1746547.98	14573332.07	40°07'38.4419"N	80°37'13.1621"W	2986.56	223.092	0.24
8955.00	89.850	164.530	6135.91	1414.45	-2269.23	-2014.40	1746573.89	14573243.84	40°07'37.5686"N	80°37'12.8332"W	3034.34	221.596	1.98
9046.00	89.630	163.960	6136.32	1505.12	-2356.81	-1989.70	1746598.59	14573156.30	40°07'36.7021"N	80°37'12.5200"W	3084.39	220.172	0.67
9138.00	90.090	164.340	6136.55	1596.80	-2445.31	-1964.57	1746623.70	14573067.83	40°07'35.8264"N	80°37'12.2014"W	3136.73	218.778	0.65
9229.00	89.600	163.800	6136.80	1687.49	-2532.82	-1939.59	1746648.67	14572980.36	40°07'34.9607"N	80°37'11.8847"W	3190.17	217.444	0.80
9320.00	89.820	163.590	6137.26	1778.23	-2620.16	-1914.05	1746674.21	14572893.05	40°07'34.0965"N	80°37'11.5606"W	3244.81	216.148	0.33
9412.00	89.690	163.930	6137.65	1869.96	-2708.48	-1888.32	1746699.93	14572804.76	40°07'33.2226"N	80°37'11.2342"W	3301.76	214.884	0.40
9503.00	89.380	163.160	6138.39	1960.72	-2795.75	-1862.54	1746725.69	14572717.52	40°07'32.3591"N	80°37'10.9072"W	3359.36	213.672	0.91
9595.00	89.200	163.580	6139.53	2052.49	-2883.90	-1836.21	1746752.01	14572629.41	40°07'31.4869"N	80°37'10.5732"W	3418.85	212.485	0.50
9686.00	89.690	164.040	6140.41	2143.21	-2971.28	-1810.84	1746777.37	14572542.06	40°07'30.6223"N	80°37'10.2514"W	3479.61	211.360	0.74
9778.00	90.060	163.640	6140.61	2234.93	-3059.65	-1785.24	1746802.97	14572453.73	40°07'29.7480"N	80°37'9.9266"W	3542.39	210.263	0.59
9869.00	89.600	164.990	6140.88	2325.59	-3147.26	-1760.64	1746827.56	14572366.16	40°07'28.8812"N	80°37'9.6148"W	3606.25	209.223	1.57
9960.00	89.380	163.880	6141.69	2416.23	-3234.92	-1736.22	1746851.97	14572278.53	40°07'28.0139"N	80°37'9.3053"W	3671.39	208.223	1.24
10052.00	89.420	164.810	6142.65	2507.88	-3323.50	-1711.40	1746876.78	14572189.99	40°07'27.1375"N	80°37'8.9906"W	3738.25	207.246	1.01
10144.00	89.450	165.440	6143.56	2599.42	-3412.41	-1687.78	1746900.39	14572101.11	40°07'26.2579"N	80°37'8.6915"W	3806.98	206.317	0.69
10235.00	90.030	162.860	6143.97	2690.09	-3499.94	-1662.93	1746925.23	14572013.61	40°07'25.3918"N	80°37'8.3764"W	3874.91	205.414	2.91
10327.00	89.230	163.880	6144.57	2781.86	-3588.09	-1636.60	1746951.55	14571925.50	40°07'24.5196"N	80°37'8.0424"W	3943.71	204.519	1.41
10418.00	89.110	164.300	6145.89	2872.55	-3675.59	-1611.66	1746976.48	14571838.03	40°07'23.6539"N	80°37'7.7261"W	4013.40	203.676	0.48
10510.00	89.140	164.040	6147.29	2964.22	-3764.09	-1586.56	1747001.56	14571749.56	40°07'22.7782"N	80°37'7.4080"W	4084.80	202.855	0.28
10601.00	89.200	164.270	6148.61	3054.89	-3851.63	-1561.72	1747026.40	14571662.06	40°07'21.9122"N	80°37'7.0930"W	4156.20	202.071	0.26
10693.00	89.350	164.050	6149.77	3146.56	-3940.13	-1536.61	1747051.50	14571573.60	40°07'21.0366"N	80°37'6.7747"W	4229.16	201.305	0.29

REFERENCE WELLPATH IDENTIFICATION

Operator	SWN PRODUCTION COMPANY, LLC	Well	Dallas Hall OHI 406H
Field	Ohio	API	47069003540000
Facility	Dallas Hall OHI Pad	Wellbore	Dallas Hall OHI 406H AWB
Slot	406H		

WELLPATH DATA (201 stations)

MD [ft]	Inclination [°]	Azimuth [°]	TVD [ft]	Vert Sect [ft]	North [ft]	East [ft]	Grid East [US ft]	Grid North [US ft]	Latitude	Longitude	Closure Dist [ft]	Closure Dir [°]	DLS [°/100ft]
10785.00	89.170	163.730	6150.96	3238.27	-4028.51	-1511.08	1747077.01	14571485.25	40°07'20.1621"N	80°37'6.4510"W	4302.58	200.561	0.40
10876.00	89.170	163.880	6152.28	3328.99	-4115.89	-1485.71	1747102.38	14571397.90	40°07'19.2975"N	80°37'6.1291"W	4375.82	199.848	0.16
10967.00	89.540	163.860	6153.30	3419.70	-4203.30	-1460.43	1747127.65	14571310.53	40°07'18.4327"N	80°37'5.8085"W	4449.78	199.160	0.41
11059.00	89.480	163.470	6154.09	3511.44	-4291.58	-1434.55	1747153.52	14571222.28	40°07'17.5591"N	80°37'5.4803"W	4525.00	198.483	0.43
11150.00	89.080	164.340	6155.23	3602.15	-4379.01	-1409.33	1747178.73	14571134.89	40°07'16.6941"N	80°37'5.1605"W	4600.21	197.840	1.05
11242.00	89.140	164.110	6156.66	3693.81	-4467.53	-1384.32	1747203.73	14571046.40	40°07'15.8183"N	80°37'4.8434"W	4677.09	197.216	0.26
11333.00	89.350	164.270	6157.86	3784.48	-4555.08	-1359.53	1747228.51	14570958.88	40°07'14.9521"N	80°37'4.5292"W	4753.64	196.618	0.29
11425.00	89.260	164.100	6158.98	3876.15	-4643.59	-1334.46	1747253.57	14570870.40	40°07'14.0763"N	80°37'4.2114"W	4831.53	196.033	0.21
11516.00	89.720	163.400	6159.79	3966.88	-4730.95	-1308.99	1747279.03	14570783.08	40°07'13.2119"N	80°37'3.8884"W	4908.70	195.466	0.92
11607.00	89.350	163.990	6160.53	4057.62	-4818.29	-1283.45	1747304.56	14570695.78	40°07'12.3478"N	80°37'3.5644"W	4986.29	194.916	0.77
11699.00	88.950	163.900	6161.89	4149.32	-4906.69	-1258.00	1747329.99	14570607.41	40°07'11.4731"N	80°37'3.2418"W	5065.39	194.380	0.45
11790.00	88.830	163.910	6163.65	4240.02	-4994.11	-1232.78	1747355.21	14570520.02	40°07'10.6082"N	80°37'2.9220"W	5144.01	193.866	0.13
11882.00	89.050	164.100	6165.36	4331.70	-5082.53	-1207.44	1747380.54	14570431.64	40°07'9.7333"N	80°37'2.6006"W	5223.98	193.364	0.32
11973.00	88.860	163.550	6167.02	4422.42	-5169.91	-1182.09	1747405.88	14570344.29	40°07'8.8687"N	80°37'2.2792"W	5303.33	192.879	0.64
12064.00	88.280	163.460	6169.29	4513.15	-5257.14	-1156.26	1747431.70	14570257.09	40°07'8.0056"N	80°37'1.9516"W	5382.79	192.404	0.64
12156.00	88.950	164.030	6171.51	4604.86	-5345.43	-1130.52	1747457.43	14570168.83	40°07'7.1320"N	80°37'1.6251"W	5463.67	191.942	0.96
12247.00	89.260	164.290	6172.93	4695.53	-5432.97	-1105.68	1747482.26	14570081.33	40°07'6.2659"N	80°37'1.3103"W	5544.34	191.503	0.44
12339.00	88.740	164.670	6174.54	4787.15	-5521.60	-1081.07	1747506.86	14569992.74	40°07'5.3890"N	80°37'0.9984"W	5626.44	191.078	0.70
12430.00	89.110	163.790	6176.25	4877.81	-5609.16	-1056.34	1747531.58	14569905.21	40°07'4.5227"N	80°37'0.6849"W	5707.76	190.665	1.05
12521.00	88.800	162.830	6177.90	4968.58	-5696.31	-1030.21	1747557.70	14569818.09	40°07'3.6604"N	80°37'0.3534"W	5788.72	190.251	1.11
12613.00	88.710	162.300	6179.90	5060.41	-5784.06	-1002.65	1747585.25	14569730.38	40°07'2.7920"N	80°37'0.0036"W	5870.32	189.834	0.58
12704.00	88.950	162.810	6181.76	5151.25	-5870.86	-975.38	1747612.51	14569643.61	40°07'1.9332"N	80°36'59.6573"W	5951.33	189.433	0.62
12887.00	89.780	165.100	6183.79	5333.65	-6046.70	-924.80	1747663.07	14569467.84	40°07'0.1933"N	80°36'59.0161"W	6117.02	188.696	1.33
12979.00	89.170	164.080	6184.63	5425.26	-6135.39	-900.36	1747687.50	14569379.18	40°06'59.3158"N	80°36'58.7064"W	6201.10	188.348	1.29
13070.00	89.290	164.180	6185.86	5515.94	-6222.92	-875.48	1747712.37	14569291.69	40°06'58.4498"N	80°36'58.3910"W	6284.20	188.008	0.17
13162.00	88.680	164.580	6187.49	5607.57	-6311.50	-850.71	1747737.13	14569203.14	40°06'57.5734"N	80°36'58.0772"W	6368.58	187.676	0.79
13253.00	88.680	162.960	6189.58	5698.28	-6398.85	-825.28	1747762.55	14569115.83	40°06'56.7091"N	80°36'57.7547"W	6451.85	187.349	1.78
13345.00	88.770	164.060	6191.63	5790.02	-6487.04	-799.18	1747788.65	14569027.67	40°06'55.8365"N	80°36'57.4236"W	6536.09	187.023	1.20
13437.00	88.920	163.660	6193.48	5881.72	-6575.40	-773.61	1747814.20	14568939.35	40°06'54.9622"N	80°36'57.0994"W	6620.75	186.710	0.46
13528.00	89.290	164.210	6194.91	5972.42	-6662.83	-748.43	1747839.37	14568851.95	40°06'54.0971"N	80°36'56.7802"W	6704.74	186.409	0.73

REFERENCE WELLPATH IDENTIFICATION			
Operator	SWN PRODUCTION COMPANY, LLC	Well	Dallas Hall OHI 406H
Field	Ohio	API	47069003540000
Facility	Dallas Hall OHI Pad	Wellbore	Dallas Hall OHI 406H AWB
Slot	406H		

WELLPATH DATA (201 stations)													
MD [ft]	Inclination [°]	Azimuth [°]	TVD [ft]	Vert Sect [ft]	North [ft]	East [ft]	Grid East [US ft]	Grid North [US ft]	Latitude	Longitude	Closure Dist [ft]	Closure Dir [°]	DLS ["/100ft]
13620.00	88.890	164.430	6196.37	6064.06	-6751.40	-723.57	1747864.23	14568763.41	40°06'53.2209"N	80°36'56.4651"W	6790.06	186.117	0.50
13711.00	88.710	164.160	6198.27	6154.71	-6838.98	-698.94	1747888.84	14568675.87	40°06'52.3543"N	80°36'56.1530"W	6874.61	185.835	0.36
13803.00	88.860	164.450	6200.22	6246.35	-6927.53	-674.06	1747913.71	14568587.35	40°06'51.4782"N	80°36'55.8377"W	6960.25	185.557	0.35
13894.00	88.770	163.780	6202.10	6337.02	-7015.04	-649.16	1747938.61	14568499.88	40°06'50.6124"N	80°36'55.5221"W	7045.01	185.287	0.74
13986.00	89.110	164.060	6203.81	6428.71	-7103.42	-623.68	1747964.07	14568411.53	40°06'49.7379"N	80°36'55.1991"W	7130.75	185.018	0.48
14077.00	88.890	163.970	6205.40	6519.40	-7190.89	-598.62	1747989.12	14568324.09	40°06'48.8725"N	80°36'54.8814"W	7215.76	184.759	0.26
14169.00	88.770	163.980	6207.27	6611.09	-7279.30	-573.23	1748014.50	14568235.72	40°06'47.9977"N	80°36'54.5595"W	7301.83	184.503	0.13
14260.00	89.820	160.520	6208.39	6701.95	-7365.94	-545.49	1748042.23	14568149.11	40°06'47.1403"N	80°36'54.2074"W	7386.12	184.235	3.97
14352.00	89.260	161.530	6209.13	6793.91	-7452.94	-515.58	1748072.13	14568062.15	40°06'46.2793"N	80°36'53.8272"W	7470.75	183.957	1.26
14443.00	89.720	159.040	6209.94	6884.89	-7538.60	-484.89	1748102.81	14567976.52	40°06'45.4315"N	80°36'53.4369"W	7554.17	183.680	2.78
14535.00	89.110	155.290	6210.88	6976.80	-7623.37	-449.19	1748138.49	14567891.79	40°06'44.5923"N	80°36'52.9822"W	7636.59	183.372	4.13
14626.00	89.780	151.580	6211.76	7067.29	-7704.74	-408.50	1748179.16	14567810.44	40°06'43.7864"N	80°36'52.4631"W	7715.56	183.035	4.14
14718.00	89.260	151.940	6212.53	7158.47	-7785.79	-364.97	1748222.68	14567729.43	40°06'42.9837"N	80°36'51.9074"W	7794.34	182.684	0.69
14810.00	89.630	151.150	6213.43	7249.61	-7866.67	-321.14	1748266.49	14567648.58	40°06'42.1825"N	80°36'51.3478"W	7873.22	182.338	0.95
14901.00	89.260	151.410	6214.31	7339.69	-7946.47	-277.42	1748310.20	14567568.81	40°06'41.3920"N	80°36'50.7894"W	7951.31	181.999	0.50
14992.00	89.420	152.620	6215.36	7429.94	-8026.82	-234.72	1748352.88	14567488.49	40°06'40.5962"N	80°36'50.2444"W	8030.25	181.675	1.34
15084.00	88.920	151.830	6216.69	7521.21	-8108.21	-191.85	1748395.73	14567407.13	40°06'39.7900"N	80°36'49.6972"W	8110.48	181.355	1.02
15176.00	88.800	151.680	6218.52	7612.38	-8189.24	-148.32	1748439.25	14567326.13	40°06'38.9874"N	80°36'49.1415"W	8190.59	181.038	0.21
15267.00	88.710	149.130	6220.50	7702.23	-8268.34	-103.39	1748484.16	14567247.06	40°06'38.2038"N	80°36'48.5677"W	8268.99	180.716	2.80
15359.00	89.260	151.670	6222.13	7793.09	-8348.32	-57.96	1748529.57	14567167.12	40°06'37.4115"N	80°36'47.9875"W	8348.52	180.398	2.82
15450.00	89.450	151.390	6223.15	7883.23	-8428.31	-14.59	1748572.93	14567087.16	40°06'36.6192"N	80°36'47.4337"W	8428.32	180.099	0.37
15542.00	89.600	151.380	6223.91	7974.33	-8509.07	29.47	1748616.97	14567006.43	40°06'35.8192"N	80°36'46.8711"W	8509.12	179.802	0.16
15633.00	89.140	151.380	6224.91	8064.44	-8588.95	73.06	1748660.54	14566926.58	40°06'35.0280"N	80°36'46.3147"W	8589.26	179.513	0.51
15725.00	88.950	151.740	6226.45	8155.57	-8669.83	116.87	1748704.33	14566845.73	40°06'34.2268"N	80°36'45.7554"W	8670.62	179.228	0.44
15816.00	88.580	151.720	6228.41	8245.74	-8749.96	159.96	1748747.40	14566765.63	40°06'33.4331"N	80°36'45.2053"W	8751.42	178.953	0.41
15908.00	88.180	151.020	6231.01	8336.80	-8830.68	204.02	1748791.45	14566684.95	40°06'32.6336"N	80°36'44.6427"W	8833.03	178.676	0.88
15999.00	87.940	150.690	6234.09	8426.75	-8910.11	248.31	1748835.73	14566605.54	40°06'31.8467"N	80°36'44.0771"W	8913.57	178.404	0.45
16090.00	88.490	151.520	6236.92	8516.75	-8989.74	292.26	1748879.66	14566525.94	40°06'31.0579"N	80°36'43.5160"W	8994.49	178.138	1.09
16182.00	88.580	151.040	6239.28	8607.81	-9070.40	336.46	1748923.84	14566445.32	40°06'30.2590"N	80°36'42.9517"W	9076.63	177.876	0.53
16274.00	88.310	151.560	6241.77	8698.86	-9151.06	380.62	1748967.98	14566364.68	40°06'29.4599"N	80°36'42.3879"W	9158.98	177.618	0.64

Actual Wellpath Report

Dallas Hall OHI 406H awp Proj: 18084'

Page 8 of 9

REFERENCE WELLPATH IDENTIFICATION

Operator	SWN PRODUCTION COMPANY, LLC	Well	Dallas Hall OHI 406H
Field	Ohio	API	47069003540000
Facility	Dallas Hall OHI Pad	Wellbore	Dallas Hall OHI 406H AWB
Slot	406H		

WELLPATH DATA (201 stations) † = interpolated, ‡ = extrapolated station

MD [ft]	Inclination [°]	Azimuth [°]	TVD [ft]	Vert Sect [ft]	North [ft]	East [ft]	Grid East [US ft]	Grid North [US ft]	Latitude	Longitude	Closure Dist [ft]	Closure Dir [°]	DLS ["/100ft]
16365.00	88.520	151.300	6244.29	8788.95	-9230.95	424.12	1749011.47	14566284.83	40°06'28.6686"N	80°36'41.8325"W	9240.69	177.369	0.37
16456.00	88.980	151.510	6246.28	8879.05	-9310.83	467.67	1749055.00	14566204.98	40°06'27.8773"N	80°36'41.2766"W	9322.57	177.125	0.56
16548.00	88.490	152.180	6248.31	8970.23	-9391.93	511.07	1749098.38	14566123.91	40°06'27.0740"N	80°36'40.7226"W	9405.82	176.885	0.90
16640.00	88.740	151.200	6250.53	9061.38	-9472.90	554.69	1749141.98	14566042.97	40°06'26.2720"N	80°36'40.1658"W	9489.12	176.649	1.10
16731.00	88.220	151.040	6252.94	9151.40	-9552.55	598.62	1749185.90	14565963.35	40°06'25.4830"N	80°36'39.6049"W	9571.29	176.414	0.60
16822.00	87.850	148.910	6256.06	9241.12	-9631.29	644.13	1749231.39	14565884.64	40°06'24.7029"N	80°36'39.0237"W	9652.81	176.174	2.37
16914.00	88.890	149.950	6258.68	9331.70	-9710.47	690.90	1749278.14	14565805.49	40°06'23.9184"N	80°36'38.4262"W	9735.02	175.930	1.60
17006.00	88.430	150.130	6260.83	9422.45	-9790.15	736.83	1749324.05	14565725.84	40°06'23.1290"N	80°36'37.8396"W	9817.84	175.696	0.54
17097.00	88.120	150.790	6263.57	9512.31	-9869.29	781.67	1749368.88	14565646.74	40°06'22.3450"N	80°36'37.2669"W	9900.19	175.471	0.80
17189.00	88.460	151.170	6266.32	9603.28	-9949.70	826.28	1749413.47	14565566.36	40°06'21.5485"N	80°36'36.6973"W	9983.95	175.253	0.55
17280.00	88.090	149.810	6269.06	9693.14	-10028.86	871.09	1749458.26	14565487.23	40°06'20.7643"N	80°36'36.1252"W	10066.62	175.036	1.55
17372.00	88.950	150.080	6271.43	9783.87	-10108.46	917.15	1749504.30	14565407.66	40°06'19.9757"N	80°36'35.5369"W	10149.98	174.816	0.98
17464.00	88.860	150.730	6273.19	9874.73	-10188.44	962.57	1749549.71	14565327.71	40°06'19.1833"N	80°36'34.9568"W	10233.81	174.603	0.71
17555.00	88.550	150.960	6275.25	9964.69	-10267.89	1006.89	1749594.01	14565248.29	40°06'18.3962"N	80°36'34.3909"W	10317.14	174.399	0.42
17647.00	88.090	150.240	6277.95	10055.58	-10348.01	1052.04	1749639.14	14565168.20	40°06'17.6026"N	80°36'33.8145"W	10401.35	174.195	0.93
17738.00	88.400	150.810	6280.73	10145.45	-10427.19	1096.79	1749683.88	14565089.05	40°06'16.8181"N	80°36'33.2430"W	10484.72	173.995	0.71
17830.00	88.400	150.590	6283.30	10236.36	-10507.39	1141.80	1749728.86	14565008.88	40°06'16.0236"N	80°36'32.6684"W	10569.25	173.798	0.24
17922.00	88.580	150.910	6285.73	10327.29	-10587.63	1186.74	1749773.78	14564928.67	40°06'15.2287"N	80°36'32.0946"W	10653.94	173.605	0.40
18013.00	88.280	149.910	6288.22	10417.14	-10666.74	1231.65	1749818.68	14564849.60	40°06'14.4451"N	80°36'31.5210"W	10737.61	173.413	1.15
18059.00	88.370	150.370	6289.56	10462.52	-10706.61	1254.55	1749841.57	14564809.74	40°06'14.0500"N	80°36'31.2287"W	10779.86	173.317	1.02
18084.00‡	88.370	150.370	6290.27	10487.20	-10728.33	1266.90	1749853.92	14564788.02	40°06'13.8349"N	80°36'31.0709"W	10802.88	173.265	0.00

REFERENCE WELLPATH IDENTIFICATION			
Operator	SWN PRODUCTION COMPANY, LLC	Well	Dallas Hall OHI 406H
Field	Ohio	API	47069003540000
Facility	Dallas Hall OHI Pad	Wellbore	Dallas Hall OHI 406H AWB
Slot	406H		

HOLE & CASING SECTIONS - Ref Wellbore: Dallas Hall OHI 406H AWB Ref Wellpath: Dallas Hall OHI 406H awp Proj: 18084'									
String/Diameter	Start MD [ft]	End MD [ft]	Interval [ft]	Start TVD [ft]	End TVD [ft]	Start N/S [ft]	Start E/W [ft]	End N/S [ft]	End E/W [ft]
13.375in Casing	26.00	540.00	514.00	26.00	539.98	0.00	0.00	2.50	-2.69
9.625in Casing	26.00	1948.00	1922.00	26.00	1933.03	0.00	0.00	-21.56	-188.15
5.5in Casing	26.00	18084.00	18058.00	26.00	6290.27	0.00	0.00	-10728.33	1266.90

TARGETS									
Name	TVD [ft]	North [ft]	East [ft]	Grid East [US ft]	Grid North [US ft]	Latitude	Longitude	Shape	
Dallas Hall OHI 406H wp1	6107.00	-7237.00	-586.74	1748001.00	14568278.00	40°06'48.4163"N	80°36'54.7310"W	point	
Dallas Hall OHI 406H LP Rev 3	6108.00	-605.08	-2534.78	1746053.71	14574907.35	40°07'54.0357"N	80°37'19.4412"W	point	
Dallas Hall OHI 406H BHL rev4	6293.00	-10726.36	1273.99	1749861.00	14564790.00	40°06'13.8541"N	80°36'30.9796"W	point	

WELLPATH COMPOSITION - Ref Wellbore: Dallas Hall OHI 406H AWB Ref Wellpath: Dallas Hall OHI 406H awp Proj: 18084'									
Start MD [ft]	End MD [ft]	Positional Uncertainty Model	Log Name/Comment	Wellbore	Survey Date				
26.00	485.00	OWSG MWD rev2 + HRGM	1 Tally MWD HRGM 17.5" 188' - 485'	Dallas Hall OHI 406H AWB	8/1/2023				
485.00	1878.00	OWSG MWD rev2 + HRGM	2 Tally MWD HRGM 12.25 550' - 1878'	Dallas Hall OHI 406H AWB	8/1/2023				
1878.00	18084.00	BH AutoTrak Curve/Express (2019) (HRGM, Short spacing)	3 BH MWD ATC HRGM Short spacing 8.5" 2009' - 18059'	Dallas Hall OHI 406H AWB	8/1/2023				