



SURVEYOR/ENGINEER: 1-304-933-3463  
 2361 DAVISSON RUN ROAD, SUITE 103  
 CLARKSBURG, WV 26301

**SURFACE HOLE LOCATION (SHL):**  
 UTM (NAD83, ZONE 17, METERS):  
 NORTHING: 4,437,623.793  
 EASTING: 529,174.074

**LANDING POINT (LPL):**  
 UTM (NAD83, ZONE 17, METERS):  
 NORTHING: 4,437,432.881  
 EASTING: 528,761.965

**BOTTOM HOLE LOCATION (BHL):**  
 UTM (NAD83, ZONE 17, METERS):  
 NORTHING: 4,433,511.331  
 EASTING: 530,519.104

LINE	BEARING	DISTANCE	DESCRIPTION	MONUMENT
L1	N 76°16'44" W	761.72'	SHL TO LANDMARK	STONE FOUND
L2	N 26°40'08" E	959.81'	SHL TO LANDMARK	CONCRETE MONUMENT

LATITUDE: 40°07'30" SURFACE HOLE 9,171'

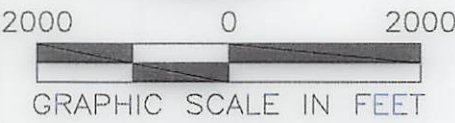
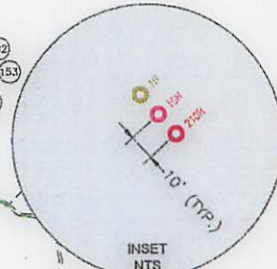
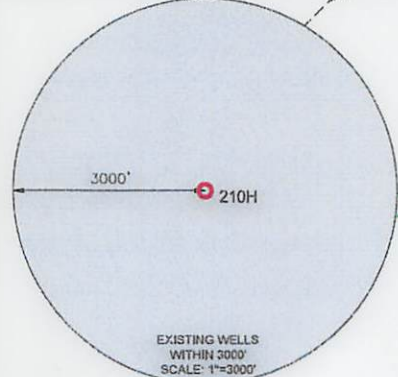
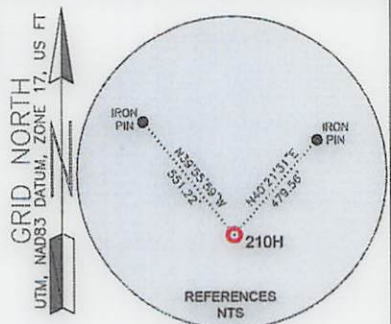

**WELL RESTRICTIONS**

1. NO OCCUPIED DWELLINGS > 2500 SQ FT. WITHIN 625 FEET OF CENTER OF PAD.
2. NO AGRICULTURE BUILDINGS > 2500 SQ FT. WITHIN 625 FEET OF CENTER OF PAD.
3. NO WATER WELLS OR DEVELOPED SPRINGS ARE WITHIN 250 FEET OF PROPOSED WELL.
4. PERENNIAL STREAMS, LAKES, PONDS, OR RESERVOIRS WITHIN 100 FEET OF THE LIMITS OF DISTURBANCE.
5. NO NATURALLY PRODUCING TROUT STREAM WITHIN 300 FEET OF LIMITS OF DISTURBANCE.
6. NO GROUND INTAKE OR PUBLIC WATER SUPPLY WITHIN 1000 FEET OF WELL PAD. LIMITS OF DISTURBANCE, E & S CONTROLS OR PUBLIC WATER SUPPLY.

LINE	BEARING	DISTANCE	CURVE LENGTH	DESCRIPTION
L3	S 65°08'38" W	1,490.09'	2,196.98'	SHL TO LPL
L4	S 29°59'53" E	499.27'	499.91'	AZL1 TO AZL2
L5	S 34°59'55" E	199.91'	199.91'	AZL2 TO AZL3
L6	S 25°05'35" E	986.25'	990.66'	AZL3 TO AZL4
L7	S 15°11'00" E	200.26'	200.26'	AZL4 TO AZL5
L8	S 20°03'20" E	488.67'	489.27'	AZL5 TO AZL6
L9	S 24°55'41" E	2,698.71'	2,698.71'	AZL6 TO AZL7
L10	S 18°24'51" E	649.64'	650.50'	AZL7 TO AZL8
L11	S 11°53'59" E	607.67'	607.67'	AZL8 TO BHL

**NOTES ON SURVEY**

1. TIES TO WELLS AND CORNERS ARE BASED ON STATE PLANE WV NORTH ZONE NAD '83.
2. WELL LAT./LONG ESTABLISHED BY DIRECT GPS NAD '83.
3. BOUNDARIES SHOWN ARE TAKEN FROM TAX MAPS, DEEDS, AND FIELD SURVEY. THIS DRAWING IS NOT REPRESENTATIVE OF A FULL BOUNDARY SURVEY.
4. SURFACE OWNER INFORMATION TAKEN FROM THE ASSESSOR AND COUNTY CLERK RECORDS OF OHIO COUNTY IN OCTOBER OF 2021.
5. WELLS SHOWN ARE TAKEN FROM RECORDS OF WVDEP.

I, THE UNDERSIGNED, HEREBY CERTIFY THAT THIS PLAT IS CORRECT TO THE BEST OF MY KNOWLEDGE AND BELIEF AND SHOWS ALL THE INFORMATION REQUIRED BY LAW AND REGULATIONS ISSUED AND PRESCRIBED BY THE DEPARTMENT OF ENVIRONMENTAL PROTECTION.

P.S. 983



(+) DENOTES LOCATION OF WELL ON UNITED STATES TOPOGRAPHIC MAPS

WVDEP  
 OFFICE OF OIL & GAS  
 601 57TH STREET  
 CHARLESTON, WV 25034

MINIMUM DEGREE OF ACCURACY: 1/200

PROVEN SURVEY SOURCE OF GRADE GPS ELEVATION: (NAVD 88, US FT)

COMPANY: **SWN** Production Company, LLC

**SWN** Production Company™

SHANNON FIELDS OHI

OPERATOR'S WELL #: 210H

API WELL #: 47 69 00334 H6A

STATE COUNTY PERMIT

WELL TYPE: OIL  WASTE DISPOSAL  PRODUCTION  DEEP  GAS  LIQUID INJECTION  STORAGE  SHALLOW

WATERSHED: UPPER OHIO SOUTH ELEVATION: 1232.0'

DISTRICT: RICHLAND COUNTY: OHIO QUADRANGLE: WHEELING 7.5', WV

SURFACE OWNER: SHANNON FIELDS, LLC ACREAGE: ±35.07

OIL & GAS ROYALTY OWNER: SHANNON FIELDS, LLC ACREAGE: ±35.07

DRILL  DRILL DEEPER  REDRILL  FRACTURE OR STIMULATE  PLUG OFF OLD FORMATION  PERFORATE NEW FORMATION

CONVERT  PLUG & ABANDON  CLEAN OUT & REPLUG  OTHER CHANGE  (SPECIFY)

TARGET FORMATION: MARCELLUS ESTIMATED DEPTH: 6,256 TVD 20,927 TMD

WELL OPERATOR: SWN PRODUCTION COMPANY, LLC DESIGNATED AGENT: BRITANY WOODY

ADDRESS: 1300 FORT PIERPONT DRIVE, SUITE 201 ADDRESS: 1300 FORT PIERPONT DRIVE, SUITE 201

CITY: MORGANTOWN STATE: WV ZIP CODE: 26508 CITY: MORGANTOWN STATE: WV ZIP CODE: 26508

- LEGEND:**
- PROPOSED SURFACE HOLE / BOTTOM HOLE
  - ⊙ EXISTING / PRODUCING WELLHEAD
  - LPL\* LANDING POINT LOCATION
  - ⊙ EXISTING WATER WELL
  - ⊙ EXISTING SPRING
  - SURVEYED BOUNDARY
  - DRILLING UNIT
  - LEASE BOUNDARY
  - PROPOSED PATH

**REVISIONS:**

DATE: 01-26-2022

DRAWN BY: NBG

SCALE: 1" = 2000'

DRAWING NO: ACE-2326

WELL LOCATION PLAT

SURFACE HOLE 13,341' LONGITUDE: 80°37'30" BOTTOM HOLE 26,856'



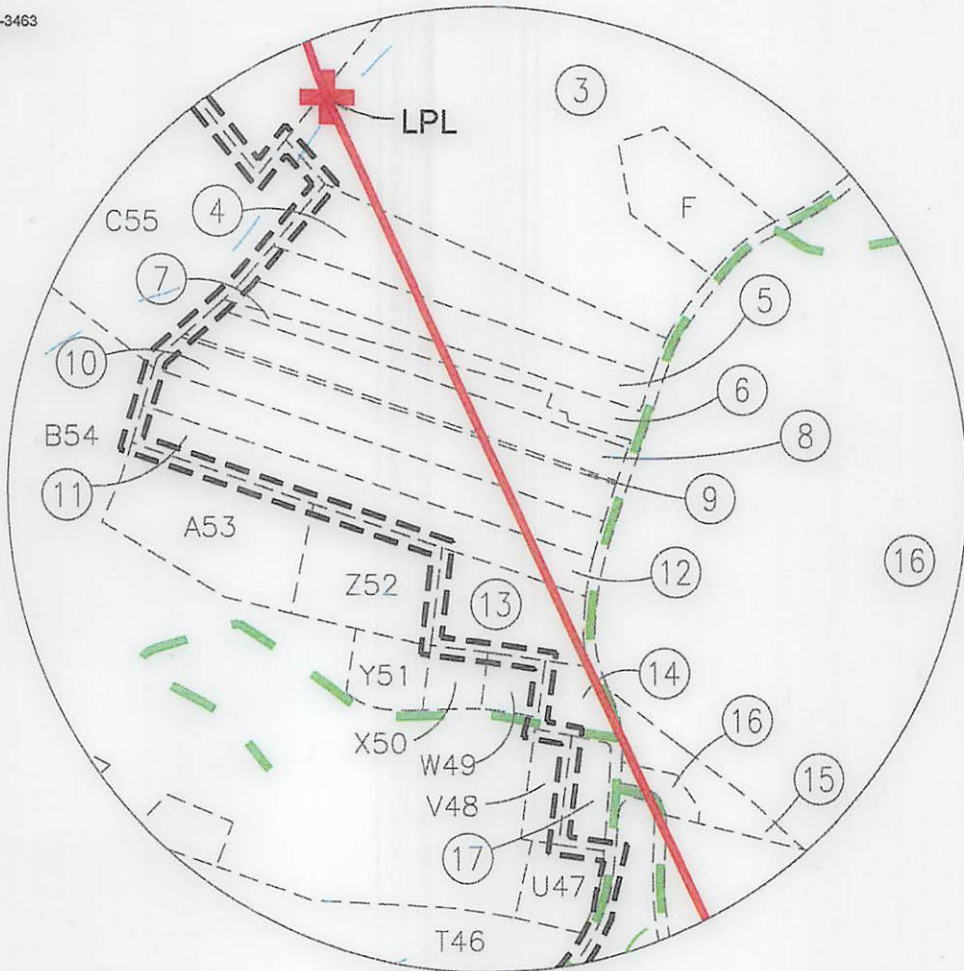

BLOW UP INSET 1  
SCALE: 1"=500'

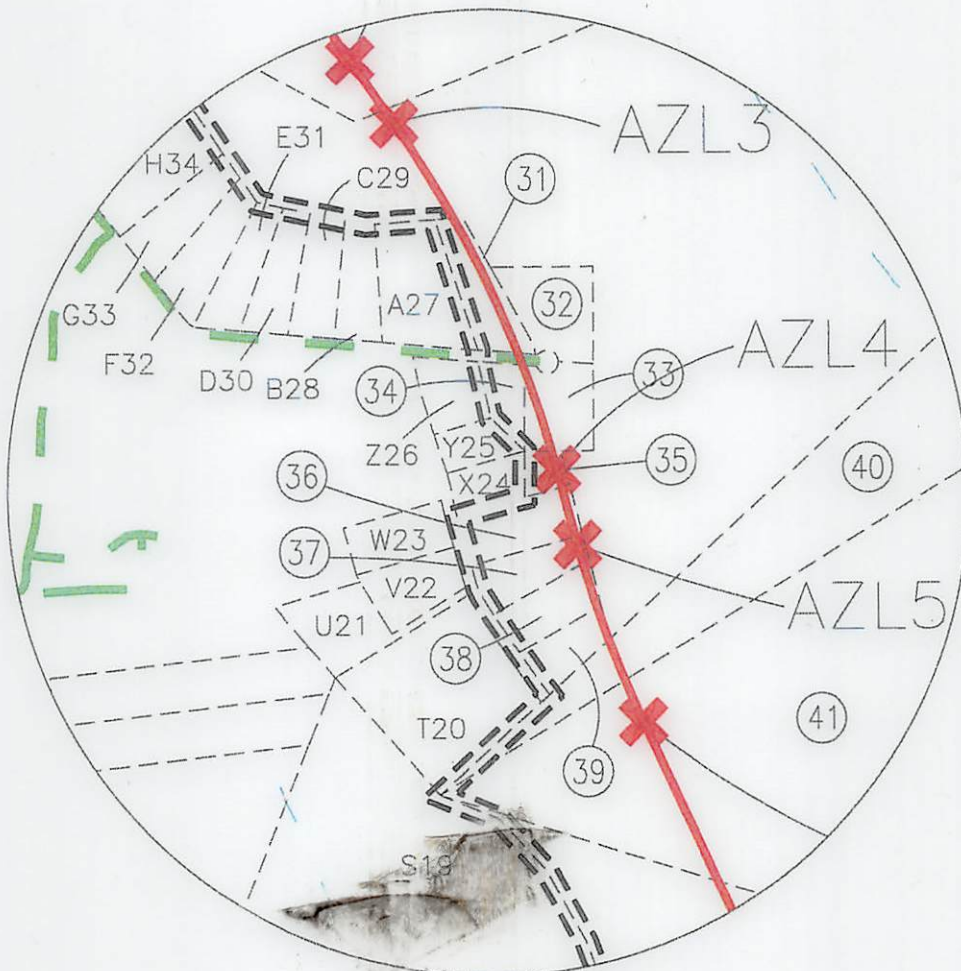

BLOW UP INSET 2  
SCALE: 1"=500'

REVISIONS: 4706900334 H6A	COMPANY:			DATE: 01-26-2022
				DRAWN BY: NBC
	OPERATOR'S	SHANNON FIELDS OHI		SCALE: N/A
	WELL #:	47-069-00334 - M00210H		DRAWING NO: ACE-2326
	DISTRICT:	COUNTY:	STATE:	WELL LOCATION PLAT
	RICHLAND	OHIO	WV	

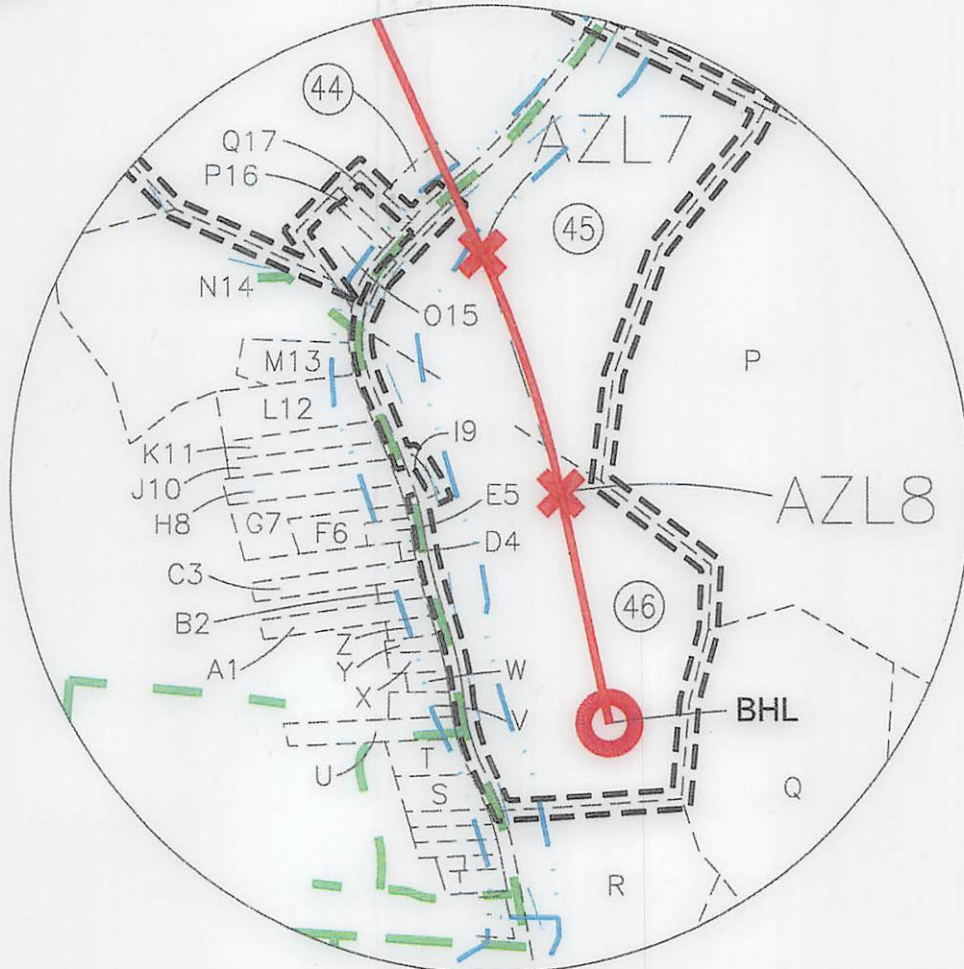

BLOW UP INSET 3  
SCALE: 1"=500'

REVISIONS:

COMPANY:

**SWN**  
Production Company, LLC

**SWN** *R<sup>+</sup>V<sup>+</sup>*  
Production Company™

OPERATOR'S SHANNON FIELDS OHI

WELL #: 47-069-00334 210H -MOD

DISTRICT:  
RICHLAND

COUNTY:  
OHIO

STATE:  
WV

DATE: 01-26-2022

DRAWN BY: NBC  
SCALE: N/A  
DRAWING NO: ACE-2326  
WELL LOCATION PLAT





SURVEYOR/ENGINEER: 1-304-933-3463  
 2361 DAVISSON RUN ROAD, SUITE 103  
 CLARKSBURG, WV 26301

WELL BORE TABLE FOR SURFACE/ROYALTY OWNERS		
TRACT	SURFACE OWNER ( S )/ROYALTY OWNER ( R )	TAX PARCEL
1	SHANNON FIELDS, LLC ( S/R )	4-R17-23.2
TRACT	SURFACE OWNER	TAX PARCEL
2	PARK VIEW MEMORIAL GARDENS, INC.	4-R17-8
3	NADA E. BENEKE, ET AL	4-R17-19
4	CRAIG V. & EMMA L. OLEARY	4-R17-17
5	JERMEY A. SCHREIBER & ELIZABETH PHILBRICK	4-R17-16
6	GUNTHER F. & M E. HEMPELMAN	4-R17-14
7	COLUMBIA GAS TRANSMISSION CORP.	4-R17-15
8	GUNTHER F. & M E. HEMPELMAN	4-R17-13
9	CARL D. III & JOLIN H. BURKLAND	4-R17-13.1
10	CARL D. III & JOLIN H. BURKLAND	4-R17-12
11	HARRY S. & BARBARA J. FISHER	4-R17-11
12	HARRY S. & BARBARA J. FISHER	4-R17-11.1
13	MATTHEW & VICTORIA GOMPERS	4-R17-10.2
14	SHASHI R & MONISHA URVAL	6-T2J-1
15	RICHARD P. & KIM M. CARTER	4-R17-23.1
16	RICHARD P. CARTER	4-R17-23.3
17	DAVID N. GAUDINO & ANN C. HOGE	6-T2J-2
18	ERICA D. & WARREN C. III WILCOX	6-T2-14
19	RODD A. & LISA R. FRANKE	6-T2-15.3
20	RODD A. & LISA R. FRANKE	6-T2-15.4
21	MICHAEL W. WILHELM	6-T2-15
22	CATHOLIC DIOCESE OF WHEELING - CHARLESTON	6-T2-11
23	DONALD G. & BECKY J. VILLANOVA	6-T2-15.2
24	DONALD G. & BECKY J. VILLANOVA	6-T2-16
25	LUANN & ARTHUR W. Jr. DANEHART	6-T2-16.1
26	LUANN & ARTHUR W. Jr. DANEHART	6-T2-16.2
27	WHEELING PARK COMMISSION	6-T7-95
28	BOARD OF EDUCATION	10-W56-1
29	BOARD OF EDUCATION	10-W56-2
30	FRANCES L. BRADEN - IRREVOC TRUST	6-T7-97
31	KENNETH & STEPHANIE SPENCER	6-T7-67.6
32	JONATHAN BRUCE WHARTON	6-T7-97.3
33	KEITH A. & WENDY J. POOLE	6-T7-97.2
34	W. C. & K. D. HAUGHT	6-T7-67.14
35	FRANCES L. BRADEN	6-T7-67
36	THOMAS L. & DONNA LYNNE FOLMAR	6-T7-67.18
37	WILLIAM O. IV & CANDICE M. LEWIS	6-T7-67.19
38	TODD M. & JENNY S. SCHIRTZINGER	6-T7-67.17
39	CHAD W. & REBECCA L. BROADWATER	6-T7-67.16
40	JAMES D. Jr. & CAROLINE K. MILLER	6-T7-117.2
41	JAMES D. Jr. & CAROLINE K. MILLER	6-T7-117.1
42	JAMES D. Jr. & CAROLINE K. MILLER	6-T7-117.3
43	PETERS RUN LAND Co., INC	6-T7-119
44	JOHN BUCHANAN	6-T7-121
45	JAY A. & LISA P. POWELL	6-T7-157
46	JANET NOEL	6-T7-126.3
ADJOINING OWNERS TABLE		
TRACT	SURFACE OWNER	TAX PARCEL
A	EARL P. HUFFNER	4-R17-24.1
B	JAMES R. MULL	4-R17-24
C	ROBERT W. MINCH, Jr. & HERBERT P. MINCH	4-R17-57
D	RUTH CARTER LEWIS, REVOCABLE TRUST	4-R17-23
E	NADA E. BENEKE	4-R17-22
F	THOMAS J. & MICHELLE N. JOHN	4-R17-20
G	CHARLES & DOLORES MONFRADI	4-R17-58
H	TIMMY B. & AMY L. MINCH	6-T2-18
I	WILLIAM A. & CYNTHIA ORUM	6-T7-178
J	DONALD A. & RHONDA L. BRADEN	6-T7-97.1
K	RALPH L. II & MELISSA E. FRITTER	6-T7-111
L	JAMES D., Jr. & CAROLINE K. MILLER	6-T7-112
M	JAMES D., Jr. & CAROLINE K. MILLER	6-T7-117
N	PETERS RUN LAND Co., INC.	6-T7-118
O	DANIEL F. OCH	6-T7-156

ADJOINING OWNERS TABLE		
TRACT	SURFACE OWNER	TAX PARCEL
P	LUCKY FARMS, LLC	6-T12-5
Q	BDDE PROPERTIES, LLC	6-T12-4
R	PAJASA LIMITED LIABILITY Co.	6-T12-2.1
S	OHIO VALLEY REALTY COMPANY	6-T12B-13.1
T	OHIO VALLEY REALTY COMPANY	6-T12B-13
U	JOYCE A. TSORAS	6-T12B-12
V	MARK D. PANEPINTO	6-T12B-11
W	MICHAEL M. & CATHY McCULLLEY	6-T12B-8
X	MARY L. QUIGLEY	6-T12B-7
Y	DENNIS THORN	6-T12B-6
Z	JEFFERY D. GIUSTINIANI & JAMACA S. DOFKA	6-T12B-4
A1	TABATHA WILSON	6-T12B-3
C3	DENNIS R. THORN, ET AL	6-T12B-1
D4	JEFFREY D. & FRANCES M. McKENZIE	6-T12B-1.1
E5	GRETA M. GATES & R. A. FOOSE	6-T7-133
F6	SCOTT R. STEWART & MICHELLE L. NICHOLSON	6-T7-132
G7	HAROLD H. & MARY K. BELL	6-T7-131
H8	CHRISTINA M. MARTIN	6-T7-130
I9	POPCORN PROPERTIES, LLC	6-T7-126.1
J10	ROGER L. KENT, Jr.	6-T7-129.1
K11	ROGER L. KENT, Jr.	6-T7-129
L12	CARL W. & CHRISTINE S. McCARDLE	6-T7-128
M13	CARL W. McCARDLE	6-T7-127
N14	JOSEPHINE L. TAGGART	6-T7-125
O15	CHRISTINE M. POWELL	6-T7-124
P16	JAYME E. TIMBERLAKE	6-T7-123
Q17	JOHN BUCHANAN	6-T7-122
R18	PETERS RUN LAND Co., INC.	6-T7-125.1
S19	JOSEPHINE L. TAGGART	6-T7-125
T20	JAMES D., Jr. & CAROLINE K. MILLER	6-T7-67.1
U21	JOHN P. & MEREDITH L. TRISCHLER	6-T7-75.4
V22	JOHN P. & MEREDITH L. TRISCHLER	6-T7-75.3
W23	JOHN P. & MEREDITH L. TRISCHLER	6-T7-75.2
X24	KEVIN L. & MICHELLE J. HEILMAN	6-T7-67.15
Y25	RYAN P. & MICHELLE M. HUNKER	6-T7-67.20
Z26	SCOTT L. & DEANNA L. NESTOR	6-T7-67.3
A27	GERALD & ROSETTA J. BISCHOF	6-T7-67.7
B28	DEEDRA DAVIS	6-T7-67.5
C29	RONALD A. & PATRICIA L. ZANDRON	6-T7-67.8
D30	DALE A. & CAROL ANN FORESTER	6-T7-67.9
E31	MARIO B. & LOIS R. JULIAN	6-T7-67.13
F32	BENJAMIN & DANIELLE ELLWOOD	6-T7-67.23
G33	CAYLA J. & MATTHEW D. BLACK	6-T7-67.10
H34	FRANCES L. BRADEN, IRREVOC TRUST	10-W56-3
I35	VINCENET J. MAGNONE	6-T7-6
J36	BRIAN M. HINDERLITER	6-T7-6.4
K37	WHEELING PARK COMMISSION	6-T7-1
L38	WHEELING PARK COMMISSION	6-T2-17
M39	STEPHEN T. & MICHELLE L. VOGRIN	6-T2-13
N40	RCK 2 GROUP, LLC	6-T2-13.1
O41	CATHOLIC DIOCESE OF WHEELING - CHARLESTON	6-T6-1
P42	WM & P.M. HESLOP	6-T2-8
Q43	D.A. & M.R. BECKER	6-T2-10
R44	CITY OF WHEELING	6-T2-11.1
S45	MARGUERITE M. CERRA - TOD	6-T2-7
T46	KAREN A. & VARONE K.J. PACHUTA	6-T2-3
U47	ROBERT J. & TAMI L. SEEVERS, WESBANCO TRUST	6-T2-2
V48	ROY ROGER SMITH - TOD	6-T2J-4
W49	JAMES C. & MARY E. WRIGHT	6-T2J-3
X50	ROBERT B. & K.S. NELSON	6-T2J-5
Y51	MICHAEL J. & SUSAN J. BAKER	6-T2J-7
Z52	MICHAEL J. & SUSAN J. BAKER	4-R17-10
A53	ATTILA A. LENKEY	4-R17-10.1
B54	WHEELING PARK COMMISSION	6-T1-2
C55	WHEELING PARK COMMISSION	4-R17-6.1
D56	GACS LP	10-W27A-1
E57	CITY OF WHEELING	4-R14-15
F58	SAM HINEBAUGH	4-R17-8.1
G59	KENDRA L. TAYLOR	4-R17-59.1
H60	DONALD R. & M.M. EDDY	4-R17-59.2

REVISIONS:

COMPANY:

**SWN**  
 Production Company, LLC

**SWN** <sup>REVISED</sup>  
 Production Company™

OPERATOR'S SHANNON FIELDS OHI

WELL #: 47-069-00334 210H - MOD

DISTRICT:  
 RICHLAND

COUNTY:  
 OHIO

STATE:  
 WV

DATE: 01-26-2022

DRAWN BY: NBG

SCALE: N/A

DRAWING NO: ACE-2326

WELL LOCATION PLAT