



west virginia department of environmental protection

Office of Oil and Gas
601 57th Street, S.E.
Charleston, WV 25304
(304) 926-0450
fax: (304) 926-0452

Harold D. Ward, Cabinet Secretary
www.dep.wv.gov

Monday, March 28, 2022
PERMIT MODIFICATION APPROVAL
Horizontal 6A / New Drill

SWN PRODUCTION COMPANY, LLC
POST OFFICE BOX 12359
SPRING, TX 773914954

Re: Permit Modification Approval for SHANNON FIELD OHI 210
47-069-00334-00-00

Lateral Extension

SWN PRODUCTION COMPANY, LLC

The Office of Oil and Gas has reviewed the attached permit modification for the above referenced permit. The attached modification has been approved and well work may begin. Please be reminded that the oil and gas inspector is to be notified twenty-four (24) hours before permitted well work is commenced.

If there are any questions, please feel free to contact me at (304) 926- 0450.

A handwritten signature in blue ink, appearing to read 'James A. Martin', is positioned above the printed name and title.

James A. Martin
Chief

Operator's Well Number: SHANNON FIELD OHI 210
Farm Name: SHANNON FIELDS, LLC
U.S. WELL NUMBER: 47-069-00334-00-00
Horizontal 6A New Drill
Date Modification Issued: 03/28/2022

Promoting a healthy environment.

STATE OF WEST VIRGINIA
DEPARTMENT OF ENVIRONMENTAL PROTECTION, OFFICE OF OIL AND GAS
WELL WORK PERMIT APPLICATION

- 1) Well Operator: SWN Production Co., LLC 494512924 069-Ohio 005-Rich 674-Wheeling
Operator ID County District Quadrangle
- 2) Operator's Well Number: Shannon Fields OHI 210H Well Pad Name: Shannon Fields OHI
- 3) Farm Name/Surface Owner: Shannon Fields, LLC Public Road Access: Boggs Hill Road (Country Route 15/1)
- 4) Elevation, current ground: 1232' Elevation, proposed post-construction: _____
- 5) Well Type (a) Gas _____ Oil _____ Underground Storage _____
Other _____
(b) If Gas Shallow _____ Deep _____
Horizontal _____
- 6) Existing Pad: Yes or No No Gayne Knitowski Digitally signed by Gayne Knitowski
Date: 2022.03.01 08:22:08 -0500
- 7) Proposed Target Formation(s), Depth(s), Anticipated Thickness and Expected Pressure(s):
Target Formation- Marcellus, Target Top TVD- 6219', Target Base TVD- 6278', Anticipated Thickness- 59', Associated Pressure- 4081
- 8) Proposed Total Vertical Depth: 6256'
- 9) Formation at Total Vertical Depth: Marcellus
- 10) Proposed Total Measured Depth: 20927'
- 11) Proposed Horizontal Leg Length: 14,133.69
- 12) Approximate Fresh Water Strata Depths: 351'
- 13) Method to Determine Fresh Water Depths: Deepest Nearby Water Well & Salinity Calculations from Timmy Minch OHI Pad
- 14) Approximate Saltwater Depths: 601' Salinity Profile
- 15) Approximate Coal Seam Depths: 503'
- 16) Approximate Depth to Possible Void (coal mine, karst, other): None that we are aware of.
- 17) Does Proposed well location contain coal seams directly overlying or adjacent to an active mine? Yes _____ No
- (a) If Yes, provide Mine Info: Name: _____
Depth: _____
Seam: _____
Owner: _____

RECEIVED
Office of Oil & Gas
MAR 24 2022
WV Department of
Environmental Protection

4706900334

WW-6B
(04/15)

API NO. 47-009
OPERATOR WELL NO. Shannon Fields OH# 2104
Well Pad Name: Shannon Fields OH#

18)

CASING AND TUBING PROGRAM

TYPE	Size (in)	New or Used	Grade	Weight per ft. (lb/ft)	FOOTAGE: For Drilling (ft)	INTERVALS: Left in Well (ft)	CEMENT: Fill-up (Cu. Ft./CTS)
Conductor	20"	New	J-55	94#	126'	126'	CTS
Fresh Water	13 3/8"	New	H-40	48#	555'	555'	534 sx/CTS
Coal	See	Intern	Casing				
Intermediate	9 5/8"	New	J-55	36#	1930'	1930'	848 sx/CTS
Production	5 1/2"	New	HCP-110	20#	20927'	20927'	1st 2785cu/ 100' inside Intermediate
Tubing							
Liners							

Digitally signed by Gayne Knitowski
Date: 2022.03.01 08:22:30 -0500

TYPE	Size (in)	Wellbore Diameter (in)	Wall Thickness (in)	Burst Pressure (psi)	Anticipated Max. Internal Pressure (psi)	Cement Type	Cement Yield (cu. ft./k)
Conductor	20"	30"	0.25	2120	81	Class A	1.20/30% Excess
Fresh Water	13 3/8"	17.5"	0.380	2730	633	Class A	1.20/30% Excess
Coal							
Intermediate	9 5/8"	12 1/4"	0.395	3950	1768	Class A	1.19/40% Excess
Production	5 1/2"	8 3/4"-8 1/2"	0.361	14360	10500	Class A	1.19/5% Excess
Tubing							
Liners							

PACKERS

Kind:				
Sizes:				
Depths Set:				

Page 2 of 3

RECEIVED
Office of Oil & Gas

MAR 24 2022

WV Department of
Environmental Protection

WW-6B
(10/14)

API NO. 47-
OPERATOR WELL NO. Shannon Fields OH# 210H
Well Pad Name: Shannon Fields OH#

19) Describe proposed well work, including the drilling and plugging back of any pilot hole:

The well will be drilled to a depth approximately 100' below the top of the Onondaga Formation to allow for open hole logging and confirming Marcellus interval formation characteristics. If casing is run, it will be run to total depth of the hole and cemented per regulatory requirements. If the well is determined to be dry and abandoned, it will be plugged per regulatory requirements for plugging and abandoning.

If drilling encounters a void, drill 25' to 75' below depth of bottom of void. Run casing minimum of 20'/maximum of 75' below base of coal void. Place cement baskets above top of void and below base of void. Mix and pump balance plug to bottom of coal void interval and grout from cement basket to surface or run external casing packer/cementing stage tool above coal void and perform 2 stage cement operation dependent upon depth of coal void. (If freshwater is encountered deeper than anticipated, it must be protected. Set casing 50' below and cts.)

20) Describe fracturing/stimulating methods in detail, including anticipated max pressure and max rate:

Well will be perforated within the target formation and stimulated with a slurry of water, sand, and chemical additives at a high rate. This will be performed in stages with the plug and perf method along the wellbore until the entire lateral has been stimulated within the target formation. All stage plugs are then drilled out and the well is flowed back to surface. In some instances, additional toe prep may be performed by pumping additional water in the toe of the well prior to perforating and pumping Stage 1 to ensure that the toe guns/toe sleeves are fully open prior to pumping stage 1. The well is produced through surface facilities consisting of high pressure production units, horizontal separation units, water and oil storage tanks. Max press and anticipated max rate- 9000 lbs @ 100 barrels a minute.

21) Total Area to be disturbed, including roads, stockpile area, pits, etc., (acres): 20.94

22) Area to be disturbed for well pad only, less access road (acres): 17

23) Describe centralizer placement for each casing string:

All casing strings will be ran with a centralizer at a minimum of 1 per every 3 joints of casing.

RECEIVED
Office of Oil & Gas

2022

24) Describe all cement additives associated with each cement type:

See Attachment ***

WV Department of
Environmental Protection

25) Proposed borehole conditioning procedures:

All boreholes will be conditioned with circulation and rotation for a minimum of one bottoms up and continuing until operator is satisfied with borehole conditions.

RECEIVED
Office of Oil & Gas

MAR 24 2022

*Note: Attach additional sheets as needed.

WV Department of
Environmental Protection

Southwestern Energy Company		Proposed Drilling Program	
Well:	SHANNON FIELDS OHI 210	Re-entry Rig:	SDC 41
Field:	PANHANDLE FIELD WET	Prospect:	Marcellus Shale
County:	OHIO	State:	WV
SHL:	40.0884 Latitude -80.6578 Longitude		
BHL:	40.0513 Latitude -80.6422 Longitude		
KB Elev:	1,258 ft MSL	KB:	26 ft AGL
		GL Elev:	1,232 ft MSL

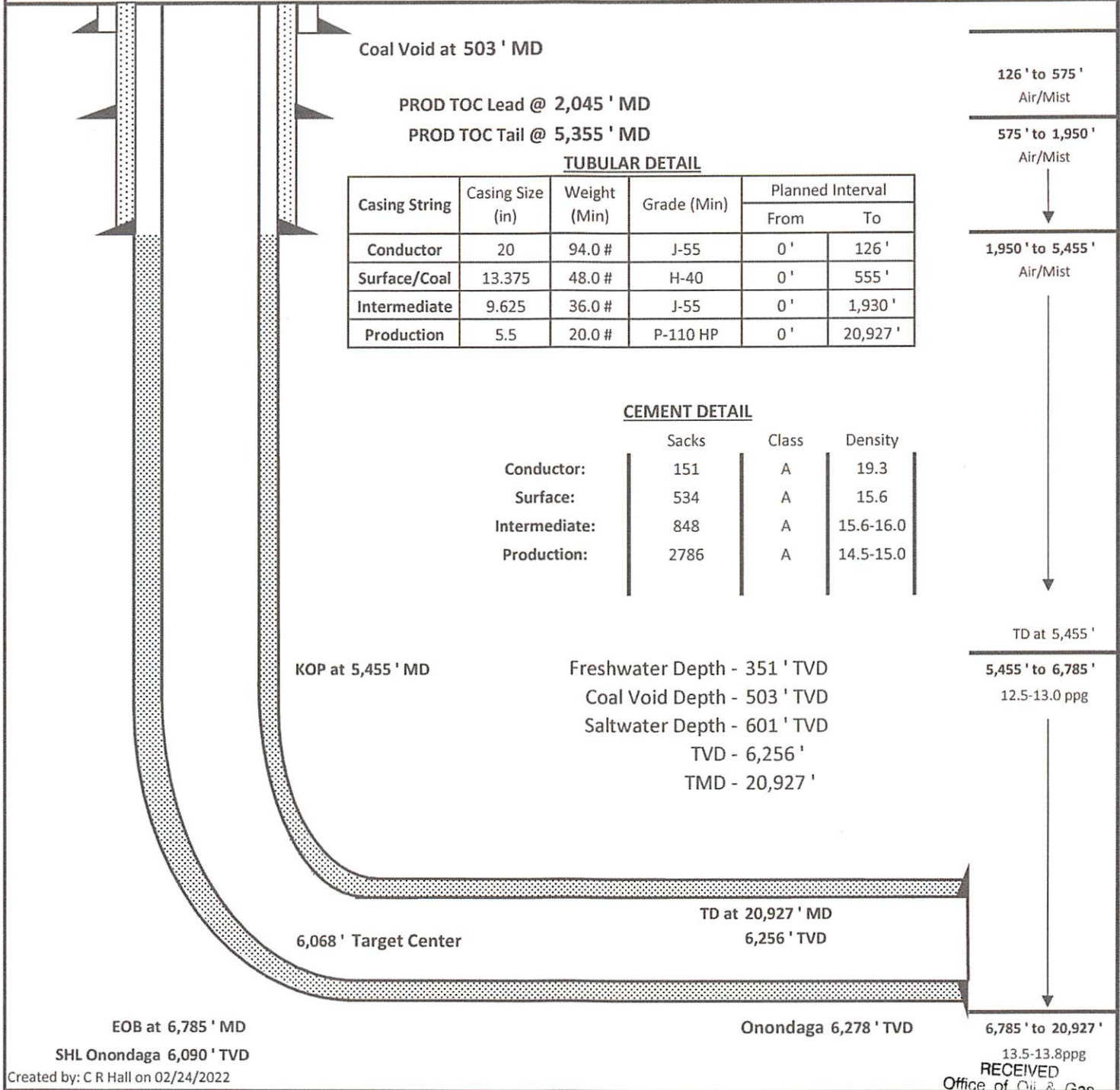

TUBULAR DETAIL

Casing String	Casing Size (in)	Weight (Min)	Grade (Min)	Planned Interval	
				From	To
Conductor	20	94.0 #	J-55	0'	126'
Surface/Coal	13.375	48.0 #	H-40	0'	555'
Intermediate	9.625	36.0 #	J-55	0'	1,930'
Production	5.5	20.0 #	P-110 HP	0'	20,927'

CEMENT DETAIL

	Sacks	Class	Density
Conductor:	151	A	19.3
Surface:	534	A	15.6
Intermediate:	848	A	15.6-16.0
Production:	2786	A	14.5-15.0

Freshwater Depth - 351' TVD
 Coal Void Depth - 503' TVD
 Saltwater Depth - 601' TVD
 TVD - 6,256'
 TMD - 20,927'

RECEIVED
 Office of Oil & Gas

Created by: C R Hall on 02/24/2022

Digitally signed
 by Gayne Knitowski
 Date: 2022.03.01 08:22:49 -05'00'

MAR 24 2022
 WV Department of Environmental Protection

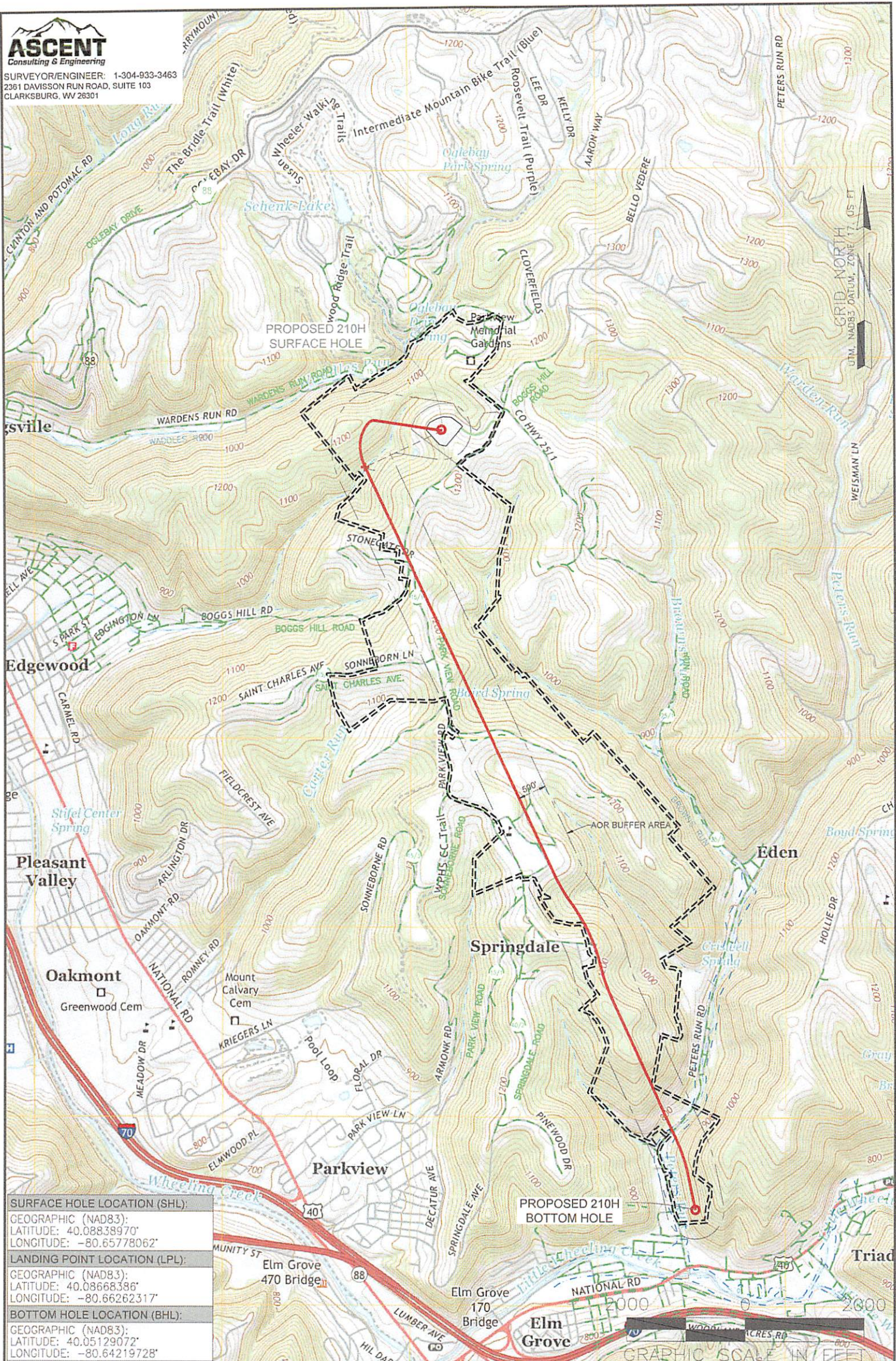

SURFACE HOLE LOCATION (SHL):
GEOGRAPHIC (NAD83):
LATITUDE: 40.08838970°
LONGITUDE: -80.65778062°
LANDING POINT LOCATION (LPL):
GEOGRAPHIC (NAD83):
LATITUDE: 40.08668386°
LONGITUDE: -80.66262317°
BOTTOM HOLE LOCATION (BHL):
GEOGRAPHIC (NAD83):
LATITUDE: 40.05129072°
LONGITUDE: -80.64219728°

NOTES ON SURVEY

1. SURFACE AND ROYALTY OWNER INFORMATION AND THEIR BOUNDARIES SHOWN HEREON WERE PLOTTED FROM DEEDS AND/OR TAX PARCEL MAPS PROVIDED BY CLIENT AND/OR FIELD LOCATIONS.
2. THIS PLAT DOES NOT REPRESENT A BOUNDARY SURVEY OF THE PARCELS SHOWN HEREON.
- 3.
4. ALL INSETS ARE GRID NORTH UNLESS OTHERWISE DEPICTED.

LEGEND:	PROPOSED SURFACE HOLE / BOTTOM HOLE	ACCESS ROAD
EXISTING / PRODUCING WELLHEAD	PUBLIC ROAD	ACCESS ROAD TO PREV. SITE
LPL	LEASE BOUNDARY	PROPOSED PATH
FLOOD PLAIN		

WELL OPERATOR: SWN PRODUCTION COMPANY, LLC	WELL (FARM) NAME: SHANNON FIELDS OHI	WELL # 210H	SERIAL # XXXX
ADDRESS: 1300 FORT PIERPONT DRIVE, SUITE 201	COUNTY - CODE OHIO - 35	DISTRICT; RICHLAND	
SURFACE OWNER: SHANNON FIELDS, LLC	USGS 7 1/2 QUADRANGLE MAP NAME WHEELING, WV		



4706900334

SWN Production Company, LLC
1300 Fort Pierpont Dr, Ste 201
Morgantown, WV 26508
Tel: 304 884 1610
Fax: 304 471 2497
www.swn.com

February 24, 2022

Mr. Charles Brewer
WV DEP Office of Oil & Gas
601 57th St., SE
Charleston, WV 25304

RE: SWN's proposed New Well: Shannon Fields OHI 210H in Ohio County, West Virginia, Drilling under Boggs Hill Road, Park View Road, and Peters Run Road.

Dear Mr. Brewer:

SWN Production Company, LLC ("SWN") is applying for a drilling permit for the above referenced well. The State of West Virginia has raised some concern as to SWN's right to drill under Boggs Hill Road, Park View Road, and Peters Run Road. Please be advised that SWN has leased all mineral owners under said route as it relates to the above-referenced well and unit.

Thank you.

Respectfully,

SWN Production Company, LLC

Gavin Nadeau, RPL
Landman

RECEIVED
Office of Oil & Gas
MAR 24 2022
WV Department of
Environmental Protection



The Right People doing the Right Things,
wisely investing the cash flow from our
underlying Assets, will create Value+®

WW-6A1
(5/13)

Operator's Well No. SHANNON FIELDS OHI 210H

**INFORMATION SUPPLIED UNDER WEST VIRGINIA CODE
Chapter 22, Article 6A, Section 5(a)(5)
IN LIEU OF FILING LEASE(S) AND OTHER CONTINUING CONTRACT(S)**

Under the oath required to make the verification on page 1 of this Notice and Application, I depose and say that I am the person who signed the Notice and Application for the Applicant, and that –

- (1) the tract of land is the same tract described in this Application, partly or wholly depicted in the accompanying plat, and described in the Construction and Reclamation Plan;
- (2) the parties and recordation data (if recorded) for lease(s) or other continuing contract(s) by which the Applicant claims the right to extract, produce or market the oil or gas are as follows:

Lease Name or Number	Grantor, Lessor, etc.	Grantee, Lessee, etc.	Royalty	Book/Page
----------------------	-----------------------	-----------------------	---------	-----------

See Exhibit A

**Acknowledgement of Possible Permitting/Approval
In Addition to the Office of Oil and Gas**

The permit applicant for the proposed well work addressed in this application hereby acknowledges the possibility of the need for permits and/or approvals from local, state, or federal entities in addition to the DEP, Office of Oil and Gas, including but not limited to the following:

- WV Division of Water and Waste Management
- WV Division of Natural Resources WV Division of Highways
- U.S. Army Corps of Engineers
- U.S. Fish and Wildlife Service
- County Floodplain Coordinator

RECEIVED
Office of Oil & Gas
MAR 24 2022
WV Department of
Environmental Protection

The applicant further acknowledges that any Office of Oil and Gas permit in no way overrides, replaces, or nullifies the need for other permits/approvals that may be necessary and further affirms that all needed permits/approvals should be acquired from the appropriate authority before the affected activity is initiated.

Well Operator: SWN Production Co., LLC 
 By: Gavin Nadeau, RPL
 Its: Landman

EXHIBIT "A"
Shannon Fields OHI 210H
Ohio County, West Virginia

Attached to and made a part of the State of West Virginia Oil and Gas Permit Form, WW-6A1, by SWN Production Company, LLC, Operator

#	TMP	LESSOR	LESSEE	ROYALTY	RR/PG
✓	04-0R17-0023-0002	Mary Carter Topp, married, dealing in her sole and separate property	Chesapeake Appalachia, L.L.C.	17.00%	808-412; 805-270
Note: Shannon Field, LLC (current Mineral Owner) obtained mineral interest by deed dated March 12, 2013 recorded at Book 854 and Page 769 in the Office of Recordors of Ohio County, West Virginia. Mineral Owner is subject to the original Chesapeake Appalachia, L.L.C. lease executed by Mary Carter Topp recorded in the Office of Recordors of Ohio County, West Virginia at Book 805 and Page 270, in which SWN Production Company, LLC operates thereunder by assignment recorded at Book 883 and Page 415.					
✓	04-0R17-0008-0000	Cornerstone Family Services of West Virginia LLC	SWN Production Company, LLC		883-415
			Chesapeake Appalachia, L.L.C.	18.00%	814-586
			SWN Production Company, LLC		884-121
	04-0R17-0019-0000	Lisa Beneke Burris, married	Chesapeake Appalachia, L.L.C.	18.00%	811-501
			SWN Production Company, LLC		884-157
		Nada E. Beneke, single	Chesapeake Appalachia, L.L.C.	18.00%	811-496
			SWN Production Company, LLC		884-157
		George Robert Beneke, single	Chesapeake Appalachia, L.L.C.	18.00%	811-407
			SWN Production Company, LLC		884-157
4)	04-0R17-0017-0000	Craig V. O'Leary and Emma L. O'Leary, husband and wife	SWN Production Company, LLC	16.00%	923-334
5)	04-0R17-0016-0000	Jeremy A. Schreiber and Elizabeth Philbrick, husband and wife	SWN Production Company, LLC	18.00%	930-427
6)	04-0R17-0014-0000	Gunther F. Hempelman and Margaret Eileen Hempelman, husband and wife	Chesapeake Appalachia, L.L.C.	18.00%	809-472
			SWN Production Company, LLC		884-97
7)	04-0R17-0015-0000	Columba Gas Transmission, LLC	SWN Production Company, LLC	16.00%	926-573
8)	04-0R17-0013-0000	Margaret F. Hempelman, a widow	SWN Production Company, LLC	15.00%	926-519
9)	04-0R17-0013-0001	Carl D. Burkland, III and John H. Burkland, husband and wife	SWN Production Company, LLC	16.00%	941-129
10)	04-0R17-0012-0000	Carl D. Burkland, III and John H. Burkland, husband and wife	SWN Production Company, LLC	16.00%	941-129
11)	04-0R17-0011-0000	Harry S. Fisher and Barbara J. Fisher, Husband and Wife	American Petroleum Partners Operating, LLC	18.00%	936-90
			SWN Production Company, LLC		980-572
12)	04-0R17-0011-0001	Harry S. Fisher and Barbara J. Fisher, Husband and Wife	American Petroleum Partners Operating, LLC	18.00%	936-90
			SWN Production Company, LLC		980-572
13)	04-0R17-0010-0002	Matthew W. Gompers and Victoria A. Gompers, husband and wife	American Petroleum Partners Operating, LLC	18.00%	936-153
			SWN Production Company, LLC		980-572
14)	06-0T23-0001-0000	Shashi R. Urval and Menisha Urval, husband and wife	SWN Production Company, LLC	16.00%	932-274
15)	04-0R17-0023-0001	Richard P. Carter and Kim M. Carter, husband and wife	SWN Production Company, LLC	15.00%	954-554
16)	04-0R17-0023-0003	Harlan P. Carter, III	Chesapeake Appalachia, L.L.C.	18.00%	836-109
			SWN Production Company, LLC		884-777
17)	06-0T23-0002-0000	David N. Gaudino and Ann C. Gaudino (k/a Ann C. Hoge), husband and wife	Chesapeake Appalachia, L.L.C.	18.00%	840-614
			SWN Production Company, LLC		885-380
18)	06-0012-0014-0000	Gloria Kalb a/k/a Gloria J. Kalb, a widow	SWN Production Company, LLC	18.00%	935-468
19)	06-0012-0015-0003	Gloria Kalb a/k/a Gloria J. Kalb, a widow	SWN Production Company, LLC	18.00%	935-468
20)	06-0012-0015-0004	Gloria Kalb a/k/a Gloria J. Kalb, a widow	SWN Production Company, LLC	18.00%	935-468
21)	06-0012-0015-0000	William D. Wilhelm, a widower, by and through his Attorney-in-Fact, Michael Wilhelm	Chesapeake Appalachia, L.L.C.	14.00%	866-791
			SWN Production Company, LLC		884-397
22)	06-0012-0011-0000	Roman Catholic Diocese of Wheeling-Charleston, by Michael J. Bramfield, Bishop	SWN Production Company, LLC	18.00%	927-667
23)	06-0012-0015-0002	Donald G. Villanova and Becky J. Villanova, husband and wife	SWN Production Company, LLC	18.00%	936-344
24)	06-0012-0016-0000	Donald G. Villanova and Becky J. Villanova, husband and wife	SWN Production Company, LLC	18.00%	936-344
25)	06-0012-0016-0001	Luzann Danehart and Arthur W. Danehart, Jr., wife and husband	American Petroleum Partners Operating, LLC	18.00%	936-689
			SWN Production Company, LLC		973-167
26)	06-0012-0016-0002	Luzann Danehart and Arthur W. Danehart, Jr., wife and husband	American Petroleum Partners Operating, LLC	18.00%	936-689
			SWN Production Company, LLC		973-167
27)	06-0012-0013-0000	Robert G. Baird, Martha Jane Cage, Ronald Morris Baird, Pamela S. Keys, Jacquelyn Ann Jacobs, and Margery Ellen Kriner	Chesapeake Appalachia, L.L.C.	18.00%	820-268
			SWN Production Company, LLC		885-105
28)	06-0012-0013-0000	Robert G. Baird, Martha Jane Cage, Ronald Morris Baird, Pamela S. Keys, Jacquelyn Ann Jacobs, and Margery Ellen Kriner	Chesapeake Appalachia, L.L.C.	18.00%	820-268
			SWN Production Company, LLC		885-105
29)	06-0012-0013-0000	Ohio County Board of Education	American Petroleum Partners Operating, LLC	18.00%	936-172
			SWN Production Company, LLC		973-167
30)	06-0017-0097-0000	Frances L. Braden, widow	Great Lakes Energy Partners, L.L.C.	14.00%	779-684
			Chesapeake Appalachia, L.L.C.		808-514
			SWN Production Company, LLC		883-192
31)	06-0017-0067-0006	Kenneth L. Spencer and Stephanie A. Spencer, husband and wife	Chesapeake Appalachia, L.L.C.	14.00%	841-775
			SWN Production Company, LLC		885-380
32)	06-0017-0097-0003	Frances L. Braden, widow	Great Lakes Energy Partners, L.L.C.	14.00%	779-684
			Chesapeake Appalachia, L.L.C.		808-514
			SWN Production Company, LLC		883-192
33)	06-0017-0097-0002	Frances L. Braden, widow	Great Lakes Energy Partners, L.L.C.	14.00%	779-684
			Chesapeake Appalachia, L.L.C.		808-514
			SWN Production Company, LLC		883-192
34)	06-0017-0067-0014	Mark C. Busack, single	Chesapeake Appalachia, L.L.C.	14.00%	841-238
			SWN Production Company, LLC		885-380
35)	06-0017-0067-0000	Frances L. Braden, Trustee of the Frances L. Braden 2016 Irrevocable Trust, dated August 10, 2016	SWN Production Company, LLC	18.00%	1009-358
36)	06-0017-0067-0018	The Frances L. Braden 2016 Irrevocable Trust dated August 10, 2016, by Frances L. Braden, Trustee	SWN Production Company, LLC	15.00%	967-395
37)	06-0017-0067-0019	The Frances L. Braden 2016 Irrevocable Trust dated August 10, 2016, by Frances L. Braden, Trustee	SWN Production Company, LLC	15.00%	967-395
38)	06-0017-0067-0017	The Frances L. Braden 2016 Irrevocable Trust dated August 10, 2016, by Frances L. Braden, Trustee	SWN Production Company, LLC	15.00%	967-395
39)	06-0017-0067-0016	The Frances L. Braden 2016 Irrevocable Trust dated August 10, 2016, by Frances L. Braden, Trustee	SWN Production Company, LLC	15.00%	967-395
40)	06-0017-0117-0002	J. D. Miller and Nancy K. Miller, husband and wife	TriEnergy, Inc.	14.00%	788-682
			Chesapeake Appalachia, L.L.C.		798-653
			SWN Production Company, LLC		883-255
41)	06-0017-0117-0001	J. D. Miller and Nancy K. Miller, husband and wife	TriEnergy, Inc.	14.00%	788-682
			Chesapeake Appalachia, L.L.C.		798-653
			SWN Production Company, LLC		883-255
42)	06-0017-0117-0003	J. D. Miller and Nancy K. Miller, husband and wife	TriEnergy, Inc.	14.00%	788-682
			Chesapeake Appalachia, L.L.C.		798-653
			SWN Production Company, LLC		883-255
43)	06-0017-0119-0000	Peters Run Land Company, LLC	Fossil Creek Ohio, LLC	18.00%	873-543
			Gulfport Energy Corporation		803-392
			American Petroleum Partners Operating, LLC		909-775
			SWN Production Company, LLC		946-406
44)	06-0017-0121-0000	John Buchanan, a single man	SWN Production Company, LLC	17.00%	993-771
45)	06-0017-0157-0000	Jay A. Powell and Lisa P. Powell, husband and wife	SWN Production Company, LLC	18.00%	922-488
46)	06-0017-0126-0003	Janet Noel, a single woman	SWN Production Company, LLC	16.00%	1060-83

END OF EXHIBIT "A"

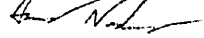
RECEIVED
Office of Oil & Gas
MAR 24 2022
WV Department of
Environmental Protection



SURVEYOR/ENGINEER: 1-304-933-3463
2361 DAVISSON RUN ROAD, SUITE 103
CLARKSBURG, WV 26301

SURFACE HOLE LOCATION (SHL):
UTM (NAD83, ZONE 17, METERS):
NORTHING: 4,437,623.793
EASTING: 529,174.074

LANDING POINT (LPL):
UTM (NAD83, ZONE 17, METERS):
NORTHING: 4,437,432.881
EASTING: 528,761.965

BOTTOM HOLE LOCATION (BHL):
UTM (NAD83, ZONE 17, METERS):
NORTHING: 4,433,511.331
EASTING: 530,519.104

LINE	BEARING	DISTANCE	DESCRIPTION	MONUMENT
L1	N 76°16'44" W	761.72'	SHL TO LANDMARK	STONE FOUND
L2	N 26°40'08" E	959.81'	SHL TO LANDMARK	CONCRETE MONUMENT

GRID NORTH
UTM, NAD83 DATUM, ZONE 17, US FT

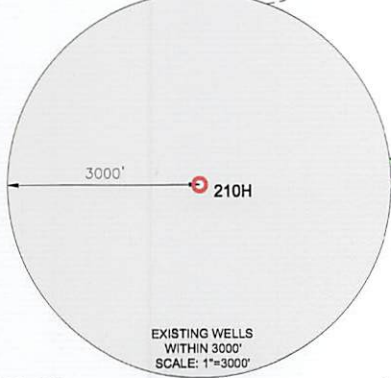
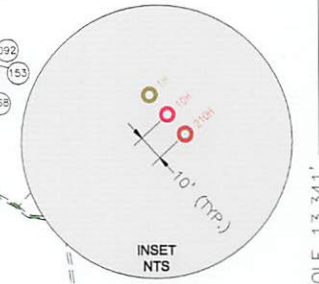
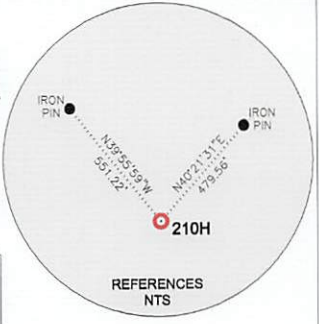

WELL RESTRICTIONS

1. NO OCCUPIED DWELLINGS > 2500 SQ FT WITHIN 625 FEET OF CENTER OF PAD.
2. NO AGRICULTURE BUILDINGS > 2500 SQ FT WITHIN 625 FEET OF CENTER OF PAD.
3. NO WATER WELLS OR DEVELOPED SPRINGS ARE WITHIN 250 FEET OF PROPOSED WELL.
4. PERENNIAL STREAMS, LAKES, PONDS, OR RESERVOIRS WITHIN 100 FEET OF THE LIMITS OF DISTURBANCE.
5. NO NATURALLY PRODUCING TROUT STREAM WITHIN 300 FEET OF LIMITS OF DISTURBANCE.
6. NO GROUND INTAKE OR PUBLIC WATER SUPPLY WITHIN 1000 FEET OF WELL PAD, LIMITS OF DISTURBANCE, E & S CONTROLS OR PUBLIC WATER SUPPLY.

LINE	BEARING	DISTANCE	CURVE LENGTH	DESCRIPTION
L3	S 65°08'38" W	1,490.09'	2,196.98'	SHL TO LPL
L4	S 29°59'53" E	499.27'	499.91'	AZL1 TO AZL2
L5	S 34°59'55" E	199.91'	199.91'	AZL2 TO AZL3
L6	S 25°05'35" E	986.25'	990.66'	AZL3 TO AZL4
L7	S 15°11'00" E	200.26'	200.26'	AZL4 TO AZL5
L8	S 20°03'20" E	488.67'	469.27'	AZL5 TO AZL6
L9	S 24°55'41" E	2,698.71'	2,698.71'	AZL6 TO AZL7
L10	S 18°24'51" E	649.64'	650.50'	AZL7 TO AZL8
L11	S 11°53'59" E	607.67'	607.67'	AZL8 TO BHL

NOTES ON SURVEY

1. TIES TO WELLS AND CORNERS ARE BASED ON STATE PLANE WV NORTH ZONE NAD '83.
2. WELL LAT./LONG ESTABLISHED BY DIRECT GPS NAD '83.
3. BOUNDARIES SHOWN ARE TAKEN FROM TAX MAPS, DEEDS, AND FIELD SURVEY. THIS DRAWING IS NOT REPRESENTATIVE OF A FULL BOUNDARY SURVEY.
4. SURFACE OWNER INFORMATION TAKEN FROM THE ASSESSOR AND COUNTY CLERK RECORDS OF OHIO COUNTY IN OCTOBER OF 2021.
5. WELLS SHOWN ARE TAKEN FROM RECORDS OF WVDEP.

I, THE UNDERSIGNED, HEREBY CERTIFY THAT THIS PLAT IS CORRECT TO THE BEST OF MY KNOWLEDGE AND BELIEF AND SHOWS ALL THE INFORMATION REQUIRED BY LAW AND REGULATIONS ISSUED AND PRESCRIBED BY THE DEPARTMENT OF ENVIRONMENTAL PROTECTION.

P.S. 983

Michael R. Hyman 3/7/22



COMPANY: **SWN** Production Company, LLC **SWN** Production Company™

(+) DENOTES LOCATION OF WELL ON UNITED STATES TOPOGRAPHIC MAPS
WVDEP
OFFICE OF OIL & GAS
601 57TH STREET
CHARLESTON, WV 25034

MINIMUM DEGREE OF ACCURACY: 1/200
PROVEN SURVEY SOURCE OF ELEVATION: SURVEY GRADE GPS (NAVD 88, US FT)

SHANNON FIELDS OHI
OPERATOR'S WELL #: 210H
API WELL #: 47 69 00334 H6A
STATE COUNTY PERMIT

WELL TYPE: OIL WASTE DISPOSAL PRODUCTION DEEP GAS LIQUID INJECTION STORAGE SHALLOW
WATERSHED: UPPER OHIO SOUTH ELEVATION: 1232.0'
DISTRICT: RICHLAND COUNTY: OHIO QUADRANGLE: WHEELING 7.5', WV
SURFACE OWNER: SHANNON FIELDS, LLC ACREAGE: ±35.07
OIL & GAS ROYALTY OWNER: SHANNON FIELDS, LLC ACREAGE: ±35.07
DRILL DRILL DEEPER REDRILL FRACTURE OR STIMULATE PLUG OFF OLD FORMATION PERFORATE NEW FORMATION
CONVERT PLUG & ABANDON CLEAN OUT & REPLUG OTHER CHANGE (SPECIFY)
TARGET FORMATION: MARCELLUS ESTIMATED DEPTH: 6,256 TVD 20,927 TMD

WELL OPERATOR: SWN PRODUCTION COMPANY, LLC DESIGNATED AGENT: BRITANY WOODY
ADDRESS: 1300 FORT PIERPONT DRIVE, SUITE 201 ADDRESS: 1300 FORT PIERPONT DRIVE, SUITE 201
CITY: MORGANTOWN STATE: WV ZIP CODE: 26508 CITY: MORGANTOWN STATE: WV ZIP CODE: 26508

LEGEND:
 PROPOSED SURFACE HOLE / BOTTOM HOLE
 EXISTING / PRODUCING WELLHEAD
 LPL: LANDING POINT LOCATION
 EXISTING WATER WELL
 EXISTING SPRING
 SURVEYED BOUNDARY
 DRILLING UNIT
 LEASE BOUNDARY
 PROPOSED PATH

REVISIONS:
DATE: 01-26-2022
DRAWN BY: NBG
SCALE: 1" = 2000'
DRAWING NO: ACE-2326
WELL LOCATION PLAT

SURFACE HOLE 13,341' | LONGITUDE: 80°37'30" | BOTTOM HOLE 26,856'



SURVEYOR/ENGINEER: 1-304-933-3463
 2361 DAVISSON RUN ROAD, SUITE 103
 CLARKSBURG, WV 26301

SURFACE HOLE LOCATION (SHL):
 UTM (NAD83, ZONE 17, METERS):
 NORTHING: 4,437,623.793
 EASTING: 529,174.074

LANDING POINT (LPL):
 UTM (NAD83, ZONE 17, METERS):
 NORTHING: 4,437,432.881
 EASTING: 528,761.965

BOTTOM HOLE LOCATION (BHL):
 UTM (NAD83, ZONE 17, METERS):
 NORTHING: 4,433,511.331
 EASTING: 530,519.104

LATITUDE: 40°07'30" SURFACE HOLE 9,171'

LINE	BEARING	DISTANCE	DESCRIPTION	MONUMENT
L1	N 76°16'44" W	761.72'	SHL TO LANDMARK	STONE FOUND
L2	N 26°40'08" E	959.81'	SHL TO LANDMARK	CONCRETE MONUMENT

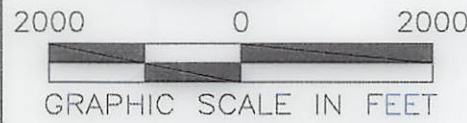
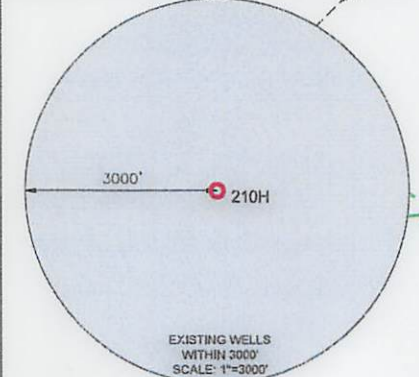

WELL RESTRICTIONS

1. NO OCCUPIED DWELLINGS > 2500 SQ FT. WITHIN 625 FEET OF CENTER OF PAD.
2. NO AGRICULTURE BUILDINGS > 2500 SQ FT. WITHIN 625 FEET OF CENTER OF PAD.
3. NO WATER WELLS OR DEVELOPED SPRINGS ARE WITHIN 250 FEET OF PROPOSED WELL.
4. PERENNIAL STREAMS, LAKES, PONDS, OR RESERVOIRS WITHIN 100 FEET OF THE LIMITS OF DISTURBANCE.
5. NO NATURALLY PRODUCING TROUT STREAM WITHIN 300 FEET OF LIMITS OF DISTURBANCE.
6. NO GROUND INTAKE OR PUBLIC WATER SUPPLY WITHIN 1000 FEET OF WELL PAD. LIMITS OF DISTURBANCE, E & S CONTROLS OR PUBLIC WATER SUPPLY.

LINE	BEARING	DISTANCE	CURVE LENGTH	DESCRIPTION
L3	S 65°08'38" W	1,490.09'	2,196.98'	SHL TO LPL
L4	S 29°59'53" E	499.27'	499.91'	AZL1 TO AZL2
L5	S 34°59'55" E	199.91'	199.91'	AZL2 TO AZL3
L6	S 25°05'35" E	986.25'	990.66'	AZL3 TO AZL4
L7	S 15°11'00" E	200.26'	200.26'	AZL4 TO AZL5
L8	S 20°03'20" E	488.67'	489.27'	AZL5 TO AZL6
L9	S 24°55'41" E	2,698.71'	2,698.71'	AZL6 TO AZL7
L10	S 18°24'51" E	649.64'	650.50'	AZL7 TO AZL8
L11	S 11°53'59" E	607.67'	607.67'	AZL8 TO BHL

NOTES ON SURVEY

1. TIES TO WELLS AND CORNERS ARE BASED ON STATE PLANE WV NORTH ZONE NAD '83.
2. WELL LAT./LONG ESTABLISHED BY DIRECT GPS NAD '83.
3. BOUNDARIES SHOWN ARE TAKEN FROM TAX MAPS, DEEDS, AND FIELD SURVEY. THIS DRAWING IS NOT REPRESENTATIVE OF A FULL BOUNDARY SURVEY.
4. SURFACE OWNER INFORMATION TAKEN FROM THE ASSESSOR AND COUNTY CLERK RECORDS OF OHIO COUNTY IN OCTOBER OF 2021.
5. WELLS SHOWN ARE TAKEN FROM RECORDS OF WVDEP.

I, THE UNDERSIGNED, HEREBY CERTIFY THAT THIS PLAT IS CORRECT TO THE BEST OF MY KNOWLEDGE AND BELIEF AND SHOWS ALL THE INFORMATION REQUIRED BY LAW AND REGULATIONS ISSUED AND PRESCRIBED BY THE DEPARTMENT OF ENVIRONMENTAL PROTECTION.

P.S. 983



(+) DENOTES LOCATION OF WELL ON UNITED STATES TOPOGRAPHIC MAPS

WVDEP
 OFFICE OF OIL & GAS
 601 57TH STREET
 CHARLESTON, WV 25034

MINIMUM DEGREE OF ACCURACY: 1/200

PROVEN SURVEY SOURCE OF GRADE GPS ELEVATION: (NAVD 88, US FT)

COMPANY: **SWN** Production Company, LLC

SHANNON FIELDS OHI

OPERATOR'S WELL #: 210H

API WELL #: 47 69 00334 H6A

STATE COUNTY PERMIT

WELL TYPE: OIL WASTE DISPOSAL PRODUCTION DEEP GAS LIQUID INJECTION STORAGE SHALLOW

WATERSHED: UPPER OHIO SOUTH ELEVATION: 1232.0'

DISTRICT: RICHLAND COUNTY: OHIO QUADRANGLE: WHEELING 7.5', WV

SURFACE OWNER: SHANNON FIELDS, LLC ACREAGE: ±35.07

OIL & GAS ROYALTY OWNER: SHANNON FIELDS, LLC ACREAGE: ±35.07

DRILL DRILL DEEPER REDRILL FRACTURE OR STIMULATE PLUG OFF OLD FORMATION PERFORATE NEW FORMATION

CONVERT PLUG & ABANDON CLEAN OUT & REPLUG OTHER CHANGE (SPECIFY)

TARGET FORMATION: MARCELLUS ESTIMATED DEPTH: 6,256 TVD 20,927 TMD

WELL OPERATOR: SWN PRODUCTION COMPANY, LLC DESIGNATED AGENT: BRITANY WOODY

ADDRESS: 1300 FORT PIERPONT DRIVE, SUITE 201 ADDRESS: 1300 FORT PIERPONT DRIVE, SUITE 201

CITY: MORGANTOWN STATE: WV ZIP CODE: 26508 CITY: MORGANTOWN STATE: WV ZIP CODE: 26508

LEGEND:

- PROPOSED SURFACE HOLE / BOTTOM HOLE
- EXISTING / PRODUCING WELLHEAD
- LPL: LANDING POINT LOCATION
- EXISTING WATER WELL
- EXISTING SPRING
- SURVEYED BOUNDARY
- DRILLING UNIT
- LEASE BOUNDARY
- PROPOSED PATH

REVISIONS:

DATE: 01-26-2022

DRAWN BY: NBG

SCALE: 1" = 2000'

DRAWING NO: ACE-2326

WELL LOCATION PLAT

LONGITUDE: 80°37'30" SURFACE HOLE 13,341' BOTTOM HOLE 26,856'

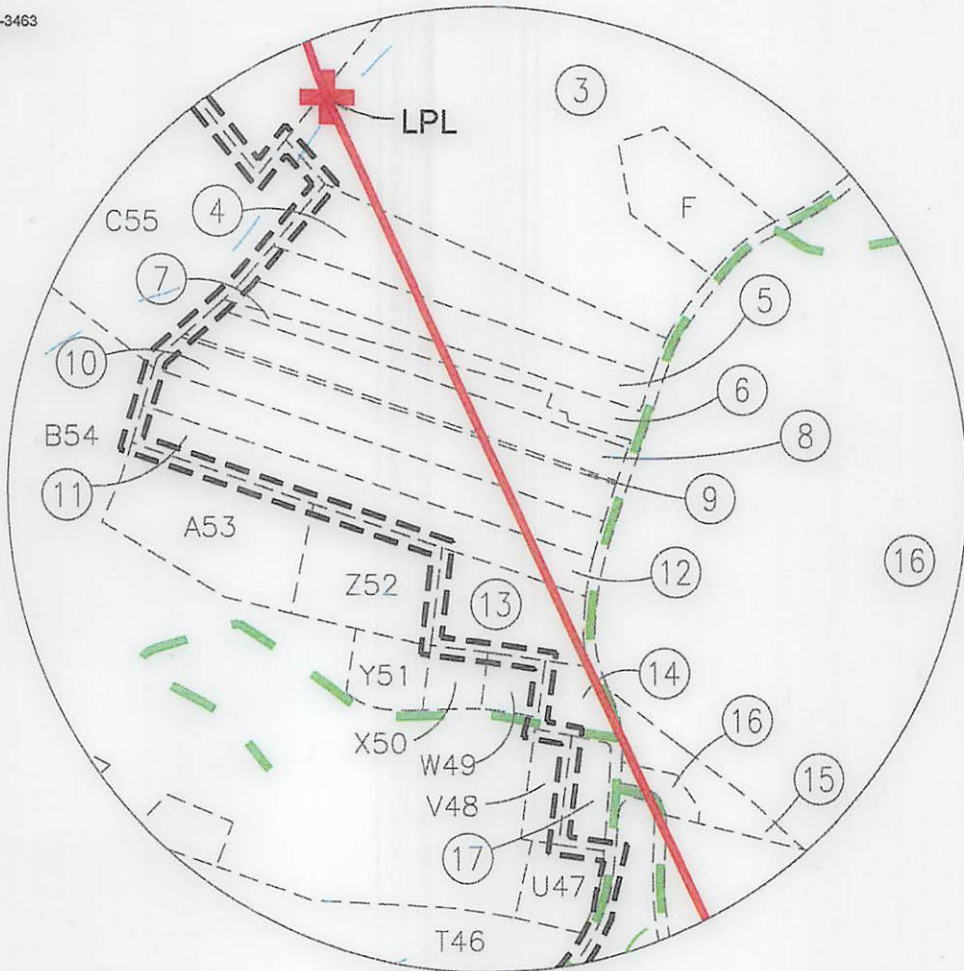

BLOW UP INSET 1
SCALE: 1"=500'

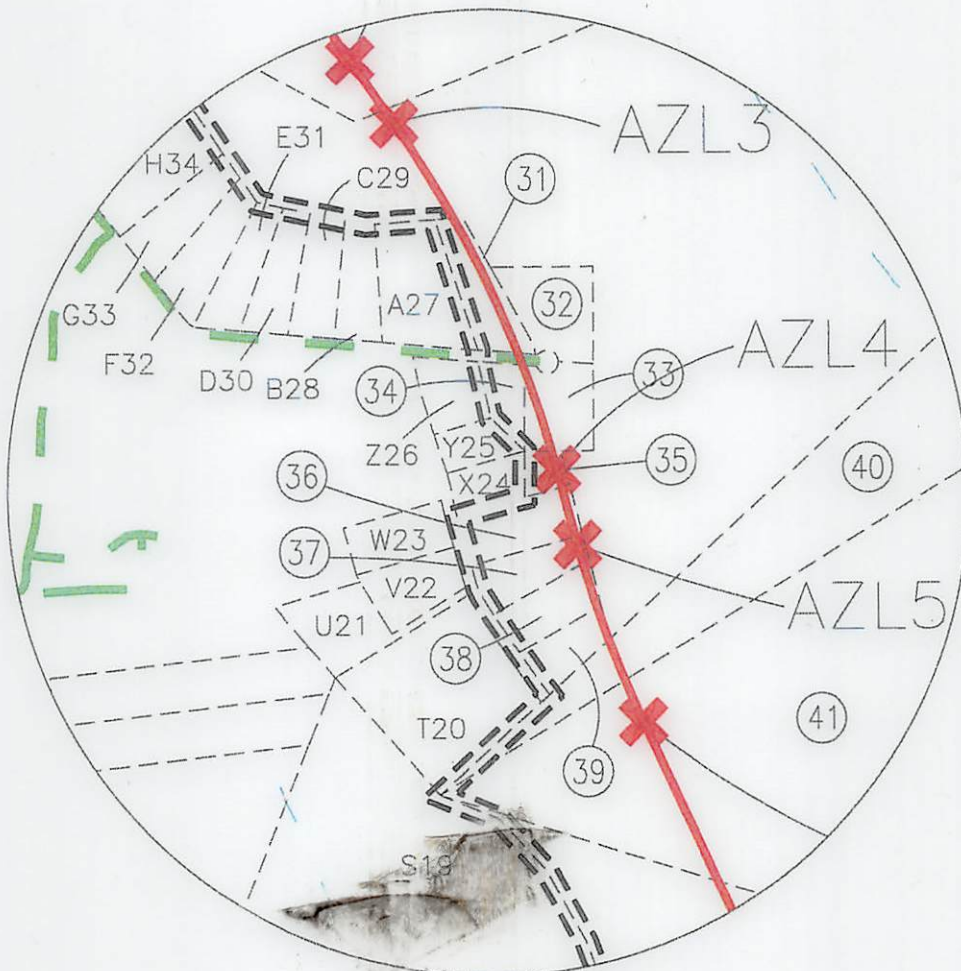

BLOW UP INSET 2
SCALE: 1"=500'

REVISIONS:	4706900334 H6A

COMPANY:		
OPERATOR'S	SHANNON FIELDS OHI	
WELL #:	47-069-00334 - M00210H	
DISTRICT:	COUNTY:	STATE:
RICHLAND	OHIO	WV

DATE: 01-26-2022
DRAWN BY: NBC
SCALE: N/A
DRAWING NO: ACE-2326
WELL LOCATION PLAT

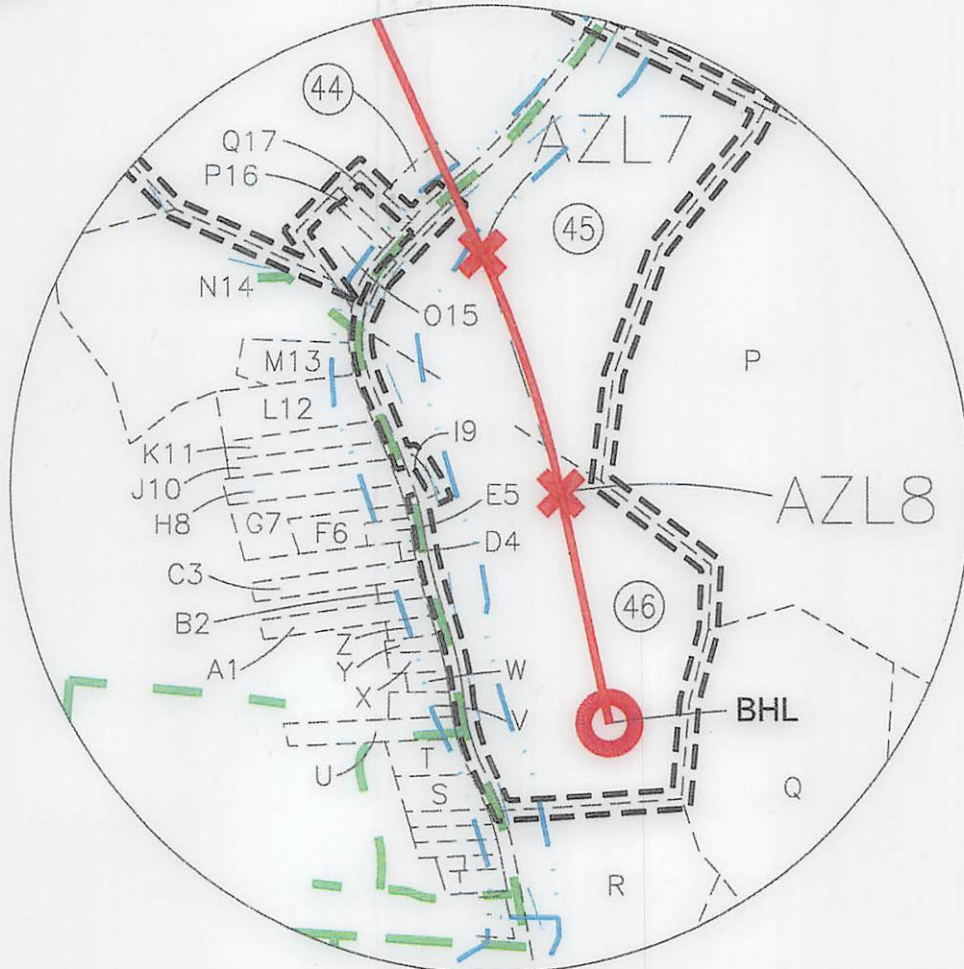

BLOW UP INSET 3
SCALE: 1"=500'

REVISIONS:

COMPANY:

SWN
Production Company, LLC

SWN *R⁺V⁺*
Production Company™

OPERATOR'S SHANNON FIELDS OHI

WELL #: 47-069-00334 210H -MOD

DISTRICT:
RICHLAND

COUNTY:
OHIO

STATE:
WV

DATE: 01-26-2022

DRAWN BY: NBC
SCALE: N/A
DRAWING NO: ACE-2326
WELL LOCATION PLAT



SURVEYOR/ENGINEER: 1-304-933-3463
 2361 DAVISSON RUN ROAD, SUITE 103
 CLARKSBURG, WV 26301

WELL BORE TABLE FOR SURFACE/ROYALTY OWNERS		
TRACT	SURFACE OWNER (S)/ROYALTY OWNER (R)	TAX PARCEL
1	SHANNON FIELDS, LLC (S/R)	4-R17-23.2
TRACT	SURFACE OWNER	TAX PARCEL
2	PARK VIEW MEMORIAL GARDENS, INC.	4-R17-8
3	NADA E. BENEKE, ET AL	4-R17-19
4	CRAIG V. & EMMA L. OLEARY	4-R17-17
5	JERMEY A. SCHREIBER & ELIZABETH PHILBRICK	4-R17-16
6	GUNTHER F. & M E. HEMPELMAN	4-R17-14
7	COLUMBIA GAS TRANSMISSION CORP.	4-R17-15
8	GUNTHER F. & M E. HEMPELMAN	4-R17-13
9	CARL D. III & JOLIN H. BURKLAND	4-R17-13.1
10	CARL D. III & JOLIN H. BURKLAND	4-R17-12
11	HARRY S. & BARBARA J. FISHER	4-R17-11
12	HARRY S. & BARBARA J. FISHER	4-R17-11.1
13	MATTHEW & VICTORIA GOMPERS	4-R17-10.2
14	SHASHI R & MONISHA URVAL	6-T2J-1
15	RICHARD P. & KIM M. CARTER	4-R17-23.1
16	RICHARD P. CARTER	4-R17-23.3
17	DAVID N. GAUDINO & ANN C. HOGE	6-T2J-2
18	ERICA D. & WARREN C. III WILCOX	6-T2-14
19	RODD A. & LISA R. FRANKE	6-T2-15.3
20	RODD A. & LISA R. FRANKE	6-T2-15.4
21	MICHAEL W. WILHELM	6-T2-15
22	CATHOLIC DIOCESE OF WHEELING - CHARLESTON	6-T2-11
23	DONALD G. & BECKY J. VILLANOVA	6-T2-15.2
24	DONALD G. & BECKY J. VILLANOVA	6-T2-16
25	LUANN & ARTHUR W. Jr. DANEHART	6-T2-16.1
26	LUANN & ARTHUR W. Jr. DANEHART	6-T2-16.2
27	WHEELING PARK COMMISSION	6-T7-95
28	BOARD OF EDUCATION	10-W56-1
29	BOARD OF EDUCATION	10-W56-2
30	FRANCES L. BRADEN - IRREVOC TRUST	6-T7-97
31	KENNETH & STEPHANIE SPENCER	6-T7-67.6
32	JONATHAN BRUCE WHARTON	6-T7-97.3
33	KEITH A. & WENDY J. POOLE	6-T7-97.2
34	W. C. & K. D. HAUGHT	6-T7-67.14
35	FRANCES L. BRADEN	6-T7-67
36	THOMAS L. & DONNA LYNNE FOLMAR	6-T7-67.18
37	WILLIAM O. IV & CANDICE M. LEWIS	6-T7-67.19
38	TODD M. & JENNY S. SCHIRTZINGER	6-T7-67.17
39	CHAD W. & REBECCA L. BROADWATER	6-T7-67.16
40	JAMES D. Jr. & CAROLINE K. MILLER	6-T7-117.2
41	JAMES D. Jr. & CAROLINE K. MILLER	6-T7-117.1
42	JAMES D. Jr. & CAROLINE K. MILLER	6-T7-117.3
43	PETERS RUN LAND Co., INC	6-T7-119
44	JOHN BUCHANAN	6-T7-121
45	JAY A. & LISA P. POWELL	6-T7-157
46	JANET NOEL	6-T7-126.3
ADJOINING OWNERS TABLE		
TRACT	SURFACE OWNER	TAX PARCEL
A	EARL P. HUFFNER	4-R17-24.1
B	JAMES R. MULL	4-R17-24
C	ROBERT W. MINCH, Jr. & HERBERT P. MINCH	4-R17-57
D	RUTH CARTER LEWIS, REVOCABLE TRUST	4-R17-23
E	NADA E. BENEKE	4-R17-22
F	THOMAS J. & MICHELLE N. JOHN	4-R17-20
G	CHARLES & DOLORES MONFRADI	4-R17-58
H	TIMMY B. & AMY L. MINCH	6-T2-18
I	WILLIAM A. & CYNTHIA ORUM	6-T7-178
J	DONALD A. & RHONDA L. BRADEN	6-T7-97.1
K	RALPH L. II & MELISSA E. FRITTER	6-T7-111
L	JAMES D., Jr. & CAROLINE K. MILLER	6-T7-112
M	JAMES D., Jr. & CAROLINE K. MILLER	6-T7-117
N	PETERS RUN LAND Co., INC.	6-T7-118
O	DANIEL F. OCH	6-T7-156

ADJOINING OWNERS TABLE		
TRACT	SURFACE OWNER	TAX PARCEL
P	LUCKY FARMS, LLC	6-T12-5
Q	BDDE PROPERTIES, LLC	6-T12-4
R	PAJASA LIMITED LIABILITY Co.	6-T12-2.1
S	OHIO VALLEY REALTY COMPANY	6-T12B-13.1
T	OHIO VALLEY REALTY COMPANY	6-T12B-13
U	JOYCE A. TSORAS	6-T12B-12
V	MARK D. PANEPINTO	6-T12B-11
W	MICHAEL M. & CATHY McCULLLEY	6-T12B-8
X	MARY L. QUIGLEY	6-T12B-7
Y	DENNIS THORN	6-T12B-6
Z	JEFFERY D. GIUSTINIANI & JAMACA S. DOFKA	6-T12B-4
A1	TABATHA WILSON	6-T12B-3
C3	DENNIS R. THORN, ET AL	6-T12B-1
D4	JEFFREY D. & FRANCES M. McKENZIE	6-T12B-1.1
E5	GRETA M. GATES & R. A. FOOSE	6-T7-133
F6	SCOTT R. STEWART & MICHELLE L. NICHOLSON	6-T7-132
G7	HAROLD H. & MARY K. BELL	6-T7-131
H8	CHRISTINA M. MARTIN	6-T7-130
I9	POPCORN PROPERTIES, LLC	6-T7-126.1
J10	ROGER L. KENT, Jr.	6-T7-129.1
K11	ROGER L. KENT, Jr.	6-T7-129
L12	CARL W. & CHRISTINE S. McCARDLE	6-T7-128
M13	CARL W. McCARDLE	6-T7-127
N14	JOSEPHINE L. TAGGART	6-T7-125
O15	CHRISTINE M. POWELL	6-T7-124
P16	JAYME E. TIMBERLAKE	6-T7-123
Q17	JOHN BUCHANAN	6-T7-122
R18	PETERS RUN LAND Co., INC.	6-T7-125.1
S19	JOSEPHINE L. TAGGART	6-T7-125
T20	JAMES D., Jr. & CAROLINE K. MILLER	6-T7-67.1
U21	JOHN P. & MEREDITH L. TRISCHLER	6-T7-75.4
V22	JOHN P. & MEREDITH L. TRISCHLER	6-T7-75.3
W23	JOHN P. & MEREDITH L. TRISCHLER	6-T7-75.2
X24	KEVIN L. & MICHELLE J. HEILMAN	6-T7-67.15
Y25	RYAN P. & MICHELLE M. HUNKER	6-T7-67.20
Z26	SCOTT L. & DEANNA L. NESTOR	6-T7-67.3
A27	GERALD & ROSETTA J. BISCHOF	6-T7-67.7
B28	DEEDRA DAVIS	6-T7-67.5
C29	RONALD A. & PATRICIA L. ZANDRON	6-T7-67.8
D30	DALE A. & CAROL ANN FORESTER	6-T7-67.9
E31	MARIO B. & LOIS R. JULIAN	6-T7-67.13
F32	BENJAMIN & DANIELLE ELLWOOD	6-T7-67.23
G33	CAYLA J. & MATTHEW D. BLACK	6-T7-67.10
H34	FRANCES L. BRADEN, IRREVOC TRUST	10-W56-3
I35	VINCENET J. MAGNONE	6-T7-6
J36	BRIAN M. HINDERLITER	6-T7-6.4
K37	WHEELING PARK COMMISSION	6-T7-1
L38	WHEELING PARK COMMISSION	6-T2-17
M39	STEPHEN T. & MICHELLE L. VOGGRIN	6-T2-13
N40	RCK 2 GROUP, LLC	6-T2-13.1
O41	CATHOLIC DIOCESE OF WHEELING - CHARLESTON	6-T6-1
P42	WM & P.M. HESLOP	6-T2-8
Q43	D.A. & M.R. BECKER	6-T2-10
R44	CITY OF WHEELING	6-T2-11.1
S45	MARGUERITE M. CERRA - TOD	6-T2-7
T46	KAREN A. & VARONE K.J. PACHUTA	6-T2-3
U47	ROBERT J. & TAMI L. SEEVERS, WESBANCO TRUST	6-T2-2
V48	ROY ROGER SMITH - TOD	6-T2J-4
W49	JAMES C. & MARY E. WRIGHT	6-T2J-3
X50	ROBERT B. & K.S. NELSON	6-T2J-5
Y51	MICHAEL J. & SUSAN J. BAKER	6-T2J-7
Z52	MICHAEL J. & SUSAN J. BAKER	4-R17-10
A53	ATTILA A. LENKEY	4-R17-10.1
B54	WHEELING PARK COMMISSION	6-T1-2
C55	WHEELING PARK COMMISSION	4-R17-6.1
D56	GACS LP	10-W27A-1
E57	CITY OF WHEELING	4-R14-15
F58	SAM HINEBAUGH	4-R17-8.1
G59	KENDRA L. TAYLOR	4-R17-59.1
H60	DONALD R. & M.M. EDDY	4-R17-59.2

REVISIONS:

COMPANY:

SWN
 Production Company, LLC

SWN ^{R-V+0}
 Production Company™

OPERATOR'S SHANNON FIELDS OHI

WELL #: 47-069-00334 210H - MOD

DISTRICT:
 RICHLAND

COUNTY:
 OHIO

STATE:
 WV

DATE: 01-26-2022

DRAWN BY: NBG
 SCALE: N/A
 DRAWING NO: ACE-2326
 WELL LOCATION PLAT



Stansberry, Wade A <wade.a.stansberry@wv.gov>

Expedited Modification Horizontal H6A Well Work Permit API: 47-069-00334)

1 message

Stansberry, Wade A <wade.a.stansberry@wv.gov>

Mon, Mar 28, 2022 at 8:01 AM

To: Brittany Woody <Brittany_Woody@swn.com>, liz_gee@swn.com, Tiffany Hoffman <thoffman@assessor.state.wv.us>, mpowell@wvassessor.com, "Gayne J. Knitowski" <gayne.j.knitowski@wv.gov>

I have attached a copy of the newly issued well [permit](#) number. This will serve as your copy.

47-069-00334 - SHANNON FIELD OHI 210H

If you have any questions, then [please](#) contact us here at the Office of Oil and Gas.

Thank you,

Wade A. Stansberry
Environmental Resource Specialist 3
West Virginia Department of Environmental Protection
Office of Oil & Gas
601 57th St. SE
Charleston, WV 25304
(304) 926-0499 ext. 41115
(304) 926-0452 fax
Wade.A.Stansberry@wv.gov

2 attachments **IR-26 Blank.pdf**
169K **47-069-00334 - mod.pdf**
4593K