

BOTTOM HOLE LATITUDE: 40°07'30" 923'

SURFACE HOLE LATITUDE: 40°07'30" 3286'



www.jhacompanies.com
68011 Vineyard Road
St. Clairsville, Ohio 43950
740-695-6100

PROPOSED SURFACE HOLE

NOTES ON SURVEY

- COORDINATE SYSTEM IS UTM NAD 83 DATUM, ZONE 17, U.S. FOOT AND WELL COORDINATES ESTABLISHED USING SURVEY GRADE GPS.
- SURFACE AND ROYALTY OWNER INFORMATION AND THEIR BOUNDARIES SHOWN HEREON WERE PLOTTED FROM DEEDS AND/OR TAX PARCEL MAPS PROVIDED BY CLIENT AND/OR FIELD LOCATIONS.
- THIS PLAT DOES NOT REPRESENT A BOUNDARY SURVEY OF THE PARCELS SHOWN HEREON.
- NO DWELLINGS OR BUILDINGS WITHIN 625 FEET OF PROPOSED CENTER OF PAD
- NO PERENNIAL STREAMS, LAKES, PONDS, RESERVOIRS OR WETLANDS WITHIN 100 FEET OF THE LIMITS OF DISTURBANCE.
- NO NATURALLY PRODUCING TROUT STREAM WITHIN 300 FEET OF THE LIMITS OF DISTURBANCE.
- NO WATER WELLS OR DEVELOPED SPRINGS WITHIN 250 FEET OF PROPOSED WELL

01/18/2019



LINE	BEARING	DISTANCE
L1	S10°18'03"W	1407.94'
L2	S52°24'25"W	1114.82'

GRID NORTH
UTM, NAD83 DATUM, ZONE 17, US

SURFACE HOLE LONGITUDE: -80°35'00" 15338'

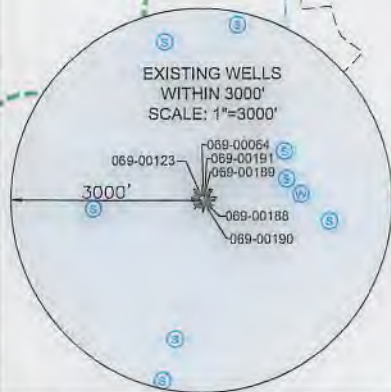
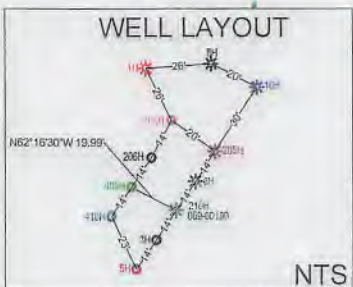

SURFACE HOLE LOCATION (SHL): UTM (NAD83, ZONE 17, METERS): NORTHING: 4440481.72 EASTING: 534502.07
LANDING POINT LOCATION (LPL): UTM (NAD83, ZONE 17, METERS): NORTHING: 4440309.41 EASTING: 533710.79
BOTTOM HOLE LOCATION (BHL): UTM (NAD83, ZONE 17, METERS): NORTHING: 4437032.09 EASTING: 535238.97



I, THE UNDERSIGNED, HEREBY CERTIFY THAT THIS PLAT IS CORRECT TO THE BEST OF MY KNOWLEDGE AND BELIEF AND SHOWS ALL THE INFORMATION REQUIRED BY LAW AND REGULATIONS ISSUED AND PRESCRIBED BY THE DEPARTMENT OF ENVIRONMENTAL PROTECTION.

P.S. 2041

COMPANY:



(+) DENOTES LOCATION OF WELL ON UNITED STATES TOPOGRAPHIC MAPS
WVDEP
OFFICE OF OIL & GAS
601 57TH STREET
CHARLESTON, WV 25034

MINIMUM DEGREE OF ACCURACY: 1/200
PROVEN SURVEY SOURCE OF GRADE GPS ELEVATION: (NAVD 83, US FT)

GLENN DIDRIKSEN OHI
OPERATOR'S WELL #: 406H
API WELL #: 47 STATE 069 COUNTY H6A 00293 PERMIT

WELL TYPE: OIL WASTE DISPOSAL PRODUCTION DEEP GAS LIQUID INJECTION STORAGE SHALLOW

WATERSHED: UPPER OHIO SOUTH ELEVATION: 1383.0'

DISTRICT: LIBERTY COUNTY: OHIO QUADRANGLE: VALLEY GROVE, WV

SURFACE OWNER: GLENN DIDRIKSEN ACREAGE: ±47.93

OIL & GAS ROYALTY OWNER: D&D FAST FOODS, INC ACREAGE: ±47.93

DRILL DRILL DEEPER REDRILL FRACTURE OR STIMULATE PLUG OFF OLD FORMATION PERFORATE NEW FORMATION

CONVERT PLUG & ABANDON CLEAN OUT & REPLUG OTHER CHANGE (SPECIFY)

TARGET FORMATION: MARCELLUS ESTIMATED DEPTH: 6,550' TVD 19,239.5'TMD

WELL OPERATOR: SWN PRODUCTION COMPANY, LLC DESIGNATED AGENT: BRITTANY WOODY

ADDRESS: P.O. BOX 1300 ADDRESS: P.O. BOX 1300

CITY: JANE LEW STATE: WV ZIP CODE: 26378 CITY: JANE LEW STATE: WV ZIP CODE: 26378

LEGEND: ○ PROPOSED SURFACE HOLE / BOTTOM HOLE * EXISTING / PRODUCING WELLHEAD LPL* LANDING POINT LOCATION ⊙ EXISTING WATER WELL ⊕ EXISTING SPRING	REVISIONS:	DATE: 10-15-2018
--- PUBLIC ROAD --- SURVEYED BOUNDARY - - - LEASE BOUNDARY --- PROPOSED PATH		DRAWN BY: D. REED SCALE: 1" = 2000' DRAWING NO: 2017-342 WELL LOCATION PLAT

609-00293





07/18/2019

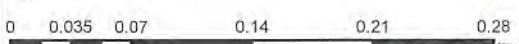

 1 in = 583 ft



Coordinate System: NAD 1983 UTM Zone 17N
Units: Meter

-  Spring
 -  Water Well
 -  Pond
 -  1500' Buffer
- OCT 22 2018
 WV Department of Environmental Protection

Coordinates: 40 112998 80 585174

Water Purveyor Map
 Well Pad: Glenn Didriksen
 County: OHI



Date: 3/6/2018 Author: willish