

NOTES ON SURVEY

1. COORDINATE SYSTEM IS UTM NAD 83 DATUM, ZONE 17, U.S. FOOT AND WELL COORDINATES ESTABLISHED USING SURVEY GRADE GPS.
2. SURFACE AND ROYALTY OWNER INFORMATION AND THEIR BOUNDARIES SHOWN HEREON WERE PLOTTED FROM DEEDS AND/OR TAX PARCEL MAPS PROVIDED BY CLIENT AND/OR FIELD LOCATIONS.
3. THIS PLAT DOES NOT REPRESENT A BOUNDARY SURVEY OF THE PARCELS SHOWN HEREON.
4. NO DWELLINGS OR BUILDINGS WITHIN 625 FEET OF PROPOSED CENTER OF PAD.
5. NO PERENNIAL STREAMS, LAKES, PONDS, RESERVOIRS OR WETLANDS WITHIN 100 FEET OF THE LIMITS OF DISTURBANCE.
6. NO NATURALLY PRODUCING TROUT STREAM WITHIN 300 FEET OF THE LIMITS OF DISTURBANCE.
7. NO WATER WELLS OR DEVELOPED SPRINGS WITHIN 250 FEET OF PROPOSED WELL.

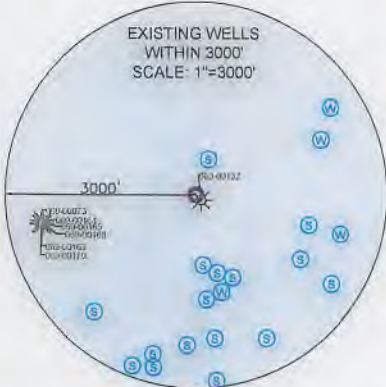

www.jhacompanies.com  
 68011 Vineyard Road  
 St. Clairsville, Ohio 43950  
 740-695-6100

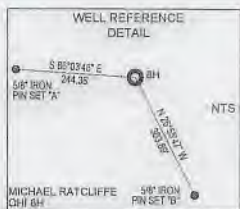

<b>SURFACE HOLE LOCATION (SHL):</b>
UTM (NAD83, ZONE 17, METERS): NORTHING: 4444328.61 EASTING: 536880.45
<b>LANDING POINT (LPL):</b>
UTM (NAD83, ZONE 17, METERS): NORTHING: 4444298.18 EASTING: 537267.40
<b>BOTTOM HOLE LOCATION (BHL):</b>
UTM (NAD83, ZONE 17, METERS): NORTHING: 4439403.38 EASTING: 539441.62

I, THE UNDERSIGNED, HEREBY CERTIFY THAT THIS PLAT IS CORRECT TO THE BEST OF MY KNOWLEDGE AND BELIEF AND SHOWS ALL THE INFORMATION REQUIRED BY LAW AND REGULATIONS ISSUED AND PRESCRIBED BY THE DEPARTMENT OF ENVIRONMENTAL PROTECTION.



COMPANY: **SWN** Production Company, LLC

	(+) DENOTES LOCATION OF WELL ON UNITED STATES TOPOGRAPHIC MAPS	MINIMUM DEGREE OF ACCURACY: 1/200	OPERATOR'S WELL #: MICHAEL RATCLIFFE OHI 8H
	WVDEP OFFICE OF OIL & GAS 601 57TH STREET CHARLESTON, WV 25034	PROVEN SURVEY SOURCE OF ELEVATION: GRADE GPS (NAVD 88, US FT)	API WELL #: 47 069 002751000 STATE COUNTY PERMIT

WELL TYPE: OIL  WASTE DISPOSAL  PRODUCTION  DEEP  GAS  LIQUID INJECTION  STORAGE  SHALLOW

WATERSHED: OHIO UPPER SOUTH ELEVATION: 1,281.2'

DISTRICT: LIBERTY COUNTY: OHIO QUADRANGLE: BETHANY & VALLEY GROVE, WV

SURFACE OWNER: MICHAEL T. RATCLIFFE ACREAGE: ±55.835

OIL & GAS ROYALTY OWNER: MICHAEL T. RATCLIFFE ACREAGE: ±55.835

DRILL  DRILL DEEPER  REDRILL  FRACTURE OR STIMULATE  PLUG OFF OLD FORMATION  PERFORATE NEW FORMATION

CONVERT  PLUG & ABANDON  CLEAN OUT & REPLUG  OTHER CHANGE  (SPECIFY)

TARGET FORMATION: MARCELLUS ESTIMATED DEPTH: 6,550' TVD 24,414.5' TMD

WELL OPERATOR: SWN PRODUCTION COMPANY, LLC DESIGNATED AGENT: BRITTANY WOODY

ADDRESS: P.O. BOX 1300 ADDRESS: P.O. BOX 1300

CITY: JANE LEW STATE: WV ZIP CODE: 26378 CITY: JANE LEW STATE: WV ZIP CODE: 26378

<b>LEGEND:</b> ○ PROPOSED SURFACE HOLE / BOTTOM HOLE * EXISTING / PRODUCING WELLHEAD LPL * LANDING POINT LOCATION (W) EXISTING WATER WELL (S) EXISTING SPRING	— SURVEYED BOUNDARY ===== LEASE BOUNDARY — PROPOSED PATH	<b>REVISIONS:</b> DATE: 08-07-2018 DRAWN BY: D. REED SCALE: 1" = 3000' DRAWING NO: 2017-637 WELL LOCATION PLAT
--	--	---



**JHA**  
Companies  
SURVEYORS  
ENGINEERS  
ENVIRONMENTAL  
GIS MAPPING  
www.jhacompanies.com  
68011 Vineyard Road  
St. Clairsville, Ohio 43950  
740-695-6100

GRID NORTH  
UTM, NAD83 DATUM, ZONE 17, US FT

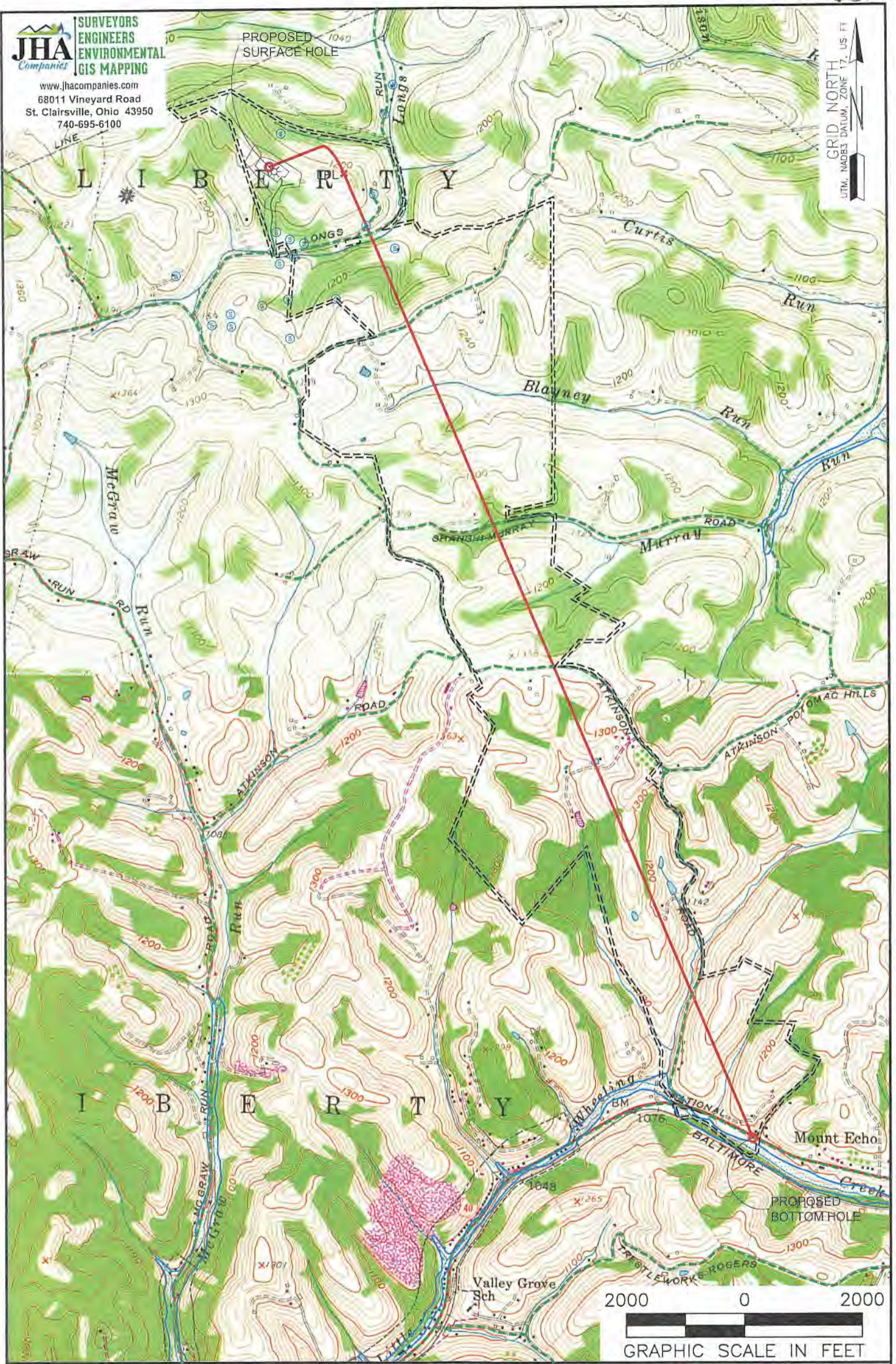

**NOTES ON SURVEY**

1. SURFACE AND ROYALTY OWNER INFORMATION AND THEIR BOUNDARIES SHOWN HEREON WERE PLOTTED FROM DEEDS AND/OR TAX PARCEL MAPS PROVIDED BY CLIENT AND/OR FIELD LOCATIONS.
2. THIS PLAT DOES NOT REPRESENT A BOUNDARY SURVEY OF THE PARCELS SHOWN HEREON.
3. ALL INSETS ARE GRID NORTH UNLESS OTHERWISE DEPICTED.

**LEGEND:**

- PROPOSED SURFACE HOLE / BOTTOM HOLE
- EXISTING / PRODUCING WELLHEAD
- LANDING POINT LOCATION
- FLOOD PLAN
- ACCESS ROAD
- PUBLIC ROAD
- ACCESS ROAD TO PREV. SITE
- LEASE BOUNDARY
- PROPOSED PATH

WELL OPERATOR: SWN PRODUCTION COMPANY, LLC	WELL (FARM) NAME: MICHAEL RATCLIFFE OHI	WELL # 8H	SERIAL # XXXX
ADDRESS: P.O. BOX 1300 JANE LEW, WV 26378	COUNTY - CODE OHIO - 069	DISTRICT; LIBERTY	
SURFACE OWNER: MICHAEL T. RATCLIFFE	USGS 7 1/2 QUADRANGLE MAP NAME BETHANY & VALLEY GROVE, WV		