

LATITUDE: 40°02'30" SURFACE HOLE

6945'

LATITUDE: 40°05'00" BOTTOM HOLE

787'



www.jhacompanies.com  
68011 Vineyard Road  
St. Clairsville, Ohio 43950  
740-695-6100

NOTES ON SURVEY

1. COORDINATE SYSTEM IS UTM NAD 83 DATUM, ZONE 17, U.S. FOOT AND WELL COORDINATES ESTABLISHED USING SURVEY GRADE GPS.
2. SURFACE AND ROYALTY OWNER INFORMATION AND THEIR BOUNDARIES SHOWN HEREON WERE PLOTTED FROM DEEDS AND/OR TAX PARCEL MAPS PROVIDED BY CLIENT AND/OR FIELD LOCATIONS.
3. THIS PLAT DOES NOT REPRESENT A BOUNDARY SURVEY OF THE PARCELS SHOWN HEREON.
4. NO DWELLINGS OR BUILDINGS WITHIN 625 FEET OF PROPOSED CENTER OF PAD.
5. NO PERENNIAL STREAMS, LAKES, PONDS, RESERVOIRS OR WETLANDS WITHIN 100 FEET OF THE LIMITS OF DISTURBANCE.
6. NO NATURALLY PRODUCING TROUT STREAM WITHIN 300 FEET OF THE LIMITS OF DISTURBANCE.
7. NO WATER WELLS OR DEVELOPED SPRINGS WITHIN 300 FEET OF PROPOSED WELL.

05/31/2019

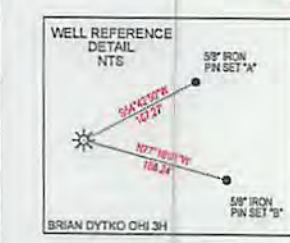

|   |
|---|
| <b>SURFACE HOLE LOCATION (SHL):</b>   |
| UTM (NAD83, ZONE 17, METERS):<br>NORTHING: 4431157.24<br>EASTING: 533452.35 |
| <b>LANDING POINT LOCATION (LPL):</b>  |
| UTM (NAD83, ZONE 17, METERS):<br>NORTHING: 4431325.04<br>EASTING: 533336.32 |
| <b>BOTTOM HOLE LOCATION (BHL):</b>  |
| UTM (NAD83, ZONE 17, METERS):<br>NORTHING: 4433335.26<br>EASTING: 531746.99 |

|   |
|---|
| <b>SURFACE HOLE LOCATION (SHL):</b>   |
| UTM (NAD83, ZONE 17, METERS):<br>NORTHING: 4431157.23<br>EASTING: 533452.38 |
| <b>LANDING POINT LOCATION (LPL):</b>  |
| UTM (NAD83, ZONE 17, METERS):<br>NORTHING: 4431320.94<br>EASTING: 533339.49 |
| <b>BOTTOM HOLE LOCATION (BHL):</b>  |
| UTM (NAD83, ZONE 17, METERS):<br>NORTHING: 4433336.39<br>EASTING: 531748.51 |

I, THE UNDERSIGNED, HEREBY CERTIFY THAT THIS PLAT IS CORRECT TO THE BEST OF MY KNOWLEDGE AND BELIEF AND SHOWS ALL THE INFORMATION REQUIRED BY LAW AND REGULATIONS ISSUED AND PRESCRIBED BY THE DEPARTMENT OF ENVIRONMENTAL PROTECTION.  
P.S. 2041



| LINE | BEARING     | DISTANCE |
|------|-------------|----------|
| L1   | S56°10'40"W | 2190.70' |
| L2   | S50°23'34"W | 1853.86' |

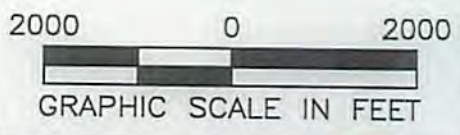

COMPANY: **SWN** Production Company, LLC **SWN** Production Company™

BRIAN DYTKO OH  
OPERATOR'S WELL #: 3H  
API WELL #: 47 069 00264  
STATE COUNTY PERMIT

WELL TYPE: OIL  WASTE DISPOSAL  PRODUCTION  DEEP  GAS  LIQUID INJECTION  STORAGE  SHALLOW   
WATERSHED: OHIO UPPER SOUTH  
DISTRICT: TRIADDELPHIA COUNTY: OHIO  
SURFACE OWNER: BRIAN J. DYTKO  
OIL & GAS ROYALTY OWNER: BRIAN J. DYTKO  
DRILL  DRILL DEEPER  REDRILL  FRACTURE OR STIMULATE  PLUG OFF OLD FORMATION  PERFORATE NEW FORMATION   
CONVERT  PLUG & ABANDON  CLEAN OUT & REPLUG  OTHER CHANGE  (SPECIFY) **AS-DRILLED**  
TARGET FORMATION: MARCELLUS ESTIMATED DEPTH: 6,365' TVD 15,147' TMD

WELL OPERATOR: SWN PRODUCTION COMPANY, LLC  
ADDRESS: 1300 FORT PIERPONT DRIVE, SUITE 201  
CITY: MORGANTOWN STATE: WV ZIP CODE: 26508  
DESIGNATED AGENT: BRITTANY WOODY  
ADDRESS: 1300 FORT PIERPONT DRIVE, SUITE 201  
CITY: MORGANTOWN STATE: WV ZIP CODE: 26508

LEGEND:  
○ PROPOSED SURFACE HOLE / BOTTOM HOLE  
\* EXISTING / PRODUCING WELLHEAD  
LPL \* LANDING POINT LOCATION  
\* EXISTING WATER WELL  
⊙ EXISTING SPRING  
— SURVEYED BOUNDARY  
===== LEASE BOUNDARY  
— ASDRILLED PATH  
— PROPOSED PATH

REVISIONS:  
DATE: 03-14-2019  
API NO: 47-069-00264  
DRAWN BY: D. REED  
SCALE: 1" = 2000'  
DRAWING NO: 2017-300  
WELL LOCATION PLAT



05/31/2019

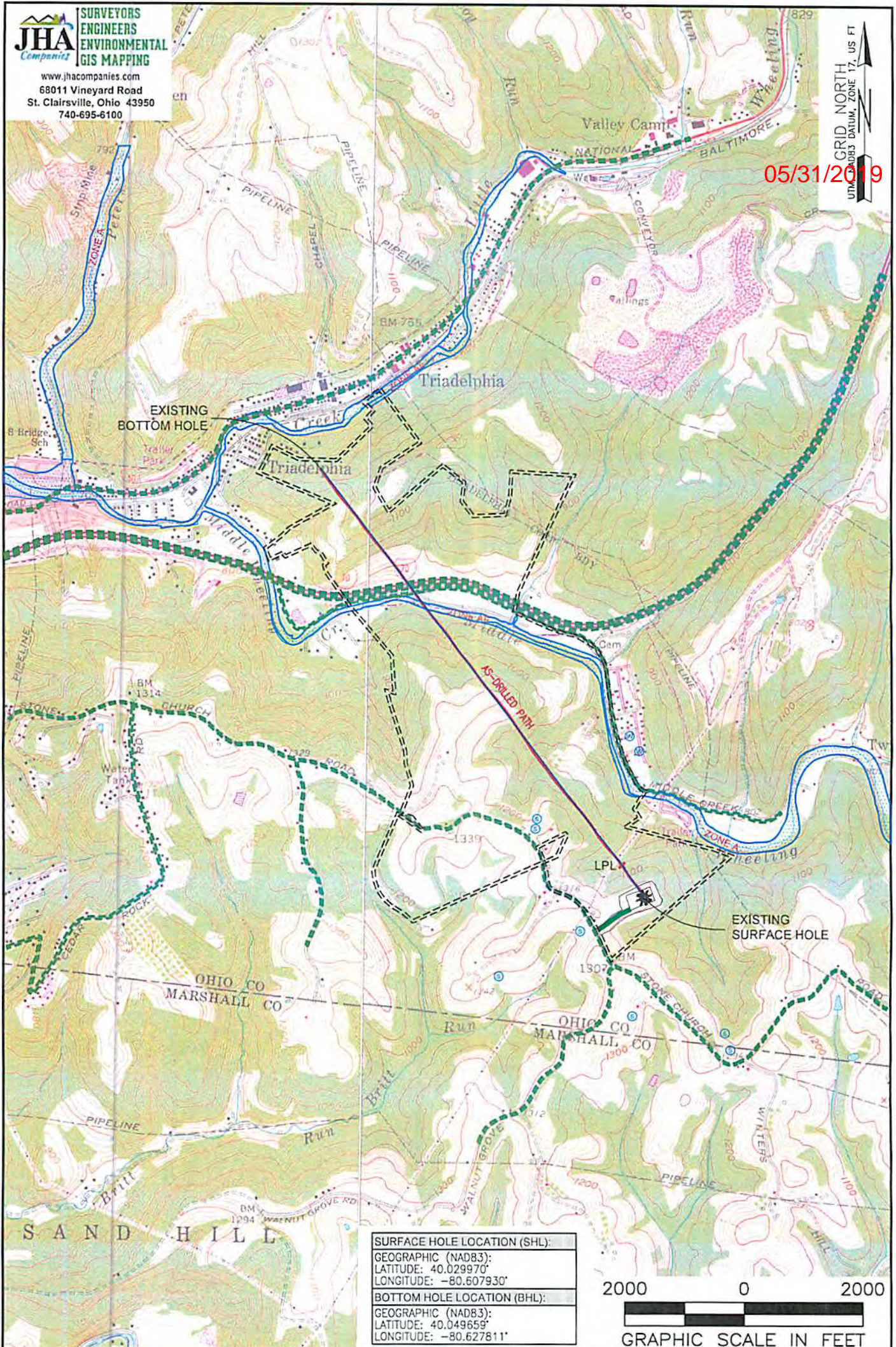

|                                     |
|-------------------------------------|
| <b>SURFACE HOLE LOCATION (SHL):</b> |
| GEOGRAPHIC (NAD83):                 |
| LATITUDE: 40.029970°                |
| LONGITUDE: -80.607930°              |
| <b>BOTTOM HOLE LOCATION (BHL):</b>  |
| GEOGRAPHIC (NAD83):                 |
| LATITUDE: 40.049659°                |
| LONGITUDE: -80.627811°              |

**NOTES ON SURVEY**

1. SURFACE AND ROYALTY OWNER INFORMATION AND THEIR BOUNDARIES SHOWN HEREON WERE PLOTTED FROM DEEDS AND/OR TAX PARCEL MAPS PROVIDED BY CLIENT AND/OR FIELD LOCATIONS.
2. THIS PLAT DOES NOT REPRESENT A BOUNDARY SURVEY OF THE PARCELS SHOWN HEREON.
3. ALL INSETS ARE GRID NORTH UNLESS OTHERWISE DEPICTED.

**LEGEND:**

- PROPOSED SURFACE HOLE / BOTTOM HOLE
- EXISTING / PRODUCING WELLHEAD
- LPL\* LANDING POINT LOCATION
- FLOOD PLAN
- ACCESS ROAD
- PUBLIC ROAD
- ACCESS ROAD TO PREV. SITE
- LEASE BOUNDARY
- PROPOSED PATH
- ASDRILLED PATH

|  |   |                                 |                                |
|--|---|---------------------------------|--------------------------------|
| <b>WELL OPERATOR:</b><br>SWN PRODUCTION COMPANY, LLC                         | <b>WELL (FARM) NAME:</b><br>BRIAN DYTKO OH                                | <b>WELL #</b><br>3H             | <b>SERIAL #</b><br>XXXX        |
| <b>ADDRESS:</b><br>1300 FORT PIERPONT DRIVE, SUITE 201, MORGANTOWN, WV 26508 | <b>COUNTY - CODE</b><br>OHIO - 069  | <b>DISTRICT:</b><br>TRIADELPHIA | <b>API NO:</b><br>47-069-00264 |
| <b>SURFACE OWNER:</b><br>BRIAN J. DYTKO                                      | <b>USGS 7 1/2 QUADRANGLE MAP NAME:</b><br>VALLEY GROVE, WV & WHEELING, WV |                                 |                                |