

LATITUDE: 40°02'30" SURFACE HOLE

6962'

LATITUDE: 40°05'00" BOTTOM HOLE

1450'



www.jhacompanies.com
68011 Vineyard Road
St. Clairsville, Ohio 43950
740-695-6100

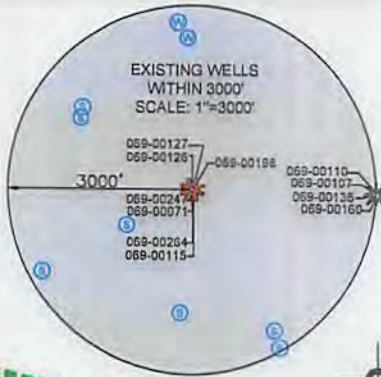

NOTES ON SURVEY

- 1. COORDINATE SYSTEM IS UTM NAD 83 DATUM, ZONE 17, U.S. FOOT AND WELL COORDINATES ESTABLISHED USING SURVEY GRADE GPS.
2. SURFACE AND ROYALTY OWNER INFORMATION AND THEIR BOUNDARIES SHOWN HEREON WERE PLOTTED FROM DEEDS AND/OR TAX PARCEL MAPS PROVIDED BY CLIENT AND/OR FIELD LOCATIONS.
3. THIS PLAT DOES NOT REPRESENT A BOUNDARY SURVEY OF THE PARCELS SHOWN HEREON.
4. NO DWELLINGS OR BUILDINGS WITHIN 625 FEET OF PROPOSED CENTER OF PAD
5. NO PERENNIAL STREAMS, LAKES, PONDS, RESERVOIRS OR WETLANDS WITHIN 100 FEET OF THE LIMITS OF DISTURBANCE.
6. NO NATURALLY PRODUCING TROUT STREAM WITHIN 200 FEET OF THE LIMITS OF DISTURBANCE.
7. NO WATER WELLS OR DEVELOPED SPRINGS WITHIN 250 FEET OF PROPOSED WELL.

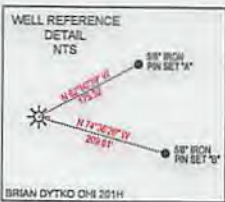

EXISTING BOTTOM HOLE



GRID NORTH UTM, NAD83 DATUM, ZONE 17, US FT

LONGITUDE: -80°35'00" BOTTOM HOLE

15121'

LONGITUDE: -80°37'30" SURFACE HOLE

4260'

SURFACE HOLE LOCATION (SHL): UTM (NAD83, ZONE 17, METERS): NORTHING: 4431161.49 EASTING: 533446.66

LANDING POINT LOCATION (LPL): UTM (NAD83, ZONE 17, METERS): NORTHING: 4431019.40 EASTING: 532727.24

BOTTOM HOLE LOCATION (BHL): UTM (NAD83, ZONE 17, METERS): NORTHING: 4432471.71 EASTING: 531549.00

SURFACE HOLE LOCATION (SHL): UTM (NAD83, ZONE 17, METERS): NORTHING: 4431161.53 EASTING: 533446.65

LANDING POINT LOCATION (LPL): UTM (NAD83, ZONE 17, METERS): NORTHING: 4431002.23 EASTING: 532747.70

BOTTOM HOLE LOCATION (BHL): UTM (NAD83, ZONE 17, METERS): NORTHING: 4432475.52 EASTING: 531552.86

Table with 3 columns: LINE, BEARING, DISTANCE. L1: 338°45'21"W 2199.28'. L2: 300°03'32"W 1862.61'

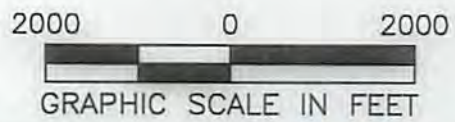

I, THE UNDERSIGNED, HEREBY CERTIFY THAT THIS PLAT IS CORRECT TO THE BEST OF MY KNOWLEDGE AND BELIEF AND SHOWS ALL THE INFORMATION REQUIRED BY LAW AND REGULATIONS ISSUED AND PRESCRIBED BY THE DEPARTMENT OF ENVIRONMENTAL PROTECTION.

P.S. 2041

COMPANY: SWN Production Company, LLC

(+) DENOTES LOCATION OF WELL ON UNITED STATES TOPOGRAPHIC MAPS
WVDEP OFFICE OF OIL & GAS
801 57TH STREET
CHARLESTON, WV 25034

MINIMUM DEGREE OF ACCURACY: 1/200
PROVEN SOURCE OF ELEVATION: SURVEY GRADE GPS (NAVD 88, US FT)

BRIAN DYTKO OHI
OPERATOR'S WELL #: 201H
API WELL #: 47 069 00251
STATE COUNTY PERMIT

WELL TYPE: OIL [] WASTE DISPOSAL [] PRODUCTION [x] DEEP [] GAS [x] LIQUID INJECTION [] STORAGE [] SHALLOW [x]
WATERSHED: OHIO UPPER SOUTH
DISTRICT: TRIADDELPHIA COUNTY: OHIO
SURFACE OWNER: BRIAN J. DYTKO
OIL & GAS ROYALTY OWNER: BRIAN J. DYTKO
DRILL [] DRILL DEEPER [] REDRILL [] FRACTURE OR STIMULATE [] PLUG OFF OLD FORMATION [] PERFORATE NEW FORMATION []
CONVERT [] PLUG & ABANDON [] CLEAN OUT & REPLUG [] OTHER CHANGE [x] (SPECIFY) AS-DRILLED
TARGET FORMATION: MARCELLUS ESTIMATED DEPTH: 6,332' TVD 13,340' TMD

WELL OPERATOR: SWN PRODUCTION COMPANY, LLC
ADDRESS: 1300 FORT PIERPONT DRIVE, SUITE 201
CITY: MORGANTOWN STATE: WV ZIP CODE: 26508
DESIGNATED AGENT: BRITTANY WOODY
ADDRESS: 1300 FORT PIERPONT DRIVE, SUITE 201
CITY: MORGANTOWN STATE: WV ZIP CODE: 26508

LEGEND: PROPOSED SURFACE HOLE / BOTTOM HOLE, EXISTING / PRODUCING WELLHEAD, LPL: LANDING POINT LOCATION, EXISTING WATER WELL, EXISTING SPRING, SURVEYED BOUNDARY, LEASE BOUNDARY, AS-DRILLED PATH, PROPOSED PATH
REVISIONS:
DATE: 03-14-2019
API NO: 47-069-00251
DRAWN BY: D. REED
SCALE: 1" = 2000'
DRAWING NO: 2017-300
WELL LOCATION PLAT

05/31/2019

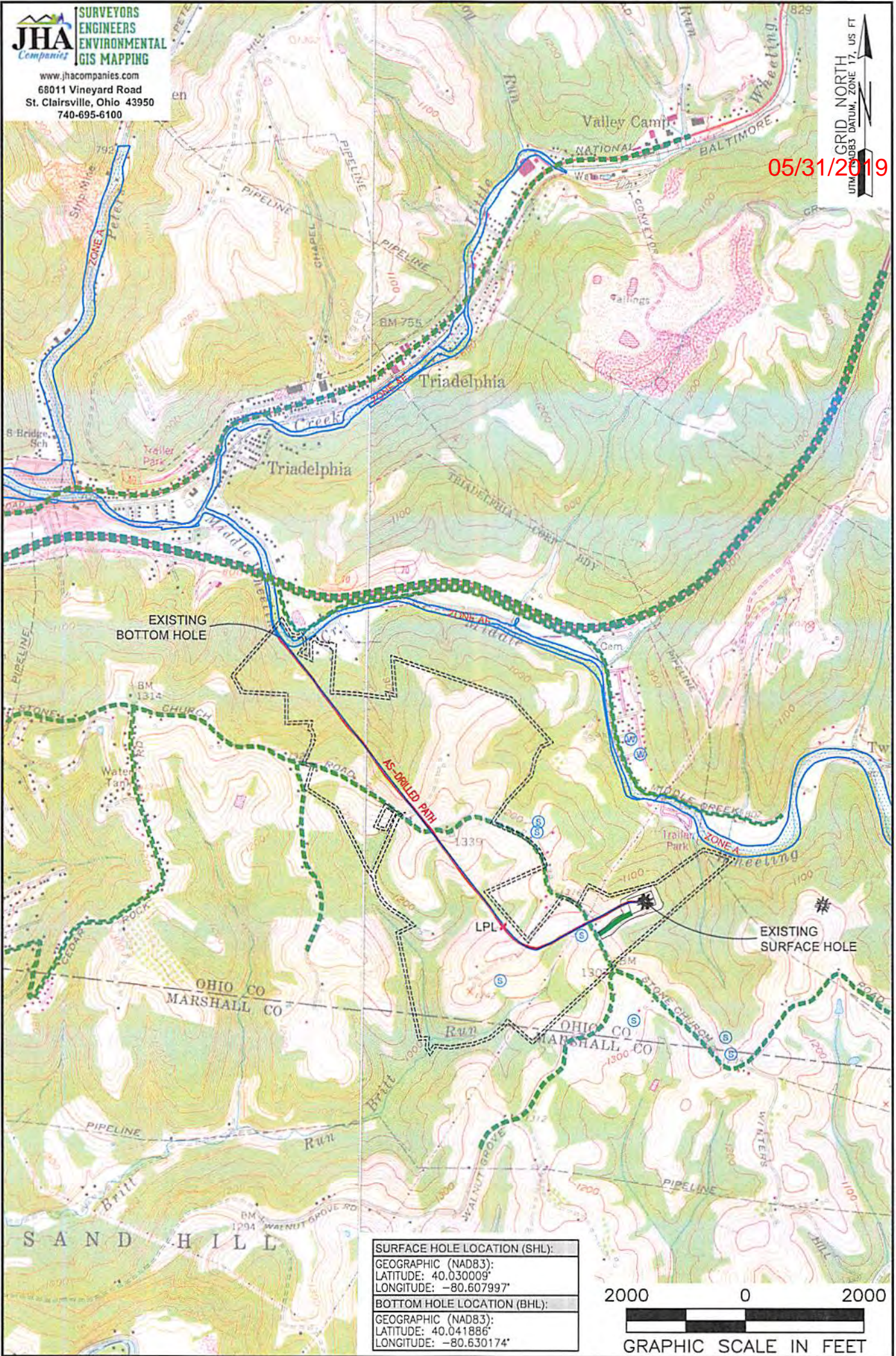

SURFACE HOLE LOCATION (SHL):
GEOGRAPHIC (NAD83):
LATITUDE: 40.030009°
LONGITUDE: -80.607997°
BOTTOM HOLE LOCATION (BHL):
GEOGRAPHIC (NAD83):
LATITUDE: 40.041886°
LONGITUDE: -80.630174°

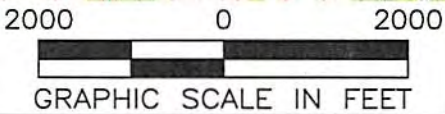

NOTES ON SURVEY

1. SURFACE AND ROYALTY OWNER INFORMATION AND THEIR BOUNDARIES SHOWN HEREON WERE PLOTTED FROM DEEDS AND/OR TAX PARCEL MAPS PROVIDED BY CLIENT AND/OR FIELD LOCATIONS.
2. THIS PLAT DOES NOT REPRESENT A BOUNDARY SURVEY OF THE PARCELS SHOWN HEREON.
3. ALL INSETS ARE GRID NORTH UNLESS OTHERWISE DEPICTED.

LEGEND:

- PROPOSED SURFACE HOLE / BOTTOM HOLE
- EXISTING / PRODUCING WELLHEAD
- LPL* LANDING POINT LOCATION
- FLOOD PLAIN
- ACCESS ROAD
- PUBLIC ROAD
- ACCESS ROAD TO PREV. SITE
- LEASE BOUNDARY
- PROPOSED PATH
- ASDRILLED PATH

WELL OPERATOR: SWN PRODUCTION COMPANY, LLC	WELL (FARM) NAME: BRIAN DYTKO OHI	WELL # 201H	SERIAL # XXXX
ADDRESS: 1300 FORT PIERPONT DRIVE, SUITE 201, MORGANTOWN, WV 26508	COUNTY - CODE OHIO - 069	DISTRICT: TRIADELPHIA	API NO: 47-069-00251
SURFACE OWNER: BRIAN J. DYTKO	USGS 7 1/2 QUADRANGLE MAP NAME: VALLEY GROVE, WV & WHEELING, WV		