

Latitude: 40°12'30"

8,356' BHL

3,573' SHL

THRASHER

THE THRASHER GROUP, INC.
600 WHITE OAKS BLVD.
BRIDGEPORT, WV 26330
PHONE 304-624-4108

- NOTES ON SURVEY**
- COORDINATES SYSTEM IS UTM, NAD 83 DATUM, ZONE 17, U.S. FOOT AND WELL COORDINATES ESTABLISHED USING SURVEY GRADE GPS.
 - SURFACE AND ROYALTY OWNER INFORMATION AND THEIR BOUNDARIES SHOWN HEREON WERE PLOTTED FROM DEEDS AND/OR TAX PARCEL MAPS PROVIDED BY CLIENT AND FIELD LOCATIONS.
 - THIS PLAT DOES NOT REPRESENT A BOUNDARY SURVEY OF THE PARCELS SHOWN HEREON.
 - NO DWELLINGS AND BUILDINGS WITHIN 625 FEET OF PROPOSED OF CENTER OF PAD.
 - NO WATER WELLS OR DEVELOPED SPRINGS WITHIN 250 FEET OF PROPOSED WELL.
 - NO PERENNIAL STREAMS, LAKES, PONDS, RESERVOIRS OR WETLANDS WITHIN 100 FEET OF THE LIMITS OF DISTURBANCE.
 - NO NATURALLY PRODUCING TROUT STREAM WITHIN 300 FEET OF LIMITS OF DISTURBANCE.

TRACT	ADJOINER	TAX PARCEL
A	JOHN P MINGA	03-15-3.1
B	GEORGE W GROVE Jr.	03-15-5.1
C	JOSEPH P TAGGART	03-15-5.3
D	NANCY L WILLIAMS	03-15-5.4
E	E L MONROE	03-15-7
F	GENE MONROE	03-15-7.3
G	GEORGE W GROVE Jr.	03-15-7.1
H	GENE & S MONROE	03-15-7.4
I	CHARLES W GROUNDS	03-15-4

GRID NORTH
UTM, NAD83 DATUM, ZONE 17, US FT

GRID NORTH
UTM, NAD83 DATUM, ZONE 17, US FT

Longitude: 80°32'30"

20,757' SHL

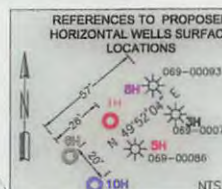
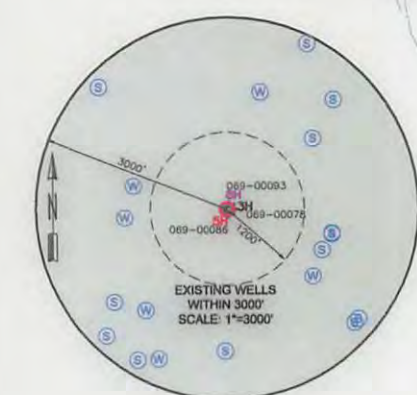

SURFACE HOLE LOCATION (SHL): UTM (NAD83, ZONE 17, METERS): NORTHING: 4,444,654.884 EASTING: 537,964.694	SURFACE HOLE LOCATION (SHL): UTM (NAD83, ZONE 17, METERS): NORTHING: 4,444,654.884 EASTING: 537,964.694
LANDING POINT LOCATION (LPL): UTM (NAD83, ZONE 17, METERS): NORTHING: 4,444,562.911 EASTING: 537,429.232	LANDING POINT LOCATION (LPL): UTM (NAD83, ZONE 17, METERS): NORTHING: 4,445,380.048 EASTING: 537,061.384
TURNING POINT LOCATION (TPL): UTM (NAD83, ZONE 17, METERS): NORTHING: 4,446,023.930 EASTING: 536,788.715	TURNING POINT LOCATION (TPL): UTM (NAD83, ZONE 17, METERS): NORTHING: 4,446,031.041 EASTING: 536,788.499
BOTTOM HOLE LOCATION (BHL): UTM (NAD83, ZONE 17, METERS): NORTHING: 4,447,154.908 EASTING: 536,491.068	BOTTOM HOLE LOCATION (BHL): UTM (NAD83, ZONE 17, METERS): NORTHING: 4,447,149.440 EASTING: 536,494.104

I, THE UNDERSIGNED, HEREBY CERTIFY THAT THIS PLAT IS CORRECT TO THE BEST OF MY KNOWLEDGE AND BELIEF AND SHOWS ALL THE INFORMATION REQUIRED BY LAW AND REGULATIONS ISSUED AND PRESCRIBED BY THE DEPARTMENT OF ENVIRONMENTAL PROTECTION.

P.S. 2270

MSW 1/8/18



GRAPHIC SCALE IN FEET

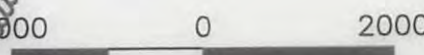

COMPANY:

SWN

SWN

Production Company, LLC

Production Company™



(+) DENOTES LOCATION OF WELL ON UNITED STATES TOPOGRAPHIC MAPS

WVDEP
OFFICE OF OIL & GAS
601 57TH STREET
CHARLESTON, WV 25034

MINIMUM DEGREE OF ACCURACY: 1/200

PROVEN SOURCE OF ELEVATION: SURVEY GRADE GPS (NAVD 88, US FT)

OPERATOR'S WELL #: THELMA HAYS OHI 1H

API WELL #: 47 STATE 069 COUNTY PERMIT 00236

WELL TYPE: OIL WASTE DISPOSAL PRODUCTION DEEP GAS LIQUID INJECTION STORAGE SHALLOW

WATERSHED: BUFFALO CREEK ELEVATION: 1244.1'

DISTRICT: LIBERTY COUNTY: OHIO

SURFACE OWNER: SHARON L GARRISON(LIFE ESTATE),TIMOTHY R HAYS AND THELMA C HAYS(REMAINDER) ACREAGE: ± 102.00

OIL & GAS ROYALTY OWNER: TIMOTHY R HAYS, THELMA C HAYS AND SHARON L GARRISON ACREAGE: ±102.00

DRILL DRILL DEEPER REDRILL FRACTURE OR STIMULATE PLUG OFF OLD FORMATION PERFORATE NEW FORMATION

CONVERT PLUG & ABANDON CLEAN OUT & REPLUG OTHER CHANGE (SPECIFY) AS-DRILLED

TARGET FORMATION: MARCELLUS ESTIMATED DEPTH: 6,351' 09/07/2018

WELL OPERATOR: SWN PRODUCTION COMPANY, LLC DESIGNATED AGENT: DEE SOUTHALL

ADDRESS: P.O. BOX 1300 ADDRESS: P.O. BOX 1300

CITY: JANE LEW STATE: WV ZIP CODE: 26378 CITY: JANE LEW STATE: WV ZIP CODE: 26378

LEGEND:

- PROPOSED SURFACE HOLE / BOTTOM HOLE
- ⊙ EXISTING / PRODUCING WELLHEAD
- LPL* LANDING POINT LOCATION
- ⊙ EXISTING WATER WELL
- ⊙ EXISTING SPRING
- SURVEYED BOUNDARY
- DRILLING UNIT
- == LEASE BOUNDARY
- PROPOSED PATH
- AS-DRILLED PATH
- TPL* TURNING POINT LOCATION

REVISIONS:

DATE: 01-08-2018

DRAWN BY: R. DOERR

SCALE: 1" = 2000'

DRAWING NO: 050-5660

WELL LOCATION PLAT